

CONTACT INFORMATION

- Website: www.supermicro.com
- General Information: marketing@supermicro.com
- Technical Support: support@supermicro.com
- Phone: +1 (408) 503-8000, Fax: +1 (408) 503-8008

FOR YOUR SYSTEM TO WORK PROPERLY, PLEASE DOWNLOAD APPROPRIATE

DRIVERS/IMAGES/USER'S MANUAL FROM THE LINKS BELOW:

- Manuals: <http://www.supermicro.com/support/manuals>
- Drivers & Utilities: <https://www.supermicro.com/wdl/>
- Safety: http://www.supermicro.com/about/policies/safety_information.cfm

PACKAGE CONTENTS

- One Supermicro Motherboard
- One Quick Reference Guide

WARNING: This product can expose you to chemicals including lead, known to the State of California to cause cancer and birth defects or other reproductive harm. For more information, go to www.P65Warnings.ca.gov.

Motherboard Layout and Features

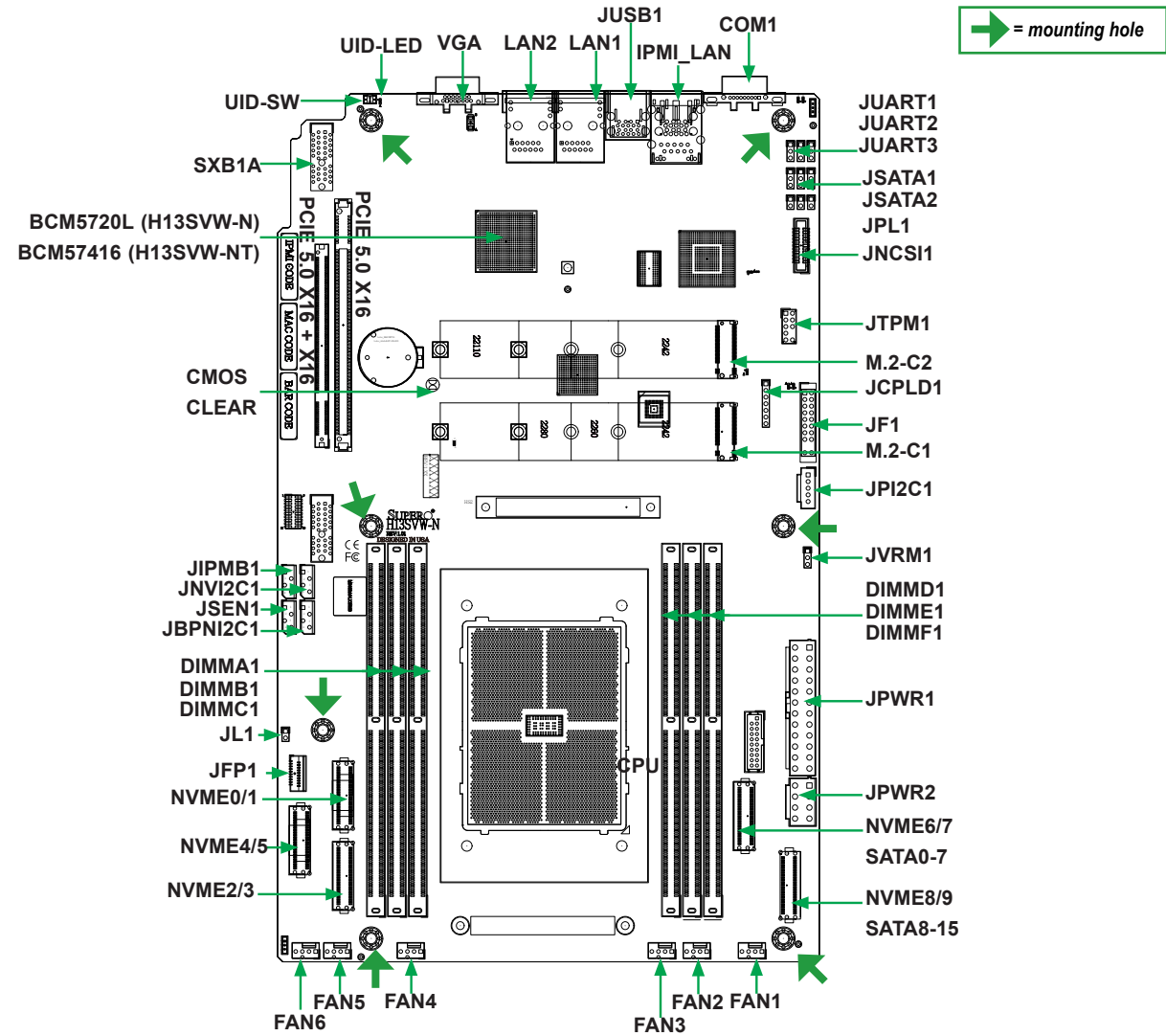

Rear I/O Panel Connectors

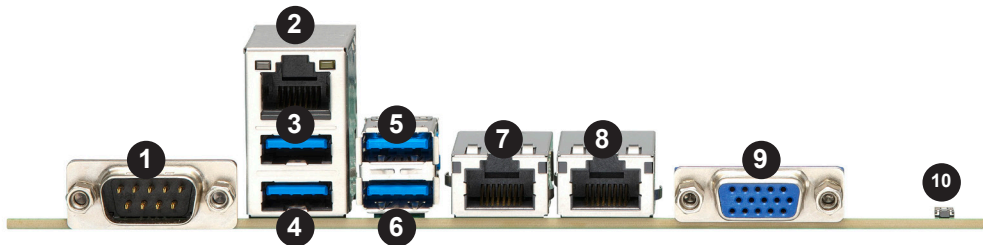

Rear I/O Ports					
#	Description	#	Description	#	Description
1	COM Port	5	USB 2 (3.0)	9	VGA Port
2	IPMI LAN Port	6	USB 3 (3.0)	10	UID Button & UID LED
3	USB 0 (3.0)	7	LAN Port #1		
4	USB 1 (3.0)	8	LAN Port #2		

Note: Graphics shown are for illustrative purposes only. Your components may or may not look exactly the same as drawings shown in this guide.

Jumpers, Connectors, and LED Indicators

Jumpers		
Jumper	Description	Default Setting
JBT1	Clear CMOS	Open (Normal)
JPL1	LAN enable/disable	Pins 1-2 (Enabled)
JSATA1	Hybrid MCIO select for JMCIO4	Pins 1-2 (Auto)
JSATA2	Hybrid MCIO select for JMCIO5	Pins 1-2 (Auto)
UID SW	Unit ID button (push-button toggle button ON/OFF)	Off

Connectors	
Connector	Description
Battery (BT1)	Onboard CMOS battery
COM 1	Rear panel COM port 1
FAN 1-6	System cooling fan headers
JF1	Front control panel
JIPMB1	4-pin external BMC I ² C header (for an IPMI card)
JL1	Chassis intrusion header
JPI2C1	PWR supply (I ² C) System Management Bus
JPWR1	24-pin ATX power supply connector
JPWR2	12 V 8-pin ATX CPU power connector
JSXB1A, JSXB1B, JSXB1C, JSXB2	Slots for Supermicro riser cards
JTPM1	Trusted Platform Module (TPM)/Port 80 connector
LAN1, LAN2	Back panel LAN1, LAN2 connectors
M.2-C1, M.2-C2	M.2 slots
NVMe0-5	NVMe slots 0-5
USB 0/1 (3.0)	Back panel USB 3.0 ports (USB 0/1)
USB 2/3 (3.0)	Back panel USB 3.0 ports (USB 2/3)
USB 4/5 (3.0)	Internal USB 3.0 header (USB 4/5)
VGA	Back panel VGA port

LED Indicators		
LED	Description	Status
LEDBMC	BMC Heartbeat	Blinking: BMC Normal/Working
LED8	Power LED	On: Power On
LED9	UID LED	Blue: UID Activated

Memory Installation

Populating DIMM Slots						
DIMMs						Nodes per Socket (NPS)
C1	B1	A1	D1	E1	F1	
1 DIMM						
		✓				NPS1
2 DIMMs						
		✓	✓			NPS2, NPS1
4 DIMMs						
✓		✓	✓		✓	NPS4, NPS2, NPS1
6 DIMMs						
✓	✓	✓	✓	✓	✓	NPS2, NPS1

Note: Refer to Chapter 2 of the User Manual for detailed information on jumpers, connectors, and LED indicators.

Processor Installation

The H13SVW-N/NT motherboard supports an AMD EPYC™ 8004 series processor in an SP6 socket.

- 1 Use a screwdriver to loosen the screws holding down the force frame in the sequence of 3-2-1.

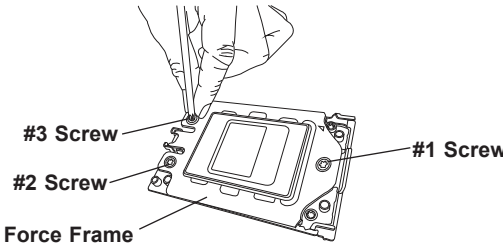

- 2 Raise the force frame and then the rail frame.



- 3 Remove the external cap and the PnP cover cap.

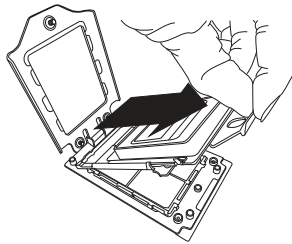

- 4 Insert the carrier frame/CPU package.

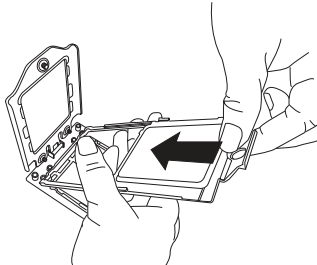

- 5 Lower and then secure the force frame. Secure the heatsink by tightening the four screws diagonally using a torque screwdriver set to 12.5 to 15.0 kgf-cm (10.8 to 13.0 in-lbf) in a clockwise direction until it is firmly in place. Your processor and heatsink are now installed on the motherboard.

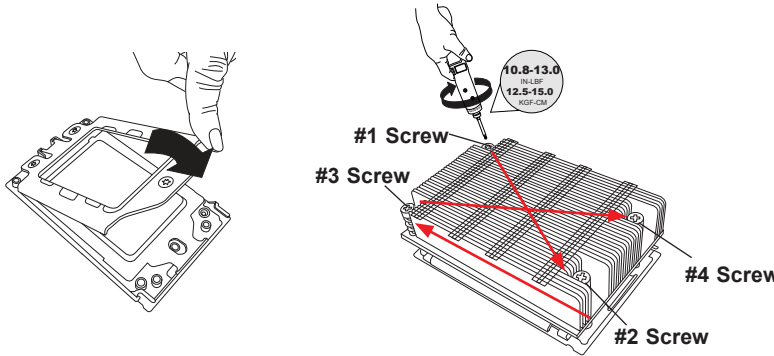

Note: Refer to Chapter 2 of the User Manual for detailed information on memory support and CPU/motherboard installation instructions.