



WIRELESS GAMING KEYBOARD X903 ROG STRIX MORPH 96 WIRELESS

Product Name / 品名： GAMING KEYBOARD / 電競鍵盤

Model / 型號： X903

MPDONGLE1/無線收發器

Quick Start Guide (US)

快速使用指南 (繁體中文)

快速使用指南 (简体中文)

クイックスタートガイド (JA)

빠른 시작 설명서 (KO)

Guide de démarrage rapide (FR)

Schnellstartanleitung (DE)

Guida rapida (IT)

Краткое руководство (RU)

Guia de inicio rápido (ES)

Beknopte handleiding (NL)

Hızlı Başlangıç Kılavuzu (TR)

Beüzemelési útmutató (HU)

Стисле керівництво для початку експлуатації (UA)

Instrukcja szybkiej instalacji (PL)

Rychlý průvodce (CZ)

Ghid de pornire rapidă (RO)

Snabbstartsguide (SE)

Stručný návod na spustenie (SK)

Panduan Konfigurasi Ringkas (ID)

Pikaopas (FI)

Hurtigstartveiledning (NO)

Guia de consulta rápida (PT-BR)

מדריך להתחלה מהירה (HB)

دليل التشغيل السريع (AR)

Package Contents / 包裝內容物 / 包装内容物



ROG STRIX MORPH 96 wireless gaming keyboard (US layout) * /
ROG STRIX MORPH 96 無線電競鍵盤 (美式布局) * /
ROG STRIX MORPH 96 无线电竞键盘 (美式布局) *



2-in-1 ROG keycap and switch puller /
二合一 ROG 接鍵器和接軸器

1 x Ctrl keycap /
1 x Ctrl 鍵帽

3 x ROG-themed keycaps (US layout) /
3 x ROG 主題鍵帽 (美式布局)



Wireless dongle extender** /
無線接收器延長器**

Wireless dongle /
無線接收器

USB Type-A to Type-C cable /
USB Type-C 轉 Type-A 轉接器



Sticker / 貼紙 / 貼紙



Technical documents / 技術文件 / 技术文件

* The illustration is for reference only. Actual product specifications may vary with models, such as keyboard layout. /
顯示僅供參考。實際產品規格如鍵盤佈局可能因型號而異。 /
图示仅供参考。实际产品规格如键盘布局可能因型号而异。

** Only use the wireless dongle extender for the wireless dongle. /
無線接收器延長器僅可用於連接無線接收器。 /
无线接收器延长器仅可用于连接无线接收器。

Keyboard features

Top view (US layout for reference)



Rear view

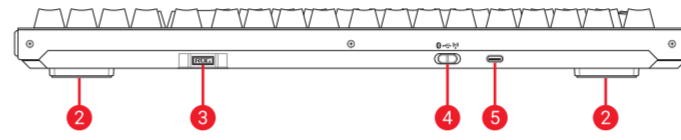

Left view

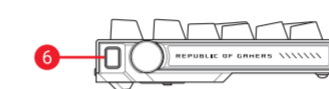

1 Multiwheel / 多功能滾輪 / 多功能滚轮

2 Adjustable feet with 3 tilt positions / 三檔可調節腳墊 / 三档可调节脚垫

3 Dongle storage / 無線接收器收納 / 无线接收器收纳

4 Connection mode switch / 連線模式切換開關 / 连接模式切换开关

5 USB Type-C® port / USB Type-C® 連接埠 / USB Type-C® 接口

6 Function switch button / 功能切換開關 / 功能切换开关

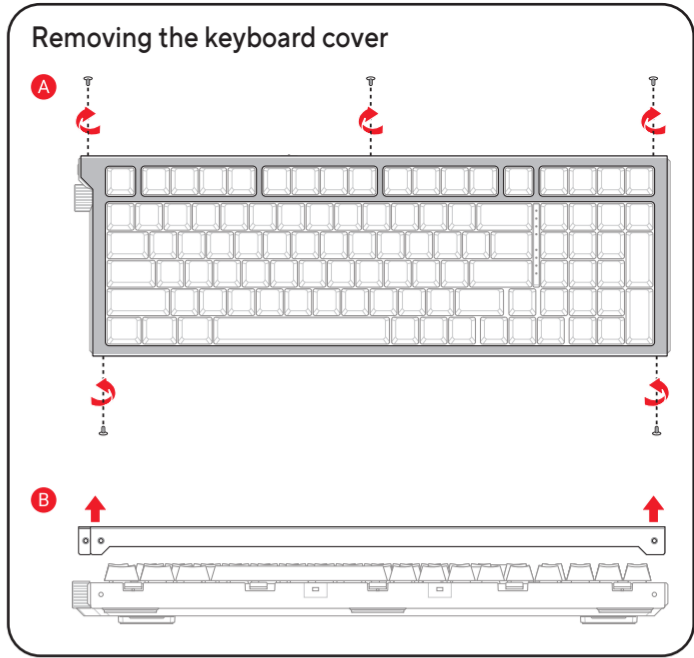

Gear Link

Utilize Gear Link <https://gearlink.asus.com> to update your keyboard's firmware and customize your keyboard.

Setting up as a wireless keyboard

- Remove the wireless dongle from the keyboard.
- Insert the wireless dongle to a USB port on the PC.
- Set the connection mode switch to **RF 2.4GHz**.



Setting up bluetooth

- Toggle the connection mode switch to Bluetooth mode.
- Press and hold the Fn key and the number 7 key for 3 seconds.



Gear Link

Utilisez Gear Link <https://gearlink.asus.com> pour mettre à jour le firmware et personnaliser votre clavier.

Configurer en tant que clavier sans fil

- Retirez le dongle sans fil du clavier.
- Insérez le dongle sans fil dans un port USB de votre ordinateur.
- Réglez l'interrupteur de mode de connexion sur **RF 2.4GHz**.



Configurer le Bluetooth

- Basculez l'interrupteur de mode de connexion en mode Bluetooth.
- Appuyez sur la touche Fn et la touche numérique 7 pendant 3 secondes.



Gear Link

Nutzen Sie Gear Link unter <https://gearlink.asus.com>, um die Firmware Ihrer Tastatur zu aktualisieren und Ihre Tastatur anzupassen.

Einrichten als kabellose Tastatur

- Entfernen Sie den Wireless-Dongle von der Tastatur.
- Stecken Sie den Wireless-Dongle in einen USB-Anschluss am PC.
- Setzen Sie den Schalter für den Verbindungsmodus auf **RF 2,4 GHz** Modus fest.



Einrichten über Bluetooth

- Legen Sie den Schalter für den Verbindungsmodus auf Bluetooth-Modus fest.
- Halten Sie die Fn-Taste + Zahl 7-Taste für 3 Sekunden gedrückt.



Gear Link

Utilizzare Gear Link <https://gearlink.asus.com> per aggiornare il firmware della tastiera e personalizzarla.

Configurazione come tastiera wireless

- Rimuovere il dongle wireless dalla tastiera.
- Inserire il dongle wireless in una porta USB del PC.
- Impostare l'interruttore della modalità di connessione su **RF 2.4GHz**.



Configurazione del Bluetooth

- Attivare l'interruttore di modalità di connessione in modalità Bluetooth.
- Tenere premuto il tasto Fn e il tasto numero 7 per 3 secondi.



Gear Link

Utilice Gear Link <https://gearlink.asus.com> para actualizar el firmware de su teclado y personalizarlo.

Configurar como un teclado inalámbrico

- Quite la llave inalámbrica del teclado.
- Inserte la llave inalámbrica a un puerto USB de su PC.
- Establezca el conmutador de modos de conexión del teclado en **RF 2.4GHz**.



Configurar la funcionalidad Bluetooth

- Cambie el conmutador de modos de conexión al modo Bluetooth.
- Mantenga pulsada la tecla Fn y la tecla número 7 durante 3 segundos.



Dişli Bağlantı

Gebruik Gear Link <https://gearlink.asus.com> adresini kullanarak klavyenizin aygıt yazılımını güncelleyin ve klavyenizi özelleştirin.

Kablosuz klavye olarak ayarlama

- Klavyeden kablosuz alıcısı çıkarın.
- Zasnuite beždrátový dongle do USB portu na PC.
- Bağlantı modu anahtarını **RF 2.4GHz** olarak ayarlayın.



Bluetooth ayarlarını yapmak

- Bağlantı modu düğmesini Bluetooth moduna getirin.
- Fn tuşunu ve 7 numaralı tuşu 3 saniye basılı tutun.



Gear Link

Použijte Gear Link <https://gearlink.asus.com> k aktualizaci firmwaru vaší klávesnice a jejímu přizpůsobení.

Nastavení jako bezdrátová klávesnice

- Odstraňte bezdrátový dongle z klávesnice.
- Zasuňte bezdrátový dongle do USB portu na PC.
- Nastavte přepínač režimu připojení na **RF 2,4 GHz**.



Nastavení Bluetooth

- Přepněte přepínač režimu připojení do režimu Bluetooth.
- Podržte klávesu Fn a číselnou klávesu 7 po dobu 3 sekund.



Gear Link

Gunakan Gear Link <https://gearlink.asus.com> untuk memperbarui firmware keyboard dan mengustomisasi keyboard Anda.

Pengaturan sebagai keyboard nirkabel

- Lepas dongle nirkabel dari keyboard.
- Masukkan dongle nirkabel ke port USB yang ada di PC.
- Atur sakelar mode koneksi ke **RF 2,4 GHz**.



Pengaturan Bluetooth

- Alihkan sakelar mode koneksi ke mode Bluetooth.
- Tekan dan tahan tombol Fn serta tombol angka 7 selama 3 detik.



Gear Link

Gebruik Gear Link <https://gearlink.asus.com> om de firmware van je toetsenbord bij te werken en je toetsenbord aan te passen.

Instellen als een draadloos toetsenbord

- Verwijder de draadloze dongle uit het toetsenbord.
- Sluit de draadloze dongle aan op een USB-poort op de pc.
- Zet de schakelaar van het verbindingsmodus op **RF 2.4GHz**.



Bluetooth instellen

- Zet de verbindingsmodus schakelaar op de Bluetooth-modus.
- Houd de Fn-toets en de nummer 7-toets 3 seconden ingedrukt.



Связь передач

Используйте Gear Link <https://gearlink.asus.com> для обновления прошивки вашей клавиатуры и ее настройки.

Настройка в качестве беспроводной клавиатуры

- Извлеките беспроводной приемник из клавиатуры.
- Вставьте беспроводной приемник в USB-разъем компьютера.
- Установите переключатель режима подключения на **RF 2.4GHz**.



Настройка Bluetooth

- Переключите режим подключения на режим Bluetooth.
- Нажмите и удерживайте клавишу Fn и клавишу с цифрой 7 в течение 3 секунд.



Link de Engrenagem

Utilize o Gear Link <https://gearlink.asus.com> para atualizar o firmware do seu teclado e personalizar seu teclado.

Configurando como um teclado sem fio

- Remova o dongle sem fio do teclado.
- Insira o dongle sem fio em uma porta USB do PC.
- Configure o interruptor de modo de conexão para **RF 2,4 GHz**.



Configurando o Bluetooth

- Altere o interruptor do modo de conexão para o modo Bluetooth.
- Pressione e segure a tecla Fn e a tecla número 7 por 3 segundos.



Gear Link

Használja a Gear Link <https://gearlink.asus.com> webhelyet a billentyűzet firmware-jének frissítéséhez és a billentyűzet testezéséhez.

Beállítás vezeték nélküli billentyűzetként

- Távolítsa el a vezeték nélküli kulcsot a PC egyik USB portjára.
- Helyezze be a vezeték nélküli kulcsot a PC egyik USB portjára.
- Állítsa a kapcsolódási mód kapcsolóját **RF 2,4 GHz**-re.



A Bluetooth beállítás

- Állítsa a kapcsolódási mód kapcsolót Bluetooth-módra.
- Nyomja meg és tartsa lenyomva az FN billentyűt és a 7-es billentyűt 3 másodpercig.



Gear Link

Bruk Gear Link <https://gearlink.asus.com> for å oppdatere fastvaren til tastaturet ditt og tilpasse tastaturet.

Sette opp som et trådløst tastatur.

- Ta ut trådløsdonglen fra tastaturet.
- Sett trådløsdonglen inn i en USB-port på PC-en.
- Sett tilkoblingsmodusrytteren til **RF 2,4 GHz**.



Sette opp Bluetooth

- Prepinač režimu pripojenja til Bluetooth-modus.
- Trykk inn og hold Fn-tasten og 7-tasten i 3 sekunder.



Gear Link

Využijte Gear Link <https://gearlink.asus.com> na aktualizáciu firmvéru vašej klávesnice a prispôsobenie klávesnice.

Zostavenie ako bezdrôtová klávesnica

- Z klávesnice vyberte bezdrôtový adaptér dongle.
- Bezdrôtový adaptér dongle zapojte do portu USB v počítači.
- Prepinač režimu pripojenia nastavte na **RF 2,4 GHz**.



Nastavenie Bluetooth

- Prepinač režimu pripojenia prepnite do režimu Bluetooth.
- Stlačením a podržaním klávesu FN a klávesu číslo 7 na 3 sekundy.



Gear Link

Skorzystaj z Gear Link <https://gearlink.asus.com>, aby zaktualizować firmware klawiatury i dostosować klawiaturę.

Konfiguracja klawiatury bezprzewodowej

- Wyjmij z klawiatury moduł połączenia bezprzewodowego.
- Włóż moduł połączenia bezprzewodowego do portu USB w komputerze.
- Ustaw przełącznik trybu połączenia w pozycji **RF 2,4GHz**.



Konfiguracja Bluetooth

- Ustaw przełącznik trybu połączenia w pozycji trybu Bluetooth.
- Naciśnij i przytrzymaj klawisz Fn oraz klawisz numer 7 przez 3 sekundy.



Gear Link

Använd Gear Link <https://gearlink.asus.com> för att uppdatera ditt tangentbords fasta programvara och anpassa ditt tangentbord.

Installera som ett trådlöst tangentbord

- Ta bort donglen för trådlös anslutning från tangentbordet.
- Sätt i donglen för trådlös anslutning i en USB-port på datorn.
- Ställ in anslutningslägesomkopplaren på **RF 2,4 GHz**.



Ställa in Bluetooth

- Ställ anslutningslägesomkopplaren på Bluetooth-läge.
- Tryck på och håll kvar FN-tangenten och nummer 7-tangenten i 3 sekunder.



Gear Link

Utilisez Gear Link <https://gearlink.asus.com> pour mettre à jour le firmware et personnaliser votre clavier.

Configurer en tant que clavier sans fil

- Retirez le dongle sans fil du clavier.
- Insérez le dongle sans fil dans un port USB de votre ordinateur.
- Réglez l'interrupteur de mode de connexion sur **RF 2.4GHz**.



Configurer le Bluetooth

- Basculez l'interrupteur de mode de connexion en mode Bluetooth.
- Appuyez sur la touche Fn et la touche numérique 7 pendant 3 secondes.



Gear Link

Використуйте Gear Link <https://gearlink.asus.com>, щоб оновити прошивку клавіатури та налаштувати її.

Налаштування бездротової клавіатури

- Вийміть з клавіатури бездротовий ключ.
- Вставте бездротовий ключ до порту USB на ПК.
- Перемикач режиму підключення встановіть на радіочастоту **2,4 ГГц**.



Налаштування Bluetooth

- Переведіть перемикач підключення в режим Bluetooth.
- Натисніть і утримуйте клавішу FN і цифру 7 протягом 3 секунд.



Gear Link

استخدم Gear Link <https://gearlink.asus.com> لتحديث البرنامج الثابت للوحة المفاتيح وتخصيصها.

إعداد لوحة مفاتيح لاسلكية

- قم بإزالة الدوئل اللاسلكي من لوحة المفاتيح.
- أدخل الدوئل اللاسلكي في منفذ USB على الكمبيوتر.
- اضبط مفاتيح التبديل بوضع الاتصال على **RF 2.4** جيجا هرتز.



إعداد Bluetooth

- قم بإزالة الدوئل اللاسلكي من لوحة المفاتيح.
- أدخل الدوئل اللاسلكي في منفذ USB على الكمبيوتر.
- اضبط مفاتيح التبديل بوضع الاتصال على **RF 2.4** جيجا هرتز.



Gear Link

Utilizează Gear Link <https://gearlink.asus.com> pentru a actualiza firmware-ul tastaturii și pentru a personaliza tastatura ta.

Configurarea ca tastatură wireless

- Scoateți adaptorul wireless de la tastatură.
- Conectați transmițătorul wireless la un port USB de pe computer.
- Setați comutatorul modului de conectare la **RF 2,4Hz**.



Configurarea Bluetooth

- Treceți comutatorul de modulul de conectare în modul Bluetooth.
- Țineți apăsată tasta FN și tasta cu numărul 7 timp de 3 secunde.



Gear Link

請透過 Gear Link 網站 <https://gearlink.asus.com/tw> 更新電競鍵盤的韌體，以及自訂您的電競鍵盤。

設定為無線鍵盤

- 取下鍵盤上的無線接收器。
- 將無線接收器插入電腦的 USB 連接埠。
- 將鍵盤的連線模式

Gear Link

Gear Link https://gearlink.asus.com을 사용하여 키보드의 펌웨어 업데이트하고 키보드를 사용자 지정하십시오.

무선 키보드로서 설정하기

- 키보드에서 무선 동글을 제거합니다.
- 무선 동글을 PC의 USB 포트에 끼웁니다.
- 연결 모드 스위치를 **RF 2.4GHz**로 설정합니다.

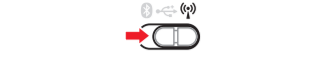

Gear Link

Gear Link https://gearlink.asus.com を使用して、デバイスのセットアップやカスタマイズ、ファームウェアを更新できます。

2.4GHz ワイヤレス接続で使用する

- キーボードからUSBレシーバーを取り外します。
- USBレシーバーをコンピューターのUSBポートに接続します。
- 接続モードスイッチ(Connection mode switch)を**2.4GHz ワイヤレスモード**に設定します。



הגדרת מקלדת אלחוטית	גמר את המותאם האלחוטי מהמקלדת.
הגדרת המקלדת אלחוטית	1. הסר את המותאם האלחוטי מהמקלדת.
	2. חבר את המותאם האלחוטי ליציאת USB בגב המחשב.
	3. הגדר את מנת מצב הריכוז ל- RF 2.4GHz .



Key combinations

On-the-fly Macro Recording
Step 1: Fn + Left-ALT to start recording
Step 2: Enter the keys to be recorded as a macro
Step 3: Fn + Left-ALT to end recording
Step 4: Assign Macro Key

Profile Switch	
Fn + 1 / 2 / 3 / 4 / 5 / 6* <p>* 6 is default</p>	
Light Effect Switch	
Fn + Right or Fn + Left	
Brightness Level	
Fn + Up: Brightness up <p>Fn + Down: Brightness down</p>	
Factory Default	
Fn + Esc: Hold these two keys until the LEDs blink green, then release the two keys.	
BLE host switch	
Host 1 (default): Fn + 8 <p>Host 2: Fn + 9 <p>Host 3: Fn + 0</p></p>	
Function Keys	
Fn + Ins: Scroll Lock <p>Fn + Home: End</p>	Fn + Del: Pause <p>Fn + PgUp: (Win+G) Open the Game Bar</p>
Fn + P: Print screen	Fn + PgDn: (Stealth key)
Fn + Caps: Hold these two keys for 1 second, Speed Tap on/off	Fn + Copilot: Menu <p>Fn + Tab: Mac/PC mode</p>
F - Switch	
Fn + ⇄: Toggle between function keys or F1-F12 (default)	
Function keys:	
F1: Screen brightness down <p>F2: Screen brightness up <p>F3: (Win + Tab) Task View <p>F4: (Win + E) File Explorer <p>F5: Brightness down <p>F6: Brightness up</p></p></p></p></p>	F7: Previous track <p>F8: Play/Pause <p>F9: Next track <p>F10: Mute <p>F11: Volume down <p>F12: Volume up</p></p></p></p></p>

Multiwheel and Function switch button

Press the function switch button **(A)** to rotate between modes. You can then use the Multiwheel to adjust the settings for each function **(B C D)**.



Modes		
Media Control	A : Volume up <p>C : Volume down <p>D : Mute/Unmute</p></p>	Brightness adjustment
Media Content	B : Previous track <p>C : Next track <p>D : Play/Pause</p></p>	Customization (Reassignment in Gear Link)
	A : Brightness up <p>C : Brightness down <p>D : Brightness 100% / brightness 0%</p></p>	
	B : Scroll up (default, can be reassigned) <p>C : Scroll down (default, can be reassigned) <p>D : Scroll click (default, can be reassigned)</p></p>	

Safety Guidelines

Keep the device away from liquid, humidity, or moisture. Operate the device only within the specified temperature range of 0°C(32°F) to 45°C(113°F). When the device exceeds the maximum temperature, unplug or switch off the device to let it cool down.

The power delivered by the charger must be between min. 3.5 Watts required by the radio equipment, and max. 4.5 Watts in order to achieve the maximum charging speed.

付属品は当該専用品です。他の機器には使用しないでください。機器の破損もしくは、火災や感電の原因となることがあります。

安全說明

- 此產品只應在溫度不高於 45°C（113°F）的環境下使用。
- 安裝錯誤型號的電池可能會導致爆炸。

本产品为微功率设备，消费者使用时应遵守以下规范，以免造成危害或损伤。

- (一) 本产品 2.4G微功率模式使用频率为:2400-2483.5MHz,发射功率限值：10mW(e.i.r.p) ，频率容限：75kHz 搭载 2.4Gz无线技术，透过 USB Dongle配对连接PC，提供低延迟音讯传输，符合“微功率短距离无线电发射设备目录和技术要求”；
- (二) 不得擅自改变使用场景或使用条件、扩大发射频率范围、加大发射率（包括额外加装射频功率放大器），不得擅自更改发射天线；
- (三) 不得对其他合法的无线电台（站）产生有害干扰，也不得提出免受有害干扰保护；
- (四) 应当承受辐射射频能量的工业、科学及医疗（ISM）应用设备的干扰或其他合法的无线电台（站）干扰；
- (五) 如对其他合法的无线电台（站）产生有害干扰时，应立即停止使用，并采取措施消除干扰后方可继续使用；
- (六) 在航空器内和依法法律法规、国家有关规定、标准划设的射电天文台、气象雷达站、卫星地球站（含测、测距、接收、导航站）等军民用无线电台（站）、机场等的电磁环境保护区域内使用微功率设备，应当遵守电磁环境保护及相关行业主管部门的规定；
- (七) 禁止在以机场跑道中心点为圆心、半径5000米的区域内使用各类模型遥控器；
- (八) 本产品使用时工作温度为0～45度，工作电压3.4-4.2V。

Notices

Limitation of Liability

Circumstances may arise where because of a default on ASUS' part or other liability, you are entitled to recover damages from ASUS. In each such instance, regardless of the basis on which you are entitled to claim damages from ASUS, ASUS is liable for no more than damages for bodily injury (including death) and damage to real property and tangible personal property, or any other actual and direct damages resulted from omission or failure of performing legal duties under this Warranty Statement, up to the listed contract price of each product.

ASUS will only be responsible for or indemnify you for loss, damages or claims based in contract, tort or infringement under this Warranty Statement.

This limit also applies to ASUS' suppliers and its reseller. It is the maximum for which ASUS, its suppliers, and your reseller are collectively responsible.

UNDER NO CIRCUMSTANCES IS ASUS LIABLE FOR ANY OF THE FOLLOWING: (1) THIRD-PARTY CLAIMS AGAINST YOU FOR DAMAGES; (2) LOSS OF, OR DAMAGE TO, YOUR RECORDS OR DATA; OR (3) SPECIAL, INCIDENTAL, OR INDIRECT DAMAGES OR FOR ANY ECONOMIC CONSEQUENTIAL DAMAGES (INCLUDING LOST PROFITS OR SAVINGS), EVEN IF ASUS, ITS SUPPLIERS OR YOUR RESELLER IS INFORMED OF THEIR POSSIBILITY.

Federal Communications Commission Statement

This device complies with Part 15 of the FCC Rules. Operation is subject to the following two conditions:

- This device may not cause harmful interference.
 - This device must accept any interference received including interference that may cause undesired operation.
- This equipment has been tested and found to comply with the limits for a Class B digital device, pursuant to Part 15 of the FCC Rules. These limits are designed to provide reasonable protection against harmful interference in a residential installation. This equipment generates, uses and can radiate radio frequency energy and, if not installed and used in accordance with manufacturer's instructions, may cause harmful interference to radio communications. However, there is no guarantee that interference will not occur in a particular installation. If this equipment does cause harmful interference to radio or television reception, which can be determined by turning the equipment off and on, the user is encouraged to try to correct the interference by one or more of the following measures:
- Reorient or relocate the receiving antenna.
 - Increase the separation between the equipment and receiver.
 - Connect the equipment to an outlet on a circuit different from that to which the receiver is connected.
 - Consult the dealer or an experienced radio/TV technician for help.

CAUTION! The use of shielded cables for connection of the monitor to the graphics card is required to assure compliance with FCC regulations. Changes or modifications to this unit not expressly approved by the party responsible for compliance could void the user’s authority to operate this equipment.

Compliance Statement of Innovation, Science and Economic Development Canada (ISED)

This device complies with Innovation, Science and Economic Development Canada licence exempt RSS standard(s). Operation is subject to the following two conditions: (1) this device may not cause interference, and (2) this device must accept any interference, including interference that may cause undesired operation of the device.

CAN ICES(B)/NMB(B)

Déclaration de conformité de Innovation, Sciences et Développement économique Canada (ISED)

Le présent appareil est conforme aux CNR d’Innovation, Sciences et Développement économique Canada applicables aux appareils radio exempts de licence. L’exploitation est autorisée aux deux conditions suivantes : (1) l’appareil ne doit pas produire de brouillage, et (2) l’utilisateur de l’appareil doit accepter tout brouillage radioélectrique subi, même si le brouillage est susceptible d’en compromettre le fonctionnement.

CAN ICES(B)/NMB(B)

Radio Frequency (RF) Exposure Information

The radiated output power of the Wireless Device is below the Innovation, Science and Economic Development Canada (ISED) radio frequency exposure limits. The Wireless Device should be used in such a manner such that the potential for human contact during normal operation is minimized.

This device has also been evaluated and shown compliant with the ISED RF Exposure limits under portable exposure conditions. (Antennas are less than 20 cm of a person’s body).

Informations concernant l’exposition aux fréquences radio (RF)

La puissance de sortie rayonnée du dispositif sans fil est inférieure aux limites d’exposition aux radiofréquences d’Innovation, Sciences et Développement économique Canada (ISED). Le dispositif sans fil doit être utilisé de manière à minimiser le potentiel de contact humain pendant le fonctionnement normal.

Cet appareil a également été évalué et montré conforme aux limites d’exposition RF ISED dans des conditions d’exposition portable. (les antennes mesurent moins de 20 cm du corps d’une personne).

Précautions d’emploi de l’appareil :

- Soyez particulièrement vigilant quant à votre sécurité lors de l’utilisation de cet appareil dans certains lieux (les aéroports, les hôpitaux, les stations-service et les garages professionnels).
- Évitez d’utiliser cet appareil à proximité de dispositifs médicaux implantés lors d’un appel téléphonique. Si vous portez un implant électronique (stimulateurs cardiaques, pompes à insuline, neurostimulateurs...), veuillez impérativement respecter une distance minimale de 15 centimètres entre cet appareil et l’implant pour réduire les risques d’interférence.
- Utilisez cet appareil dans de bonnes conditions de réception pour minimiser le niveau de rayonnement. Ce n’est pas toujours le cas dans certaines zones ou situations, notamment les parkings souterrains, les ascenseurs, en train ou en voiture ou tout simplement dans un secteur mal couvert par le réseau.
- Tenez cet appareil à distance du ventre des femmes enceintes et du bas-ventre des adolescents.

ASUS Recycling/Takeback Services

ASUS recycling and takeback programs come from our commitment to the highest standards for protecting our environment. We believe in providing solutions for you to be able to responsibly recycle our products, batteries, other components as well as the packaging materials. Please go to https://esg.asus.com/em/[Takeback.htm](https://esg.asus.com/em/Takeback.htm) for detailed recycling information in different regions.

REACH

Complying with the REACH (Registration, Evaluation, Authorisation, and Restriction of Chemicals) regulatory framework, we published the chemical substances in our products at ASUS REACH website at https://esg.asus.com/[Compliance.htm](https://esg.asus.com/Compliance.htm).

RF exposure warning

The equipment complies with FCC RF exposure limits set forth for an uncontrolled environment. The equipment must not be co-located or operating in conjunction with any other antenna or transmitter.

Lithium-Ion Battery Warning
CAUTION: Danger of explosion if battery is incorrectly replaced. Replace only with the same or equivalent type recommended by the manufacturer. Dispose of used batteries according to the manufacturer’s instructions.

鎳金屬電池安全警告
電池如果更換不正確，會有爆炸的危險。請依照製造商說明書使用相同或同款式電池，並請依照製造商指示處理用過的電池。

Proper disposal

The Waste Electrical and Electronic Equipment (WEEE) Directive (Directive 2012/19/EU) is a European Union law that aims to reduce the environmental impact of electrical and electronic equipment. It mandates producers to take responsibility for the end-of-life management of their products, promoting collection, treatment, and recycling to minimize waste and encourage resource recovery.

Do not throw your electrical and electronic equipment in municipal waste.

The symbol of the crossed-out wheeled bin on the product or packaging indicates that this product (including any batteries it contains) must not be disposed of with your household waste.

To prevent potential harm to the environment and human health, a collection framework should be used to return, recycle, and recover waste electrical and electronic equipment (WEEE), and this product has been designed to enable the reuse of parts and facilitate the recycling of certain materials.

Improper disposal may involve risks due to the presence of hazardous substances within electrical and electronic equipment, such as lead and BFR and other harmful components.

Check your local recycling services for electronic products.
(https://esg.asus.com/em/[circular-economy/resource-regeneration/global-take-back-service](https://esg.asus.com/em/circular-economy/resource-regeneration/global-take-back-service))

For more information on the multi-language version please scan below:

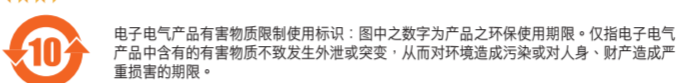
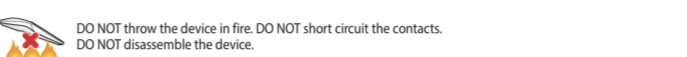

部件名称	有害物质									
	铅 (Pb)	汞 (Hg)	镉 (Cd)	六价铬 (Cr (VI))	多溴联苯 (PBB)	多溴二苯醚 (PBDE)	邻苯二甲酸二丁酯 (DBP)	邻苯二甲酸 (2-乙基己酯) (DEHP)	邻苯二甲酸二丁酯 (DBP)	邻苯二甲酸二丁酯 (BBP)
印刷电路板及其电子组件	x	o	o	o	o	o	o	o	o	o
外壳	o	o	o	o	o	o	o	o	o	o
外部信号连接头及线材	o	o	o	o	o	o	o	o	o	o
其它	x	o	o	o	o	o	o	o	o	o
<p>本表格依据 SJ/T 11364 的规定编制。</p> <p>o：表示该有害物质在该部件所有均质材料中的含量均在 GB/T 26572 规定的限量要求以下。</p> <p>x：表示该有害物质至少在该部件的某一均质材料中的含量超出 GB/T 26572 规定的限量要求，然该部件仍符合欧盟指令 2011/65/EU 的规范。</p> <p>备注：此产品所标示之环保使用期限，系指在一般正常使用状况下。</p>										

單元	限用物質及其化學符號	鉛 (Pb)	汞 (Hg)	鎘 (Cd)	六價鉻 (Cr ^{VI})	多溴聯苯 (PBB)	多溴二苯醚 (PBDE)
印刷電路板及電子組件	–	o	o	o	o	o	o
塑膠外殼	o	o	o	o	o	o	o
按鍵	o	o	o	o	o	o	o
外部信號連接頭及線材等	o	o	o	o	o	o	o
<p>備考 1.“O”係指該項限用物質之百分比含量未超出百分比含量基準值。</p> <p>備考 2.“-”係指該項限用物質為排除項目。</p>							

NCC: Wireless Statement

取得實驗證明之低功率射頻器材，非經核准，公司、商號或使用者均不得擅自變更頻率、加大功率或變更原設計之特性及功能。低功率射頻器材之使用不得影響飛航安全及干擾合法通信；經發現有干擾現象時，應立即停止，並改善至無干擾時方得繼續使用。前述合法通信，指依電信管理法規作業之無線電通信。低功率射頻器材須符合合法通信或工業、科學及醫療用電波輻射性電機設備之干擾。

KC: Korea Warning Statement

	<p>본급 기기 (가정용 방송통신기자재) 이 기기는 가정용(본급) 전자파적합기기로서 주로 가정에서 사용하는 것을 목적으로 하며, 모든 지역에서 사용할 수 있습니다.</p>
---	---

Regional notice for Singapore

Complies with IMDA Standards DB103778	This ASUS product complies with IMDA Standards.
---------------------------------------	---

France sorting and recycling information



Ukraine Certification Logo



USB Charging

The power delivery by the charger must be between min 3.5 Watts required by the radio equipment, and max 10.0 Watts in order to achieve maximum charging speed.

Function	Frequency	Maximum Output Power (EIRP)
2.4GHz wireless	(2402 - 2480MHz) - Keyboard	10mW
	(2402 - 2480MHz) - Dongle	10mW
BLE	(2402 - 2480MHz) - Keyboard	10mW
	(2402 - 2480MHz) - Keyboard	10mW

UKCA RF Output table (The Radio Equipment Regulations 2017)

Function	Frequency	Maximum Output Power (mW)
2.4GHz wireless	(2402 - 2480MHz) - Keyboard	< 100
	(2402 - 2480MHz) - Dongle	< 100
BLE	(2402 - 2480MHz) - Keyboard	< 100

CE RED RF Output table (Directive 2014/53/EU)

Function	Frequency	Maximum Output Power (mW)
2.4GHz wireless	(2402 - 2480MHz) - Keyboard	< 100
	(2402 - 2480MHz) - Dongle	< 100
BLE	(2402 - 2480MHz) - Keyboard	< 100

Simplified UKCA Declaration of Conformity

ASUSTek Computer Inc. hereby declares that this device is in compliance with the essential requirements and other relevant provisions of The Radio Equipment Regulations 2017 (S.I. 2017/1206). Full text of UKCA declaration of conformity is available at https://www.asus.com/support/.

CE Mark Warning



English ASUSTek Computer Inc. hereby declares that this device is in compliance with the essential requirements and other relevant provisions of related Directives. Full text of EU declaration of conformity is available at: www.asus.com/support

Français ASUSTek Computer Inc. déclare par la présente que cet appareil est conforme aux critères essentiels et aux autres dispositions pertinentes des directives concernées. La déclaration de conformité de l'UE peut être téléchargée à partir du site Internet suivant : https://www.asus.com/fr/support/download-center. Veuillez saisir le nom du modèle pour accéder à la déclaration de conformité complète du produit.

Deutsch ASUSTek Computer Inc. erklärt hiermit, dass dieses Gerät mit den wesentlichen Anforderungen und anderen relevanten Bestimmungen der zugehörigen Richtlinien übereinstimmt. Der gesamte Text der EU-Konformitätserklärung ist verfügbar unter: www.asus.com/support

Italiano ASUSTek Computer Inc. con la presente dichiara che questo dispositivo è conforme ai requisiti essenziali e alle altre disposizioni pertinenti con le direttive correlate. Il testo completo della dichiarazione di conformità UE è disponibile all'indirizzo: www.asus.com/support

Русский Компания ASUS заявляет, что это устройство соответствует основным требованиям и другим соответствующим условиям соответствующих директив. Подробную информацию, пожалуйста, смотрите на www.asus.com/support

Български С настоящото ASUSTek Computer Inc. декларира, че това устройство е в съответствие със съществените изисквания и другите приложими постановления на съхраните директиви. Пълният текст на декларацията за съответствие на ЕС е достъпен на адрес: www.asus.com/support

Hrvatski ASUSTek Computer Inc. ovim izjavijuje da je ovaj uređaj skladan s bitnim zahtjevima i ostalim odgovarajućim odredbama vezanih direktiva. Cijeli tekst EU izjave o skladnosti dostupan je na: www.asus.com/support

Čeština Společnost ASUSTek Computer Inc. tímto prohlašuje, že toto zařízení splňuje základní požadavky a další příslušná ustanovení souvisejících směrnic. Plné znění prohlášení o shodě EU je k dispozici na adrese: www.asus.com/support

Dansk ASUSTek Computer Inc. erklærer hermed, at denne enhed er i overensstemmelse med hovedkravene og andre relevante bestemmelser i de relaterede direktiver. Hele EU-overensstemmelseserklæringen kan findes på: www.asus.com/support

Nederlands ASUSTek Computer Inc. verklaart hierbij dat dit apparaat voldoet aan de essentiële vereisten en andere relevante bepalingen van de verwante richtlijnen. De volledige tekst van de EU-verklaring van conformiteit is beschikbaar op: www.asus.com/support

Eesti Käesolevaga kinnitab ASUSTEK Computer Inc. et see seade vastab asjakohaste direktiivide olulistele nõuetele ja teistele asjassepuutuvatele sätetele. EL vastavusdeklaratsiooni täielik tekst on saadaval järgmisel aadressil: www.asus.com/support

Suomi ASUSTek Computer Inc. ilmoittaa täten, että tämä laite on asiaankuuluvien direktiivien olennaisten vaatimusten ja muiden tätä koskevien säädösten mukainen. EU-yhdenmukaisuusilmoituksen koko teksti on luettavissa osoitteessa: www.asus.com/support

Ελληνικά Με το παρόν, η ASUSTek Computer Inc. δηλώνει ότι αυτή η συσκευή συμμορφώνεται με τις θεμελιώδεις απαιτήσεις και άλλες σχετικές διατάξεις των οδηγιών της ΕΕ. Το πλήρες κείμενο της δήλωσης συμμόρφωσης είναι διαθέσιμο στη διεύθυνση: www.asus.com/support

Magyar Az ASUSTek Computer Inc. ezennel kijelenti, hogy ez az eszköz megfelel a kapcsolódó irányelvek lényeges követelményeinek és egyéb vonatkozó rendelkezéseinek. Az EU megfelelésegi nyilatkozat teljes szövege innen tekinthető: www.asus.com/support

Latviski ASUSTek Computer Inc. ar šo paziņo, ka šī ierīce atbilst saistošo Direktīvu būtiskajām prasībām un citiem citiem saistošajiem nosacījumiem. Pilns ES atbilstības paziņojuma teksts pieejams šeit: www.asus.com/support

Lietuvių ASUSTek Computer Inc. šiuo tvirtina, kad šis įrenginys atitinka pagrindinius reikalavimus ir kitas svarbias susijusių direktyvų nuostatas. Visą ES atitikties deklaracijos tekstą galima rasti: www.asus.com/support

Norsk ASUSTek Computer Inc. erklærer herved at denne enheten er i samsvar med hovedsaklige krav og andre relevante forskrifter i relaterte direktiver. Fullstendig tekst for EU-samsvarserklæringen finnes på: www.asus.com/support

Polski Firma ASUSTEK Computer Inc. niniejszym oświadcza, że urządzenie to jest zgodne z zasadniczymi wymogami i innymi właściwymi postanowieniami powiązanych dyrektyw. Pełny tekst deklaracji zgodności UE jest dostępny pod adresem: www.asus.com/support

Português A ASUSTek Computer Inc. declara que este dispositivo está em conformidade com os requisitos essenciais e outras disposições relevantes das Diretivas relacionadas. Texto integral da declaração da UE disponível em: www.asus.com/support

Română ASUSTek Computer Inc. declară că acest dispozitiv se conformează cerințelor esențiale și altor prevederi relevante ale directivelor conexe. Textul complet al declarației de conformitate a Uniunii Europene se găsește la: www.asus.com/support

Srpski ASUSTek Computer Inc. ovim izjavljuje da je ovaj uređaj u saglasnosti sa osnovnim zahtjevima i drugim relevantnim odredbama povezanih Direktiva. Pun tekst EU deklaracije o usaglašenosti je dostupan na adresi: www.asus.com/support

Slovensky Spoločnosť ASUSTEK Computer Inc. týmto vyhlasuje, že toto zariadenie vyhovuje základným požiadavkám a ostatným príslušným ustanoveniam príslušných smerníc. Celý text vyhlásenia o zhode pre štáty EU je dostupný na adrese: www.asus.com/support

Slovenčina ASUSTek Computer Inc. izjavlja, da je ta naprava skladna s bistvenimi zahtevami in drugimi ustreznimi določbami povezanih direktiv. Celotno besedilo EU-izjave o skladnosti je na voljo na spletnem mestu: www.asus.com/support

Español Por la presente, ASUSTek Computar Inc. declara que este dispositivo cumple los requisitos básicos y otras disposiciones pertinentes de las directivas relacionadas. El texto completo de la declaración de la UE de conformidad está disponible en: www.asus.com/support

Svenska ASUSTek Computer Inc. förklarar härmed att denna enhet överensstämmer med de grundläggande kraven och andra relevanta föreskrifter i relaterade direktiv. Fulltext av EU-försäkran om överensstämmelse finns på: www.asus.com/support

Українська ASUSTek Computer Inc. заявляє, що цей пристрій відповідає основним вимогам та іншим відповідним положенням відповідних Директив. Повний текст декларації відповідності стандартам ЄС доступний на: www.asus.com/support