

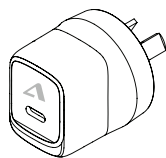

1

**Package Contents**

1

30W Rapid Power  
USB-C Mini GaN  
Charger



1

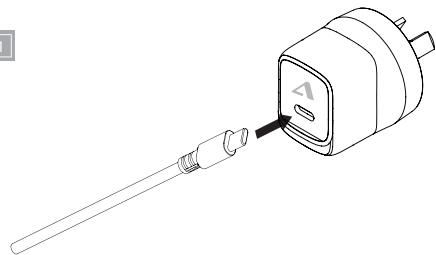

2

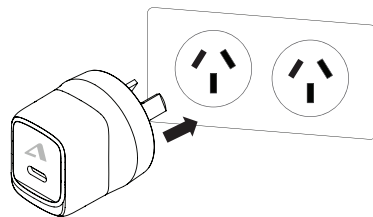

3

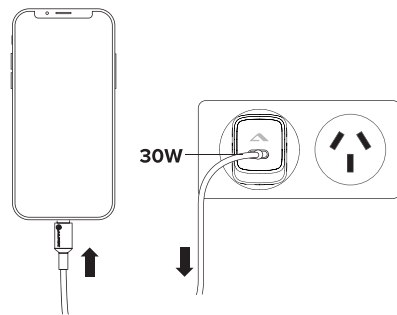

EN

**Instructions**

This tiny charger uses GaN technology to provide a powerful output of up to 30W in a miniaturised design. This is sufficient to power and charge small to medium sized devices including\*:

- Apple iPhone
- Apple iPad and iPad Pro
- Most other mobile phones and tablets
- Ultraportable notebooks and Chromebooks that can operate from 30W power supplies

\* Requires suitable charging cable to connect the charger to the device – available separately

To use the device, please follow the instructions below while following the important information in the Safety Notices section of this manual.

**Using the Charger**

(Refer to the images on the previous pages)

1. Plug a charging cable into the wall charger that is suitable for the device being charged. The charger can be used with USB-C to USB-C charging cables as well as other cable types such as USB-C to Lightning depending on the charging port on the device to be charged.

ALOGIC makes a comprehensive range of charging cables to suit any device, available for purchase separately.

2. Plug the power adapter into a power outlet.
3. Plug the charging cable into the device being charged and turn the power adapter on at the power outlet. The device connected to the power adapter should begin charging within a few seconds.

**Specifications**

Model	WCG1C30WH-ANZ, WCG1C30BK-ANZ		
Dimensions	40 x 40 x 37mm Excluding Pins		
Weight	50g		
Output	1x USB-C (female) charging port 5-20V DC charging output up to 30W USB PD: 5V=3A, 9V=3A, 15V=2A, 20V=1.5A (30W Max) PPS: 5.0-11V=2.7A (30W Max) PPS: 5.0-16V=2A (30W Max)		
Input	Supply Voltage Range	AC 100-240V ~50/60Hz, 1.0A	
	Standby Input Power	0.1W	
Device Compatibility	<p>Suitable for use with devices that support USB charging requiring up to 30W of power, including*:</p> <ul style="list-style-type: none"> <li>• Apple iPhone</li> <li>• Apple iPad and iPad Pro</li> <li>• Apple MacBook Air</li> <li>• Most mobile phones and tablets</li> <li>• Ultraportable notebooks and Chromebooks that can operate from 30W power supplies</li> </ul> <p>* Requires suitable charging cable to connect the charger to the device – available separately</p>		
Environmental	Temperature	Operating 0-25 Celsius	Storage -10-55 Celsius
	Humidity	20-90% RH	5-95% RH
Compliance	RCM, RoHS		
Warranty	2 Years		

## 30W Rapid Power USB-C Mini GaN Charger

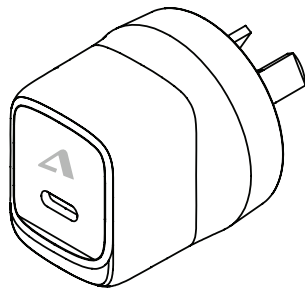

### Safety notices

#### General safety

- This device is designed for indoors use only.
- This device including its packaging and accessories are not a toy and may pose choking and other safety hazards to children. Do not allow children to play with the product to avoid potential harm and risk of damage to the device and other equipment.
- Do not deliberately damage the device or expose it to damp, direct sunlight, or high temperature conditions.
- Disassembling or failing to properly use and care for your device will void the warranty on the product and may create a risk of electric shock, fire, and/or damage to other equipment.
- If the device becomes damaged, immediately cease use and dispose of the device responsibly.
- Arrange all cables and cords so that people, pets and moving objects are unlikely to catch, pull or trip on them. Do not allow children to play with cables and cords.
- Position equipment in a manner that ensures it cannot be struck, pulled off a surface or stepped on to avoid damage to the device and other devices that are connected to it.
- ALOGIC bears no responsibility for damage to the device or other damages arising from improper use or lack of care and is not liable for repair or replacement of the device or other damages in these circumstances to the extent permissible by applicable law.

#### Power adapter safety

- WARNING!** Electrical equipment poses a risk of electric shock when used in unsafe situations.

To reduce the risk of electric shock:

- Plug power adapters into a mains outlet that is visible and easily accessible at all times.
- Power adapters and power cords should be positioned so that they will not be stepped on, crushed, pinched or sliced into by other items and will not be knocked or struck by moving objects.
- Damaged mains power cords and mains power adapters may expose users to a significant risk of electric shock. If a power adapter or power cord becomes damaged immediately turn off the power at the mains power outlet, cease using the power adapter or power cord and dispose of it responsibly.

- Only use power adapters in indoors areas where it is not possible for the power adapter or mains power cable to come into contact with moisture or liquids.

#### Heat caution

- WARNING!** Electronic devices can become very warm in normal use. ALOGIC products comply with the user accessible surface temperature limits defined in applicable safety standards, however care should be taken to ensure they are used in appropriate conditions.

- Ensure that electronic devices are used in well ventilated areas. Set up the device on a stable surface that allows for adequate air circulation under and around the device.
- Ensure electronic devices are not covered by anything that may block airflow while in operation, such as papers or blankets, which may cause the device to overheat.
- Do not allow electronic equipment to be used in contact with skin, soft surfaces such as pillows, rugs or blankets, or other surfaces which may accumulate or be affected by heat

### Environmental Notices



#### Disposal of waste electronic equipment

- The WEEE symbol denotes that this product must be disposed of separately to household waste according to local laws and regulations. To protect human health and the environment this product must be recycled through an appropriate service and should not be disposed of in general waste. Take this equipment to a designated collection point for the recycling of waste electrical and electronic equipment when disposing of the device.