



THUNDERBOLT 4™ KVM SWITCH WITH 8K DISPLAY AND 60W CHARGING



FEATURES

- KVM mode can connect and switch between 2x DisplayPort Alternate Mode (DP Alt Mode) compatible computers over 2x USB-C Thunderbolt™ ports
- 3x Thunderbolt 4™ ports transfer at up to 40Gbps with BC1.2 charging
- 4x Type-A USB 3.2 Gen 2x1 ports transfer at up to 10Gbps with BC1.2 (5V@2.4A) charging for iPad, cell phones, and more
- Supports DisplayPort 1.4 up to 8K@60Hz (DSC1.2 with enabled) and 5K@60Hz output (needs TB4 to DP dongle or USB-C to DP dongle) with systems that support DP Alt Mode over USB-C
- High-quality aluminum body for optimized heat dissipation with integrated cable and LED indicators for upstream source and power delivery
- Bus-powered, and also supports PD3.0 bypass charging for laptops at up to 60W via USB-C with the included power adapter

SYSTEM REQUIREMENTS

- Windows
- macOS

PACKAGE CONTENT

- Thunderbolt 4™ KVM Switch
- Thunderbolt 4™ cable (70cm)
- Power adapter (24V/5A)
- User manual

PRODUCT OVERVIEW

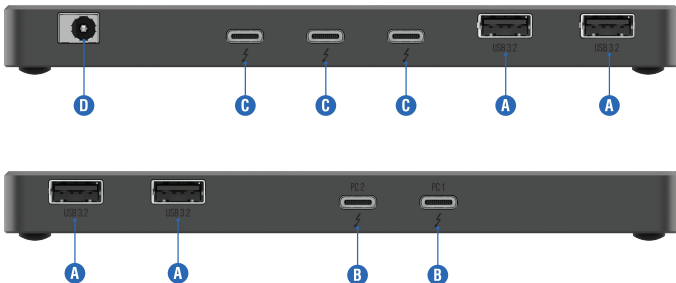

A. USB 3.2 Gen 2 Type-A Ports (x4)

Connect hard drives, mice, keyboards, and more
Transfer speed up to 10Gbps and BC1.2 support

B. Connect a Mac or PC with USB-C

Supports PD3.0 60W Charging
DisplayPort Alternate Mode (DP Alt Mode)

C. Thunderbolt 4™ Ports (x3)

Connect displays, adapters, storage, and more
Transfer speed up to 40Gbps and BC1.2 support

D. DC Jack

24V/5A DC power input

E. Switch Button

Switches between systems with a click



LED Indicators:

#	Color	Function	Description
1	Blue	PC 1 Power delivery indicator	Solid blue when PC connected
2	Blue	PC 2 Power delivery indicator	

CONNECTION AND OPERATION

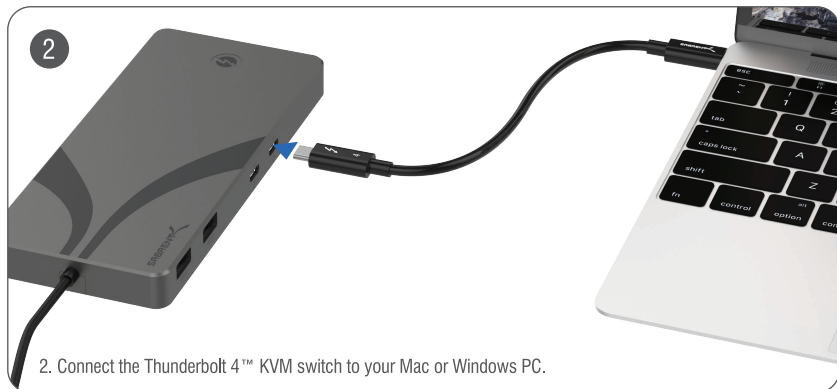
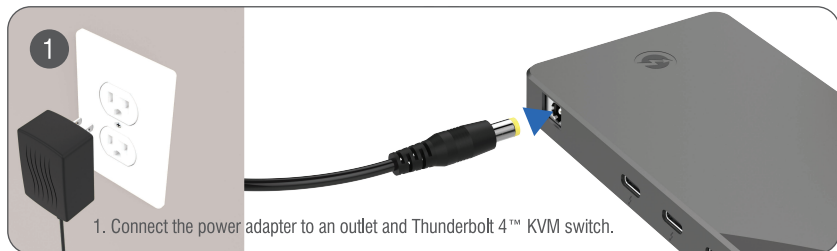

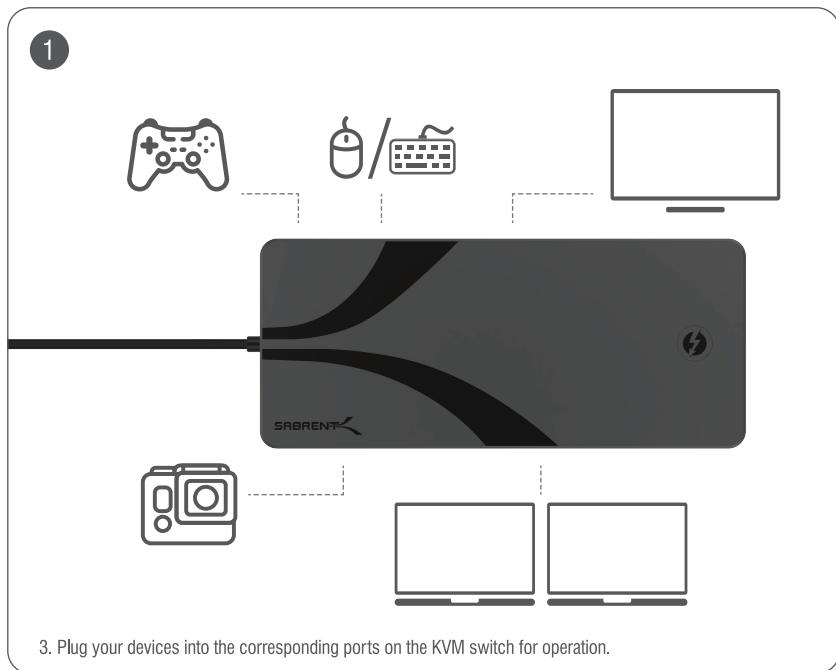



FOR HELP, COMMENTS, QUESTIONS OR CONCERNS
PLEASE CONTACT OUR TECH SUPPORT TEAM VIA OUR WEBSITE
WWW.SABRENT.COM