

E23315

First Edition / March 2024

IN SEARCH OF INCREDIBLE



Service Manual

ASUS

COPYRIGHT INFORMATION

No part of this manual, including the products and software described in it, may be reproduced, transmitted, transcribed, stored in a retrieval system, or translated into any language in any form or by any means, except documentation kept by the purchaser for backup purposes, without the express written permission of ASUSTeK COMPUTER INC. ("ASUS").

ASUS PROVIDES THIS MANUAL "AS IS" WITHOUT WARRANTY OF ANY KIND, EITHER EXPRESS OR IMPLIED, INCLUDING BUT NOT LIMITED TO THE IMPLIED WARRANTIES OR CONDITIONS OF MERCHANTABILITY OR FITNESS FOR A PARTICULAR PURPOSE. IN NO EVENT SHALL ASUS, ITS DIRECTORS, OFFICERS, EMPLOYEES OR AGENTS BE LIABLE FOR ANY INDIRECT, SPECIAL, INCIDENTAL, OR CONSEQUENTIAL DAMAGES (INCLUDING DAMAGES FOR LOSS OF PROFITS, LOSS OF BUSINESS, LOSS OF USE OR DATA, INTERRUPTION OF BUSINESS AND THE LIKE), EVEN IF ASUS HAS BEEN ADVISED OF THE POSSIBILITY OF SUCH DAMAGES ARISING FROM ANY DEFECT OR ERROR IN THIS MANUAL OR PRODUCT.

Products and corporate names appearing in this manual may or may not be registered trademarks or copyrights of their respective companies, and are used only for identification or explanation and to the owners' benefit, without intent to infringe.

SPECIFICATIONS AND INFORMATION CONTAINED IN THIS MANUAL ARE FURNISHED FOR INFORMATIONAL USE ONLY, AND ARE SUBJECT TO CHANGE AT ANY TIME WITHOUT NOTICE, AND SHOULD NOT BE CONSTRUED AS A COMMITMENT BY ASUS. ASUS ASSUMES NO RESPONSIBILITY OR LIABILITY FOR ANY ERRORS OR INACCURACIES THAT MAY APPEAR IN THIS MANUAL, INCLUDING THE PRODUCTS AND SOFTWARE DESCRIBED IN IT.

Copyright © 2024 ASUSTeK COMPUTER INC. All Rights Reserved.

LIMITATION OF LIABILITY

Circumstances may arise where because of a default on ASUS' part or other liability, you are entitled to recover damages from ASUS. In each such instance, regardless of the basis on which you are entitled to claim damages from ASUS, ASUS is liable for no more than damages for bodily injury (including death) and damage to real property and tangible personal property; or any other actual and direct damages resulted from omission or failure of performing legal duties under this Warranty Statement, up to the listed contract price of each product.

ASUS will only be responsible for or indemnify you for loss, damages or claims based in contract, tort or infringement under this Warranty Statement.

This limit also applies to ASUS' suppliers and its reseller. It is the maximum for which ASUS, its suppliers, and your reseller are collectively responsible.

UNDER NO CIRCUMSTANCES IS ASUS LIABLE FOR ANY OF THE FOLLOWING: (1) THIRD-PARTY CLAIMS AGAINST YOU FOR DAMAGES; (2) LOSS OF, OR DAMAGE TO, YOUR RECORDS OR DATA; OR (3) SPECIAL, INCIDENTAL, OR INDIRECT DAMAGES OR FOR ANY ECONOMIC CONSEQUENTIAL DAMAGES (INCLUDING LOST PROFITS OR SAVINGS), EVEN IF ASUS, ITS SUPPLIERS OR YOUR RESELLER IS INFORMED OF THEIR POSSIBILITY.

SERVICE AND SUPPORT

Visit our multi-language website at <https://www.asus.com/support/>.

Table of Contents

Chapter 1: Introduction

Disclaimer	6
Safety precautions.....	6
Pre-repair checklist	8
Diagnostics tool	9
Installation tools.....	9
Major components.....	10
Accessories.....	11

Chapter 2: Service Procedures

Bottom cover.....	14
Removal	14
Installation	15
Wireless card.....	16
Removal	17
Installation	18
CMOS battery.....	19
Removal	20
Installation	21
Heatsink	23
Removal	24
Installation	26
Motherboard	29
Removal	29
Installation	30
RF cable assembly	32
Removal	33
Installation	36

Chassis	39
Removal	40
Installation	42

Chapter 1: ***Introduction***

Disclaimer

ASUS is not responsible for direct, indirect, intentional or unintentional damages resulting from improper installation and operation.

Safety precautions

- Before handling components, use a grounded wrist strap or touch a safely grounded object to avoid damaging them due to static electricity.
- Keep liquids or moisture away from your Chromebox to avoid short circuits.
- Remove rings, watches, and any other metal objects from your hands.
- Hold components by the edges to avoid touching the ICs.
- Properly install all components before connecting the AC power.
- Do not use power adapters or batteries from other devices to reduce the risk of injury to persons due to fire or explosion. Use only certified power adapters or batteries supplied by the manufacturer or authorized retailers.
- Detach all clips or flaps before removing cables to prevent damage.

- Disconnect cables, connectors, and power plugs by pulling the plug evenly to avoid damage.
- Use screws with the correct specifications on your Chromebox to prevent damage.
- Confirm that the cable orientation is correct before connecting any cables.
- Photograph the appearance of cables, cable routing, connectors, and screws for later reference before proceeding with each step.

Pre-repair checklist

1. Read the entire manual before starting any service procedures and follow all instructions.
2. Back up your Chromebox.
3. Turn off your Chromebox.
4. Place your Chromebox on a stable surface.
5. Disconnect all connected peripherals and cables.

IMPORTANT!

- Purchase replacement components from an authorized retailer of this Chromebox to ensure maximum compatibility and reliability.
- Refer to <https://www.asus.com> for a list of compatible components.

NOTE:

- The illustrations are for reference only.
 - Product and component images are for illustrative purposes only. The actual appearance and specifications may vary depending on the model.
 - The procedures described in this manual may vary depending on the model configuration and may not reflect the entire servicing process. To service components that are not covered in this manual, please visit an authorized service center for assistance.
 - Keep all adhesive tape, insulating materials, screws, and other removable items in a safe place until the service procedure is completed, as they may be needed during installation.
-

Diagnostics tool

Diagnostics tools are available to help you identify components that need to be replaced and ensure the functionality of the newly installed component(s).

For more information, visit

<https://www.asus.com/support/FAQ/1051593>

Installation tools



Screwdriver



Plastic blade



Tweezers

Major components

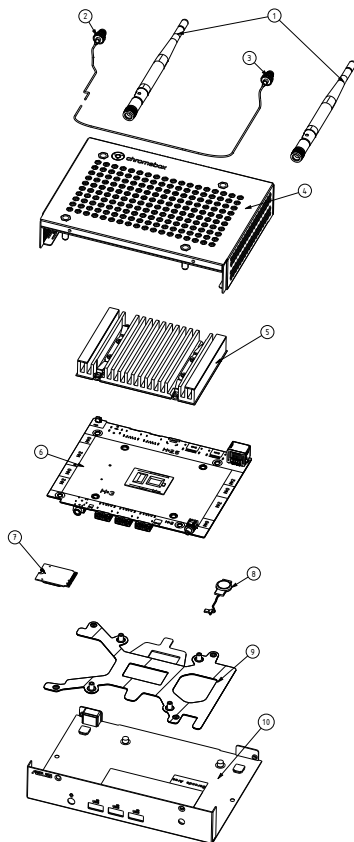

1. Wi-Fi antenna
2. RF cable assembly (short)
3. RF cable assembly (long)
4. Chassis (top)
5. Heatsink
6. Motherboard
7. Wireless card
8. CMOS battery
9. Bracket
10. Chassis (bottom cover)

Accessories

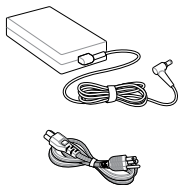

**Power adapter
and cord**

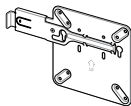

VESA mount



Wi-Fi antenna

Chapter 2: ***Service Procedures***

Bottom cover

Before you begin

Read the **Safety Precautions** and complete the **Pre-repair Checklist**.

Screw list

- ⊕ M3 X 3.1L (6 pcs)

Removal

1. Place the Chromebox on a flat stable surface with its top side facing down.
2. Loosen the screw(s) securing the Chromebox's bottom cover, and with extreme care, remove the bottom cover as shown.

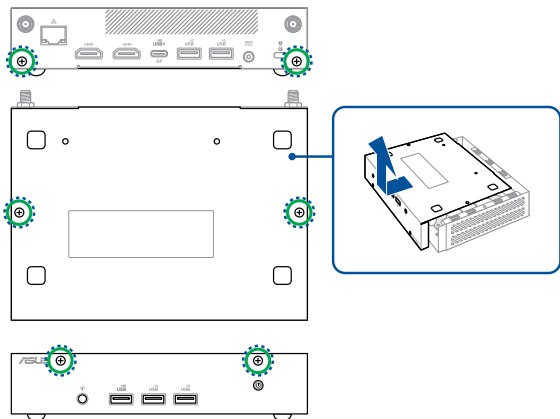

Installation

1. Place the bottom cover into position as shown.
2. Tighten the screw(s) on the bottom cover to secure it in place.

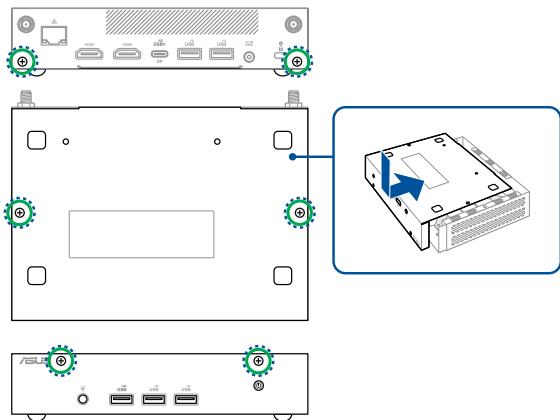

Wireless card

Before you begin

1. Read the **Safety Precautions** and complete the **Pre-repair Checklist**.
2. Remove the following component(s):
Bottom cover

Screw list

- ⊕ M2 X 2.5L (1 pc)

Removal

Remove the wireless card as shown.

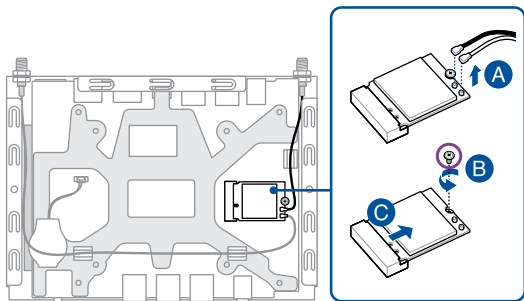

Installation

1. Install the wireless card as shown.

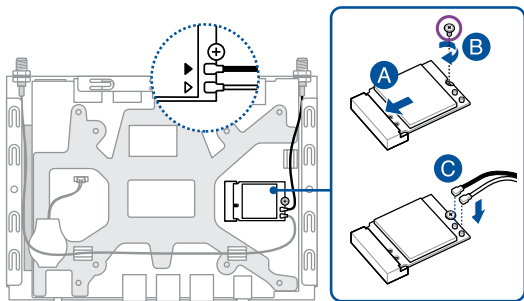

NOTE:

- Connect the black antenna cable to the wireless card connector marked with a black triangle ▲, and connect the white antenna cable to the one marked with a white triangle △.
 - Connecting antennas to your wireless card may strengthen the wireless signal.
 - A soft clicking sound indicates that the antenna has been securely attached to the wireless card.
-

2. Install the component(s) you removed in **Before you begin**.

CMOS battery

Before you begin

1. Read the **Safety Precautions** and complete the **Pre-repair Checklist**.
2. Remove the following component(s):
 - Bottom cover

Removal

1. Disconnect the battery cable from the connector.

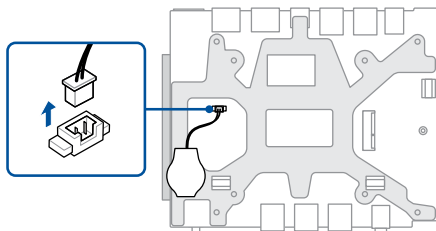

2. Carefully remove the CMOS battery.

IMPORTANT! When removing the battery, be careful not to damage the motherboard or the CMOS battery, which is taped to the motherboard.

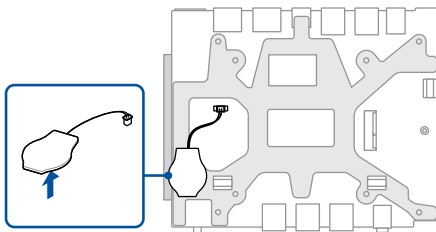

Installation

1. Remove the release liner on the battery, if one exists.
2. Align the battery as shown, and then affix it to the metal bracket on the motherboard.

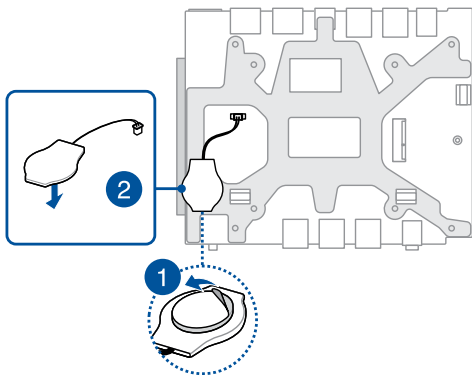

3. Connect the cable from the battery to the battery connector on the motherboard.

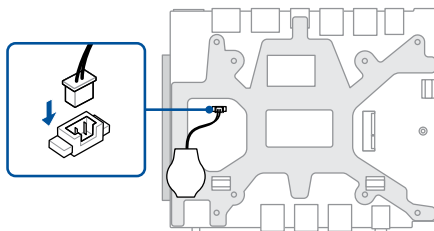

4. Install the component(s) you removed in **Before you begin**.

Heatsink

WARNING! To prevent potential damage to the CPU, you should have the heatsink replaced by a service center near you.

IMPORTANT! Thermal paste, thermal pads, liquid metal, or other thermal interface materials must be thoroughly removed and replaced if this component is removed. Ensure that replacement materials are available before proceeding, or contact an authorized service center for assistance.

Before you begin

1. Read the **Safety Precautions** and complete the **Pre-repair Checklist**.
2. Remove the following component(s):
Bottom cover

Screw list

- ⊕ M2 X 4.0L (4 pcs) for the motherboard
- ⊕ M2 X 4.0L (4 pcs) for the heatsink

Removal

1. Disconnect the RF cable assemblies from the wireless card (A), and then remove the RF cable assemblies from the cable guide(s) on the motherboard.

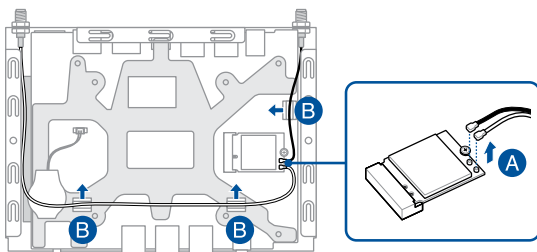

2. Remove the screw(s) securing the motherboard to the chassis one by one in the sequence shown.

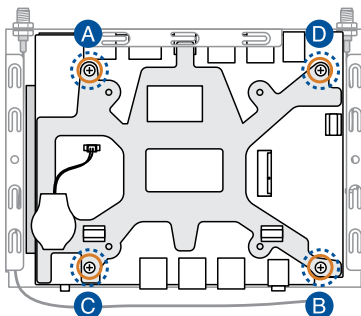

3. Remove the motherboard as shown.

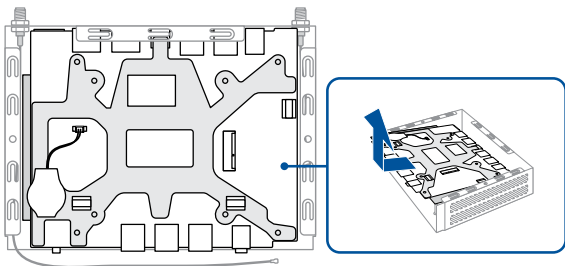

4. Place the motherboard face down, and remove the heatsink screw(s) one by one in the sequence shown.

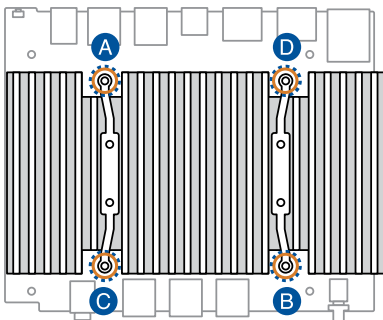

5. Remove the heatsink.

Installation

1. Wipe the CPU and chipset surfaces clean with a clean cloth. Apply several drops of Thermal Interface Material (TIM) to the exposed areas of the CPU and chipset that will come in contact with the heatsink. Ensure that the TIM is spread evenly in a thin layer over the surfaces.

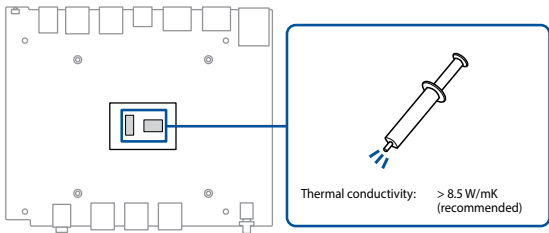

WARNING! The TIM is toxic and inedible. DO NOT eat it. If it gets into your eyes or touches your skin, wash it off immediately, and seek professional medical help.

IMPORTANT! To prevent contaminating the TIM, DO NOT spread it with your finger.

- Align and place the heatsink as shown, and secure it to the motherboard by tightening the screw(s) removed earlier one by one in the sequence shown.

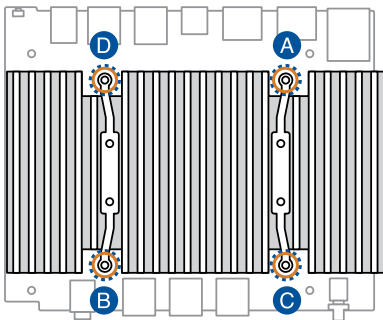

- Align and place the motherboard in the chassis as shown.

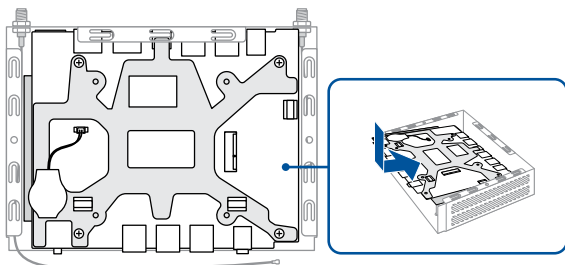

- Secure the motherboard by tightening the screw(s) removed earlier one by one in the sequence shown.

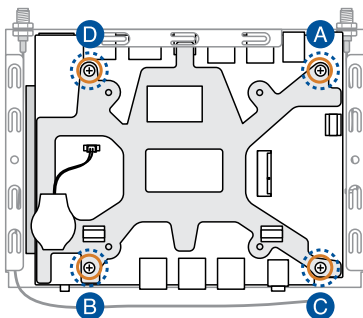

- Route the RF cable assemblies through the cable guide(s) (A), and then reconnect the RF cable assemblies to the wireless card.

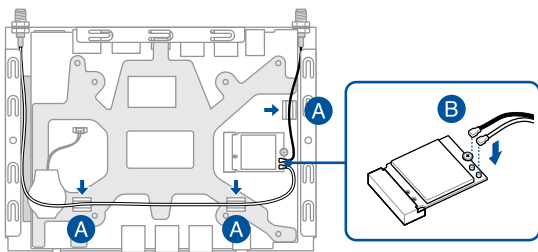

- Install the component(s) you removed in **Before you begin**.

Motherboard

Before you begin

Read the **Safety Precautions** and complete the **Pre-repair Checklist**.

NOTE: It is recommended that you replace the motherboard under professional supervision. You may also visit an authorized service center for further assistance.

Screw list

- ⊕ M2 X 4.0L (4 pcs)

Removal

Remove the following component(s):

- Bottom cover
- Wireless card (if installed)
- CMOS battery
- Heatsink

Installation

WARNING! To prevent potential damage to the CPU, you should have the heatsink replaced by a service center near you.

IMPORTANT! Thermal paste, thermal pads, liquid metal, or other thermal interface materials must be thoroughly removed and replaced if this component is removed. Ensure that replacement materials are available before proceeding, or contact an authorized service center for assistance.

1. Prepare the motherboard by wiping the CPU and chipset surfaces clean with a clean cloth. Apply several drops of Thermal Interface Material (TIM) to the exposed areas of the CPU and chipset that will come in contact with the heatsink. Ensure that the TIM is spread evenly in a thin layer over the surfaces.

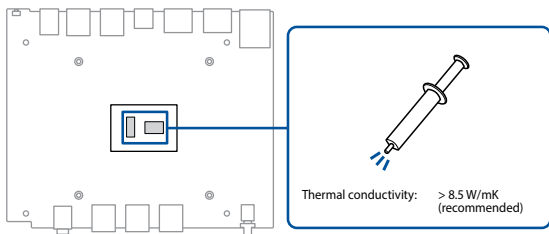

WARNING! The TIM is toxic and inedible. DO NOT eat it. If it gets into your eyes or touches your skin, wash it off immediately, and seek professional medical help.

IMPORTANT! To prevent contaminating the TIM, DO NOT spread it with your finger.

2. Install the component(s) you removed in **Before you begin**.

RF cable assembly

Before you begin

1. Read the **Safety Precautions** and complete the **Pre-repair Checklist**.
2. Remove the following component(s):
Bottom cover

Screw list

- ⊕ M2 X 4.0L (4 pcs)

Removal

1. Disconnect the RF cable assemblies from the wireless card (A), and then remove the RF cable assemblies from the cable guide(s) on the motherboard.

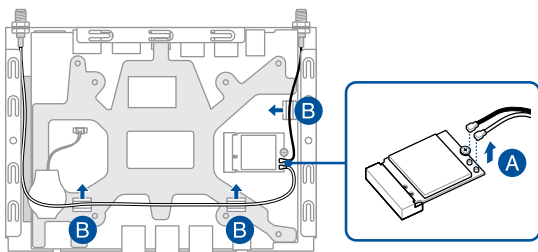

2. Remove the screw(s) securing the motherboard to the chassis one by one in the sequence shown.

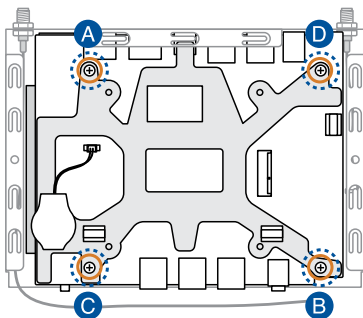

3. Remove the motherboard as shown.

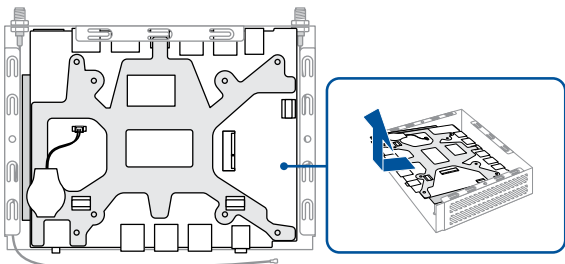

4. Locate in the chassis the antenna jack end of the RF cable assembly.
5. Remove the hex screw securing the antenna jacks
6. Remove the O-ring from the antenna jack.
7. Remove the RF cable assembly from the chassis.
8. Repeat steps 4 to 7 to remove the other RF cable assembly.

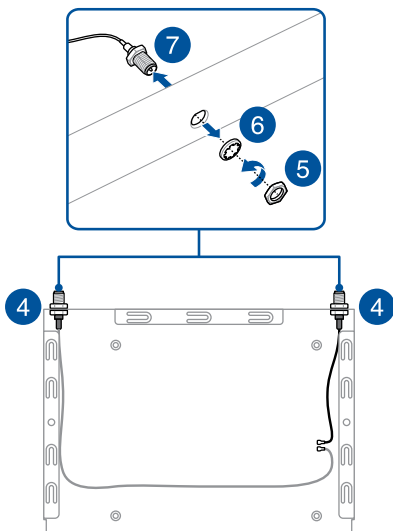

Installation

1. Insert the antenna jack end of the RF cable assembly into the antenna hole from within the chassis outwards.
2. Insert the O-ring removed earlier over the antenna jack.
3. Secure the antenna jack using the hex screw removed earlier.

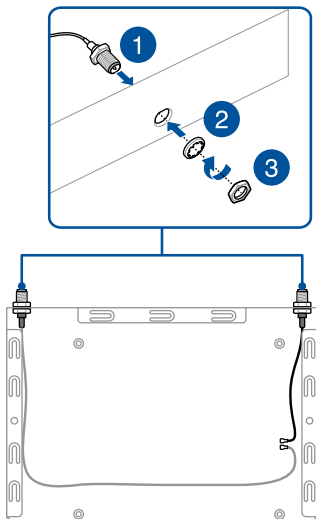

4. Repeat steps 1 to 3 to install the other RF cable assembly.

5. Align and place the motherboard in the chassis as shown.

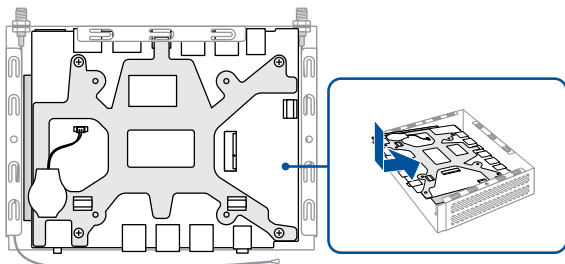

6. Secure the motherboard by tightening the screw(s) removed earlier one by one in the sequence shown.

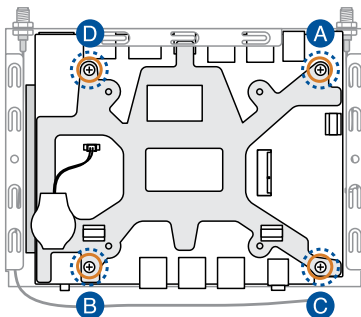

7. Route the RF cable assemblies through the cable guide(s) (A), and then connect the RF cable assemblies to the wireless card.

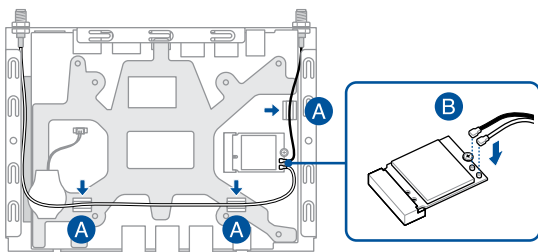

8. Install the component(s) you removed in **Before you begin**.

Chassis

Before you begin

1. Read the **Safety Precautions** and complete the **Pre-repair Checklist**.
2. Remove the following component(s):
Bottom cover

Screw list

- ⊕ M2 X 4.0L (4 pcs)

Removal

1. Disconnect the RF cable assemblies from the wireless card (A), and then remove the RF cable assemblies from the cable guide(s) on the motherboard.

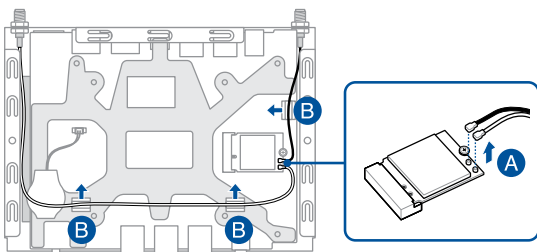

2. Remove the screw(s) securing the motherboard to the chassis one by one in the sequence shown.

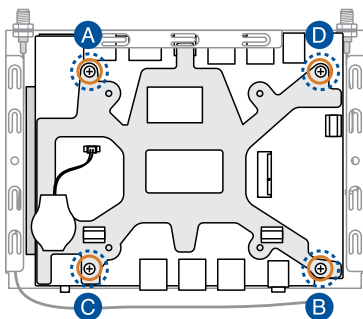

3. Remove the motherboard as shown.

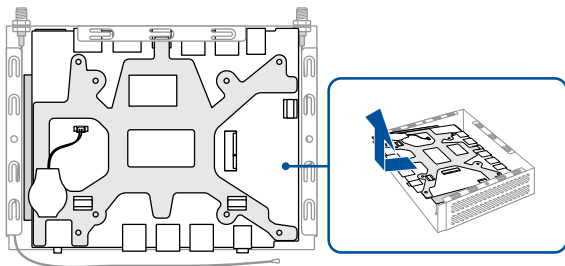

Installation

1. Align and place the motherboard in the chassis as shown.

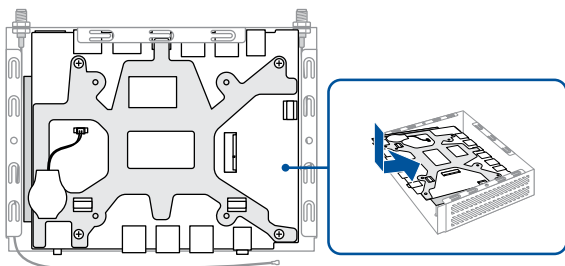

2. Secure the motherboard by tightening the screw(s) removed earlier one by one in the sequence shown.

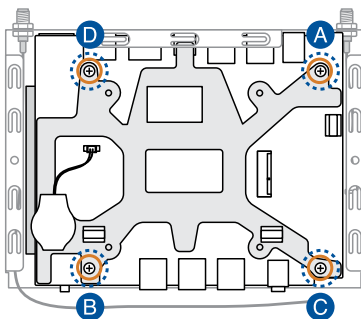

3. Route the RF cable assemblies through the cable guide(s) (A), and then reconnect the RF cable assemblies to the wireless card.

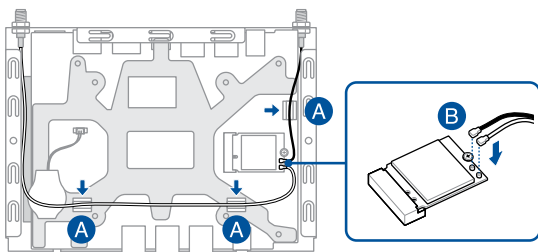

4. Install the component(s) you removed in **Before you begin**.

