



Heavy-Duty 17" Gooseneck w/ Cable Routing & Universal Tablet Enclosure

PAD-GN2SUHB

INSTRUCTION - MANUAL

CONTENTS:

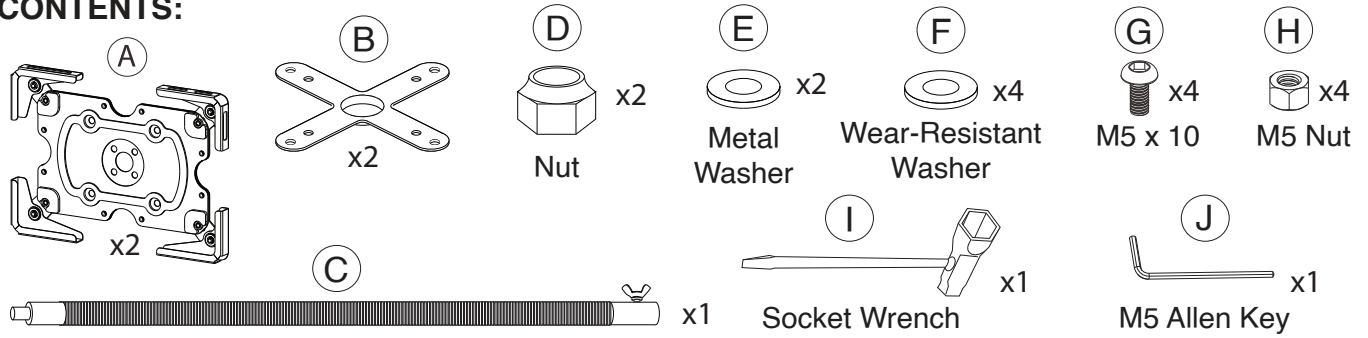

INSTALLATION:

1. Connecting VESA Plate to the Gooseneck :

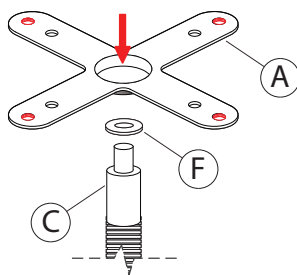

1A. Align and place VESA (A), Washer (F) and Gooseneck end connector (C) in order as shown above.

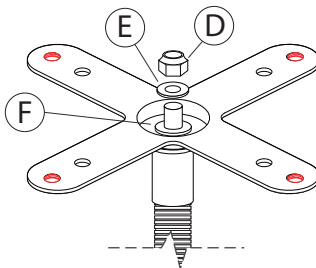

1B. When everything is connected, place washers (E & F) and nut (D) as shown. Rotate nut with hand initially.

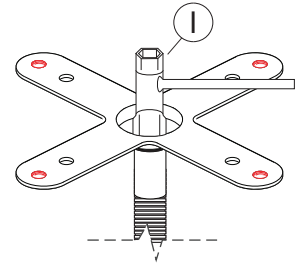

1C. Use provided wrench tool (I) to rotate nut until securely fastened.

2. Attaching enclosure to VESA gooseneck :

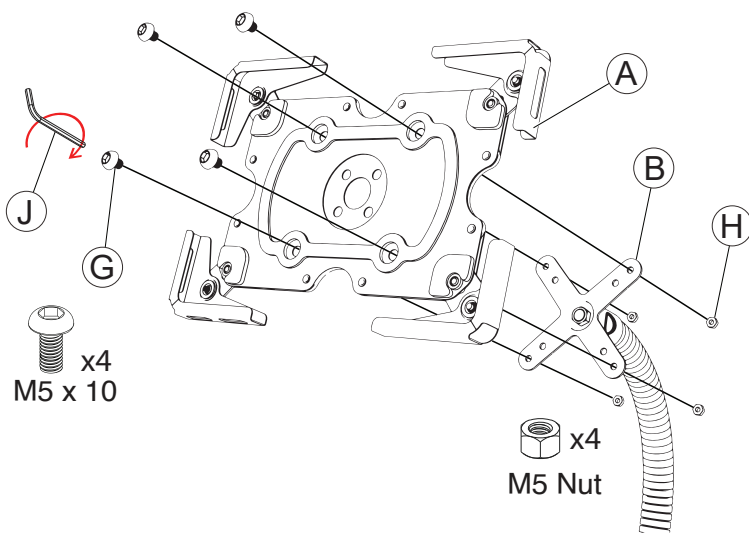

2A. Align enclosure VESA holes (A) to VESA plate holes (B) on gooseneck. Turn in the screws (G) with the provided allen key tool (J) while holding with your hands the nuts (H) in the back. As shown above.

3. Setting up enclosure and tablet :

****Just loosen the screw by half a turn to release the corners.**

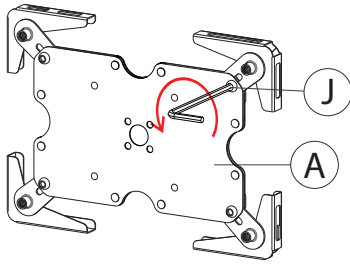

3A. Begin inserting your tablet device into the enclosure by loosening the enclosure corner arms. Find the screw on the body (A) as illustrated and loosen all (4) with provided special allen key tool (J).

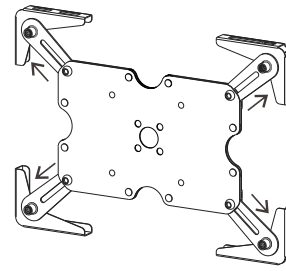

3B. Extend the arms outwards as far as the range can go.



3C. Insert your tablet then retract all(4) arms onto the corners of the tablet as illustrated above.

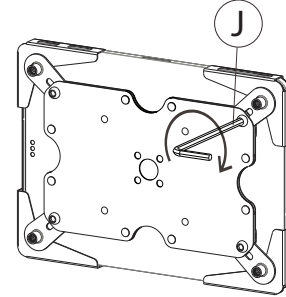

3D. While all the arms are tightly and secured on the tablet edge corners, go back to the backside and using special allen key tool (J) rotate the opposite direction for all (4) screws until securely tightened.

4. Fixed the tablet :

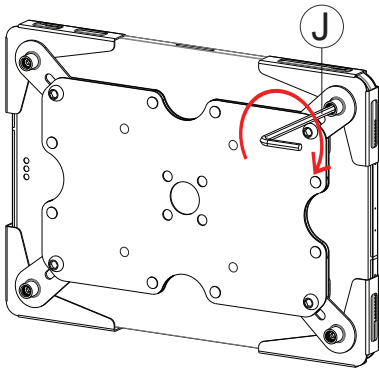

4A. Tighten the inner nut by (J) security allen key to adjust the enclosure thickness.

5. Swapping out different corners arms (optinal) :

Exposed Corner

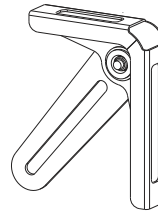

Solid Corner

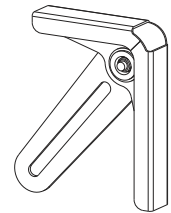

5A. You can switch out your corner arms from exposed to solid or vice versa as illustrated above. Exposed corners allow you to have the volume buttons to not be as covered.

6. Adjusting Gooseneck and Rotation.

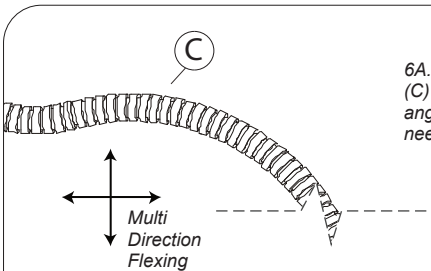

6A. Flex the gooseneck (C) to adjust the view angle according to your needs.

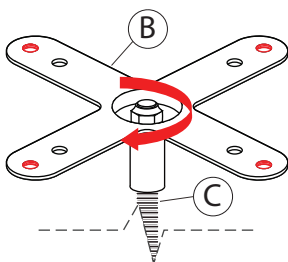

6B. Rotate the VESA Plate (B) clockwise to adjust orientation to preferred setup.

7. Cable Management.

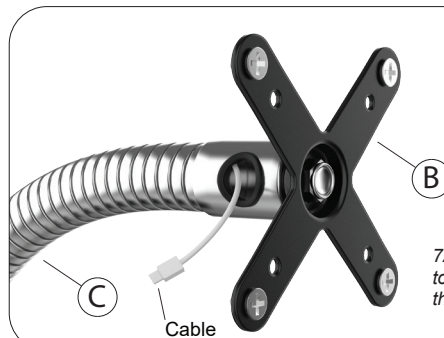

****Cable for illustration only and not included.**

7A. Fish one end of the cable through top hole, and route the other end through the other end hole as shown.