



Perfection V19 II/V39 II User's Guide

Contents

Perfection V19 II/V39 II User's Guide	7
Product Basics	8
Scanner Parts	8
Scanner Buttons and Lights	11
Using the Scanner Stand	11
Placing Originals on the Scanner	16
Placing Originals on the Scanner Glass	16
Placing Originals While Using the Scanner Stand	19
Placing Thick Documents	23
Scanning	24
Scanning Using Epson ScanSmart	24
Starting a Scan from a Scanner Button	25
Selecting the Scan Mode	26
Scanning Documents and Photos in Epson ScanSmart	26
Saving a Scan	30
Sending a Scan to a Cloud Service	30
Attaching a Scan to E-mail	31
Printing a Scan	33
Stitching Photos	34
Selecting Epson ScanSmart Settings	35
Changing the Epson Product	35
Changing the Scan Settings	36
Photo Enhancements Settings	39
Changing the File Name Settings	40
Available Image Adjustments - Document Mode	43
Available Image Adjustments - Photo Mode	44
Changing the Save Settings	47
Save Settings	49
Customizing Action Icons	50
Scan Resolution Guidelines	52

Cleaning and Transporting Your Product	54
Cleaning Your Scanner	54
Transporting Your Scanner	54
Solving Problems	56
Scanner Light Status	56
Solving Scanning Problems	57
Scanner Does Not Turn On or Turns Off Unexpectedly	57
Scanner Buttons Do Not Work as Expected	58
Cannot Start Epson ScanSmart.....	58
Scanning is Slow	58
Solving Scanned Image Quality Problems	59
Uneven Colors, Dirt and Spots Appear in Your Scanned Image.....	59
The Image Quality is Rough	60
Spots or Lines Appear in All Scanned Images.....	60
Straight Lines in an Image Appear Crooked	60
Text or Images are Blurry	60
Image Colors are Patchy at the Edges	61
Back of Original Image Appears in Scanned Image	61
Ripple Patterns Appear in an Image	61
Cannot Scan the Correct Area.....	61
Cannot Scan Multiple Photos at the Same Time	62
Image is Scanned Upside-Down	62
Characters are not Recognized Correctly.....	62
Binding Margins of a Booklet are Distorted or Blurred	63
Cannot Solve Problems in the Scanned Image	63
Checking Your Applications.....	64
Checking Your Applications for Windows	64
Checking Your Applications for Mac OS	65
Updating Applications and Firmware	65
Uninstall Your Product Software.....	65
Uninstalling Product Software - Windows	66
Uninstalling Product Software - Mac	66
Where to Get Help (U.S. and Canada)	67

Where to Get Help (Latin America).....	68
Technical Specifications	71
Windows System Requirements	71
Mac System Requirements	71
General Specifications	72
Dimension Specifications	72
Electrical Specifications	72
Environmental Specifications	73
USB Interface Specifications.....	73
Safety and Approvals Specifications	74
Notices	75
Important Safety Instructions.....	75
Default Delay Times for Power Management for Epson Products.....	76
Restrictions on Copying	76
Trademarks	77
Copyright Notice.....	77
libTIFF Software Acknowledgment.....	78
A Note Concerning Responsible Use of Copyrighted Materials.....	79
Copyright Attribution	79

Perfection V19 II/V39 II User's Guide

Welcome to the Perfection V19 II/V39 II *User's Guide*.

For a printable PDF copy of this guide, [click here](#).

Note: Availability of products in this guide varies by country.

Note: The Perfection V39 II is shown in most illustrations in this manual, unless noted otherwise.

Product Basics

See these sections to learn about the basic features of your product.

[Scanner Parts](#)

[Scanner Buttons and Lights](#)

[Using the Scanner Stand](#)

Scanner Parts

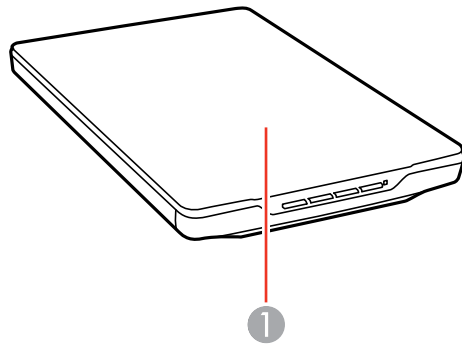

1 Scanner cover

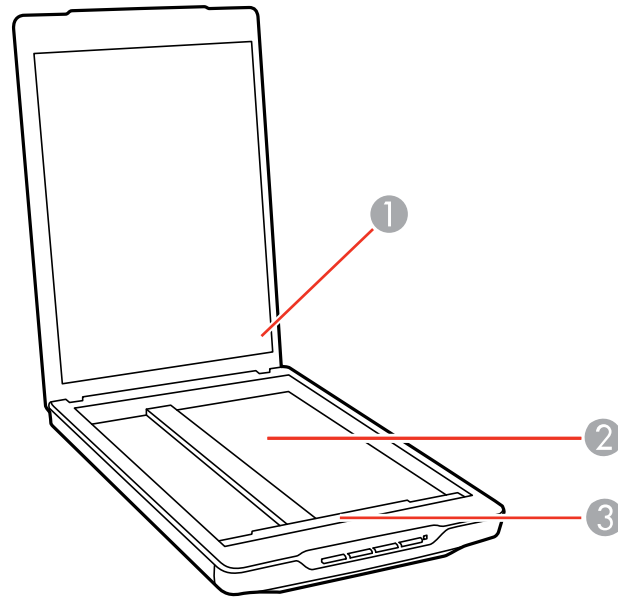

- 1 Document mat
- 2 Scanner glass
- 3 Carriage (beneath scanner glass)

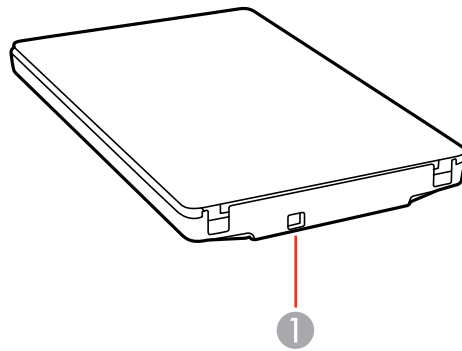

1 USB port

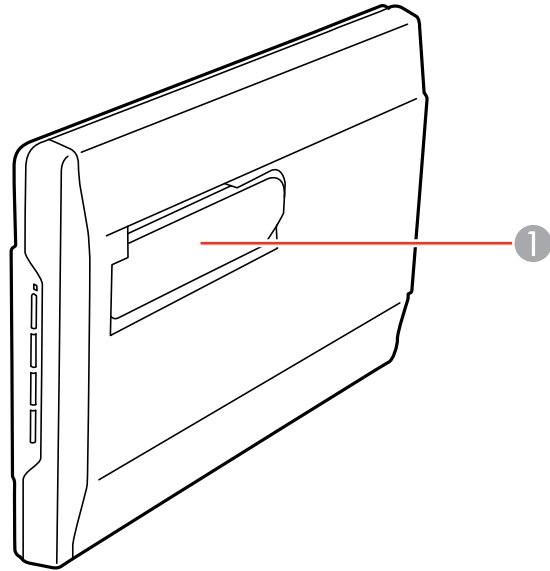



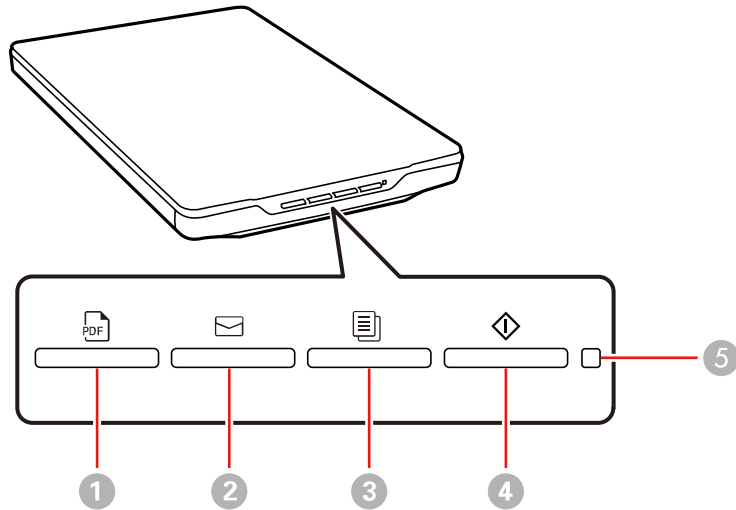

1 Scanner stand

Parent topic: [Product Basics](#)

Scanner Buttons and Lights



- 1 The  PDF button
- 2 The  email button
- 3 The  copy button
- 4 The  start button
- 5 The status light

Parent topic: [Product Basics](#)

Related references
[Scanner Light Status](#)

Using the Scanner Stand

The scanner can be used in an upright position if surface space is limited.

1. Stand the scanner upright.

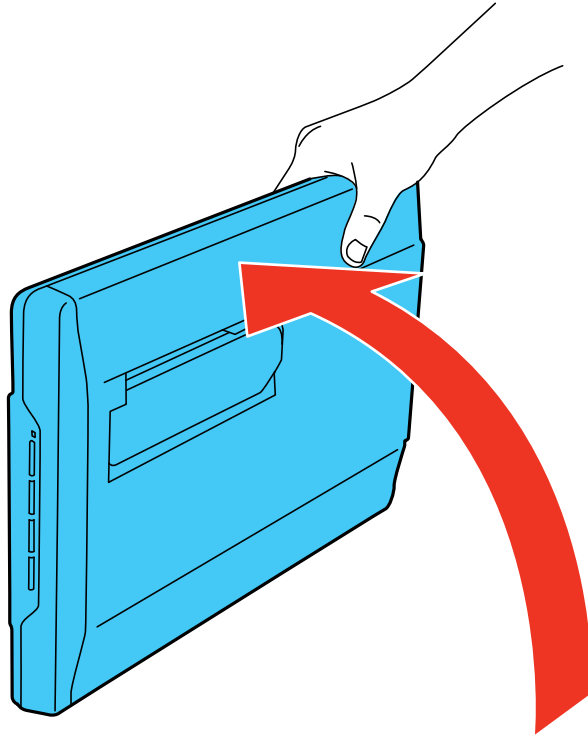

2. Extend the scanner stand from the back of the scanner until it clicks into place.

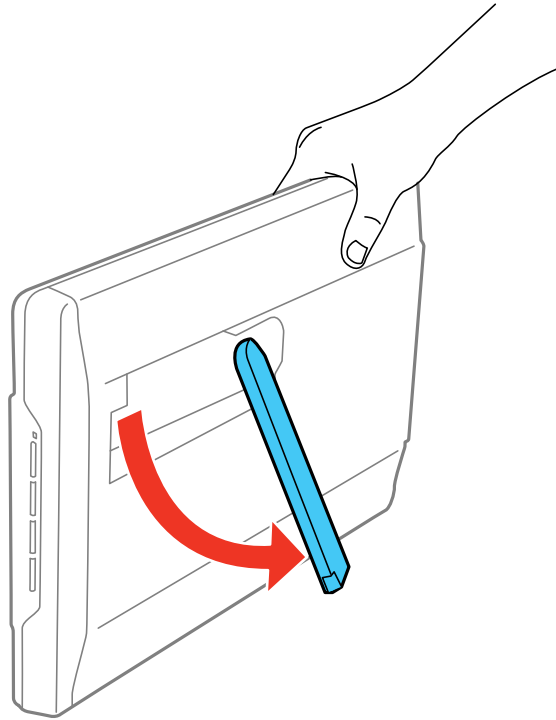

3. Tilt the scanner until it rests on the scanner stand.

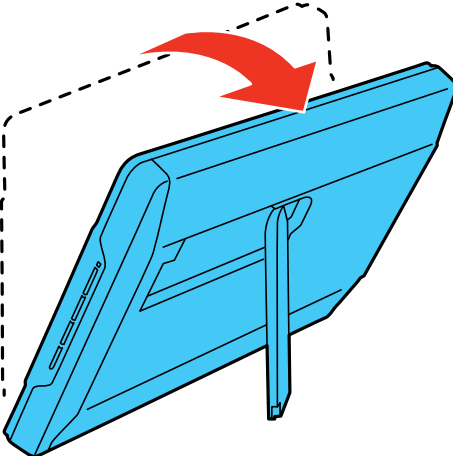

4. To put the scanner stand away, rotate it into the back of the scanner.

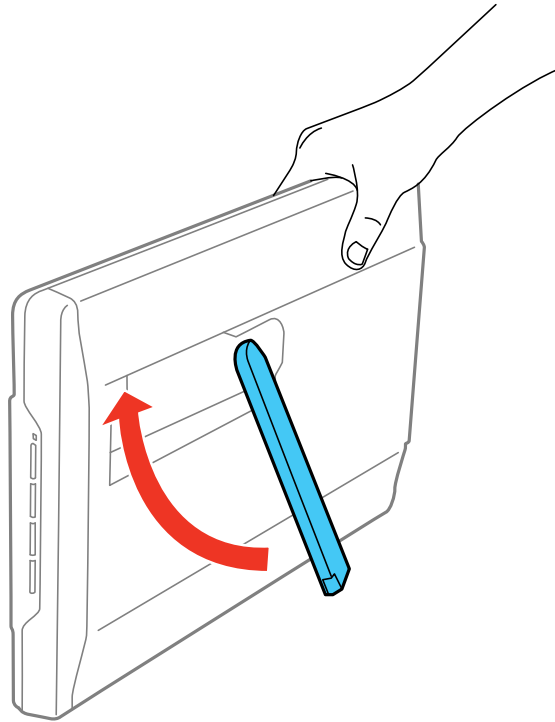

Parent topic: [Product Basics](#)

Placing Originals on the Scanner

Follow the instructions here to place your originals on the scanner.

Caution: Do not place anything on top of your scanner or use its cover as a writing surface to avoid damaging it.

[Placing Originals on the Scanner Glass](#)

[Placing Originals While Using the Scanner Stand](#)

[Placing Thick Documents](#)

Placing Originals on the Scanner Glass

You can place originals directly on the scanner glass.

Caution: Do not place heavy objects on the scanner glass and do not press on the glass with too much force, or it may damage the scanner. Do not leave photos on the scanner glass for an extended period, or they may stick to the glass.

1. Open the scanner cover.

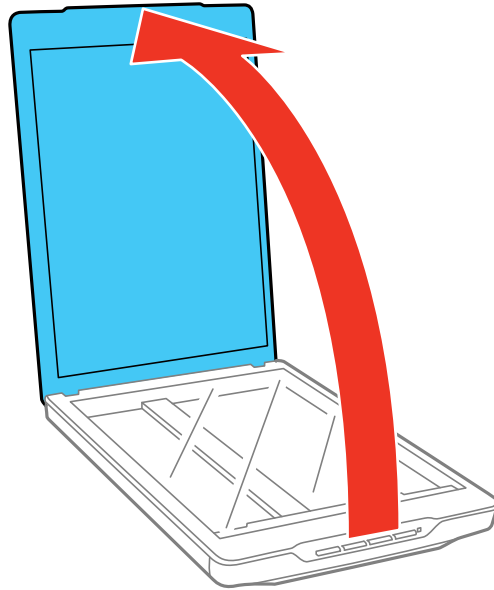

Caution: Be careful not to open the scanner cover beyond its stop point (about 100°), or you may damage it.

2. Place your original facedown on the scanner glass with the top edge facing as shown. Slide the original to the edges of the indicated corner.

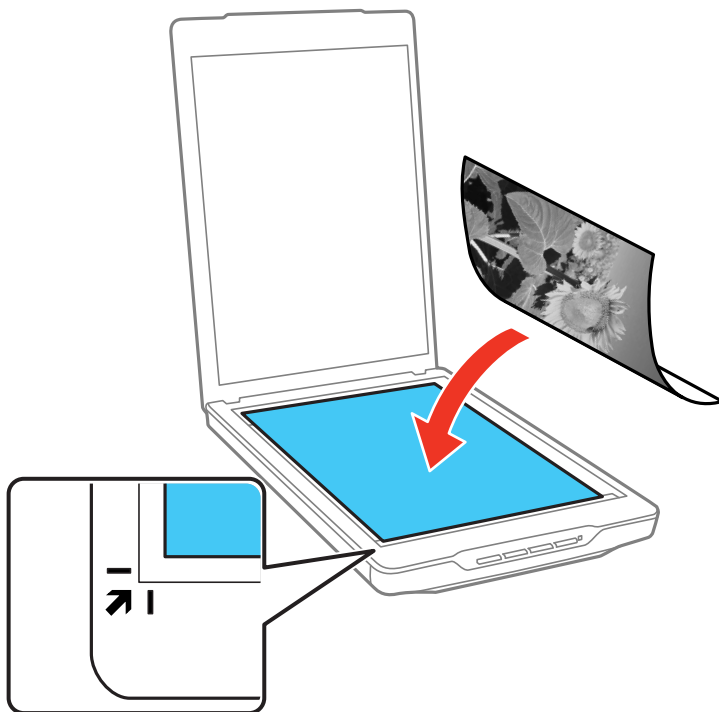

Note: When scanning documents (using Auto Mode or Document Mode): You can avoid cropping by moving your original by 0.1 inch (2.5 mm) from the top and side edges.

Note: When scanning photos (using Auto Mode or Photo Mode): Place each photo about 0.24 inch (6 mm) away from the edges of the scanner glass. You can scan multiple photos at the same time. Make sure they are at least 0.8 inch (20 mm) away from each other.

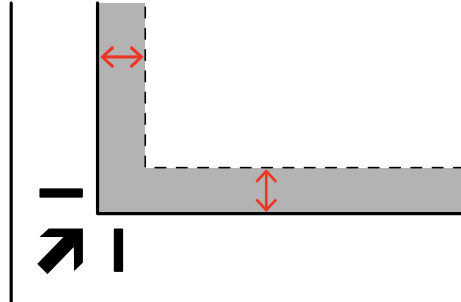

3. Close the scanner cover gently to keep your original in place.

Note: Always keep the scanner glass clean.

Parent topic: [Placing Originals on the Scanner](#)

Related tasks

[Placing Originals While Using the Scanner Stand](#)

Placing Originals While Using the Scanner Stand

You can place originals directly on the scanner glass while the scanner stand is extended.

Caution: Do not place heavy objects on the scanner glass and do not press on the glass with too much force, or it may damage the scanner. Do not leave photos on the scanner glass for an extended period, or they may stick to the glass.

Note: You cannot place large or thick documents when the scanner is in a standing position.

1. Open the scanner cover.

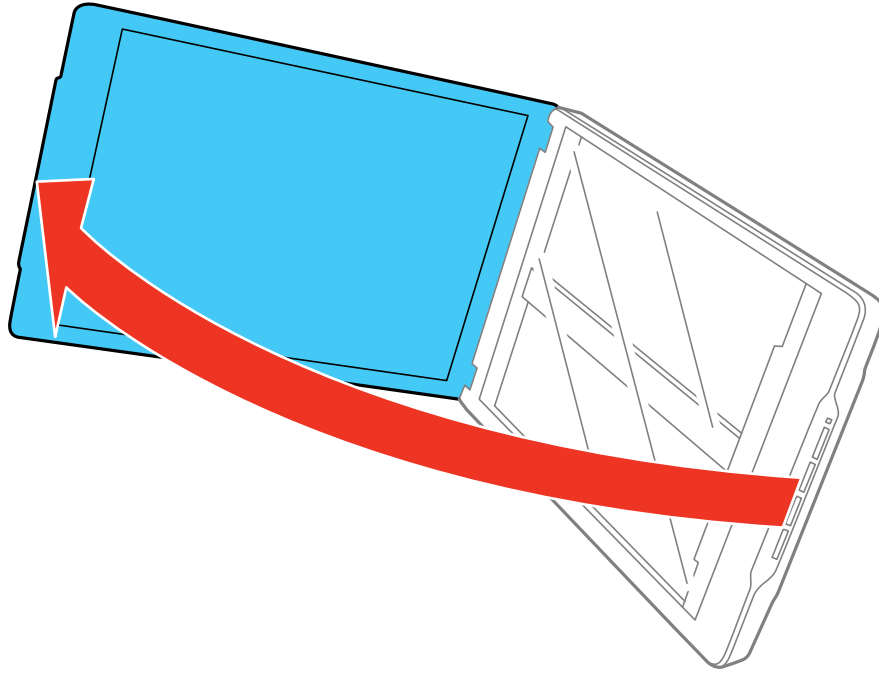

2. Place your original facedown on the scanner glass with the top edge facing as shown. Slide the original to the edges of the indicated corner.

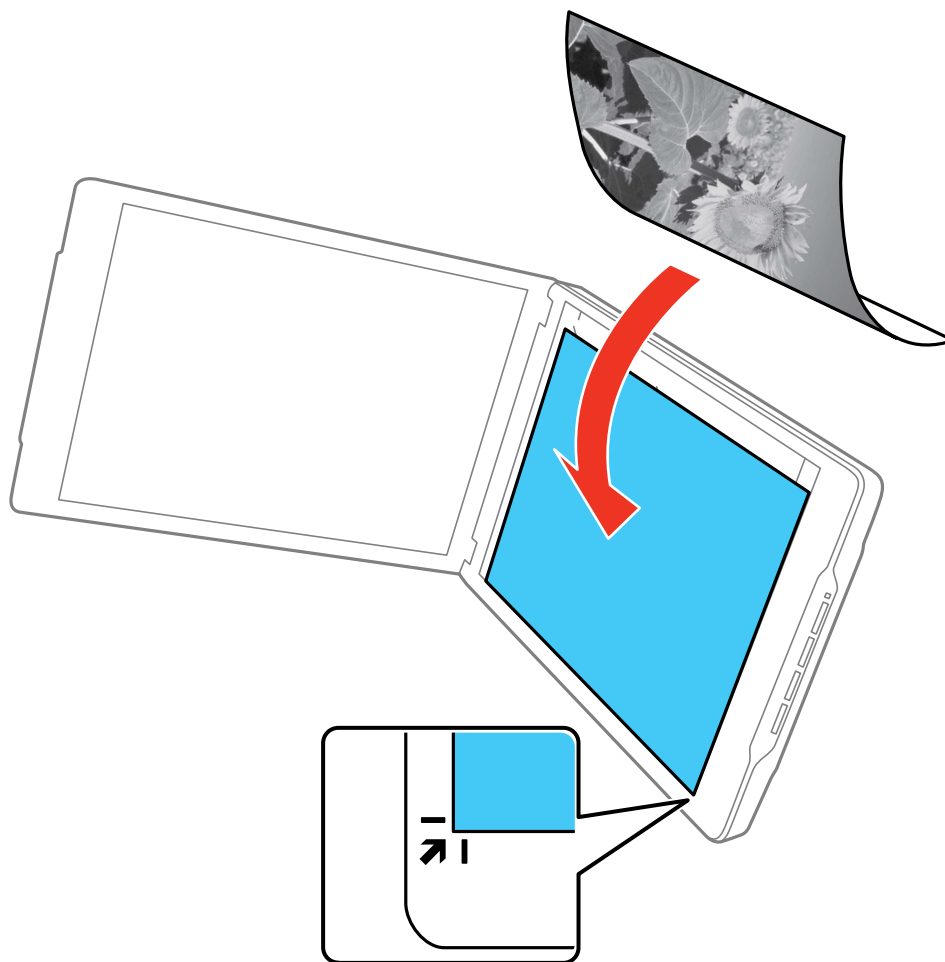

Note: The edges of your original may be cropped by 0.1 inch (2.5 mm) from the top and side edges.

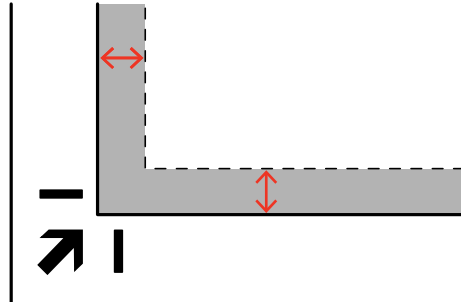

3. Close the scanner cover gently and hold it to keep your original in place while scanning so that the scanner cover does not open.

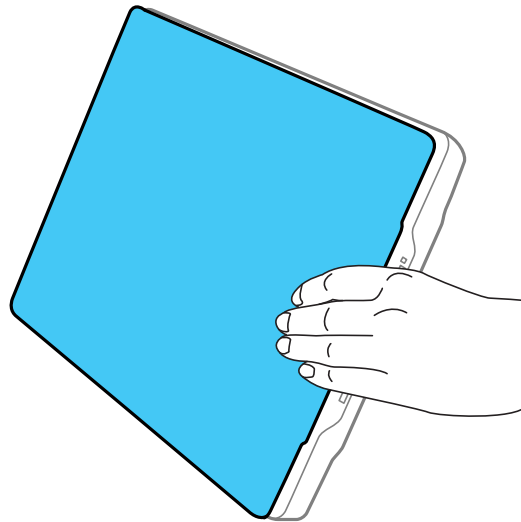

Parent topic: [Placing Originals on the Scanner](#)

Related tasks

[Placing Originals on the Scanner Glass](#)

Placing Thick Documents

If you are scanning a book or other thick document, you can remove the scanner cover.

1. Hold the scanner cover near the hinges and pull straight up, keeping the cover horizontal.

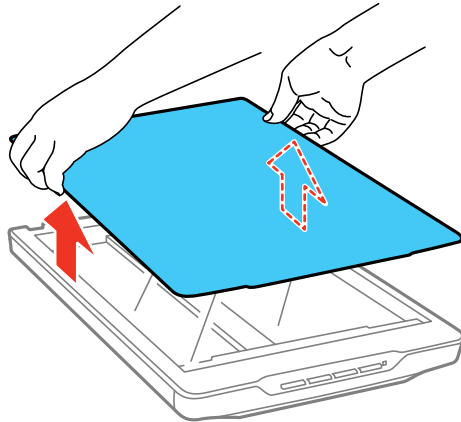

2. Place your document facedown on the scanner glass.

Note: Press down on your document gently to flatten it and hold the document down as you scan.

3. When you are finished scanning, replace the scanner cover in the reverse order that you removed it.

Parent topic: [Placing Originals on the Scanner](#)

Scanning

You can scan your originals and save them as digital files.

[Scanning Using Epson ScanSmart](#)

[Scanning Documents and Photos in Epson ScanSmart](#)

[Stitching Photos](#)

[Selecting Epson ScanSmart Settings](#)

[Scan Resolution Guidelines](#)

Scanning Using Epson ScanSmart

Epson ScanSmart has three modes for easy scanning. Select the option that suits your originals:

- **Auto Mode:** Scans by automatically detecting the type of original.
- **Document Mode:** Scans by using adjustment features suitable for the document.
- **Photo Mode:** Scans by using the image quality adjustment features suitable for photos.

Automatic cropping according to the originals

You can scan and save your originals without setting the size. The originals will be cropped to the correct size automatically, based on the size of the originals. Automatic cropping supports not only standard size originals but also irregular shaped documents, such as receipts or slips, and photos of various sizes. When scanning photos, you can save multiple photos at once by cropping each one individually without having to scan them one by one.

- Select **Auto Mode** or the mode that best suits the original. Go into **Settings > Scan Settings** to select the mode.
 - When scanning documents: Use **Auto Mode** or **Document Mode**.
 - When scanning photos: Use **Auto Mode** or **Photo Mode**.
 - When using **Document Mode**, set **Custom Settings > Document Size** to **Auto Detect**.

Note: Depending on the scanner and application version you are using, the operating procedures and available features may differ.

[Starting a Scan from a Scanner Button](#)

[Selecting the Scan Mode](#)

Parent topic: [Scanning](#)

Related tasks

[Placing Originals on the Scanner Glass](#)

[Placing Originals While Using the Scanner Stand](#)





[Scanning Documents and Photos in Epson ScanSmart](#)

Starting a Scan from a Scanner Button

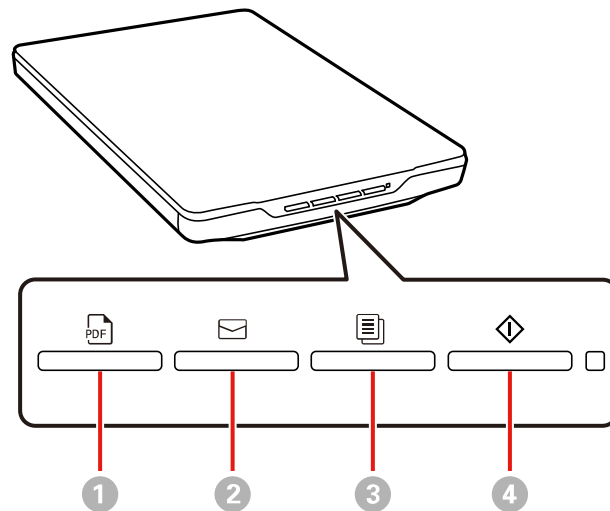
You can scan using a button on your scanner. Your product automatically selects suitable default scan settings, but you can view or change them as necessary.

1. Make sure you installed the scanner software and connected the scanner to your computer
2. Place the original on your scanner.
3. Press one of the following buttons on your scanner:



- 1 The  PDF button saves the scanned image in PDF format.
- 2 The  Email button starts a scan, then opens the email client on your computer and attaches the scanned images to an email.
- 3 The  Copy button will scan your originals and print on a printer connected to the computer.
- 4 The  Start button starts Epson ScanSmart so you can select the your scan mode, settings and action.

4. Follow the on-screen instructions to save the scanned image.

Parent topic: [Scanning Using Epson ScanSmart](#)

Related tasks

[Placing Originals on the Scanner Glass](#)

[Placing Originals While Using the Scanner Stand](#)

[Scanning Documents and Photos in Epson ScanSmart](#)

[Sending a Scan to a Cloud Service](#)

[Attaching a Scan to E-mail](#)

[Printing a Scan](#)

Selecting the Scan Mode

You can select the scanning mode according to the type of originals you are scanning.

1. Click **Settings** in the Epson ScanSmart window.
2. Select the scanning mode on the Scan Settings window.
 - **Auto Mode:** This mode automatically detects the type of content you are scanning and selects settings for it.
 - **Document Mode:** Select this mode when scanning documents. You can also select various image adjustment options, and preview and size your scanned image.
 - **Photo Mode:** Select this mode when scanning photos. You can manually customize all available settings, and preview and size your scanned image.
3. Check the scanned images and edit them if necessary.



Parent topic: [Scanning Using Epson ScanSmart](#)

Scanning Documents and Photos in Epson ScanSmart

You can scan and review documents and photos in Epson ScanSmart.

Note: The images in this guide show Windows screens. Mac screens may be slightly different. Depending on your product model and software version, not all options may be available.

1. Load your original into the product.
2. Open Epson ScanSmart on your computer. Do one of the following:
 - **Windows 11:** Click , then search for **Epson ScanSmart** and select it.

- **Windows 10:** Click  > **Epson Software** > **Epson ScanSmart**.
- **Windows 8.x:** Navigate to the **Apps** screen and select **Epson ScanSmart**.
- **Windows (other versions):** Click  or **Start**, and select **All Programs** or **Programs**. Select **Epson Software** > **Epson ScanSmart**.
- **Mac:** Open the **Applications** folder, open the **Epson Software** folder, and select **Epson ScanSmart**.

You see a screen like this:

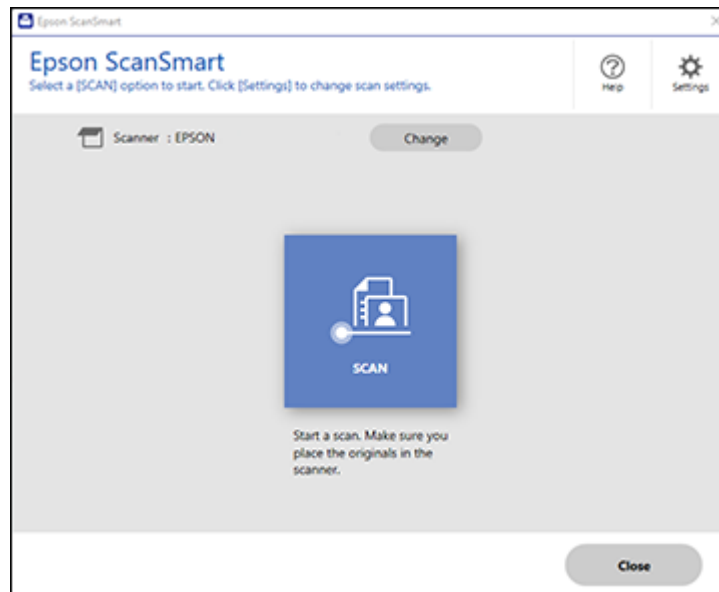

3. Select **SCAN**.

The original is scanned. When scanning is complete, you see a screen like this:

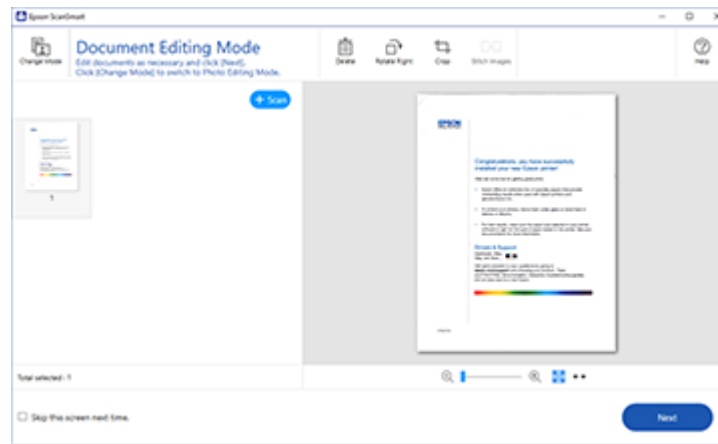

4. You can review, edit, or reorder the scanned images as follows:
 - Select **+ Scan** to scan more originals.
 - Select **Delete** to delete selected scanned images.
 - Select **Rotate Right** to rotate each scanned image.
 - Select **Crop** to crop the selected image.
 - Control-click two images, select **Stitch Images**, and follow the on-screen instructions to combine them into a single image.
5. If Photo Mode is automatically detected, the following enhancement options are available:
 - **Auto Color Enhancement**: automatically adjusts the brightness, contrast, and saturation of your photos
 - **Restore Faded Colors**: restores the colors in faded photos automatically
 - **Remove Red Eye**: automatically removes the red-eye effect from your photos
 - **Auto Cropping**: automatically crops the scanned image edges

Note:

You can scan multiple photos at the same time. Make sure there is a gap of at least 0.80 inches (20 mm) between the photos. Also, place each photo about 0.24 inches (6 mm) away from the edges of the scanner glass.

6. When you finish reviewing and editing the scanned images, click **Next**.
You see a screen like this:

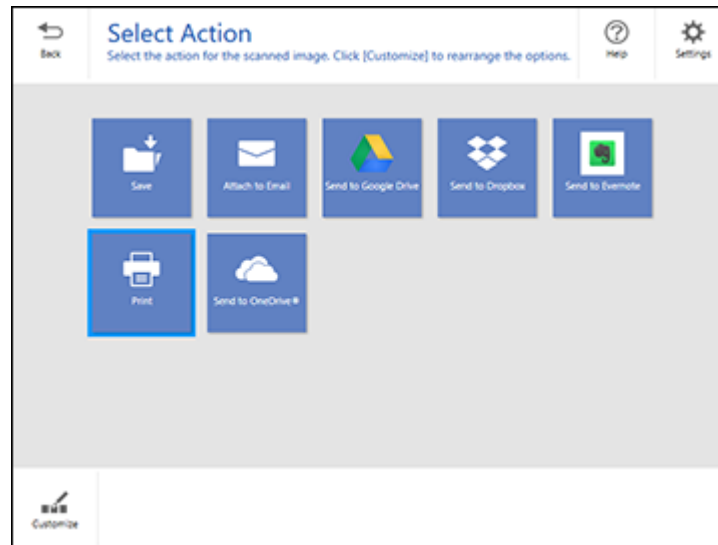

7. Select an option to save, send, or print the scanned images. See the links below.

[Saving a Scan](#)

[Sending a Scan to a Cloud Service](#)

[Attaching a Scan to E-mail](#)

[Printing a Scan](#)

Parent topic: [Scanning](#)

Related references

[Available Image Adjustments - Document Mode](#)

[Available Image Adjustments - Photo Mode](#)

Related tasks

[Changing the Epson Product](#)

[Changing the Scan Settings](#)

[Photo Enhancements Settings](#)

[Changing the File Name Settings](#)

Saving a Scan

You can save a scanned image to your computer in a variety of formats.

1. Make sure your originals are scanned and reviewed. See the link below.
2. In the **Select Action** window, click **Save**.

You see a screen like this:

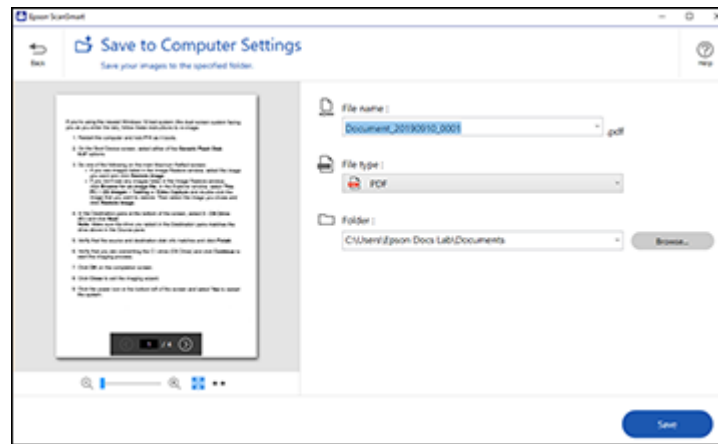

3. Change the settings as follows:
 - The document type and scan date for the file name are automatically detected. You can change them as necessary.
 - You can save the scanned image in a variety of formats.
 - Select the folder on your computer in which to save the file.
4. Click **Save**.

Parent topic: [Scanning Documents and Photos in Epson ScanSmart](#)

Sending a Scan to a Cloud Service

You can upload scanned images to a cloud service. Internet access is required.

1. Make sure your originals are scanned and reviewed. See the link below.
2. In the **Select Action** window, click one of the cloud service send options.

You see a screen like this:

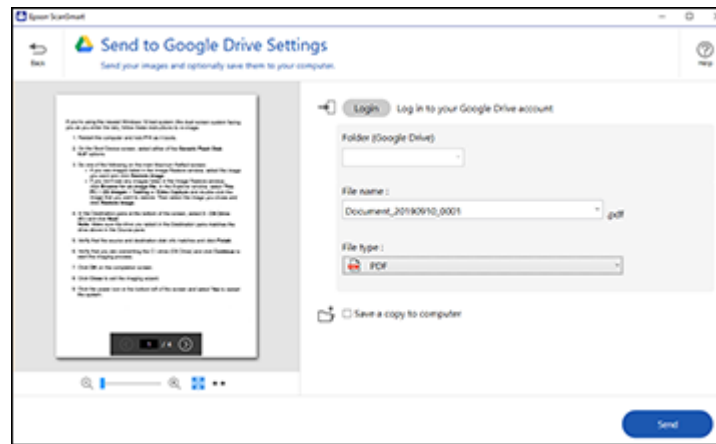

3. Log in to your account.

Note: You may need to allow Epson ScanSmart access to your account. The first time you log in, you may be prompted to enter an authentication code. You can only save to top-level folders, you cannot save to a nested folders.

4. Change the settings as follows:
 - Select the folder in your account where you want to send the document.
 - The document type and scan date for the file name are automatically detected. You can change them as necessary.
 - You can save the scanned image in a variety of formats.
 - If you also want to save a copy of the scanned image to your computer, click the checkbox.
5. Click **Send**.

Parent topic: [Scanning Documents and Photos in Epson ScanSmart](#)

Attaching a Scan to E-mail

You can attach a scanned image to an e-mail as a file attachment.

Note: Epson ScanSmart supports only Outlook or e-mail software that supports MAPI. The following Outlook versions are supported by Epson ScanSmart: Microsoft Outlook 2003/2007/2010/2013/2016/2019/2021 (32-bit). Check the help for your e-mail software to confirm if your software supports MAPI.

Note: Your e-mail app and account settings should be configured before scanning. You must install a MAPI-type e-mail program such as Outlook Express, Windows Live Mail, Entourage, or Mac Mail. Attach to E-mail only supports 32-bit MAPI-compatible mail apps. Web-based e-mail services such as Gmail are not supported. If you see an error message, your e-mail app may not be compatible and you will need to save the scans and manually attach the file to an e-mail.

1. Make sure your originals are scanned and reviewed. See the link below.
2. In the **Select Action** window, click **Attach to E-mail**.

You see a screen like this:

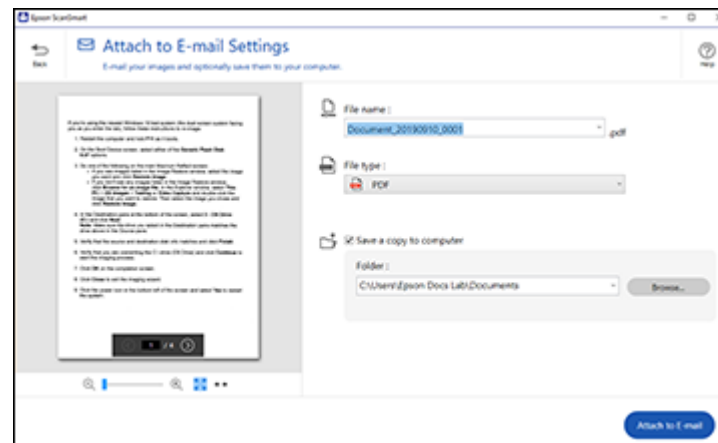

3. Change the settings as follows:
 - The document type and scan date for the file name are automatically detected. You can change them as necessary.
 - You can save the scanned image in a variety of formats.
 - If you also want to save a copy of the scanned image to your computer, make sure the checkbox is selected and select the folder on your computer in which to save the file.
4. Click **Attach to E-mail**.

Your e-mail program opens with the file attached to a new e-mail.

Parent topic: [Scanning Documents and Photos in Epson ScanSmart](#)

Printing a Scan

You can print your scanned image and save the scanned file to your computer.

1. Make sure your originals are scanned and reviewed. See the link below.
2. In the **Select Action** window, click **Print**.

You see a screen like this:

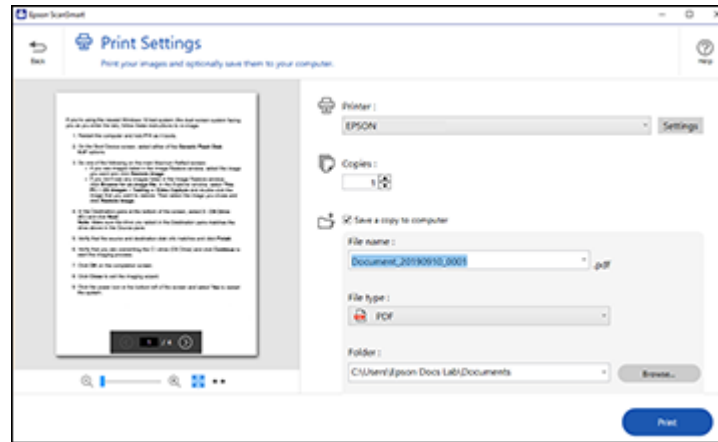

3. Change the settings as follows:
 - Select the Epson printer and change the print settings, if necessary.
 - Select the number of copies you want to print.
 - If you also want to save a copy of the scanned image to your computer, click the checkbox.
 - The document type and scan date for the file name are automatically detected. You can change them as necessary.
 - You can save the scanned image in a variety of formats. If you select Searchable PDF as the **File type** setting, you can select the OCR (Optical Character Recognition) language.
 - Select the folder on your computer in which to save the file.
4. Click **Print**.

Stitching Photos

You can combine scanned photos to create a single image. You can use either of the following methods.

- **Basic Stitching:** Combines two images into one; images can be positioned side-by-side or top-to-bottom.



- **Advanced Stitching:** Combines images into one by automatically detecting overlapping areas in the images (Perfection V39 II).



Note: Images that are too large cannot be stitched together. The longest edge of the photo must not exceed the following:

- **Basic Stitching:** 65,535 pixels (Windows) or 39,686 pixels (Mac)
- **Advanced Stitching:** 25,000 pixels
 - This feature cannot be used with all images, including monotone images and charts.

1. Place the originals on your scanner.
2. Open Epson ScanSmart. Do one of the following:
 - To scan from the scanner, press the  button on the scanner. Epson ScanSmart opens and scanning starts.
 - To scan from your computer, start Epson ScanSmart, and then click **SCAN**.When using **Advanced Stitching**, you can scan the originals multiple times while shifting them slightly each time to ensure that the resulting scans overlap.
3. Select photos you want to combine, and then click **Stitch Images**. To select multiple images, hold down the Ctrl or Shift key while clicking on the images.
4. Select **Basic Stitching** or **Advanced Stitching**.

5. On the **Stitch Images** screen, check the stitched image. When you have selected **Basic Stitching**, you can edit the image using the buttons at the top of the screen to rotate and change the position of the images.
6. Click **OK**, and then follow the on-screen instructions to save the image.

Parent topic: [Scanning](#)

Related references

[Available Image Adjustments - Photo Mode](#)

Selecting Epson ScanSmart Settings

After starting Epson ScanSmart, you can change various scanning settings.

[Changing the Epson Product](#)

[Changing the Scan Settings](#)

[Photo Enhancements Settings](#)

[Changing the File Name Settings](#)

[Available Image Adjustments - Document Mode](#)

[Available Image Adjustments - Photo Mode](#)

[Changing the Save Settings](#)

[Save Settings](#)

[Customizing Action Icons](#)

Parent topic: [Scanning](#)

Changing the Epson Product

If you are using more than one Epson product with Epson ScanSmart, you can change the product that you are using with your computer.

1. On the main screen, click **Change**.

You see a screen like this:

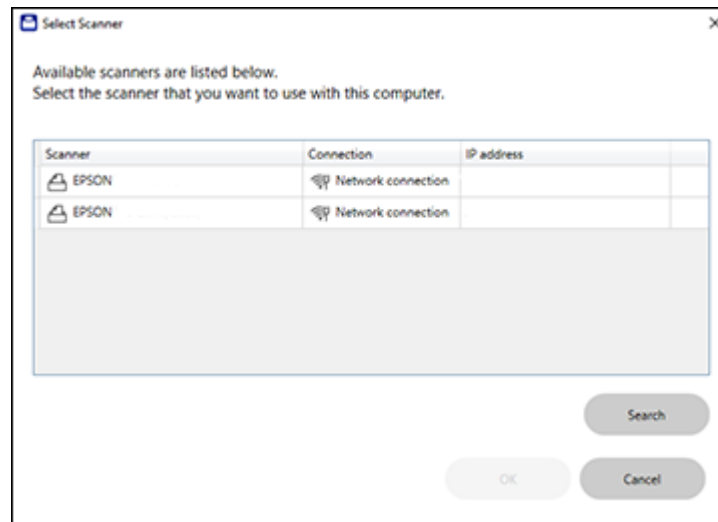

2. Select the Epson product you want to use with your computer and click **OK**.

Parent topic: [Selecting Epson ScanSmart Settings](#)

Changing the Scan Settings

You can change detailed scan settings, such as the resolution, document size, and more.

1. Click the  **Settings** button.

You see a screen like this:

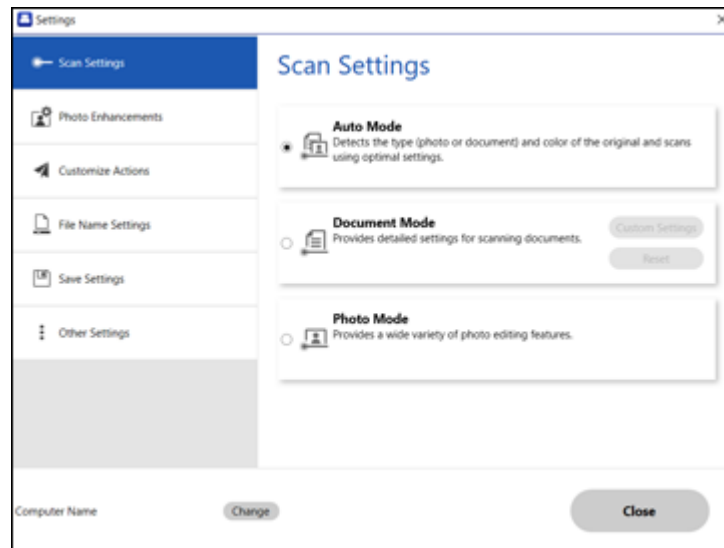

2. Do one of the following:
 - To change Document Mode settings, select **Document Mode > Custom Settings**.
 - To change Photo Mode settings, select **Photo Mode** and click **Close**. When you start a scan, you will be prompted to select scan settings.

You see a screen like this:

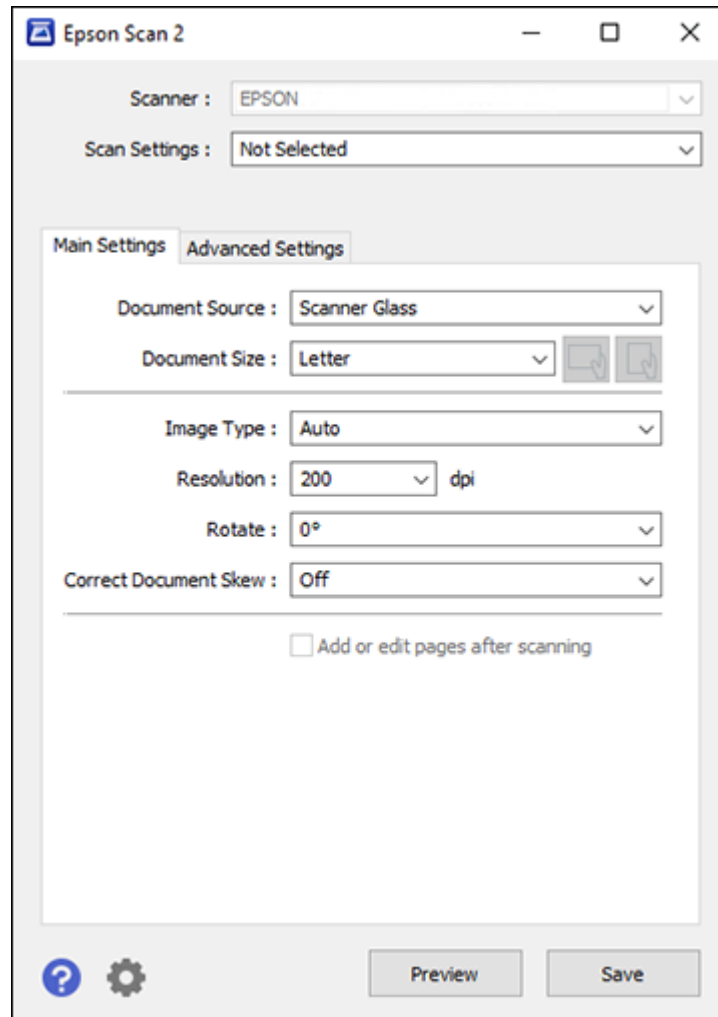

3. Change the settings as necessary and click **Save**.

Parent topic: [Selecting Epson ScanSmart Settings](#)

Photo Enhancements Settings

You can change the photo enhancements options.

1. Click the  **Settings** button.

You see a screen like this:

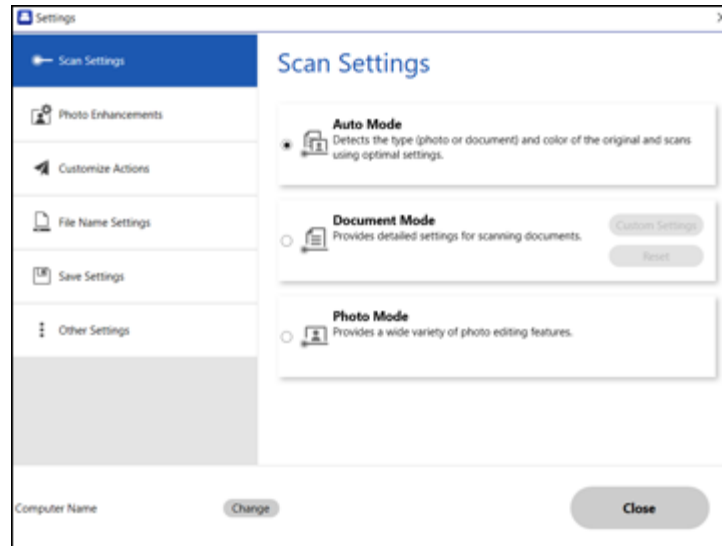

2. Click the **Photo Enhancements** tab.

You see a screen like this:

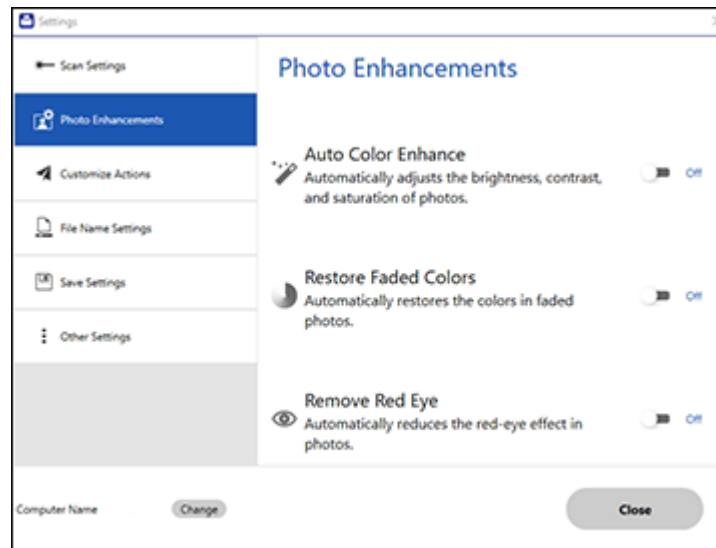

3. Change the settings as necessary:
 - **Auto Color Enhancement:** automatically adjusts the brightness, contrast, and saturation of your photos.
 - **Restore Faded Colors:** restores the colors in faded photos automatically.
 - **Remove Red Eye:** automatically removes the red-eye effect from your photos.
4. Click **Close**.

Parent topic: [Selecting Epson ScanSmart Settings](#)

Changing the File Name Settings

You can change the default file naming method for your scans.

1. Click the  **Settings** button.

You see a screen like this:

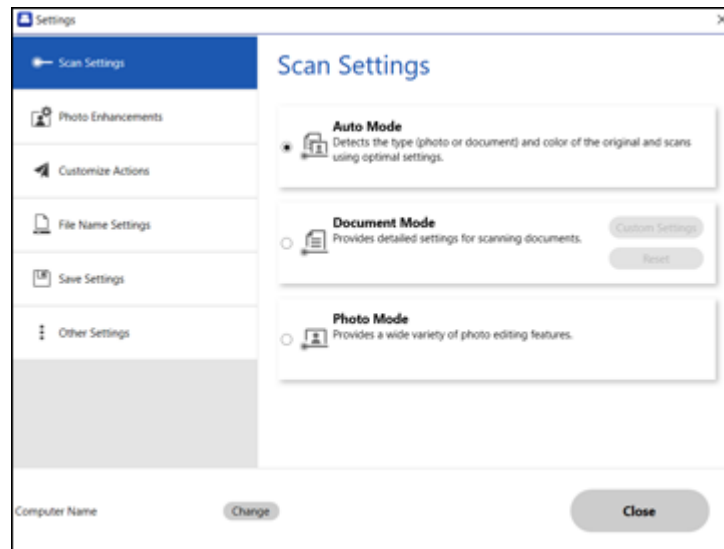

2. Click the **File Name Settings** tab.

You see a screen like this:

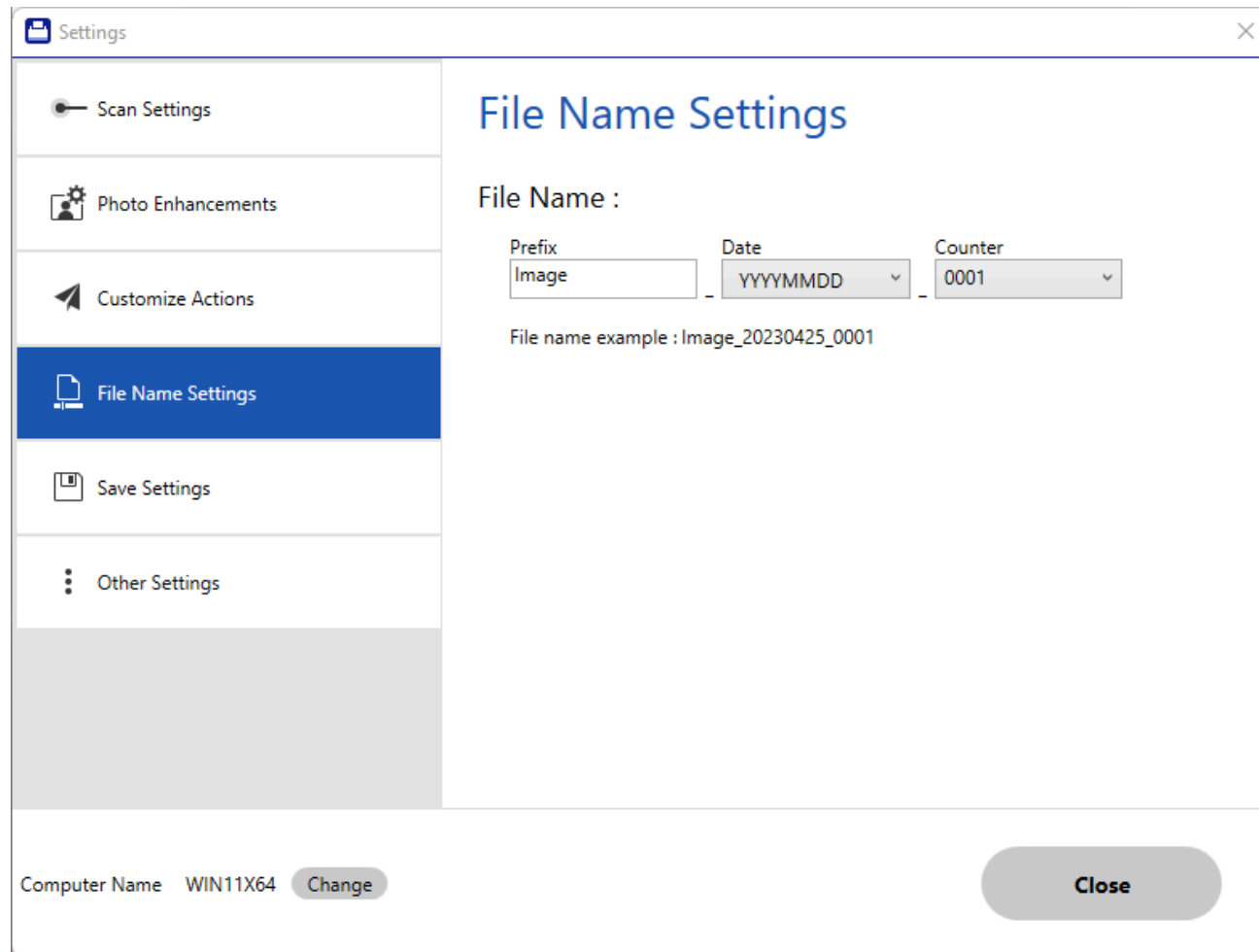

3. Change the settings as necessary:

- If you want OCR to automatically detect the subject and date and add them to the file name, click the **Automatic file naming** checkbox. You can also enter a default file name if OCR cannot detect a subject.
- Enter a prefix for the file name.

- Select the date format.
 - Select a number format as the counter format.
4. Click **Close**.

Parent topic: [Selecting Epson ScanSmart Settings](#)

Available Image Adjustments - Document Mode

Select **Custom Settings** on the  **Settings** > **Scan Settings** tab to display the Scan Settings. You can adjust scanned images using the features on the **Advanced Settings** tab. For **Document Mode**, you can use image adjustment features that are suitable for text documents.

Note: Some items may not be available depending on other settings you made.

Image Option

Remove Background

Removes the background of the originals.

Text Enhancement

Sharpens the appearance of letters in text documents.

Auto Area Segmentation

Makes black and white images clearer and text recognition more accurate by separating the text from the graphics.

Dropout

You can remove the color specified from the scanned image, and then save it in grayscale or black and white. For example, you can erase marks or notes you wrote in the margins with color pen when scanning.

Color Enhance

Enhances the shades of the color you select in the scanned image.

Brightness

Adjusts the overall lightness and darkness of the scanned image.

Contrast

Adjusts the difference between the light and dark areas of the overall scanned image.

Gamma

Adjusts the midtone density of the scanned image.

Threshold

Adjusts the level at which black areas in text and line art are delineated, improving text recognition in OCR (Optical Character Recognition) programs.

Unsharp Mask

Makes the edges of certain image areas clearer. Turn off this option to leave softer edges.

Descreening

Removes the ripple pattern that might appear in subtly shaded image areas, such as skin tones. This option improves results when scanning magazines or newspapers. (The results of descreening do not appear in the preview image, only in your scanned image.)

Edge Fill

Corrects shadowing around the edges of the image by filling the shadows with black or white.

Dual Image Output (For Windows Only)

Scans the original image twice using different output settings.

Watermark (For Windows Only)

Adds a watermark to the scanned image.

Parent topic: [Selecting Epson ScanSmart Settings](#)

Related references

[Available Image Adjustments - Photo Mode](#)

Related tasks

[Photo Enhancements Settings](#)

Available Image Adjustments - Photo Mode

In Photo Mode, the Scan Settings screen opens when scanning. You can adjust scanned images using the features on the **Advanced Settings** tab. For **Photo Mode**, you can use image adjustment features that are suitable for photos or pictures. For most features, you can check the adjustment results in the preview window.

Note: Some features cannot be set without previewing. Some items may not be available depending on other settings you made.

Brightness

Adjusts the overall lightness and darkness of the scanned image.

Contrast

Adjusts the difference between the light and dark areas of the overall scanned image.

Saturation

Adjusts the density of colors in the overall image.

Detailed Adjustments

You can adjust the image quality for the scanned image by using a histogram or tone curve. This allows you to output high-quality images while keeping image degradation to a minimum.

Reset

Returns adjustments made on the **Detailed Adjustments** screen to their defaults.

Image Adjustment

You can adjust the color balance and gray balance of the image.

Color Balance

Adjusts the color balance of the image. You can adjust the tint when photos are tinted with red and green due to the weather or the lighting where the photo was shot.

Gray Balance Intensity

Adjusts the gray balance of the image. It is useful when certain colors are too dominant due to lighting or other factors, as it enables you to remove them. Operations are available once you select the parts

you want to make black and white or gray (neutral) with the  button.

**Button**

Use the eyedropper displayed on the preview image, and select the parts you want to make black and white or gray (neutral).

Note: You can change the measurement range for the eyedropper by clicking the



(Configuration) button, and then selecting **Configuration > Preview > Eyedropper Sampling Area**.

Tone Correction Tab

You can use the tone curve to adjust the brightness and contrast of the image.

Tone Correction

By adjusting the shape of the tone curve, you can adjust the brightness and contrast of the image. You can add up to 16 points along the line of the tone curve to control the shape.

Channel

Select the color (RGB) to be adjusted using the tone curve.

Preset





Standard tone curves that have already been registered.

Histogram Adjustment

You can use the histogram to adjust the brightness of the image.

Histogram

To adjust the brightness of an image, you can check its histogram, which is a graph that shows the distribution of light and shade. You can then use different methods to adjust the shadow for the darkest parts, gamma for the medium light and shade parts, and highlight for the lightest parts. Choose one of the following methods to make the necessary adjustments.

- Move the triangle mark. The  symbol indicates shadow,  indicates gamma, and  indicates highlights.
- Select the  button. To shadow, gamma, or highlight a color, simply use the eyedropper tool shown on the preview image to select the color.
- Enter values directly. Adjust the values in Output for shadow and highlight. When the highlight is set to 255, the light parts will be white. When the shadow is set to 0, the dark parts will be black.
- **Note:** You can change the measurement range for the eyedropper by clicking the



(Configuration) button, and then selecting **Configuration > Preview > Eyedropper Sampling Area**.

Channel

Select the color (RGB) to be adjusted using the histogram.

Input

Displays the values for shadow, gamma, and highlight when scanning an original.

Output

Displays the values for the previous shadow and highlight adjustments.

Tone Curve

The density of the output value for the given image input value is displayed. Adjusts the density outside of the shadow or highlight parts set in **Histogram**.

Unsharp Mask

Makes the edges of certain image areas clearer. Turn off this option to leave softer edges.

Color Restoration

Corrects color in faded images.

Backlight Correction

Lightens darkly backlit images.

Descreening

Removes the ripple pattern that might appear in subtly shaded image areas, such as skin tones. This option improves results when scanning magazines or newspapers. (The results of descreening do not appear in the preview image, only in your scanned image.)

Dust Removal

Removes dust on scanned images.

Parent topic: [Selecting Epson ScanSmart Settings](#)

Related references

[Available Image Adjustments - Document Mode](#)

Related tasks

[Photo Enhancements Settings](#)

Changing the Save Settings

You can change the file type options for saving your scans.

1. Click the  **Settings** button.

You see a screen like this:

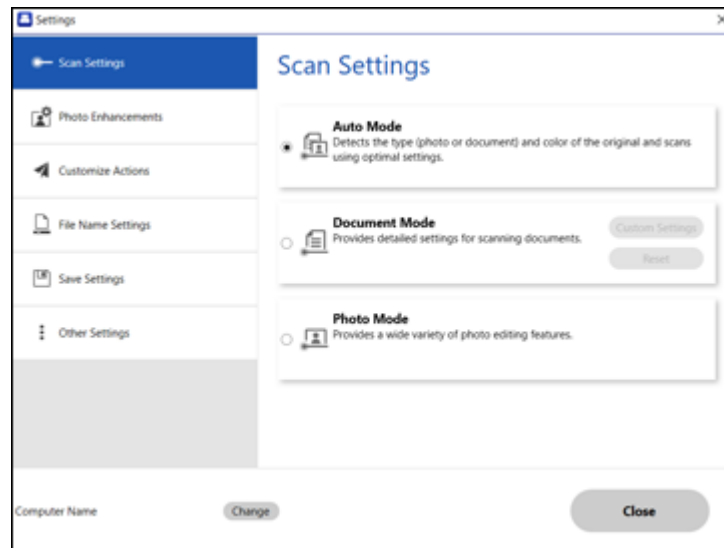

2. Click the **Save Settings** tab.

You see a screen like this:

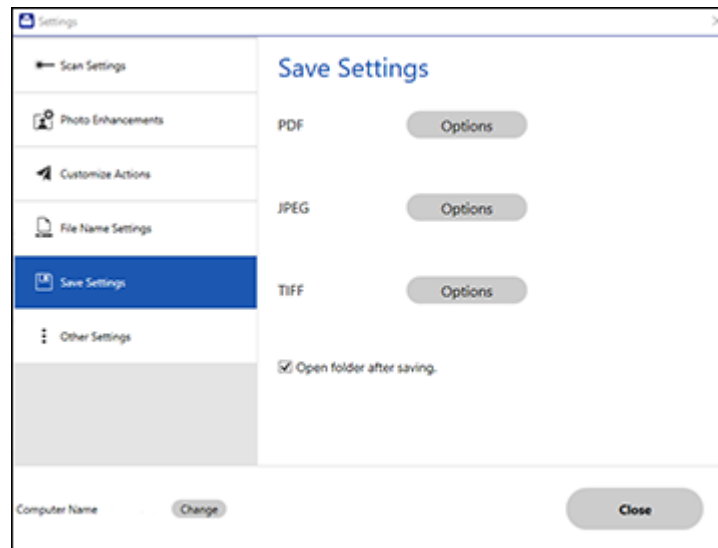

3. Click **Options** for a file format and change the settings as necessary.
4. Click **Open folder after saving** to open the file folder after a file is saved.

Parent topic: [Selecting Epson ScanSmart Settings](#)

Save Settings

You can change the settings for how scanned images are saved as PDFs, JPEGs or TIFF.

PDF Options

Setting	Options	Description
General	Generate PDF/A File	Creates a PDF that conforms to PDF/A-1 standards
	Create file with all pages	Saves all pages as one file
	Compression Level	Selects the compression level for color or grayscale images

JPEG Options

Setting	Options	Description
Image Quality Options	—	Sets a compression level by moving a slider or entering a value. File size increases when high resolution is selected.
Encoding (Windows only)	Standard	Images load from top to bottom in a web browser. It takes longer to load the entire image.
	Progressive	Images first load completely at low resolution and then adjust to high resolution in a web browser
Embed ICC Profile (Windows only)	—	Allows you to add ICC profiles to the image

TIFF Options

Setting	Options	Description
Byte Order	Windows Macintosh	Specifies the operating system format in which the scanned image is saved
Compression (Windows only)	—	Specifies the compression format and level for Color/Grayscale and B&W images. File size increases with higher quality.
Embed ICC Profile (Windows only)	—	Allows you to add ICC profiles to the image

Parent topic: [Selecting Epson ScanSmart Settings](#)

Customizing Action Icons

You can customize how the scan action icons are displayed on the **Select Action** screen.

Note: You can also customize them by clicking the **Customize** icon on the **Select Action** screen.

1. Click the  **Settings** button.

You see a screen like this:

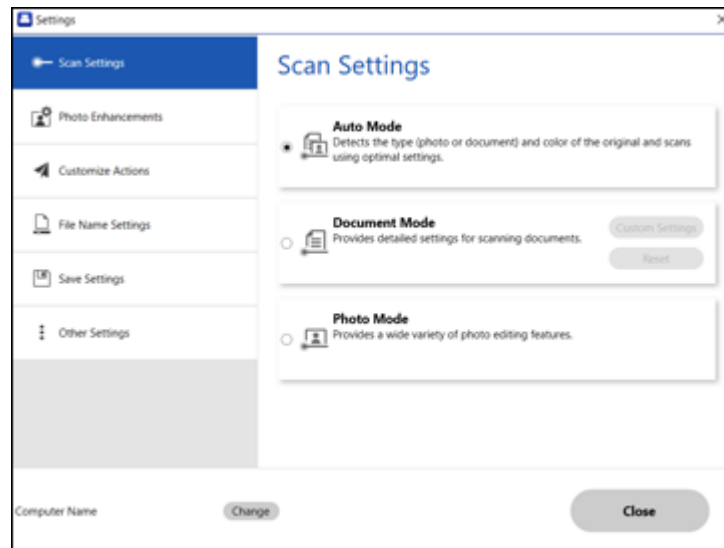

2. Click the **Customize Actions** tab.

You see a screen like this:

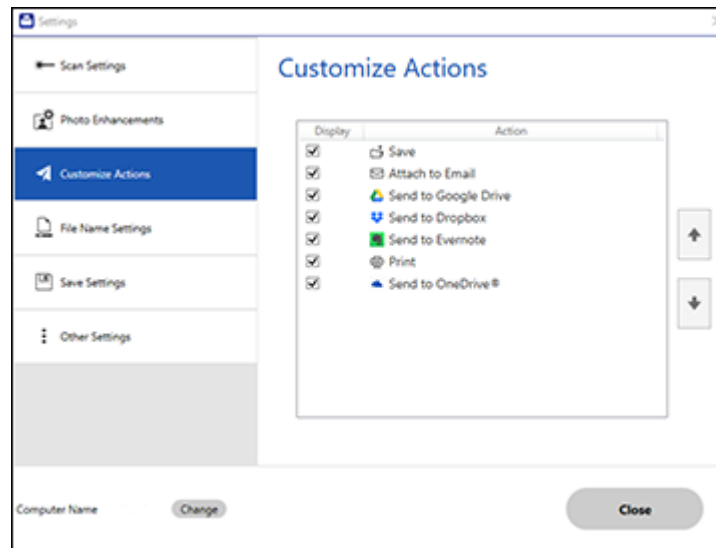

3. Choose which action icons to display by selecting or deselecting each checkbox. Click the arrow icons to move the icons up or down in the display order you want.
4. Click **Close**.

Parent topic: [Selecting Epson ScanSmart Settings](#)

Scan Resolution Guidelines

The resolution setting in your scanning software, measured in dpi (dots per inch), controls the amount of detail captured in your scans. Increasing the resolution raises the amount of detail captured but comes with the following disadvantages:

- Larger file sizes
- It takes longer to scan your originals, send/receive your scans by email or fax, and to print your scans
- The image may become too large to fit on your display or print on paper

If you plan to enlarge a scanned image so you can print it at a larger size, you may need to increase the resolution from the default resolution set by the software. Follow these guidelines to determine the resolution setting you need:

- You will scan the image at its original size but enlarge it later in an image-editing program.

Increase the resolution setting in your scanning software. Increase the resolution by the same amount you will increase the image size to retain a high image quality. For example, if the resolution is 300 dpi (dots per inch) and you will double the image size later, change the resolution setting to 600 dpi.

- You will scan the image at 100% or smaller size.

Select the resolution setting based on how you will use the scanned image:

- Email/view on a computer screen/post on the web: 96 to 200 dpi
- Print/fax/convert to editable text (OCR)/create searchable PDF: 200 to 300 dpi

Parent topic: [Scanning](#)

Related topics

[Selecting Epson ScanSmart Settings](#)

Cleaning and Transporting Your Product

See these sections if you need to clean or transport your product.

[Cleaning Your Scanner](#)

[Transporting Your Scanner](#)

Cleaning Your Scanner

To keep your product working at its best, you should clean it several times a year.

Caution: Do not use a hard brush, alcohol, or paint thinner to clean the product or you may damage it. Do not use oil or other lubricants inside the product or let water get inside it. Do not open the product case. Do not press the surface of the scanner glass with any force and be careful not to scratch or damage the scanner glass. A damaged glass surface can decrease the scan quality.

1. Disconnect the USB cable.
2. Clean the outer case with a cloth dampened with mild detergent and water.
3. If the scanner glass gets dirty, clean it with a soft, dry cloth. If the glass surface is stained with grease or some other hard-to-remove material, use a small amount of glass cleaner on a soft cloth to remove it. Wipe off all remaining liquid.

Note: Do not spray glass cleaner directly on the scanner glass. Make sure that no dust builds up on the surface of the scanner glass. Dust can cause spots in your scanned images.

4. If the document mat is dirty, dampen a soft cloth with mild detergent and water, wring it out thoroughly, and then wipe off any remaining stains. After that, use a soft dry cloth to wipe the mat.

Parent topic: [Cleaning and Transporting Your Product](#)

Transporting Your Scanner

If you need to ship your product, transport it a long distance, or store it for an extended period, prepare it for transportation as described here.

1. Make sure the carriage is in the home position on the upper side of the scanner. If the carriage is not in the home position, turn on the scanner by opening the scanner software and wait until the carriage moves to the home position.

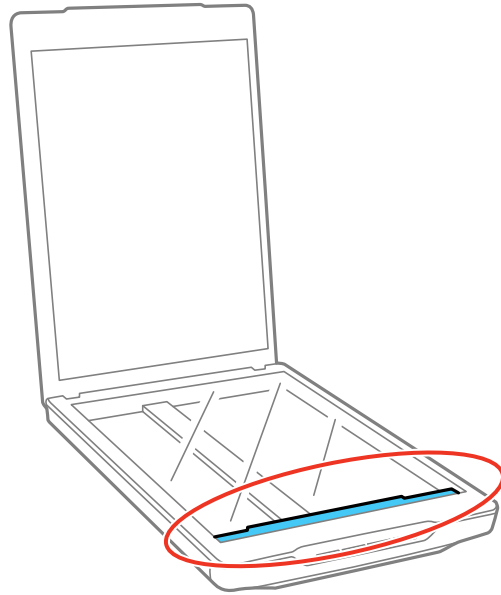

2. Disconnect the USB cable.
3. Place the scanner in its original packing materials if possible, or use equivalent materials with cushioning around the scanner.

Caution: Avoid turning the scanner upside down when transporting. If the scanner is not packed correctly, vibrations and shocks during transport may damage the scanner.

Parent topic: [Cleaning and Transporting Your Product](#)

Solving Problems

Check these sections for solutions to problems you may have using your product.

[Scanner Light Status](#)

[Solving Scanning Problems](#)

[Solving Scanned Image Quality Problems](#)

[Where to Get Help \(U.S. and Canada\)](#)

[Where to Get Help \(Latin America\)](#)

Scanner Light Status

You can often diagnose problems with your scanner by checking the status light.

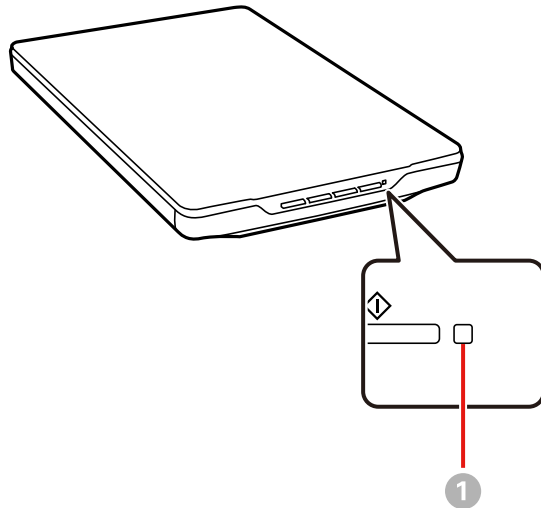

1 The status light

Light status	Condition/solution
On	The scanner is turned on and ready to scan.

Light status	Condition/solution
Flashing (1 second intervals)	The scanner is scanning or initializing. Wait for the status light to stop flashing before turning off the scanner.
Flashing rapidly (0.5 second intervals)	An error has occurred. Try the following: <ul style="list-style-type: none"> • Check the scanner connection to your computer to make sure it is secure. • Make sure your scanning software is installed correctly. • If the status light is still flashing, close any scanner software and unplug the scanner from the computer's USB port. Plug the scanner into the USB port again and open the scanning software.
Off	The scanner is turned off.

Parent topic: [Solving Problems](#)

Solving Scanning Problems

Check these solutions if you have problems scanning with your product.

[Scanner Does Not Turn On or Turns Off Unexpectedly](#)

[Scanner Buttons Do Not Work as Expected](#)

[Cannot Start Epson ScanSmart](#)

[Scanning is Slow](#)

Parent topic: [Solving Problems](#)

Scanner Does Not Turn On or Turns Off Unexpectedly

If the scanner does not turn on or if it turns off unexpectedly, try these solutions:

- Make sure the USB cable is securely connected to the computer.
- Connect the scanner directly to the computer. The scanner may not work properly when connected through a USB hub.
- Use the USB cable that came with the scanner.
- Wait a few seconds for the scanner to turn on and the status light to stop flashing. When the status light stops flashing, it indicates that the scanner is ready to scan.
- Make sure Epson ScanSmart and Epson Scan 2 are installed correctly.

- If you are using any TWAIN-complaint applications, make sure that the correct product is selected as the **Scanner** or **Source** setting.
- If the scanner continues to not turn on or turns off unexpectedly, uninstall and then re-install Epson Scan 2.

Parent topic: [Solving Scanning Problems](#)

Related tasks

[Uninstalling Product Software - Windows](#)

[Uninstalling Product Software - Mac](#)

Scanner Buttons Do Not Work as Expected

If the scanner buttons do not start the correct program or perform the correct action, try these solutions:

- Make sure Epson ScanSmart and Epson Scan 2 are installed correctly. If necessary, uninstall and reinstall the software.

Parent topic: [Solving Scanning Problems](#)

Related tasks

[Uninstalling Product Software - Windows](#)

[Uninstalling Product Software - Mac](#)

Cannot Start Epson ScanSmart

If you cannot start Epson ScanSmart, try these solutions:

- Make sure your scanner is turned on and any interface cables are securely connected at both ends.
- Use the USB cable that came with the scanner.
- Wait until the status light stops flashing, indicating that the scanner is ready to scan.
- If you connected the scanner using a USB cable, make sure it is connected directly to your computer or through only one USB hub.
- If you are using a TWAIN-compliant program, make sure that the correct product is selected as the **Scanner** or **Source** setting.

Parent topic: [Solving Scanning Problems](#)

Scanning is Slow

If scanning becomes slow, try these solutions:

- Scan your original at a lower resolution, if possible.

- Make sure your system meets the requirements for your operating system. If you are scanning a high-resolution image, you may need more than the minimum requirements. If necessary, increase your system's memory or reduce the resolution.
- Make sure the scanner is plugged into a USB 2.0 or higher port.

Parent topic: [Solving Scanning Problems](#)

Solving Scanned Image Quality Problems

Check these sections if a scanned image on your computer screen has a quality problem.

[Uneven Colors, Dirt and Spots Appear in Your Scanned Image](#)

[The Image Quality is Rough](#)

[Spots or Lines Appear in All Scanned Images](#)

[Straight Lines in an Image Appear Crooked](#)

[Text or Images are Blurry](#)

[Image Colors are Patchy at the Edges](#)

[Back of Original Image Appears in Scanned Image](#)

[Ripple Patterns Appear in an Image](#)

[Cannot Scan the Correct Area](#)

[Cannot Scan Multiple Photos at the Same Time](#)

[Image is Scanned Upside-Down](#)

[Characters are not Recognized Correctly](#)

[Binding Margins of a Booklet are Distorted or Blurred](#)

[Cannot Solve Problems in the Scanned Image](#)

[Checking Your Applications](#)

[Uninstall Your Product Software](#)

Parent topic: [Solving Problems](#)

Uneven Colors, Dirt and Spots Appear in Your Scanned Image

- Clean the scanner glass.
- Remove any trash or dirt that adheres to the original.
- Do not press on the glass or the document cover with too much force or it may damage the scanner. If you press with too much force, blurring, smudges, and spots may occur.

Parent topic: [Solving Scanned Image Quality Problems](#)

The Image Quality is Rough

- Set the Epson ScanSmart mode according to the original you want to scan. To scan documents, use the **Document Mode** settings. For scanning photos, use the **Photo Mode** settings.
- When you are using **Document Mode** or **Photo Mode** in Epson ScanSmart, use the image quality adjustment features on the **Advanced Settings** tab on the Scan Settings screen.
- If the resolution is low, try increasing the resolution and then scanning.
- The scanned image quality may differ from the original you scanned.

Parent topic: [Solving Scanned Image Quality Problems](#)

Spots or Lines Appear in All Scanned Images

If spots or lines appear in all your scanned images, try these solutions:

- Clean the scanner glass and document mat.
- Remove any dust from the scanned image.
- If lines or spots continue, contact Epson Support.

Parent topic: [Solving Scanned Image Quality Problems](#)

Straight Lines in an Image Appear Crooked

If straight lines in an original appear crooked in a scanned image, try these solutions:

- Make sure to place your original straight when you scan it.

Parent topic: [Solving Scanned Image Quality Problems](#)

Text or Images are Blurry

If a scanned image appears distorted or blurry, try these solutions:

- Make sure your original is not wrinkled or warped. This may prevent the original from laying flat when passing over the scanner sensors.
- Do not move your original or your scanner during scanning.
- Your product will not operate properly while tilted at an angle. Place your product on a flat, stable surface that extends beyond its base in all directions.
- When using **Document Mode** or **Photo Mode** in Epson ScanSmart, change the **Resolution** on the **Main Settings** tab on the Scan Settings screen, and then scan again.

- When using **Document Mode** in Epson ScanSmart, select **Text Enhancement** under **Image Option** on the **Advanced Settings** tab on the Scan Settings screen.
 - Depending on the condition of your scanned image, click **Settings** and try setting a lower level for **Edge Enhancement** or a higher level for **Noise Reduction Level**.
- If scanning in JPEG format, try changing the compression level.

Parent topic: [Solving Scanned Image Quality Problems](#)

Image Colors are Patchy at the Edges

If you are scanning a thick or warped original, cover its edges with paper to block external light as you scan it.

Parent topic: [Solving Scanned Image Quality Problems](#)

Back of Original Image Appears in Scanned Image

- For thin originals, place the original on the scanner glass and then cover it with a piece of black paper.
- When using **Document Mode** or **Photo Mode** in Epson ScanSmart, adjust the **Brightness** on the **Advanced Settings** tab on the Scan Settings screen.
- This feature may not be available depending on the settings on the **Main Settings > Image Type** or the settings on the **Advanced Settings** tab.
- When using Document Mode in Epson ScanSmart, select **Text Enhancement** under **Image Option** on the **Advanced Settings** tab on the Scan Settings screen.

Parent topic: [Solving Scanned Image Quality Problems](#)

Ripple Patterns Appear in an Image

You may see a ripple pattern (called a moiré) in scanned images. Try adjusting these settings and scanning again:

- When using Document mode or Photo Mode in Epson ScanSmart, enable **Descreening** on the **Advanced Settings** tab on the Scan Settings screen.
- When using Document mode or Photo Mode in Epson ScanSmart, change the **Resolution** on the **Main Settings** tab on the Scan Settings screen, and scan again.

Parent topic: [Solving Scanned Image Quality Problems](#)

Cannot Scan the Correct Area

- Make sure the original is placed correctly against the arrow marks in the corners.

- Move the originals about 0.1 in (2.5 mm) away from the horizontal and vertical edges of the scanner glass to avoid cropping.
- Do not use the scanner stand, and place the base of the scanner directly on a flat, stable surface.
- Depending on the original, automatic cropping according to the size may not work correctly. Set the original size manually using Document Mode in Epson ScanSmart. Select **Settings > Scan Settings > Document Mode**. Click **Custom Settings**, and then select the size of the original in **Main Settings > Document Size**.

Parent topic: [Solving Scanned Image Quality Problems](#)

Cannot Scan Multiple Photos at the Same Time

- When placing multiple originals on the scanner glass, make sure there is a gap of at least 0.80 inch (20 mm) between the originals. Also, place the original approximately 0.24 inch (6 mm) away from the edges of the scanner glass.
- Check that the original is placed straight.
- Depending on the originals, you may not be able to scan multiple originals at the same time. Scan each original one at a time.

Parent topic: [Solving Scanned Image Quality Problems](#)

Image is Scanned Upside-Down

- Small photos are not rotated automatically.
- Photos for which the top and bottom cannot be detected are not rotated automatically. Rotate them manually by using the **Rotate Right** feature in Epson ScanSmart.

Parent topic: [Solving Scanned Image Quality Problems](#)

Characters are not Recognized Correctly

Check the following to increase the recognition rate of OCR (Optical Character Recognition).

- Check that the original is placed straight.
- Use an original with clear text. Text recognition may decline for the following types of originals:
 - Originals that have been copied several times.
 - Originals received by fax (low resolution).
 - Originals where the letter spacing or line spacing is too small.
 - Originals with ruled lines or underlined text.

- Originals with handwritten text.
- Originals with creases or wrinkles.
- Paper types made of thermal paper, such as receipts, may deteriorate due to age or friction. Scan them as soon as possible.
- When saving as **Searchable PDF** files, check that the correct languages are selected. Check the **Language** in each Save Setting window.

Note: You need the Epson Scan OCR Component to save as a Searchable PDF. When you set up the scanner using the installer, this is installed automatically.

Parent topic: [Solving Scanned Image Quality Problems](#)

Binding Margins of a Booklet are Distorted or Blurred

When scanning a booklet on the scanner glass, characters may appear distorted or blurred on the binding margin. If this problem occurs, text is not recognized correctly when you save the scanned image as a **Searchable PDF**. To decrease distortion or blurring on the binding margin, gently press down the document cover and hold it down while scanning to flatten the booklet. Make sure you do not move the booklet while scanning.

Caution: Do not press the document cover with too much force. Otherwise, the booklet or the scanner may be damaged.



Parent topic: [Solving Scanned Image Quality Problems](#)

Cannot Solve Problems in the Scanned Image

If you have tried all of the solutions and have not solved the problem, initialize the scanner driver (Epson Scan 2) settings using Epson Scan 2 Utility.

Note: Epson Scan 2 Utility is one of the applications supplied with the scanner software.

1. Start Epson Scan 2 Utility

- **Windows 11:** Click , then select **All apps > EPSON > Epson Scan 2 Utility**.
- **Windows 10:** Click , and select **EPSON > Epson Scan 2 Utility**.
- **Windows 8.x:** Enter the application name in the search charm, and then select the displayed icon.

- **Windows 7:** Click the start button, and then select **All Programs** or **Programs > EPSON > Epson Scan 2 > Epson Scan 2 Utility**.
 - **Mac OS:** Select **Go > Applications > Epson Software > Epson Scan 2 Utility**.
2. Select the **Other** tab.
 3. Click **Reset**.

Note: If initialization does not solve the problem, uninstall and re-install the scanner driver (Epson Scan 2).

Parent topic: [Solving Scanned Image Quality Problems](#)

Checking Your Applications

To use the functions described in this *User's Guide*, you need to install the following applications.

- Epson ScanSmart
- Scanner driver (Epson Scan 2)
- EPSON Software Updater
- **Note:** When you set up the scanner using the installer, the scanner driver (Epson Scan 2) is automatically installed.



[Checking Your Applications for Windows](#)

[Checking Your Applications for Mac OS](#)

[Updating Applications and Firmware](#)

Parent topic: [Solving Scanned Image Quality Problems](#)

Checking Your Applications for Windows

1. Open the Control Panel:
 - **Windows 11:** Click , then select **All apps > Windows Tools > Control Panel**.
 - **Windows 10:** Click , then select **Windows System > Control Panel**.
 - **Windows 8.x:** Select **Desktop > Settings > Control Panel**.
 - **Windows 7:** Click the start button, and then select **Control Panel**.
2. Select **Uninstall a program** in **Programs**.
3. Check the list of currently installed applications.

Parent topic: [Checking Your Applications](#)

Checking Your Applications for Mac OS



1. Select **Go > Applications > Epson Software**.
2. Check the list of currently installed applications.

Parent topic: [Checking Your Applications](#)

Updating Applications and Firmware

You may be able to clear certain problems and improve or add functions by updating the applications and the firmware. Make sure you use the latest version of the applications and firmware.

Caution: Do not turn off the computer or the scanner while updating.

1. Make sure that the scanner and the computer are connected, and that the computer is connected to the internet.
2. Start **EPSON Software Updater** and update the applications or the firmware.
 - **Windows 11:** Click , then select **All apps > Epson Software > EPSON Software Updater**.
 - **Windows 10:** Click , then select **Epson Software > EPSON Software Updater**.
 - **Windows 8.x:** Enter the application name in the search charm, and then select the displayed icon.
 - **Windows 7:** Click the start button, and then select **All Programs** or **Programs > Epson Software > EPSON Software Updater**.
 - **Mac OS:** Select **Finder > Go > Applications > Epson Software > EPSON Software Updater**.

Note: If you cannot find the application you want to update in the list, you cannot update the application using the EPSON Software Updater. Check for the latest versions of the applications on the Epson support website.

Parent topic: [Checking Your Applications](#)

Uninstall Your Product Software

If you have a problem that requires you to uninstall and re-install your software, follow the instructions for your operating system.



[Uninstalling Product Software - Windows](#)

[Uninstalling Product Software - Mac](#)

Parent topic: [Solving Scanned Image Quality Problems](#)

Uninstalling Product Software - Windows

You can uninstall and then re-install your product software to solve certain problems.

1. Exit all applications currently running on your computer.
2. Turn off the product.
3. Disconnect any interface cables.
4. Do the following to uninstall each of your scanning software programs and follow any on-screen instructions:
 - **Windows 11:** Click , then search for **Settings** and select it. Select **Apps** or **System > Apps & features**. Then select the program you want to uninstall and select **Uninstall**.
 - **Windows 10:** Click  and select  (Settings) > **Apps > Apps & features**. Select the product software program and click **Uninstall**.
 - **Windows 8.x:** Navigate to the **Apps** screen and select **Control Panel > Programs > Programs and Features**. Select the product software program and click **Uninstall/Change**.
 - **Windows 7:** Open the Windows **Control Panel** utility. Select **Programs and Features**. (In Classic view, select **Programs** and click **Uninstall a program**.) Select the product software program and click **Uninstall/Change**.
5. Restart your computer, then see the *Start Here* sheet to re-install your software.

Note: If you find that re-installing your product software does not solve a problem, contact Epson.

Parent topic: [Uninstall Your Product Software](#)

Uninstalling Product Software - Mac

In most cases, you do not need to uninstall your product software before re-installing it. However, you can download the Uninstaller utility from the Epson support website to uninstall your product software as described here.

1. To download the Uninstaller utility, visit epson.com/support (U.S.), epson.ca/support (Canada), or latin.epson.com/support (Caribbean) and select your product.
2. Follow the instructions on the screen to install the Uninstaller utility.
3. Quit all applications currently running on your Mac.
4. Double-click the **Uninstaller** icon.

5. In the Epson Uninstaller screen, select the checkbox for each software program you want to uninstall.
6. Click **Uninstall**.
7. Follow the on-screen instructions to uninstall the software.
8. To reinstall your product software, see the *Start Here* sheet for instructions.

Note: The Uninstaller removes all drivers for Epson scanners on the computer. If you use multiple Epson scanners and you only want to delete some of the drivers, delete all of them first, and then install the necessary scanner drivers again.

Note: If you find that re-installing your product software does not solve a problem, contact Epson. If you cannot find the application you want to uninstall in the application list, you cannot uninstall using the Uninstaller. In this situation, select **Go > Applications > Epson Software**, select the application you want to uninstall, and then drag it to the trash icon.

Parent topic: [Uninstall Your Product Software](#)

Where to Get Help (U.S. and Canada)

If you need to contact Epson for technical support services, use the following support options.

Internet Support

Visit Epson's support website at epson.com/support (U.S.) or epson.ca/support (Canada) and select your product for solutions to common problems with your product. You can download utilities and documentation, get FAQs and troubleshooting advice, or e-mail Epson with your questions.

Speak to a Support Representative

Before you call Epson for support, please have the following information ready:

- Product name
- Product serial number (located on a label on the product)
- Proof of purchase (such as a store receipt) and date of purchase
- Computer configuration
- Description of the problem

Then call:

- U.S.: (562) 276-4382, 7 AM to 4 PM, Pacific Time, Monday through Friday

- Canada: (905) 709-3839, 7 AM to 4 PM, Pacific Time, Monday through Friday

Days and hours of support are subject to change without notice. Toll or long distance charges may apply.

Note: For help using any other software on your system, see the documentation for that software for technical support.

Purchase Supplies and Accessories

You can purchase genuine Epson accessories at epson.com (U.S. sales) or epson.ca (Canadian sales). You can also purchase accessories from an Epson authorized reseller. To find the nearest one, call 800-GO-EPSON (800-463-7766) in the U.S. or 800-807-7766 in Canada.

Parent topic: [Solving Problems](#)

Where to Get Help (Latin America)

If you need to contact Epson for technical support services, use the following support options.

Internet Support

Visit Epson's support website at latin.epson.com/support and select your product for solutions to common problems with your product. You can download utilities and documentation, get FAQs and troubleshooting advice, or e-mail Epson with your questions.

Speak to a Support Representative

Before you call Epson for support, please have the following information ready:

- Product name
- Product serial number (located on a label on the product)
- Proof of purchase (such as a store receipt) and date of purchase
- Computer configuration
- Description of the problem

Then call:

Country	Telephone
Argentina	(54 11) 5167-0300 0800-288-37766

Country	Telephone
Bolivia*	800-100-116
Brazil	State capitals and metropolitan areas: 3004-6627 Other areas: 0800-377-6627 / 0800-EPSONBR
Chile	(56 2) 2484-3400
Colombia	Bogota: (57 1) 602-4751 Other cities: 01-8000-915235
Costa Rica	800-377-6627
Dominican Republic*	1-888-760-0068
Ecuador*	1-800-000-044
El Salvador*	800-6570
Guatemala*	1-800-835-0358
Mexico	Mexico City: (52 55) 1323-2052 Other cities: 01-800-087-1080
Nicaragua*	00-1-800-226-0368
Panama*	00-800-052-1376
Paraguay	009-800-521-0019
Peru	Lima: (51 1) 418-0210 Other cities: 0800-10126
Uruguay	00040-5210067
Venezuela	(58 212) 240-1111

* Contact your local phone company to call this toll-free number from a mobile phone.

If your country does not appear in the list, contact the sales office in the nearest country. Toll or long distance charges may apply.

Note: For help using any other software on your system, see the documentation for that software for technical support.

Purchase Supplies and Accessories

You can purchase genuine Epson accessories from an Epson authorized reseller. To find the nearest reseller, visit latin.epson.com or call your nearest Epson sales office.

Parent topic: [Solving Problems](#)

Technical Specifications

These sections list the technical specifications for your product.

Note: Epson offers a recycling program for end of life Epson products. Please go to [this site](#) (U.S.) or [this site](#) (Canada) for information on how to return your Epson products for proper disposal.

[Windows System Requirements](#)

[Mac System Requirements](#)

[General Specifications](#)

[Dimension Specifications](#)

[Electrical Specifications](#)

[Environmental Specifications](#)

[USB Interface Specifications](#)

[Safety and Approvals Specifications](#)

Windows System Requirements

Make sure your system meets these requirements before using it with your scanner.

System	Microsoft Windows 11, Windows 10, Windows 8.x, Windows 7
Interface	USB 2.0 (Type-B standard connector)

Parent topic: [Technical Specifications](#)

Mac System Requirements

Make sure your system meets these requirements before using it with your scanner.

System	OS X 10.11 or later, macOS 11 or later (Fast user switching on OS X is not supported.)
Interface	Macintosh USB

Note: Epson Scan does not support the UNIX File System (UFS) for OS X. Install Epson Scan on a disk or in a partition that does not use UFS.

Parent topic: [Technical Specifications](#)

General Specifications

Scanner type	Flatbed, color
Photoelectric device	CIS
Effective pixels	40800 × 56160 pixels at 4800 dpi Scanning area may be restricted if resolution setting is large.
Document size	Maximum: 8.5 × 11.7 inches (216 × 297 mm); US letter or A4
Scanning resolution	4800 dpi (main scan) 4800 dpi (sub scan)
Output resolution	50 to 4800, 7200, and 9600 dpi (50 to 4800 dpi in 1 dpi increments)
Image data	16 bits per pixel per color internal 8 bits per pixel per color external
Interface	One Hi-Speed USB port
Light source	LED

Parent topic: [Technical Specifications](#)

Dimension Specifications

Height	1.6 inches (39 mm)
Width	9.9 inches (249 mm)
Depth	14.4 inches (364 mm)
Weight	3.1 lb (1.4 kg)

Parent topic: [Technical Specifications](#)

Electrical Specifications

Note: Check the label on the scanner for voltage information.

Power supply	USB bus power
Rated input voltage	DC 5 V
Rated input current	0.5 A
Power consumption	Operating: 2.5 W Ready mode: 1.1 W Power off mode: 0.0125 W

Parent topic: [Technical Specifications](#)

Environmental Specifications

Temperature	Operating: 50 to 95 °F (10 to 35 °C) Storage: -4 to 140 °F (-20 to 60 °C)
Humidity (non-condensing)	Operating: 20 to 80% RH Storage: 20 to 80% RH
Operating conditions	Ordinary office or home conditions

Note: Avoid operating the scanner in direct sunlight, near a strong light source, or in extremely dusty conditions.

Parent topic: [Technical Specifications](#)

USB Interface Specifications

Interface type	Universal Serial Bus Specifications Revision 2.0
Electrical standard	Full Speed mode (12 Mbits per second) and Hi-Speed mode (480 Mbits per second) of Universal Serial Bus Specifications Revision 2.0
Connector type	One Micro-B port

Parent topic: [Technical Specifications](#)

Safety and Approvals Specifications

United States

EMC: FCC part 15 Subpart B class B

Canada

EMC: CAN/CSA-CEI/IEC CISPR 22 Class B

Parent topic: [Technical Specifications](#)

Notices

Check these sections for important notices about your product.

Note: Epson offers a recycling program for end of life Epson products. Please go to [this site](#) (U.S.) or [this site](#) (Canada) for information on how to return your Epson products for proper disposal.

[Important Safety Instructions](#)

[Default Delay Times for Power Management for Epson Products](#)

[Restrictions on Copying](#)

[Trademarks](#)

[Copyright Notice](#)

Important Safety Instructions

Follow these safety instructions when setting up and using the product.

- Read all these instructions, and follow all warnings and instructions marked on the product.
- Place the product close enough to the computer for the interface cable to reach it easily. Do not place or store the product outdoors, near excessive dirt or dust, water, heat sources, or in locations subject to shocks, vibrations, high temperature or humidity, direct sunlight, strong light sources, or rapid changes in temperature or humidity.
- Do not use with wet hands.
- When connecting this product to a computer or other device with a cable, ensure the correct orientation of the connectors. Each connector has only one correct orientation. Inserting a connector in the wrong orientation may damage both devices connected by the cable.
- Do not insert objects into any opening as they may touch dangerous voltage points or short out parts. Beware of electrical shock hazards.
- Place the product on a flat, stable surface that extends beyond the base of the product in all directions. If you place the product by the wall, leave at least 3.9 inches (10 cm) between the back of the product and the wall.
- After replacing consumable parts, dispose of them correctly following the rules of your local authority. Do not disassemble them.
- Do not place or store the product outdoors, in a car, near excessive dirt or dust, water, heat sources, or in locations subject to shocks, vibrations, condensation, high temperature or humidity, direct sunlight, strong light sources, or rapid changes in temperature or humidity.

- Never disassemble, modify, or attempt to repair the product or a product option by yourself except as specifically explained in this guide.

Warning: The cords included with this product contain chemicals, including lead, known to the State of California to cause birth defects or other reproductive harm. **Wash hands after handling.** (This notice is provided in accordance with Proposition 65 in Cal. Health & Safety Code § 25249.5 and following.)

USB

- The USB cable should be placed to avoid abrasions, cuts, fraying, crimping, and kinking.
- Do not place objects on top of the USB cable and do not allow the cable to be stepped on or run over. Be particularly careful to keep the USB cable straight at the end.
- If you are not going to use the product for a long period, unplug the USB cable from the computer.
- Unplug the product and the USB cable, and refer servicing to qualified service personnel under the following conditions: Liquid has entered the product; the product has been dropped or the case has been damaged; the product does not operate normally or exhibits a distinct change in performance. (Do not adjust controls that are not covered by the operating instructions.)

Parent topic: [Notices](#)

Default Delay Times for Power Management for Epson Products

This product will enter sleep mode after a period of nonuse. The time interval has been set at the factory to ensure that the product meets Energy Star standards of energy efficiency, and cannot be modified by the consumer.

Parent topic: [Notices](#)

Restrictions on Copying

Observe the following restrictions to ensure responsible and legal use of your scanner.

Copying of the following items is prohibited by law:

- Bank bills, coins, government-issued marketable securities, government bond securities, and municipal securities
- Unused postage stamps, pre-stamped postcards, and other official postal items bearing valid postage
- Government-issued revenue stamps, and securities issued according to legal procedure

Exercise caution when copying the following items:

- Private marketable securities (stock certificates, negotiable notes, checks, etc.), monthly passes, concession tickets, etc.
- Passports, driver's licenses, warrants of fitness, road passes, food stamps, tickets, etc.

Note: Copying these items may also be prohibited by law.

Responsible use of Copyright Materials

Products can be misused by improperly copying copyrighted materials. Unless acting on the advice of a knowledgeable attorney, be responsible and respectful by obtaining the permission of the copyright holder before copying published material.

Parent topic: [Notices](#)

Trademarks

EPSON® and Perfection® are registered trademarks and the EPSON logo is a registered logomark of Seiko Epson Corporation.

Mac, macOS, and OS X are trademarks of Apple Inc., registered in the U.S. and other countries.

Google Drive is a trademarks of Google LLC.

Microsoft and Windows are trademarks of the Microsoft group of companies..

General Notice: Other product names used herein are for identification purposes only and may be trademarks of their respective owners. Epson disclaims any and all rights in those marks.

The EPSON logo is displayed in a bold, blue, sans-serif font. The letters are all uppercase and have a consistent thickness. A small registered trademark symbol (®) is located at the top right of the letter 'N'.

Parent topic: [Notices](#)

Copyright Notice

All rights reserved. No part of this publication may be reproduced, stored in a retrieval system, or transmitted in any form or by any means, electronic, mechanical, photocopying, recording, or otherwise, without the prior written permission of Seiko Epson Corporation. The information contained herein is designed only for use with this Epson product. Epson is not responsible for any use of this information as applied to other products.

Neither Seiko Epson Corporation nor its affiliates shall be liable to the purchaser of this product or third parties for damages, losses, costs, or expenses incurred by purchaser or third parties as a result of:

accident, misuse, or abuse of this product or unauthorized modifications, repairs, or alterations to this product, or (excluding the U.S.) failure to strictly comply with Seiko Epson Corporation's operating and maintenance instructions.

Seiko Epson Corporation shall not be liable for any damages or problems arising from the use of any options or any consumable products other than those designated as Original Epson Products or Epson Approved Products by Seiko Epson Corporation.

Seiko Epson Corporation shall not be held liable for any damage resulting from electromagnetic interference that occurs from the use of any interface cables other than those designated as Epson approved Products by Seiko Epson Corporation.

This information is subject to change without notice.

[libTIFF Software Acknowledgment](#)

[A Note Concerning Responsible Use of Copyrighted Materials](#)

[Copyright Attribution](#)

Parent topic: [Notices](#)

libTIFF Software Acknowledgment

Copyright © 1988-1997 Sam Leffler

Copyright © 1991-1997 Silicon Graphics, Inc.

Permission to use, copy, modify, distribute, and sell this software and its documentation for any purpose is hereby granted without fee, provided that (i) the above copyright notices and this permission notice appear in all copies of the software and related documentation, and (ii) the names of Sam Leffler and Silicon Graphics may not be used in any advertising or publicity relating to the software without the specific, prior written permission of Sam Leffler and Silicon Graphics.

THE SOFTWARE IS PROVIDED "AS-IS" AND WITHOUT WARRANTY OF ANY KIND, EXPRESS, IMPLIED OR OTHERWISE, INCLUDING WITHOUT LIMITATION, ANY WARRANTY OF MERCHANTABILITY OR FITNESS FOR A PARTICULAR PURPOSE.

IN NO EVENT SHALL SAM LEFFLER OR SILICON GRAPHICS BE LIABLE FOR ANY SPECIAL, INCIDENTAL, INDIRECT OR CONSEQUENTIAL DAMAGES OF ANY KIND, OR ANY DAMAGES WHATSOEVER RESULTING FROM LOSS OF USE, DATA OR PROFITS, WHETHER OR NOT ADVISED OF THE POSSIBILITY OF DAMAGE, AND ON ANY THEORY OF LIABILITY, ARISING OUT OF OR IN CONNECTION WITH THE USE OR PERFORMANCE OF THIS SOFTWARE.

Parent topic: [Copyright Notice](#)

A Note Concerning Responsible Use of Copyrighted Materials

Epson encourages each user to be responsible and respectful of the copyright laws when using any Epson product. While some countries' laws permit limited copying or reuse of copyrighted material in certain circumstances, those circumstances may not be as broad as some people assume. Contact your legal advisor for any questions regarding copyright law.

Parent topic: [Copyright Notice](#)

Copyright Attribution

© 2023 Epson America, Inc.

5/23

CPD-62790

Parent topic: [Copyright Notice](#)