



Brenthaven+

Protect+ Case Install Quick Start Guide



⚠ Important!

Start by installing case, once case is on the device, then install the cable-free adapter.

For more detailed instructions and removal, scan the QR code.



1. Remove the frame and screen protector by flexing a case corner down and away.

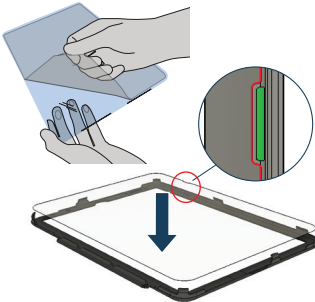

2. Lay the front side of the frame on a flat surface. If not using screen protector, skip to step three(3).

For screen protector installation, remove the packaging film from side one(1) and ensure the notch on the screen protector aligns with the tab on the frame. Remove the packaging film from side two(2).

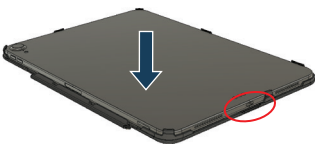

3. Turn the device face down. Snap the frame around the edges of the device. Ensure the port is not covered by the frame.

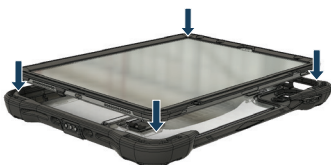

4. Ensure the device port aligns with the bottom port opening on the case. Take the device and align over the case. Evenly press around the perimeter of the case for secure installation.