



Height-Adjustable Rolling Desk with 2 Grommet VESA Mounts

PAD-ARLTD2

INSTRUCTION - MANUAL

CONTENTS:

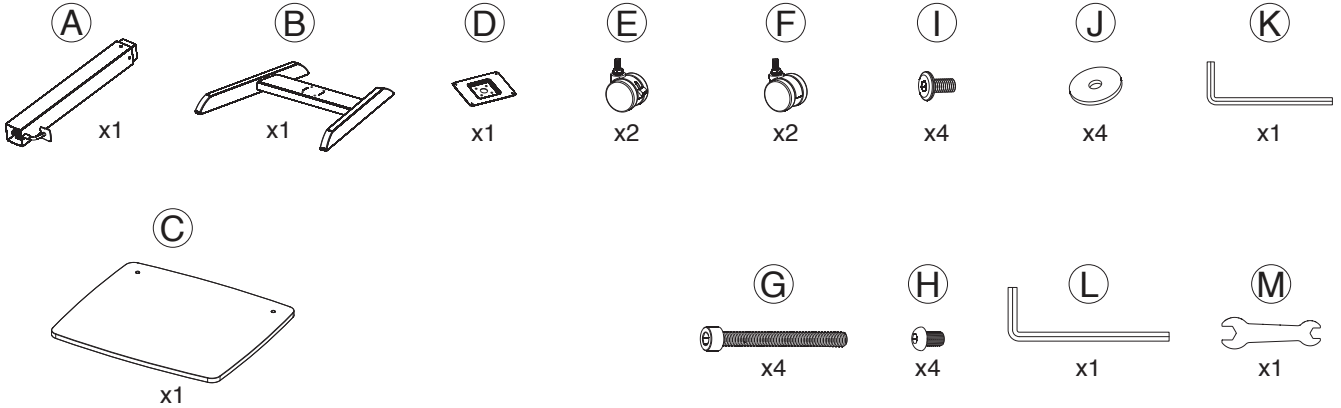

INSTALLATION:

1. Mounting Plate to Workstation Main Pole

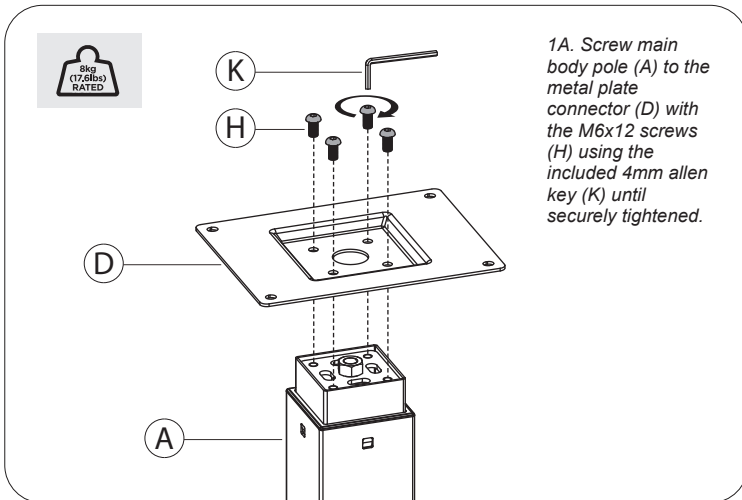

2. Mounting Plate to Underside of Table

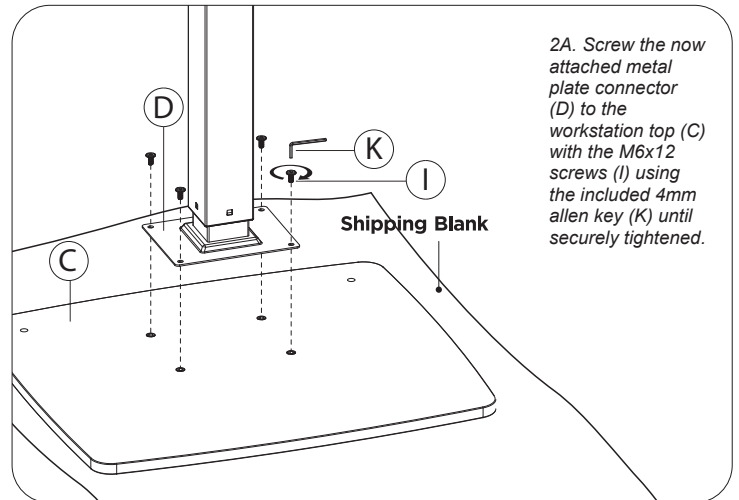

3. Mounting Base with Main Body Pole

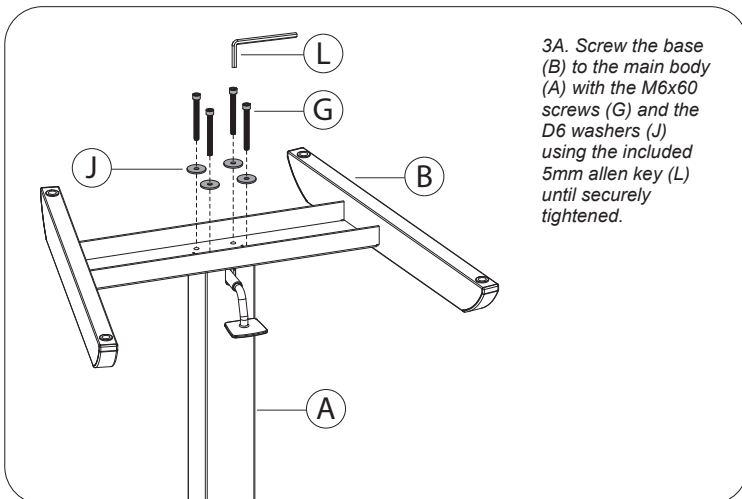

4. Attaching Wheels to Base

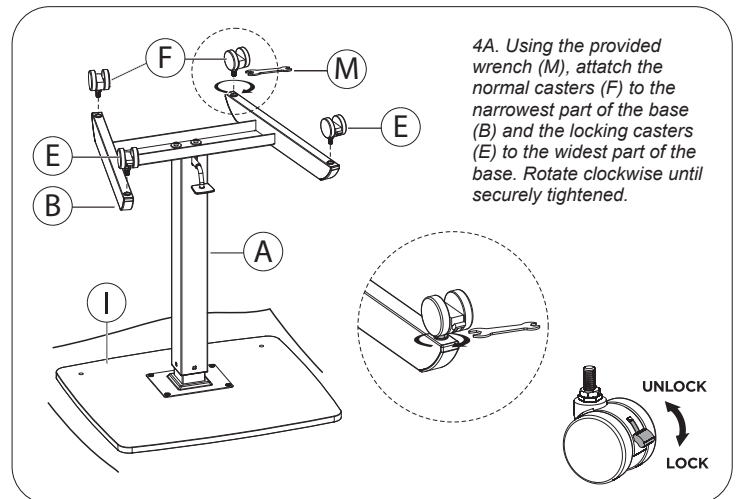

5. Adjusting Workstation Height

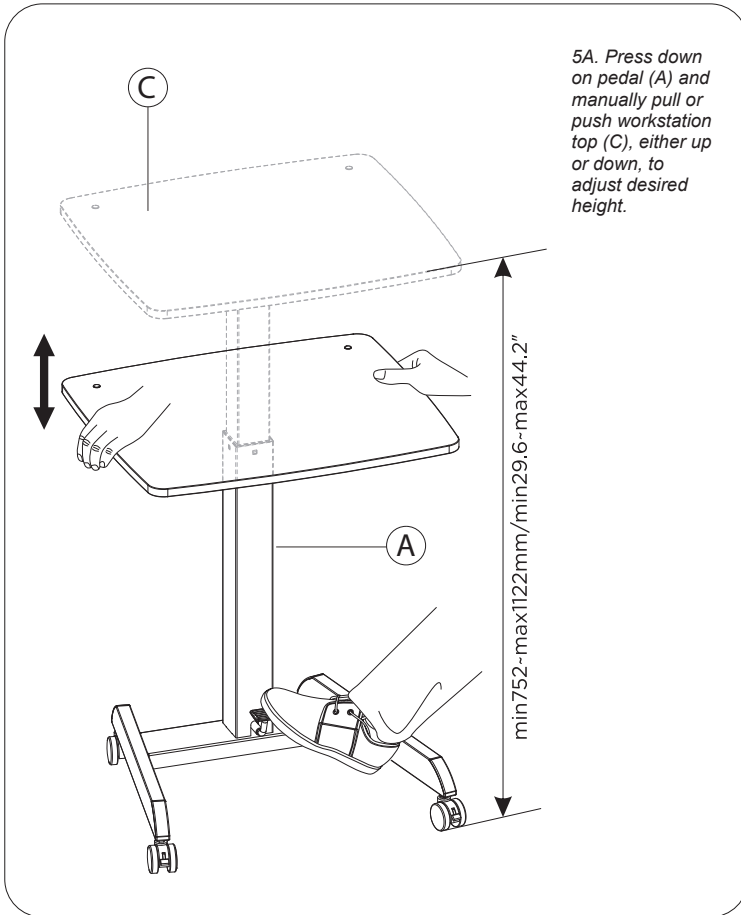

6. Attaching Counterbalance Monitor Arm Component



7. Attaching Articulating Monitor Arm



Caution

Please be sure to fasten all the screws securely before using. Failure to do so may compromise integrity.