



# Digital Password Combination Security Desk Mount w/ Printer Shelf Compartment

PAD-FPDMDC

INSTRUCTION - MANUAL

## CONTENTS:

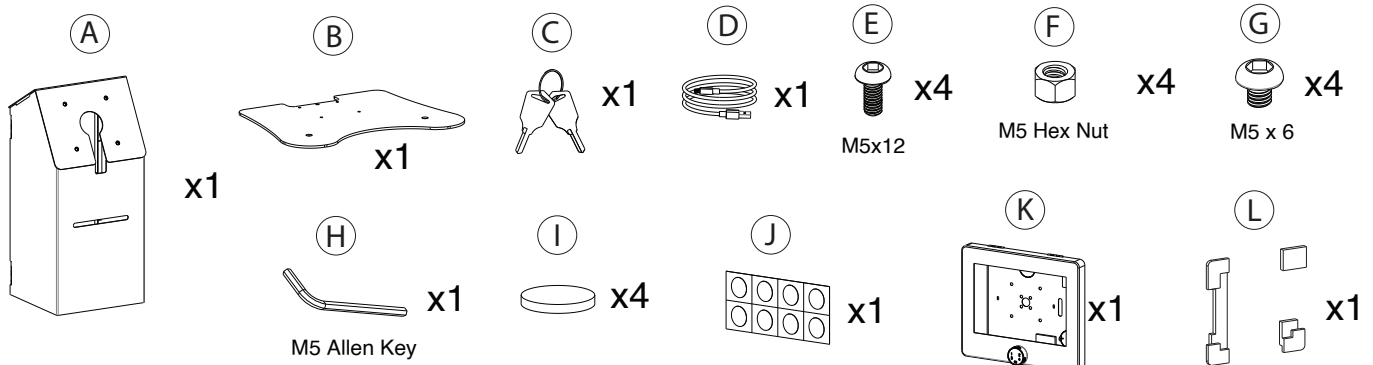

## INSTALLATION:

### 1. Assembling base

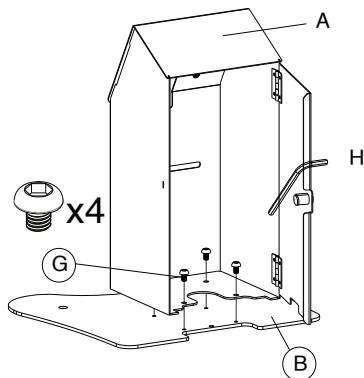

1A. Connect base (B) with body (A). Take the body (A) and align the mounting holes. Rotate in (4) screws (G) with provided allen key (H) until securely tightened.

### 2. Attaching Base Pads

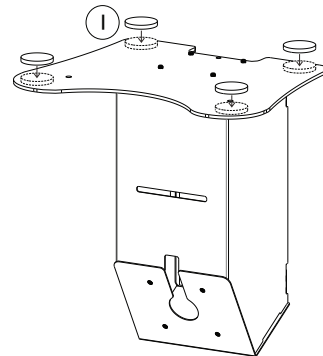

2A. Flip over the now combined base section. Find the base pads (component I) and peel off the sticker to expose the adhesive. Place the foam pads (adhesive face down on base) at the corners and give it a firm press for a few seconds until it's securely attached.

### 3. Attaching Kiosk Body to Enclosure

M5x12  
X4

M5 Hex Nut  
X4

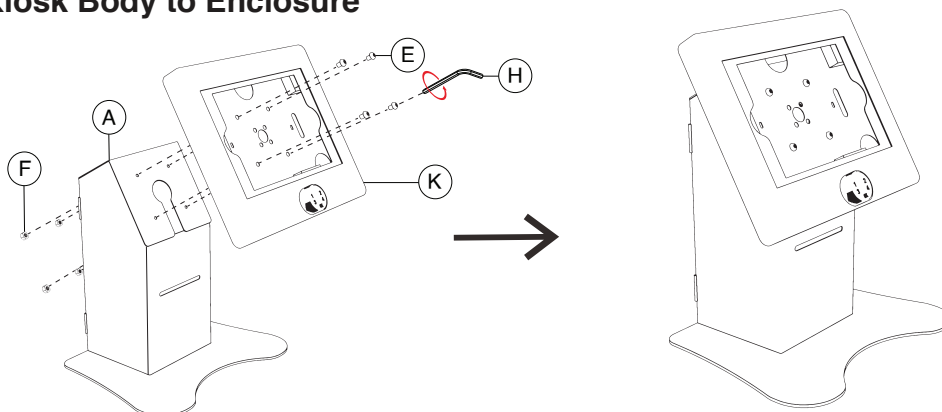

3A. Align VESA holes of the enclosure (K) to the VESA holes of the kiosk body (A). Rotate in screws (E) from above using provided tool (H) while holding hex nuts (F) from behind from within the storage compartment until securely fastened.

## 4. Setting up the Foam Adapters

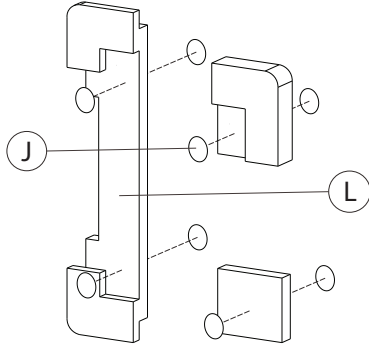

4A. Identify the double sided adhesives (J). Peel away the backing on both sides. Adhesive four of them behind the foam pieces (L) as illustrated. They are to adhere the foam to the enclosure. Peel away the back on the next four and place them on top of the foam pieces as illustrated. These are to attach the foam to the tablets and ensure security.

## 5. Inserting Tablet into Enclosure

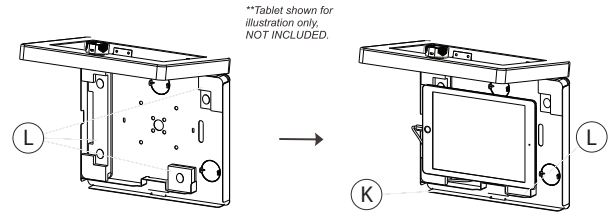

\*\*Tablet shown for illustration only NOT INCLUDED.

5A. With the enclosure open, insert tablet into the foam adapters (L). Make sure the adhesives have been placed ahead of time or tablet will fall out. Plug your tablet into any cables/wires you have routed to the enclosure. After tablet is secure, close the top and lock into place.

## 6. Setting Up Enclosure

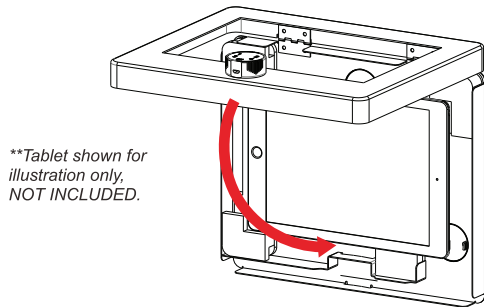

\*\*Tablet shown for illustration only, NOT INCLUDED.

6A. Once tablet is inserted, close the front cover securely.

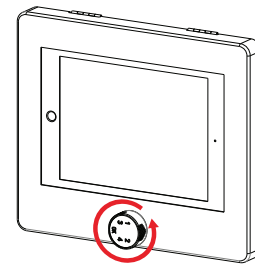

\*\*See following page for digital lock usage and setup

6B. After, turn the digital lock 90 degrees clockwise. This will lock the tablet in place.

## 7. Removing Enclosure Back Opening Covers

\*\*Tablet shown for illustration only, NOT INCLUDED.

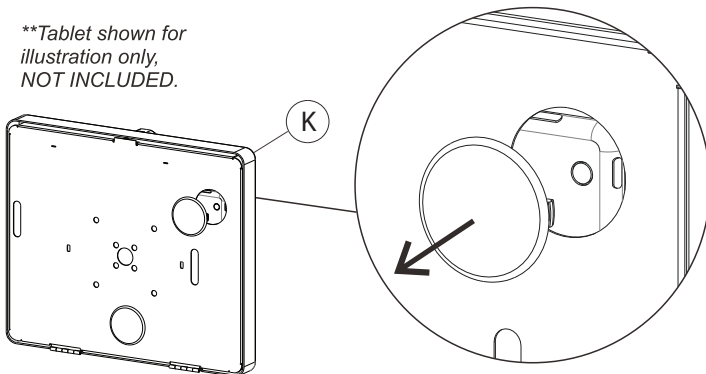

7A. When installing device into the enclosure, identify where the camera is. Simply remove and pop out the cover prior to mounting or setting up tablet to properly expose camera if needed.

## 8. Anti-Theft Deterrent Security

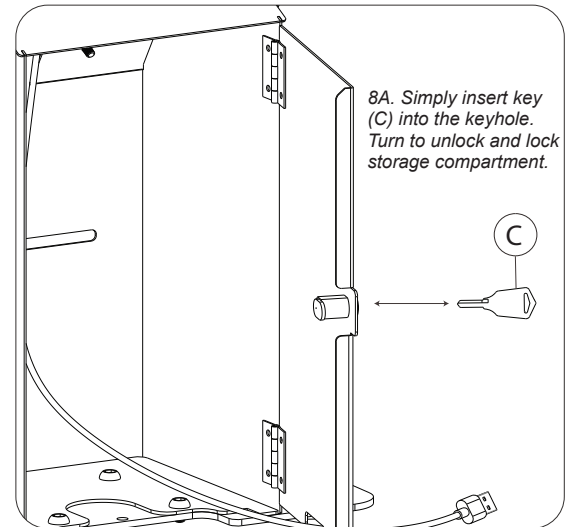

8A. Simply insert key (C) into the keyhole. Turn to unlock and lock storage compartment.

## 9. Charging the Digital Lock

\*\*Tablet shown for illustration only, NOT INCLUDED.

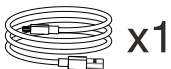

9A. Using the charging cord (D), plug into the port of the digital lock firmly to charge it up.

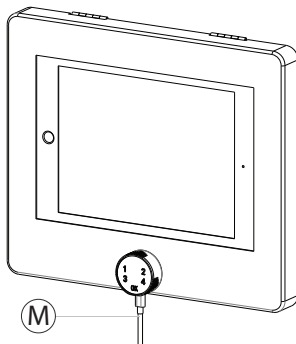

## 10. Cable Routing

10A. Fish the wire through the opening at the top through the kiosk body (A) and out the bottom towards the outlet or wherever it needs to go.

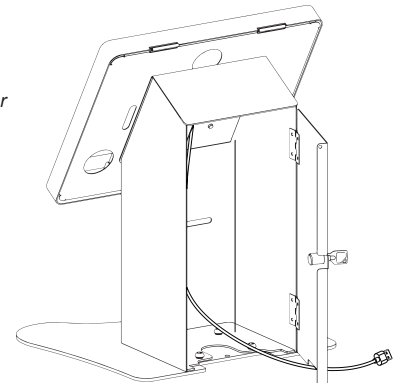



## How to unlock

---

1. Press default password “123”, press “OK”.
2. Green light on about 5 seconds and you hear a long beep means verification passed and it is unlocked. Please turn the lock to unlock within 5 seconds.

*Remark: If you entered wrong password 3 times the system will be locked for 1 minute.*

## Press 1: Change Administrator Password

---

The password should be 3-9 digits, each digits can be any number during 1-4.

1. Press “1”, Press “OK”, when the blue light on and there is a beep, means into setting mode.
2. Verification:  
Enter default password “123”, press “OK” to confirm.  
Blue light flashes and beeps 3 times means verification passed.
3. When the blue light flashes  
Enter new password and press “OK” to confirm.  
Enter new password again and press “OK” to confirm.  
When the green light on and a long beep heard means new password setting is done.
4. Use new password to unlock to test.

*Remark: Please do remember your new Administrator Password. If forgot we don't have other way to get it back and without it factory setting can't be done too.*

## Press 2: Create User Password

---

The password should be 3-9 digits, each digit can be any number during 1-4.

You can add up to 20 user passwords.

1. Press “2”, Press “OK”, when the blue light on and there is a beep, means into setting mode.
2. Verification:  
Enter administrator password, press “OK” to confirm.  
Blue light flashes and beeps 3 times means verification passed.
3. When the blue light flashes  
Enter new password and press “OK” to confirm.  
Enter new password again and press “OK” to confirm.  
When the green light on and a long beep heard means new password setting is done.
4. Use new password to unlock to test.

## Restore Factory Setting

---

1. Press “OK” for about 15 seconds until the red light on (please ignore the blue light).
2. Verification:  
Enter Administrator Password and press “OK” to confirm.  
When the light flashes and a long beep heard means verification passed.

*When complete, all the user's passwords and temporary passwords are invalid and administrator password back to “123” again.*

## Power Instruction

---

1. Low power warning: Red light flashes and beeps 5 times. Please charge the lock.
2. You can unlock when charging by USB cable.