



HMD 27 | HMDC 27 HME 27

27 SERIES HEADSET

Quick Guide
Kurzanleitung
Guide de démarrage rapide
Guía rápida
Instrucciones resumidas
Instruções resumidas
Beknopte gebruiksaanwijzing
Krótka instrukcja obsługi
Snabbguide

Kort vejledning
Pikaohje
Σύντομες οδηγίες
Kısa Kılavuz
Краткая инструкция
快速指南
快速使用指南
クイックガイド
요약 안내서

SENNHEISER



Sennheiser Documentation App



or online at
www.sennheiser.com/download
27 SERIES HEADSET

Sennheiser electronic GmbH & Co. KG

Am Labor 1, 30900 Wedemark, Germany
www.sennheiser.com

Printed in Germany, Publ. 07/22, 592848/A01

In the box

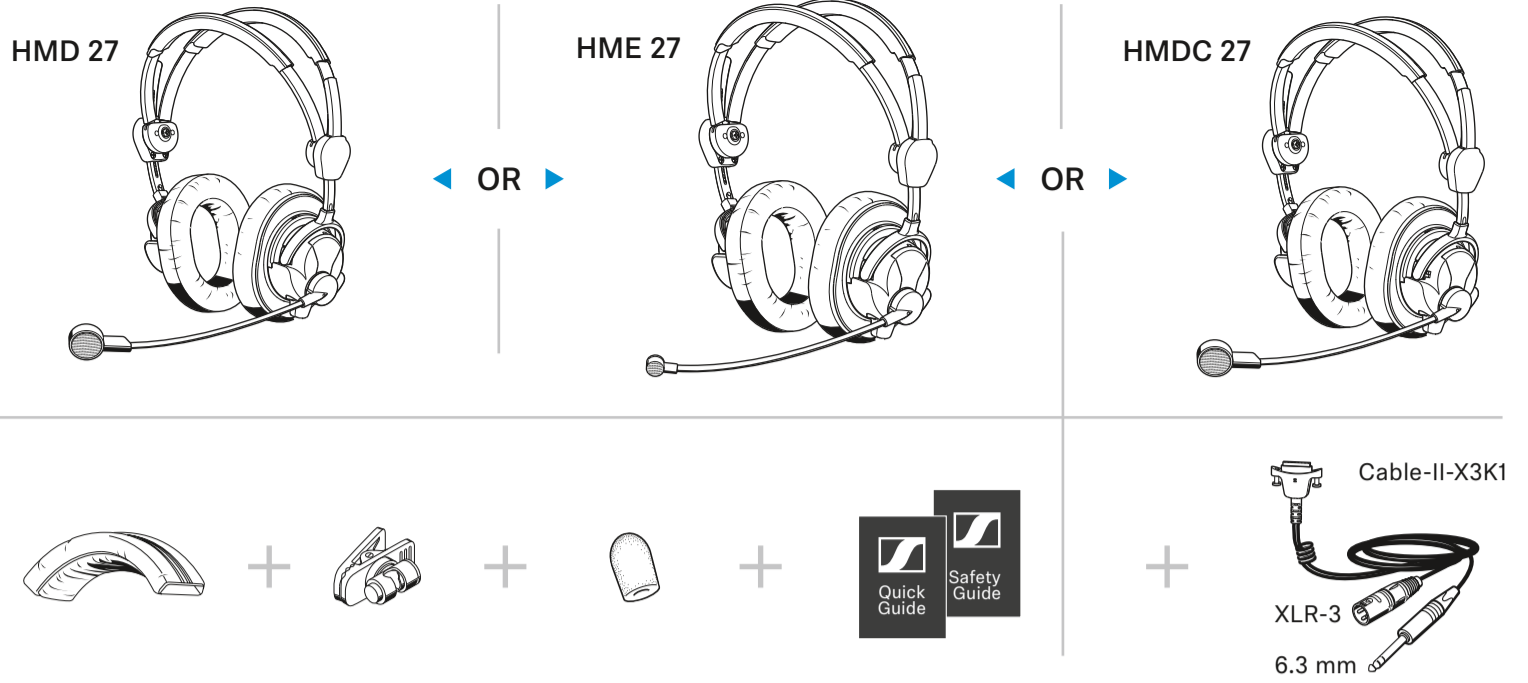

Switching ActiveGard™

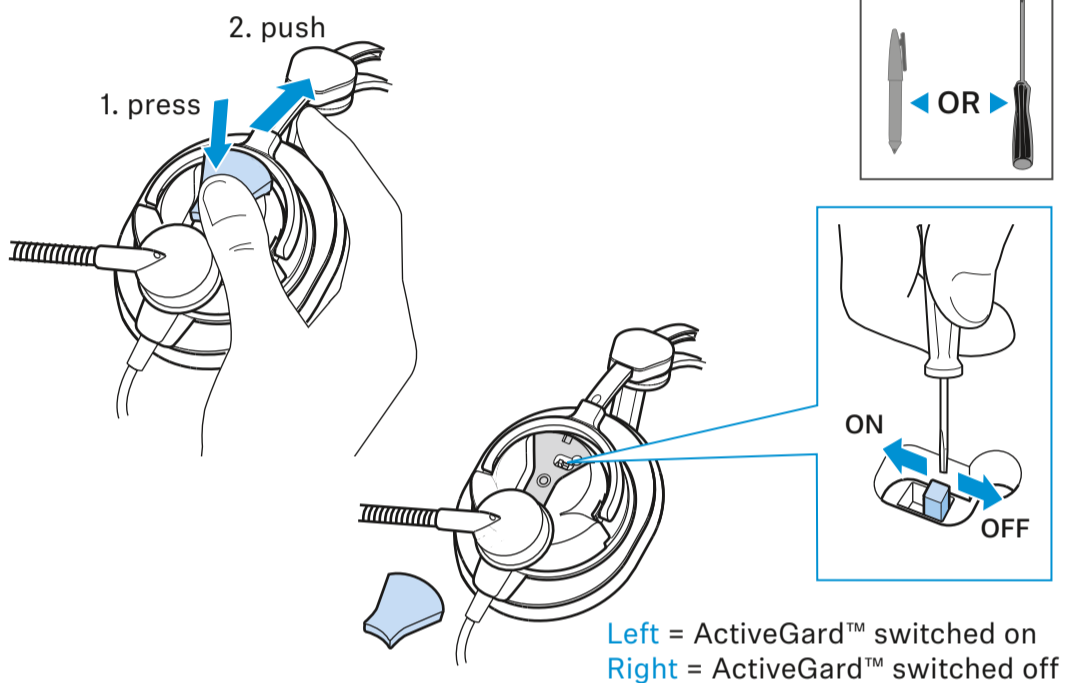
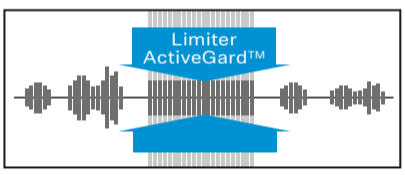
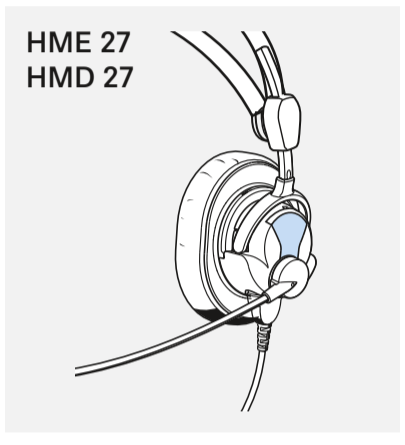

Left = ActiveGard™ switched on
Right = ActiveGard™ switched off

Switching ActiveGard™

HMDC 27

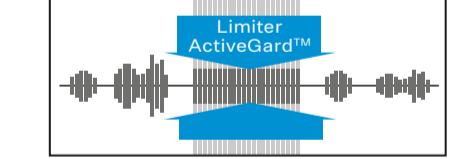
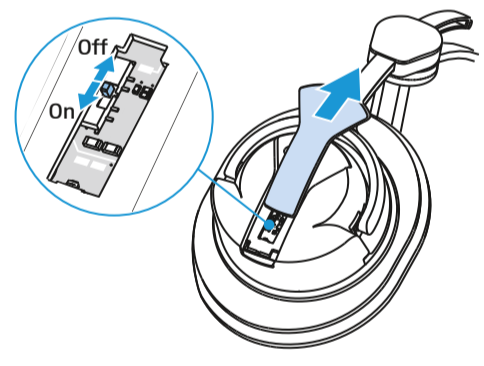

Wearing the headset

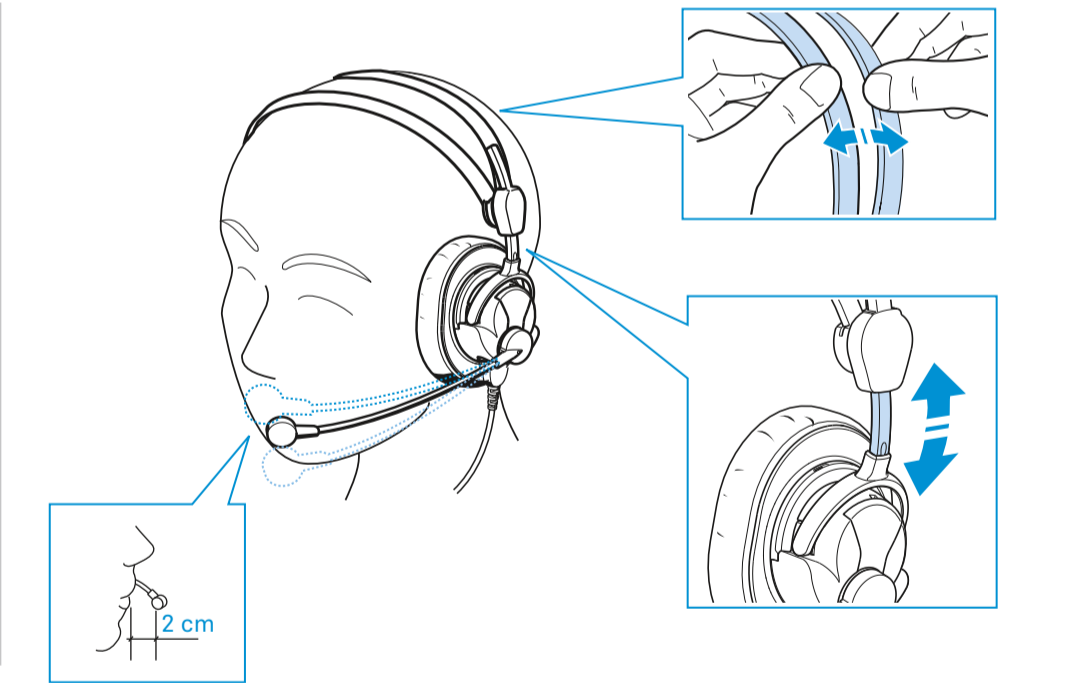
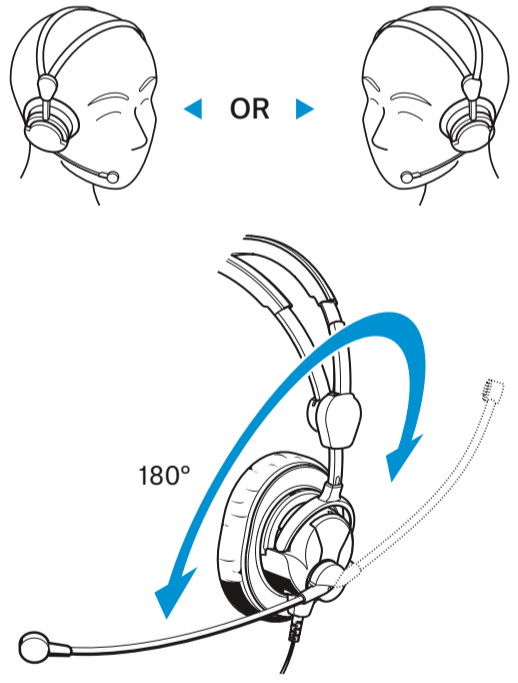

Switching NoiseGard™

HMDC 27

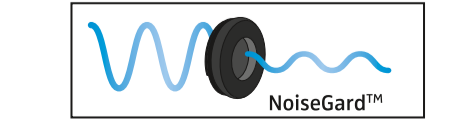
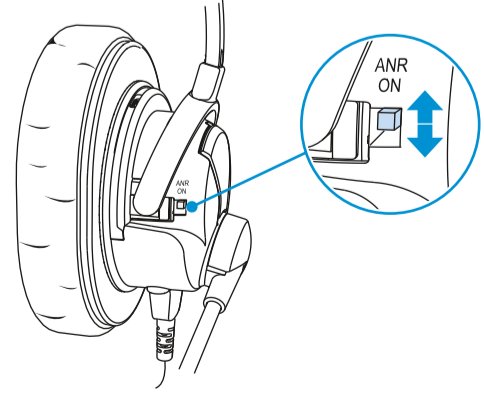

Single-sided listening

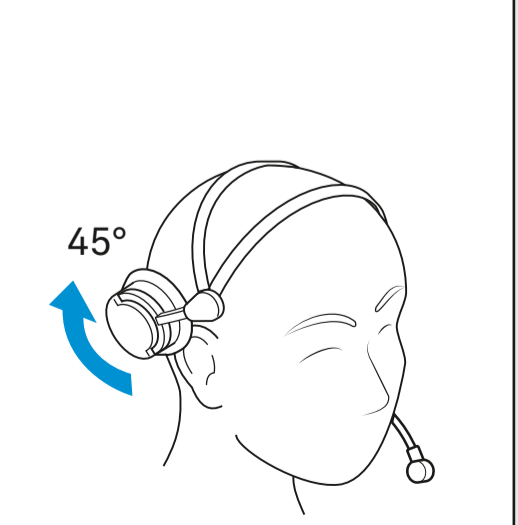

Using accessories

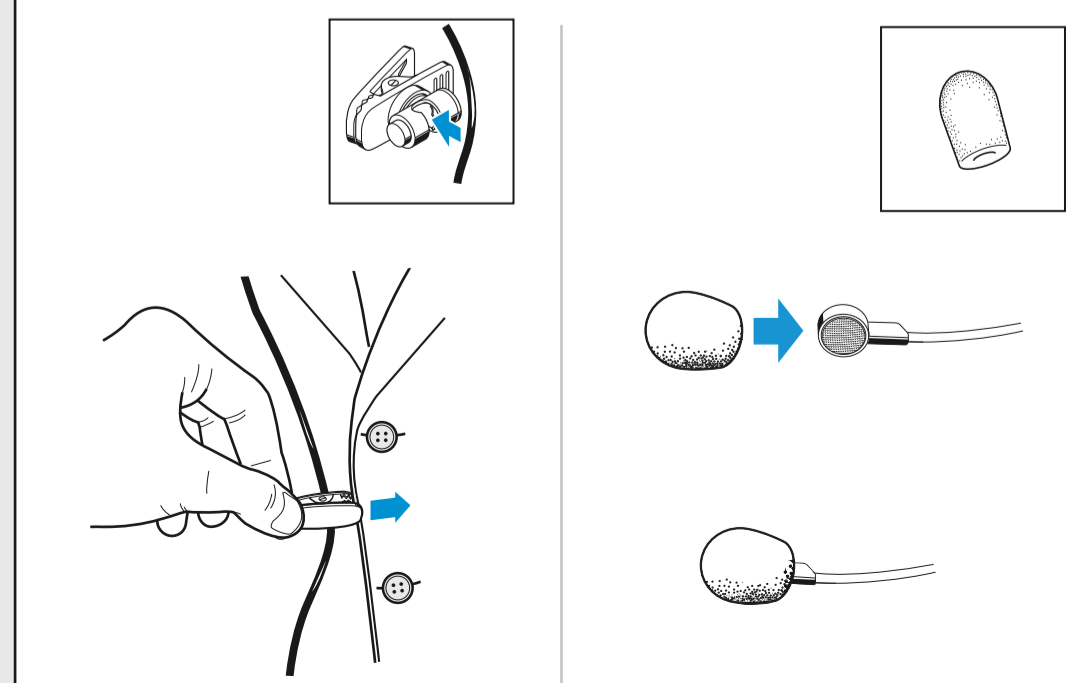

Replacing the headband

Wearing with large headband padding

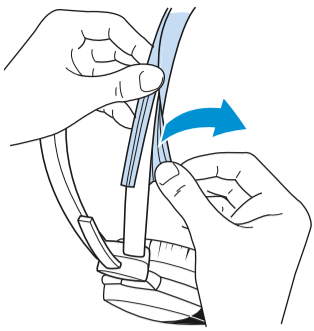

1 Remove both small headbands.

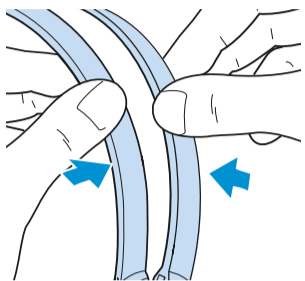

2 Collapse the split headband.

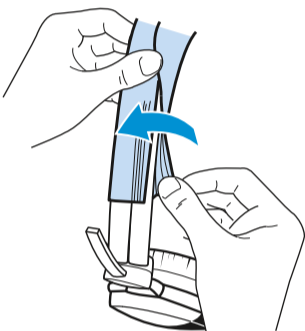

3 Mount the large headband padding.

Wearing with small headbands

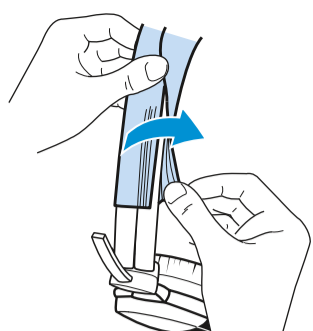

1 Peel off the large headband padding.

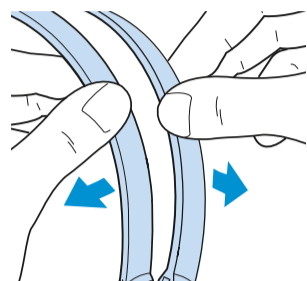

2 Pull the headband carefully apart.

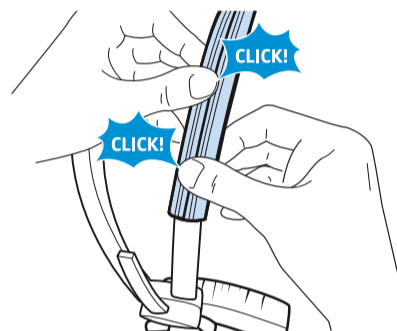

2 Mount the small headbands.

Replacing the ear pads

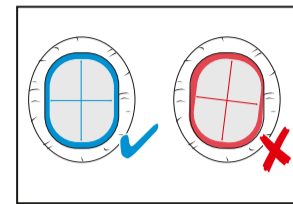
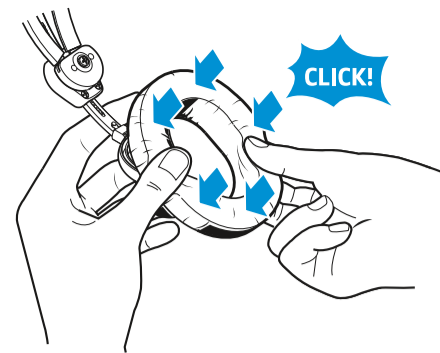
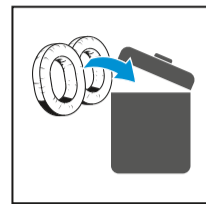
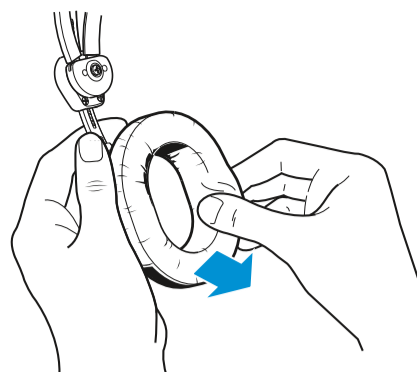

Cleaning

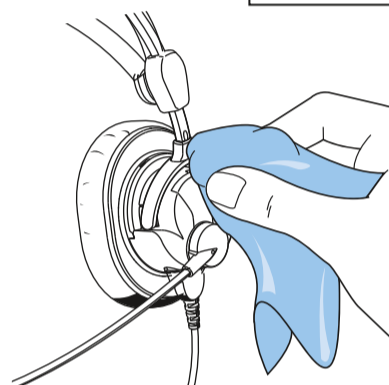
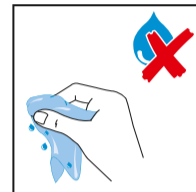

Specifications

	HME 27	HMD 27	HMDC 27
Headphone			
Transducer principle	dynamic, closed		
Ear coupling	circumaural		
Frequency response	8 Hz – 18,000 Hz		
Impedance	64 Ω	600 Ω ANR on / 200 Ω ANR off	
Power rating	500 mW		
Sensitivity	112 dB SPL / 1 V _{rms} / 1 kHz Limiter off		112 dB SPL / 1 V _{rms} / 1 kHz ANR on, Limiter off 107 dB SPL / 1 V _{rms} / 1 kHz ANR off, Limiter on/off
Max. sound pressure level Limiter off	128 dB SPL @ 1 kHz		115 dB SPL @ 1 kHz ANR on 128 dB SPL @ 1 kHz ANR off
Max. sound pressure level Limiter on	110 dB SPL @ 1 kHz		110 dB SPL @ 1 kHz ANR on/off
Ambient noise reduction	≤ 32 dB passive ANR off respectively		
	-	additional ≤ 15 dB ANR on	
Distortion	< 0.1% @ 1 kHz, 100 dB SPL		
Power supply / consumption	-		Phantom powered P12-P48 12 V – 48 V, ≤ 10 mA
Contact pressure	approx. 3.3 N		

	BKE 10-4	BMD 434
Microphone		
Type	BKE 10-4	BMD 434
Transducer principle	pre-polarized condenser microphone	dynamic
Directivity	cardioid	super-cardioid
Transmission rate	40 – 20,000 Hz	40 – 18,000 Hz
Sensitivity	16 mV/Pa @ 1 kHz	0.5 mV/Pa @ 1 kHz
Impedance	-	300 Ω
Max. sound pressure level	150 dB SPL, 1 kHz, 0.5% THD	-
Interface	Phantom-powered P12-P48	-
Power supply	12 V – 48 V	-

General Data	
Ambient temperature	Operation: -15 °C to +55 °C Storage: -55 °C to +70 °C
Weight without cable	approx. 240 g