



Universal Flush-to-Wall Mount and Enclosure

PAD-PARADWM

INSTALLATION - MANUAL

Contents:

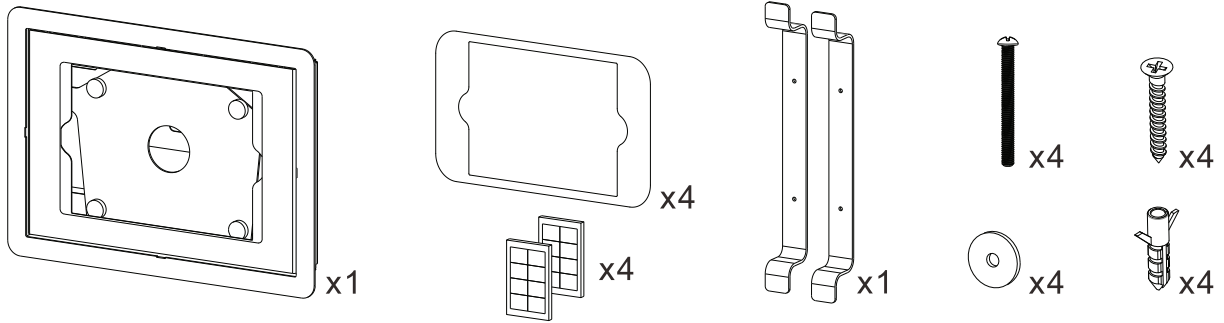

1A. Installation into Drywall

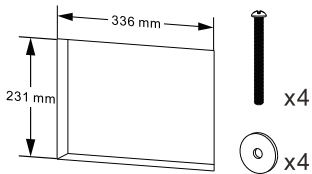

Open a 336mm x 231mm hole in the wall

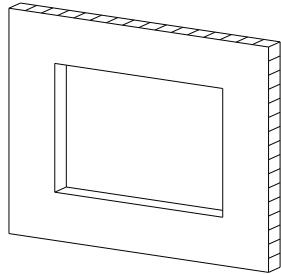

1. Identify Opening (Shown Above)

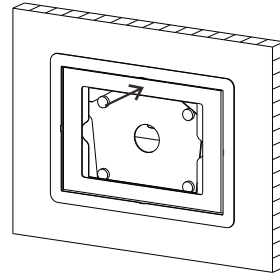

2. Insert Enclosure into opening (Shown Above)

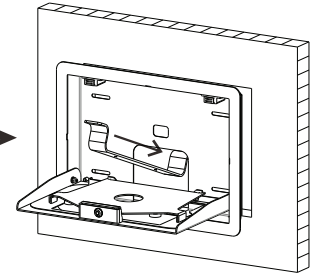

3. Slide Brackets through the opening in the enclosure and out the back (Shown Above)

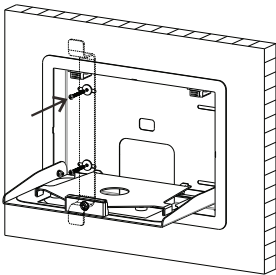

4. From the front, screw in bracket to enclosure (Shown Above)

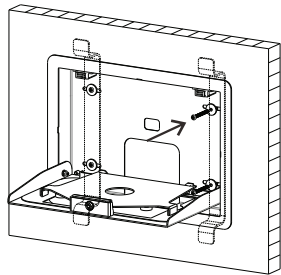

5. Repeat steps 3 and 4 (Shown Above)

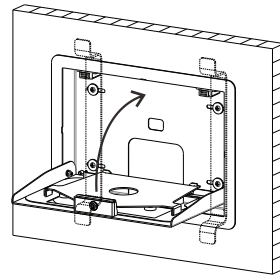

6. Close cover to complete

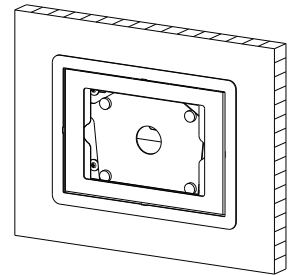

1B. Installation into Drywall Stud or Solid Wall

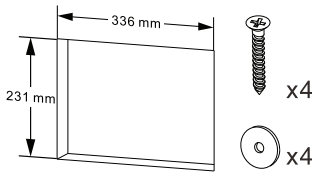

Open a 336mm x 231mm hole in the wall

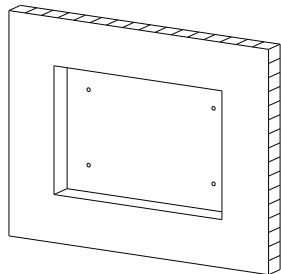

1. Identify Opening (Shown Above)

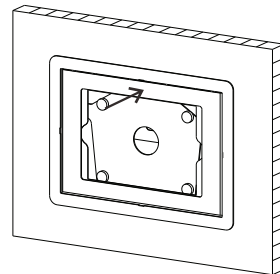

2. Insert Enclosure into opening (Shown Above)

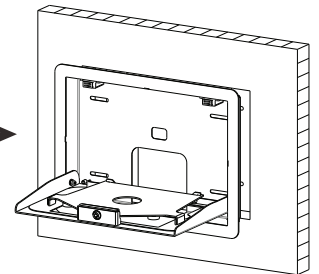

3. Identify (4) slit openings for nails. (Shown Above)

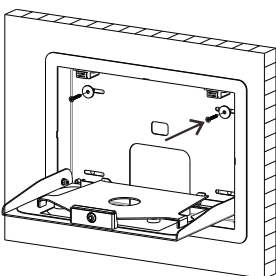

4. Nail in bolts at top (Shown Above)

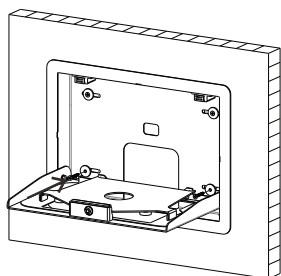

5. Nail in bolts at bottom (Shown Above)

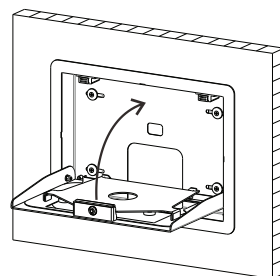

6. Close cover to complete (Shown Above)

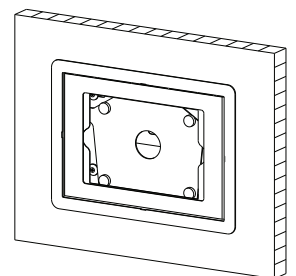

2. How to Insert Tablet into Enclosure

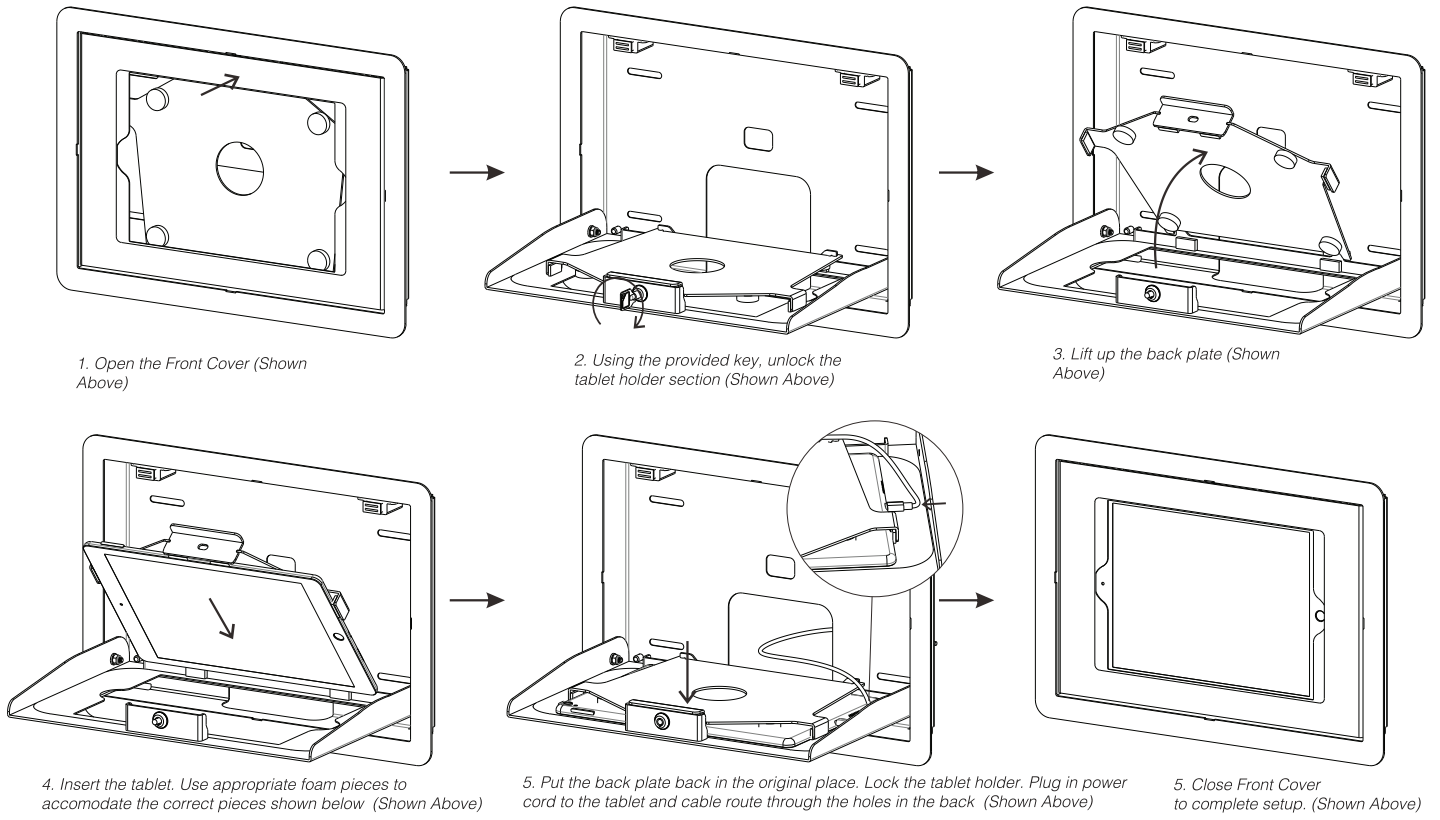

3. How to insert different foams to accommodate various compatible tablets

