

UNITE® 180 Camera



UNITE® 180 Camera

© 2021 ClearOne, Inc.

Information in this document is subject to change without notice.

Compliance

Details about compliance for the UNITE® 180 Camera are available online on ClearOne's website (www.clearone.com) in the Resource Library.

ClearOne® Contacts

Headquarters

5225 Wiley Post Way
Suite 500
Salt Lake City, UT 84116

US & Canada

Tel: 801.975-7200
Fax: 801.303.5711

International

Tel: 801.975.7200
email: global@clearone.com

Sales

Tel: 801.975.7200
email: sales@clearone.com

Technical Support

Tel: 800.283.5936
email: videotechsupport@clearone.com

Important Safety Information

Before you set up the camera, read this manual carefully. Follow the setup instructions indicated in this manual.

Keep this manual for future use.

To prevent electric shock, do not remove screws or the camera housing. No self-serviceable parts are inside the housing.

Avoid direct sunlight or other heat sources. Keep unit away from moisture and humidity. Avoid inserting any sharp objects into the product. Avoid dropping the product to avoid damage.

Normal operating temperature is 32° to 104°F (0° to 40°C)

Careful installation

Install the camera on a smooth desktop or on the top of a computer monitor.

Do not disassemble

Damage caused by the user's disassembly is not covered by warranty.



UNITE® 180 Camera

Power

Use only the included adaptor to power the camera.

Electromagnetic fields at specific frequencies may affect the camera's image .

WARNING: TO PREVENT FIRE OR ELECTRICAL SHOCK HAZARD, DO NOT EXPOSE THIS PRODUCT TO RAIN OR MOISTURE

 <p>THE LIGHTING FLASH AND ARROWHEAD WITHIN THE TRIANGLE IS A WARNING SIGN ALERTING YOU OF DANGEROUS VOLTAGE INSIDE THE PRODUCT.</p>	<p style="text-align: center;">CAUTION</p> <p style="text-align: center;">RISK OF ELECTRIC SHOCK DO NOT OPEN</p> <p style="text-align: center;">AVIS RISQUE DU CHOC ELECTRIQUE - NE PAS OUVRIR</p> <p>CAUTION: TO REDUCE THE RISK OF ELECTRIC SHOCK, DO NOT REMOVE COVER (OR BACK) NO USER SERVICEABLE PARTS INSIDE. REFER SERVICING TO QUALIFIED SERVICE PERSONNEL.</p>	 <p>THE EXCLAMATION POINT WITHIN THE TRIANGLE IS A WARNING SIGN ALERTING YOU OF IMPORTANT INSTRUCTIONS ACCOMPANYING THE PRODUCT.</p>
<p>SEE MARKING ON BOTTOM/BACK OF PRODUCT</p>		



Use only in non-tropical locations.



Use only at altitudes of 2000 meters or less.

Packing List



Camera



**Rubber expansion
plug (x 2)**



**KA4 x 30 self-
tapping screw (x2)**



**Thumb screw
1/2-20-LSmm (x1)**

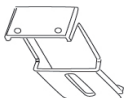

Wall bracket (x1)

Carefully inspect the shipment. If the shipment shows obvious signs of damage, retain the box and packing material for inspection by the carrier. Contact the carrier immediately.

ClearOne is not responsible for product damage incurred during shipment.

Installation

Wall Mounting

- Using a ¼" (6mm) drill bit, drill two holes with a horizontal spacing of 1.1" (28mm) on the mounting wall. Push 2 rubber expansion plugs into the holes.

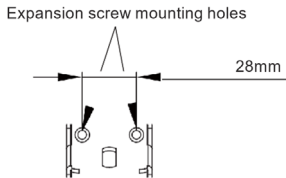

- Attach the wall bracket to the wall using a #2 Phillips screwdriver and the 2 self-tapping screws.
- Secure the camera to the bracket with thumb screws.

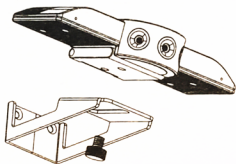

UNITE® 180 Camera

Monitor Mounting

- On the underside of the camera body, open the damped rotating shaft bracket.
- Place camera on top of flat-panel monitor and adjust to preferred position.

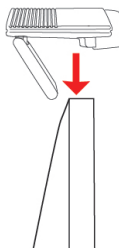
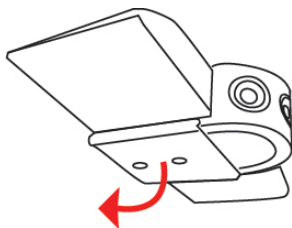

Troubleshooting

Problem	Resolution
The Image jitters	Check stability of the location: Remove vibrating objects
The image flashes	Eliminate unstable lighting.

