

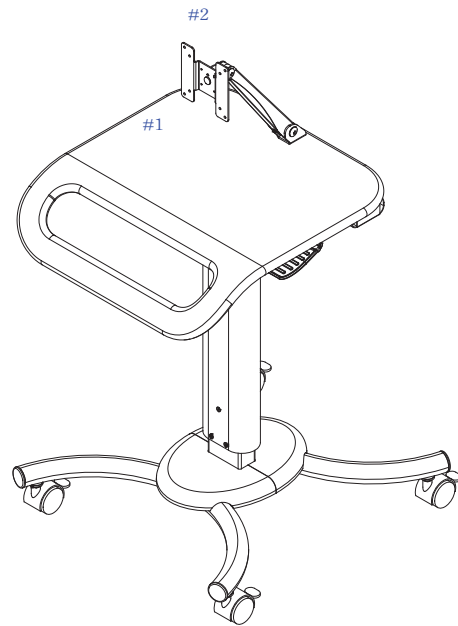

Height-Adjustable Rolling
Workstation Cart with VESA Plate
QPAD-HRSWW

#1 Max Load : 11 LBS
#2 Max Load: 4.4 LBS



Contents

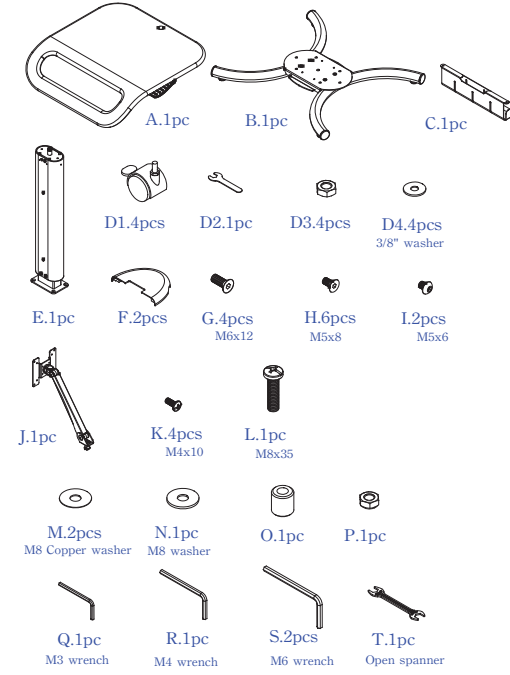

Installation Instructions

1. Insert and tighten the wheels

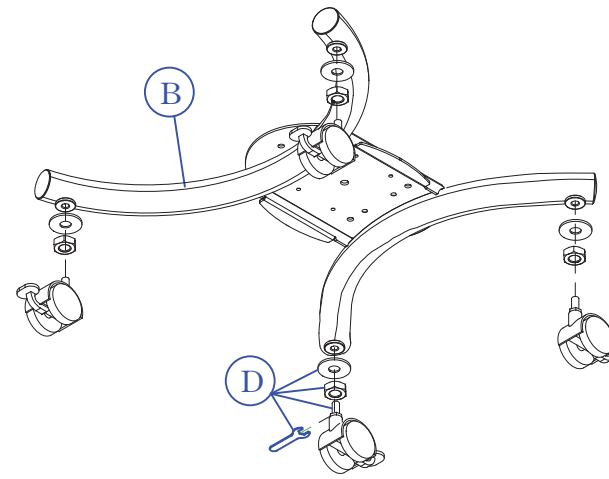

**If necessary, please add nuts and washers to level the base

Installation Instructions

2. Line up and screw in the body

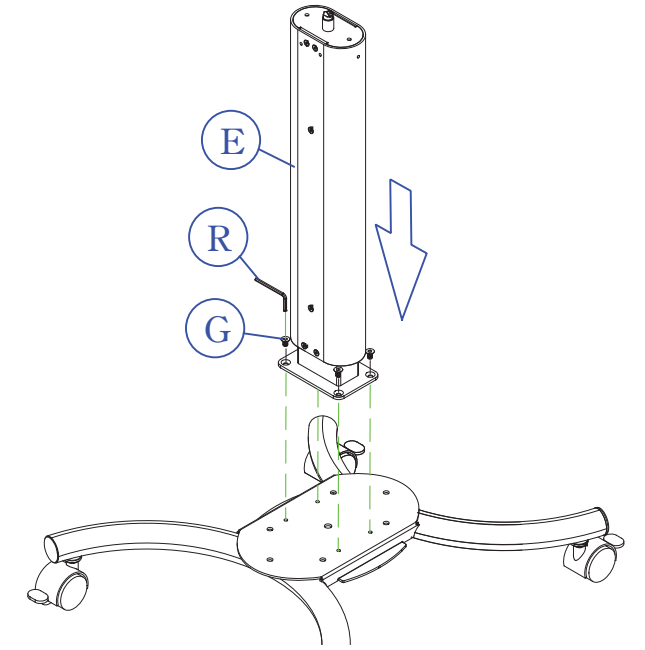

Installation Instructions

3. Attach Base Cover

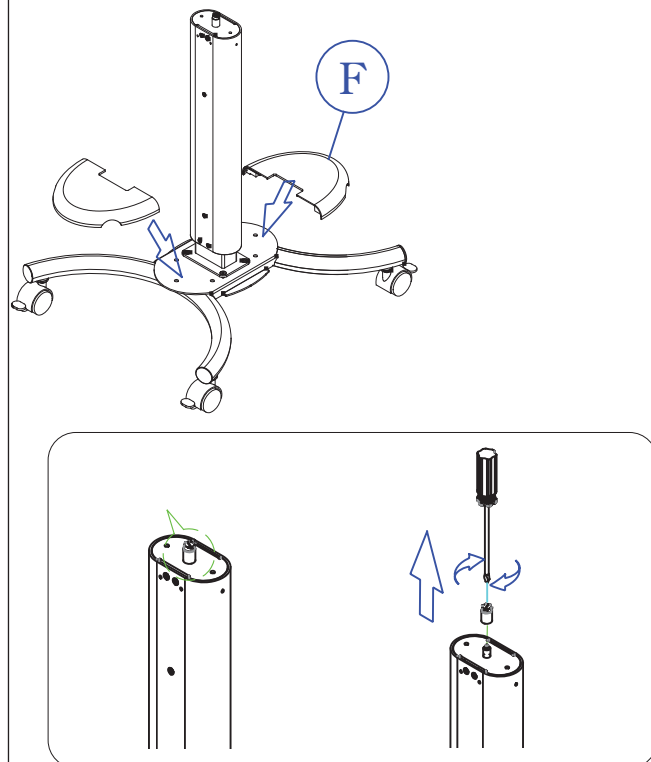

Installation Instructions

4. Line up tray with body
5. Insert and tighten screws

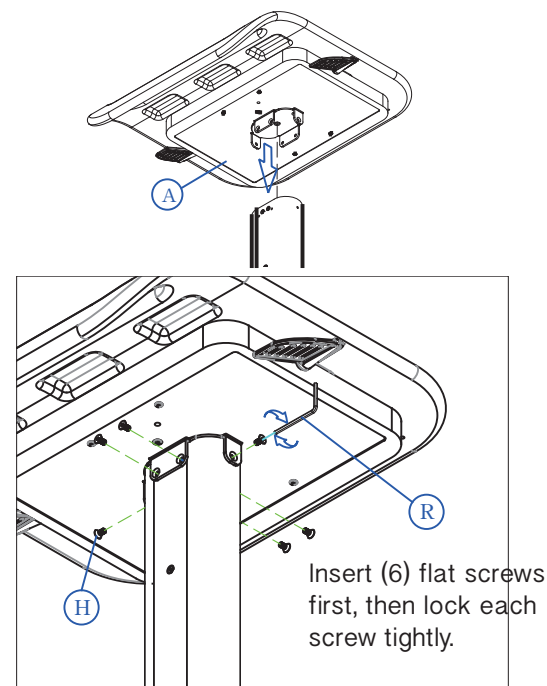

Installation Instructions

6. Screw in accessories holder

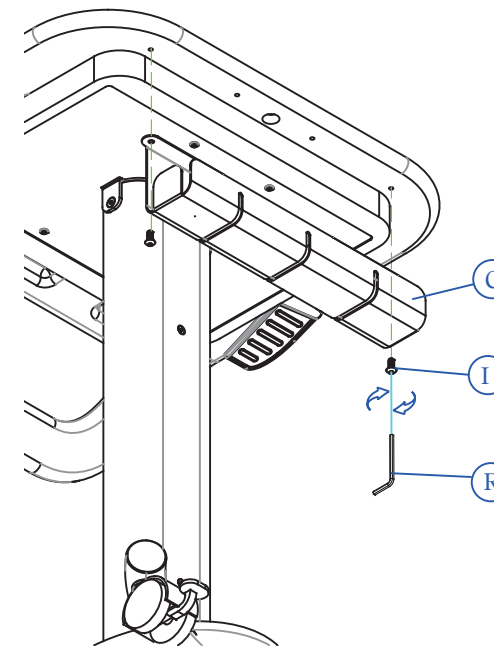

Installation Instructions

7. Install arm, screws, washers and accessories as shown

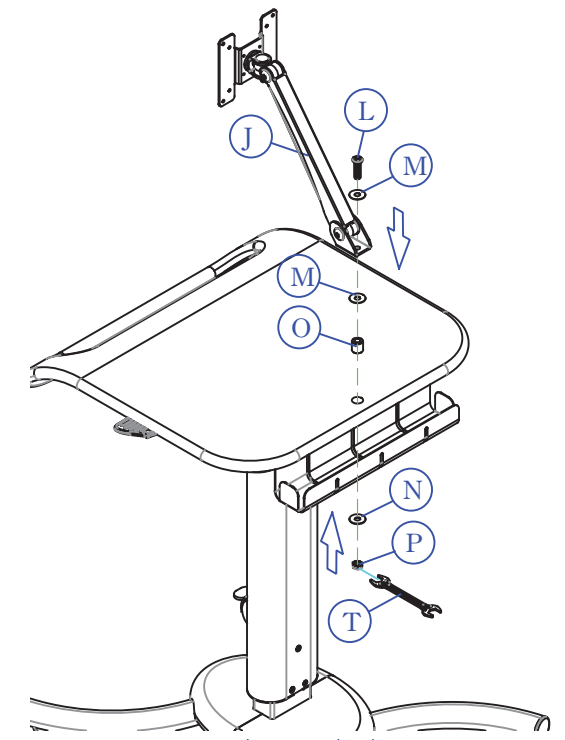

Adjusting Stand Height

**Press lever to adjust height up/down.

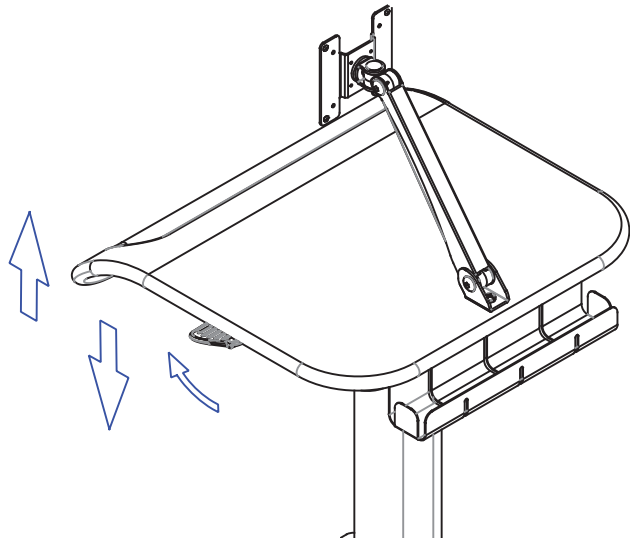

How to Cable Route

**Detach the cable tray cover. Align cable to device and along the neck down to power surge. Replace the cable tray cover as shown.

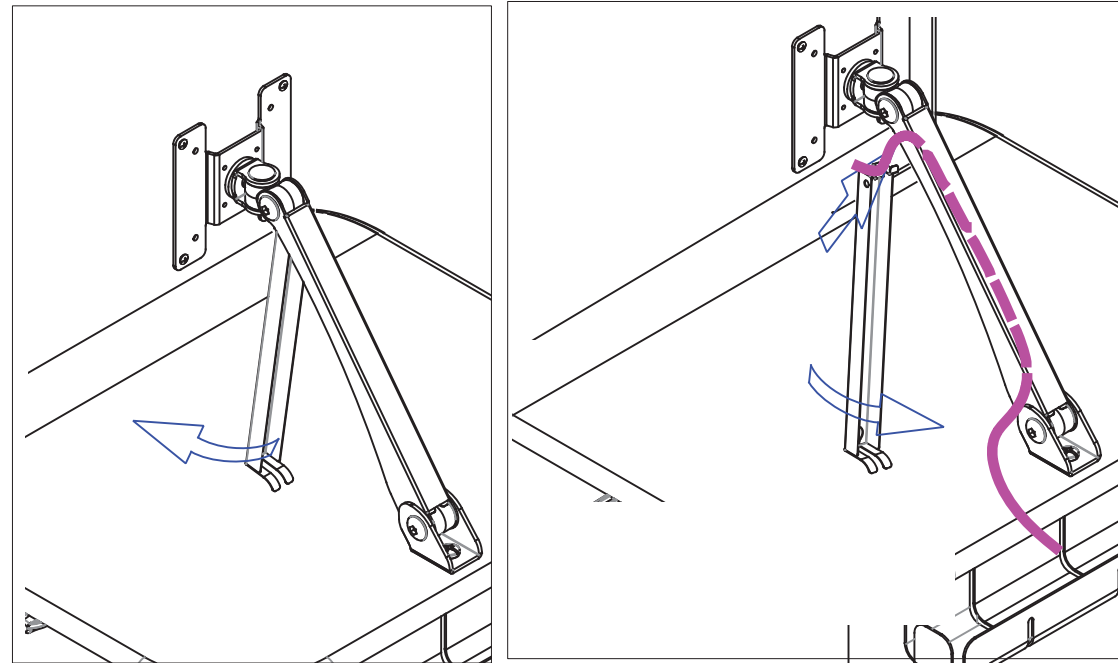

Installing VESA Compatible Device

**Align 75x75 or 100x100 holes to compatible device or VESA compatible item. Screw in nails from behind as shown through the VESA plate into the device/item.

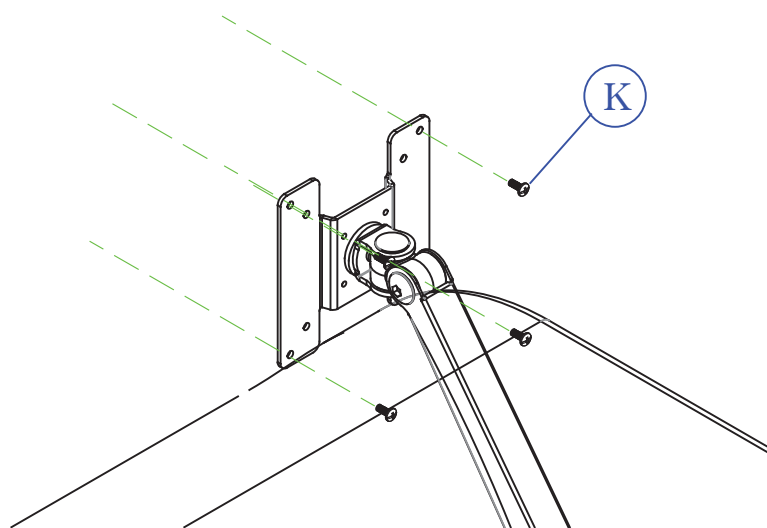

Adjusting Arm

**Using provided tool, loosen joint as shown to adjust arm. Rotate opposite direction to tighten once arm is adjusted to preferred position.

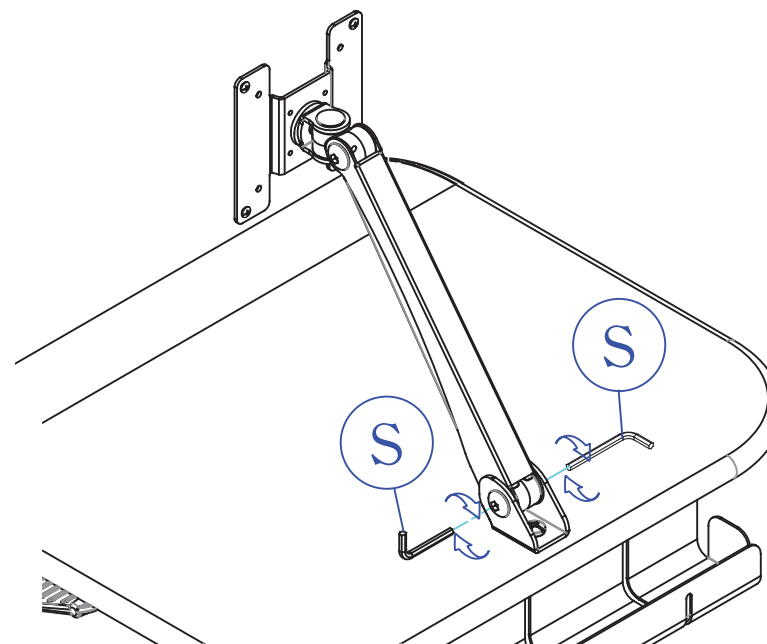

****Caution Disclaimer** - Please do not try to adjust any flexible feature when tightened or else product integrity will be in question. CTA will not be liable for any such user actions.



CTA DIGITAL
Brooklyn NY 11205
support@ctadigital.com