

KanexPro®

1080p USB 2.0 Gaming Capture Dongle



Quick Installation Guide

VER. 1.0

INTRODUCTION:

The **KanexPro CON-GAMECAP** is a video capture device that can capture both HDMI video and HDMI audio, sending audio and video signals to a computer in order to preview or record video content. Suitable for video game console capture, educational recordings, medical imaging, or streaming with the use of an action camera.

FEATURES:

- Support input max resolution 3840x2160@30Hz;
- Support output max resolution 1920x1080@30Hz;
- Support 8/10/12bit deep color;
- Support AWG26 HDMI standard cable: input up to 15 meters, (1080P and below resolution);
- Supports most video recording and streaming software, such as VLC, OBS, Debut, etc;
- Support Windows, Android and MacOS;
- Conform to USB Video and UVC standard;
- Conform to USB Audio UAC standard;
- Without external power supply, compact and portable.

PACKAGE CONTENTS:

- 1x CON-GAMECAP
- 1x User Manual
- 1x AM/AF Cable (L=100MM)
- 1x Type-C USB3.1 Male to USB 2.0 Female Connector

APPLICATION OPTIONS:

- 1: Connect the UHD signal source to the HDMI input of the video capture with one HDMI cable.
- 2: Connect the computer to the USB port of the video capture with USB cable.

3: Getting Started:

The CON-GAMECAP is compatible with various video recording and streaming applications. You can choose any of the popular programs like VLC, Debut, or OBS Studio (<https://obsproject.com/>).

KanexPro recommends OBS Studio is recommended for simplicity and ease of use of the software.

Open OBS Studio:

1. →Add Sources:

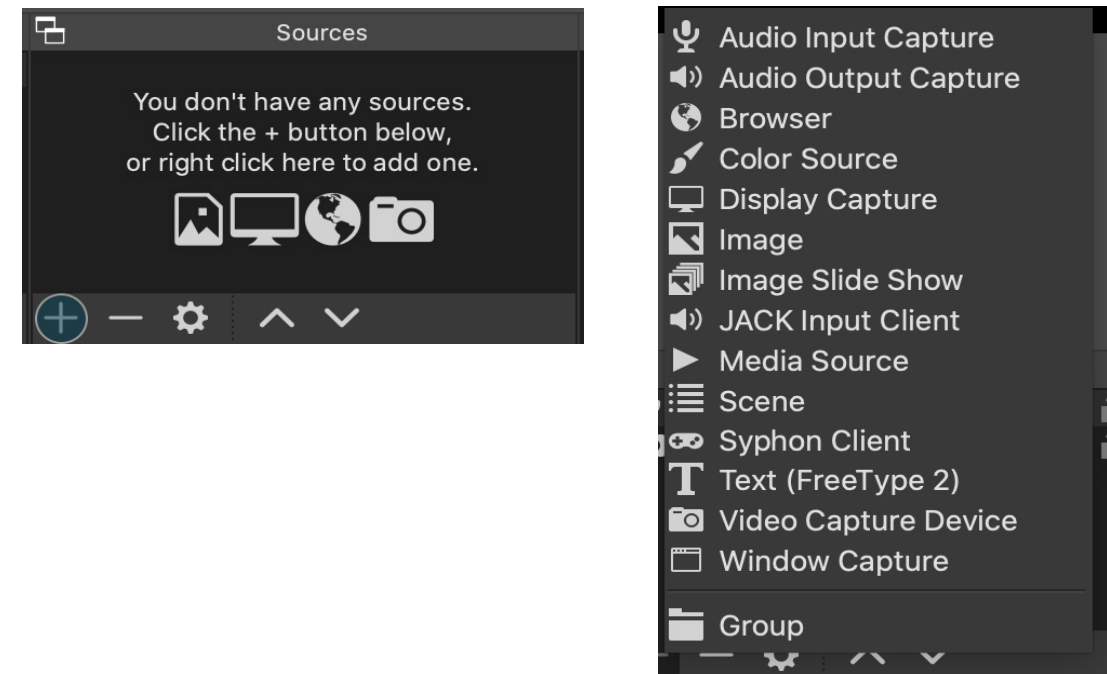

“Video capture Device” -> USB Camera



“Audio Input Capture” -> USB Digital Audio



2. Select either Recording or Streaming Mode

a. Follow the on-screen prompts

3. Choose “Studio Mode” (double window).

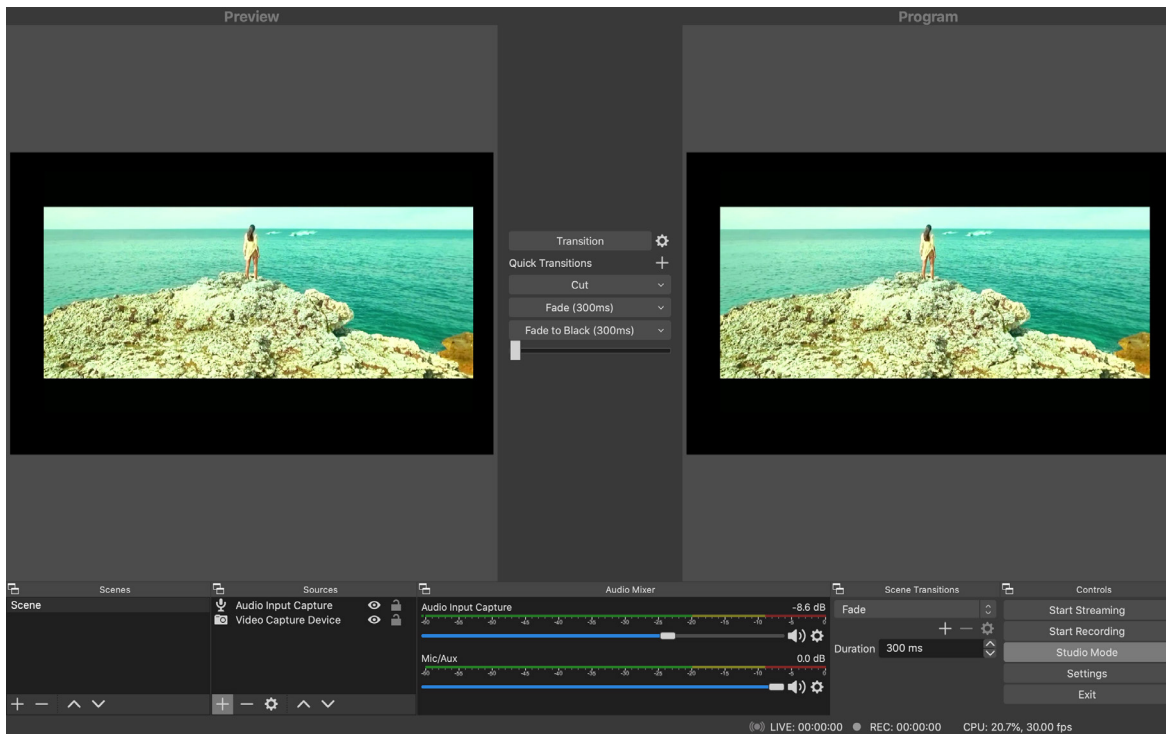

4. Click “Start Recording”

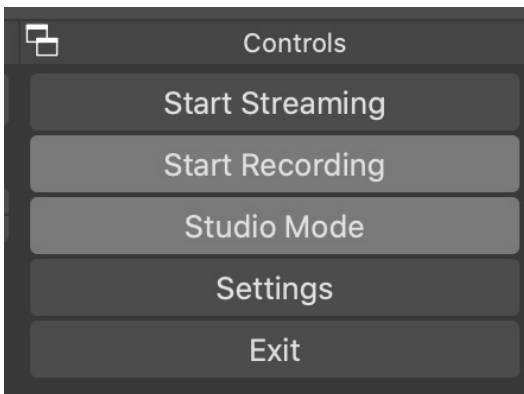

SPECIFICATIONS:

HDMI resolution:	Max input can be 3840x2160@30Hz
Support video for:	8/10/12bit Deep color
Video output format:	YUV, JPEG
Video output resolution:	Max output can be 1920x1080@30Hz
Support audio format:	L-PCM
Input cable distance:	≤15m, AWG26 HDMI standard cable
Max working current:	0.4A/5VDC
Operating Temperature range:	(-10 to +55°C)
Dimension (L x W x H):	64x28x13 (mm)
Weight:	21.4g