

Truly Wireless Earbuds With Speaker

User's Guide for Model IAEBTS410 v2460-01

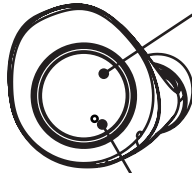

Microphone



Function Touch Pad

Note: Function Touch Pad is sensitive and must be touched or tapped to operate properly.

Earbuds auto power ON when removed from case. If not touch and hold for three seconds to power ON.

Tap one of the earbuds once to pause or resume playback.

Quickly tap right earbud two times to skip to next track.

Quickly tap left earbud two times to skip to previous track.

Quickly tap any earbud three times to activate SIRI.

Touch and hold for five seconds to power OFF.

Charging the Earbuds

1. Open the cover and place the earbuds on the charging contacts. Be sure to match the left and right earbuds with the correct docking station in the case.
2. The earbuds will automatically start charging. When charging, the **LED Indicators** on the earbuds will turn red. When charging is complete, the indicators will turn off.

Earbud LED Indicator

Flashes blue when powered on, or connected to device. Alternately flashes red and blue when ready to pair.

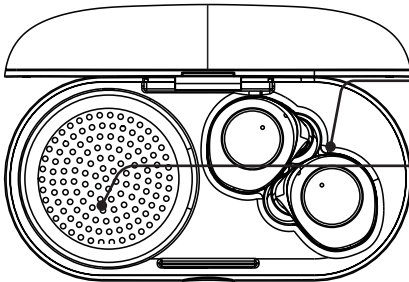

Earbuds on Charge Contacts

Solid red when charging.

Light turns off when fully charged.

Case Speaker

Charging the Case

Using a **Micro-USB to USB** cable, connect to the USB port of a powered on computer or USB power adaptor (not included) to charge the case.

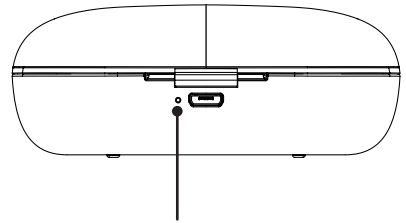

Charging LED Indicator will turn solid blue when charging the earbuds. Light will turn off when charging is complete.

When charging the case the LED will flash red, when charging is complete it will turn solid red.

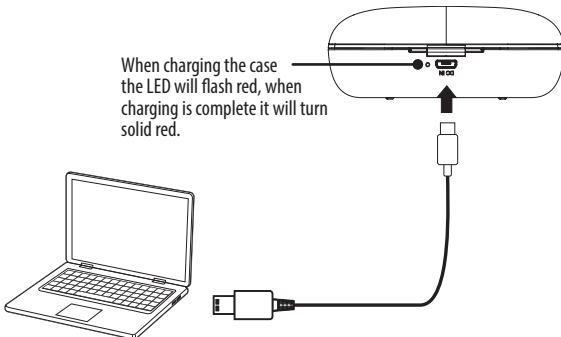

Linking Earbuds

To link the earbuds:

- Earbuds auto power ON when removed from the case. If not, touch and hold the **Function Touch Pad**, and they will automatically link to each other after a few seconds. A voice prompt will also announce the link.

Note: If pairing is not completed within five minutes, the earbuds will power OFF.

Pairing Bluetooth

1. With the earbuds linked, you can now connect to your Bluetooth device. The **LED Indicator** on the left earbud will continue flashing blue and red, indicating it is ready to pair to a Bluetooth device.
2. On your Bluetooth device, access Bluetooth Settings and search for nearby devices. Select **IAEBTS410** when it is discovered. When successfully connected to your Bluetooth device, the **LED Indicator** on both of the earbuds will blink blue once every 6 seconds and a voice prompt will announce the Bluetooth connection.
3. Audio played through the connected Bluetooth device will now be heard through both earbuds. Use the controls on the connected device to play audio and adjust volume.

Note: To use a single earbud, take one earbud out of the case, touch and hold the **Function Touch Pad** to turn on the earbud and start from step 2.

PLEASE NOTE: Due to the nature of truly wireless earbuds, you may experience slight interruptions with your audio in areas with multiple 2.4Ghz bands or in high wireless traffic areas.

Speakerphone Function

- To accept or end a phone call, tap the **Function Touch Pad**.
- If you receive a call while already on one call, you can double tap the **Function Touch Pad** to switch between calls. Tap once to end current call and automatically switch to the other call.
- You can also use the controls on the connected phone to handle phone functions.

Charging Case

- Placing the earbuds in the charging case will automatically begin charging them.
- Removing the earbuds from the case will automatically power them on, link them, and connect to the last used Bluetooth device (earbuds must have been linked and connected to a Bluetooth device already).

Using the Case Speaker

While the earbuds are on and connected to your device:

- Placing the left or both earbuds in the case and closing the cover will turn on the **Case Speaker**.
- Audio will now be heard out loud, from the speaker.
- Use Bluetooth device to control **play/pause/volume/phone functions**.

Customer Support

Customer Service: 1-888-999-4215 | **Email Support:** prodinfo@dpiinc.com | **Email Parts:** partsinfo@dpiinc.com

For Warranty Information and the most up-to-date version of this User's Guide, go to www.iLiveElectronics.com

To download this User's Guide in English, Spanish, or French, or to get answers to frequently asked questions, visit the support section at: www.iLiveElectronics.com

Para descargar este Manual del Usuario en inglés, español y francés, o para obtener respuestas a preguntas frecuentes, visite la sección de apoyo en: www.iLiveElectronics.com

Pour télécharger ce guide de l'utilisateur en anglais, espagnol ou français, ou pour obtenir des réponses à des questions fréquemment posées, consultez la rubrique d'assistance sur: www.iLiveElectronics.com

Copyright © 2019 Digital Products International (DPI, Inc.) All other trademarks appearing herein are the property of their respective owners. Specifications are subject to change without notice.

FCC Warnings

WARNING: Changes or modifications to this unit not extaply approved by the party responsible for compliance could void the user's authority to operate the equipment.

NOTE: This equipment has been tested and found to comply with the limits for a Class B digital device, pursuant to Part 15 of the FCC Rules. These limits are designed to provide reasonable protection against harmful interference in a residential installation. This equipment generates, uses, and can radiate radio frequency energy and, if not installed and used in accordance with the instructions, may cause harmful interference to radio communications. However, there is no guarantee that interference will not occur in a particular installation. If this equipment does cause harmful interference to radio or television reception, which can be determined by turning the equipment off and on, the user is encouraged to try to correct the interference by one or more of the following measures:

- Reorient or relocate the receiving antenna.
- Increase the separation between the equipment and receiver.
- Connect the equipment into an outlet on a circuit different from that to which the receiver is connected.
- Consult the dealer or an experienced radio/TV technician for help.

Additional Warnings

- **WARNING:** To prevent fire or shock hazards, do not expose this unit to rain or moisture.
- **WARNING :** Where the mains plug or appliance coupler is used as the disconnect device, such disconnect device shall remain readily operable.
- Lithium batteries, like all rechargeable batteries, are recyclable and should be recycled or disposed of according to state and local guidelines. They should never be disposed of in normal household waste, and they should never be incinerated, as they might explode. Contact your local government for disposal or recycling practices in your area.
- This product meets and complies with all Federal regulations.
- **To avoid hearing damage,** make sure that the volume on your music player is turned down before connecting your headphones. After placing headphones in/on your ears, gradually turn up the volume until you reach a comfortable listening level.



WARNING : This product can expose you to chemicals including lead, which is known to the State of California to cause cancer and birth defects or other reproductive harm. For more information go to www.P65Warnings.ca.gov.

This product meets and complies with all Federal regulations.