

INSTALLATION INSTRUCTIONS

C-DMM-3001 Flip up Dash Monitor Mount

2013-2019 Ford Police Interceptor Utility (SUV) Standard Interior and Interceptor with Interior Upgrade Package (Ford option code 65U) 2011-2019 Ford Retail Explorer

TOOLS REQUIRED:

Ratchet Wrench	Dash panel removal tool	Open End Wrench - 7/16"
Socket Set	Phillips screwdriver	Torque wrench (in-lbs.)

HARDWARE and PARTS:

<u>QTY</u>	<u>DESCRIPTION</u>	<u>PART#</u>
1	Upper driver side support bracket	CM009283-DS
1	Upper passenger side support bracket	CM009283-PS
1	Lower passenger side support bracket	CM009284
3	10-32 x 1/2" Machine screw	GSM33118
3	#10 Star washer	GSM31034
1	VESA rotator plate	CM009068
1	PVC washer	CM008582
2	1/4" Plastic washer	CM86600
2	1/4" Steel washer	GSM31005
2	1/4" Nylock nut	GSM30016

Notes:

The C-DMM-3000 swivel plate accepts C-MM-301 offset bracket used with C-MM-2XX adaptors. C-MM-2XX series adaptor brackets are not needed for most VESA 75 and other Havis Docking Station mounting applications.

CM009068 VESA rotator plate gives additional positioning options, but is not required depending on mounting preference.

Always!

- Read all instructions before installing any Havis, Inc. products.
- Check for obstructions (Wires, brake lines, fuel tank, etc.) before drilling any holes!
- Use hardware provided with install kit

C-DMM-3001 Assembly

CM009283-PS

Passenger side upper
support bracket

CM009283-DS

Driver side upper support bracket

CM86600 - 1/4" Plastic washer

GSM31005 - 1/4" Steel washer

GSM30016 - 1/4" Nylock nut

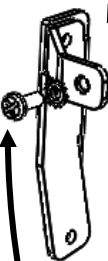

GSM33118 - 10-32 x 1/2" screw

GSM31034 - #10 Star washer

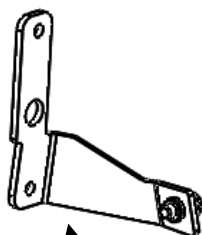

CM009284

Passenger side lower
support bracket

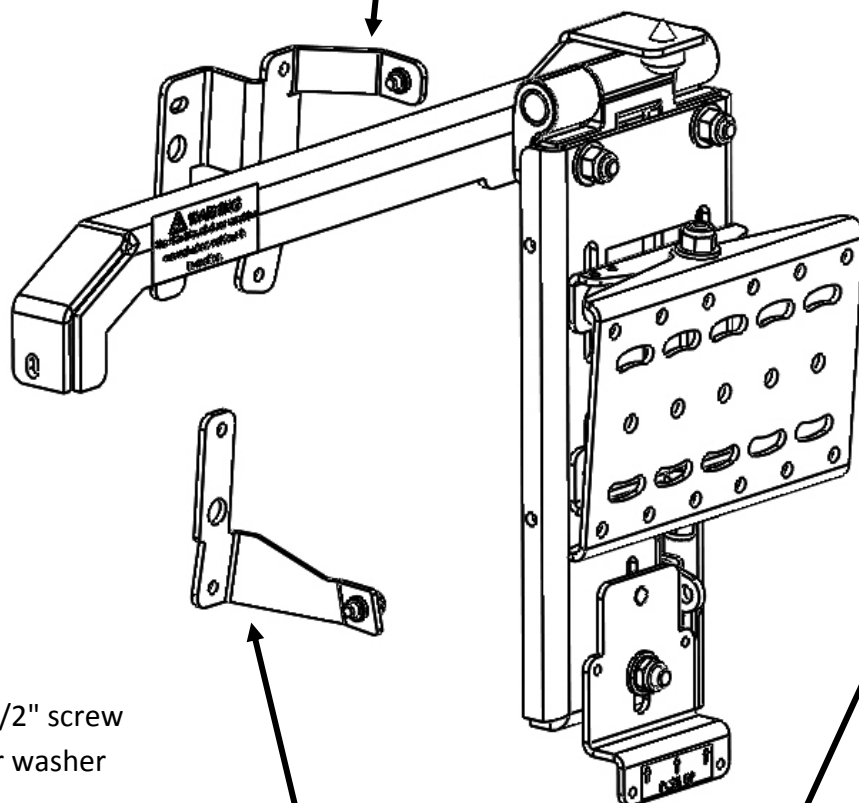

CM008582
PVC washer

CM009068
VESA rotator plate

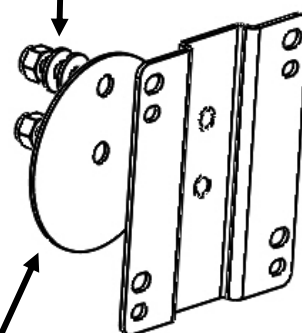



View of dash center instrument panel



Carefully remove driver and passenger side trim bezels using plastic panel tool.



Remove screws holding center panel.
Unplug and remove center control panel.



Attach lower support bracket to dash using OEM
7mm head fasteners
Torque to 3 Nm (27 in-lbs.)



Remove (4) 7mm head screws



Unplug and remove radio display.



Place driver and passenger upper support brackets in vehicle and attach using OEM fasteners.
Torque to 3 Nm (27 in-lbs.)



Reattach center control panel
Torque to 3 Nm (27 in-lbs.)



Reattach trim bezels allowing the support brackets to sit between the bezel and the dash.



Place DMM frame onto the support tabs and attach the upper passenger side corner using 10-32 x 1/2" screw and star washer.



Attach the upper driver side corner using supplied 10-32 x 1/2" screw and star washer



Attach the lower passenger side with 10-32 x 1/2" screw and star washer. Access hole in the frame.



Attach VESA plate to the back of the dock. The gray nylon washer will go between this bracket and the DMM swivel plate.



Determine desired position for your specific computer and attach to DMM swivel plate using nylon washers, steel washers, and nylock nuts. Tighten so that the dock rotates smoothly. (Firm, but not too tight)



Upper stop bumper shown in open position.
Test for proper latching in closed position.

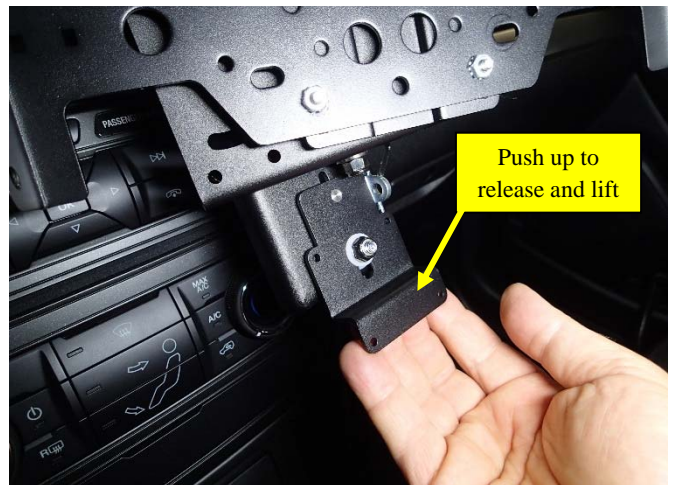

Simply Push up to release latch and
Pull to hinge up computer display.



Route wiring as needed along the side of the DMM flip up frame using wire tie holes as shown. Test up / down and side to side motion to confirm wires have adequate slack and strain relief.



Installation is now complete.