

INSTRUCTION SHEET
VDM-A SERIES
ADJUSTABLE POLE 12" TO 72"

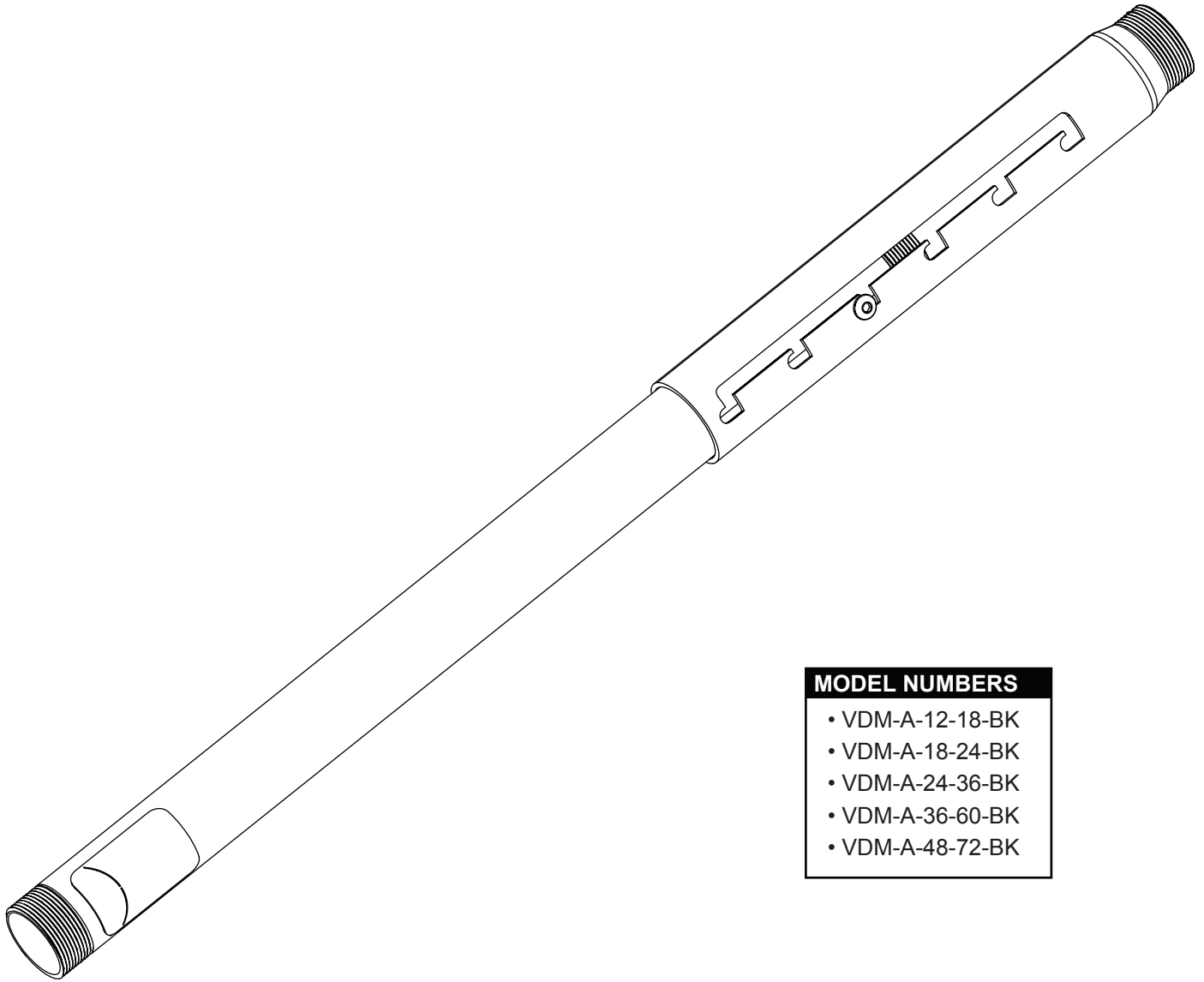

MODEL NUMBERS

- VDM-A-12-18-BK
- VDM-A-18-24-BK
- VDM-A-24-36-BK
- VDM-A-36-60-BK
- VDM-A-48-72-BK

THANK YOU

Thank you for purchasing the VDM-A 12" to 72" adjustable pole series. Please read these instructions thoroughly before installing or assembling this product.

PRODUCT FEATURES

- 1 1/2" NPSM threads on both ends
- 500 lb. weight capacity
- Adjustable pole length

IMPORTANT SAFETY INSTRUCTIONS

- Read these instructions.
- Heed all warnings.
- Clean only with dry cloth.
- Keep these instructions.
- Follow all instructions.
- Only use attachments/accessories specified by the manufacturer.



DANGER HAZARDOUS VOLTAGE: The lightning flash with the arrowhead symbol, within an equilateral triangle is intended to alert the user to the presence of uninsulated dangerous voltage within the product's enclosure that may be of sufficient magnitude to constitute a risk of electric shock to persons.



WARNING: A warning alerts you to a situation that could result in serious personal injury or death.



CAUTION: A caution alerts you to a situation that may result in minor personal injury or damage to the product and/or property.

NOTE: A note is used to highlight procedures pertaining to the installation, operation, or maintenance of the product.



WARNING: Failure to read, understand and follow the following information can result in serious personal injury, damage to the equipment or voiding of the warranty. It is the responsibility of the Installer/User to ensure that this product is loaded according to specifications.



WARNING: Failure to provide correct structural strength for the component may result in serious personal injury or damage the equipment.



WARNING: Exceeding the weight capacity may result in personal injury or equipment damage. The combined weight of all components attached to the mount must not exceed weights listed on page 3.



WARNING: Be aware of pinch points and do not place fingers in between moving parts.



WARNING: Use this product for its intended use and only use attachments recommended by the manufacturer.



WARNING: Do not use a damaged product. Return damaged products to a qualified service center for repair.



WARNING: Not intended for outdoor use.

INSTRUCTIONS IMPORTANTES SUR LA SÉCURITÉ

- Lire ces instructions.
- Respectez tous les avertissements.
- Nettoyer uniquement avec un chiffon sec.
- Conservez ces instructions.
- Suivez toutes les instructions.
- N'utilisez que des accessoires spécifiés par le fabricant.



DANGER TENSION DANGEREUSE: Le symbole de la pointe de flèche, dans un triangle équilatéral, est destiné à alerter l'utilisateur sur la présence de tension dangereuse non isolée dans l'enceinte du produit qui peut être d'une ampleur suffisante pour constituer un risque d'électrocution.



AVERTISSEMENT: Un avertissement vous avertit d'une situation pouvant entraîner des blessures graves ou la mort.



ATTENTION: Une attention vous avertit d'une situation pouvant entraîner des blessures mineures ou des dommages au produit et/ou à la propriété.

REMARQUE: Une remarque est utilisée pour mettre en évidence les procédures relatives à l'installation, au fonctionnement ou à l'entretien du produit.



AVERTISSEMENT: Refus de lire, comprendre et suivre les renseignements suivants peut traduire par de graves blessures, des dommages à l'équipement ou invalider la garantie. Il est la responsabilité de l'installateur / utilisateur de s'assurer que ce produit est chargé conformément aux spécifications.



AVERTISSEMENT: Le défaut de fournir une résistance structurelle correcte pour le composant peut entraîner des blessures graves ou endommager l'équipement.



AVERTISSEMENT: Dépassez la capacité de poids peut entraîner des blessures ou des dommages matériels. Le poids combiné de tous les composants reliés au support de montage ne doit pas dépasser les grammages indiqués à la page 3.



AVERTISSEMENT: Soyez conscient des points de pincement et de ne pas placer les doigts entre les pièces mobiles.



AVERTISSEMENT: Utilisez ce produit pour son utilisation prévue et utiliser uniquement les accessoires recommandés par le fabricant.



AVERTISSEMENT: Ne pas utiliser un produit endommagé. Retour produits endommagés à un centre de service qualifié pour la réparation.



AVERTISSEMENT: Non destiné à une utilisation en extérieur.

WEIGHT RATINGS

Model	Product Weight	Weight Rating
VDM-A-12-18-BK	4.0 lbs. (1.81 kg)	500 lbs. (226.8 kg) Maximum Total Rated Load
VDM-A-18-24-BK	6.0 lbs. (2.72 kg)	500 lbs. (226.8 kg) Maximum Total Rated Load
VDM-A-24-36-BK	8.0 lbs. (3.63 kg)	500 lbs. (226.8 kg) Maximum Total Rated Load
VDM-A-36-60-BK	12.0 lbs. (5.44 kg)	500 lbs. (226.8 kg) Maximum Total Rated Load
VDM-A-48-72-BK	15.0 lbs. (6.80kg)	500 lbs. (226.8 kg) Maximum Total Rated Load

SUPPLIED COMPONENTS AND HARDWARE

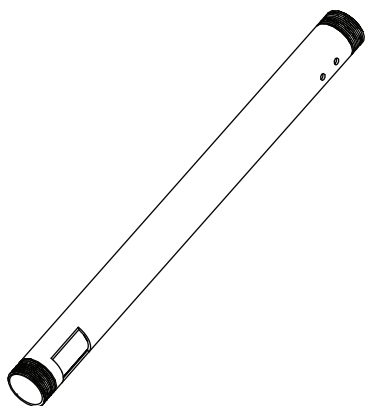

Extension Pipe
A

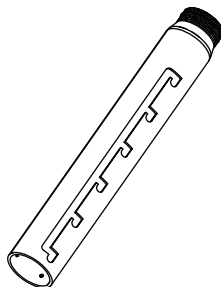

Adjustment Tube
B



Cable Access Cover
C



Button Head Screw
D



Security
Button Head Screw
E



(2x)
Set Screw
F



(2x)
Security Set Screw
G

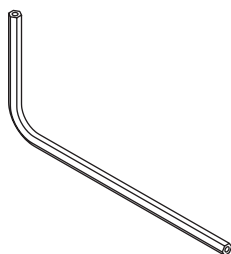

4mm Security
Hex Wrench
H

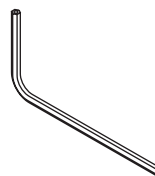

2.5mm Security
Hex Wrench
J

ASSEMBLING ADJUSTMENT TUBE

1. Slide end of extension pipe (A) with tapped holes into adjustment tube (B). (**FIGURE A**)

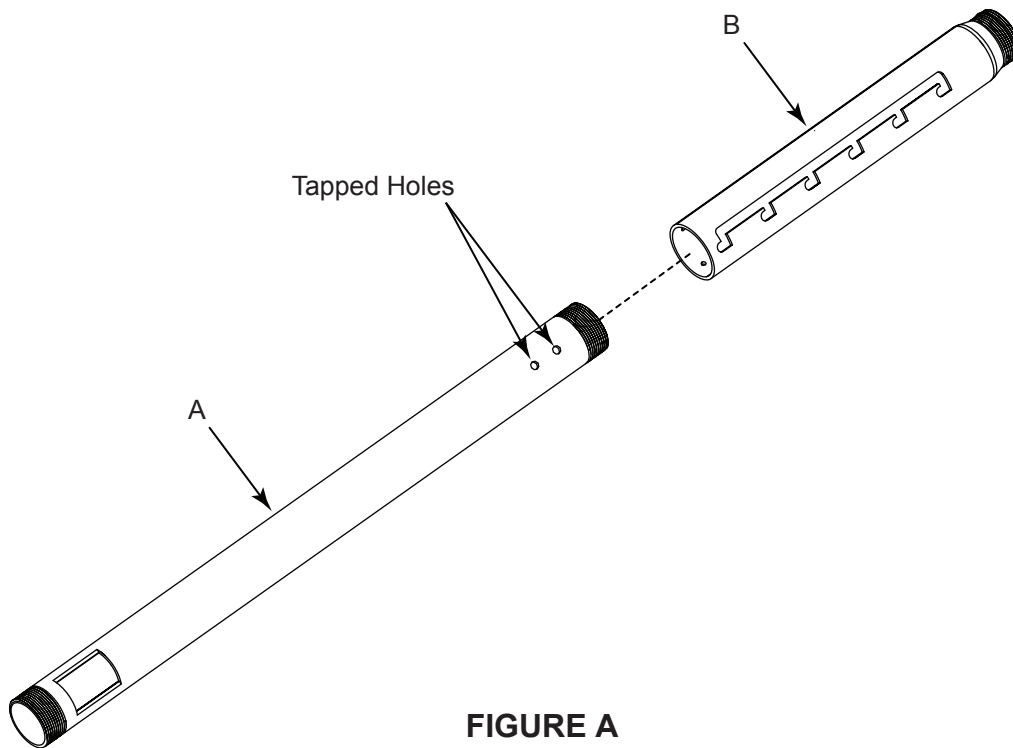

FIGURE A

2. Thread button head screw (D or E) into slot in adjustment tube (B), but do not tighten. (**FIGURE B**)
3. Slide extension pipe (A) into adjustment tube to the desired length.
4. Twist screw into slot and pull extension pipe down to hook screw into place.
5. Tighten button head screw (D or E) using 4MM hex key (H).

NOTE: Hex wrench supplied can be used for both standard and security screws.

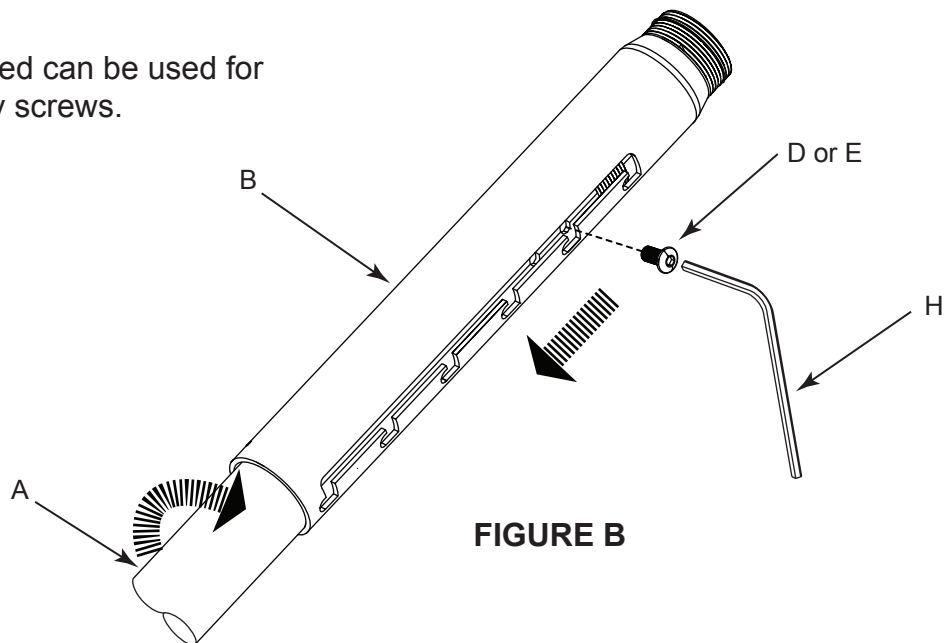

FIGURE B

ASSEMBLING ADJUSTMENT TUBE (CONTINUED)

6. Insert (2x) set screws (F or G) into adjustment tube (B) and tighten to secure extension pipe (A) in place. (**FIGURE C**)

NOTE: Hex wrench supplied can be used for both standard and security set screws.

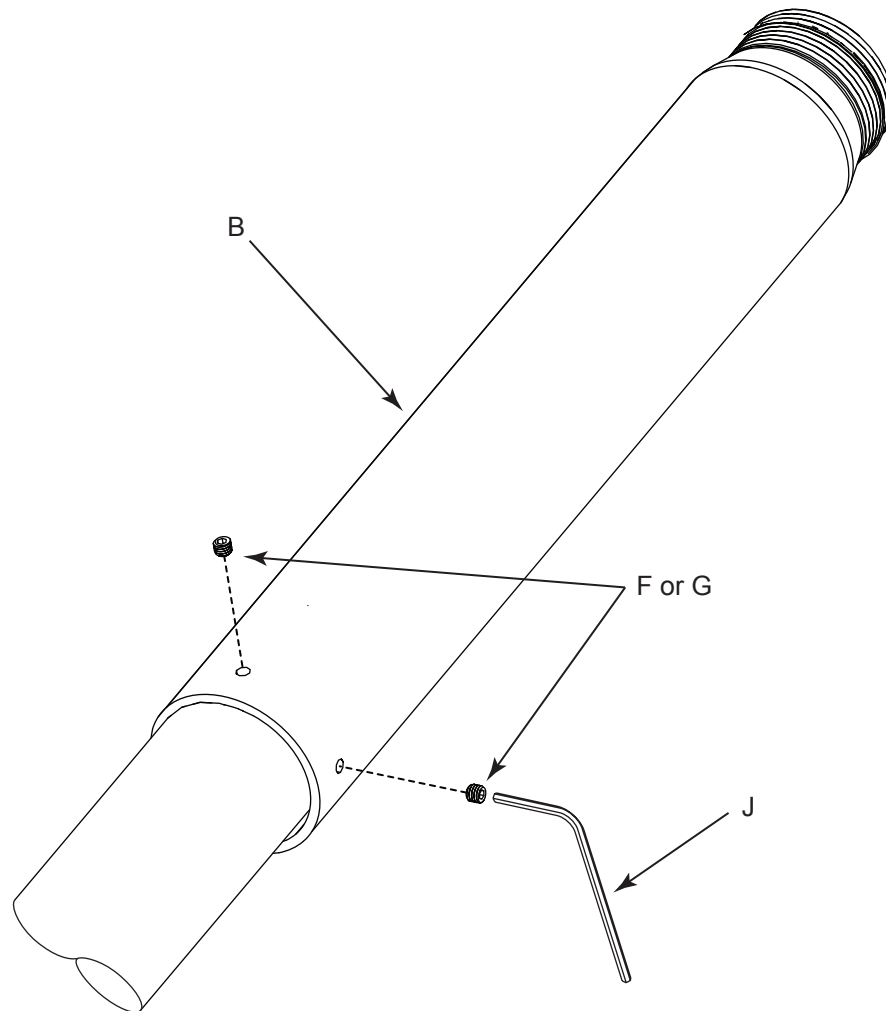

FIGURE C

INSTALLING CABLE ACCESS COVER

1. Prior to installing extension pipe assembly when cabling will be passed through the inside of extension, snap off breakaway section of cable access cover (C) at the perforation line to provide clearance for cables. (**FIGURE D**)
2. Once breakaway section is removed, cover can be snapped back in place over pipe opening.

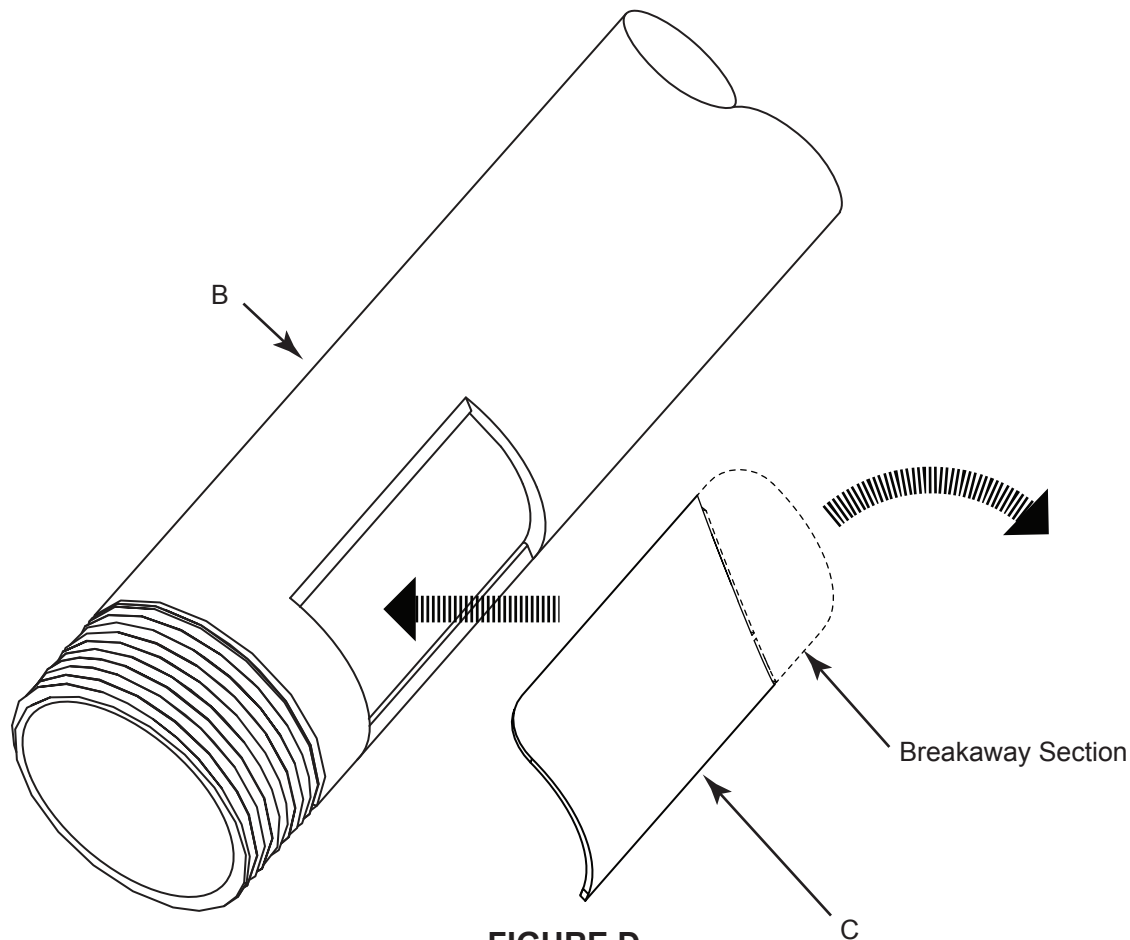

FIGURE D

WARRANTY

For warranty information, refer to <http://www.middleatlantic.com/company/about-us.aspx#warranty>

Corporate Headquarters

Corporate Voice: 973-839-1011 - Fax: 973-839-1976 / International Voice: +1 973-839-8821
Fax: +1 973-839-4982
www.middleatlantic.com - info@middleatlantic.com

Middle Atlantic Canada

Voice: 613-836-2501 - Fax: 613-836-2690
ca.middleatlantic.com - customerservicecanada@middleatlantic.ca

Factory Distribution

USA: NJ - CA - IL Canada: ON - BC

At Middle Atlantic Products we are always listening. Your comments are welcome.

Middle Atlantic Products is an ISO 9001 and ISO 14001 Registered Company.