



CTA DIGITAL

# PAD-SHFS

## Heavy-Duty Security Gooseneck Floor Stand for 7-13 Inch Tablets

### INSTRUCTION MANUAL

Thank you for choosing CTA Digital's product. We hope that you will enjoy using it. Please follow the guidelines and instructions as laid out in this instruction manual.

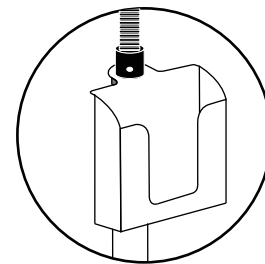
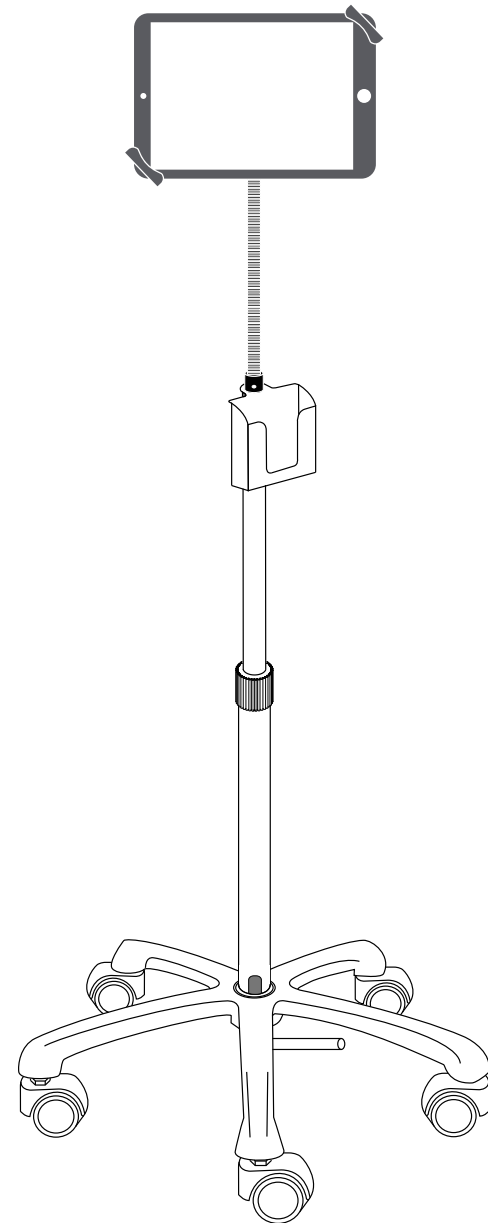

Attachable  
battery-pack  
cradle

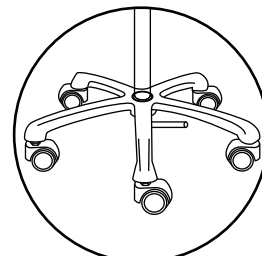

Attachable and  
detachable  
swivel casters



Adjustable holder  
for tablets 7 - 13  
inches

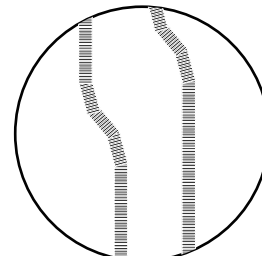

Ultra-flexible and  
sturdy gooseneck

### Package Contents:

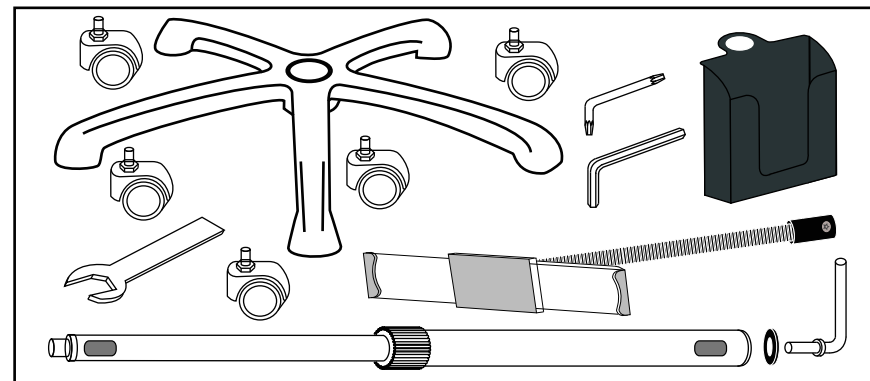

### Instructions:

#### 1.Going the Cable Through the Cable Routings on the Pole

This product allows you to go through the cable from the cable routings on the pole.



1.Put the top pole to the lowest position,insert the cable into the cable routing on the bottom pole and push inward.

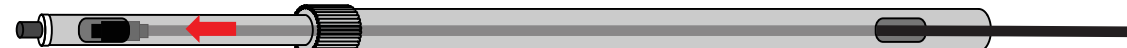

2.Draw out the top pole and continue to push inward the cable until the cable head is visible through the cable routing on the top pole .



3.Draw out the cable head from the cable routing on the top pole .

### 2.Stand Assembly:

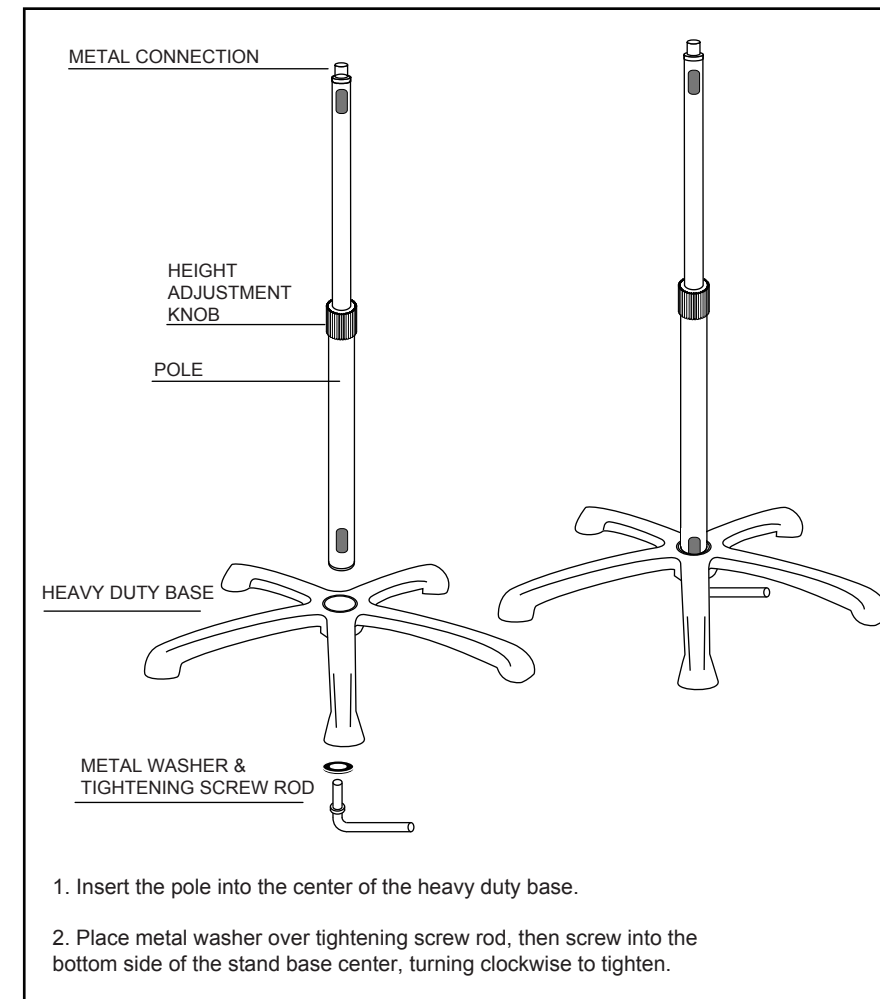

### Attaching wheels:

Connect wheels to stand base before attaching pole.

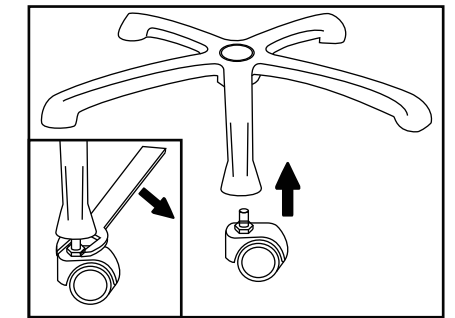

Screw wheels into floor base by hand,  
then use wrench to tighten.

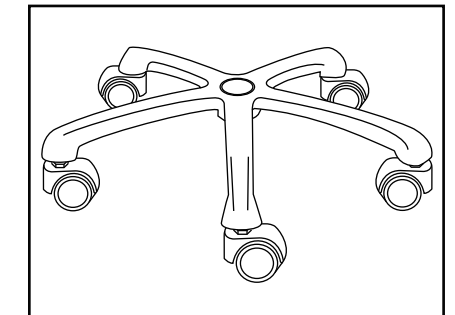

### 3.Connecting the Gooseneck Tablet Holder & Battery Case

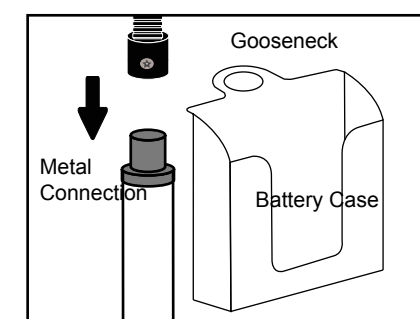

1. Place battery case over metal  
connection on the pole.

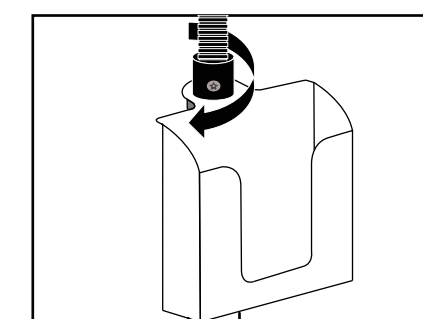

2.Place gooseneck over metal connection  
then turn clockwise to screw down until tight.

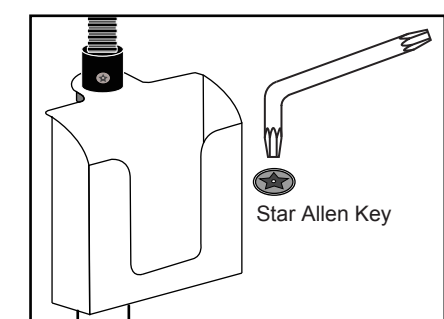

3.Use the smaller Star Allen key to tighten the  
small star meter screw inside the gooseneck.  
*Note: if meter screw is already in, unscrew  
before attaching gooseneck in step 2.*

### 4. Installing your Device and Adjusting the Tablet Holder

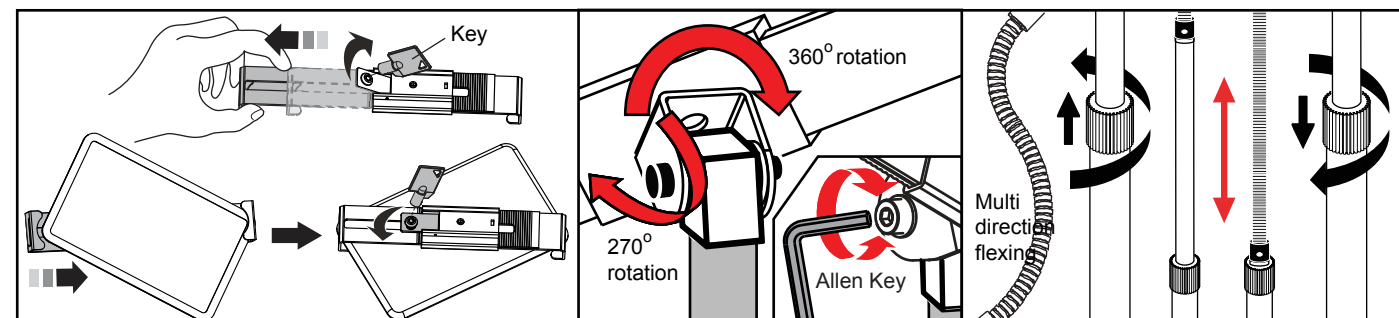

1. Insert key into lock at back of holder.Turn counter-  
clockwise to unlock, then slide to open.Insert tablet  
against fixed end,then slide down to hold tight.  
Turn key clockwise to tighten.

2. Use Allen key to adjust tension at point of  
connection between the tablet holder and  
gooseneck,flex the gooseneck to adjust the view  
angle according to your needs.

3. Rotate plastic grip counter-clockwise  
to loosen, then adjust pole to desired  
height. Rotate plastic grip clockwise to  
tighten.

SUPPORT@CTADIGITAL.COM