

# EM900F eZ.HD Series

1080p Full High Definition  
Micro Mini Metal Camera

---

*User's Manual*



Copyright © EverFocus Electronics Corp.

Release Date: February 2016

## Precautions

1. **Do not install the camera near electric or magnetic fields.** Install the camera away from TV/radio transmitters, magnets, electric motors, transformers and audio speakers since the electromagnetic fields generated from these devices may distort the video image or otherwise interfere with camera operation.
2. **Never disassemble the camera beyond the recommendations in this manual nor introduce materials other than those recommended herein.** Improper disassembly or introduction of corrosive materials may result in equipment failure or other damage.
3. **Try to avoid facing the camera toward the sun.** In some circumstances, direct sunlight may cause permanent damage to the sensor and/or internal circuits, as well as creating unbalanced illumination beyond the capability of the camera to compensate.
4. **Keep the power cable away from water and other liquids and never touch the power cord with wet hands.** Touching a wet power cord with your hands or touching the power cord with wet hands may result in electric shock.
5. **Never install the camera in areas exposed to oil, gas or solvents.** Oil, gas or solvents may result in equipment failure, electric shock or, in extreme cases, fire.
6. **Cleaning.** For cameras with interchangeable lenses, do not touch the surface of the sensor directly with the hands. Use lens tissue or a cotton tipped applicator and ethanol to clean the sensor and the camera lens. Use a damp soft cloth to remove any dirt from the camera body. Please do not use complex solvents, corrosive or abrasive agents for cleaning of any part of the camera.
7. **Do not operate the camera beyond the specified temperature, humidity or power source ratings.** This camera is suitable for indoor operation only. Use the camera at temperatures within  $-10^{\circ}\text{C}\sim 50^{\circ}\text{C}$  ( $14^{\circ}\text{F}\sim 112^{\circ}\text{F}$ ) and humidity less than 80%; this device is not rated as submersible. The input power source is 12VDC. Be sure to connect the proper + / - polarity and voltage, as incorrect polarity or too high a voltage will likely cause the camera to fail, and such damage is not covered by the warranty.
8. **Mounting.** Use care in selecting a solid mounting surface which will support the weight of the camera plus any wind, snow, ice or other loading, and securely attach the camera to the mounting surface using screws and anchors which will properly support the camera. If necessary (e.g. when mounting to drop ceilings) use a safety wire to provide additional support for the camera.

# Safety Notice

## Federal Communication Commission Interference Statement

This equipment has been tested and found to comply with the limits for a Class A digital device, pursuant to Part 15 of the FCC Rules. These limits are designed to provide reasonable protection against harmful interference in a residential installation. This equipment generates uses and can radiate radio frequency energy and, if not installed and used in accordance with the instructions, may cause harmful interference to radio communications. However, there is no guarantee that interference will not occur in a particular installation. If this equipment does cause harmful interference to radio or television reception, which can be determined by turning the equipment off and on, the user is encouraged to try to correct the interference by one of the following measures:

- Reorient or relocate the receiving antenna.
- Increase the separation between the equipment and receiver.
- Connect the equipment into an outlet on a circuit different from that to which the receiver is connected.
- Consult the dealer or an experienced radio/TV technician for help.

**FCC Caution:** Any changes or modifications not expressly approved by the party responsible for compliance could void the user's authority to operate this equipment.

This device complies with Part 15 of the FCC Rules. Operation is subject to the following two conditions: (1) This device may not cause harmful interference, and (2) this device must accept any interference received, including interference that may cause undesired operation.



**ATTENTION!** This is a class A product which may cause radio interference in a domestic environment; in this case, the user may be urged to take adequate measures.↵



This Product is RoHS compliant.↵



WEEE↵

Your EverFocus product is designed and manufactured with high quality materials and components which can be recycled and reused. This symbol means that electrical and electronic equipment, at their end-of-life, should be disposed of separately from your household waste. Please, dispose of this equipment at your local community waste collection/recycling centre. In the European Union there are separate collection systems for used electrical and electronic product.↵  
Please, help us to conserve the environment we live in!

# Contents

<b>1. Introduction.....</b>	<b>5</b>
1.1 Packing List .....	6
1.2 Features .....	6
<b>2. Overview .....</b>	<b>7</b>
<b>3. Installation and Adjustment .....</b>	<b>8</b>
<b>4. Configuration in the OSD Menu .....</b>	<b>10</b>
<b>5. Specifications.....</b>	<b>14</b>

## 1. Introduction

The EverFocus eZ.HD Series EM900F provides incredible performance in bright light or low light environments and the resolution listed in the specification from the actual camera you install. To take full advantage of the amazing resolution available from this advanced imaging technology, the EM900F uses a fixed focal lens together with 1/2.8" SONY 2.43M pixels CMOS to deliver 1080p high resolution. This camera truly provides HD images without compromising its 1080p video quality, Digital Wide Dynamic Range for clear color images in the most challenging of bright or unbalanced scene lighting conditions. The EM900F supports both NTSC and PAL scanning systems, which can be switched via OSD.

Model	Image Sensor and Lens	Resolution	Housing	Lens Type	Lens size	Environment
EM900FP1	1/2.8" SNOY 2.43M pixels CMOS	1080p	Mini Metal Case	Conical type	3.7mm	Indoor
EM900FP3				Flat face type	3.7mm	
EM900FP4				Supercone type	3.7mm	

## 1.1 Packing List

- Camera Body x 1
- User Manual x 1
- Warning Paper x 1
- Power Pigtail Cable x 1
- Power / Video Cable x 1

## 1.2 Features

- 1080p full HD with high flexibility and performance for astounding image
- 1/2.8" Sony 2.43M pixels CMOS sensor, delivering amazing high sensitivity
- Astounding image quality from the 3.7mm conical/3.7mm flat/3.7mm cone lens
- D-WDR to improve the visibility under high contrast scene
- 3D-Noise Reduction ensures less blurry moving subjects, vivid and high SN ratio images even under low light environments
- Supports 1080p, 720p & 960H analog signal output, which can be easily switched using OSD Joystick
- Compact metal case design is suitable for convert place, such as ATM
- eZ.Controller function: Control camera OSD settings and PTZ operation directly from DVR end

**2. Overview**

**Cable Description:**

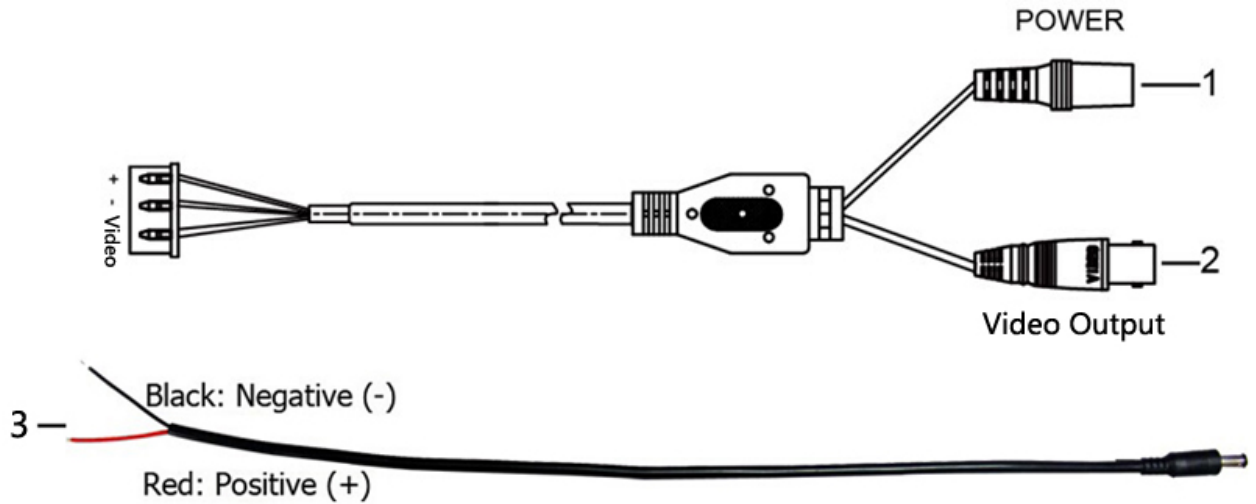

No.	Name	Descriptions
1	Power Input	Connect to a 12 VDC
2	Video Output	1080p, 720p and 960H output, using a 75 Ohm BNC-type coaxial cable.
3	DC Power Pigtail Cable	Optional power pigtail cable. The red wire is positive (+); while the black wire is negative (-).

### 3. Installation and Adjustment

1. Connect the camera to a 12 VDC power source by using the supplied **Power / Video Cable**, you can optionally use the supplied **Power Pigtail Cable** or a power adapter. (Refer to the connection diagram as below )

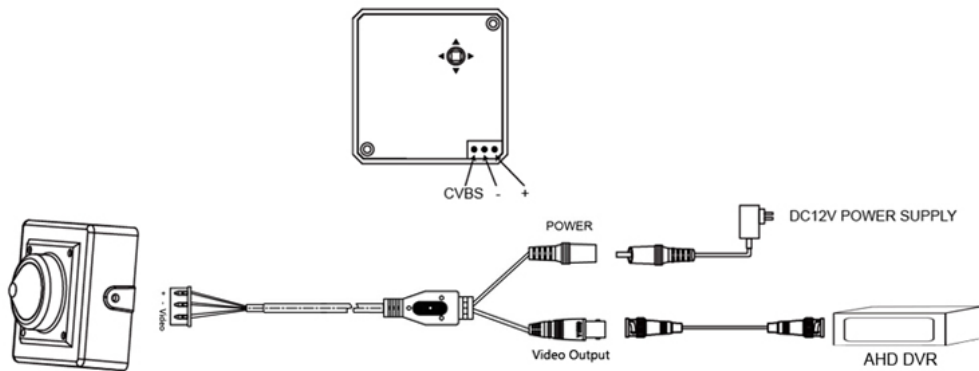

DIY CABLE CONNECTION

2. Take the camera and turn it around, then configure the OSD menu by using the Joystick.

**OSD indication as shown in the figure:**

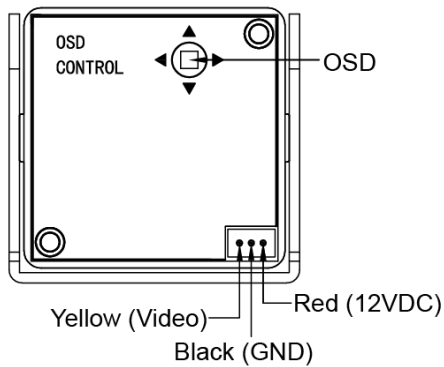

- Push the Joystick up / down to select among menu items.
- Push the Joystick left / right to adjust the level of the selected item.
- Press the Joystick to enter the submenu or exit the OSD Setup Menu.



**Note: The function button is using to control direction, and also to switch video format and video output. Please follow the detailed instruction as below to switch the camera to:**

- ✧ Switch between 1080p and 720p (Default, 1080p): Press Upward for 5 Seconds
  - ✧ Switch from HD (1080p / 720p) to 960H: Press Left for 5 Seconds
  - ✧ Switch from 960H to HD (1080p / 720p): Press Right for 5 Seconds
  - ✧ Switch between NTSC and PAL: Press Downward for 5 Seconds
3. Drill three holes on the position where you want to attach the camera. Unscrew the bracket which located at the back of the camera, then screw the bracket to these holes.

## 4. Configuration in the OSD Menu

You can use the Joystick on the rear panel of the camera to configure camera settings in the OSD menu. For details on the OSD menu structure as below:

No.	Main	Sub Menu	Sub Menu / Function			
1	Lens	DC	Indoor	Min Shu.	NTSC: 1/30	
					PAL: 1/25	
			Outdoor	Max. Shu.	NTSC: 1/60,FLK,1/240, 1/480,1/1000, 1/2000,1/5000, 1/10000, 1/50000	
					PAL: 1/50,FLK,1/200, 1/400,1/1000, 1/2000*,1/5000, 1/10000, 1/50000	
		Iris Speed	0 – 15			
Manual						
2	Exposure	Shutter	NTSC: 1/30, 1/60, FLK, 1/240, 1/480, 1/1000, 1/2000, 1/5000, 1/10000, 1/50000, X2, X4, X6, X8, X10, X15, X20, X25, X30, Auto			
			PAL: 1/25, 1/50, FLK, 1/200, 1/400, 1/1000, 1/2000, 1/5000, 1/10000, 1/50000, X2, X4, X6, X8, X10, X15, X20, X25, X30, Auto			
		AGC	0 – 15			
		Sens-up	Off			
			Auto	Sens-up	X2, X4, X6, X8, X10, X15, X20, X25, X30	
		Brightness	1-100			
		D-WDR	Off			
			On	Level	0-8	
			Auto			
		Defog	Off			
Auto	Pos/Size		Position, Size, ↑, ↓, →, ←			
	Gradation		0-2			
Default						
3	Backlight	Off				

		BLC	Level	Middle, High, Low			
			Area	Position, Size, ↑, ↓, →, ←			
			Default				
		HSBLC	Select	Area1, Area2, Area3, Area4			
			Display	Off			
				On	Position, Size, ↑, ↓, →, ←		
			Black Mask	On/Off			
			Level	0-100			
			Model	All Day			
		Night		AGC Level	0-255		
Default							
4	White Balance	ATW					
		AWC→SET					
		Indoor					
		Outdoor					
		Manual	Blue	1-500			
			Red	0-100			
		AWB					
5	Day & Night	Ext	D→N(Delay)	0-60			
			N→D(Delay)	0-60			
		Auto	D→N(AGC)	1-255			
			D→N(Delay)	0-60			
			N→D(AGC)	1-255			
			N→D(Delay)	0-60			
		Color					
		B/W	Burst	Off/On			
			IR Smart	Off			
				On	Level	0-15	
			Area	Position, Size, ↑, ↓, →, ←			
		IR PWM	Off				
0-100							
6	NR	2DNR	Middle/Low/Off/High				
		3DNR	Middle/Low/Off/High				
7	Special	Cam Title	Off				
			On	0123456789ABCDEFGHIJKLMN OPQRSTUVWXYZ▶→ ← ↑ ↓ () ^ _ █ /=&:~.,			

	D-effect	Freeze	Off/On			
		Mirror	Off, Mirror, V-flip, Rotate			
		Neg. Image	Off/On			
	Motion	On	Off			
			Select	Area1,Area2,Area3,Area4		
				Display	On	Position, Size, ↑, ↓, →, ←
			Off			
			Sensitivity	0-100		
			Color	Green, Blue, White, Red		
			Trans	1.00,0.75,0.50, 0.25		
			Alarm	View Type	Off, Block, Outline, All	
				OSD View	On/Off	
				Alarm Out	On/Off	
				Time	1-15	
	Default					
	Privacy	On	Off			
			Select	Area1,Area2,Area3,Area4		
				Display	Off	
			Color		Position, Size, ↑, ↓, →, ←	
			Mosaic		Position, Size, ↑, ↓, →, ←	
			Inv		Position, Size, ↑, ↓, →, ←	
			Color	White, Black, Red, Blue, CYAN, Yellow, Green		
			Trans	1.00,0.75,0.50, 0.25		
Default						
Language	ENG/CHN1/CHN2/GER/FRA/ITA/SPA/POL/RUS/POR/NED/TUR					
Defect	Live DPC	Off				
		On	AGC level	0-255		
	Level		0-100			
	White DPC	Off				
		On	Pos/Size	Position, Size, ↑, ↓, →, ←		
			Start	Close the iris then press		
			DPC View	Off/On		
Level	0-60					

				AGC	0-14		
				Sens-up	x2, x4, x6, x8,x10, x15, x20, x25, x30		
			Black DPC	Off			
				On	Pos/Siz	Position, Size, ↑, ↓, →, ←	
		Start			Press Enter		
		DPC View			Off/On		
		RS485	Level		0-255		
			CAM ID	0-255			
			ID Display	Off/On			
				Baud Rate	2400,4800,9600,19200 ,38400		
8	Adjust	Sharpness	Off				
			Auto	Level	0-10		
				Start AGC	0-255		
				End AGC	0-255		
		Monitor	CRT	Blue Gain	0-100		
				Red Gain	0-255		
			LCD	Gamma	User,0.45,0.50,0.55,0.60,0.65,0.70,0.75,0.80,0.85,0.90,0.95,1.00		
				Blue Gain	0-100		
				Red Gain	0-100		
				LSC	Off/On		
Video. Out		PAL/NTSC					
9	AF	AF Mode	Semi.				
			Auto				
			Manual				
		One Shot AF					
		TDN AF	On				
			Off				
Lens Init.							
10	Exit	Save& END /Reset/Not Saved					

## 5. Specifications

Part Number	EM900FP1	EM900FP3	EM900FP4
Lens Type	3.7mm Conical	3.7mm Flat	3.7mm cone
Pickup Device	1/2.8" Sony 2.43M pixels CMOS		
Video Format	NTSC/PAL(can be switched via OSD)		
Effective Pixels	1920(H) x 1080(V)		
Scanning System	Progressive Scan		
Sensitivity	0.2 Lux		
Electronic Shutter	Auto/Manual(x30~1/50,000)/FLK		
Gamma Correction	0.45		
BLC	OFF/BLC/HSBLC Selectable		
AGC	0~15 Levels		
White Balance	ATW/AWC-SET/Indoor/Outdoor/ Manual/AWB		
Sync. Mode	Internal		
Day/Night	Ext, Auto, Color, B/W		
UTC Function	Supported		
OSD Languages	English/Simplified Chinese/Traditional Chinese/German/French/Italian/ Spanish/Polish/Russian/Portuguese/Netherlands/Turkish		
DNR	2DNR/3DNR,Off		
Defog	Off/Auto		
D-WDR	On/Off/Auto		
Sens-up	Off/Auto(x2~x30)		
Mirror	Off/Mirror/V-Flip/Rotate		
Motion Detection	Off/On for 4 selectable zones		
Privacy Mask	Off/On for 4 selectable zones		
Power Source	12VDC		
Power Consumption	1.08W max.		
Operating Temperature	-10°C ~50°C / 14°F ~122°F		
Humidity	Less than 80%		
Dimensions	30x18mm/1.18"x0.71"		30x19mm/1.18"x0.74"
Weight	60g/0.132lbs		
Certifications	CE/FCC/RoHS		

**Specifications and designs are subject to change for improving the functionality of this product without notice.**

## EverFocus Electronics Corp.

### EverFocus Taiwan:

12F-1, No.79, Sec. 1, Shin-Tai Wu Road,  
Hsi-Chih, New Taipei City, Taiwan  
TEL: +886 2 2698 2334  
FAX: +886 2 2698 3943  
[www.everfocus.com.tw](http://www.everfocus.com.tw)  
[marketing@everfocus.com.tw](mailto:marketing@everfocus.com.tw)

### EverFocus China - Beijing:

Room 609, Technology Trade Building,  
Shangdi Information Industry Base,  
Haidian District, Beijing 100085, China  
TEL: +86 10 6297 3336~39  
FAX: +86 10 6297 1423  
[www.everfocus.com.cn](http://www.everfocus.com.cn)  
[marketing@everfocus.com.cn](mailto:marketing@everfocus.com.cn)

### EverFocus USA - California:

1801 Highland Avenue, Unit A, Duarte, CA 91010,  
USA  
TEL: +1 626 844 8888  
FAX: +1 626 844 8838  
[www.everfocus.com](http://www.everfocus.com)  
[sales@everfocus.com](mailto:sales@everfocus.com)

### EverFocus Europe - Germany:

Albert-Einstein-Strasse 1, D-46446  
Emmerich, Germany  
TEL: +49 2822 93940  
FAX: +49 2822 939495  
[www.everfocus.de](http://www.everfocus.de)  
[sales@everfocus.de](mailto:sales@everfocus.de)

### EverFocus China - Shenzhen:

4F, No. 2, D4 Building, Wan Yelong  
Industrial Park, Tangtou Road, Shiyan,  
Baoan, Shenzhen, Guangdong 518101, China  
TEL: +86 755 2765 1313  
FAX: +86 755 2765 0337  
[www.everfocus.com.cn](http://www.everfocus.com.cn)  
[marketing@everfocus.com.cn](mailto:marketing@everfocus.com.cn)

### EverFocus Japan:

3F Kuramochi, BuildingII 2-2-3 Koto-Bashi,  
Sumida-Ku Tokyo, 130-0022, Japan  
TEL: +81 3 5625 8188  
FAX: +81 3 5625 8189  
[www.everfocus.co.jp](http://www.everfocus.co.jp)  
[info@everfocus.co.jp](mailto:info@everfocus.co.jp)

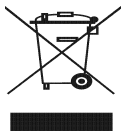

Your EverFocus product is designed and manufactured with high quality materials and components which can be recycled and reused.  
This symbol means that electrical and electronic equipment, at their end-of-life, should be disposed of separately from your household waste.  
Please, dispose of this equipment at your local community waste collection/recycling centre.  
In the European Union there are separate collection systems for used electrical and electronic product.  
Please, help us to conserve the environment we live in!

Ihr EverFocus Produkt wurde entwickelt und hergestellt mit qualitativ hochwertigen Materialien und Komponenten, die recycelt und wieder verwendet werden können.  
Dieses Symbol bedeutet, dass elektrische und elektronische Geräte am Ende ihrer Nutzungsdauer vom Hausmüll getrennt entsorgt werden sollen.  
Bitte entsorgen Sie dieses Gerät bei Ihrer örtlichen kommunalen Sammelstelle oder im Recycling Centre.  
Helfen Sie uns bitte, die Umwelt zu erhalten, in der wir leben!



**EverFocus**