

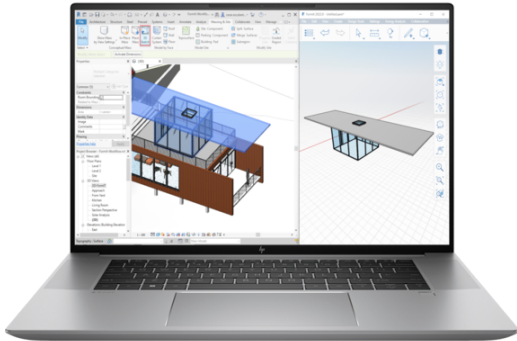

HP ZBook Studio 16 inch G10 Mobile Workstation PC Wolf Pro Security Edition (894D5UT)



Overview

Powerfully immersive. Perfectly sized

Be ready when inspiration strikes. Packed with professional performance in an incredibly sleek PC that comfortably fits in your bag, the ZBook Studio is engineered to get you in the zone and help you stay focused. Now you can build complex assemblies, render in real time or visualize data—from anywhere.

Pro-grade performance for your biggest projects

Push your 3D workflows further with an Intel® CPU,[1] integrated or discrete graphics[2] and upgraded memory.

See more of your content with less scrolling

Bring projects to life on a brilliant display and 16:10 aspect ratio so you can see more vertical content.

Create and collaborate on the go

Work effectively on a light laptop with a long-lasting battery and AI Noise Suppression software.[5]

A work laptop you'll want to game on

Enjoy fast, smooth gameplay with an NVIDIA RTX™ professional or GeForce RTX™ GPU.[2] Highlight favorite keys and create custom key maps with Z Light Space software[9] and a RGB keyboard with per-key LED backlighting. [8]

Features

Windows 11

Work anywhere without compromising on performance or security with Windows 11 powered by HP's collaboration and connectivity technology.

Intel® Core™ i9 processor

Get high-end performance for intensive tasks like rendering and video editing with the Intel® Core™ i9 processor.^[1]

HP Z Turbo Drive High-speed Storage

Work without limits in any location with local PCIe storage that's up to 6x faster than SATA SSD, and up to 21x faster than traditional HDD storage.^[3]

HP Fast Charge

Ultra-fast recharge takes you from zero to 50% charge in just 30 minutes.^[4]

Spill-resistant Keyboard

Accidents happen - which is why we designed our keyboard with a drain hole, so minor spills flow out the bottom for easy cleanup.

Industry-leading security features

Advanced security features come standard. System safeguards like HP Sure Start – the industry's first self-healing BIOS – mean your device is locked down tight, so your data and identity are too.

[1] Multicore is designed to improve performance of certain software products. Not all customers or software applications will necessarily benefit from use of this technology. Performance and clock frequency will vary depending on application workload and your hardware and software configurations. Intel's numbering, branding and/or naming is not a measurement of higher performance.

[2] Optional feature that must be configured at purchase.

[5] AI Noise Reduction is delivered automatically through Windows update or can be downloaded from <https://support.hp.com/us-en/drivers> when available. Requires Windows 10 or higher, compatible with internal PC speakers, microphone and analog headsets. The DNN Noise Reduction setting can be configured through the Application HP Audio Control.

[8] RGB keyboard is an optional, configurable feature. Available only in the US, UK, Germany and France only.

[3] For hard drives, GB = 1 billion bytes. TB = 1 trillion bytes. Actual formatted capacity is less. Up to 30GB (for Windows 10) of system disk is reserved for system recovery software.

[4] Recharges the battery up to 50% within 30 minutes when the system is off or in standby mode. Power adapter with a minimum capacity of 65 watts is required. After charging has reached 50% capacity, charging will return to normal. Charging time may vary +/-10% due to System tolerance.

Specifications

Operating system	Windows 11 Pro ^[1]
Processor family	13th Generation Intel® Core™ i9 processor
Processor	Intel® Core™ i9-13900H (up to 5.4 GHz with Intel® Turbo Boost Technology, 24 MB L3 cache, 14 cores, 20 threads)
Memory	32 GB DDR5-5600 MHz RAM (2 x 16 GB)
Memory Slots	2 SODIMM; supports dual channel
Internal Storage	1 TB PCIe® NVMe™ TLC SSD
Memory card device	1 microSD 7.1 media card reader
Graphics	Integrated
Graphics (integrated)	Intel® Iris® Xe Graphics
Display	40.6 cm (16") diagonal, WUXGA (1920 x 1200), IPS, narrow bezel, anti-glare, 400 nits, 100% sRGB
Display	16" diagonal, WUXGA (1920 x 1200), IPS, narrow bezel, anti-glare, 400 nits, 100% sRGB ^[15,16,27,29]
Display size (diagonal)	40.6 cm (16")
Display size (diagonal)	16"
Audio	Audio by Bang & Olufsen, Quad-speaker audio (2 tweeters & 2 Quad woofers), 2 Top Facing Microphone dual array digital microphones, functions keys for volume up and down, combo microphone/headphone jack, HD audio with 200Hz Bass Roll off
Minimum dimensions (W x D x H)	35.6 x 24.2 x 1.9 cm (non-touch); 35.6 x 24.2 x 1.8 cm (touch)
Minimum dimensions (W x D x H)	14.02 x 9.54 x 0.76 in (non-touch); 14.02 x 9.54 x 0.72 in (touch)
Weight	Starting at 1.73 kg (Weight varies by configuration and components.)
Weight	Starting at 3.81 lb (Weight varies by configuration and components.)
Keyboard	HP RGB Z Command Keyboard – spill-resistant, full-size, backlit keyboard with drain and DuraKeys
Pointing device	ClickPad Glass with multi-touch gesture support, taps enabled as default
Camera	720p HD IR camera
Ports	1 power connector; 1 headphone/microphone combo; 2 Thunderbolt™ 4 with USB4™ Type-C® 40Gbps signaling rate (USB Power Delivery, DisplayPort™ 1.4, HP Sleep and Charge) ^[12]
Ports	1 Super Speed USB Type-A 5Gbps signaling rate (charging); 1 SuperSpeed USB Type-C® 10Gbps signaling rate (USB Power Delivery, DisplayPort™ 1.4)
Wireless	Intel® Wi-Fi 6E AX211 (2x2) and Bluetooth® 5.3 wireless card, vPro®
Power	200 W external AC power adapter ^[48]
Battery type	HP Long Life 6-cell, 86 Wh Li-ion polymer

Battery recharge time	Supports battery fast charge: approximately 50% in 30 minutes
Ecolabels	TCO Certified
Energy star certified	ENERGY STAR® certified
Management features	HP Power Manager ^[13]
Sustainable impact specifications	Low Halogen
Security management	Absolute persistence module; HP Credential Manager; HP Power On Authentication; Master Boot Record security; Pre-boot authentication; Windows Defender; HP Manageability Integration Kit; HP BIOSphere Gen6; HP Sure Start Gen6; HP Sure Admin; HP Image Assistant; Nano Security Lock Slot; HP Image Assistant Gen4.6; HP Client Security Manager Gen7; Trusted Platform Module TPM 2.0; HP Privacy Key ^[8,34,35,37,38,39,43,49]
Software included	Bing search for IE11; HP Hotkey Support; HP Noise Cancellation Software; HP Performance Advisor; HP Support Assistant; Native Miracast support; HP Connection Optimizer; myHP; HP Privacy Settings; Data Science Stack; HP Easy Clean; HP PC Hardware Diagnostics; Windows 10 Cloud Recovery Client; HP Z Light Space; HP Camera & Super Resolution Software; Microsoft 365 and Office (sold separately and Internet access required for activation); HP Presence ^[25,28,30,31,33,51,52]
UPC number	196188217689

Additional specifications

Additional information about HP in the countries	hp.com
Available software	HP Smart Support ^[19]
Battery brand	HP
Battery capacity	86
Battery capacity uom	Wh
Battery cells number	6
Battery life	Long Life
Battery type	Li-ion polymer
Bluetooth version	Bluetooth® 5.3
Camera Infrared	IR
Camera resolution (vertical)	720p
Camera resolution standard	HD
Color gamut	100% sRGB
Datasheet photo 1	AHID/f19575baf8c2ef5cc46835a71fed71bba9c550e6
Datasheet photo 3	AHID/9240c928811020e3c08d170fb96b5892b6c7bc38
Datasheet photo 4	AHID/1a76ab6d3b182a42a5c3a8cba7b7def70cc094ed
Datasheet photo 5	AHID/5b93b92dd8f2823290cdfd05624fe9d7ee0174bd
Display	16" diagonal WUXGA display
Display	40.6 cm (16") diagonal WUXGA display
Display bezel	narrow bezel
Display brightness	400
Display brightness uom	nits
Display panel technology	IPS
Display resolution (pixels)	1920 x 1200
Display resolution standard	WUXGA
Display size (diagonal) uom	"
Display size (diagonal, imperial)	16
Display size (diagonal, metric)	40.6
Display size (diagonal, metric) uom	cm
Display surface treatment	anti-glare
ECC memory	non-ECC

External I/O ports footnote number	[12]
Fingerprint reader	Fingerprint Sensor
Graphic card footnote number	[12,18,22,32]
Graphics	Discrete
Graphics (discrete)	NVIDIA® GeForce RTX™ 4080 (12 GB GDDR6X dedicated)
Graphics card brand	NVIDIA®
Graphics card family	GeForce®
Graphics card memory size	12
Graphics card memory size uom	GB
Graphics card memory type	GDDR6X
I/O Port location	Right side
I/O Port location	Left side
Keyboard backlight	backlit
Keyboard features	Spill-resistant
Keyboard protection	Durakeys
Keyboard size	Full-size
Legal tagline	HP recommends Windows 11 Pro for business
Memory and storage	32 GB memory; 1 TB SSD storage
Memory layout (slots & size)	2 x 16 GB
Memory module type	DIMM
Memory size	32
Memory size uom	GB
Memory speed	5600
Memory speed uom	MHz
Memory type	DDR5
Model Number	RTX™ 4080
Number of memory slots	2
Playbook TS icon OS	http://h10003.www1.hp.com/digmedialib/prodimg/lowres/c03905482.png
Playbook TS icon battery life	http://h10003.www1.hp.com/digmedialib/prodimg/lowres/c03905264.png
Playbook TS icon connectivity	http://h10003.www1.hp.com/digmedialib/prodimg/lowres/c08201987.png
Playbook TS icon dimensions NB	https://h10003.www1.hp.com/digmedialib/prodimg/lowres/c08250394.png
Playbook TS icon display NB	http://h10003.www1.hp.com/digmedialib/prodimg/lowres/c08205649.png
Playbook TS icon graphics	https://h10003.www1.hp.com/digmedialib/prodimg/lowres/c08169202.png
Playbook TS icon memory	https://h10003.www1.hp.com/digmedialib/prodimg/lowres/c08267700.png
Playbook TS icon processor	https://h10003.www1.hp.com/digmedialib/prodimg/lowres/c08201972.png

Playbook TS icon storage	http://h10003.www1.hp.com/digmedialib/prodimg/lowres/c08192819.png
Playbook TS icon weight imperial	http://h10003.www1.hp.com/digmedialib/prodimg/lowres/c05790117.png
Playbook TS icon weight metric	https://h10003.www1.hp.com/digmedialib/prodimg/lowres/c08267650.png
Processor Brand	Intel®
Processor cache	24 MB L3
Processor core	14
Processor family	Core™ i9
Processor frequency technology	Intel® Turbo Boost Technology
Processor generation	13th Generation
Processor maximum frequency	5.4
Processor maximum frequency uom	GHz
Processor model	13900
Processor threads	20
Product long name specifications	HP ZBook Studio 16 inch G10 Mobile Workstation PC Wolf Pro Security Edition, 16", Windows 11 Pro, Intel® Core™ i9, 32GB RAM, 1TB SSD, NVIDIA® GeForce® RTX™ 4080, WUXGA
Product short name specifications	HP ZBook Studio 16 inch G10 Mobile Workstation PC Wolf Pro Security Edition, 16", Intel® Core™ i9, 32GB RAM, 1TB SSD
Security Software Licenses	HP Wolf Pro Security Edition (1 year)
Standard memory note	Transfer rates up to 5600 MT/s.
Storage capacity	1
Storage capacity uom 01	TB
Storage interface 01	PCIe®
Storage interface protocol 01	NVMe™
Storage memory technology 01	TLC
Storage type	SSD
Storage type 01	SSD
UNSPSC code	43211503
Wireless Model	Wi-Fi 6E AX211
Wireless antenna	2x2
Wireless standard	Wi-Fi 6E
Wireless supplier	Intel®
vPro enabled	vPro®

[1] Not all features are available in all editions or versions of Windows. Systems may require upgraded and/or separately purchased hardware, drivers, software or BIOS update to take full advantage of Windows

functionality. Windows is automatically updated and enabled. High speed internet and Microsoft account required. ISP fees may apply and additional requirements may apply over time for updates. See <http://www.windows.com>.

[8] HP Tamper Lock is an optional feature that must be configured at the factory and requires a supervisor password be established prior to use.

[12] Multi-Function USB-C port works with Discrete Graphics and Intel(r) Iris Xe Graphics. Note: For Nvidia Discrete Gfx, it can support HDMI 2.1 except GPU of QN20-P1 SKU(HDMI2.0 support).

[13] Manage and monitor your battery's performance and condition and customize charging options with the easy-to-use HP Power Manager dashboard.

[15] UHD content required to view UHD images.

[16] HD content required to view HD images.

[19] HP Smart Support automatically collects the telemetry necessary upon initial boot of the product to deliver device-level configuration data and health insights and is available preinstalled on select products, thru HP Factory Configuration Services; or it can be downloaded. For more information about how to enable HP Smart Support or for download, please visit <http://www.hp.com/smart-support>.

[25] Data Science Stack is available on select skus only.

[27] Display options may be limited to specific CPU / GPU Configurations.

[28] HP Z Light space is an optional feature, requires Windows 10 or higher and must be configured at hardware purchase.

[29] Resolutions are dependent upon monitor capability, and resolution and color depth settings.

[30] Available on select HP PCs with Windows 10 and higher and Intel processors.

[31] Miracast is a wireless technology your PC can use to project your screen to TVs, projectors, and streaming media players that also support Miracast. You can use Miracast to share what you're doing on your PC and present a slide show. For more information: <http://windows.microsoft.com/en-us/windows-8/project-wireless-screen-miracast>.

[33] HP Connection Optimizer requires Windows 10.

[34] HP BIOSphere Gen6 features may vary depending on the platform and configuration.

[35] Absolute agent is shipped turned off, and will be activated when customers activate a purchased subscription. Subscriptions can be purchased for terms ranging multiple years. Service is limited, check with Absolute for availability outside the U.S. The Absolute Recovery Guarantee is a limited warranty. Certain conditions apply. For full details visit: <http://www.absolute.com/company/legal/agreements/computrace-agreement>. Data Delete is an optional service provided by Absolute Software. If utilized, the Recovery Guarantee is null and void. In order to use the Data Delete service, customers must first sign a Pre-Authorization Agreement and either obtain a PIN or purchase one or more RSA SecurID tokens from Absolute Software.

[37] HP Manageability Integration Kit can be downloaded from <http://www.hp.com/go/clientmanagement>.

[38] Security lock for security slot is sold separately.

[39] HP Client Security Manager Gen7 requires Windows and is available on the select HP Elite and Pro PCs.

[43] HP Sure Start Gen6 is available on select HP PCs.

[48] 150W Power Adapter is not available with Nvidia RTX™ Graphics

[49] HP Sure Admin requires Windows 10 or higher, HP BIOS, HP Manageability Integration Kit from <http://www.hp.com/go/clientmanagement> and HP Sure Admin Local Access Authenticator smartphone app from the Android or Apple store.

[51] HP Easy Clean requires Windows 10 RS3 and will disable the keyboard, touchscreen, and clickpad only. Ports are not disabled. See user guide for clean.

[52] Select HP Products are enhanced with HP Presence. Features vary by platform. HP conferencing features require Windows and the latest myHP app, available over the air or for download via sofaq on the HP Support website. Planned availability in spring 2023.



Services

HP Care Pack Services

★ : Recommended

Personal Systems Hardware Support Onsite Service

HP 3 year Next Business Day Response Onsite Notebook Hardware Support	U02BQE ★
HP 1 year Post Warranty Next Business Day Response Onsite Notebook Hardware Support	UD0P5PE
HP 3 year Next Business Day Response Onsite w/Accidental Damage Protection NB HW Supp	U02BVE
HP 3 year Next Business Day Response Onsite w/Defective Media Retention NB HW Supp	U02BYE
HP 3y NBD Resp Onsite w/Accidental Damage Protection/Defective Media Retention NB HW Supp	U02C1E
HP 4 year Next Business Day Response Onsite Notebook Hardware Support	U02BRE
HP 4 year Next Business Day Response Onsite w/Accidental Damage Protection NB HW Supp	U02BWE
HP 4 year Next Business Day Response Onsite w/Defective Media Retention NB HW Supp	U02BZE
HP 4y NBD Resp Onsite w/Accidental Damage Protection/Defective Media Retention NB HW Supp	U02C2E
HP 5 year Next Business Day Response Onsite Notebook Hardware Support	U02BSE
HP 5 year Next Business Day Response Onsite w/Accidental Damage Protection NB HW Supp	U02BXE
HP 5 year Next Business Day Response Onsite w/Defective Media Retention NB HW Supp	U02C0E
HP 5y NBD Resp Onsite w/Accidental Damage Protection/Defective Media Retention NB HW Supp	U02C3E

Personal Systems Commercial Care Pack Services

HP 4 year Active Care Next Business Day Response Onsite Notebook Hardware Support	U17XSE ★
HP 5 year Active Care Next Bus Day Resp Onsite w/Accidental Damage Protection NB HW Supp	U17XXE ★
HP 1 year PW Next Bus Day Resp Onsite w/Defective Media Retention/TravelCoverage NB HW Supp	UD0S9PE
HP 1 year Post Warranty Next Business Day Response Onsite w/Travel Coverage NB HW Supp	UD0S8PE
HP 1 year Post Warranty Pickup and Return Notebook Hardware Support	UD5P1PE
HP 3 Year SmartFriend Pro Stand Alone Software Support	U35R2E
HP 3 year Active Care Next Bus Day Resp Onsite w/Accidental Damage Protection NB HW Supp	U17XVE

HP 3 year Active Care Next Bus Day Resp Onsite w/Defective Media Retention NB HW Supp	U17XYE
HP 3 year Active Care Next Business Day Response Onsite Notebook Hardware Support	U17XRE
HP 3 year Active Care Next Business Day Response Onsite Notebook Solution Support	U48R9E
HP 3 year Active Care Next Business Day Response Onsite w/Accidental Damage Protection NB SOLU Supp	U48RHE
HP 3 year Active Care Next Business Day Response Onsite w/Defective Media Retention NB SOLU Supp	U48RDE
HP 3 year Active Care Next Business Day Response Onsite w/Travel Coverage NB HW Supp	U17Y1E
HP 3 year NBD Onsite w/Accidental Damage Protection/Defective Media Retention NB SOLU Supp	U48RXE
HP 3 year Next Bus Day Response Onsite w/Defective MediaRetention/Travel Coverage MWS HW Supp	U02CGE
HP 3 year Next Business Day Response Onsite Notebook Solution Support	U48RLE
HP 3 year Next Business Day Response Onsite w/Accidental Damage Protection NB Solution Support	U48RTE
HP 3 year Next Business Day Response Onsite w/Defective Media Retention NB Solution Support	U48RQE
HP 3 year Next Business Day Response Onsite w/TRV/Accidental Damage Protection NB HW Supp	U02CKE
HP 3 year Next Business Day Response Onsite w/Travel Coverage NB HW Supp	U02CBE
HP 3 year Pickup and Return w/Accidental Damage Protection (1 Claim) Notebook HW Supp	U09K9E
HP 3 year Pickup and Return w/Accidental Damage Protection 1 Claim Notebook Solution Support	U48S5E
HP 3 year Pickup and Return w/Accidental Damage Protection Notebook Hardware Support	U02C7E
HP 3 year Pickup and Return w/Accidental Damage Protection Notebook Solution Support	U48S2E
HP 3 year Pickup and Return w/Accidental Damage Protection/Defective Media Retention NB SOLU Supp	U48SCE
HP 3 year Pickup and Return w/Defective Media Retention Notebook Hardware Support	U09K2E
HP 3 year Pickup and Return w/Defective Media Retention Notebook Solution Support	U48S8E
HP 3 year Wolf Protect and Trace Hardware Support	U05GME
HP 3y Active Care NBD ONS w/Accidental Damage Protection/Defective MediaRetention NB HW Supp	U42DCE
HP 3y Active Care Next Bus Day Resp Onsite w/TRV/Defective Media Retention NB HW Supp	U22X9E

HP 3y Active Care/Wolf Protect and Trace Next Bus Day Response Onsite (models 2021+) NB HW Supp	U05G2E
HP 3y NBD Resp ONS w/TRV/Accidental Damage Protection/Defective Media Retention NB HW Supp	U02CNE
HP 3y Pickup and Return w/Defective Media Retention/Accidental Damage Protection NB HW Supp	U09K5E
HP 4 year Active Care Next Bus Day Resp Onsite w/Accidental Damage Protection NB HW Supp	U17XWE
HP 4 year Active Care Next Business Day Onsite w/Defective Media Retention Notebook Hardware Support	U17XZE
HP 4 year Active Care Next Business Day Response Onsite Notebook Solution Support	U48RBE
HP 4 year Active Care Next Business Day Response Onsite w/Accidental Damage Protection NB SOLU Supp	U48RJE
HP 4 year Active Care Next Business Day Response Onsite w/Defective Media Retention NB SOLU Supp	U48RFE
HP 4 year Active Care Next Business Day Response Onsite w/Travel Coverage NB HW Supp	U17Y2E
HP 4 year NBD Onsite w/Accidental Damage Protection/Defective Media Retention NB SOLU Supp	U48RYE
HP 4 year Next Business Day Onsite w/Defective Media Retention/Travel Coverage NB HW Supp	U02CHE
HP 4 year Next Business Day Response Onsite Notebook Solution Support	U48RME
HP 4 year Next Business Day Response Onsite w/Accidental Damage Protection NB Solution Support	U48RVE
HP 4 year Next Business Day Response Onsite w/Defective Media Retention NB Solution Support	U48RRE
HP 4 year Next Business Day Response Onsite w/TRV/Accidental Damage Protection NB HW Supp	U02CLE
HP 4 year Next Business Day Response Onsite w/Travel Coverage NB HW Supp	U02CCE
HP 4 year Pickup and Return Notebook Hardware Support	U02C4E
HP 4 year Pickup and Return Notebook Solution Support	U48S0E
HP 4 year Pickup and Return w/Accidental Damage Protection (1 Claim) Notebook HW Supp	U09KBE
HP 4 year Pickup and Return w/Accidental Damage Protection 1 Claim Notebook Solution Support	U48S6E
HP 4 year Pickup and Return w/Accidental Damage Protection Notebook Hardware Support	U02C8E
HP 4 year Pickup and Return w/Accidental Damage Protection Notebook Solution Support	U48S3E
HP 4 year Pickup and Return w/Accidental Damage Protection/Defective Media Retention NB SOLU Supp	U48SDE
HP 4 year Pickup and Return w/Defective Media Retention Notebook Hardware Support	U09K3E

HP 4 year Pickup and Return w/Defective Media Retention Notebook Solution Support	U48S9E
HP 4 year Wolf Protect and Trace Hardware Support	U05GNE
HP 4y Active Care NBD ONS w/Accidental Damage Protection/Defective MediaRetention NB HW Supp	U42DDE
HP 4y Active Care Next Bus Day Resp Onsite w/TRV/Defective Media Retention NB HW Supp	U22XBE
HP 4y Active Care/Wolf Protect and Trace Next Bus Day Response Onsite (models 2021+) NB HW Supp	U05G3E
HP 4y NBD Resp ONS w/TRV/Accidental Damage Protection/Defective Media Retention NB HW Supp	U08SWE
HP 4y Pickup and Return w/Defective Media Retention/Accidental Damage Protection NB HW Supp	U09K6E
HP 5 year Active Care Next Business Day Onsite w/Defective Media Retention Notebook Hardware Support	U17Y0E
HP 5 year Active Care Next Business Day Response Onsite Notebook Hardware Support	U17XTE
HP 5 year Active Care Next Business Day Response Onsite Notebook Solution Support	U48RCE
HP 5 year Active Care Next Business Day Response Onsite w/Accidental Damage Protection NB SOLU Supp	U48RKE
HP 5 year Active Care Next Business Day Response Onsite w/Defective Media Retention NB SOLU Supp	U48RGE
HP 5 year Active Care Next Business Day Response Onsite w/Travel Coverage NB HW Supp	U17Y3E
HP 5 year NBD Onsite w/Accidental Damage Protection/Defective Media Retention NB SOLU Supp	U48RZE
HP 5 year Next Business Day Onsite w/Defective Media Retention/Travel Coverage NB HW Supp	U02CJE
HP 5 year Next Business Day Response Onsite Notebook Solution Support	U48RNE
HP 5 year Next Business Day Response Onsite w/Accidental Damage Protection NB Solution Support	U48RWE
HP 5 year Next Business Day Response Onsite w/Defective Media Retention NB Solution Support	U48RSE
HP 5 year Next Business Day Response Onsite w/TRV/Accidental Damage Protection NB HW Supp	U02CME
HP 5 year Next Business Day Response Onsite w/Travel Coverage NB HW Supp	U02CDE
HP 5 year Pickup and Return Notebook Hardware Support	U02C5E
HP 5 year Pickup and Return Notebook Solution Support	U48S1E
HP 5 year Pickup and Return w/Accidental Damage Protection (1 Claim) Notebook HW Supp	U09KCE
HP 5 year Pickup and Return w/Accidental Damage Protection 1 Claim Notebook Solution Support	U48S7E

HP 5 year Pickup and Return w/Accidental Damage Protection Notebook Hardware Support	U02C9E
HP 5 year Pickup and Return w/Accidental Damage Protection Notebook Solution Support	U48S4E
HP 5 year Pickup and Return w/Accidental Damage Protection/Defective Media Retention NB SOLU Supp	U48SFE
HP 5 year Pickup and Return w/Defective Media Retention Notebook Hardware Support	U09K4E
HP 5 year Pickup and Return w/Defective Media Retention Notebook Solution Support	U48SBE
HP 5 year Wolf Protect and Trace Hardware Support	U05GQE
HP 5y Active Care NBD ONS w/Accidental Damage Protection/Defective MediaRetention NB HW Supp	U42DFE
HP 5y Active Care Next Bus Day Resp Onsite w/TRV/Defective Media Retention NB HW Supp	U22XCE
HP 5y Active Care/Wolf Protect and Trace Next Bus Day Response Onsite (models 2021+) NB HW Supp	U05G4E
HP 5y NBD Resp ONS w/TRV/Accidental Damage Protection/Defective Media Retention NB HW Supp	U02CQE
HP 5y Pickup and Return w/Defective Media Retention/Accidental Damage Protection NB HW Supp	U09K7E
HP Onsite Battery Replacement (No CSR 1 time replacement) (High End) Hardware Support	U9UW8E
HP Pickup and Return Battery Replacement (No CSR 1 time replacement) (High End) HW Supp	U9UW7E
HP Recover Hard Disk Data Svc, 9x5, 3 year	UE372E
OSRest/DRS/SWSup/PROMO HW ONS Only, 3 yr	U9AN7E

Accessories

Keyboards/Mice and Input Devices

★ : Recommended

Mice

HP 935 Creator Wireless Mouse	1D0K8AA
-------------------------------	---------

Keyboards

HP 975 Dual-Mode Wireless Keyboard	3Z726AA
------------------------------------	---------

Security and Protection

PC Locks

HP Nano Keyed Cable Lock	1AJ39AA
--------------------------	---------

Cases and Covers

Backpacks

HP Prelude Backpack 15.6	1E7D6AA
--------------------------	---------

HP Prelude Pro 15.6-inch Recycled Backpack	1X644AA
--	---------

HP Prelude Pro 15.6-inch Recycled Backpack	1X644UT
--	---------

HP Renew Business 17.3-inch Laptop Backpack	3E2U5A6
---	---------

HP Renew Business 17.3-inch Laptop Backpack	3E2U5AA
---	---------

HP Renew Business 17.3-inch Laptop Backpack	3E2U5UT
---	---------

HP Renew Executive 16-inch Laptop Backpack	6B8Y1AA
--	---------

Cases

HP Prelude Pro 15.6-inch Recycled Top Load	1X645AA
--	---------

HP Prelude Pro 15.6-inch Recycled Top Load	1X645UT
--	---------

HP Prelude Pro Rec 15.6 TL (Bulk 12)	1X645A6
--------------------------------------	---------

HP Renew Business 15.6-inch Laptop Bag	3E5F8A6
--	---------

HP Renew Business 15.6-inch Laptop Bag	3E5F8AA
--	---------

HP Renew Business 15.6-inch Laptop Bag	3E5F8UT
--	---------

HP Renew Business 17.3-inch Laptop Bag	3E2U6AA
--	---------

HP Renew Business 17.3-inch Laptop Bag	3E2U6UT
--	---------

HP Renew Executive 16-inch Laptop Bag	6B8Y2AA
---------------------------------------	---------

Audio/Multimedia and Communication Devices

Headsets

Poly D261N Headset

7FOJ6AA

Monitors

Business Monitors

★ : Recommended

E-Series

HP E22 G5 FHD Monitor	6N4E8AA
HP E23 G4 FHD Monitor	9VF96A8
HP E23 G4 FHD Monitor	9VF96AA
HP E24 G5 FHD Monitor	6N6E9AA
HP E24i G4 WUXGA Monitor	9VJ40AA
HP E24q G5 QHD Monitor	6N4F1AA
HP E24t G5 FHD Touch Monitor	6N6E6AA
HP E27 G5 FHD Monitor	6N4E2AA
HP E27q G5 QHD Monitor	6N6F2AA

P-Series

HP P22 G5 FHD Monitor	64X86AA
HP P22h G5 FHD Monitor	64W30AA
HP P24 G5 FHD Monitor	64X66AA
HP P24h G5 FHD Monitor	64W34AA
HP P27 G5 FHD Monitor	64X69AA
HP P27h G5 FHD Monitor	64W41AA

Z Displays

HP Z24f G3 FHD Display	3G828AA
HP Z24m G3 QHD Conferencing Display	4Q8N9AA
HP Z24n G3 WUXGA Display	1C4Z5AA
HP Z24q G3 QHD Display	4Q8N4AA
HP Z27q G3 QHD Display	1C4Z7AA
HP Z32k G3 4K USB-C Display	50U19AA
HP Z34c G3 WQHD Curved Display	30A19AA

Hybrid Work Solutions

Audio

★ : Recommended

Audio Accessories

Poly BT700 USB-A Bluetooth Adapter	786C4AA
Poly BT700 USB-C Bluetooth Adapter	786C5AA
Poly DA75 USB to QD Adapter	786C6AA
Poly DA85 USB to QD Adapter	786C7AA
Poly DA85-M USB to QD Adapter	786C8AA
Poly Savi 7310 Headset (Teams)	783N2AA
Poly Savi 7320 Headset	783N1AA
Poly Savi 7320 Headset (Teams)	783N3AA
Poly Savi 8210/8220 Universal Power Supply - 9V 500mA	783M9AA
Poly Voyager Office Base	786C9AA
Poly Voyager Office Base Teams	786D0AA

Wired Headset

Poly Blackwire 3210 USB-A Headset (Bulk Qty.50)	77R25AA
Poly Blackwire 3210 USB-A Monoaural Headset (Bulk Qty.50)	77R25A6
Poly Blackwire 3210 USB-C Cable Black Headset	77R26AA
Poly Blackwire 3210 USB-C Headset	77R27AA
Poly Blackwire 3210 USB-C Headset (Bulk Qty.50)	77R27A6
Poly Blackwire 3215 USB-A Cable Black Headset	77R24AA
Poly Blackwire 3215 USB-A Headset	77R23AA
Poly Blackwire 3215 USB-A Monoaural Headset (Bulk Qty.50)	77R23A6
Poly Blackwire 3215 USB-C Headset	77R34AA
Poly Blackwire 3215 USB-C Headset (Bulk Qty.50)	77R34A6
Poly Blackwire 3220 USB-A Black Headset	77R32AA
Poly Blackwire 3220 USB-A Headset	77R33AA
Poly Blackwire 3220 USB-A Headset (Bulk Qty.50)	77R33A6
Poly Blackwire 3220 USB-C Cable Black Headset	77R30AA
Poly Blackwire 3220 USB-C Headset	77R31AA
Poly Blackwire 3220 USB-C Headset (Bulk Qty.50)	77R31A6
Poly Blackwire 3225 USB-A Headset	77R29AA
Poly Blackwire 3225 USB-A Stereo Headset (Bulk Qty.50)	77R29A6

Poly Blackwire 3225 USB-C Headset	77R28AA
Poly Blackwire 3225 USB-C Headset (Bulk Qty.50)	77R28A6
Poly Blackwire 3310 Microsoft Teams Certified USB-A Headset	767F6AA
Poly Blackwire 3310 Microsoft Teams Certified USB-C Headset	760Q7AA
Poly Blackwire 3310 USB-A Headset	767F7AA
Poly Blackwire 3310 USB-C Headset	767F8AA
Poly Blackwire 3315 Microsoft Teams Certified USB-A Headset	76J13AA
Poly Blackwire 3315 Microsoft Teams Certified USB-C Headset	76J15AA
Poly Blackwire 3315 USB-A Headset	76J12AA
Poly Blackwire 3315 USB-C Headset	76J14AA
Poly Blackwire 3320 Microsoft Teams Certified USB-C Headset	76J19AA
Poly Blackwire 3320 USB-C Headset	76J18AA
Poly Blackwire 3325 Microsoft Teams Certified USB-A Headset	76J21AA
Poly Blackwire 3325 Microsoft Teams Certified USB-C Headset	76J23AA
Poly Blackwire 3325 USB-A Headset	76J20AA
Poly Blackwire 3325 USB-C Headset	76J22AA
Poly Blackwire 5210 USB-A Headset (Bulk Qty.50)	7D786AA
Poly Blackwire 5210 USB-C Headset	783M2AA
Poly Blackwire 5210 USB-C Headset (Bulk Qty.50)	7D7G7AA
Poly Blackwire 5220 USB-A Headset (Bulk Qty.40)	7D785AA
Poly Blackwire 5220 USB-C Headset	783M4AA
Poly Blackwire 5220 USB-C Headset (Bulk Qty.40)	7D787AA
Poly Blackwire 8225 Microsoft Teams Certified USB-C Headset	772K5AA
Poly Blackwire 8225 USB-C Headset	772K4AA
Poly EncorePro 310 Monoaural with Quick Disconnect Headset	77T43AA
Poly EncorePro 310 Stereo USB-A Headset	767G1AA
Poly EncorePro 310 USB-C Monoaural Headset	760Q8AA
Poly EncorePro 320 Monoaural USB-C Headset	767F9AA
Poly EncorePro 320 Stereo USB-A Headset	767G0AA
Poly EncorePro 320 with Quick Disconnect Binaural Headset	77T26AA
Poly EncorePro 510 with Quick Disconnect Monoaural Headset	783Q1AA
Poly EncorePro 510D with Quick Disconnect Monoaural Digital Headset	783Q0AA
Poly EncorePro 510V Voice Tube Microphone with Quick Disconnect Monoaural Headset	783Q3AA
Poly EncorePro 515 Microsoft Teams Certified Monoaural with USB-A Headset	783R1AA
Poly EncorePro 515 Monoaural with USB-A Headset	783R0AA

Poly EncorePro 520 with Quick Disconnect Binaural Headset	783P6AA
Poly EncorePro 520D with Quick Disconnect Binaural Digital Headset	783P5AA
Poly EncorePro 520V Voice Tube Microphone with Quick Disconnect Binaural Headset	783P8AA
Poly EncorePro 525 Microsoft Teams Certified Stereo with USB-A Headset	783R2AA
Poly EncorePro 525 USB-A Stereo Headset	783R3AA
Poly EncorePro 530 with Quick Disconnect Discreet Headset	783P2AA
Poly EncorePro 530D with Quick Disconnect Discreet Digital Headset	783P4AA
Poly EncorePro 540 with Quick Disconnect Convertible Headset	783P0AA
Poly EncorePro 540D with Quick Disconnect Convertible Digital Headset	783N7AA
Poly EncorePro 545 USB-A Convertible Headset	783R4AA
Poly EncorePro 710 with Quick Disconnect Monoaural Headset	783M8AA
Poly EncorePro 710D with Quick Disconnect Monoaural Digital Headset	783N6AA
Poly EncorePro 715 USB-A Monoaural Headset	783N5AA
Poly EncorePro 720 with Quick Disconnect Binaural Headset	783M7AA
Poly EncorePro 720D with Quick Disconnect Binaural Digital Headset	783N4AA
Poly EncorePro 725 USB-A Stereo Headset	783M6AA
Poly SupraPlus H251H with Quick Disconnect (for hearing aid) Monoaural Headset	783S0AA
Poly SupraPlus H261H with Quick Disconnect (for hearing aid) Binaural Headset	783S1AA

Wireless Headset

Poly C540 Convertible Headset	7E2J7AA
Poly CS510 Headset	7E2J8AA
Poly CS520 Headset	7E2J9AA
Poly CS540 Convertible Multi Pack Headset	7K2F0AA
Poly CS540 DECT 6 Convertible Headset	7K2E6AA
Poly CS540 with handset lifter Headset	7K2E8AA
Poly CS545 Headset	7E2K0AA
Poly Savi 7210 DECT 6 Monoaural Headset	77T42AA
Poly Savi 7220 DECT 6 Headset	77T41AA
Poly Savi 7310 DECT Monoaural Headset	77T38AA
Poly Savi 7310 Microsoft Teams Certified Headset	77T40AA
Poly Savi 7320 DECT Stereo Headset	77T37AA
Poly Savi 7320 Microsoft Teams Certified DECT Headset	77T39AA
Poly Savi 8210 DECT Office 3-Way Connectivity Headset	77R40AA

Poly Savi 8210 Microsoft Teams Certified DECT Office 3-Way Connectivity Headset	77T23AA
Poly Savi 8210 Microsoft Teams Certified UC DECT USB-A Headset	77T31AA
Poly Savi 8210 Microsoft Teams Certified UC DECT USB-C Headset	77T32AA
Poly Savi 8210 UC DECT USB-A Headset	77T29AA
Poly Savi 8210 UC DECT USB-C Headset	77T30AA
Poly Savi 8220 DECT Office 3-Way Connectivity Headset	77P42AA
Poly Savi 8220 Microsoft Teams Certified DECT Office 3-Way Connectivity Headset	77Y84AA
Poly Savi 8220 Microsoft Teams Certified UC DECT USB-A Headset	77Y82AA
Poly Savi 8220 Microsoft Teams Certified UC DECT USB-C Headset	77Y83AA
Poly Savi 8220 UC DECT USB-A Headset	77T33AA
Poly Savi 8220 UC DECT USB-C Headset	77T34AA
Poly Savi 8240 DECT Office 3-Way Connectivity Headset	77P43AA
Poly Savi 8240 Microsoft Teams Certified DECT Office 3-Way Connectivity Headset	77R22AA
Poly Savi 8240 Microsoft Teams Certified UC DECT USB-A Headset	77P40AA
Poly Savi 8240 Microsoft Teams Certified UC DECT USB-C Headset	77P38AA
Poly Savi 8240 UC DECT USB-A Headset	77P39AA
Poly Savi 8240 UC DECT USB-C Headset	77P37AA
Poly Savi 8245 DECT USB-A Computer+Desk Phone+Mobile Headset	77T24AA
Poly Savi 8245 DECT USB-A D200 Headset	77T35AA
Poly Savi 8245 DECT USB-C D200 Headset	77T27AA
Poly Savi 8245-M Microsoft Teams Certified DECT USB-A Computer+Desk Phone+Mobile Headset	77T25AA
Poly Savi 8245-M Microsoft Teams Certified DECT USB-A D200 Headset	77T36AA
Poly Savi 8245-M Microsoft Teams Certified DECT USB-C D200 Headset	77T28AA
Poly Savi 8245-M USB-A Computer+Desk Phone+Mobile Headset	7K2E4AA
Poly Voyager 4245 USB-A Headset	7D7K0AA
Poly Voyager 4245-M Microsoft Teams Certified USB-A Office Headset	7F0J5AA
Poly Voyager 4310 Microsoft Teams Certified USB-A Headset +BT700 dongle	77Y91AA
Poly Voyager 4310 Microsoft Teams Certified USB-C Headset +BT700 dongle	77Y95AA
Poly Voyager 4310 USB-A Headset +BT700 dongle	76U48AA
Poly Voyager 4310 USB-C Headset +BT700 dongle	77Y94AA
Poly Voyager 4310 USB-C Headset +BT700 dongle +Charging Stand	77Y96AA
Poly Voyager 4310-M Microsoft Teams Certified USB-C Headset +BT700 dongle +Charging Stand	77Y97AA
Poly Voyager 4320 Microsoft Teams Certified USB-A Headset +BT700 dongle	77Y98AA

Poly Voyager 4320 Microsoft Teams Certified USB-C Headset +BT700 dongle	77Z30AA
Poly Voyager 4320 USB-A Headset +BT700 dongle	76U49AA
Poly Voyager 4320 USB-C Headset +BT700 dongle	76U50AA
Poly Voyager 4320 USB-C Headset +BT700 dongle +Charging Stand	77Z31AA
Poly Voyager 4320-M Microsoft Teams Certified Headset +BT700 dongle +Charging Stand	77Z32AA
Poly Voyager 5200 Headset	7D7G6AA
Poly Voyager 5200 UC USB-A Headset +BT600 Dongle	7K2E1AA
Poly Voyager 5200 USB-A Bluetooth Headset +BT700 dongle	7K2F3AA
Poly Voyager 5200 USB-A Office Headset	7D793AA
Poly Voyager 5200 USB-C Office Headset	7D796AA
Poly Voyager 5200-M USB-C Headset	7D797AA
Poly Voyager 5200-R Headset	7F0H8AA
Poly Voyager 6200 Black Headset	7D7G5AA
Poly Voyager 6200 USB-C Black Headset	7D792AA
Poly Voyager 8200 Black Headset	7D7G4AA
Poly Voyager 8200 USB-C Black Headset	7D791AA
Poly Voyager Focus 2 Microsoft Teams Certified USB-A Headset	77Y85AA
Poly Voyager Focus 2 Microsoft Teams Certified USB-C Headset	77Y88AA
Poly Voyager Focus 2 USB-A Headset	76U46AA
Poly Voyager Focus 2 USB-C Headset	76U47AA
Poly Voyager Focus 2 USB-C with charge stand Headset	77Y89AA
Poly Voyager Focus 2-M Microsoft Teams Certified with charge stand Headset	77Y90AA
Poly Voyager Focus B825 UC Headset	7F0J1AA
Poly Voyager Focus B825 UC USB-C Headset +Charging Stand	7F0J3AA
Poly Voyager Focus B825 USB-A with charge stand Headset	7E2M4AA
Poly Voyager Focus B825 USB-C Headset	7F0J4AA
Poly Voyager Focus B825-M Microsoft Teams Certified UC Headset	7F0J2AA
Poly Voyager Focus B825-M Microsoft Teams Certified UC with charge stand Headset	7F0J0AA
Poly Voyager Focus BT UC Headset	7K2E2AA
Poly Voyager Focus UC Headset	7K2E3AA
Poly Voyager Legend-R Headset	7F0H9AA

Speakerphones

Poly Sync 20 USB-A Pink Speakerphone	77ZC7AA
Poly Sync 20 USB-C Speakerphone	7F0J7AA

Poly Sync 20+ Microsoft Teams Certified USB-A Speakerphone	772C9AA
Poly Sync 20+ Microsoft Teams Certified USB-C Speakerphone	772D1AA
Poly Sync 20+ USB-A Speakerphone	772C6AA
Poly Sync 20+ USB-C Speakerphone	772D0AA
Poly Sync 20-M Microsoft Teams Certified USB-C Speakerphone	7F0J8AA
Poly Sync 40+ Microsoft Teams Certified Speakerphone	77P36AA
Poly Sync 40+ Speakerphone	772C5AA
Poly Sync 60 Microsoft Teams Certified Speakerphone	77P41AA
Poly Sync 60 Speakerphone	772C2AA

Disclaimer — Copyright

Intel, Core, Optane, Celeron, Pentium, Iris, XMM, and Thunderbolt are trademarks or registered trademarks of Intel Corporation or its subsidiaries in the United States and other countries. AMD, Ryzen, Athlon, and Radeon are trademarks of Advanced Micro Devices, Inc. Bluetooth is a trademark owned by its proprietor and used by HP Inc. under license. NVIDIA and GeForce are trademarks and/or registered trademarks of NVIDIA Corporation in the U.S. and other countries. USB Type-C® and USB-C® are registered trademarks of USB Implementers Forum. DisplayPort™ and the DisplayPort™ logo are trademarks owned by the Video Electronics Standards Association (VESA®) in the United States and other countries. McAfee and McAfee LiveSafe are trademarks or registered trademarks of McAfee LLC in the United States and other countries. ENERGY STAR is a registered trademark of the U.S. Environmental Protection Agency. All other trademarks are the property of their respective owners.

© Copyright 2023 HP Development Company, L.P. The information contained herein is subject to change without notice. The only warranties for HP products and services are set forth in the express warranty statements accompanying such products and services. Nothing herein should be construed as constituting an additional warranty. HP shall not be liable for technical or editorial errors or omissions contained herein.