



\* All images are for illustrative purposes only.

**OUTDOOR** LG LED SIGNAGE

# GSCA Versatile Series



Fast Installation



Easy Maintenance



Two Cabinet Options



90° Corner Design Available



Front or Rear Serviceability



IP Rated Weatherproof Design





## Fast Installation

Various factors including magnets on the top and bottom, positioning pins, handles and fast locks help installers easily set up and dismantle the LED screens without additional tools.

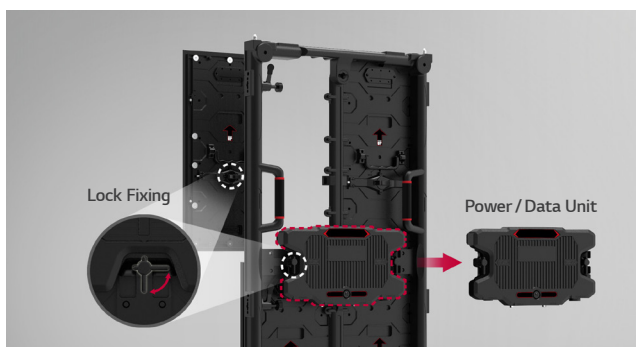

## Easy Maintenance

The GSCA series applied a simple Lock Fixing method which requires no additional tools, making it easier to replace LED modules or power/data units. It saves cost and time for maintenance.



## Two Cabinet Options

The GSCA series offers two sizes of cabinets enabling a screen size configuration that fits perfectly with customer's demands.



## IP Rated Weatherproof & 90° Corner Design

The cabinet is IP65 certified, allowing stable operation unaffected by weather and harsh outdoor environments. Also, if you add a 90° corner option, the GSCA series can deliver flawless content even when installed on the corners.

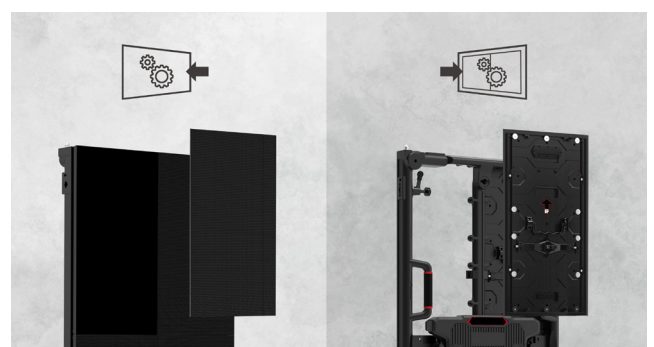

## Front or Rear Serviceability

The product offers either front access or rear access, allowing customers to choose installation options according to their environment and minimizes limitations in installation and maintenance.

# PRODUCT INFORMATION



## GSCA Series

Pixel Pitch	3.91 / 4.63 mm
Brightness	5,000 nit
Refresh Rate	3,840 Hz
Serviceability	Front or Rear (One Option Only)
IP Rating	IP65

## DIMENSION

(unit: mm)

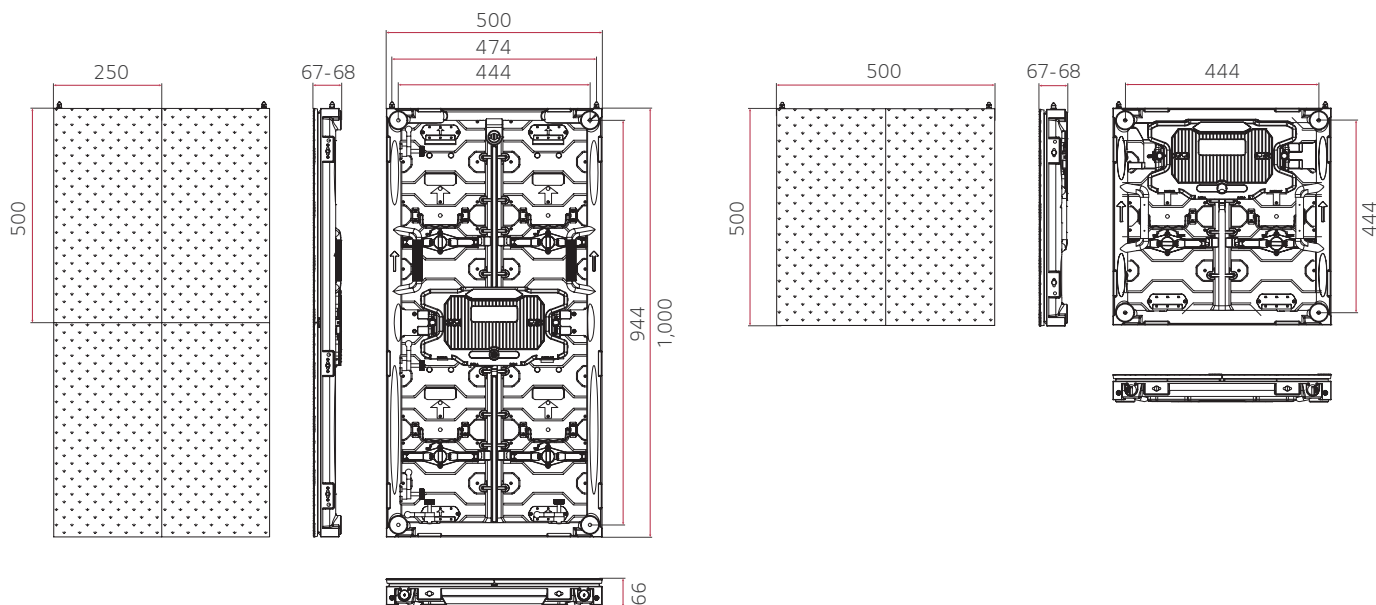

As a continuing policy of product development at LG Electronics, the design and specifications are subject to change. They may vary from model to model. Colour/shades may vary due to printing restrictions. E&OE.



**LG B2B CUSTOMER CARE**

1800-180-9898 (Toll Free)

5757554 (Send SMS)

www.lg.com/in/support

LG Service India Mobile App Available at Google Play

MOBILE APP

www.facebook.com/lgindiapage/

www.twitter.com/LGIndia

To know more about LG, visit [www.lg.com/in](http://www.lg.com/in)

For B2B Solutions/Product enquiries, please write to [b2b.solutions@lge.com](mailto:b2b.solutions@lge.com)

For B2B Service, please write to [b2bsupport.india@lge.com](mailto:b2bsupport.india@lge.com)

