



SocketScan® S730

Ergonomic and Elegant

The SocketScan S730 laser barcode scanner with Bluetooth wireless technology is ergonomic and comfortable to use for extended periods of time. The long-lasting battery withstands your entire work day while the scanner's laser scans hard-to-reach places, meeting various jobs' demands. It offers rapid scanning ability for moderate to rigorous scanning applications. It enables easy scanning of barcodes on high shelves or other unreachable areas. With intuitive light icons to keep users informed on its connection and power status, this scanner is ideal for scanning long distances through glass/plastic, in bright sunlight, on curved reflective surfaces or other sensitive lighting conditions. The S730 is designed to be software compatible with all applications. Updates on operating systems may alter the devices' performance.

For the most reliable and consistent performance, please verify with your application provider that Socket Mobile's latest Capture SDK was implemented in your app.

Use our Companion App for easy set up and configuration.



Certified by Apple® for iOS devices (iPad®, iPhone®, iPod Touch®) and compatible with Android and Windows®.

Features

- **Bluetooth Wireless Technology** - Connects easily to a wide range of Bluetooth enabled smartphones, tablets, notebooks and desktop computers
- **Certified by Apple® for iOS devices** – Guaranteed Compatibility - With Capture SDK integrated in over 700+ applications, Socket Mobile scanners are one of the most natively integrated scanners available today. Socket Mobile Scanners are also 100% compatible with any application out-of-the-box in HID (keyboard emulation) mode.
- **Compatible with all Android and Windows devices and applications**
- **Scanning** - High Performance Class 2 laser, ideal for moderate to rigorous scanning applications (scans thousands of barcodes per day)
- **Flexible** - Effectively scans barcodes in sensitive lighting conditions, including through glass/plastic, in bright sunlight, in dark environments, or on curved/reflective surfaces
- **Long Read Range** - Up to 45" (1.1m) enables easy scanning of barcodes on high shelves or other hard-to-reach areas
- **Fast** - Rapidly decodes all 1D and stacked barcodes (including ISBN book and VIN numbers), even worn, damaged or tightly spaced codes
- **Long-Lasting Battery**- Power to last over 16 hours
- **Replaceable Battery** – 2 AA NiMH rechargeable batteries
- **User Indicators** – Improved interface with intuitive LEDs, beeps, and vibrations let users know battery status, Bluetooth connection and scanning status
- **User Feedback** - Audible tones and hand pulsation
- **Exceptional Ergonomics** - Small, lightweight and fits perfectly in the hand for comfortable use over extended periods
- **Protective Material** - Made with antimicrobial material for protection against potentially harmful bacteria
- **Color Options** - Black, Blue, green, red, white and yellow colors enable style, corporate-branding for personalization and in easy to find in varying work environments.
- **Application Integration** – Socket Mobile's Capture SDK enables integration in your applications to improve business productivity with fast, efficient and reliable data transfer over Bluetooth wireless technology.
- **Wearable** - Includes wrist strap. Holster, lanyard and retractable clip available (sold separately)
- **Designed and Assembled in the USA**
- **Developer Support Available**
- **1-Year Warranty**



Status Indicators

- Beep
- Vibrate

Intuitive LED Indicators

- Battery LED: Green, Amber and Red
- Bluetooth LED: Blue
- Scan LED: Green and Red

Weight/Mass
• 4.0 oz. (113 g)

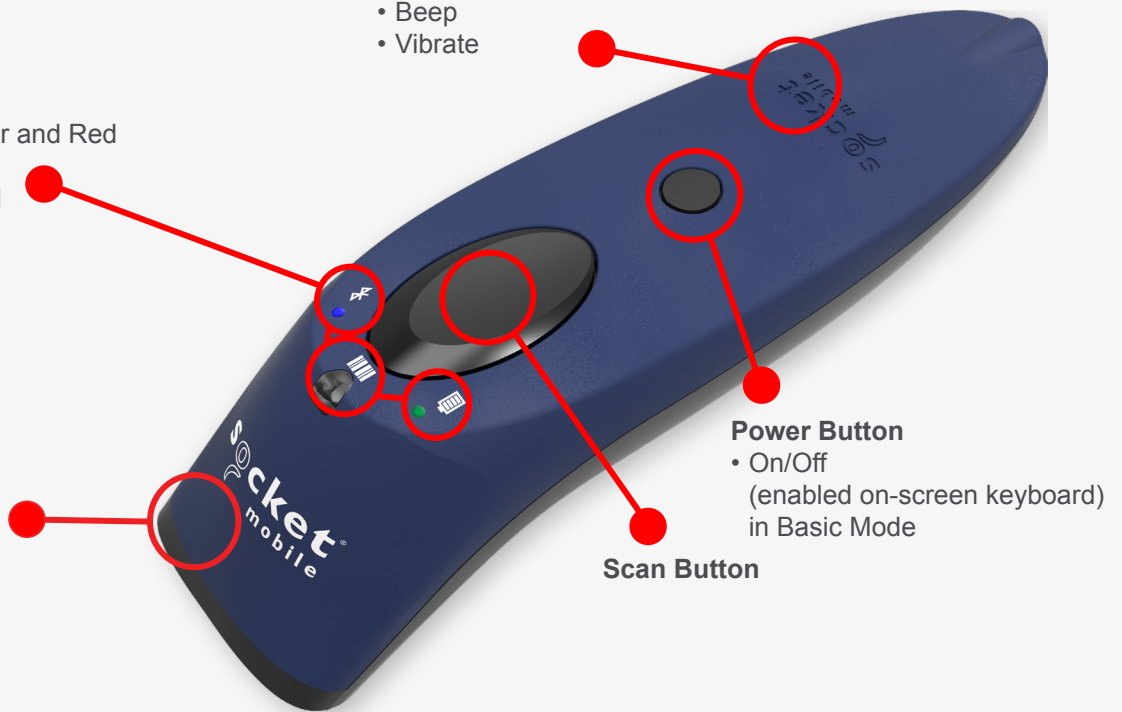

- (1) SocketScan S730, Class 2 Laser Barcode Scanner
- (1) Charging Cable
- (1) Wrist Strap
- (1) Get Started insert

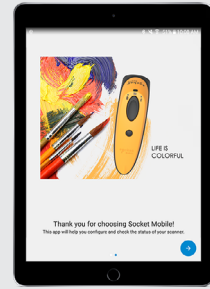

Socket Mobile Companion
Download for Free!

The S730 is available in 6 colors:



Colors:	S730	S730 w/ Black Charging Dock	S730 w/ White Charging Dock
Black:	CX3806-2566	CX3808-2568	
Blue:	CX3361-1683	CX3460-1928	CX3486-1981
Green:	CX3404-1862	CX3458-1926	CX3526-2129
Red:	CX3400-1858	CX3456-1924	CX3525-2127
White:	CX3406-1864	CX3459-1927	CX3485-1980
Yellow:	CX3402-1860	CX3457-1925	CX3526-2128

Optional Accessories

Charging Stand



Great for using AutoScan Mode

Charging Dock



Ideal as a desktop charger

Durable Retractable Clip



Provides quick access to scanner
Scanner & Phone Holder

Holster



Safe and accessible placement

Wrist Strap



Keeps the scanner at your fingertips



Nice one-handed option

Warranty

Scanner:	Standard one year limited warranty
Accessories:	90 days
Extended Warranty: (sold separately)	www.socketmobile.com/socketcare



Default Barcode Symbologies	Australia Post, Code 39, Code 128, EAN-8/JAN, Ean-13/JAN, GS1 Databar Expanded, GS1 DataBar Limited, GS1-128, Interleaved 2 of 5, ISBT 128, UPC A, UPC E0
Supported Barcode Symbologies:	Australia Post, Bookland EAN, Chineses 2 of 5, Codabar, Code 11, Code 39, Code 93, Code 128, EAN-8/JAN, Ean-13/JAN, GS1 DataBar, GS1 Databar Expanded, GS1 DataBar Limited, GS1-128, Interleaved 2 of 5, ISBT 128, Korean 3 of 5, Matrix 2 of 5, MS1, UPC A, UPC E0
Scan Angle:	Wide: 47° (Default) Medium: 35° Narrow: 10°
Optical Resolution:	0.005 in. Minimum element width
Print Contrast:	Minimum 25% absolute dark

Reading Distance:

1D codes 3.05 to 457.2 cm (1.2 in to 180 in)
Depends on width & barcode size, symbology, label media

Battery

Battery:	2 AA NiMH rechargeable batteries
Charge Time:	~6 Hours
Battery Life - Per Full Charge:	Standby time: over 20 hours Active Scan Time: 100,000 scans within 9 hours (based on 2 scans every 1 second) 16,000 scans within 18 hours (based on 1 scan every 4 seconds)
Note:	Battery life varies depending on ambient temperature, ambient light and age of battery.

Scanner Type

Technology:	1D Class 2 Laser Barcode Scanner
Laser Power at 650 nm :	Scanning Mode: 1.7 mW (nominal peak power) Aiming Mode: 0.67 mW

Bluetooth (wireless connection)

Bluetooth Radio:	Class 2 Bluetooth, version 2.1 + EDR (Enhanced Data Rates) with 56-bit data encryption
Bluetooth Range:	Up to 10 m (33 ft.) depending on environment, range limit is usually due to the Host Device (phone, tablet or notebook)
Bluetooth Profiles:	Basic Mode - Human Interface Device (HID)*, Application Mode - Serial Port Profile (SPP) and Application Mode - MFi-SPP. Some Operating Systems or smartphone/tablet models may support only one profile. <i>*By default, the scanner is set to Basic Mode (HID).</i>

Ambient Light:	From 4,800 to 86,000 lux From artificial indoor (fluorescent and incandescent) to natural outdoor lighting (direct sunlight)
Operating Temperature:	-20° to 50° C (-4° to 122° F)
Storage Temperature:	-40° to 70° C (-40° to 158° F)
Relative Humidity:	95% at 60° C (140° F) (non-condensing)
Drop Specifications:	4 ft. drop to linoleum

Operating System Compatibility

Android OS - Basic Mode (HID)* & Application Mode (SPP)	Mac OS - Basic Mode (HID)* only
Apple iOS - Basic Mode (HID)* & Application Mode (MFi-SPP)	Windows OS - 10, 8, and 7 - Basic Mode (HID)* & Application Mode (SPP)
Compatible with devices supporting Basic Mode (HID)* protocol	Windows Mobile, Embedded Handheld - Basic Mode (HID)* & Application Mode (SPP)
Supported Language Setting in Basic Mode (HID): ANSI, English UK, English, French, German, Italian, Japanese, Polish, Spanish and Swedish	
*By default, the factory settings of the Socket Mobile Scanners are set to Basic Mode (keyboard emulation: HID). In order to use the scanner with an application using Capture SDK, the scanner must be configured in Application Mode (Bluetooth Serial Port Profile: SPP)	

Certified by Apple® for iOS devices (iPad®, iPhone®, iPod Touch®) and compatible with Android and Windows®.



Certification & Regulatory

Bluetooth SIG:	Declaration ID: D030473 QD ID: 82009
Electrical Safety:	Certified to IEC 60950-1, UL 60950-1, CAN/CSA C22.2
Environmental:	Environmental: RoHS EN 50581
EMI / RFI:	FCC Part 15 Class C, RSS 210, iCES 003, C-Tick, CISPR 22, CE EN55022, EN55024, TELEC FCC ID: T9J-RN42 IC ID: 6514-RN42 Telec: 201-125799
LED Safety:	IEC/EN 62471 (EXEMPT GROUP)



Common Uses

Retail/Point of Sale	Warehouse Inventory management
Asset Tracking	Shipping & Receiving
Healthcare	Field Sales/Service
Mobile Tracking	Supply Chain / Proof of Delivery
Field Sales Merchandising & Account Management	Hospitality

socketmobile.com	sales@socketmobile.com	
Toll-Free: +1 800 552 3300 (USA/Canada)	Asia Pacific: +1 510 933 3122	EMEA & Russia: +41 62 834 0780
France: +33 970 462 241	Germany: +49 9401 5299 052	Japan: +8190 9808 0518
Latin America: +1 510 933 3153	Switzerland: +41 62 834 07 80	UK/Ireland/South Africa: +44 (0) 1252 761403 +44 7787 112109