

# ASUS X409

## Experience the power of an everyday classic

One of the world's smallest all-rounder 14-inch laptops



### Get a wider view of the world

The NanoEdge display gives ASUS X409 a vast screen area for an immersive viewing experience for work and play. Its wide-view FHD panel features an anti-glare coating to reduce unwanted distractions from irritating glare and reflections, so you can truly focus on what's in front of you.

6.5mm

thin bezel

78%

screen to body ratio



Powered by Intel® Core™ i7 Processor.  
Learn more at: <https://www.asus.com/Laptops/ASUS-Laptop-Series-Products/>

starting at \$ xxxxxxxx  
\* Specification may vary by model.

### Fast and efficient

ASUS X409 ensure everyday tasks are handled with ease. They are powered by up to 10th Generation Intel Core i7 processors with NVIDIA GeForce MX250 discrete graphics. The dual storage design features up to a 512GB SSD and 1TB HDD, with optional Intel Optane™ memory technology.

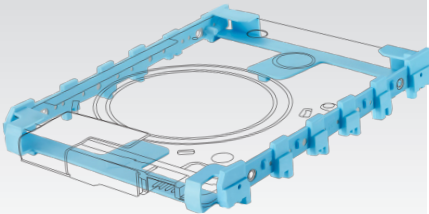
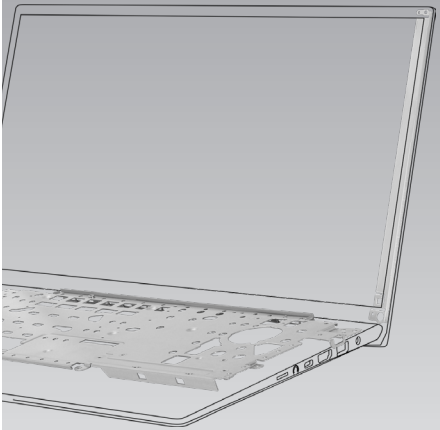

### Empower your dynamic lifestyle!

With an overall weight of just 1.65kg\*, the extremely portable ASUS X409 is the lightweight laptop that keeps up with your fast-paced lifestyle. It looks good, too, with its Transparent Silver or Slate Grey finish.

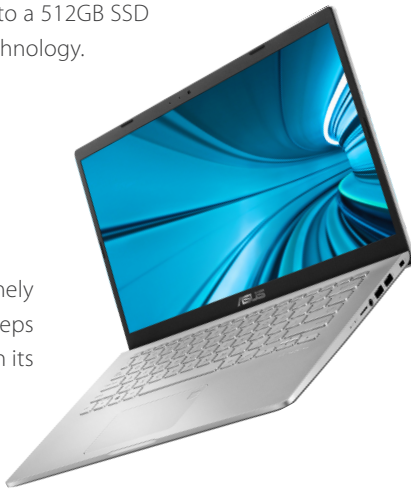

### Reinforced chassis for your durability

X409 feature the metal brace underneath the keyboard that provides a stable platform for a much more comfortable typing and touchpad experience. Besides the structural rigidity, perpendicular braces along the edge of the chassis work like side impact protection beams in automobiles to protect the hinge joint and internal components. The sides of the lid are reinforced and work like side-impact protection beams in automobiles.

### EAR HDD protection

The HDD features E A R™ HDD shock dampening protection is designed to protect your data from physical impact. Laptop HDDs are generally more susceptible to physical damage compared to SSDs. This active hard-drive protection feature automatically detects shock and vibration across all three axes to effectively reduce the chances of HDD damage, so you can work without worry, even in a moving vehicle.

### ASUS X409

- Windows 10 Home / Windows 10 Pro
- Up to 14" 16:9 Full HD (1920 x 1080) matte display
- **NanoEdge display for immersive viewing**
- **Smaller chassis and stylish design available in 2 classic colors**
- **6.5mm thin bezel for immersive 78% screen to body ratio**
- **178° wide-view** technology
- Weighs only **1.65kg\***
- Up to **10th Gen Intel® Core™ i7** processor
- Up to **16GB DDR4 2400MHz** RAM
- Up to **512GB SSD + 1TB HDD** storage
- Up to **NVIDIA MX250** discrete graphics
- One-touch **fingerprint login** with Windows Hello
- Full-size backlit keyboard (optional) with 1.4mm key travel
- Integrated dual-band Wi-Fi 5 (802.11ac)
- 1 x USB-C™ 3.1, 1 x USB 3.1, 2 x USB 2.0, 1 x HDMI, 1 x audio combo jack, 1 x microSD card reader
- **Fast charging** to 60% in 49 minutes
- **3X longer** battery lifespan
- ASUS **SonicMaster** stereo audio system with surround-sound
- 325.4 x 216 x 22.9 mm



ASUS Laptop	X409
CPU	Intel® Core™ i7 1065G7 Processor 1.5GHz (8MB cache up to 3.9GHz) Intel® Core™ i7-8565U Processor 1.8GHz (8MB cache, up to 4.6GHz) Intel® Core™ i7-8550U Processor 1.8GHz (8MB cache, up to 4.0GHz) Intel® Core™ i5 1035G1 Processor 1.0GHz (8MB cache up to 3.6 GHz) Intel® Core™ i5-8265U Processor 1.6GHz (6MB cache, up to 3.9GHz) Intel® Core™ i5-8250U Processor 1.6GHz (6MB cache, up to 3.4GHz) Intel® Core™ i3 1005G1 Processor 1.2GHz (8MB cache up to 3.4 GHz) Intel® Core™ i3-8145U Processor 2.1GHz (4MB cache, up to 3.9GHz) Intel® Core™ i3-7020U Processor 2.3GHz (3MB cache, up to 2.3GHz) Intel® Pentium® Silver N5000 Processor 1.1GHz (4MB cache, up to 2.70GHz) Intel® Pentium® Gold 4417U Processor 800MHz (2MB cache, up to 2.3GHz) Intel® Celeron® Processor N4000 1.1GHz (4MB cache, up to 2.60GHz) Intel® Celeron® Processor N4100 1.1GHz (4MB cache, up to 2.40GHz)
Operating System	64-bit Windows 10 Pro / Windows 10 Home
On Board Memory	On board 4GB / 8GB DDR4 + 1 x SODIMM (Up to 16GB)
Memory Slot	1
Memory Max.	DDR4 2400MHz 16GB
Storage	128GB / 256GB SATA3 SSD or 256GB / 512GB PCIe SSD + 500GB / 1TB HDD
EMMC / ISSD	NA
Display	14.0" FHD 1920x1080, two-sided NanoEdge display, Wide View (optional), Anti-glare
External Video Display Modes	HDMI
Discrete GPU	NVIDIA® MX110 / MX230 / MX250
Integrated GPU	Intel® UHD Graphics 620
Video Memory	2GB VRAM
Video Camera	Yes
FingerPrint	Yes (optional)
Wireless	Wi-Fi 5 (802.11ac), Bluetooth® 4.1/5.0
LAN	NA
Card Reader	Type: MicroSD
Interface	1 x Type-C / 1 x Type-A / 2 x USB 2.0 / 1 x HDMI / 1 x Combo audio jack / 1 x MicroSD card reader
Audio	Built-in array microphone / Built-in speaker / ASUS SonicMaster stereo audio system
Weight (kg)	1.65kg
Dimension (cm)	325.4 x 216 x 22.9 mm
AC Adapter	65W AC Adapter: Output: 19V DC, 3.42A / Input: 100 ~240 V AC, 50/60Hz universal
Battery	32Whr 2-cell battery
Replaceable Battery	NO
Keyboard Type	Illuminated Chiclet Keyboard (optional)
Security	Firmware TPM (fTPM) / Windows Hello, login with Fingerprint (optional) BIOS Booting User Password Protection
Warranty	
Price	