

GCS62HMDPKIT

2-Port HD Cable KVM with MiniDisplayPort Adapters Bundle



2-Port Cable HDMI / Mini DisplayPort KVM Switch

- Switch between two computers with the push of a button
 - Offers the flexibility to mix and match computer connections: HDMI and Mini DisplayPort
 - Includes 2 x Mini DisplayPort to HDMI adapters
 - No external power needed
 - Cost effective, Plug-N-Play solution
-
- Share a display with HDMI connection, a USB keyboard and mouse, with 2 USB computers
 - Separate the Internet and Intranet with the click of a button
 - Full 1080p and up to 1920 x 1200 @ 60Hz
 - Digital Audio support
 - HDCP Compliant
 - Multi OS platform support
 - Works with game consoles
 - Port switching via remote switch button, mouse or hotkeys
 - Hotkeys allows independent KVM and audio switching between computers
 - Includes 2.1 stereo sound and microphone support
 - USB 2.0 Peripheral Sharing via mouse port. Connect a powered USB Hub to expand your USB connectivity*
 - USB mouse and keyboard emulation for error-free boot-up and instantaneous recognition when switching computers
 - Power-On Detection – If one of the computers is powered off, it will automatically switch to the next powered-on computer
 - Re-programmable hotkey activation for keyboards without a scroll lock key
 - Keyboard emulation can be disabled to support gaming keyboard's special keys
-
- Mouse emulation can be disabled to support mice with special keys
 - Mac and Sun keyboard support
 - Firmware upgradeable
 - Plug-n-play; no software required
 - Mini DisplayPort to HD Adapters:
 - Converts your Mini DisplayPort to HD so you can connect to a HD projector, TV or monitor.
 - Works with Apple® iMac® or MacBook®
 - Compliant with Mini DisplayPort Specification 1.1a for both 1.62 Gbps and 2.7 Gbps
 - Support full Mini DisplayPort link tracking
 - Supported resolutions:
 - Full HD 1080p
 - 1920x1200
 - Compliant with HDMI up to 2.25Gbps
 - Support interrupt request output for expansion function
 - Supports Deep Sleep Mode (suspend mode)

*IOGEAR's DynaSync provides the EDID support for Windows 7
 **Mouse emulation must be disabled for this feature to function correctly



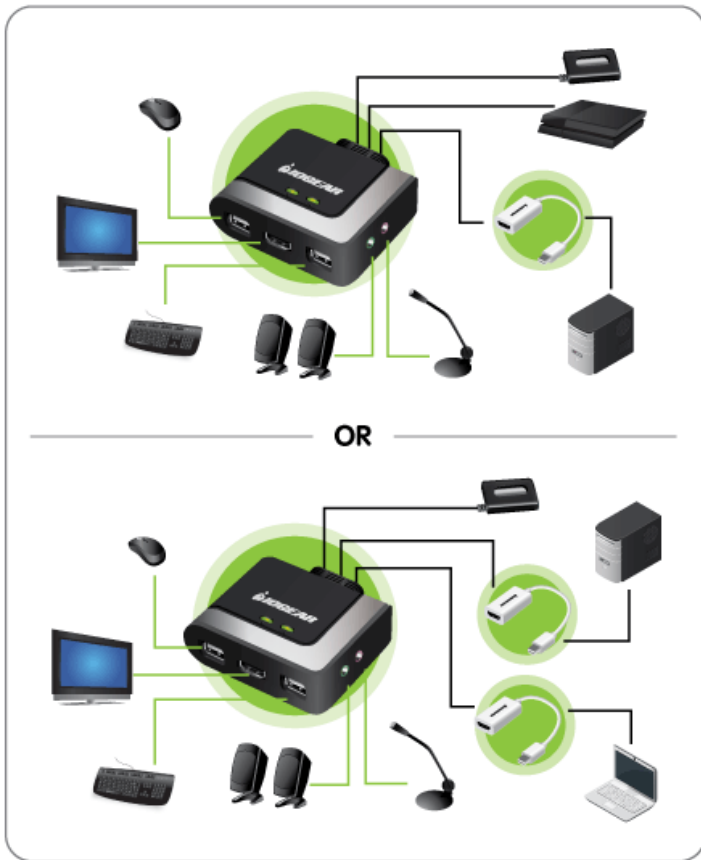

Requirements

Package Contents

Console:

- 1 x HDMI display
- 1 x standard 104 key wired USB keyboard
- 1 x standard 2 or 3 button wired USB mouse

- 1 x 2-Port HD Cable KVM Switch
- 2 x MiniDisplay Port to HDMI Adapters
- 1 x Installation Guide
- 1 x Warranty Card

Computers:

- 1 x HDMI or MiniDisplayPort port
- 2 x USB ports

Operating Systems:

- Windows Vista®, Windows® 7, Windows® 8, Windows® 8.1, Windows® 10
- Mac OS® X 9 to 10.x
- Oracle® Solaris
- Linux®, Unix and other USB supported systems*

**Additional drivers and support may be needed*

***IOGEAR's Display Emulation Technology provides the EDID support for Windows® 7*

Specifications

Function	GCS62HMDPKIT	Dimensions	GCS62HMDPKIT
Computer Connections		POP Information	
Direct	2	10" Peg Hook	5
Console Connectors		6" Peg Hook	3
Monitor	1 x HDMI Female	Unit Dimensions	
Keyboard	1 x USB Type A Female	Height	2.5" (6.35cm)
Mouse	1 x USB Type A Female	Depth	1" (2.54cm)
Audio	1 x 3.5mm Mini Stereo Jack Female (Green)	Length	3.125" (7.93cm)
Microphone	1 x 3.5mm Mini Stereo Jack Female (Pink)	Unit Package Dimensions	
CPU Connectors		Width	6.5" (16.51cm)
Monitor	2 x HDMI Male; 2 x Mini DisplayPort Male (with adapter)	Height	9.25" (23.49cm)
Keyboard	2 x USB Type A Male (Purple)	Depth	2.75" (6.99cm)
Mouse	2 x USB Type A Male (Black)	Master Carton	
Audio	2 x 3.5mm Mini Stereo Jack Male (Green)	Width	16" (40.64cm)
Microphone	2 x 3.5mm Mini Stereo Jack Male (Pink)	Height	9.5" (24.13cm)
LEDs		Depth	7.5" (19.05cm)
On Line	2 x Green	Master Carton Qty.	6
Emulation		Weight	
Keyboard	USB	Master Carton Wt.	8.96lb (4.07kg)
Mouse	USB	Unit Pack Wt.	1.36lb (0.62kg)
Scan Interval		Unit Wt.	1.00lb (0.45kg)
3, 5, 10, 20 seconds (Default 5 seconds)			
Environment			
Storage Temperature	-20~60°C		
Operation Temperature	0~50°C		
Humidity	0~80%; Non-condensing		
Housing			
Case	Plastic		
Video Resolution			
1080p; 1920x1200			
Port Selection			
Remote Switch, Hotkey, and Mouse			