



ELECTRIC LIFT MOBILE STAND

FPS1/EL/GG



Take control of creative, presentation and collaboration work spaces. Salamander's beautiful and highly functional FPS Series Mobile Stands offer superior ergonomics complimenting any touch screen display with improved productivity, unrivaled flexibility and lifetime value.

A stylish, sleek and compact design moves easily between spaces. A thoughtful range of accessories provides even more utility and an improved user experience.

- Mobile stand for interactive display / touchscreen panel
- Motorized Electric Lift and wired remote
- Supports most VESA compliant display sizes 42" to 65" up to 175 lb (80 kg) including Microsoft 55" Surface Hub
- Ergonomic design. Adjustable height positioning provides best possible ergonomics and viewing
- Range of travel, Center of screen: Min - 36.83" (935.5 mm) and Max 62.42" (1585.5 mm)
- Superior mobility. High quality commercial grade locking casters and integrated handles provide easy maneuverability and transport
- Fully concealed cable management allows clean and uncluttered installation
- Storage for electronic components, peripherals and accessories
- Telescopic design allows compact position for transport and storage
- Durable construction. Made in USA of powder coated steel, Linak Motor components, Powder coated and/or veneered MDF panels
- Options available for peripheral equipment mounting, retractable cable reel, secure equipment storage cover, keyboard tray and more
- Limited Lifetime Warranty



ELECTRIC LIFT MOBILE STAND

FPS1/EL/GG

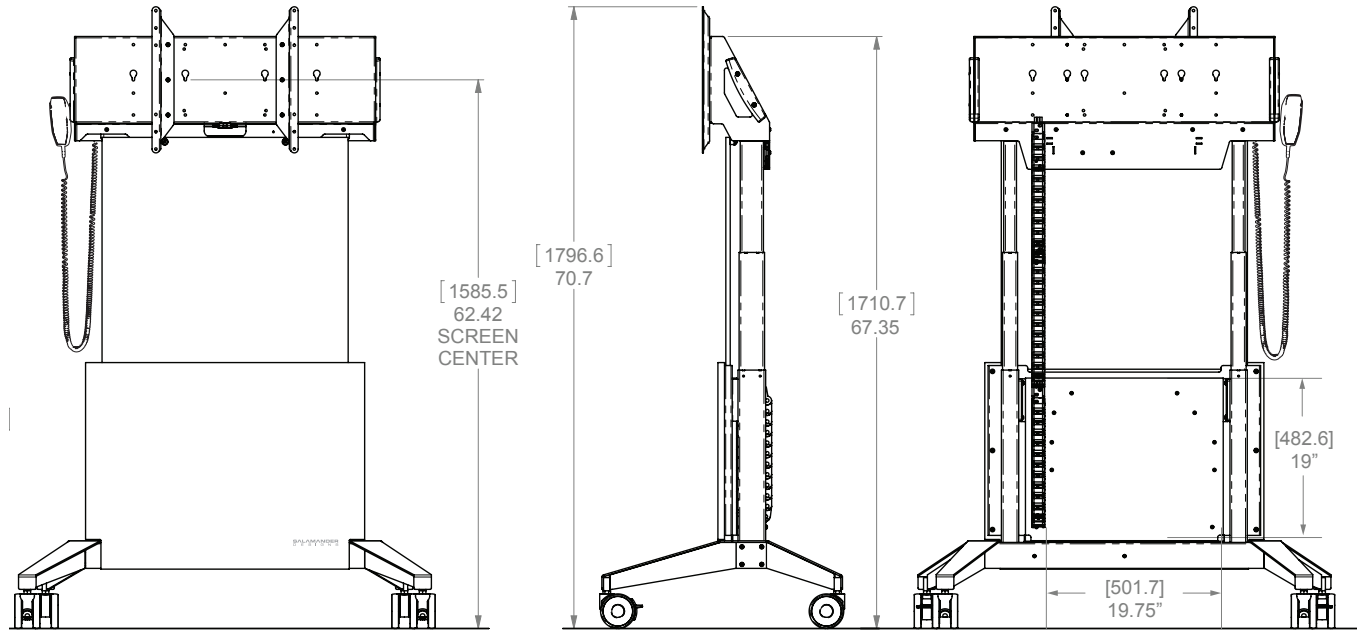

Equipment Mounting Panel

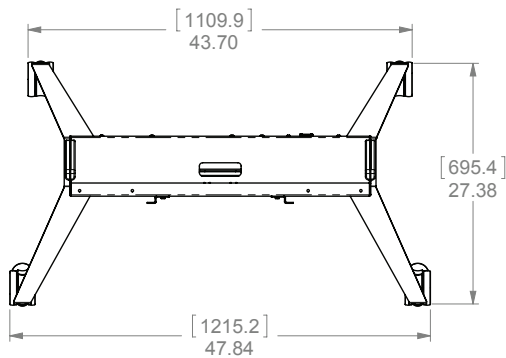
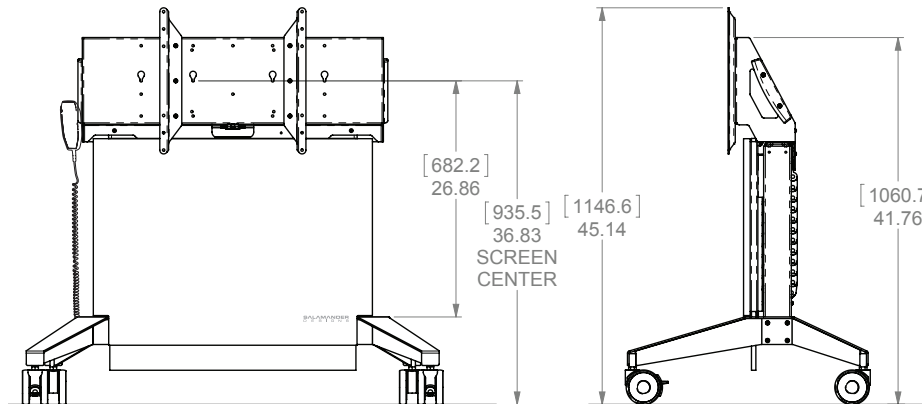



ELECTRIC LIFT MOBILE STAND

FPS1/EL/GG



PRODUCT SPECIFICATIONS	Metric (mm)		US/Imperial Inches		SHIPPING DIMENSIONS	
Length	1215.2	47.84			1,219 mm	48 inch
Overall Height Range	1146.6 - 1796.6	45.14 - 70.7			1,016 mm	40 inch
Center of Screen Range of Travel	935.83 - 1585.5	36.83 - 62.42				
Depth	695.4	27.38			406 mm	16 inch
Weight	61.23 kg	135 lbs			72.57 kg	160 lbs
Max Load Capacity	79.38 kg	175 lbs				
UPC Number		634878507110				

VESA COMPLIANT MOUNT PATTERN

Horizontal - 300mm, 400mm, 600mm

Vertical - 200mm, 300mm, 400mm

Panel Mounting - M4, M5, M6 Screws

CASTER WHEELS

4" (100mm) HD, Non Marking, Brakes on 2

ELECTRICAL INFORMATION

Input: 90V - 240V ~, 48 Hz - 63HZ

Duty Cycle: 10% Max 2min / 18min

CABLE MANAGER CHAIN

1" x .75" x 34" (25 x 19 x 865mm)

POWER CABLE

IEC - Type Class 2, 2-prong

USA Included: (PN 400-590)

Available: EU (PN 400-591)

UK (PN 400-592)



ELECTRIC LIFT MOBILE STAND

FPS1/EL/GG

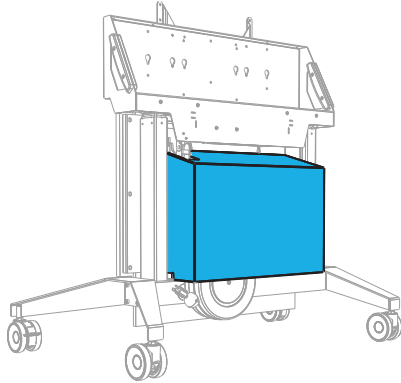

**Equipment Storage
Cover- Graphite - FPSA/SC/GT**

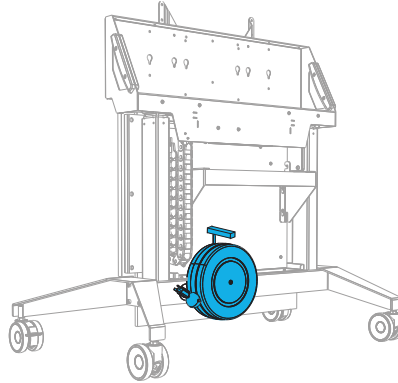

**Cable Reel 30' Payout, 24"
Tri-Tap Female End - FPSA/CR**

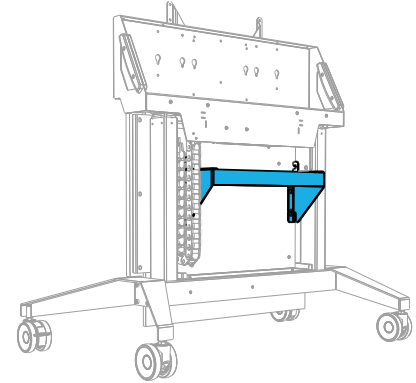

**19" Rack Mounting 3 RU
RM/VR/3U**

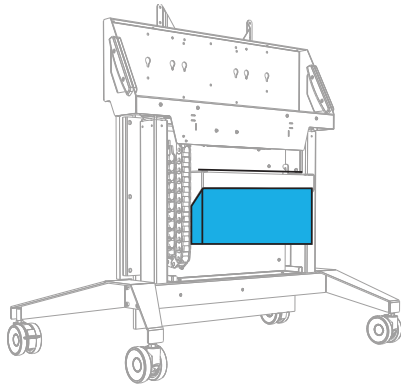

**Power Distribution Unit
SA/RM/PDU**

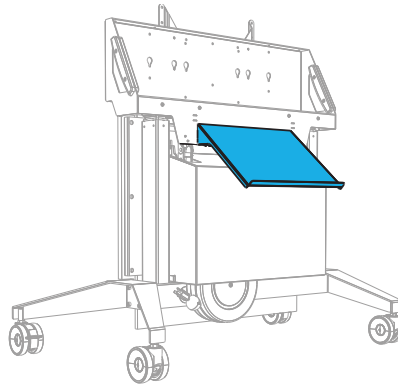

**Keyboard Storage
Shelf- Graphite - FPSA/KS/GT**

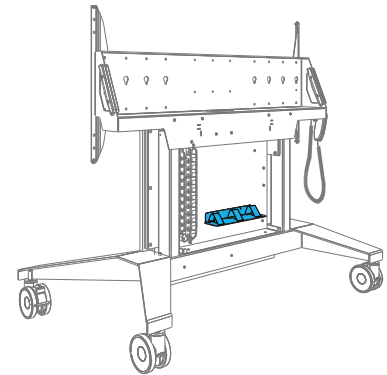

**Accessory Shelf
with Straps - FPSA/AS1**