



RC-8iR

8-Button Universal Room Controller with IR Learning



The **RC-8iR** is an 8-button room controller for multimedia rooms. It controls audio components, video components and other room facilities such as lights and screens.

Available in Gray, White & Off-White

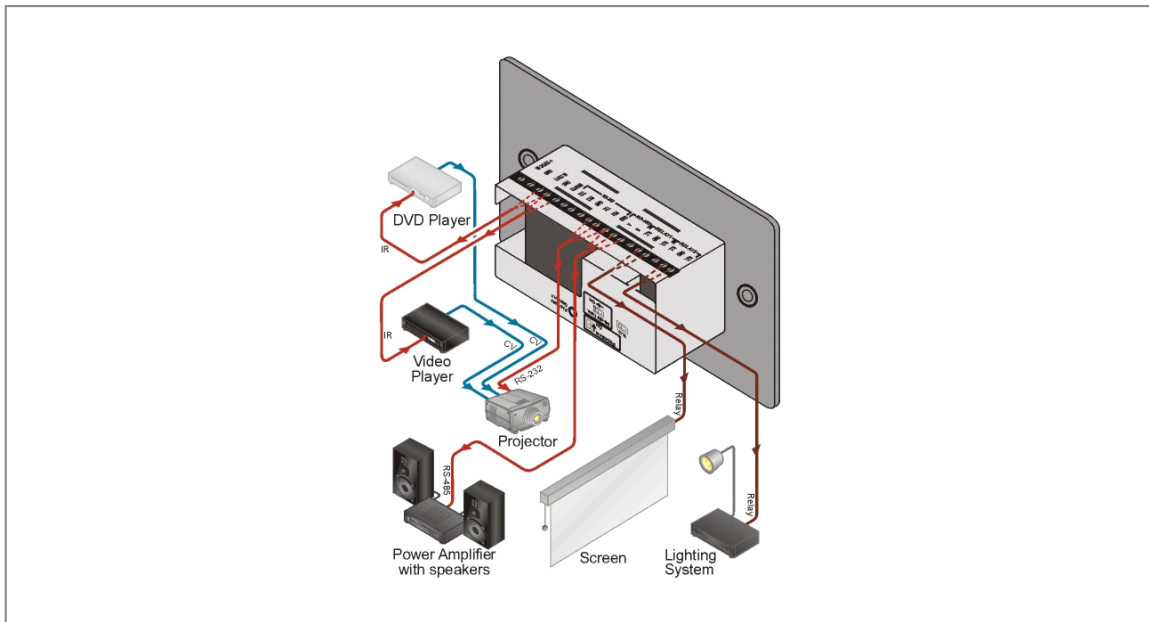



RC-8iR

FEATURES

- **8 Back Lit & Label Capable Buttons** - Up to 15 commands per macro and 4 toggling macros per button.
- **Ethernet Port** - Allows for easy setup with Kramer's Windows®-based configuration software from an internet connection anywhere in the world.
Note: Although under certain conditions the Ethernet port of the RC-8iR may be used to control an AV product, it is not designed for this purpose and we do not recommend doing this.
- **2 IR Ports.**
- **IR Learning Function** - Learn commands from IR remotes.
- **2 Relay Contact Closure Ports** - Conveniently control other room items related to the AV system such as raising and lowering drapes, the screen or the projector.
- **2 Bidirectional RS-232 and 1 RS-485 Ports** - Control up to three additional devices via serial control protocols.
- **Lock Out Feature** - The RC-8iR can be locked and unlocked to prevent tampering.
- **Dimensions** - 6.9cm x 3.14cm x 11.4cm (2.71" x 1.23" x 4.49") US; 15.1cm x 3.14cm x 8.6cm (5.94" x 1.23" x 3.39") and 15.1cm x 3.14cm x 8.0cm (5.94" x 1.23" x 3.15") EU W, D, H.
- **Wall Plate Size** - 1 gang US, 2 gang EU.

TECHNICAL SPECIFICATIONS

PORTS:	2 RS-232 on terminal block connectors, 1 RS-485 on terminal block connectors, 1 Ethernet RJ-45 port, 2 IR.
OUTPUTS:	2 relays on terminal block connectors (36V AC or DC, 2A, 60V AC maximum on non-inductive load); 2 IR emitters on terminal block connectors (for RC-6iR and RC-8iR).
POWER SOURCE:	12V DC, 155mA.
DIMENSIONS:	6.9cm x 3.14cm x 11.4cm (2.71" x 1.23" x 4.49") US; 15.1cm x 3.14cm x 8.6cm (5.94" x 1.23" x 3.39") and 15.1cm x 3.14cm x 8.0cm (5.94" x 1.23" x 3.15") EU W, D, H.
WEIGHT:	0.3kg (0.67lbs) approx.
ACCESSORIES:	Power supply, Java based control software (internal), Kramer's Windows®-based configuration software.
OPTIONS:	Dual IR emitter cable, single IR emitter cable, IR extension cable.