

194x260mm

PRODUCT DISPLAY

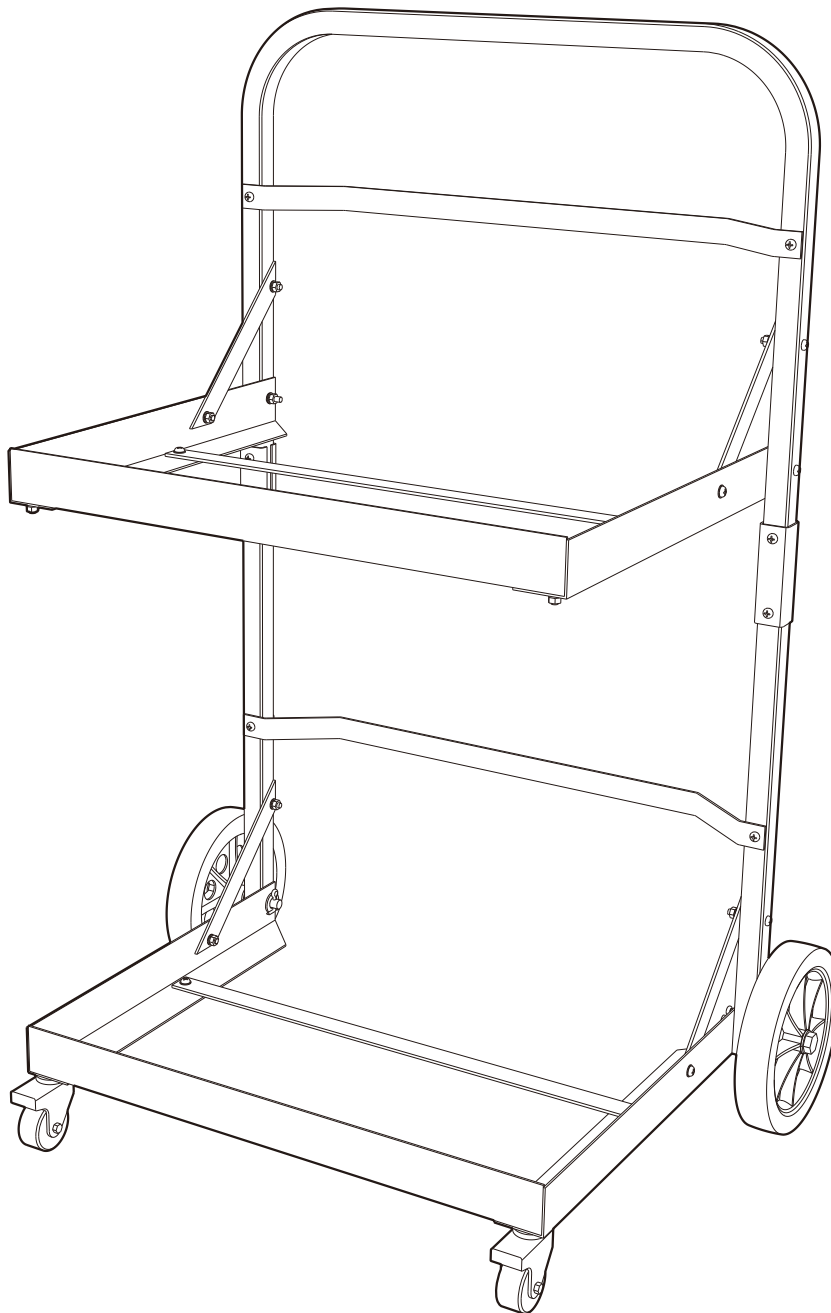

RECYCLE CART

Assembly Instructions

www.recyclecarts.com

SCHEMATIC DIAGRAM OF INTEGRAL PART LIST

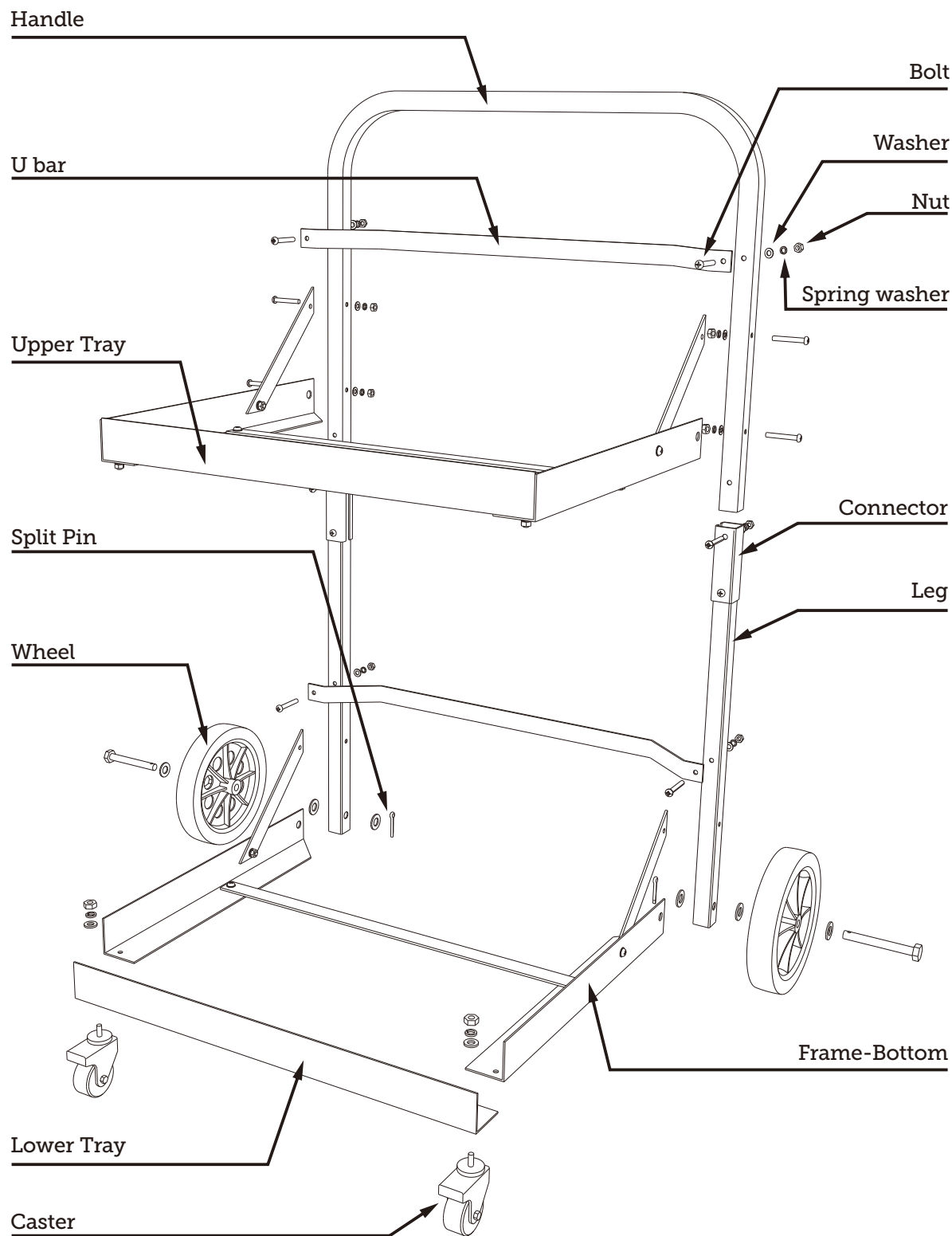

TOOLS REQUIRED

Scissor (for unpacking)

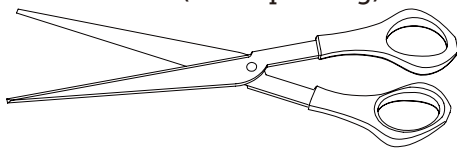

Philips head screwdriver to hold bolts.

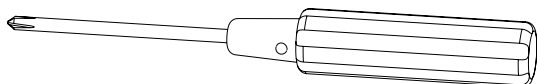

Adjustable wrench
(for tightening the nut)

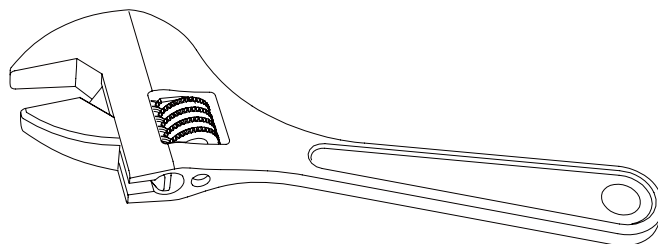

HARDWARE / QUANTITY DESCRIPTION

(1)

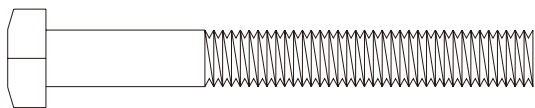

M12x80mm Bolt (2 PCS)



M12 Washer (6PCS)

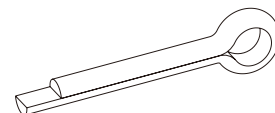

Split Pin (2PCS)

(2)

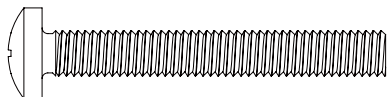

M6x40mm Bolt (12 PCS)



M6 Spring Washer (12 PCS)



M6 Washer (24 PCS)



M6 Nut (12 PCS)

(3)



M8 Washer (2 PCS)



M8 Spring Washer (2 PCS)

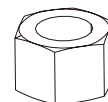

M8 Nut (2 PCS)

INSTALLATION PROCEDURE

1

Connect the top handle
with 2 square tube
extensions.

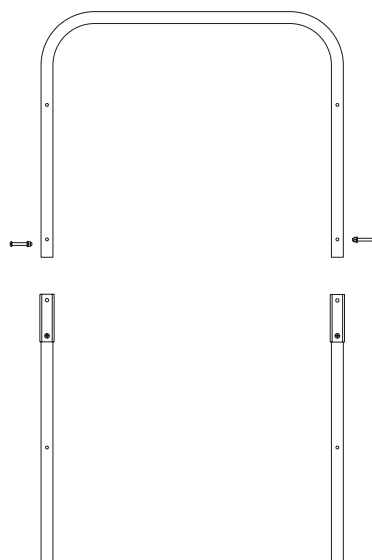

- Bolt M6x40mm
- Nut M6
- Washer M6
- Spring Washer M6

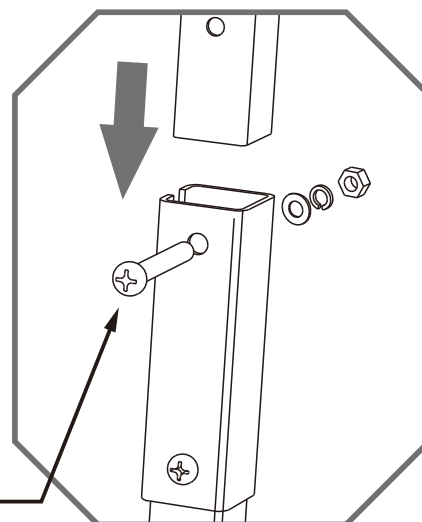

2

Install the upper tray on the top handle.

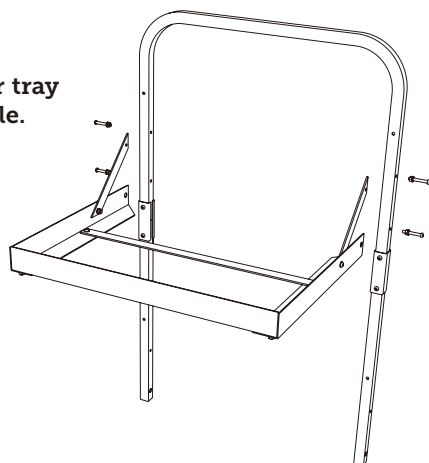

- Bolt M6x40mm
- Nut M6
- Washer M6
- Spring Washer M6

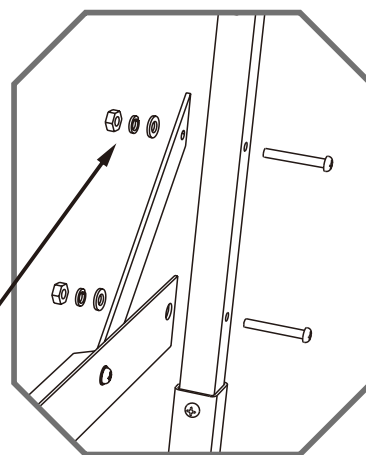

3

Install the front frame on the lower tray together with the 2 casters.

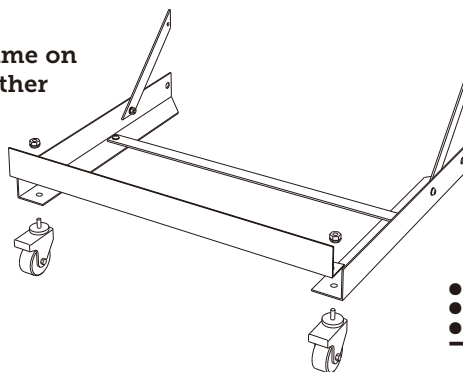

- Nut M8
- Washer M8
- Spring Washer M8

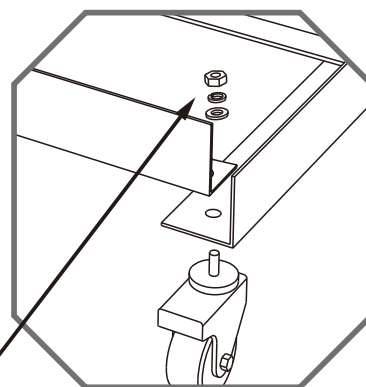

4

Install the wheels together with the lower tray and the tube extensions.

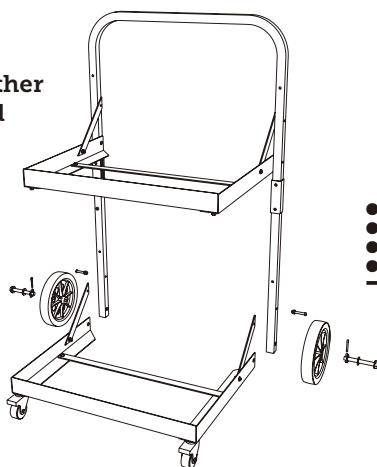

- Bolt M12x80mm
- washer M12
- Spring washer M12
- Split Pin

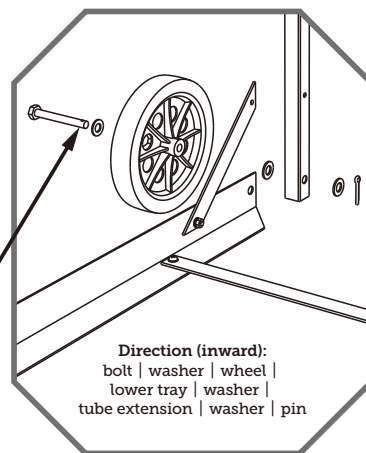

5

Install the U-Bars on the handle.

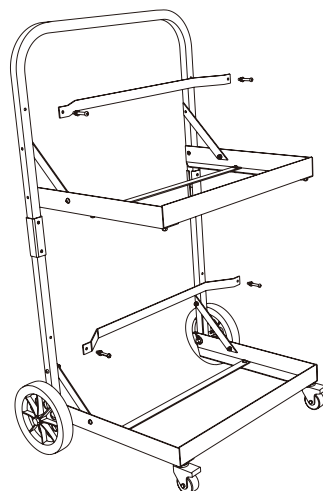

- Bolt M6x40mm
- Nut M6
- Washer M6
- Spring Washer M6

