

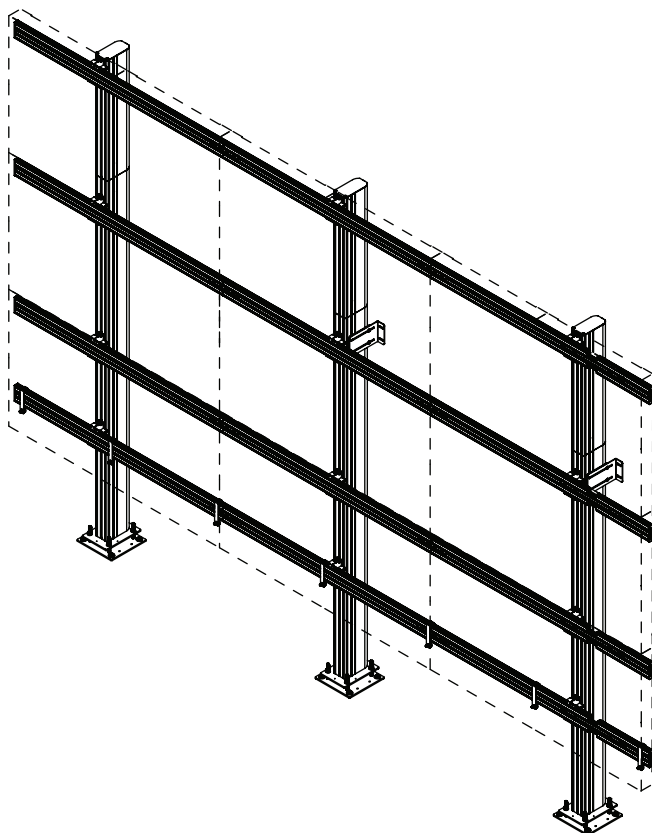

SEAMLESS Connect Universal dvLED Floor-to-Wall LEDFWL Series



⚠ WARNING

ENG - This product is designed to be installed on solid concrete. Hardware is included for solid concrete installation. Before installing make sure the supporting surface will support the combined load of the equipment and hardware. Screws must be tightly secured. Do not overtighten screws or damage can occur and product may fail. Never exceed the Maximum Load Capacity. Always use an assistant or mechanical lifting equipment to safely lift and position equipment. This product is intended for indoor use only. Use of this product outdoors could lead to product failure or personal injury. Be careful not to pinch fingers when operating the mount. For support please call customer care at 1-800-865-2112.

ENG Symbols



ENG **WARNING**



ENG Screws must get at least three full turns and fit snug.

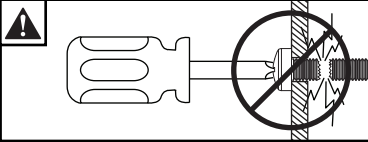

ENG Do not overtighten screws.



ENG To properly tighten screws: Tighten until screw head makes contact, then tighten another 1/2 turn. Do not overtighten screws.

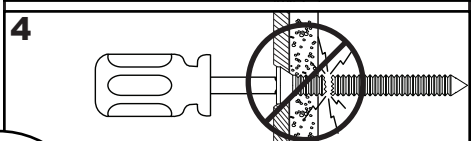
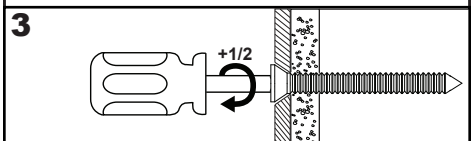
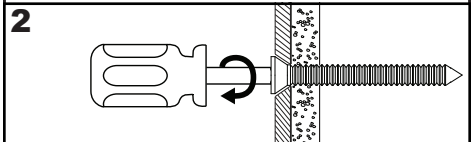
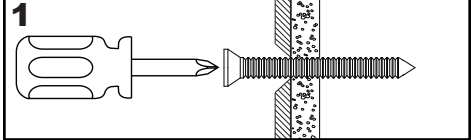

Tools Needed for Assembly.

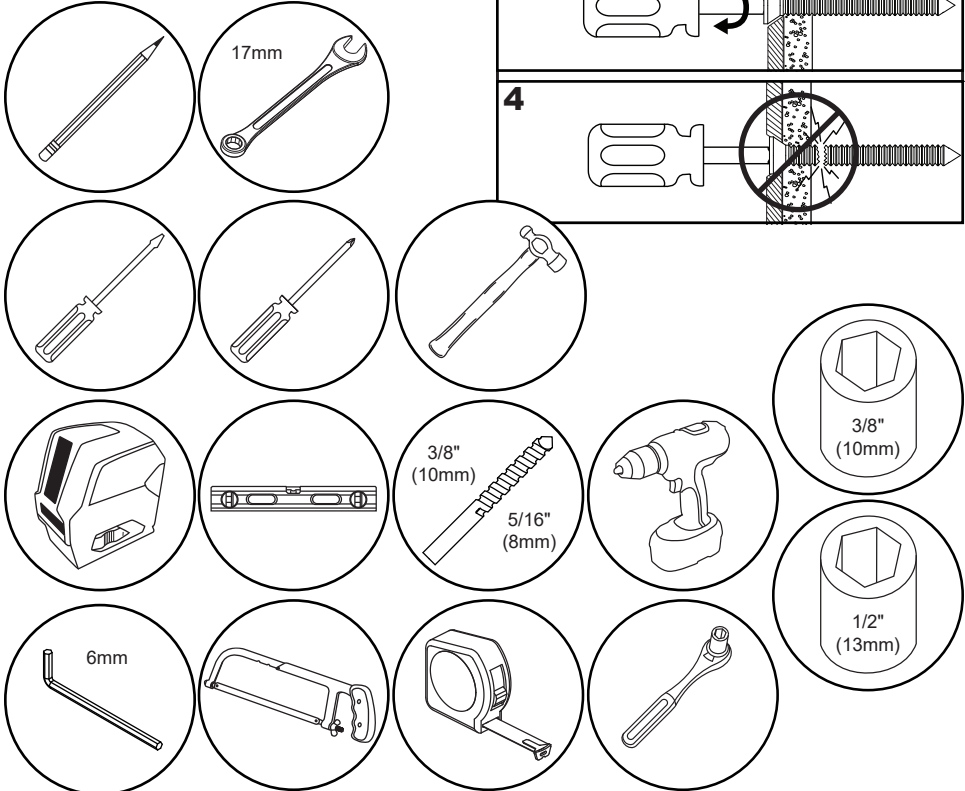

Parts (Before beginning, make sure you have all parts shown below). *Refer to parts list included with your model.

Parts List	
Description	Qty*
A base mounting plate	*
B floor plate	
C hex nut	
D attachment bracket	
E M8 x 50mm socket screw	
F 1/4" washer	
G upright, long	
H upright, short	
I latch assembly	
J extrusion end cap	
K 8mm concrete anchor	
L #14 x 2-1/2" wood screw	
M horizontal extrusion 1200mm	
N nut bar, four screw	
O barbed fastener	
P upright cover	
Q M10 washer	
R -	
S horizontal extrusion expandable	
T drop-in nut bar	
U rawl bolt	
V 5mm allen wrench	
W M5 cup washer	
X M6/M8 cup washer	
Y M5 flat head screw	
Z M6 flat head screw	
AA M8 flat head screw	
BB M10 flat head screw	
CC stand-off bracket	
DD -	
EE -	
FF nut bar, two screw	
GG M6 x 10mm socket screw	
HH 1" washer	
II adjustable wall bracket	
JJ -	
KK -	
LL top alignment plate	
MM M6 boss washer	
NN M8 boss washer	
OO M10 boss washer	

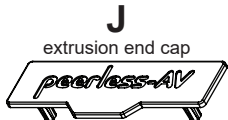
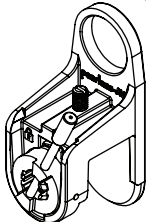
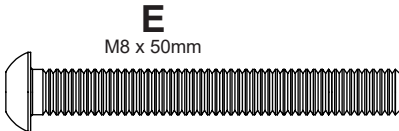
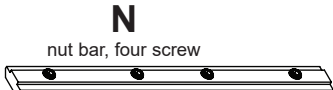
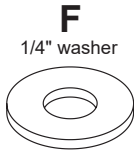
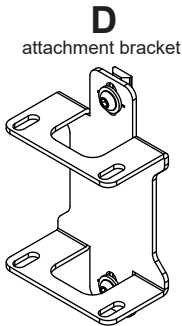
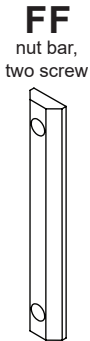
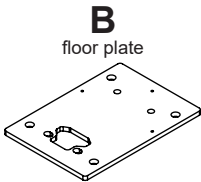
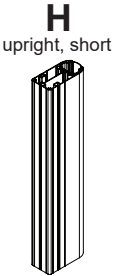
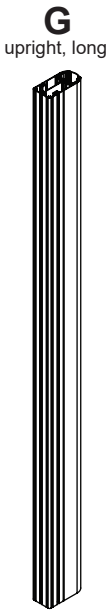
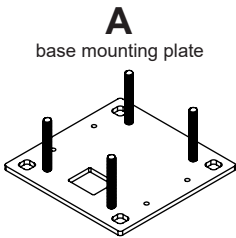

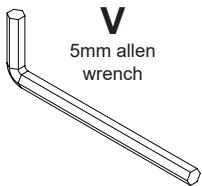

V
5mm allen
wrench

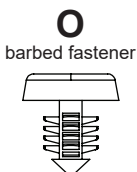

O
barbed fastener

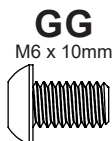

GG
M6 x 10mm

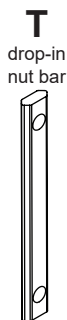

T
drop-in
nut bar

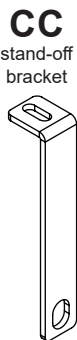

CC
stand-off
bracket

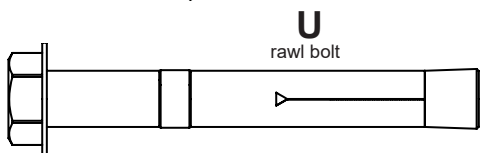

U
rawl bolt



W
M5 cup
washer

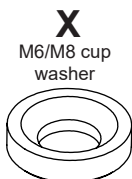

X
M6/M8 cup
washer



Y
M5 flat
head screw

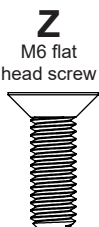

Z
M6 flat
head screw

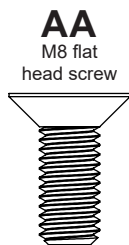

AA
M8 flat
head screw

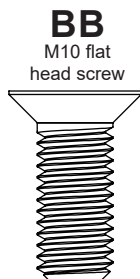

BB
M10 flat
head screw

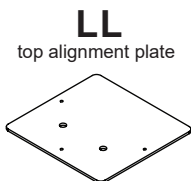

LL
top alignment
plate

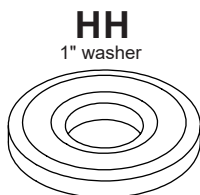

HH
1" washer

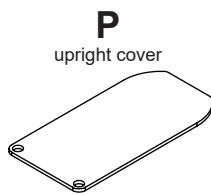

P
upright cover

II
adjustable wall bracket

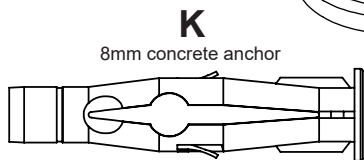
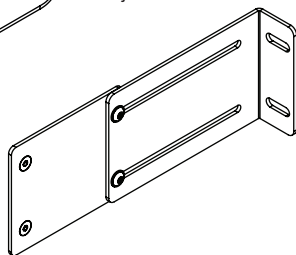

K
8mm concrete anchor

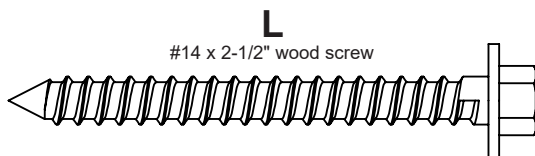

L
#14 x 2-1/2" wood screw

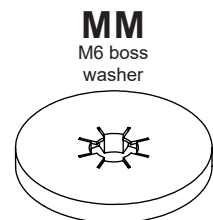

MM
M6 boss
washer

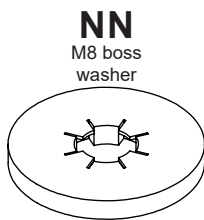

NN
M8 boss
washer

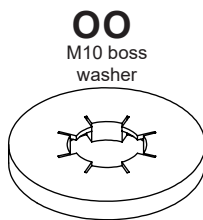

OO
M10 boss
washer

Parts List		
	Description	Qty.
AAA	spacer	2
BBB	3mm allen wrench	1
CCC	laser target	2
DDD	4mm allen wrench	1
EEE	spacer extension	2
FFF	shim plate	2
GGG	M4 flat head screw	12

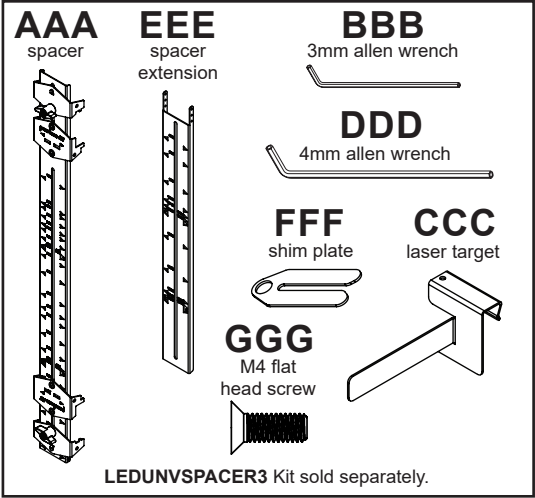

1

Scan QR Code provided to obtain dvLED configurator drawing specific to your model.

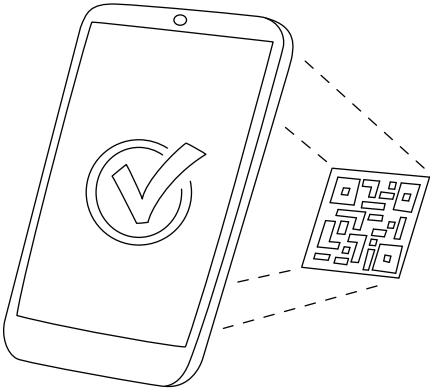

USA



UK

Join vertical uprights using nut bars provided. Arrange so that longest upright is at the bottom. Ensure threaded holes are at bottom of the bottom upright.

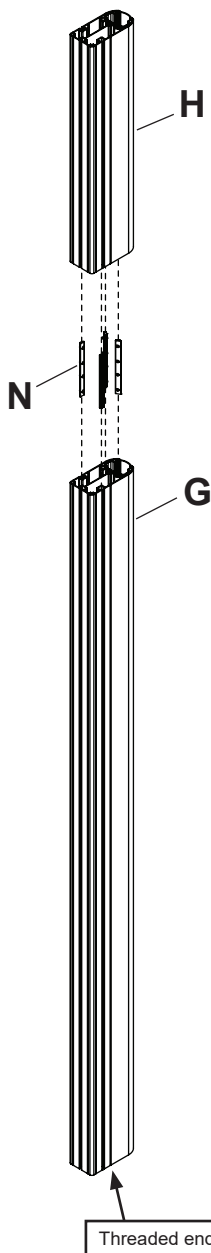

TOP VIEW

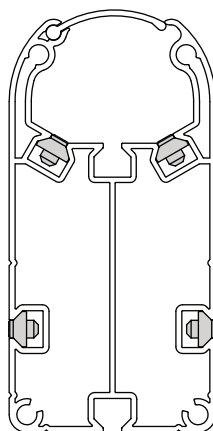

SIDE VIEW

MIN 25 in. • lb
(2.82 N.M.)

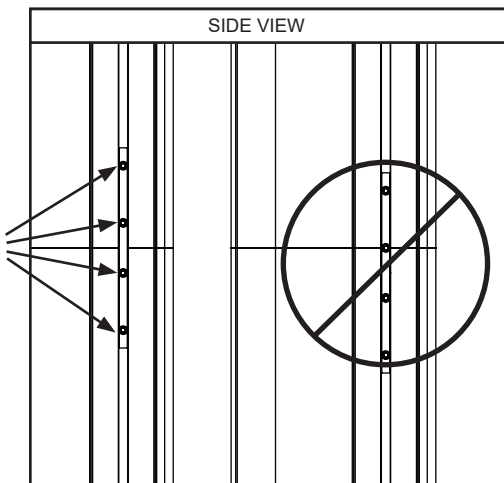

▲ WARNING

ENG - When installing Peerless mounts on a concrete floor, the floor must be at least 8" thick with a minimum compressive strength of 2000 psi. Never attach concrete expansion anchors to concrete covered with plaster, drywall, or other finishing material.

3-1

Reference configuration drawing specific to your model for spacing of base mounting plates. Mark mounting holes.

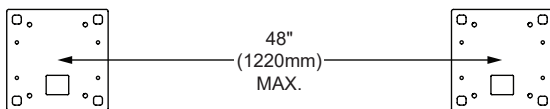
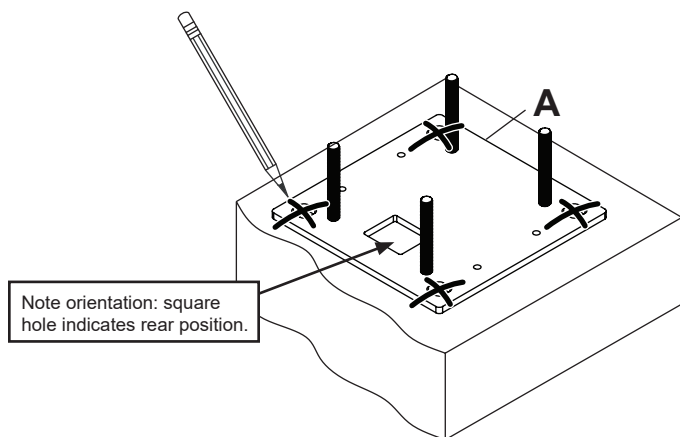

Spacing between two uprights shall not exceed 48" (1220mm).

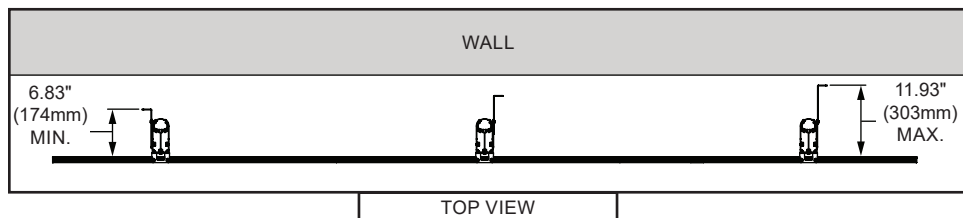
**3-2**

Drill mounting holes into supporting surface (3" (76mm) minimum depth required).

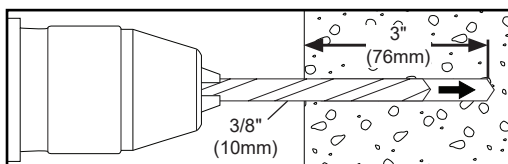
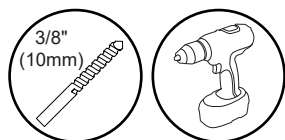

3-3

Align base mounting plates. Install using concrete anchors provided. Install M10 nuts and M10 washers onto threaded posts.

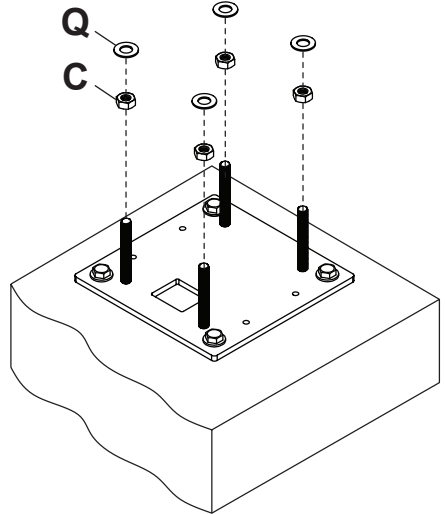
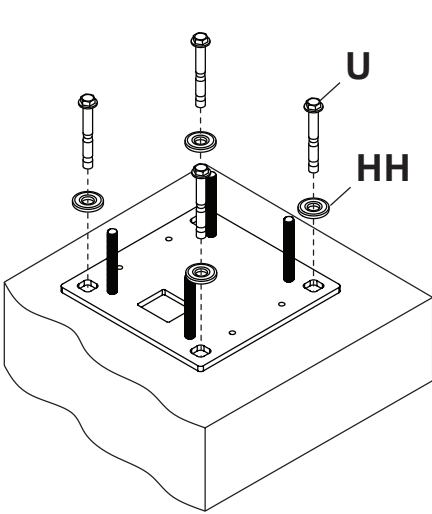
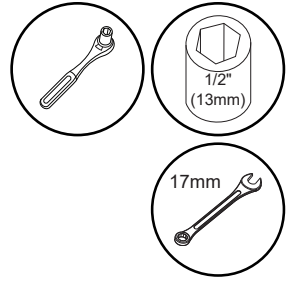
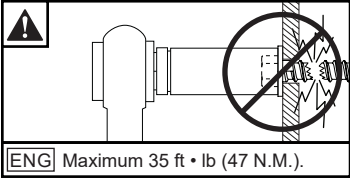

3-4

Slide adjustable wall brackets onto uprights from the bottom. Refer to configuration drawing specific to your model to determine orientation of adjustable wall brackets.

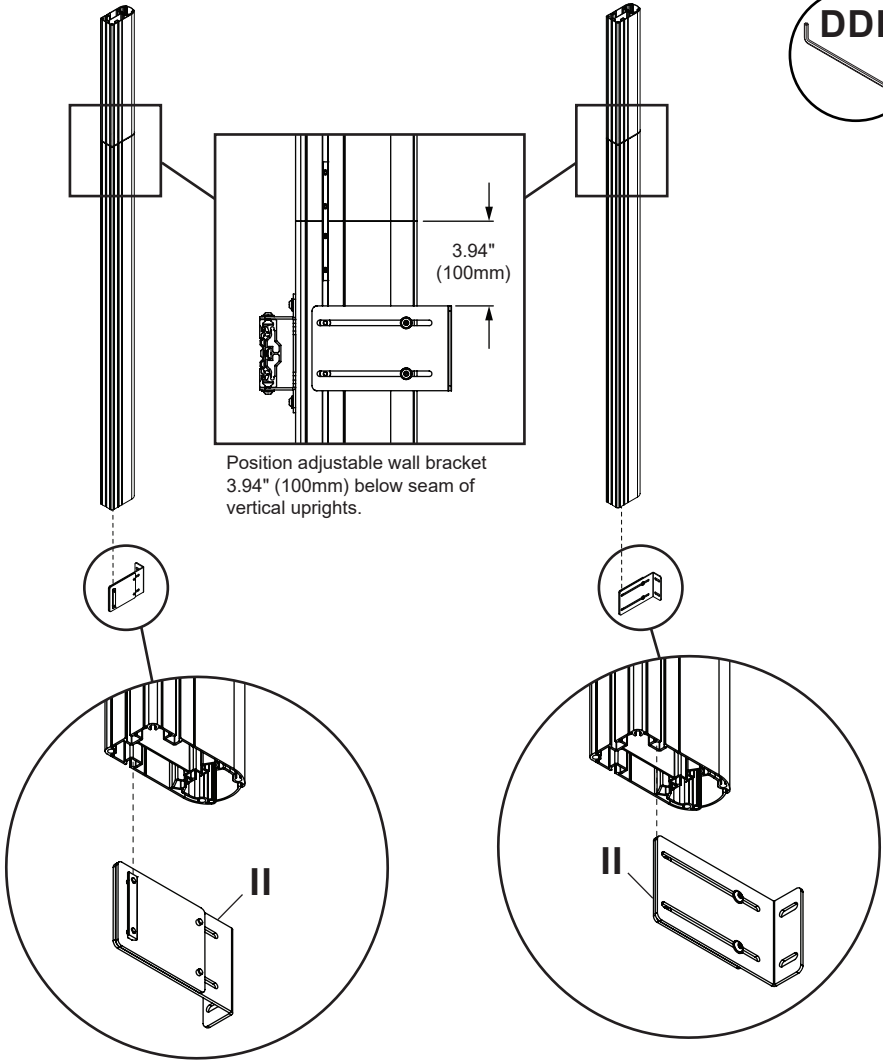

3-5

Attach floor plate to the bottom of each vertical column with cut out hole to the rear.

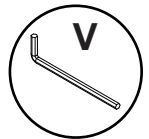
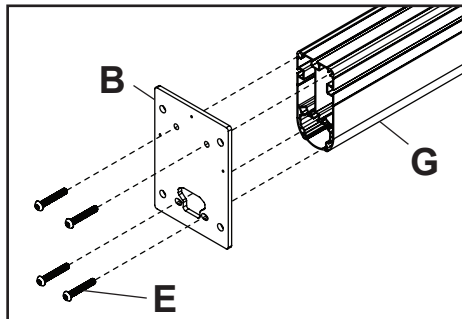

3-6

Install vertical upright assemblies to the base mounting plates.
Use a plumb laser to align holes of top alignment and base mounting plate to achieve plumb. Tighten hardware. Repeat for every upright assembly.

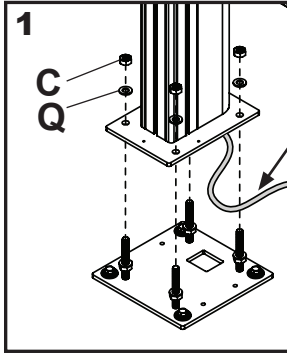
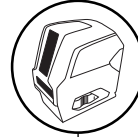
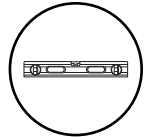

Route cables through vertical upright prior to securing to base mounting plate.

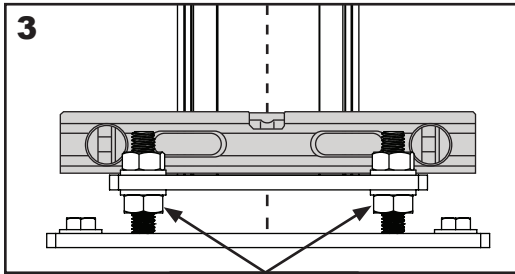
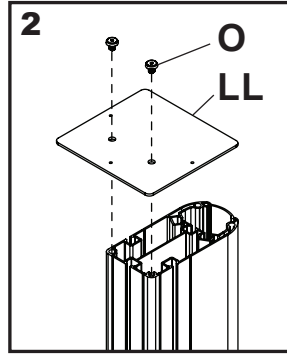

Adjust to level/plumb.

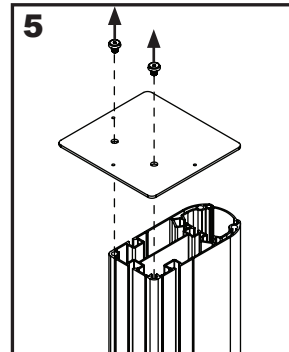
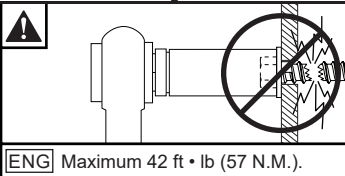
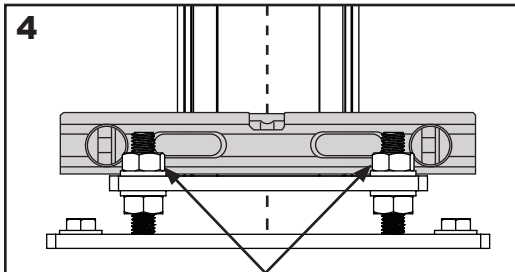

Remove top alignment plate when finished.

Slide brackets onto vertical upright. Hand tighten hardware.

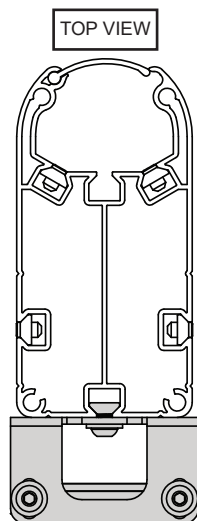
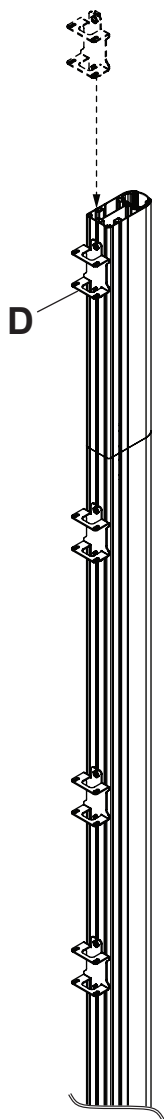

5-1

Viewing from the front, arrange extrusions as shown when building assembly.
Expandable extrusion shall be installed on the far right side, note orientation.



5-2

For displays narrower than 1200mm, determine the required extrusion length with the following extrusion cut to length formula:

$$\text{Video Wall Width} - 0.25" (6\text{mm}) = \text{Extrusion Length}$$

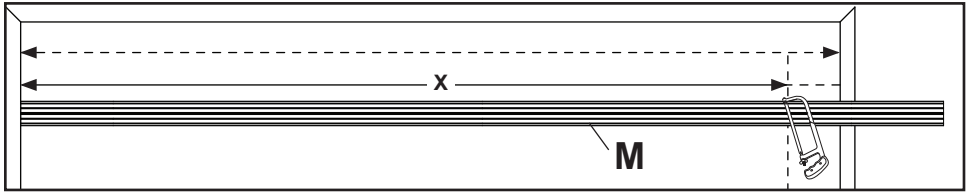

5-3

Connect two horizontal extrusions using connector plate.

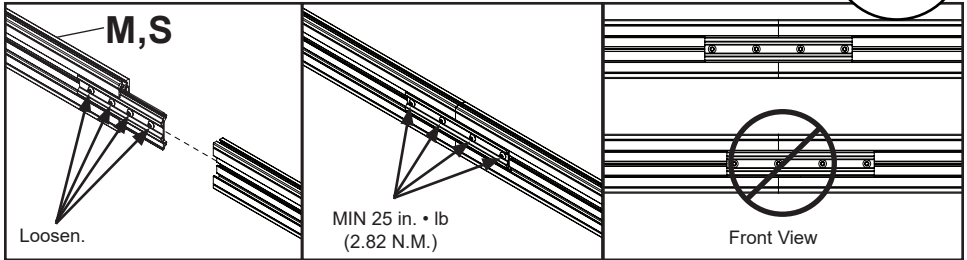

5-4

Extend the connection joint of expandable extrusion as needed.

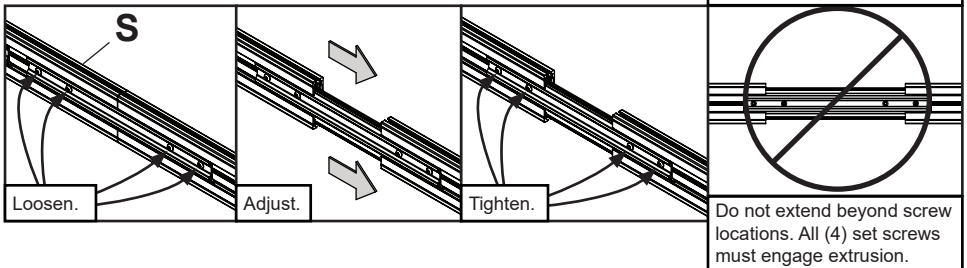

6-1

Slide nut bars into top and bottom channels of horizontal extrusions.

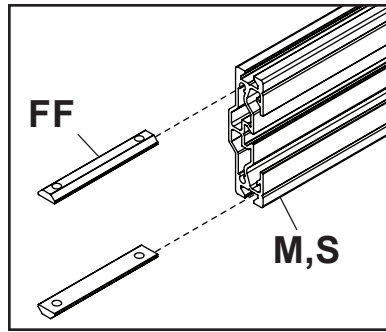

6-2

Position horizontal extrusions into the openings of the attachment brackets. Align nut bars inside the top and bottom channels of horizontal extrusion with holes of attachment brackets. Secure using hardware provided.

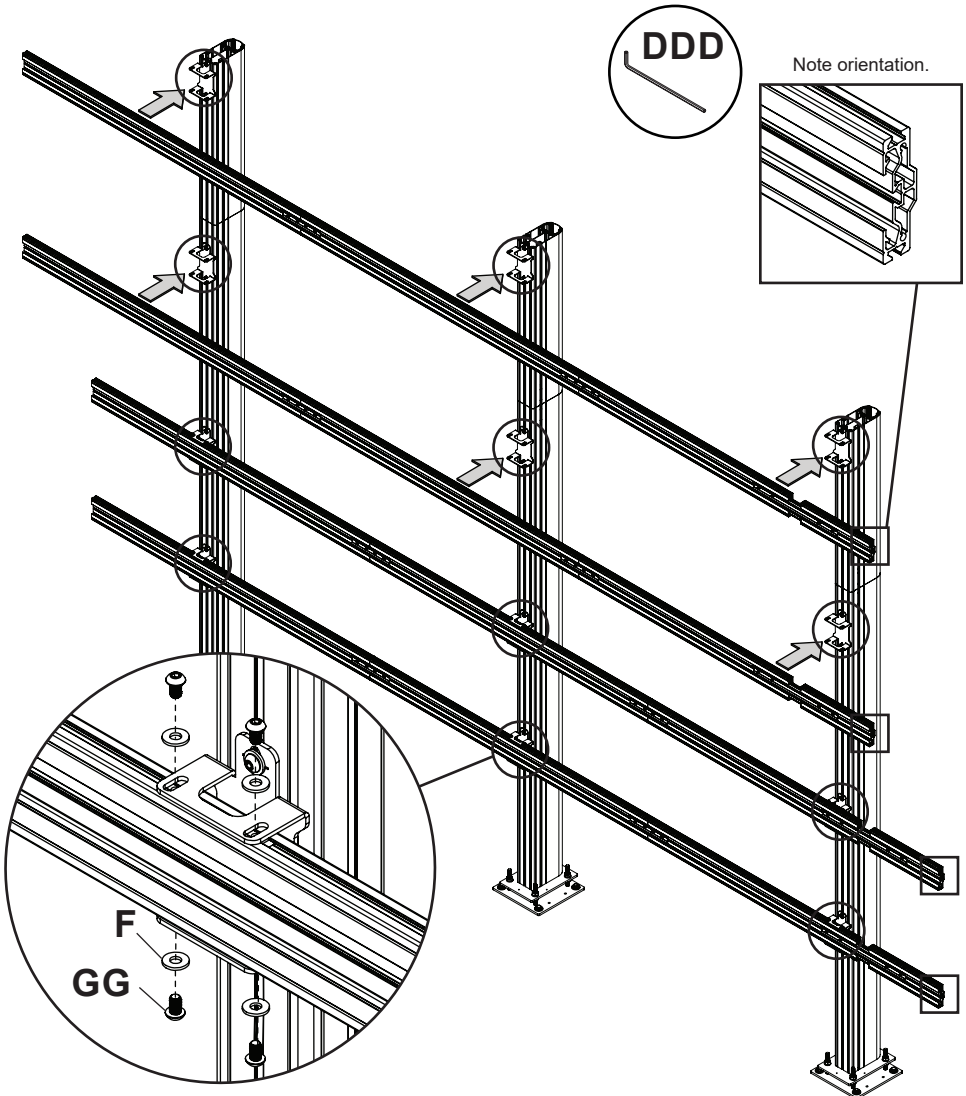

This page intentionally left blank.

WALL

6.83"
(174mm)
MIN.11.93"
(303mm)
MAX.

TOP VIEW

DDD

Loosen, adjust, tighten.

⚠ WARNING

ENG - When installing Peerless wall mounts on a concrete wall, the wall must be at least 8" thick with a minimum compressive strength of 2000 psi. When installing Peerless wall mounts on a cinder block wall, the cinder blocks must meet ASTM C-90 specifications and have a minimum nominal width of 8". Do not drill into mortar joints! Be sure to mount in a solid part of the block, generally 1" (25mm) minimum from the side of the block. It is suggested that a standard electric drill on slow setting is used to drill the hole instead of a hammer drill to avoid breaking out the back of the hole when entering a void or cavity. Never attach concrete expansion anchors to concrete or cinder block covered with plaster, drywall or other finishing material.

8-1

Ensure the assembly is level. Mark mounting holes.

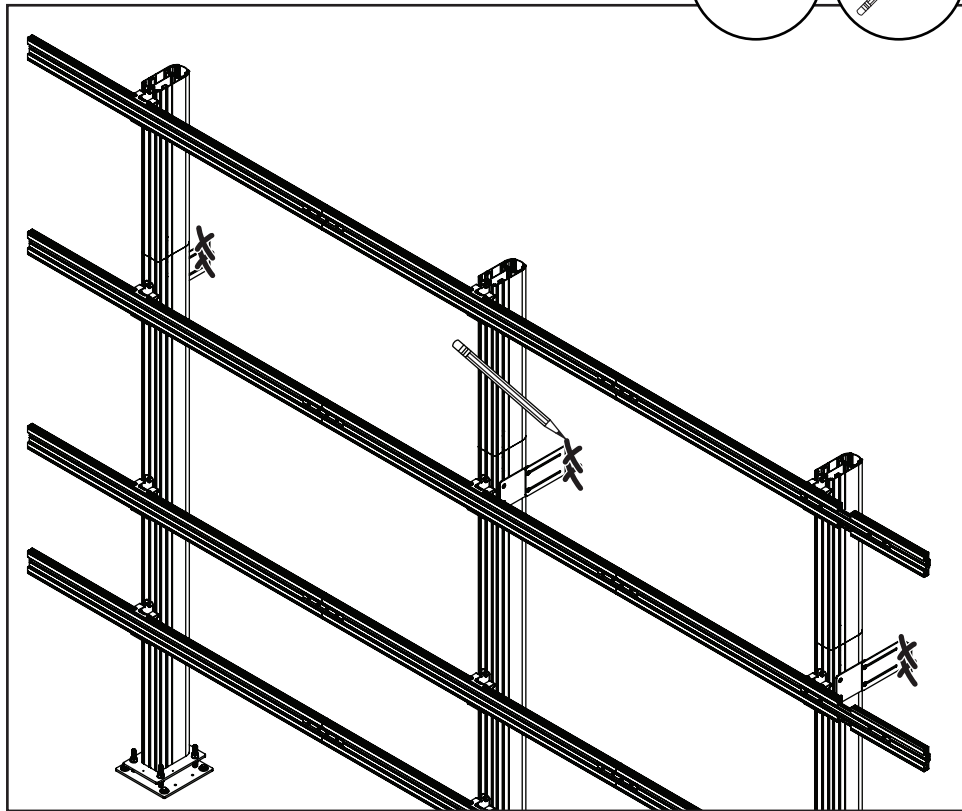
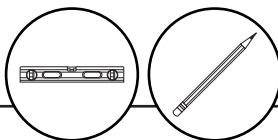
**8-2**

Drill mounting holes into supporting surface (2.5" (64mm) minimum depth required).

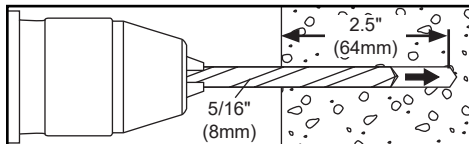
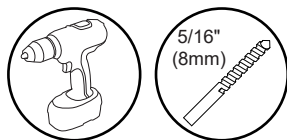

8-3

Insert anchor flush to concrete.

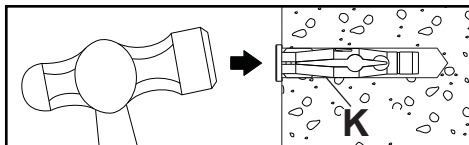
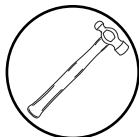

8-4

Install using concrete anchors and wood screws provided.

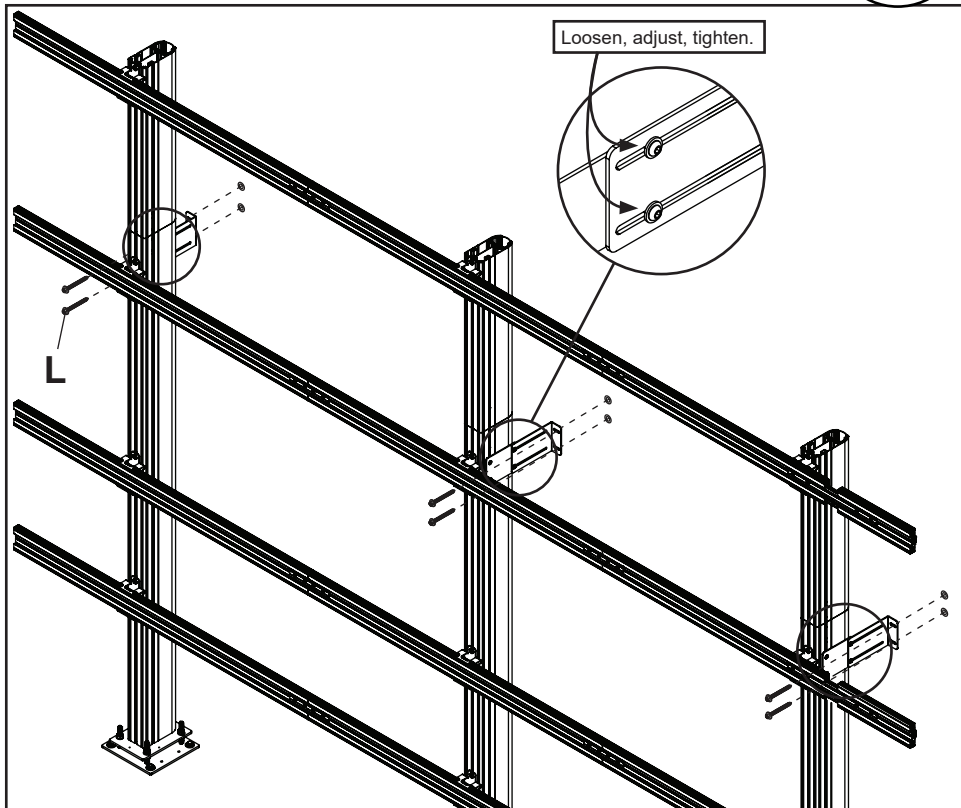
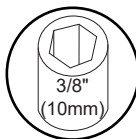
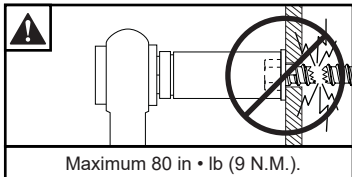

9-1

Determine the height of the displays being mounted and locate the same dimension on the front of the spacer. If that height is above 686mm, attach spacer extension. If that height is not listed on the spacer, use measurement of height of display to set custom spacing.

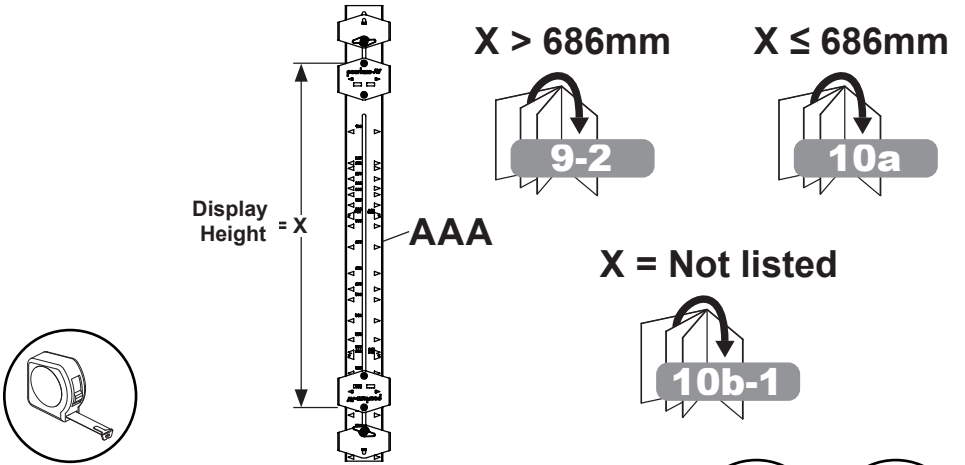

9-2

Add the extension when "X" measurement (step 9-1) is taller than 686mm. Detach lower fixed jaw and clamp bracket from main spacer assembly and reattach to the extension.

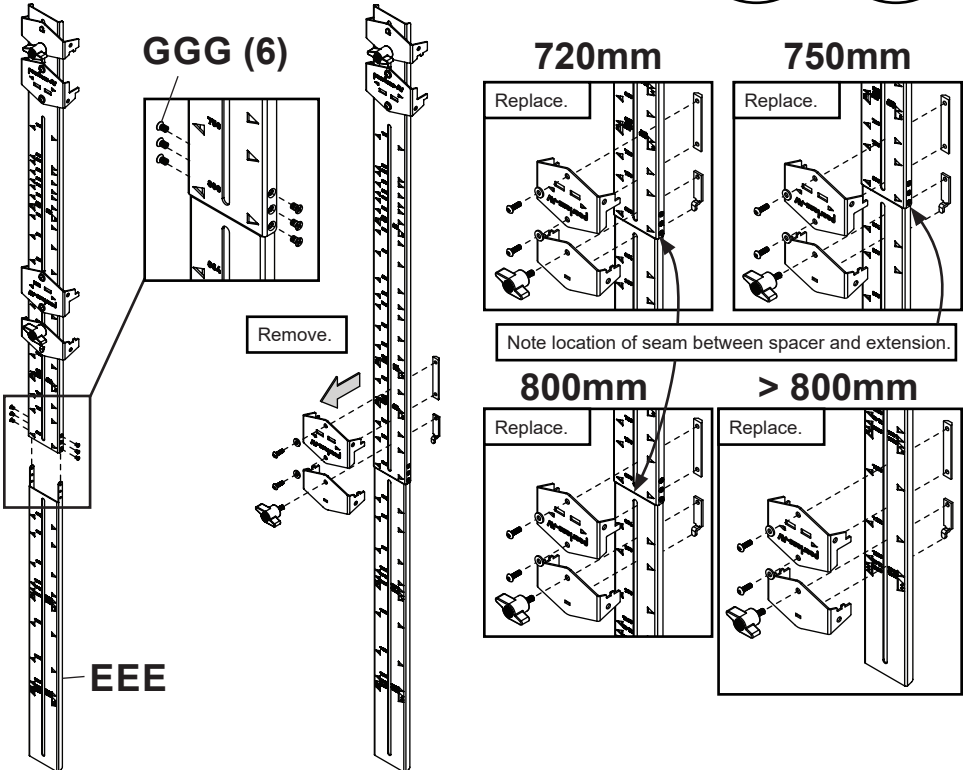

10a

Move spacer bracket and clamp to align window of spacer bracket with corresponding height value (measurement "X", step 9-1).

DDD

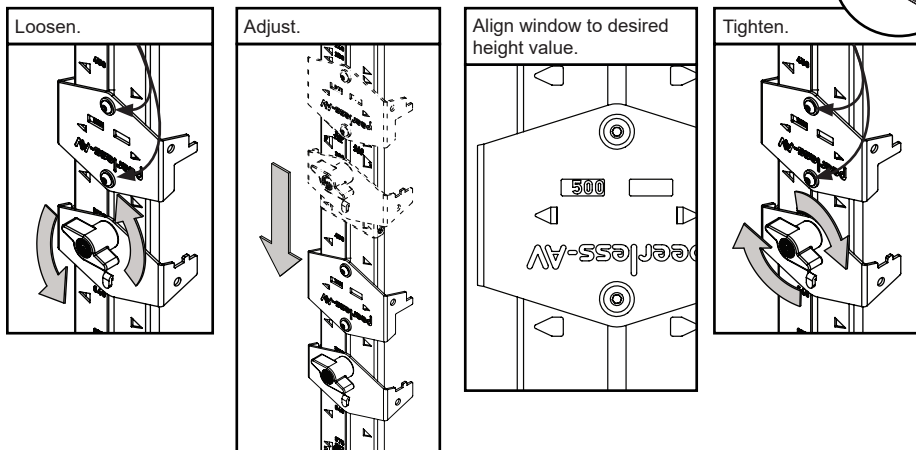

10b-1

If the display height is not listed on the spacer, measure the display to set custom spacing. Remove top spacer clamp. Move upper spacer bracket to the zero position. Loosen lower spacer bracket to insert shim plate underneath to allow spacer bracket to slide freely.

DDD

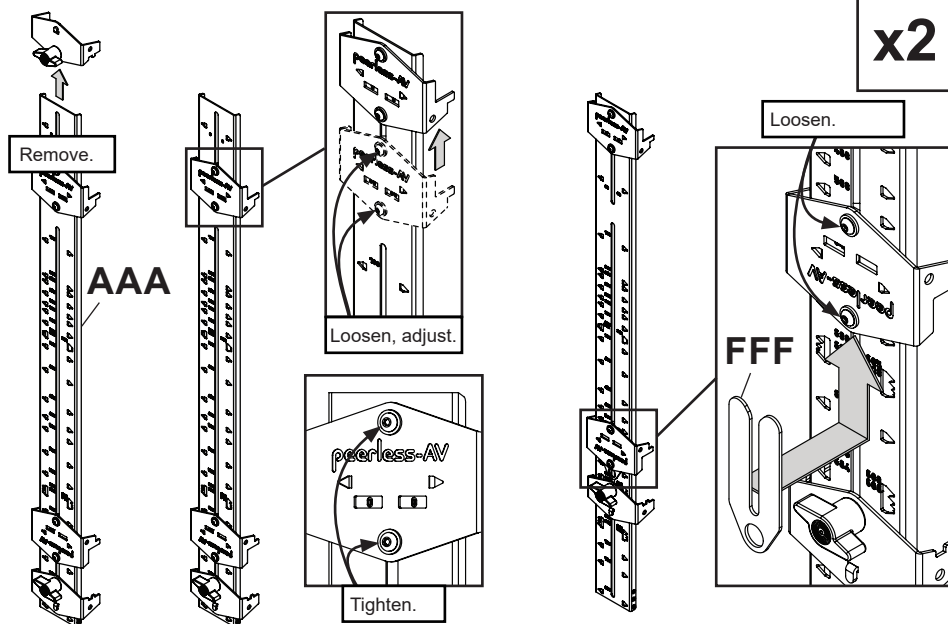

10b-2

With spacer brackets positioned wide enough to fit display inside, position notch of top spacer bracket flush with top edge of display. Slide the bottom spacer bracket to the bottom edge of display. Tighten screws of bottom spacer bracket.

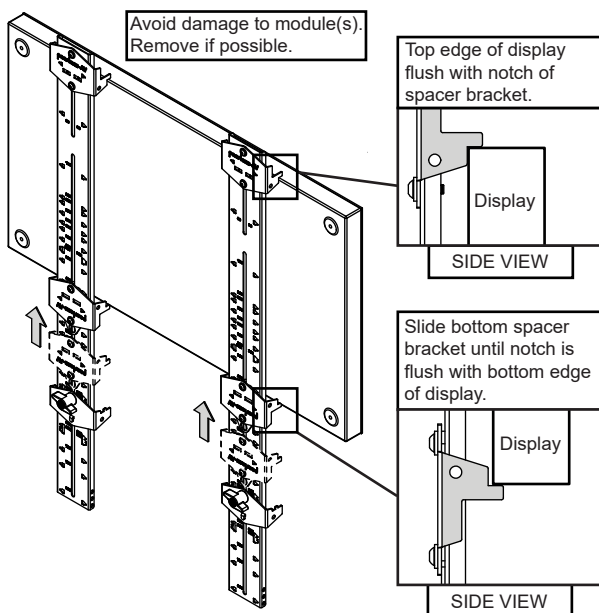

DDD

Tighten.

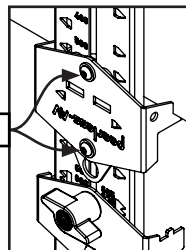

10b-3

Remove display. Return top spacer bracket to the 80mm position. Replace top clamp onto assembly.

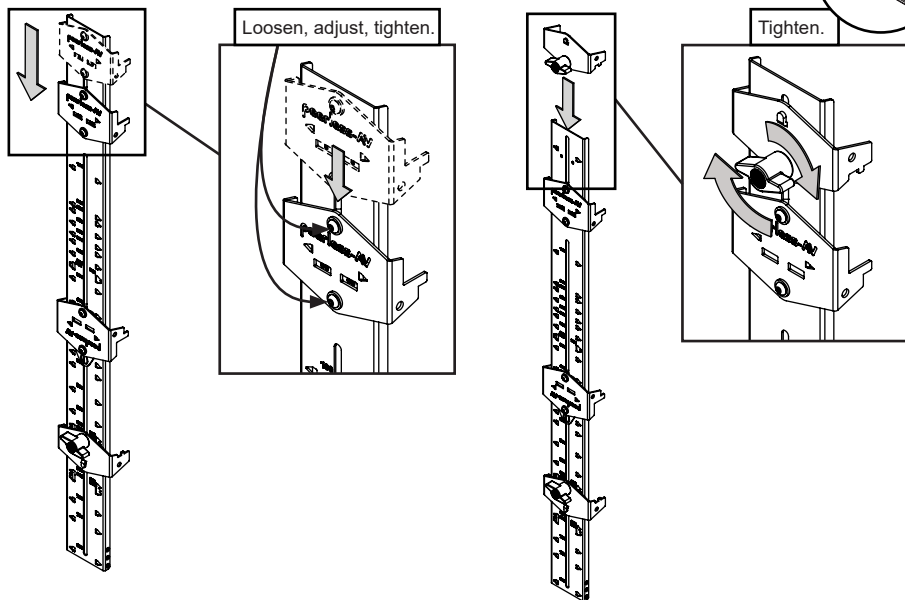

DDD

11-1

Refer to drawing specific to your model for measurements to locate top horizontal extrusion's height. The top of attachment bracket shall be flush with top of vertical upright. If a lower A.F.F. (Above Finished Floor) height is desired, adjust the height of the top horizontal extrusion as needed.

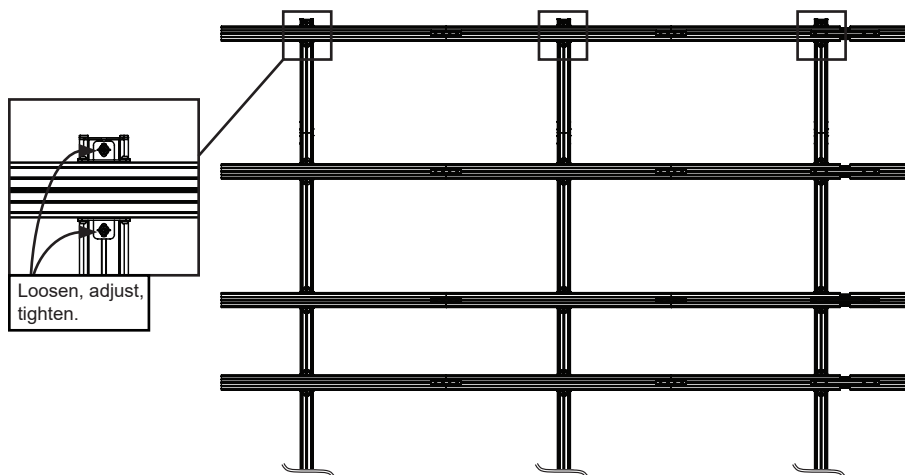

11-2

Adjust height of remaining extrusions using the spacers. Clamp the lower spacer jaw assembly to an unadjusted extrusion assembly. Clamp the upper spacer jaw assembly to extrusion previously installed. Vertically align extrusions with a laser. Tighten hardware.

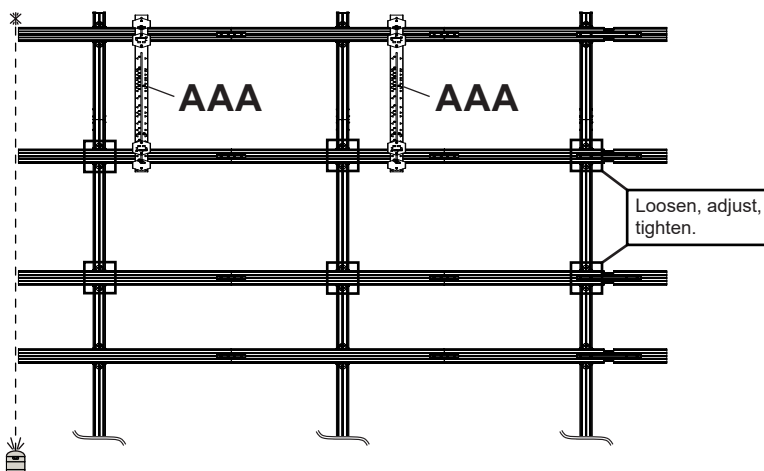
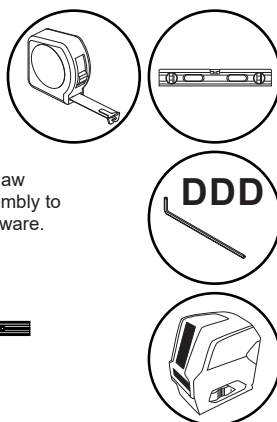

11-3

Refer to configuration drawing specific to your model to locate height of bottom extrusion.

Y = Bottom of horizontal extrusion second from the bottom to the top of horizontal extrusion on the bottom.

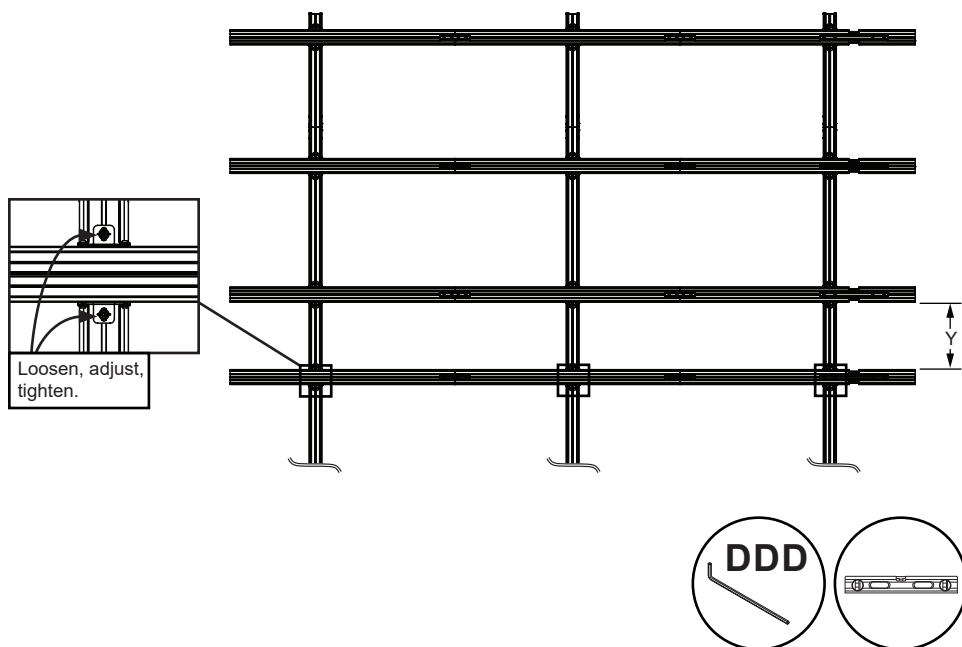

12

Optional: If uprights would be visible above the video wall, uprights may be cut as needed.

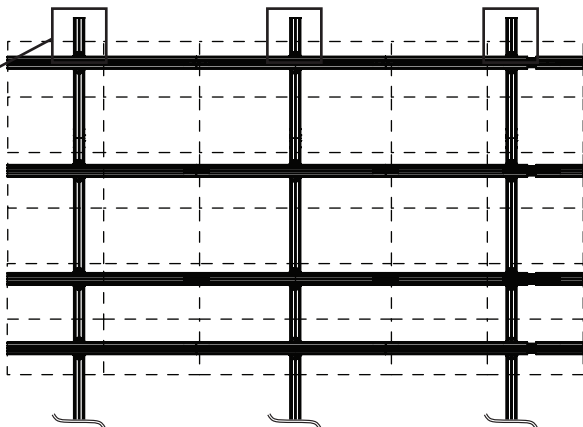
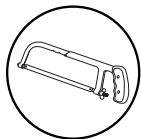
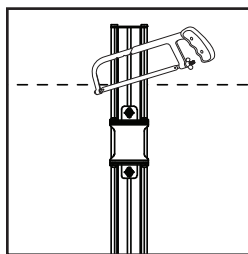

13

Set laser level so that it is parallel to the mount. With horizontal extrusion set all the way back, measure from the face of the extrusion to laser, in various locations. Mount laser target at the attachment bracket location that is near the mount's high point, determined by the shortest distance from the extrusion to the laser. Adjust extrusion out slightly, tighten adjustment screws and mark laser line on the target. Move target to a location near the next attachment bracket, adjusting depth until the laser is on the line, tightening screws as you go. Continue until all attachment brackets are adjusted.

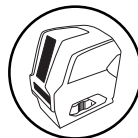

Double check using a straight edge to span three extrusions. Adjust low and high spots as needed.

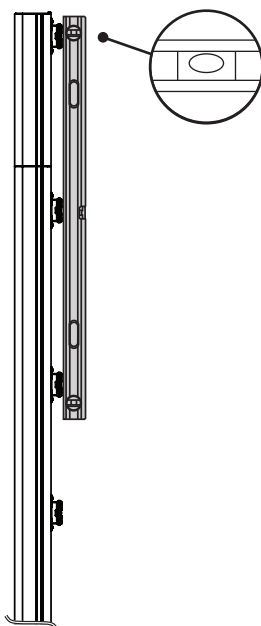
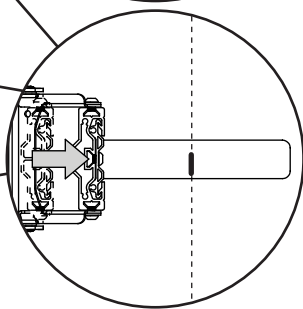
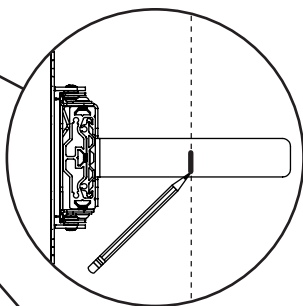
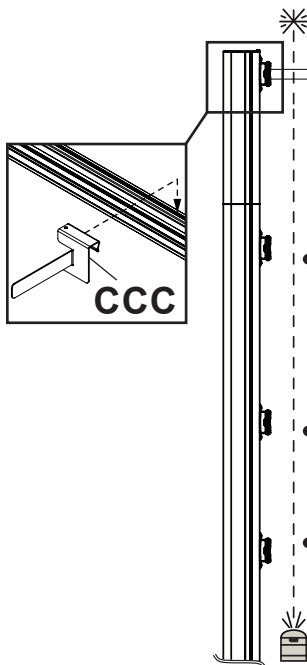

Install column covers and extrusion end caps.

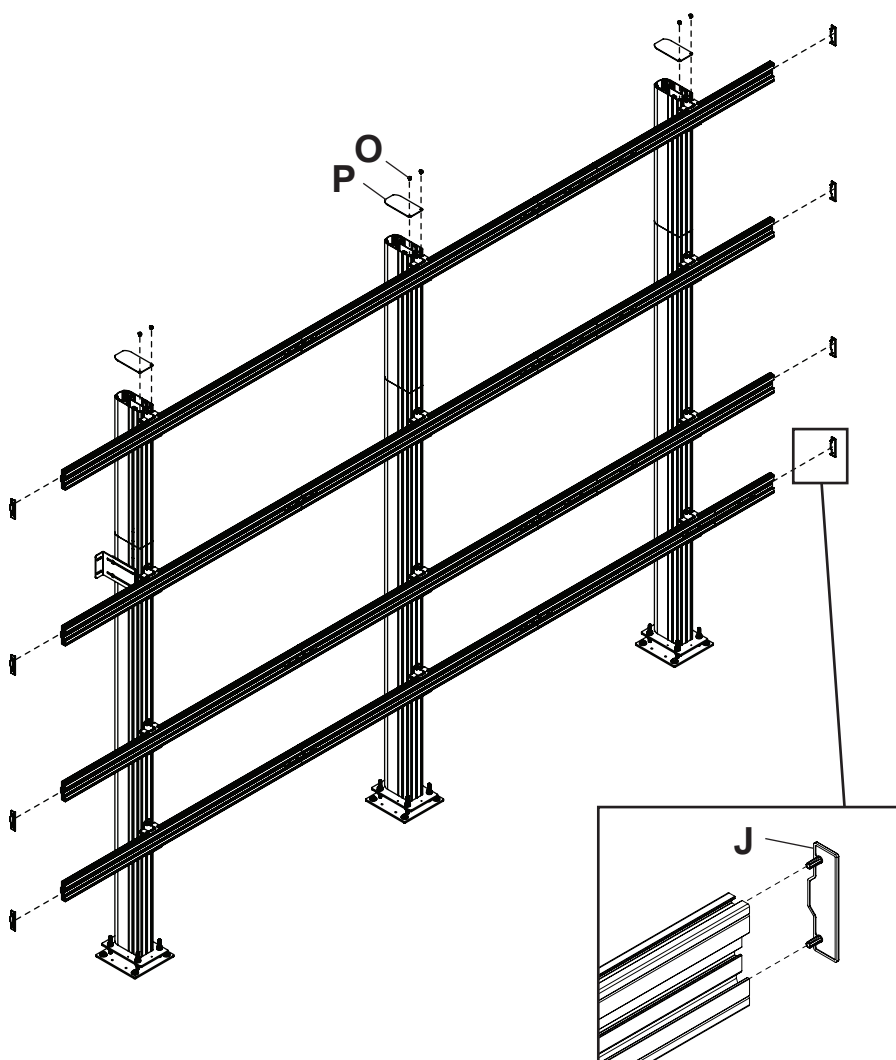



If mounting hardware is preinstalled, remove and replace with hardware provided.

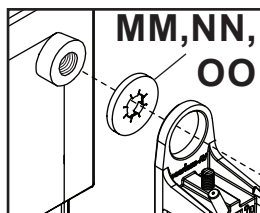
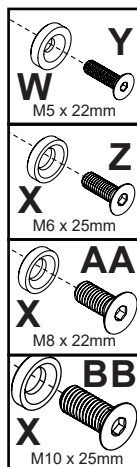
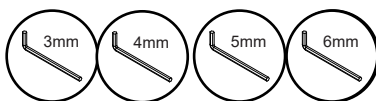
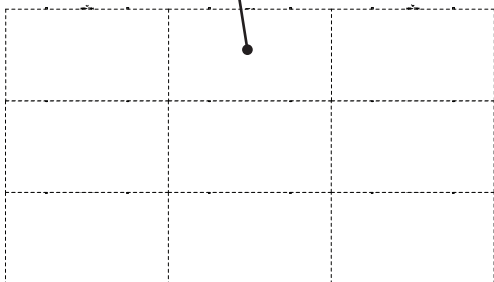
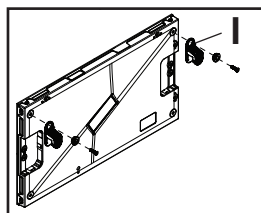

If display has raised mounting points, use boss washers as shown.

16-1

Install stand-off brackets to the bottom extrusion using drop-in nut bars as shown.

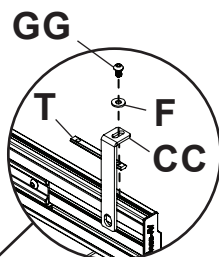
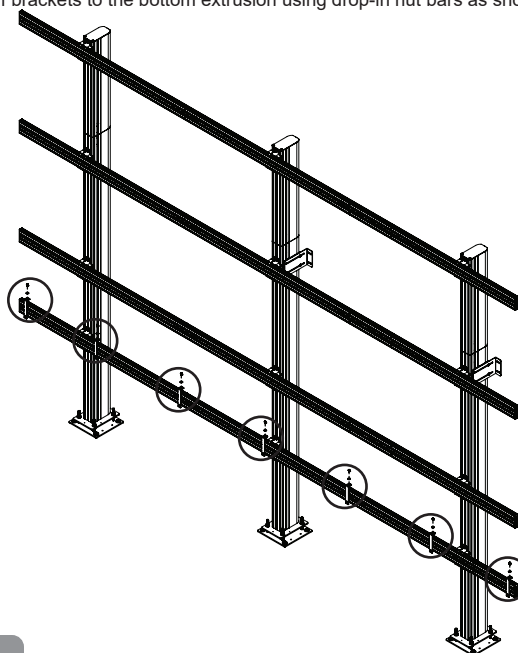

16-2

Hook display cabinets onto horizontal extrusion, adjust height to level and join cabinets together using display's connecting system. Close latch, then run cables one at a time starting from left to right.

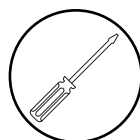
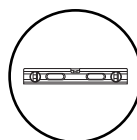

HEIGHT ADJUSTMENT

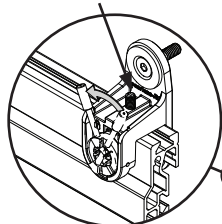

TURN LATCH LEVER
TO SECURE

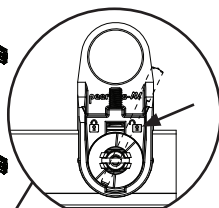
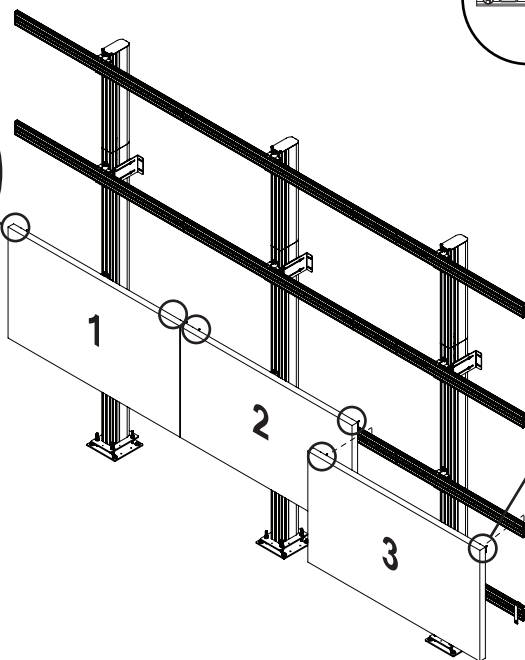

ENSURE LATCH IS
UNLOCKED PRIOR TO
INSTALLATION.

16-3

One stand-off bracket shall be located at every seam between two displays.
Secure stand-off brackets to the bottom mounting holes of the bottom row of displays.

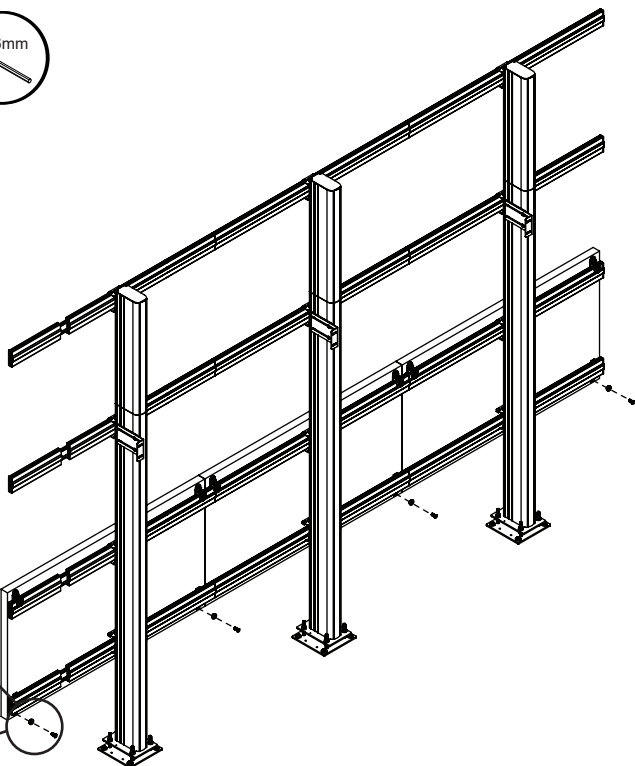
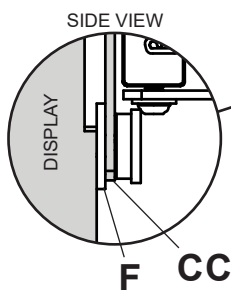
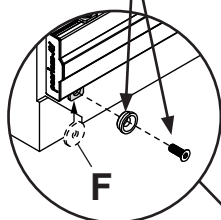
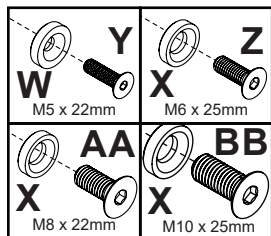
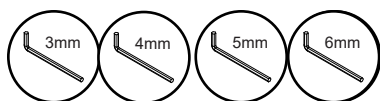

17

Hook display cabinets onto horizontal extrusion, adjust height to level and join cabinets together using display's connecting system. Close latch, then run cables one at a time starting from left to right.

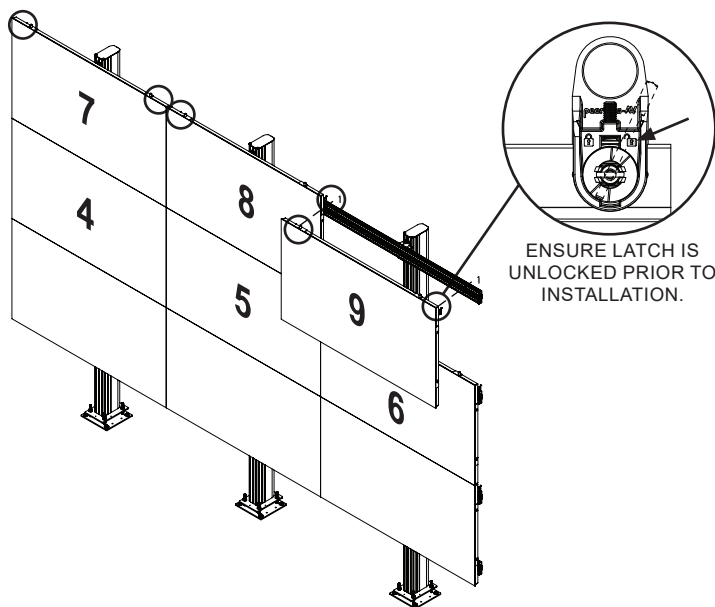

18

To remove, start from the top right.

Open latch assemblies, disconnect cables, separate cabinets and remove displays one at a time.

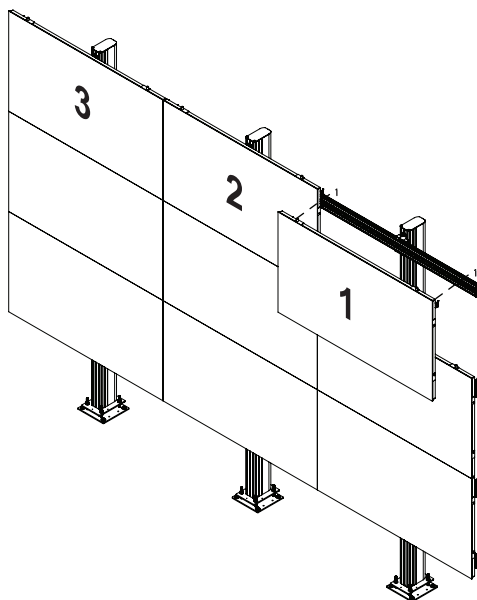

This page intentionally left blank.

This page intentionally left blank.

This page intentionally left blank.

ENG	Warranty	ESP	Garantía	FRN	Garantie	DEU	Garantie	NEL	Garantie
ITL	Garanzia	ČES	Záruka	SLK	Záruka	POR	Garantia	TÜR	Garanti

www.peerless-av.com/warranty • www.peerless-av.com • www.peerless-av.com/patents

peerless-AV®

Peerless-AV
2300 White Oak Circle
Aurora, IL 60502, USA
info@peerless-av.com

(800) 865-2112
(630) 375-5100

Peerless-AV EMEA
Unit 2, Curo Park
Frogmore, St. Albans,
Hertfordshire, AL2 2DD
United Kingdom

+44 (0) 1923 200 100

Peerless-AV B.V.
Papendorpseweg 75
3528 BJ Utrecht
The Netherlands

+31 (0) 70 770 8037

Peerless-AV Latin America
Av. de las Industrias 413
Parque Industrial Escobedo
General Escobedo N.L.,
México 66062

+52 (81) 8384-8300