

**Assembly Instructions**  
**MODEL NO.: N137**  
**R/T Conference table**

<b>A</b> TUN0102L 	<b>B</b> TUN0102L 	<b>C</b> Cam Cover (structural)	<b>D</b> TUN029 	<b>E</b> TUN021AG 	<b>F</b> TUN0118 	<b>G</b> TUN0103C 	<b>H</b> TUN0118 	<b>I</b> 4-6X12 
--------------------------	--------------------------	------------------------------------	------------------------	--------------------------	-------------------------	--------------------------	-------------------------	------------------------

**STEP1**

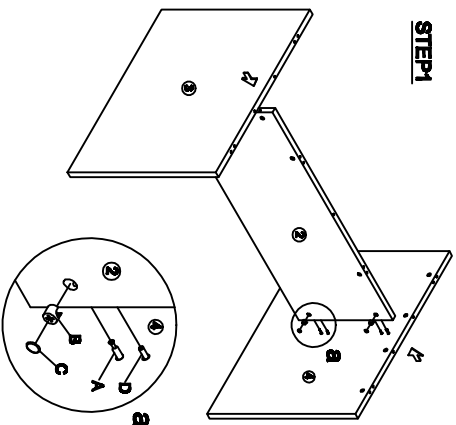

**IMPORTANT:**  
FUNCTION OF KIX CAM  
1/4 RIGHT  
TURN FOR  
LOCKING  
MAKE SURE THE ARROW IS  
POINTING UPWARDS BEFORE  
INSERTING INTO THE PANEL'S  
HOLE

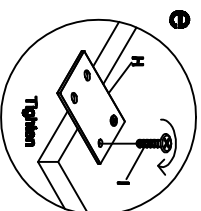
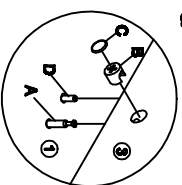
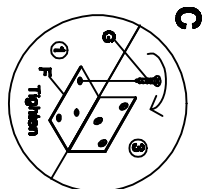
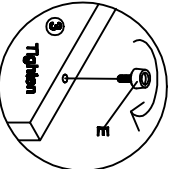

**STEP2**

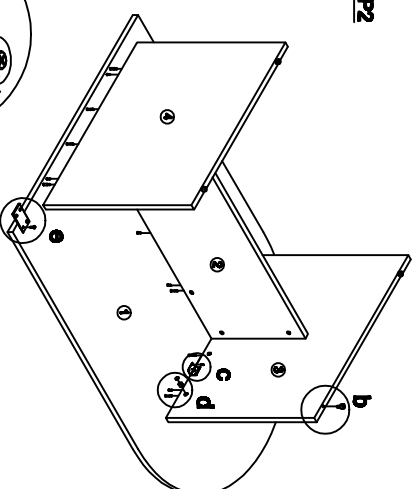

**STEP3**

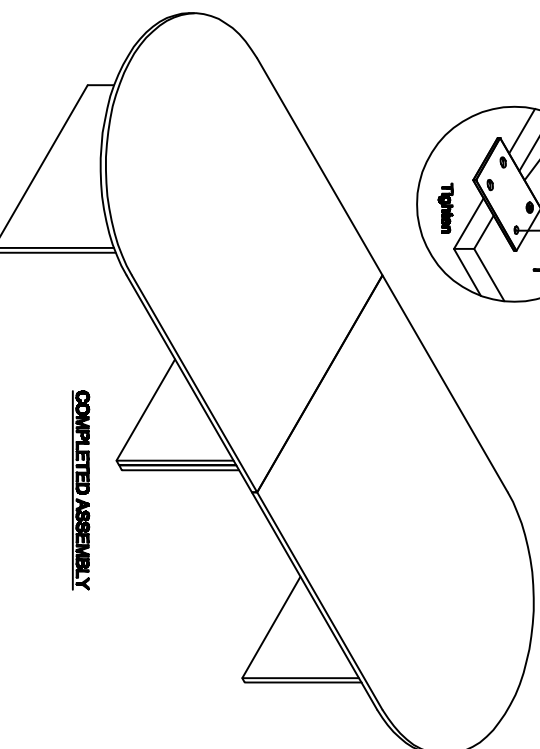
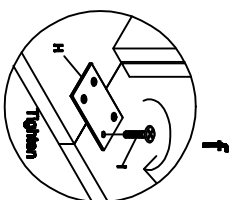
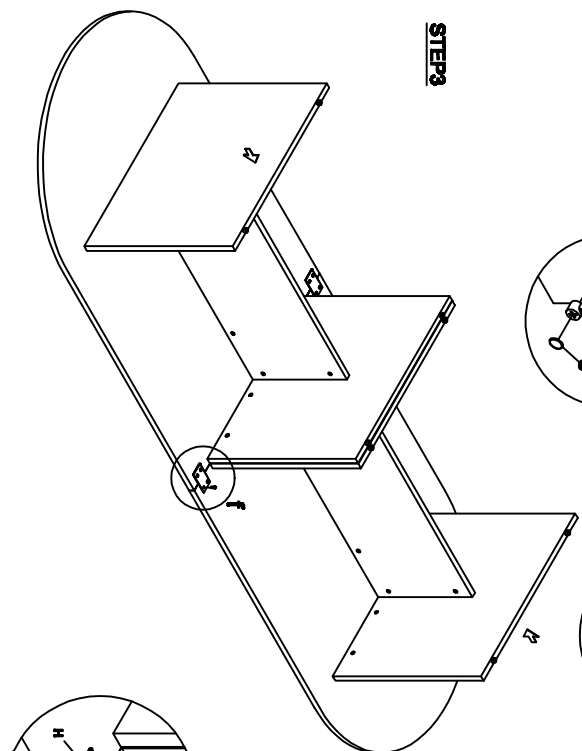

**COMPLETED ASSEMBLY**

**IMPORTANT NOTE:**

- Place all laminated parts on a clean and smooth surface such as a rug or carpet to avoid the parts from being scratched.
- Check to be sure that you have all parts and hardware.
- Remove all wrapping materials, including staples & packing straps before you start to assemble.
- Don't tighten all screws/bolts until all completely assembled.
- Keep all hardware parts out of reach of children

