

High Capacity Feeder Feed Roller Kit • Kit de rouleaux d'entraînement du magasin grande capacité •
Kit rulli di alimentazione dell'alimentatore ad alta capacità • Großraumbehälter-Rollensatz •
Kit de rodillos de alimentación del alimentador de alta capacidad •
Kit del rodet d'alimentació de l'alimentador d'alta capacitat • Kit de rolo de alimentação do alimentador de alta capacidade •
Invoerrolkit grote papierlade • Matarrullats till stormagasin • Materullpakke til stormagasin •
Sæt med fremføringsruller til stor fremfører • Ison paperialustan syöttörollat •
Комплект роликов подачи для податчика большой емкости • Sada nabíracích válečků pro velkokapacitní podavač •
Zestaw rolek podajnika o dużej pojemności • Adagológörgő-készlet a nagy kapacitású adagolóhoz •
Kit de rolă de alimentare pentru alimentator de mare capacitate • Yüksek Kapasiteli Besleyici Besleme Silindiri Kiti •
Κιτ κυλίνδρου τροφοδοσίας για Τροφοδότη μεγάλης χωρητικότητας

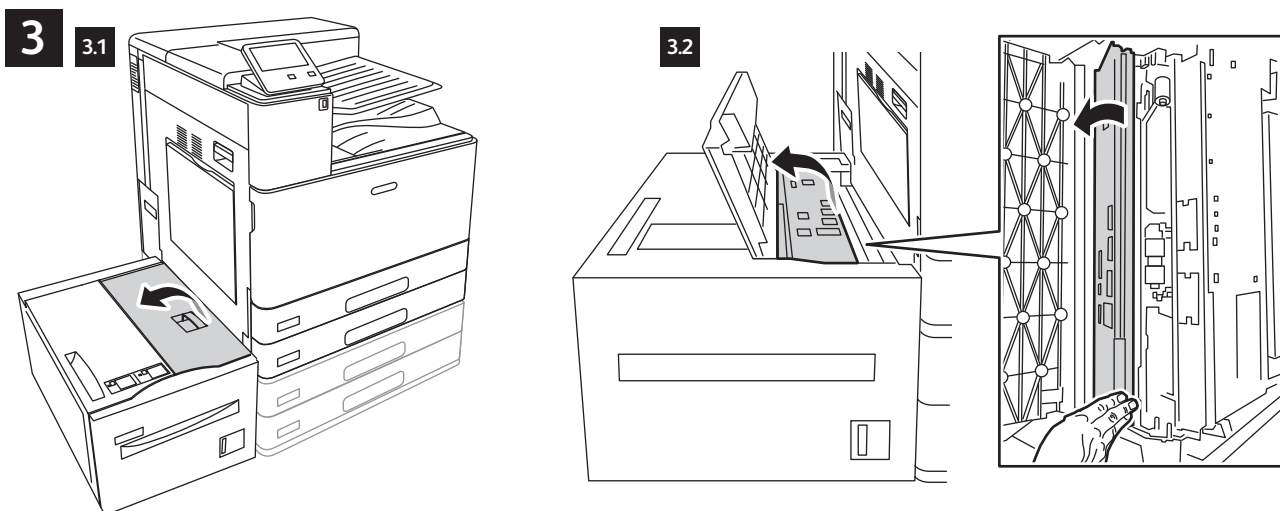

4

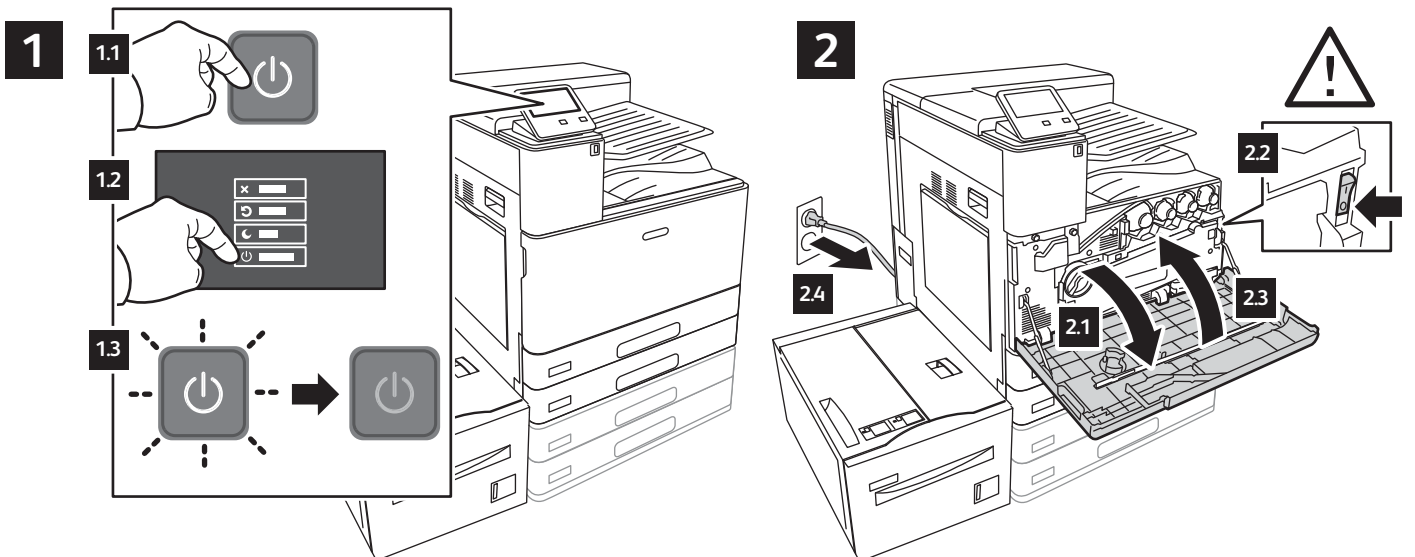
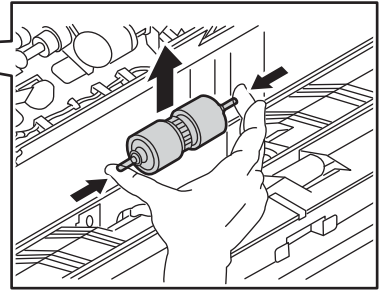
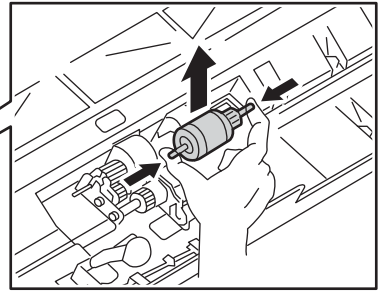
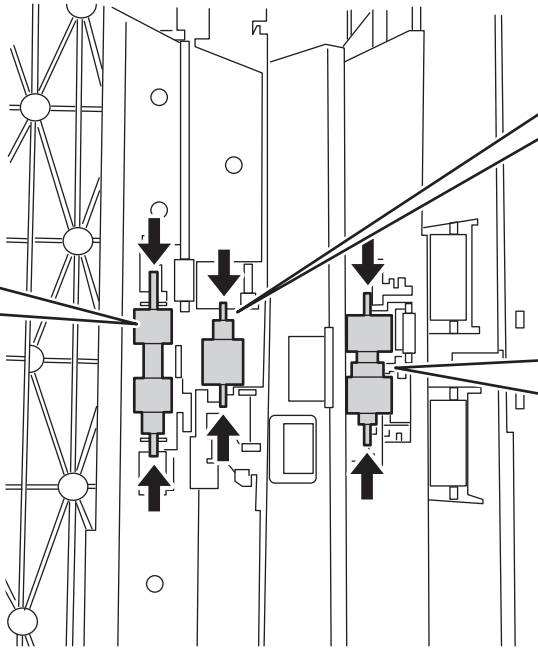
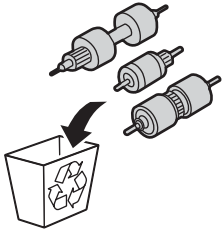
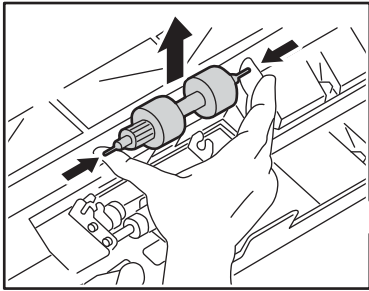

5

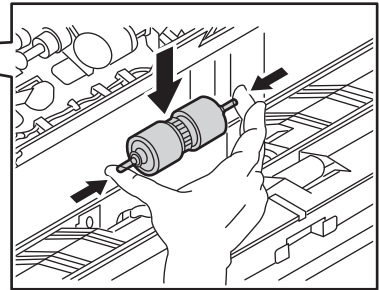
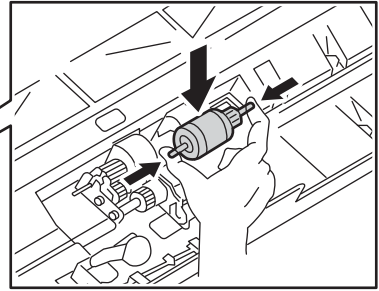
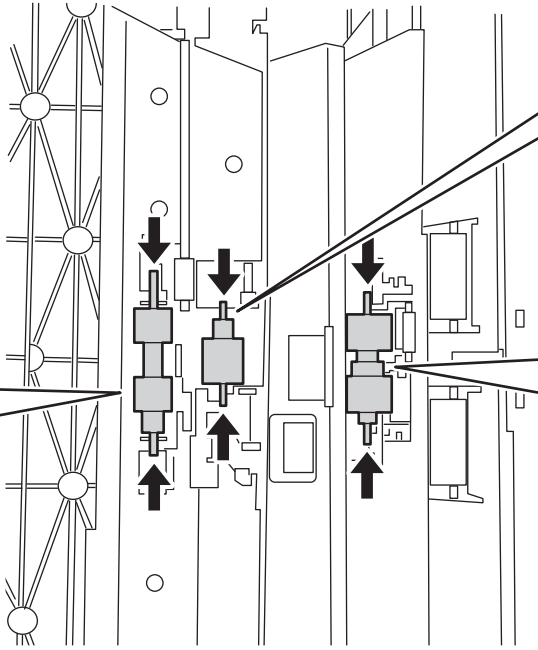
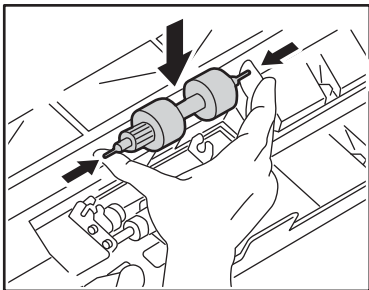
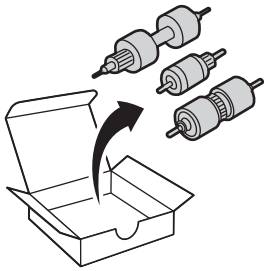

6

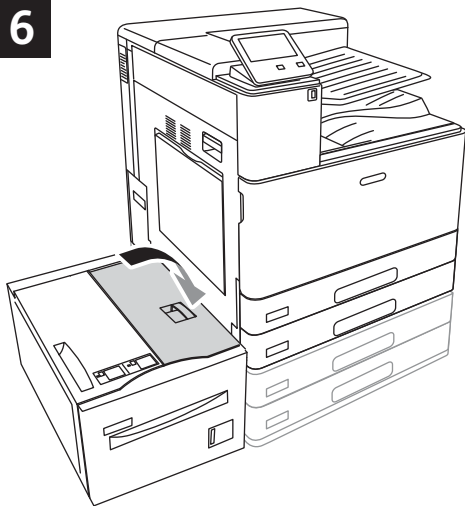

7

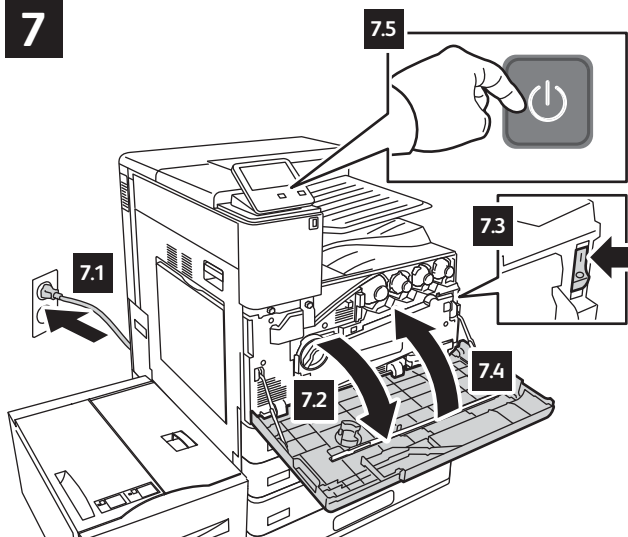

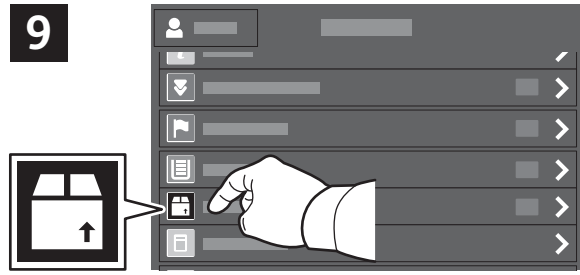
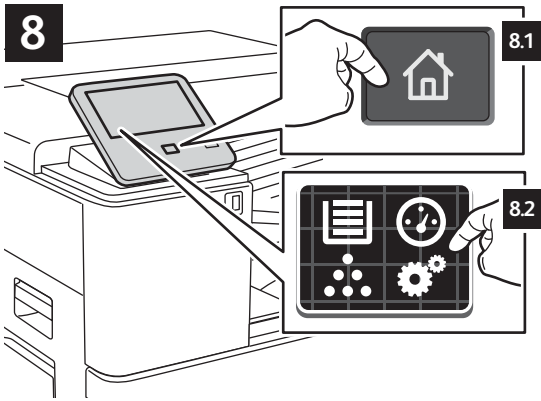

10

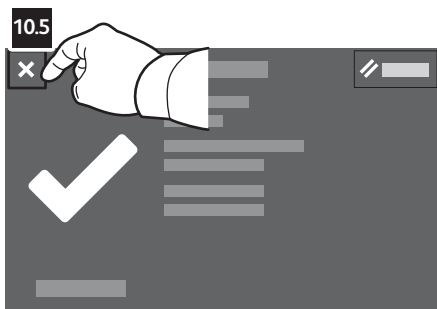
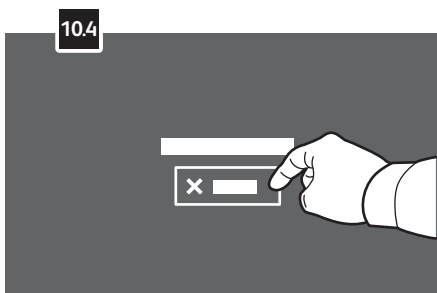
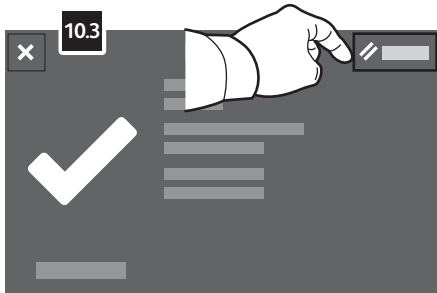
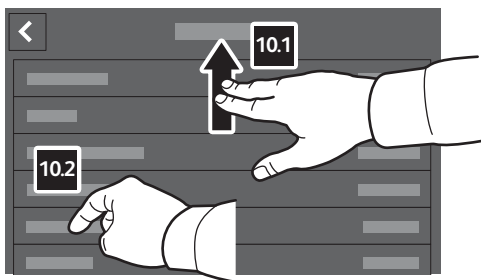

EN To reset the counter, touch **Tray 6 Feed Roller**.

FR Pour réinitialiser le compteur, touchez **Tête de départ du magasin 6**.

IT Per ripristinare il contatore, toccare **Rullo alim. vassoio 6**.

DE Zum Zurücksetzen des Zählers die **Zufuhrrolle in Behälter 6** berühren.

ES Para reiniciar el contador, pulse **Rodillo de alimentación de la bandeja 6**.

CA Per reinicialitzar el comptador, toqueu **Rodet d'alimentació de la safata 6**.

PT Para reiniciar el contador, pulse **Rodillo de alimentação de la bandeja 6**.

NL Om de teller op nul te zetten, selecteert u **Invoerrol lade 6**.

SV Tryck på **Matarrullar i magasin 6** för att återställa räkneverket.

NO Trykk på **materullen for magasin 6** for å tilbakestille telleren.

DA Hvis du vil nulstille tælleren, skal du trykke på **fremføringsrullen i magasin 6**.

FI Nollaa laskin koskettamalla kohtaa **alustan 6 syöttörulla**.

RU Для сброса счетчика нажмите **Ролик подачи лотка 6**.

CS Chcete-li vynulovat počítadlo, stiskněte položku **Podávací válec zásobníku 6**.

PL Aby zresetować licznik, dotknij pozycji **Rolka podawania tacy 6**.

HU A számláló alaphelyzetbe állításához érintse meg az **6. tálcá adagológörgőjét**.

RO Pentru a reseta contorul, atingeți **Rolă de alimentare Tava 6**.

TR Sayacı sıfırlamak için **Kaset 6 Besleyici Silindiri'**ne dokununuz.

EL Για επαναφορά του μετρητή, επιλέξτε **Κύλινδρος τροφοδοσίας Δίσκου 6**.