

Lenovo  
**ThinkPad**

ThinkPad P14s Gen 5 / ThinkPad P16s Gen 3

**Lenovo**

# Get started



\* Lenovo USB-C to  
VGA Adapter



\* Lenovo USB-C to  
DisplayPort Adapter



\* Lenovo HDMI to  
VGA Adapter



\* Lenovo USB-C to  
Ethernet Adapter

\* For selected models

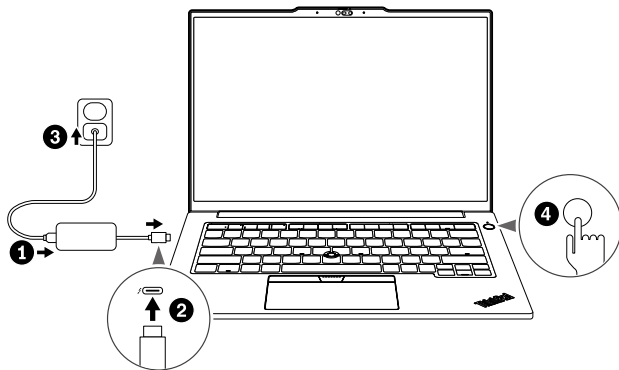

# Overview

## ThinkPad P14s Gen 5

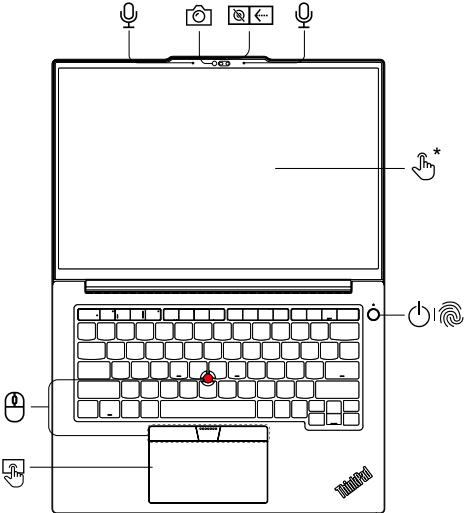

 Press to log in to the computer

 Navigate as a traditional mouse

# Overview

 Press to log in to the computer

 Navigate as a traditional mouse

## ThinkPad P16s Gen 3

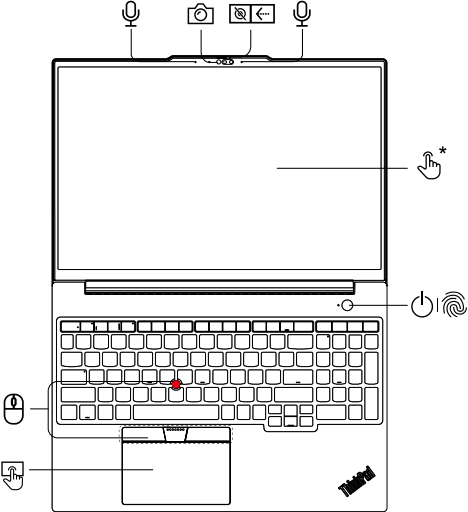

# Overview

## ThinkPad P14s Gen 5

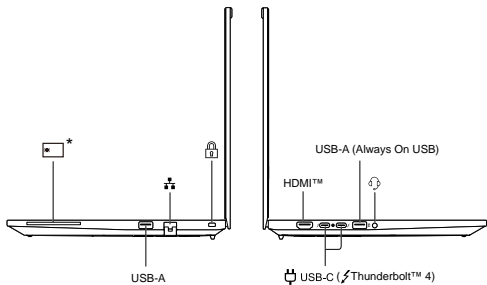

## ThinkPad P16s Gen 3

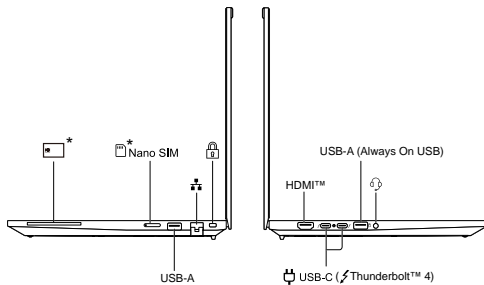

Read the statement on USB transfer rate in the *User Guide*. To access the *User Guide*, refer to methods mentioned on the back cover.

## TrackPoint Quick Menu

Launch TrackPoint Quick Menu by double tapping<sup>1</sup> for quick configuration of some device settings.

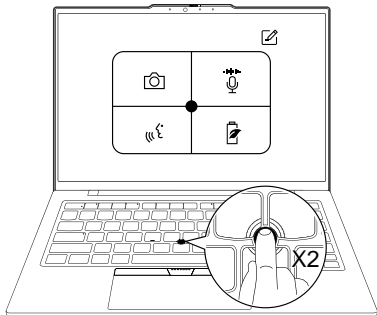

<sup>1</sup> It can be set to single tapping.

## Lenovo Commercial Vantage\*

Access Commercial Vantage to adjust device settings and check for system updates.

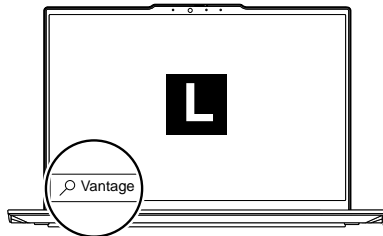

## Lock on leave<sup>2</sup>



Protect your privacy and improve battery life.

<sup>2</sup> For infrared camera models only

# Lenovo View\*



Video Enhancer

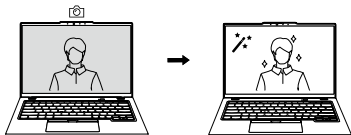

Background Removal

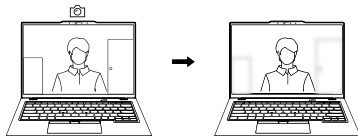

Privacy Guard

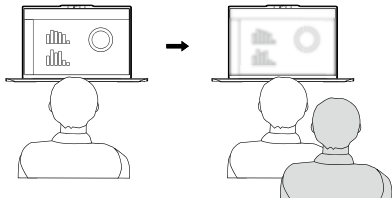

Posture Warning

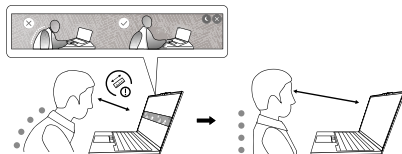

[English]

## Specific absorption rate (SAR)

YOUR DEVICE MEETS INTERNATIONAL GUIDELINES FOR EXPOSURE TO RADIO WAVES.

Refer to the following for 10g SAR limit and maximum reported SAR values:

10g SAR limit: 2 W/kg (body-worn SAR); 4 W/kg (limb SAR)

Maximum SAR with 0 mm separation distance:

Product name	Body-worn SAR value	Limb SAR value
ThinkPad P14s Gen 5	0.427 W/kg	0.427 W/kg
ThinkPad P16s Gen 3	1.401 W/kg	1.401 W/kg

For more information about SAR, refer to the *Safety and Warranty Guide* that came with your device.

## European Union (EU) / United Kingdom (UK) — radio frequency and power

This radio equipment operates with the following frequency bands and maximum radio-frequency power:

Technology	Frequency [MHz] / band	Maximum transmit power
WLAN 802.11b/g/n/ax Bluetooth BR/EDR/LE	2400 - 2483.5	< 20 dBm
WLAN 802.11a/n/ac/ax	5150 - 5350; 5470 - 5725	< 23 dBm
WLAN 802.11a/n/ac/ax	5725 - 5875	< 13.98 dBm
WLAN 802.11ax	5945 - 6425	< 23 dBm
WWAN UMTS	1/3/8	< 25.2 dBm
WWAN LTE	1/3/7/8/20/28/38/40/41/42/43	< 25 dBm
WWAN LTE HPUE	41	< 26.5 dBm

Note: Not all wireless bands may be enabled depending on your product configuration. Usage of this device is limited to indoor locations in the bands 5150 - 5350 MHz and 5945 - 6425 MHz.

## Access User Guide

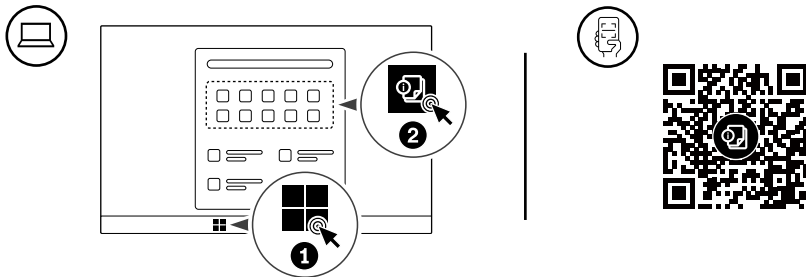

First Edition (May 2024)

© Copyright Lenovo 2024.

**LIMITED AND RESTRICTED RIGHTS NOTICE:** If data or software is delivered pursuant to a General Services Administration "GSA" contract, use, reproduction, or disclosure is subject to restrictions set forth in Contract No. GS-35F-05925.

Lenovo, Lenovo logo, ThinkPad, and ThinkPad logo are trademarks of Lenovo. Intel and Thunderbolt are trademarks of Intel Corporation or its subsidiaries in the U.S. and/or other countries. The terms HDMI and HDMI High-Definition Multimedia Interface are trademarks or registered trademarks of HDMI Licensing LLC in the United States and other countries. USB-C® is a registered trademark of USB Implementers Forum. All other trademarks are the property of their respective owners.



Reduce  
Reuse  
Recycle

For FSC Mix logo only