

<b>Color Side 1:</b> Black	<b>Flat size:</b> 17.481 x 12.402 in (444.0174 mm x 315.0108 mm)	<b>Fold 1:</b> 3-panel accortion	<b>Fold 2:</b> 3-panel accortion
<b>Color Side 2:</b> Black	<b>Folded size:</b> 5.827 x 4.134 in (148.0058 mm x 105.0036 mm)		



**Kit contents**

Kit contents might vary depending on your computer model.

- Controller
- Cables
- Main board adapter
- Installation instructions (this document)
- Warranty information

**Before you begin**

To view QuickSpecs and determine the compatibility of this product with your HP computer, see <http://www.hp.com/go/productbulletin>.

**Tools required**

You need a #1 Phillips screwdriver to install the module and secure it to the system board.

**Preparing for installation**

- 1** If you need help preparing the computer for this installation, consult the removal and replacement procedures at <http://www.hp.com/go/hardwarevideos>.
- 2** Turn off the computer, and then disconnect the power cord.
- 3** Turn off all external devices, and then disconnect them from the computer.
- 4** Remove the access panel.

**Installing the main board adapter in the HP Z2 Mini G9 computer**

- 1** Remove any components that block your access to where the main board adapter will connect to the system board. If there are no components blocking your access, go to the next step.
  - Remove the screw securing the riser cage **1** and then remove the riser cage from the computer **2**.

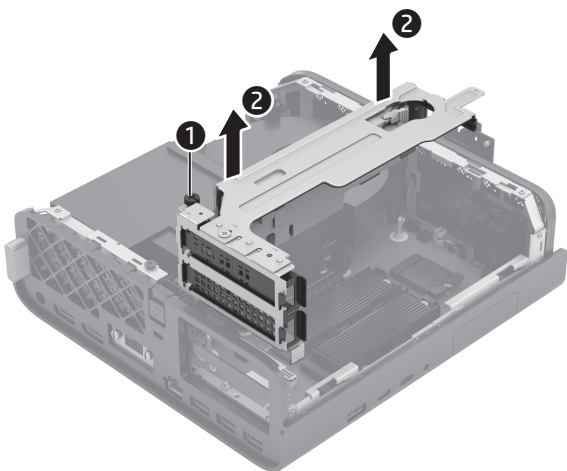

- If you see a fan, remove the two screws that secure it to the chassis **1**, disconnect the cable from the system board **2**, and then remove it from the computer **3**.

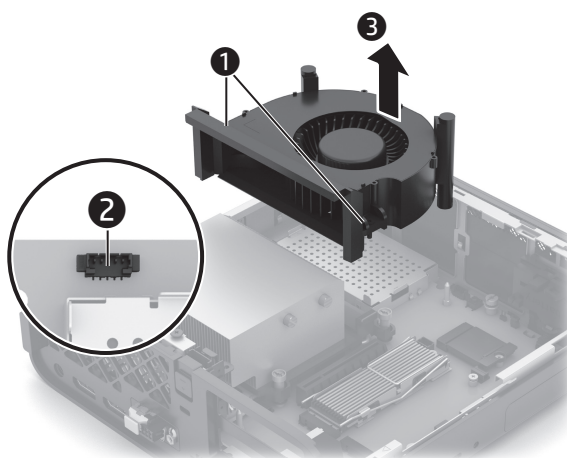

- Remove the four T15 screws in the order shown on the label of the heat sink **1**, and then lift the heat sink out of the chassis **2**.

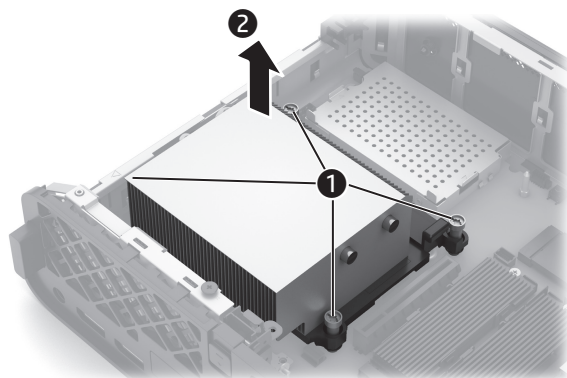

**Installing the main board adapter in the HP Z2 Mini G9 computer**  
*continued*

- 2** Press the tab **1** to release the plastic cover from the I/O port **2**.

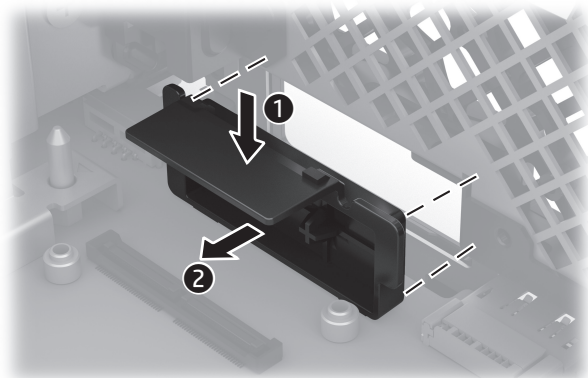

- 3** Slide the main board adapter into place **1**, press down on the connector until it snaps into place **2**, and then secure it to the system board **3**.

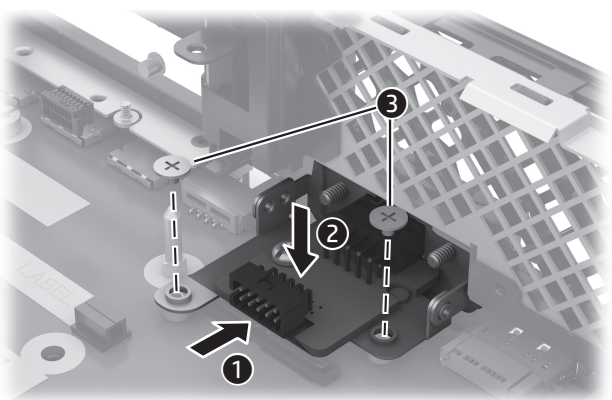

- 4** Remove the paper from bottom of the rubber cable guides and affix them to the system board in the four locations shown.

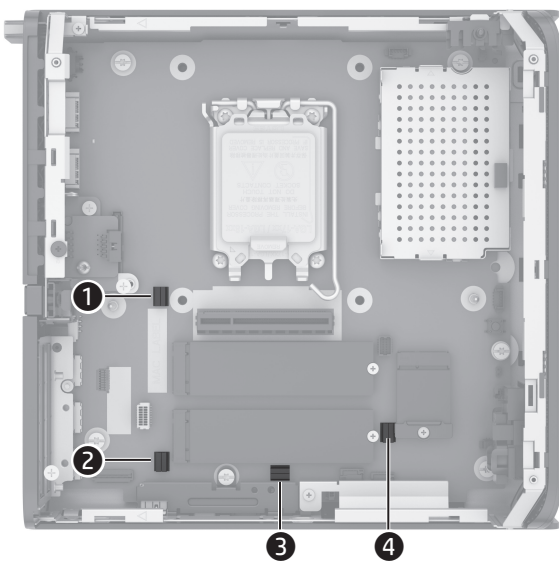

<b>Color Side 1:</b> Black	<b>Flat size:</b> 17.481 x 12.402 in (444.0174 mm x 315.0108 mm)	<b>Fold 1:</b> 3-panel accortion	<b>Fold 2:</b> 3-panel accortion
<b>Color Side 2:</b> Black	<b>Folded size:</b> 5.827 x 4.134 in (148.0058 mm x 105.0036 mm)		

Installing the  
main board  
adapter in the  
HP Z2 Mini G9  
computer  
*continued*

- 5 Connect the cable to the module 1, and the system board 3, and then route it through the rubber cable guides 2.

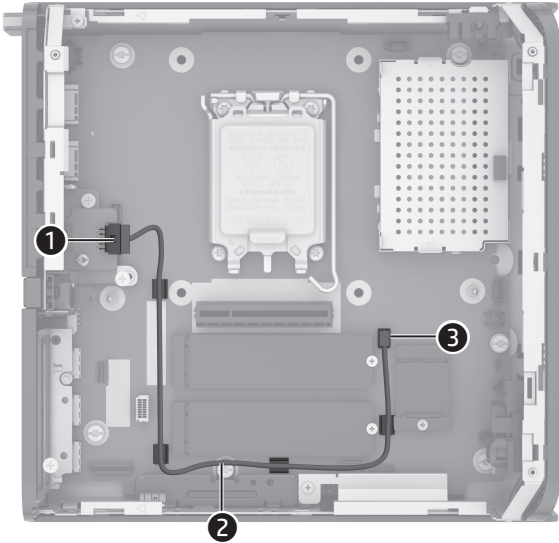

- 6 Replace all of the components that were removed.
- Replace the heat sink 1 and secure the screws 2.

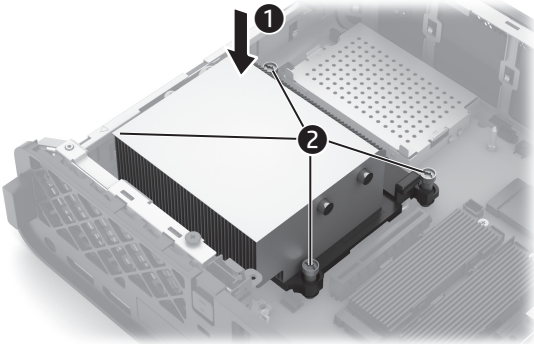

- Connect the fan cable to the system board 1, lower the fan onto the system board 2, and secure it with the two screws 3.

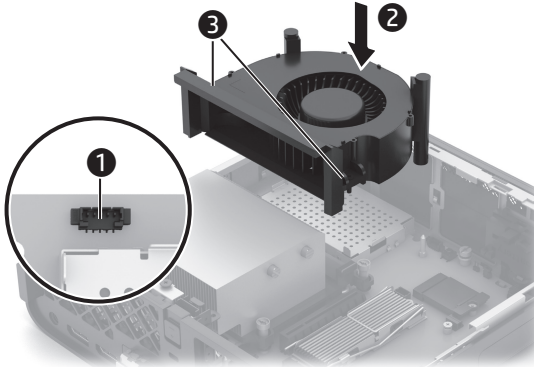

Installing the  
main board  
adapter in the  
HP Z2 Mini G9  
computer  
*continued*

- Slide the riser cage into the computer 1, and then fasten the screw 2.

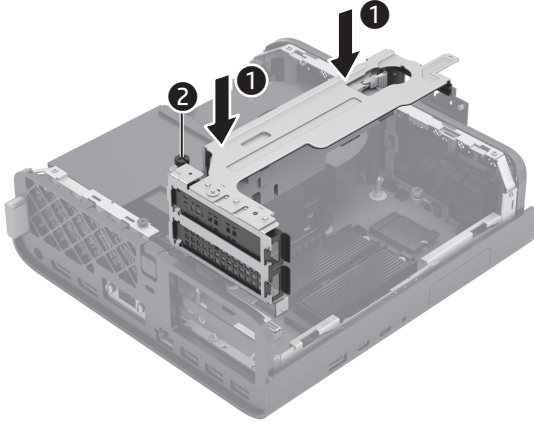

- 7 Connect the following cables:
- 10-pin cable
  - DisplayPort™ cable
  - USB cable
  - RJ-45 (network) cable
  - RJ-45 network uplink cable

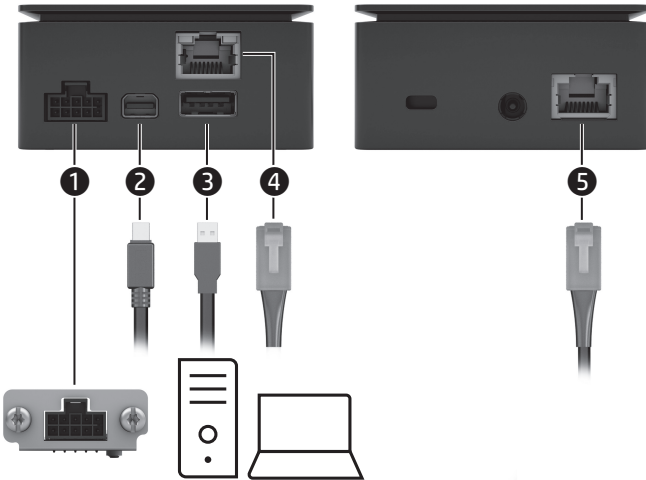

After the  
installation

- 1 Reinstall the access panel.
- 2 Reconnect the external devices and the power cord to the computer, and then restore power.

By using Redfish API commands to control the HP Anyware Remote System Controller, you accept the terms of the HP End User License Agreement (EULA), which is available to you upon logging in to the Remote System Controller web browser user interface or is otherwise available on the web at <https://www.hp.com/go/sweula>.

 <https://www.hp.com/support>



For regulatory, certification, and environmental information, including Restriction of Hazardous Substances (RoHS), scan the QR code, or go to [www.hp.com/go/regulatory](https://www.hp.com/go/regulatory).



N55843-001

PRINTER: Replace this box with Printed-In (PI) Statement(s) as per spec.  
NOTE: This box is simply a placeholder. PI Statement(s) do not have to fit inside the box but should be placed in this area.

RMN/型號/型号: FCLSA-2206, QMB-2201, PA-1041-81

© Copyright 2023 HP Development Company, L.P.

DisplayPort™ and the DisplayPort™ logo are trademarks owned by the Video Electronics Standards Association (VESA®) in the United States and other countries.

The information contained herein is subject to change without notice. The only warranties for HP products and services are set forth in the express warranty statements accompanying such products and services. Nothing herein should be construed as constituting an additional warranty. HP shall not be liable for technical or editorial errors or omissions contained herein.

First Edition: April 2023