



NetShelter™ SX Advanced Enclosures

Get ready for AI workloads with even higher density racks

Taller, deeper, stronger racks designed for AI workloads and ready for rack, stack, and ship. NetShelter SX Advanced offers:

- **Uncompromised shipping protection** designed to safely load, transport, unload, and deploy a rack with IT equipment pre-installed
- **Maximized space** to build high-density AI infrastructure, accommodating large-depth servers and seamless integration of liquid cooling components
- **Higher weight loading capacity** to fit more equipment in each rack for a smaller IT footprint, reducing data center costs

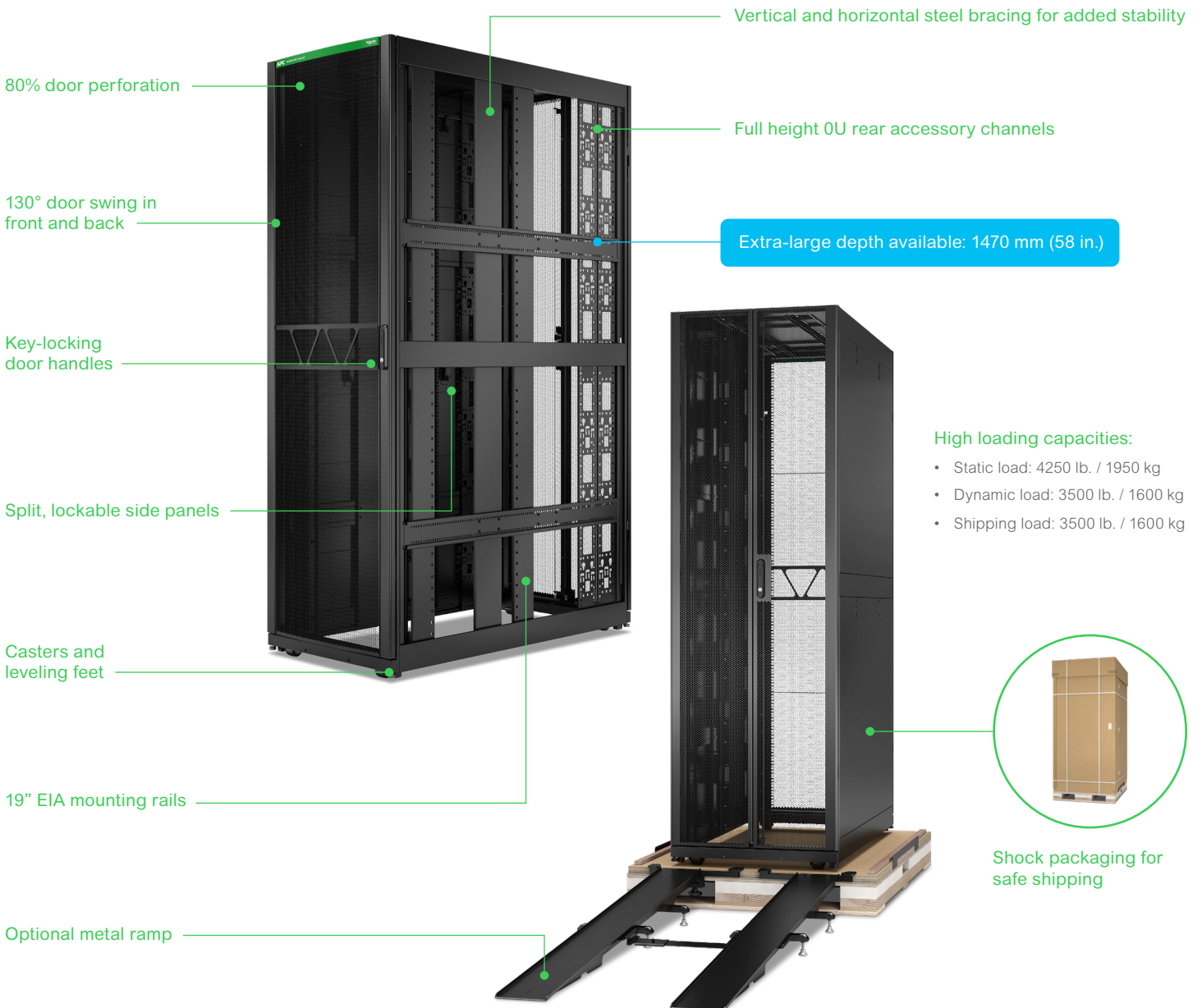

Life Is On

Schneider
Electric

Hassle-free onsite deployment:

Safely load, transport, unload, and deploy a rack with up to 3500 lbs. (1600 kg) of IT equipment installed.

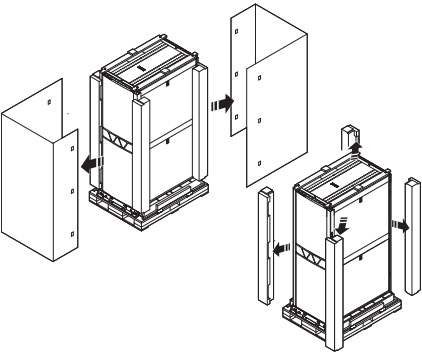

Remove outer wrap layers

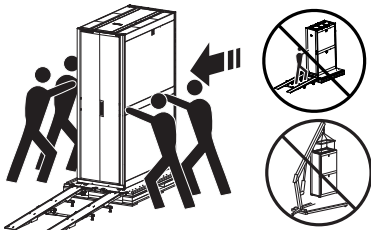

Install and test IT equipment

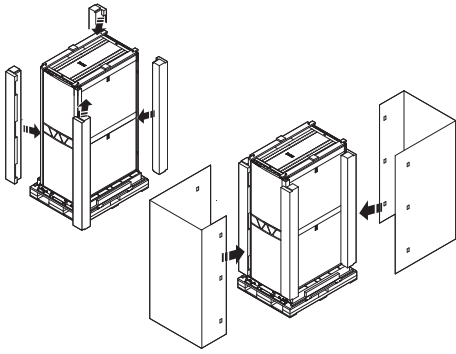

Reapply protective packaging

NetShelter SX Advanced technical specifications

	NetShelter SX Advanced	
Static load	4250 lb. / 1950 kg	NEW
Dynamic load	3500 lb. / 1600 kg	NEW
Shipping load	3500 lb. / 1600 kg	NEW
Shock packaging	✓	NEW
Equipment mounting rails	19" EIA, adjust in .5 in. (12.7 mm) increments	
Door perforation	80%	
Front door swing	130°, reversible, curved front	
Rear door swing	130°, flat front	
Side panels	Split, lockable	
Baying kit	Included	
Roof	4 extra large cable entry points	
Bottom plate	Optional	
Locking	3-point locking	
Casters & leveling feet	Included	
Rear accessory	Full-height 0U accessory channels*	
Door handles**	Key locking**	
Toolless features	Doors, roof, roof cable trough (optional)	
Certifications	UL, ISTA, RoHS, REACH	
Warranty	5 years	



Top view:
4 extra-large cable entry points.



*See SKUs for exact model specification. **Options for combination lock, keycard access, and unique key cylinders available.

		Model (Black)	Available in*		Rack Units	Dimensions (mm)			Max Equipment Depth (mm)	Static (lb.)	Dynamic (lb.)	Shipping (lb.)	0U Accessory Channels	Doors & Sides
						H	W	D						
NetShelter SX Advanced	High Strength & Shock Packaged	AR9557SPB2	WW		48	2258	750	1295	1143	4250	3500	3500	4	✔
		AR9587SPB2	WW		48	2258	800	1295	1143	4250	3500	3500	4	✔
		AR9657SPB2	WW		48	2258	750	1470	1318	4250	3500	3500	4	✔
		AR9558SPB2	NAM	EUR	52	2436	750	1295	1143	4250	3500	3500	4	✔
		AR9588SPB2	NAM	EUR	52	2436	800	1295	1143	4250	3500	3500	4	✔
		AR9588SPB2	NAM	EUR	52	2436	800	1295	1143	4250	3500	3500	4	✔
		AR9000RAMPX886	WW		Metal ramp, reusable 30 times, order as accessory									

Regional availability key: **NAM** = North America; **EUR** = Europe; **WW** = Worldwide
*Commercial Reference (CR) availability is generalized and may not cover all countries. Please check our website to confirm specific CR availability in your country.

Learn more