

S8050 Quick Installation Guide

Document # D2582-100 / Revision 1.0



Read Me First

1. The motherboard User's Manual is available for download from our Web site at <http://www.tyan.com>. Make sure to read all precautions and instructions before you start installing the server board.
2. Refer all servicing to qualified personnel to avoid the risk of damage to the server board.
3. Exercise normal ESD (Electrostatic Discharge) procedures during system integration. TYAN/MITAC recommends wearing gloves and an anti-static wrist strap to avoid possible damage to the equipment.
4. Current processor socket design places the pins on the motherboard instead of the processor itself. Exercise extreme caution when installing the processors as the manufacturer's warranty does not cover damage inflicted upon the motherboard, including damage to the CPU sockets.

Package Contents



Required Tools

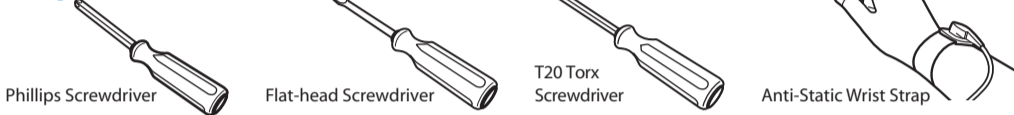

Motherboard Placement



CONNECTORS

- | | | |
|--|---|---|
| 1 IPMB Connector (IPMB1) | 18 CPLD JTAG Header (J12) | 35 MCIO x8 NVME (CN6) |
| 2 Front Fan Header (FAN_HD1) | 19 M.2 Connector (CN3) PCIe Only | 36 MCIO x8 NVME (CN5) |
| 3 COM2 Port Header (COM2) | 20 Mini SAS Connector (J26) | 37 PSMI Header (PSMI_HD1) |
| 4 TYAN Module Header (J62) | 21 Mini SAS Connector (J25) | 38 SVI Header (J17) |
| 5 TYPE A USB3.2 Gen1 Header (TYPEA_USB1) | 22 Power Connector (PW1) | 39 4-pin Fan Connector (CPU0_FAN) |
| 6 NMI Button (SW5) | 23 CPU and Memory Power Connector (PW2) | 40 4-pin Fan Connector (SYS_FAN_5) |
| 7 USB3.2 Gen1 Header (USB3_FPIO1) | 24 4-pin Fan Connector (SYS_FAN_4) | 41 VGA Header (VGA1) |
| 8 COLD_RST Button (SW2) | 25 4-pin Fan Connector (SYS_FAN_3) | 42 ID Button (ID_BTN) |
| 9 SGPIO0 Header (SGPIO0) | 26 4-pin Fan Connector (SYS_FAN_2) | 43 CPU and Memory Power Connector (PW3) |
| 10 PWR Button (SW1) | 27 M.2 Connector (CN1) PCIe only | 44 IPMI LAN USB3.0 Connector (LAN5) |
| 11 HDT Header (J1) | 28 MCIO x4 SATA/NVME (CN10) | 45 VGA and COM1 Port Header (VGA_COM1) |
| 12 WARM_RST Button (SW12) | 29 4-pin Fan Connector (SYS_FAN_1) | 46 RJ45 LAN Port (LAN3/LAN4) |
| 13 I210 LAN LED Header (J29) | 30 7p SATA Connector (J15) | 47 RJ45 LAN Port (LAN1) |
| 14 Front Panel Header (FPIO_2) | 31 7p SATA Connector (J16) | 48 RJ45 LAN Port (LAN2) |
| 15 HDD BP Smbus Header (HDR_2) | 32 7p SATA Connector (J18) | 49 BIOS Debug (BIOS_DBG1) |
| 16 HDD BP Smbus Header (HDR_1) | 33 7p SATA Connector (J19) | 50 SPI TPM Connector (J56) |
| 17 Intrusion Header (J66) | 34 MCIO x4 SATA/NVME (CN11) | |

LEDs

- i PROCHOT LED
- ii BMC Heartbeat LED
- iii CPU RESET LED
- iv SATA & M.2 LED
- v PWR_GOOD LED
- vi PWROK LED
- vii BMC ALERT LED
- viii SYS_PWROK LED
- ix PSU_ALERT LED

JUMPERS

- a COM2 Switch Jumper (J6)
- b COM2 Switch Jumper (J7)
- c RESET Switch Jumper (J33)
- d NCSI SWITCH (J4)
- e CMOS CLEAR (J75)
- f BMC Header (J2)
- g CPLD PowerOn Jumper (J3)
- h VRM SMBUS SEL Jumper (3PHD1)
- i COM1 Switch Jumper (J9)
- j COM1 Switch Jumper (J8)

SLOTS

- A PCIe#3 x16 (PESLOT3)
- B PCIe#5 x16 (PESLOT5)
- C PCIe#4 x16 (PESLOT4)
- D PCIe#2 x16 (PESLOT2)
- E PCIe#1 x16 (PESLOT1)

Jumper Cap On/Off

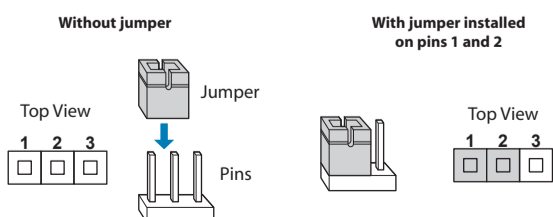

DOA/ RMA Reminder

NOTE: Please save and replace the PnP Cap when returning the server board for service.

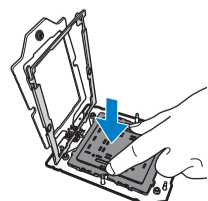

1 Install the Server Board

- 1 Insert the server board into the chassis.

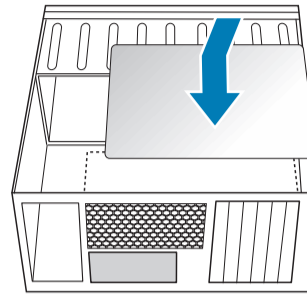

- 2 Attach the server board to the chassis by securing the screws on the designated locations.

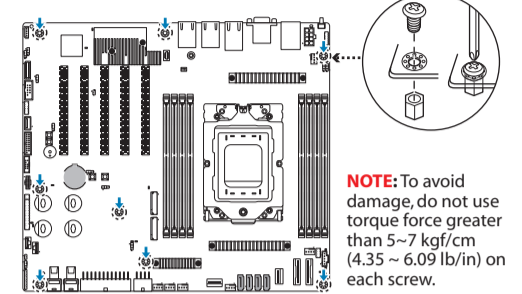

2 Install the Processor

- 1 Use a T20 Torx screwdriver to loosen the screw securing the force frame. **NOTE:** The force frame will automatically eject after the captive screws are being released.

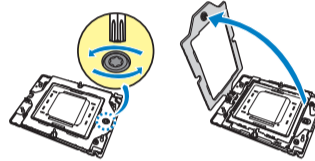

- 3 Remove the external cap from the rail frame.

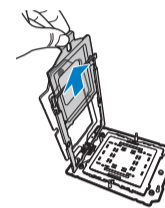

- 5 Using your thumb and forefinger, remove the PnP cap by lifting it up vertically.

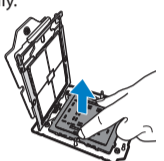

- 4 Align and install the carrier frame with package into the slot on the rail frame. **NOTE:** During installation, observe the following:
 - ⇒ make sure to push the carrier frame with package towards the end of the rail frame until it clicks into place.
 - ⇒ do not drop the carrier frame or touch the package pad to avoid component damage.

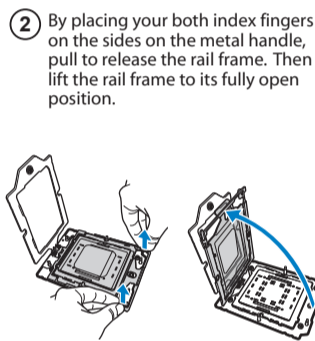

- 6 Carefully close the rail frame with the installed package. Then push both edges of the rail frame firmly until it locks in place.

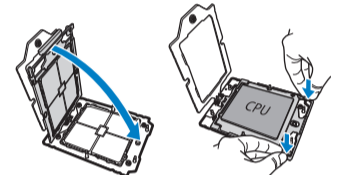

- 7 Close the force frame. Then use a T20 Torx screwdriver to tighten the screw to secure the force frame.

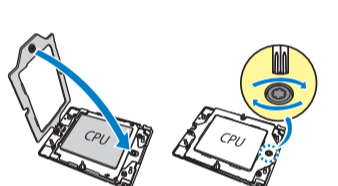

3 Install the CPU Heatsink

- 1 Align and install the CPU heatsink onto the top of the CPU socket.

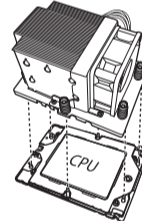

- 2 Use a T20 Torx screwdriver to tighten the heatsink screws.

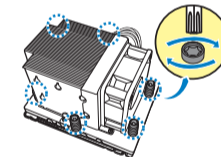

- 3 Connect the heatsink power cable to the mainboard connector.

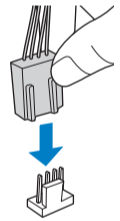

4 Install the Memory

- 1 Unlock the clips.

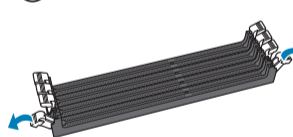

- 2 Insert the memory module.

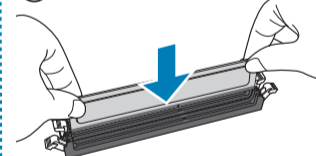

- 3 Lock the clips.

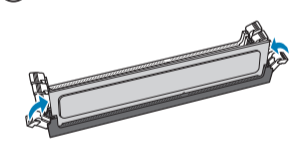

5 Install the Power Cable

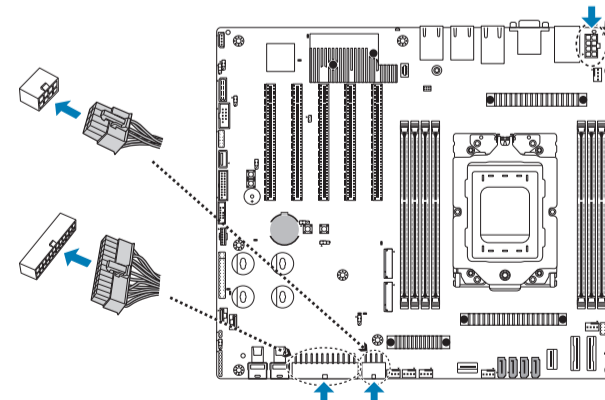

Locate the External I/O Ports

