

NetWay4E1WP

4-port PoE+ Hardened Switch



Altronix NetWay4E1WP Outdoor PoE+ Hardened Switch provides a 1Gb SFP port and four (4) PoE+ (30W) ports. Cameras/edge devices may be located up to 100m from the unit.



NetWay4E1WP

Key Features

- Four (4) 10/100/1000 Mbps PoE/PoE+ (up to 30W) ports
- IEEE 802.3af (15W) and IEEE 802.3at (30W) compliant
- 120W total power
- One (1) Gigabit SFP port
- NEMA4/4X, IP66 Rated enclosure for outdoor use
- Built-in charger for sealed lead acid or gel type batteries
- Automatic switch over to stand-by battery when AC fails
- PoE activity LED indicators
- CE European Conformity
- Lifetime Warranty

Similar products

NetWay4E1WPX	Outdoor 4-port PoE+ Hardened Switch in NEMA 4/4X, IP66-11 enclosure which accommodates stand-by batteries
NetWay4E1WPN	Outdoor 4-port PoE+ Hardened Switch only in NEMA 4/4X, IP66-11 enclosure
NetWay4E1PL	4-port PoE+ Hardened Switch with Integral Power on a Backplane
NetWay4E1X	Indoor 4-port PoE+ Hardened Switch in NEMA 1 Rated indoor enclosure
NetWay4E1B	4-port PoE+ Hardened Switch (board only)

Lifetime Warranty

Typical Applications

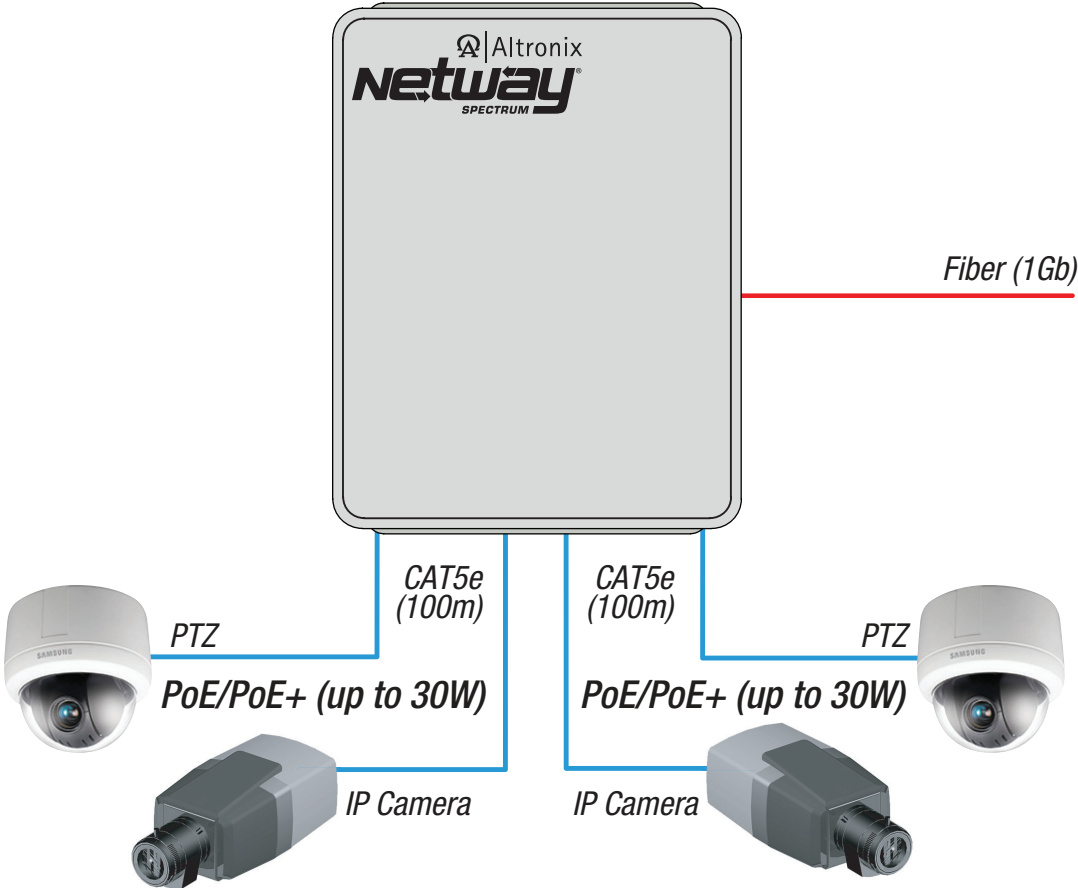

Lifetime Warranty

NetWay4E1WP

4-port PoE+ Hardened Switch



Specifications

Input

Voltage	115VAC, 60Hz, 2.5A or 230VAC, 50/60Hz, 1.3A
Fusing	5A/250V

Power Output

Maximum Power	Four (4) 10/100/1000 Mbps PoE/PoE+ (up to 30W) ports IEEE 802.3af (15W) and IEEE 802.3at (30W) compliant 120W total power Integral surge protection
Fiber Port:	One (1) Gigabit SFP port

Indicators (LED)

- Individual PoE On LEDs for each port
- Individual IP Link status, 10/100Base-T/active LEDs for each port
- ALOS LED indicates fiber connection for SFP port
- Heartbeat LED indicates proper operation of the unit

Back-up Battery (not included)

Type	Sealed lead acid or gel type
Failover	Upon AC loss, instantaneous

Agency Listings

CE	European Conformity
----	---------------------

Physical and Environmental

Enclosure Dimensions (H x W x D approx.):
13.31" x 11.31" x 5.59" (338.1mm x 287.3mm x 142mm)

NEMA 4/4X, IP66-11 Rated enclosure for outdoor use

Product Weight / Shipping (approx.)

Product Weight:	10.32 lb. (4.68 kg)
Shipping Weight:	11.7 lb. (5.3 kg)

Temperature

Operating:	60W: -40°C to 75°C (-40°F to 167°F)
	75W: -40°C to 70°C (-40°F to 158°F)
	100W: -40°C to 55°C (-40°F to 131°F)
	120W: -40°C to 45°C (-40°F to 113°F)

Storage: -40°C to 85°C (-40°F to 185°F)

Relative Humidity: 85% +/-5%

BTU/Hr. (approx.): 61 BTU/Hr.

Operating Altitude: -304.8 to 2,000m

Accessories (order separately)

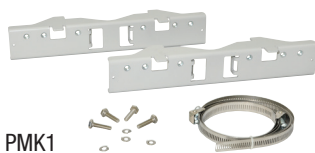

PMK1 - Pole Mount Kit

PMK1 pole mount kit is designed to simplify installation of outdoor units. It accommodates 2" - 8" (diameter) poles.



SFP Modules - Hot pluggable Transceivers

- P1MM** Multi-Mode SFP Module for distances up to 550m.
- P1SM10** Single-Mode SFP Module for distances up to 10km.
- P1AB2K** Single Strand SFP Module for distances up to 2km.
- P1GCE** Copper SFP Module for distances up to 100m.

Lifetime Warranty