



Smart access control and door entry systems

**Product Selection Guide**



## Why work with us?



### Easy to quote

- Build your system one door at a time
- A range of products to suit any site requirement
- Scalable system – add doors when the budget is available



### Easy to install

- Plug and play solutions that connect directly to the network
- Mix and match Net2 products – they are all designed to work together seamlessly
- Clear instructions and colour coded wiring labels



### Easy to work with

- Industry-leading technical support
- 5-year guarantee and three step returns policy
- Free software upgrades and no multiple licence fees



# The Paxton Installer App



## Paxton in Your Pocket – the Ultimate Installer Tool

The new Paxton Installer app gives you instant access to all the tools you need to install Paxton products. The free app, available for iOS and Android, provides quick and easy access to product specs and technical information, plus anything you could need on-site!



**Superfast access to  
product information**



**Get answers to  
your FAQs**



**Be the first to hear  
Paxton news**



**Find your  
distributors**



**Dial direct to Paxton  
Technical Support**



## 5 Networked Access Control

Our networked access control system, Net2, is administered using one or more PCs and can be monitored and managed from a central location. Our door controllers come as IP, wireless or battery powered.

- 6 Wired Controllers - Net2 Plus
- 8 Wireless Controllers - Net2 Nano
- 9 Wireless Controllers - Net2 PaxLock
- 10 Building Control - I/O Board
- 11 Net2 Readers
- 15 Net2 Tokens
- 17 Net2 Software
- 18 Accessories & Other Components
- 20 Demonstration Products

## 21 Access Control & Video Management

Our single platform solution combining access control and video management. Paxton10 is an ideal solution to futureproof site security.

- 22 Paxton10
- 23 Integration
- 24 Cameras
- 26 Readers & Tokens
- 27 Software & Apps

## 28 Video Intercom

Our video intercom system, Entry, is an advanced one cable intercom system with built-in access control capabilities.

- 29 Entry System Components
- 32 Demo Cases

## 34 Wireless Door Handles

PaxLock Pro is compatible with Net2 and Paxton10, or works in Standalone mode. PaxLock is a wireless, electronic battery powered door handle.

- 35 PaxLock Pro
- 37 PaxLock Pro Components

## 38 Standalone Access Control

Our standalone access control is a non-networked system made up of readers or simple door controllers located at each door. Standalone systems are administered via the use of tokens or card packs.

- 39 Switch2
- 40 Switch2 Readers
- 43 Compact
- 45 Standalone Tokens
- 46 Standalone Accessories

- 48 Additional Information

## Welcome

**This Product Selection Guide is designed to help you to choose the right products to build up an access control system.**

Paxton produce a variety of security solutions to suit different site requirements. Our one door philosophy means doors can be added as required or when budget becomes available.

## What's new?

### Paxton10 CORE & PRO Cameras

Our most powerful system, Paxton10 is now suitable for more installations than ever before with the introduction of the CORE and PRO Series cameras. Two new series of Paxton10 cameras to choose from, mix and match to tailor your own solution.



#### Great value CORE Series:

Mini Bullet, Mini Dome and Turret 4MP cameras with 64GB of in-built edge storage

#### High performance PRO Series:

Mini Bullet, Vari-focal Bullet and Turret 8MP, 4K cameras with a huge 256GB of edge storage

## See page 24

### PaxLock Catalogue Updates

Following recent updates to simplify our PaxLock Pro portfolio, you can now find all our PaxLock Pro products on **page 34** of this Product Selection Guide. Every PaxLock Pro is now compatible with both Net2 and Paxton10, as well as working in standalone mode.

Please note: Net2 PaxLock is still available - see page 9.

# Networked Access Control

**Our networked access control system, Net2, is administered using one or more PCs and can be monitored and managed from a central location. Our door controllers come as IP, wireless or battery powered.**

- ▶ Net2 is Paxton's flagship access control product
- ▶ A powerful networked system that addresses the needs of the mid-market
- ▶ Modular approach for simplicity and scalability
- ▶ Simple intuitive software
- ▶ Range of features that move beyond basic access control
- ▶ A complete solution that encompasses wireless and door entry

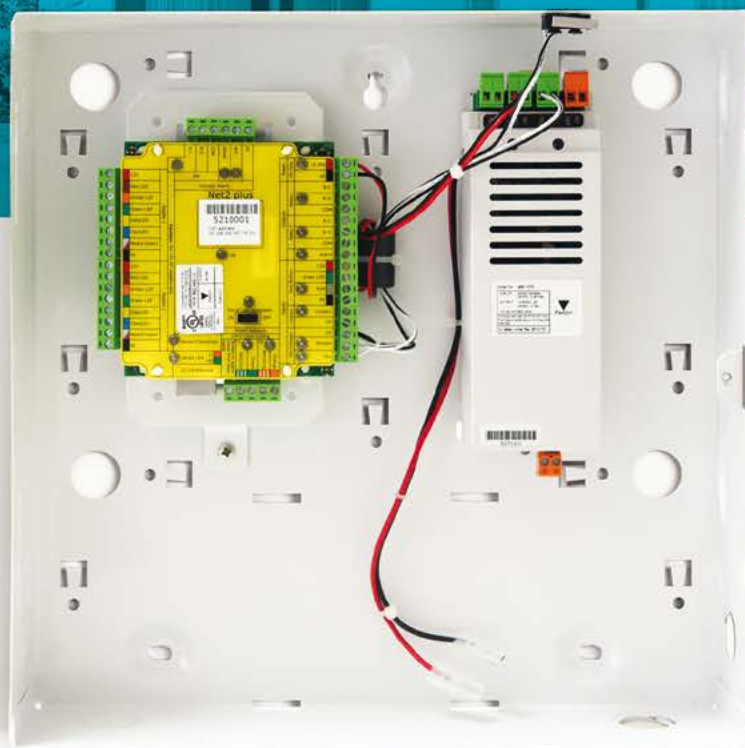

## Net2 plus Wired Controller

- ▶ A networked IP ready single door controller
- ▶ On-board TCP/IP connection allows direct connection to a network
- ▶ Can connect together with dedicated RS485 network

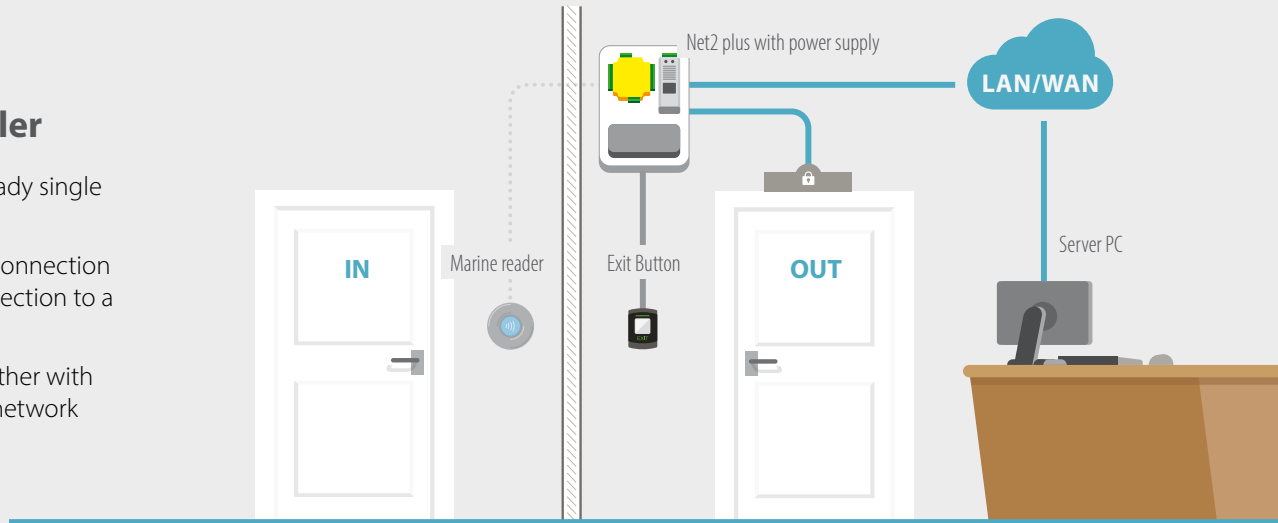

Net2 plus 1 door access control unit

**BEST SELLER**

Sales code  
682-493-US

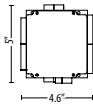

Net2 plus 1 door ACU in plastic housing

Sales code  
682-528-US

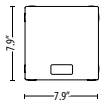

Net2 plus in US Metal Enclosure with  
12/24V PSU

**BEST SELLER**

Sales code  
682-610-US

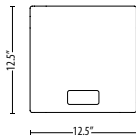

Net2 plus in US Metal Enclosure with  
PoE+ PSU

Sales code  
682-630-US

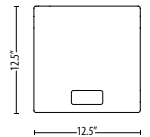

Net2 plus in US Metal Enclosure  
with 12V or 24V PSU with trigger  
disconnect

Sales code  
682-620-US

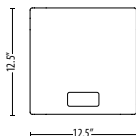

Net2 Plus is a suitable alternative to the Net2 Entry - Control Unit, when combined with any 802.3af or 802.3at (PoE+) compliant 3rd party PoE switch. We recommend the TP Link TL-SF1006P switch which has been thoroughly tested with the Entry system.



## Net2 IP starter kit for 2 doors - Low Voltage PSU

**Sales code**  
682-930-US

## Net2 Plus starter kit for 2 doors - PoE+ PSU

**Sales code**  
682-920-US

**Includes:**  
2 x Net2 plus controller, metal cabinet      10 x Keyfobs & 10 cards  
2 x P50M readers      1 x Net2 Pro software  
1 x Enrollment reader USB



## Net2 Plus Single Door Expansion Kit - Low Voltage PSU

**Sales code**  
682-960-US

## Net2 Plus Single Door Expansion Kit - PoE+ PSU

**Sales code**  
682-950-US

**Includes:**  
1 x Net2 plus controller, metal cabinet  
1 x Proximity reader - P50M

## Net2 nano Wireless Controller

- ▶ A wireless single door controller
- ▶ Communicates to the server using Net2Air technology via a Net2Air bridge
- ▶ No cable required between Net2 nano and the server PC, reducing installation time

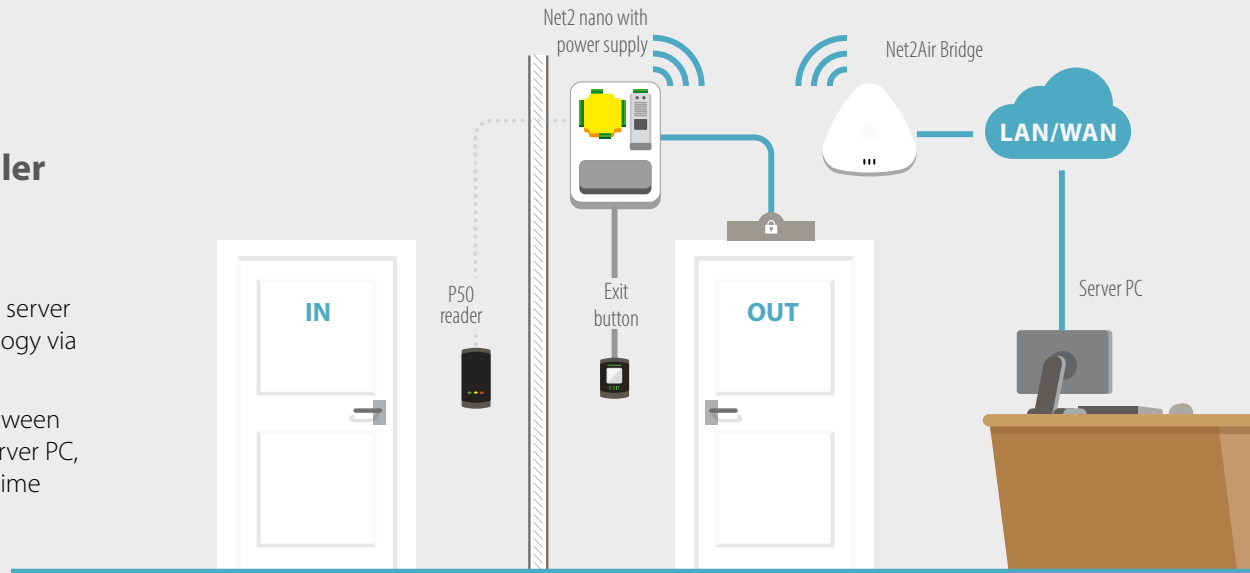

Net2 nano 1 door controller - 12/24V  
2A AC/DC PSU, Plastic cabinet

Sales code  
654-910-US

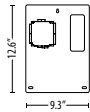

Net2Air Bridge

Sales code  
477-600-US

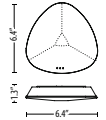

## Net2 PaxLock Wireless Controller

- ▶ Networked access control system in a wireless door handle
- ▶ Ready to install with a C Keyway core
- ▶ Integrates with Net2 access control
- ▶ Communicates using Net2Air technology

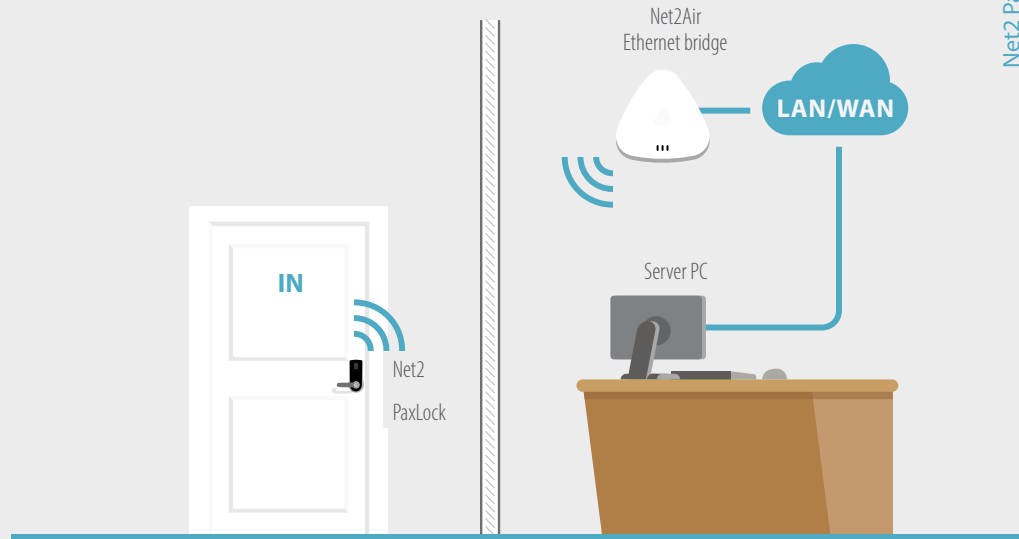

### Net2 PaxLock US C Keyway - Galaxy

Sales code  
921-130-US

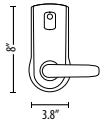

### Net2 PaxLock US C Keyway - Eclipse

Sales code  
921-131-US

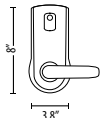

### Net2 PaxLock US – Door installation jig

Sales code  
921-200-US



Galaxy handle



Eclipse handle



C Keyway core



HID™ activation license required

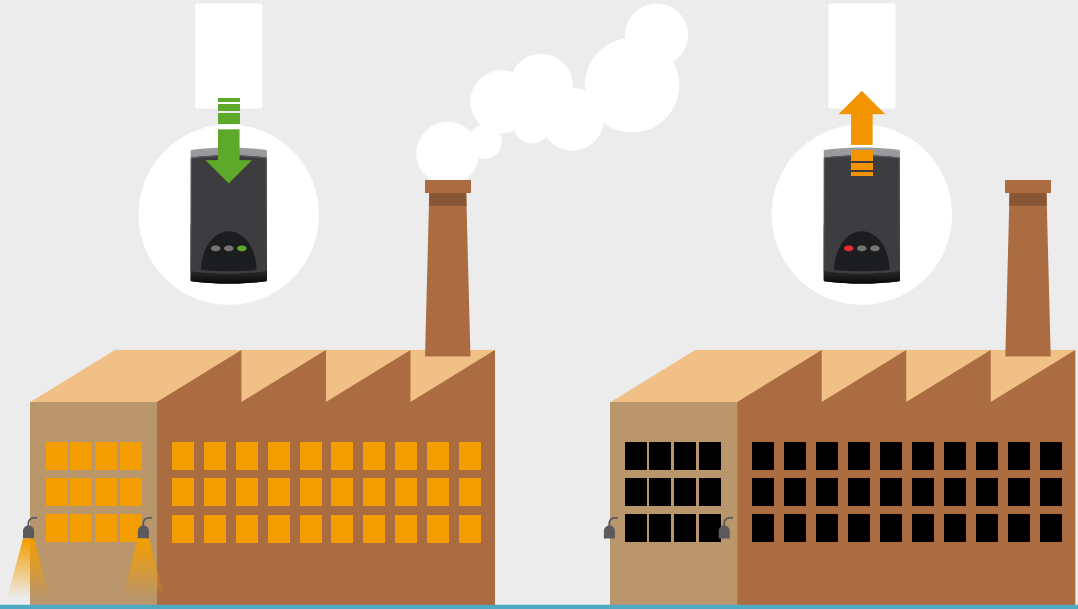

## Building Control - I/O Board

**When a valid fob is presented to the reader, the I/O board can be programmed to trigger the power to elevators, lighting, heating and electrical equipment.**

The Net2 I/O board is a simple, yet powerful addition to the Net2 system. It can be wired alongside a Net2 door controller, to switch power on and off to electrical equipment to save money and energy. The Net2 I/O board can control power to elevators, lighting, heating, water and air-conditioning by using the Triggers and Actions application in the Net2 software. These actions can be programmed for a particular time, or in response to a specific Net2 event.

- ▶ Connect directly to a LAN/WAN only
- ▶ Enable integration with elevators, lighting, heating and more
- ▶ 4 inputs and 4 outputs on the Net2 I/O board



Please note, Net2 I/O boards work as part of the Net2 system. They are not door controllers.



Net2 I/O board

Sales code  
489-710-US

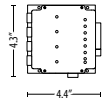

Net2 I/O board in plastic housing

Sales code  
385-710-US

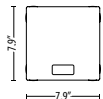

Net2 I/O board with 2A PSU in plastic cabinet

Sales code  
411-623-US

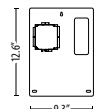

## Net2 Readers Pre-Activated with Genuine HID Technology™

The pre-activated Net2 series of readers with Genuine HID Technology™ come pre-enabled with HID™ 125kHz Proximity out of the box. HID™ license activation is not required. These readers can also include an optional HID™ Wiegand output with a separate purchase of a Wiegand activation card.



	<p><b>Net2 Proximity Readers with Genuine HID Technology™</b></p> <p><b>P38</b> Sales code 400-130-US</p>	<p><b>Mullion</b> Sales code 400-150-US</p>	<p><b>P75</b> Sales code 400-175-US</p>
	<p><b>Proximity Keypad KP50 with Genuine HID Technology™</b></p> <p>Sales code 400-250-US</p>		<p><b>Proximity Keypad KP75 with Genuine HID Technology™</b></p> <p>Sales code 400-275-US</p>
	<p><b>Proximity Marine Reader with Genuine HID Technology™</b></p> <p>Sales code 400-190-US</p>		<p><b>Proximity Architectural Reader Satin Chrome with Genuine HID Technology™</b></p> <p>Sales code 400-195SC-US</p> <p>Insert also required - see p.11</p>
	<p><b>Proximity Architectural Reader Gun Metal Grey with Genuine HID Technology™</b></p> <p>Sales code 400-195GG-US</p> <p>Insert also required - see p.11</p>		

## Net2 Readers

These readers are for use with Net2. Designed to fit in seamlessly in any environment, our wide range means you get the right choice for your site requirements.

\* Indicates readers that have functionality to read HID™ 125kHz Proximity tokens, using Genuine HID Technology™ 125kHz. This is enabled using Genuine HID Technology™ Proximity activation licence cards or Wiegand activation licence cards (if the reader needs to provide a Wiegand output), both sold separately (see Tokens section, pg., [pg.16](#)).



PROXIMITY P38 reader

Sales code

333-110-US



**BEST SELLER**

Proximity P50 Mullion reader

Sales code

345-220-US



**BEST SELLER**

PROXIMITY P50 MIFARE® reader

Sales code

353-467-US



PROXIMITY P75 reader

Sales code

373-110-US

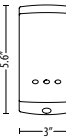



\*

PROXIMITY P200 reader

---

Sales code  
323-110-US





\*

PROXIMITY P200 reader - Metal mount

---

Sales code  
324-110-US





\*

PROXIMITY metal reader, satin chrome

**BEST SELLER**

---

Sales code  
390-747-US

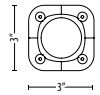



\*

PROXIMITY metal reader, chrome

---

Sales code  
390-727-US

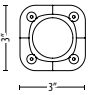

**\*** PROXIMITY vandal proof reader



Sales code  
568-855-US

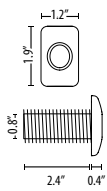

**\*** PROXIMITY panel mount reader



Sales code  
390-135-US

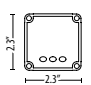

**\*** PROXIMITY marine reader



Sales code  
500-010-US

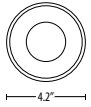

Energy saving reader



Sales code  
595-248-US

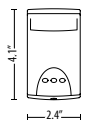

**\*** PROXIMITY architectural reader, gunmetal grey



Sales code  
360-864GG-US



Insert - stone



Sales code  
361-002-US



Insert - glass with logo



Sales code  
361-003-US



**\*** PROXIMITY architectural reader, satin chrome



Sales code  
360-864SC-US



Vandal resistant metal keypad



Sales code  
521-715-US

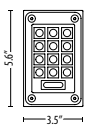

Long range reader



Sales code  
313-110-US

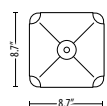

CARDLOCK reader, satin chrome



Sales code  
409-711SC-US

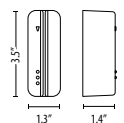



PROXIMITY KP50 keypad

Sales code  
355-110-US



PROXIMITY KP75 keypad

Sales code  
375-110-US

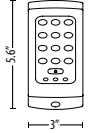

TOUCHLOCK K50 keypad

Sales code  
351-110-US



TOUCHLOCK K75 keypad

Sales code  
371-110-US

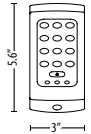

TOUCHLOCK K50 stainless steel keypad

Sales code  
352-110-US



TOUCHLOCK K75 stainless steel keypad

Sales code  
372-110-US

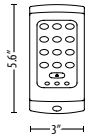

Proximity metal keypad, MIFARE® - KP75

Sales code  
375-130-US

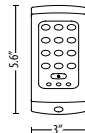

## Net2 Tokens

These tokens are for use with Net2 systems.

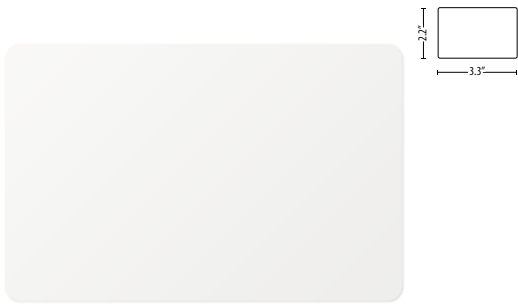

Net2 proximity ISO cards, Without magstripe

x10

Sales code  
692-500-US

x500

Sales code  
692-052-US

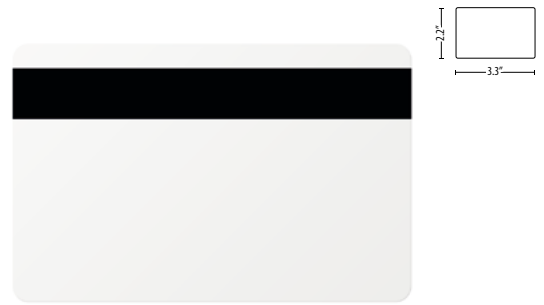

Net2 proximity ISO cards with magstripe

x10

Sales code  
692-448-US

x500

Sales code  
692-053-US



MIFARE® Classic 1k ISO card - Without magstripe

x10

Sales code  
692-148-US

x500

Sales code  
692-152-US



Net2 proximity keyfobs, box of 10

Sales code  
695-644-US

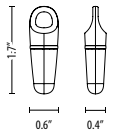

Net2 proximity self-adhesive disc, box of 10

Sales code  
660-100-US





Net2 hands free keyfob

Sales code  
690-222-US

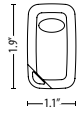

Net2 hands free keycard

Sales code  
690-333-US

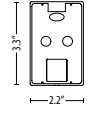

### Genuine HID Technology™ License Activation Cards

125Khz ISO Proximity Card Licence x 1 with Genuine HID Technology™



Sales code  
125-001-US

Wiegand Activation Card with Genuine HID Technology™



Sales code  
125-201-US

Genuine HID Technology™ 125kHz Proximity activation license cards and Wiegand activation license cards are for use with Net2 readers indicated with the symbol ✨ (from pg. 12) to activate functionality to read HID™ 125kHz Proximity or HID™ Wiegand tokens.



## Net2 Software

**Net2 Pro** has all the capabilities of Net2 Lite software with advanced features like timesheet and timeline, Landlord Tenant, security lockdown and anti-passback. Net2 Pro also includes a number of new features to support COVID-secure sites.

**Net2 Lite** contains all of the access control features to manage access privileges and report on users. Other features include multiple workstations, CCTV and intruder alarm integration and site graphics.



Feature	Lite	Pro
Multiple clients	•	•
Free upgrades	•	•
CCTV integration	•	•
Site graphics	•	•
Triggers and actions	•	•
Intruder alarm integration*	•	•
Entry compatible	•	•
Biometric integration	•	•
Card designer	•	•
Timesheet & Timeline*	•	•
Landlord/Tenant		•
Roll call and muster reporting*		•
Fire alarm integration*		•
Anti-passback*		•
Security lockdown*		•
Multi-zone intruder alarm integration*		•
Custom days*		•
Areas		•
Customizable welcome page		•
Paxton Connect app**		•
Net2Online***		•
Checkpoint Control		•
Occupancy Management		•

\* Not available with wireless nano products

\*\* Paxton Connect app only works with Net2 Pro v6.00 or above

\*\*\* Net2Online only works with Net2 Pro v6.01 or above

**Watch our tutorial videos** and learn how you can get the very best from the Net2 software and offer your customers more from their access control system.

<http://paxton.info/3142>



Net2 Pro Software

Sales code  
930-010-US

Net2|Lite

Net2 Software - Lite

Download only



### Net2Online and Paxton Connect

Easy access to your Net2 system wherever you are – any location, any device. Flexible site management via a browser with Net2Online and from the Paxton Connect app.

#### Features include:

- ▶ User admin
- ▶ Viewing reports and events
- ▶ Managing roll call reports
- ▶ Free with Net2 Pro
- ▶ Open door functionality

#### Download the app now:



## Net2 Accessories & Other Components



\* Net2 desktop reader, USB

Sales code  
514-326-US

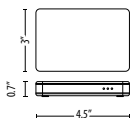

Net2 desktop reader, proximity and magstripe USB

Sales code  
350-910-US

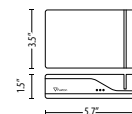

\* Desktop reader with Keyboard Output, USB

Sales code  
214-326-US

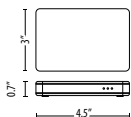

Hands free interface in plastic housing

Sales code  
477-222-US



US Metal Enclosure Only

Sales code  
857-600-US

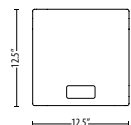

PoE+ power supply in metal cabinet

Sales code  
857-630-US

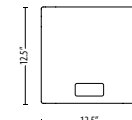

12/24V DC 2.5A power supply in metal cabinet

Sales code  
857-610-US

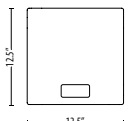

\* 514-326-US has functionality to read HID™ 125kHz Proximity tokens, using Genuine HID Technology™ 125kHz. This is enabled using Genuine HID Technology™ Proximity activation licence cards (pg.16)



Single port midspan 802.3at PoE injector

Sales code  
477-400-US

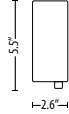

Exit button marine

Sales code  
593-721-US

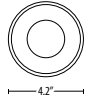

Exit button E50

Sales code  
356-310-US



Exit button E75

Sales code  
376-310-US

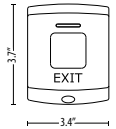

Hands free card holders with suckers, pack of 5

Sales code  
696-100-US

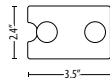

ISO card holder, clear, pack of 5

Sales code  
696-400-US

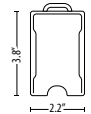

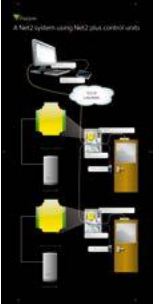

Net2 demo board - Net2 plus

Sales code  
121-005-US

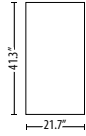

### Demo case Net2 PaxLock US

The case Includes a Net2 PaxLock with override keys, Net2 Pro software, Net2 desktop reader and a Net2Air bridge.

Sales code  
921-999-US

\* one demo case per customer



### Demo case Net2 Plus

The case includes a Net2 plus, Net2 Pro software, Net2 desktop reader and a sample pack of Net2 demonstration tokens.

Sales code  
541-427-US

\* one demo case per customer



## Access Control and Video Management



**Paxton10 is a single platform solution combining access control and video management. Scalable from 1 to 1000 doors, and 1 to 1000 cameras, Paxton10 is a versatile solution suitable for all building types and sizes.**

- ▶ Easy to quote and configure, build a complete system with just five components
- ▶ Manage multiple sites on a single system from anywhere with an internet connection
- ▶ Web-based user interface with no configuration required
- ▶ A variety of cameras available as well as being compatible with third-party IP video cameras.
- ▶ Custom dashboards to suit any user requirements
- ▶ Built in **Bluetooth®** to use phone or smartwatch smart credentials.
- ▶ Works seamlessly with Entry and PaxLock Pro

# Access Control and Video Management

## Paxton10 Access control. Video management. One system

- ▶ Single door controller architecture for ease of install and flexibility
- ▶ Feature rich video management solution embedded in the cameras, no third-party integration required
- ▶ Built-in Bluetooth® wireless technology, supports free of charge smart credentials
- ▶ Fully compatible with Entry, our award-winning video and audio door entry solution
- ▶ Fully compatible with PaxLock Pro, our wireless door handle line
- ▶ Distributed intelligence to increase reliability
- ▶ Powerful multiformat readers and keypad, reads Paxton, MIFARE®, HID™ Prox, EM, FeliCa, NFC and DESFire token technology

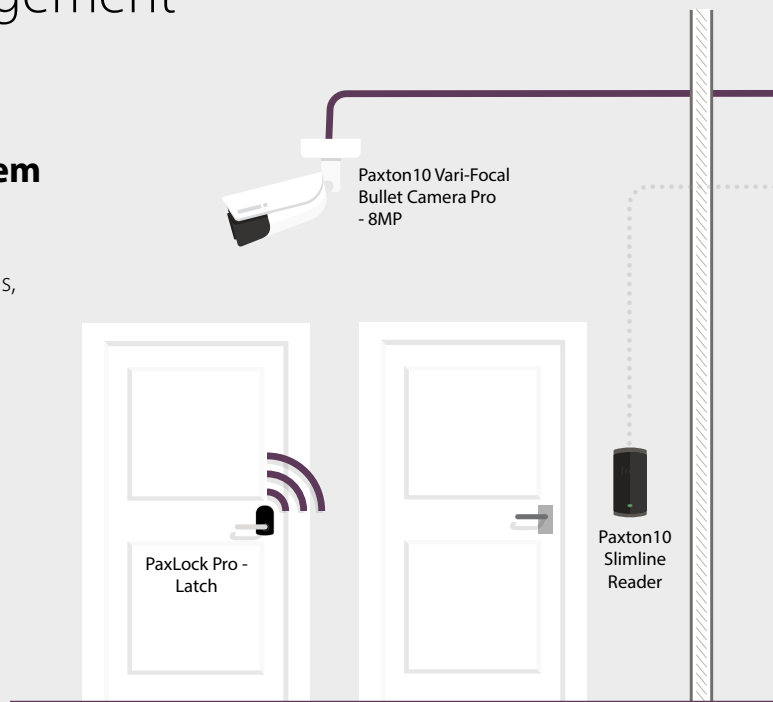

Paxton10  
Door Controller

Sales code  
010-403-US

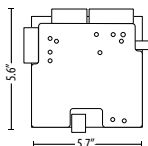

Paxton10  
Door Controller - Plastic Enclosure

Sales code  
010-315-US

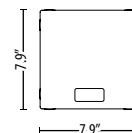

Paxton10  
Door Controller - 12/24V 2A PSU

Sales code  
010-522-US

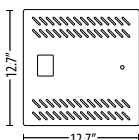

Paxton10  
Video Controller - 12/24V 4A PSU

Sales code  
010-803-US

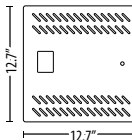

Paxton10  
Door Controller - PoE+ PSU

Sales code  
010-495-US

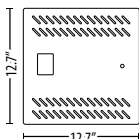

Paxton10  
Video Controller - PoE+ PSU

Sales code  
010-304-US

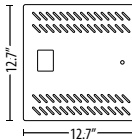

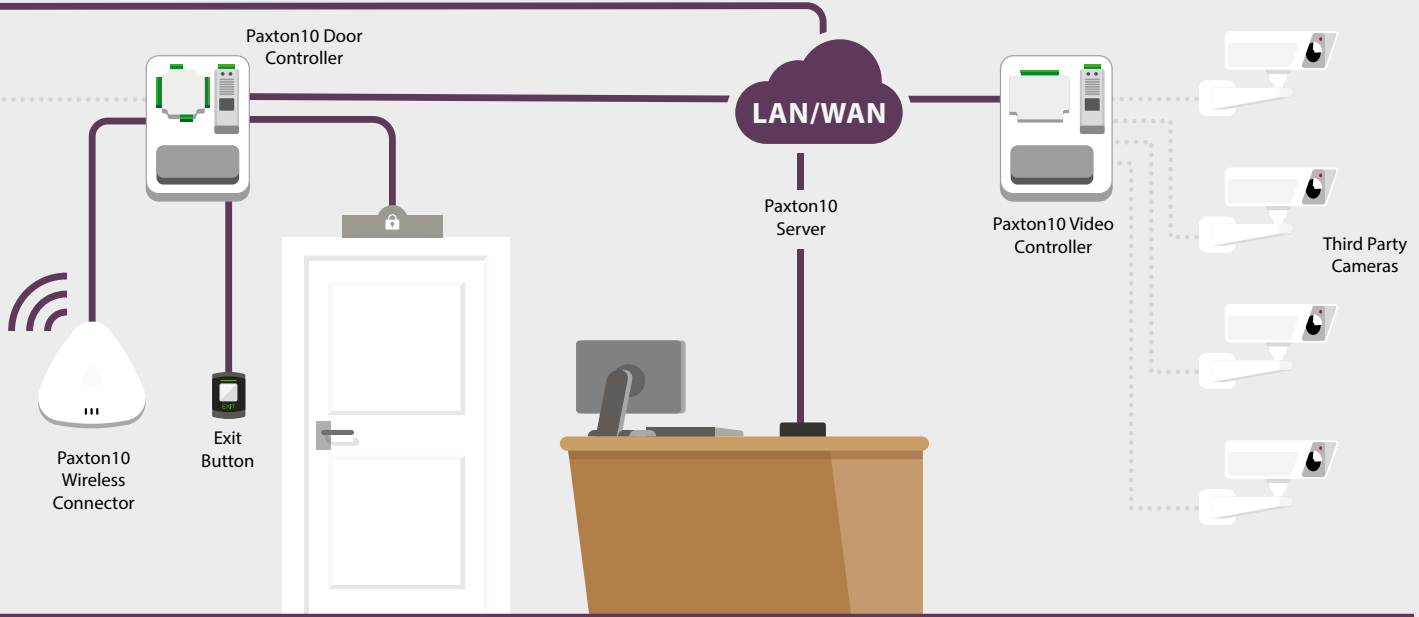

## Integration



Paxton10 integrates with fire and intruder alarms to simplify building management.



Paxton10 Alarm Connector

Sales code  
010-203-US



Paxton10 Server

Sales code  
003-375-US

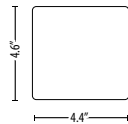

The Paxton10 Server is an Intel manufactured product and is therefore not covered by the Paxton 5-year guarantee. Paxton supports a 3-year warranty for this product, as supplied by Intel.

The Paxton10 Server comes in two variants, manufactured by Intel and Lenovo. The product you receive will depend on current stock availability.



Paxton10 Reader Converter

Sales code  
010-552-US

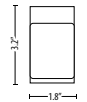

Paxton10 Wireless Connector

Sales code  
010-592-US

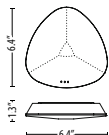

Paxton10 Desktop Reader

Sales code  
010-387-US

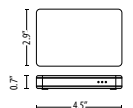

See **page 34** for relevant PaxLock Pro products.

# Access Control and Video Management

## Paxton10 Cameras

Paxton10 includes Paxton's own video management solution and range of CORE & PRO cameras, providing a single point of management for system users. A Paxton10 system can manage up to 1000 cameras including integration with third party IP cameras.

- ▶ Industry leading low light performance (0.003 Lux)
- ▶ IP67 rated for internal and external use\*
- ▶ IK10 rated robust metal construction\*\*
- ▶ Edge and centralized recording capability
- ▶ Simple configuration

\*010-924 is IP66 rated

\*\*010-102 and 010-924 only

Paxton10 cameras come with a 256GB SD card (PRO Series) or 64GB SD card (CORE Series) as standard. Please note, the SD card is a consumable item and is therefore excluded from the guarantee.



**NEW**

### High performance PRO series:

- ▶ 256GB surveillance quality on camera storage
- ▶ 8MP 4K resolution for crystal clear recording



**NEW**

### High value CORE series:

- ▶ 64GB of in-built edge storage
- ▶ 4MP resolution





Paxton10 Mini Bullet Camera - PRO Series

Sales code  
010-158-US

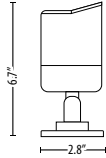

Paxton10 Mini Bullet Camera - CORE Series

Sales code  
010-911-US

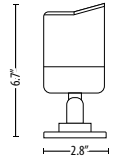

Paxton10 Vari-Focal Bullet Camera - PRO Series

Sales code  
010-924-US

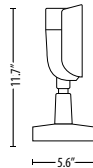

Paxton10 Mini Dome Camera - CORE Series

Sales code  
010-102-US

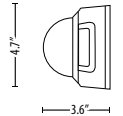

Paxton10 Turret Camera - PRO Series

Sales code  
010-480-US

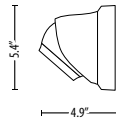

Paxton10 Turret Camera - CORE Series

Sales code  
010-705-US

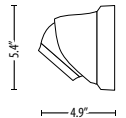

Paxton10 Mini Bullet Camera Junction Box

Sales code  
010-373-US

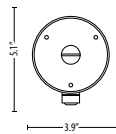

Paxton10 Mini Dome Camera Junction Box

Sales code  
010-799-US

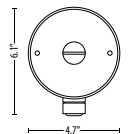

Paxton10 Turret Camera Junction Box

Sales code  
010-445-US

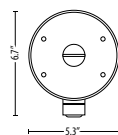



Paxton10 Reader Keypad

Sales code  
010-721-US

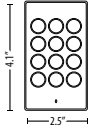

Paxton10 Keyfobs -  
Pack of 10

Sales code  
010-170-US

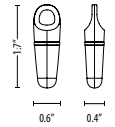

Paxton10 Vandal  
Resistant Reader

Sales code  
010-254-US

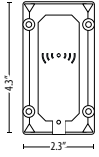

Paxton10 Bluetooth®  
Hands Free Keyfob

Sales code  
010-690-US

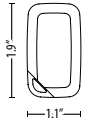

Paxton10 Slimline  
Reader

Sales code  
010-296-US



Paxton10 Cards-  
Pack of 10

Sales code  
010-427-US

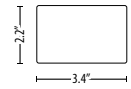



Paxton Connect

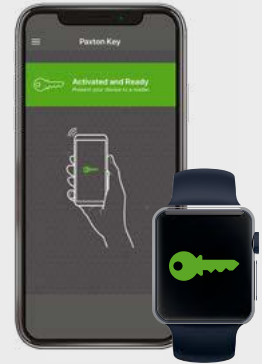

Paxton Key App

## Paxton10 Software

**A web-based user interface that is intuitive and easy to use.**

Accessible from any device with an internet connection, the interface makes remote site management simple. The software comes as a native part of the system with a Paxton10 server. It has a range of intelligent features to maximise efficiency and optimize the combined access and video management solution.

- ▶ Web-based software – no installation, plug-ins or upgrading required
- ▶ Free of charge – simple online updates with no ongoing charges
- ▶ Suitable for touchscreen and desktop devices
- ▶ Optimised for use on PCs and tablets
- ▶ Low battery alerts, easy to monitor back up battery state
- ▶ Flexible and secure remote access

**Features:**

**Dashboards** - Customized dashboards to suit any user requirements

**Reports** - Powerful reporting engine where all system events and videos can be reviewed

**Site plans** - For the visual management of the system

**Tutorial wizards** - Support new and existing users to make full use of the software

**People** - Manage user permissions, credentials and information

**Rules** - Set permissions, time profiles, triggers and actions and much more

**Devices** - Configure and manage the devices in a building

## Paxton10 Apps

### Paxton Connect

**Flexible site management**

The Paxton Connect app provides easy and flexible site management for Paxton10. Containing easy to use features in one smart user interface, Paxton Connect enables you and your customers to manage multiple sites remotely from a smartphone.

**Features:**

**People** - Manage user permission, credentials and information

**Reports** - Access all system reports from your smart device or tablet

**Devices** - Configure and manage all devices on site

**Dashboards** - Access custom dashboards for personalized system overview

### Paxton Key

**Utilize smart devices as access tokens**

The Paxton Key app allows system users to make use of their smartphone, smartwatch or tablet in place of traditional tokens. These are called smart credentials and can be issued free of charge. Utilizing the built-in Bluetooth® wireless technology in Paxton10 readers, the smart device can securely communicate with the Paxton10 system to grant or deny access. Paxton Key also enables the user to carry out predefined building management functionality – such as setting the intruder alarm.

Download the free apps from the **App Store** or **Google Play**



# Video Intercom

**Entry is a video intercom system that works standalone or alongside Net2 access control, combining door entry with key features of Net2.**

**Entry is a scalable solution, allowing expansion of up to a hundred panels and a thousand monitors.**

- ▶ Just 3 components - monitor, panel and door controller
- ▶ Premium, standard, audio, and vandal resistant solutions available
- ▶ Intruder alarm integration - set the alarm in Net2 from the Entry panel for extra convenience
- ▶ Pan/tilt camera functionality to capture an angled view
- ▶ Low light sensitivity camera - ideal for use day or night
- ▶ SIP compatibility - the door can be answered from cell phone, tablet or PC
- ▶ Add a secondary IP camera for higher security sites



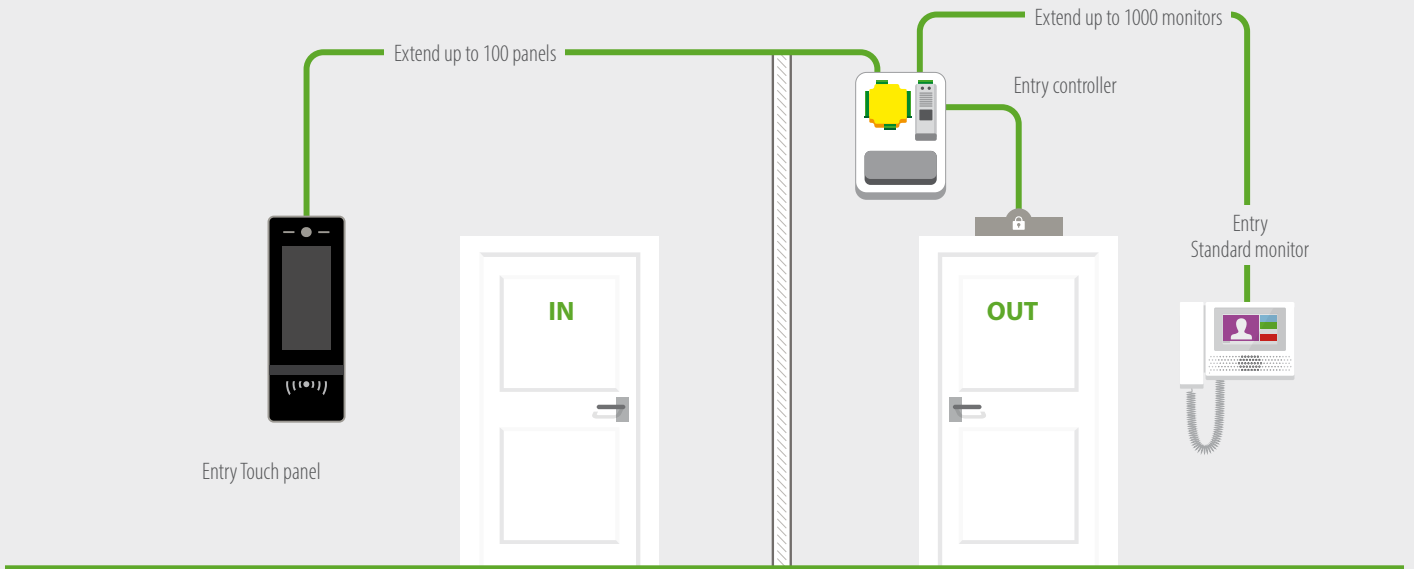

## Entry

### A smart, simple video intercom system.

- ▶ Panels available in three variants: the Entry Touch panel with an advanced 7-inch color touch screen, Entry Standard panel in anthracite grey and the Entry VR panel in super durable stainless steel
- ▶ All variants available in flush, surface and rain-hood versions - suitable for a range of environments
- ▶ Three monitors available, including premium, standard and audio, to create a custom solution for any site
- ▶ Personalize the Entry Touch panel, premium monitor and Standard monitor with multiple theme options and contact images for quick visual recognition
- ▶ Video voicemail, enables visitors to leave a video message
- ▶ Add a secondary IP camera for higher security sites
- ▶ Reads Paxton and MIFARE® token technology



Entry - Touch panel, surface mount

Sales code  
337-620-US

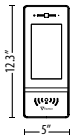

Entry - Touch panel, flush mount

Sales code  
337-600-US

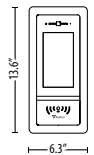

Entry - Touch panel, surface mount with rain hood

Sales code  
337-610-US

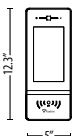

\* Indicates readers that have functionality to read HID™ 125kHz Proximity when enabled using Genuine HID Technology™ 125kHz. Proximity activation license cards, sold separately (see Tokens section, pg.16).



# Video Intercom

Entry



Entry - VR panel, surface mount

Sales code  
337-520-US

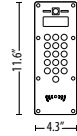

Entry - Standard panel, surface mount

Sales code  
337-420-US

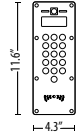

Entry - VR panel, flush mount

Sales code  
337-500-US

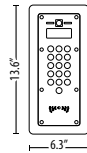

Entry - Standard panel, flush mount

Sales code  
337-400-US

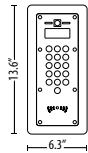

Entry - VR panel, surface mount with rain hood

Sales code  
337-510-US

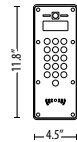

Entry - Standard panel, surface mount with rain hood

Sales code  
337-410-US

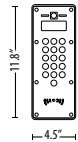

Entry Premium monitor



Sales code  
337-290-US

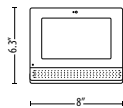

Entry Premium monitor - with handset



Sales code  
337-292-US

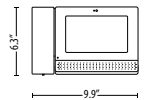

Entry monitor - desktop stand



Sales code  
337-294-US

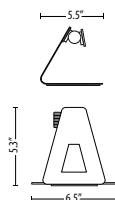



Entry Standard monitor

Sales code  
337-280-US

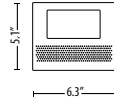
Entry Standard monitor -  
with handset

Sales code  
337-282-US

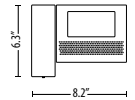

Entry Audio monitor

Sales code  
337-270-US

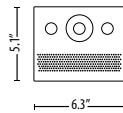

Entry Audio monitor - handset

Sales code  
337-272-US

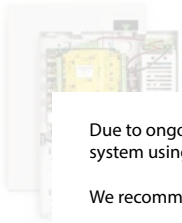
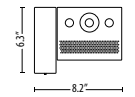

Net2 Entry - Control unit



Entry - Extension switch

Due to ongoing component supply issues, the Net2 Entry - Control Unit and Entry - Extension switch are temporarily unavailable. You can continue to install our Entry system using a Net2 Plus controller and any 802.3af or 802.3at (PoE+) compliant 3rd party PoE switch.

We recommend the TP Link TL-SF1006P switch which has been thoroughly tested with the Entry system.

## Entry Standard Monitor

The latest addition to our video intercom range.

Introducing the next generation standard monitor, a versatile, feature rich and cost-effective solution.

- Excellent audio quality, full-duplex voice communication & easy read, high contrast screen
- Personalized experience with 14 theme designs. Premium user interface with call & event log
- Action buttons, call snapshot and compatibility with concierge management\*
- Available with or without a handset. Universal wall or desk mounting
- Quick and easy installation, providing a true plug and play solution



\*When used with the Entry Premium monitor.  
The standard monitor cannot function as the concierge monitor.

## Demo Cases

Demo cases contain everything you need to demonstrate a one door system.

Additionally, show your customers the benefits of our simple video intercom solution in just two minutes, with the Entry video. Watch it here: <http://paxton.info/3143>

\* Indicates readers that have functionality to read HID™ 125kHz Proximity when enabled using Genuine HID Technology™ 125kHz. Proximity activation license cards, sold separately (see Tokens section, [pg.16](#)).



### Demo case \* Entry - Touch panel

The case includes an Entry Touch panel, Entry Premium monitor and a sample pack of Net2 demonstration tokens.

Sales code  
337-635-US



### Demo case \* Entry - Standard panel

The case includes an Entry Standard panel, Entry Standard monitor and a sample pack of Net2 demonstration tokens.

Sales code  
337-430-US



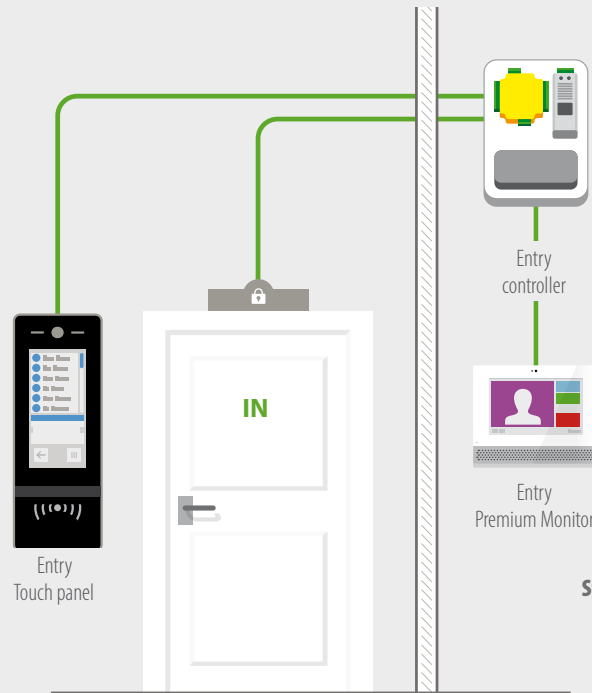

## Entry now works Standalone

Our standalone access control is a non-networked system that provides a simple and low maintenance solution made up of readers or door controllers.

- Quick system installation with no servers or PCs required
- Simple user management
- Combine with other Paxton standalone products
- Build an entire easy-to-use system supporting the same tokens across the site
- Easily expand and upgrade to an online Net2 solution with no hidden costs
- Enable offline token-based access control on any Entry site



We also have standalone colored keyfobs and function cards to make it even simpler to manage access control within the system

### Watch the Entry Video



Show your customers the benefits of our simple video intercom solution in just two minutes, with the Entry video.

- ▶ Featuring the whole Entry range, including the touch panel and premium monitor
- ▶ Just 3 components that auto-detect on set up
- ▶ Discover a scalable solution that suits a variety of locations

**Watch it here:**

<http://paxton.info/3143>

# Wireless Door Handles

**PaxLock Pro is compatible with Net2 and Paxton10, or works in Standalone mode. PaxLock Pro is a wireless, electronic, battery powered door handle.**

- ▶ Flexible upgrade path from standalone to networked, allowing your system to grow to suit your needs
- ▶ Internal and external variants available
- ▶ IK10 impact rated, external variant is also IP55 rated (reader side only)
- ▶ Supports multi-token technology, including Paxton, MIFARE®, Bluetooth®\* and HID®Prox
- ▶ FCC part 15 & ISED certified



\*Bluetooth® compatible with Paxton10 only

## PaxLock Pro Wireless Controller

- ▶ PaxLock Pro - Mortise & PaxLock Pro - Latch versions available
- ▶ Standalone or networked
- ▶ Simple upgrade path from standalone to networked
- ▶ Dual-frequency proximity reader
- ▶ UL294 Certified
- ▶ UL10C Certified\*\* for fire doors
- ▶ Tested to ANSI 156.25\*\*

\*\* PaxLock Pro - Mortise only

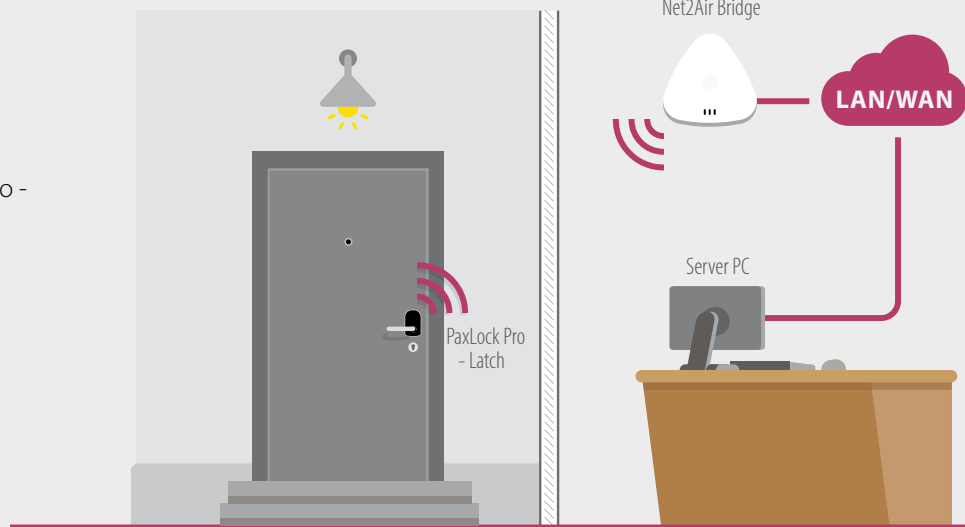

Example PaxLock Pro with a Net2 system

### NEW SALES CODES



PaxLock Pro - Mortise, Galaxy

**Sales code**  
900-640WT-US White

**Sales code**  
900-640BL-US Black

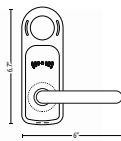

PaxLock Pro - Latch, Galaxy

**Sales code**  
900-620WT-US White

**Sales code**  
900-620BL-US Black

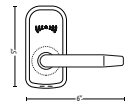

For internal use only

PaxLock Pro - Mortise, Eclipse

**Sales code**  
900-650WT-US White

**Sales code**  
900-650BL-US Black

PaxLock Pro - Latch, Eclipse

**Sales code**  
900-630WT-US White

**Sales code**  
900-630BL-US Black

**Please note:** The PaxLock Pro – Mortise lockset provides key override functionality to ensure access can be gained in the rare event of a unit failure.

## PaxLock Pro Components

These products may be used with PaxLock Pro to aid installation on a variety of doors.

PaxLock Pro – Latchbolt Mortise lock



Sales code  
901-053-US

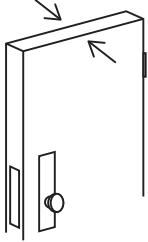

PaxLock Pro - Mortise, 2" door kit  
Sales code  
900-061-US

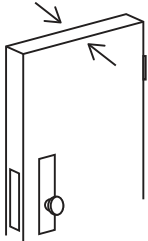
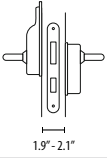

PaxLock Pro - Mortise, 2-1/4" door kit  
Sales code  
900-062-US

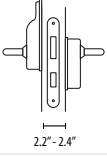

PaxLock Pro - Deadbolt Mortise lock



Sales code  
901-054-US

PaxLock Pro - Latch, 2" door kit  
Sales code  
900-059-US

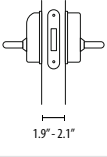

PaxLock Pro - Latch, 2-1/4" door kit  
Sales code  
900-060-US

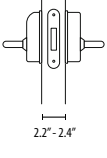

PaxLock Pro - 1/2" Mortise lock cylinder



Sales code  
901-058-US



PaxLock Pro - Mortise door installation jig

Sales code  
900-081-US



PaxLock Pro - Latch door installation jig

Sales code  
900-080-US



Net2Air Bridge

Sales code  
477-600-US

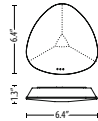

Paxton10 Wireless Connector

Sales code  
010-687-US

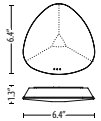

## Demo case PaxLock Pro

The demo case comes with everything you need to show your customers the PaxLock Pro options in action.

- ▶ 2 x Demo Stands with PaxLock Pro - Mortise and Latch options
- ▶ Standalone Token pack (x2 Tokens)
- ▶ Batteries

Sales code  
900-695-US





## Standalone Access Control

**Standalone access control is the simplest way to secure and control access through doors around your building. If you're looking to step up security, protect your staff and assets and save money, then Standalone access control is for you.**

- ▶ A non-networked access control solution
- ▶ Simple and unique card management system
- ▶ Internal (Compact)/external (Switch2)
- ▶ Suitable for small to medium sized premises, or any site looking to secure a small number of doors



## Switch2

Switch2 is a standalone system that comes as a separate single door controller and reader. The door controller is fitted on the secure side of the door, with the reader fitted on the other side. Switch2 offers a secure solution for customers wishing to control door access, who do not need the reports on users' movements provided by a PC based access control system.

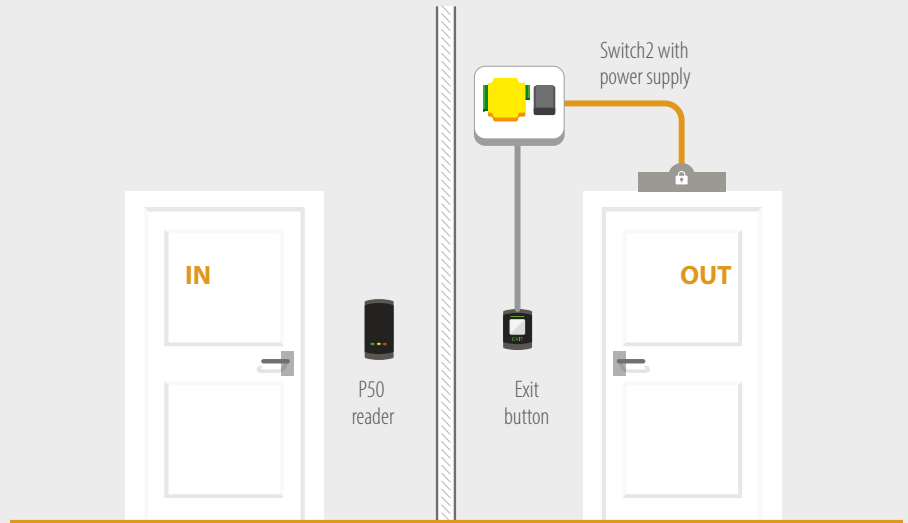

Switch2 control unit

Sales code  
405-321-US

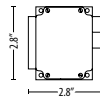

Switch2 ACU and 1A PSU in plastic housing

Sales code  
242-166-US

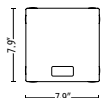

## Entry

Our video intercom system works in standalone mode for a quick, simple installation and easy user management with our standard enrolment and shadow cards. Offer a flexible system that can grow in line with your customers' requirements and be upgraded to work with Net2 or Paxton10, with no hidden costs.

See [page 33](#) for more information

## PaxLock Pro

PaxLock Pro is our wireless access control solution in a battery operated door handle. It can be installed in standalone mode for use on sites not requiring the additional functionality of an online system. It's flexible upgrade path from standalone to networked creates a solution which can evolve with the needs of your customer.

See [page 35](#) for more information

# Standalone Access Control

## Switch2 Readers

These readers are for use with Switch2. Designed to fit in seamlessly in any environment, our wide range means you get the right choice for your site requirements.



PROXIMITY P38 reader

Sales code  
333-110-US



**BEST SELLER**

Proximity P50 Mullion reader

Sales code  
345-220-US

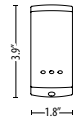

PROXIMITY P75 reader

Sales code  
373-110-US

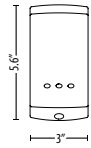

PROXIMITY P200 reader

Sales code  
323-110-US

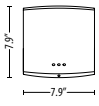

PROXIMITY P200 reader - Metal mount

Sales code  
324-110-US

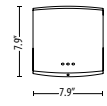

PROXIMITY metal reader, satin chrome

Sales code  
390-747-US



PROXIMITY metal reader, chrome

Sales code  
390-727-US

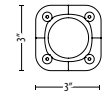



PROXIMITY vandal proof reader

Sales code  
568-855-US

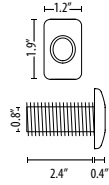

PROXIMITY panel mount reader

Sales code  
390-135-US



PROXIMITY marine reader

Sales code  
500-010-US



Energy saving reader

Sales code  
595-248-US

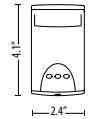

Long range reader

Sales code  
313-110-US

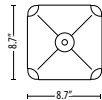

CARDLOCK reader, satin chrome

Sales code  
409-711SC-US

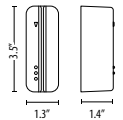

PROXIMITY architectural reader,  
Gunmetal grey

Sales code  
360-864GG-US



Insert - Stone

Sales code  
361-002-US

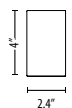

Insert - Glass with logo

Sales code  
361-003-US

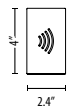

PROXIMITY architectural reader, satin  
chrome

Sales code  
360-864SC-US



# Standalone Access Control

Switch2 Readers



PROXIMITY KP50 keypad

Sales code  
355-110-US



PROXIMITY KP75 keypad

Sales code  
375-110-US

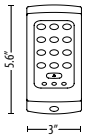

TOUCHLOCK K50 keypad

Sales code  
351-110-US



TOUCHLOCK K75 keypad

Sales code  
371-110-US

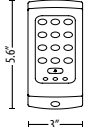

TOUCHLOCK K50 stainless steel keypad

Sales code  
352-110-US



TOUCHLOCK K75 stainless steel keypad

Sales code  
372-110-US

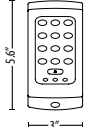

Vandal resistant metal keypad

Sales code  
521-715-US

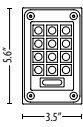

## Compact

Compact is a standalone solution where all the electronics are housed within the reader. Compact is suitable for low security internal doors requiring a cost-effective solution.

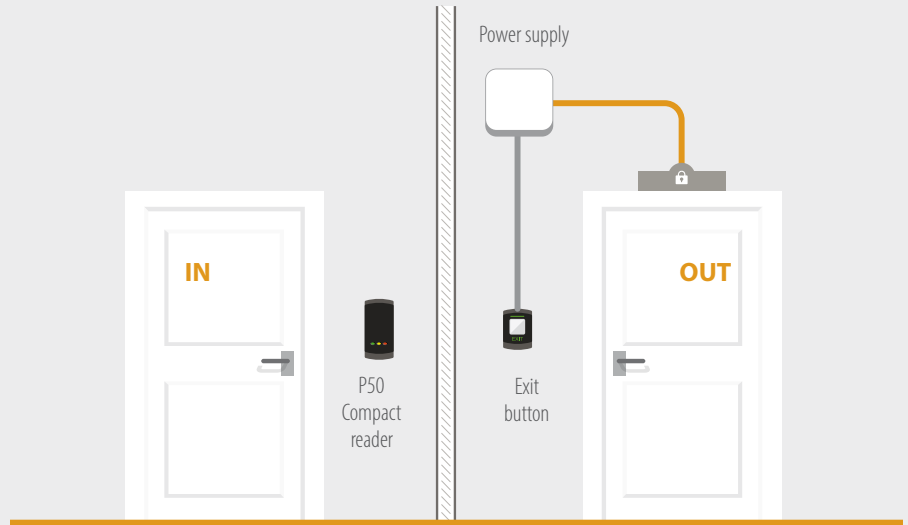

PROXIMITY P38 compact reader

Sales code  
333-210-US

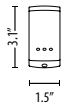

PROXIMITY P50 compact reader

Sales code  
353-210-US

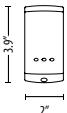

PROXIMITY P75 compact reader

Sales code  
373-210-US

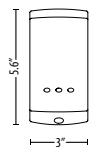

PROXIMITY compact vandal proof reader

Sales code  
326-735-US

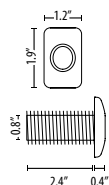

Vandal resistant compact metal keypad

Sales code  
521-836-US

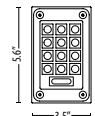

# Standalone Access Control

Compact



TOUCHLOCK K50 compact keypad

Sales code  
351-210-US



TOUCHLOCK K75 compact keypad

Sales code  
371-210-US

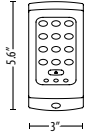

TOUCHLOCK K50 stainless steel compact keypad

Sales code  
352-210-US



TOUCHLOCK K75 stainless steel compact keypad

Sales code  
372-210-US

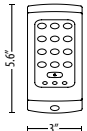

## Standalone Tokens

These tokens are for use with Switch2 and Compact systems..



PROXIMITY 10 keyfob pack - Green, Amber or Red

Sales code  
820-010G/A/R-US

**BEST SELLER**



PROXIMITY 10 card pack - Green, Amber or Red

Sales code  
830-010G/A/R-US

**BEST SELLER**



10 hands free keyfob pack for Switch2, green

Sales code  
860-010G-US



Proximity function card pack

Sales code  
820-000-US

# Standalone Access Control

## Standalone Accessories

These accessories are for use with Switch2 and Compact systems.



Exit button E50

Sales code  
356-310-US



Exit button E75

Sales code  
376-310-US

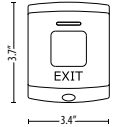

Exit button marine

Sales code  
593-721-US



Hands free interface in plastic housing

Sales code  
477-222-US



US Metal Enclosure Only

Sales code  
857-600-US

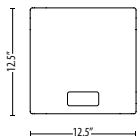

PoE+ power supply in metal cabinet

Sales code  
857-630-US

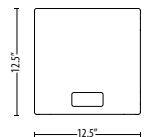

12/24V DC 2.5A power supply in metal cabinet

Sales code  
857-610-US

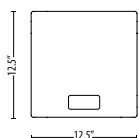



ISO card holder, clear, pack of 5

Sales code  
696-400-US

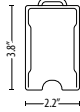

Hands free card holders with  
suckers, pack of 5

Sales code  
696-100-US

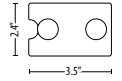

# Additional Information

## Dealer training

We offer practical hands-on training for our Net2 system. The BICSI CEC registered program is designed to provide you with the essential knowledge needed to install Paxton products.

- ▶ Ensure accurate installation
- ▶ Reduce time on site
- ▶ Courses are free of charge
- ▶ Materials and equipment provided

For more information and to book a session, go to <http://paxton.info/3139>.



## Industry leading technical support

Call Paxton and you will be put straight through to our expert support team. Our friendly team is available from 2am-8pm EST Monday-Friday.

Call : 877.438.7298  
 E-mail : supportUS@paxton-access.com  
 Skype : USApaxton.support



## Sales literature

We offer an extensive range of brochures and sales guides to support you every step of the way, from sales to specification. All documentation is available to download from our website at <http://paxton.info/1549>.

## Case studies

Find out how the Net2 system can be adapted to meet a range of diverse requirements by reading our latest case studies. We have a range of examples covering education, healthcare, retail, leisure, commercial and public buildings.

**See our latest case studies here:**  
<http://paxton.info/3140>

## Net2 integration



We want to ensure that we are providing the most sophisticated solutions available. We do this by working with quality manufacturers to provide the best of breed solutions and making them available to you. You can see a map of our Net2 integration partners at <http://paxton.info/2958>.

## Sign up to our newsletter

The Paxton Installer is your regular newsletter, containing the latest news, product information and updates from us. Your copy of the Paxton Installer will arrive in your inbox, full of useful information that will make your job easier and help you to win more business.

**Sign up now:**  
<http://paxton.info/3141>









## Paxton 5 year warranty and hassle free returns policy

We offer a five year guarantee on all our products.

If a problem arises, all you have to do is return your Paxton product to your local distributor.

We want to make life as easy as possible for installers of Paxton products. Our five year warranty and hassle-free returns policy helps us to do this successfully.



## Product Selection Guide 2022

 **Paxton Access Inc.**  
138 Commerce Center  
Greenville  
SC 29615  
USA

 877.438.7298

 [supportUS@paxton-access.com](mailto:supportUS@paxton-access.com)

 [www.paxton-access.com/us](http://www.paxton-access.com/us)

MIFARE® is a registered trademark of NXP B.V. and is used under license.

The Genuine HID Technology logo is a trademark of HID Global Corporation/ASSA ABLOY AB. Used with permission.

All information and specifications correct at the point of publication, but may be subject to change without notice.

All pictures shown are for illustration purpose only. Actual products may vary.