



National Products Inc.

2021 | **SAMSUNG** MOUNTING SOLUTIONS



Field Service . Healthcare . Manufacturing . Public Safety . Retail . Transportation . Warehouse

SEEN IN THIS PHOTO:

RAM-TC-SAM29U

RAM® Tough-Case™ with USB Type-A
for Samsung Tab Active3/2

RAM-GDS-CHARGE-USB2QCIG

RAM® 2-Port USB Cigarette Charger
with Qualcomm® Quick Charge™



SUPPORTED DEVICES

TABLETS



TAB A 8.0 (2018)

- 16 INTELLISKIN® & INTELLISKIN® NEXT GEN
- 18 GDS® VEHICLE DOCKS™
- 20 RAM® TOUGH-DOCK™ & COOL-DOCK™
- 22 RAM® TOUGH-CASE™
- 24 RAM® TOUGH-CASE™ HOLDER
- 25 RAM® TAB-TITE™ & TAB-LOCK™
- 27 RAM® X-GRIP®



TAB A 8.0 (2019)

- 15 GDS® VEHICLE DOCKS™
- 16 INTELLISKIN® & INTELLISKIN® NEXT GEN
- 18 GDS® VEHICLE DOCKS™
- 20 RAM® TOUGH-DOCK™ & COOL-DOCK™
- 22 RAM® TOUGH-CASE™
- 24 RAM® TOUGH-CASE™ HOLDER
- 25 RAM® TAB-TITE™ & TAB-LOCK™
- 27 RAM® X-GRIP®



TAB A 8.4

- 15 GDS® VEHICLE DOCKS™
- 16 INTELLISKIN® NEXT GEN
- 18 GDS® VEHICLE DOCKS™
- 20 RAM® TOUGH-DOCK™ & COOL-DOCK™
- 25 RAM® TOUGH-CASE™
- 24 RAM® TOUGH-CASE™ HOLDER
- 25 RAM® TAB-TITE™ & TAB-LOCK™
- 27 RAM® X-GRIP®



TAB A 10.5 (2018)

- 16 INTELLISKIN® & INTELLISKIN® NEXT GEN
- 20 RAM® TOUGH-DOCK™ & COOL-DOCK™
- 25 RAM® TAB-TITE™ & TAB-LOCK™
- 27 RAM® X-GRIP®



TAB A 10.1 (2019)

- 16 INTELLISKIN® & INTELLISKIN® NEXT GEN
- 20 RAM® TOUGH-DOCK™ & COOL-DOCK™
- 22 RAM® TOUGH-CASE™
- 24 RAM® TOUGH-CASE™ HOLDER
- 25 RAM® TAB-TITE™ & TAB-LOCK™
- 27 RAM® X-GRIP®



TAB A7 10.4

- 16 INTELLISKIN® & INTELLISKIN® NEXT GEN
- 20 RAM® TOUGH-DOCK™ & COOL-DOCK™
- 22 RAM® TOUGH-CASE™
- 24 RAM® TOUGH-CASE™ HOLDER
- 25 RAM® TAB-TITE™ & TAB-LOCK™
- 27 RAM® X-GRIP®



TAB ACTIVE3 & TAB ACTIVE2

- 1 RAM® TOUGH-CASE™
- 3 FORM-FIT DOCKS
- 4 FORM-FIT DOCKS
- 5 PERIPHERALS
- 9 DESKTOP DOCKS
- 10 DESKTOP DOCKS
- 11 INTELLISKIN®
- 14 RAM® SKIN™
- 16 INTELLISKIN® & INTELLISKIN® NEXT GEN
- 19 GDS® COOL-DOCK™
- 20 RAM® TOUGH-DOCK™ & COOL-DOCK™
- 21 RAM® TOUGH-CASE™
- 22 RAM® TOUGH-CASE™
- 23 RAM® TOUGH-CASE™ HOLDER
- 24 RAM® TOUGH-CASE™ HOLDER
- 25 RAM® TAB-TITE™ & TAB-LOCK™
- 27 RAM® X-GRIP®



TAB ACTIVE PRO

- 3 FORM-FIT DOCKS
- 4 FORM-FIT DOCKS
- 5 PERIPHERALS
- 9 DESKTOP DOCKS
- 14 RAM® SKIN™
- 16 INTELLISKIN® & INTELLISKIN® NEXT GEN
- 17 INTELLISKIN® NEXT GEN
- 19 INTELLISKIN® NEXT GEN
- 20 RAM® TOUGH-DOCK™ & COOL-DOCK™
- 22 RAM® TOUGH-CASE™
- 24 RAM® TOUGH-CASE™ HOLDER
- 25 RAM® TAB-TITE™ & TAB-LOCK™
- 27 RAM® X-GRIP®

PHONES



A20

- 16 INTELLISKIN® & INTELLISKIN® NEXT GEN
- 20 RAM® TOUGH-DOCK™ & COOL-DOCK™
- 25 RAM® TAB-TITE™ & TAB-LOCK™
- 27 RAM® X-GRIP®



S20

- 16 INTELLISKIN® & INTELLISKIN® NEXT GEN
- 20 RAM® TOUGH-DOCK™ & COOL-DOCK™
- 25 RAM® TAB-TITE™ & TAB-LOCK™
- 27 RAM® X-GRIP®



XCOVER PRO

- 7 RAM® EZ-ROLL'R™ POWERED
- 10 SAMSUNG XCOVER PRO & FIELDPRO
- 10 DESKTOP DOCKS
- 16 INTELLISKIN® & INTELLISKIN® NEXT GEN
- 20 RAM® TOUGH-DOCK™ & COOL-DOCK™
- 25 RAM® TAB-TITE™ & TAB-LOCK™
- 27 RAM® X-GRIP®



XCOVER FIELDPRO

- 8 SAMSUNG XCOVER PRO & FIELDPRO
- 10 DESKTOP DOCKS
- 16 INTELLISKIN® & INTELLISKIN® NEXT GEN
- 20 RAM® TOUGH-DOCK™ & COOL-DOCK™
- 25 RAM® TAB-TITE™ & TAB-LOCK™
- 27 RAM® X-GRIP®

 VISIT **RAMMOUNT.COM** FOR MORE SUPPORTED DEVICES

Supports factory OEM skin and
RAM® Skin™

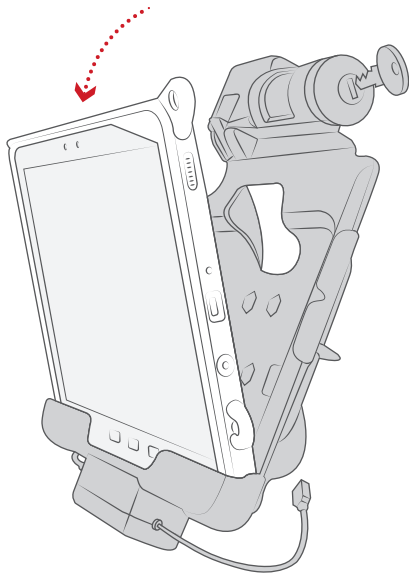

FORM-FIT DOCKS

For a slim, clean mounting solution, the form-fit holders offer a custom housing that fits perfectly for select Samsung devices in its original OEM skin or the RAM® Skin™. Numerous add-ons and options include combination locks, key locks, dual USB and power-only docks.



RAM-101B-225B-SAM60PD-AUD-V7BU

RAM® Powered Mount for Samsung
Tab Active3 and Tab Active2 with Speaker



RAM-HOL-SAM57PKLU
RAM® Skin™ Key-Locking
Powered Dock for Samsung
Tab Active Pro



RAM-HOL-SAM60PU
RAM® EZ-Roll'r™ Powered
Dock for Samsung Tab
Active3 and Tab Active2



RAM-HOL-SAM58PD2CLU
RAM® Skin™ Combo-
Locking Powered Dock for
Samsung Tab Active3/2

AVAILABLE IN:



KEY LOCK



COMBO LOCK



NON-LOCKING



POWER



POWER + DATA

FEATURES

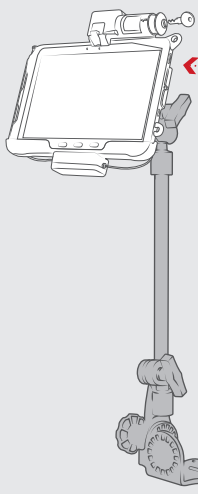

Back of Form-Fit
Holder, showing the
AMPS hole patterns

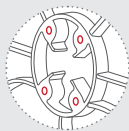

AMPS hole pattern
connects to any RAM®
vehicle mounts

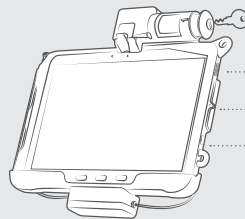

Speakers, mics and
headphone jack remain exposed

1

Speakers

2

Mics

3

Headphone
Jack

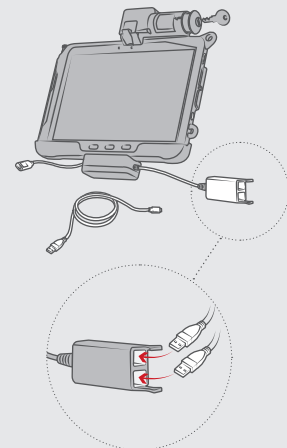

Keeps your tablet charged, protected
and connected to your peripherals



SEEN IN THIS PHOTO:

RAM-HOL-SAM57PD2KLU
 RAM® Skin™ Key-Locking
 Power + Dual USB Data
 Cradle for Tab Active Pro

FORM-FIT DOCKS CONTINUED

TAB ACTIVE2 & TAB ACTIVE3					
PART NUMBER	⚡ POWER	🔑 KEY LOCKING	🔒 COMBO LOCKING	⚡ SINGLE USB PERIPHERAL	⚡🔌 DUAL USB PERIPHERAL
RAM-HOL-SAM60PU	•				
RAM-HOL-SAM60PDU	•			•	
RAM-HOL-SAM60PD2U	•				•
RAM-HOL-SAM58PKLU	•	•			
RAM-HOL-SAM58PDKLU	•	•		•	
RAM-HOL-SAM58PD2KLU	•	•			•
RAM-HOL-SAM58PCLU	•		•		
RAM-HOL-SAM58PDCLU	•		•	•	
RAM-HOL-SAM58PD2CLU	•		•		•

TAB ACTIVE PRO					
PART NUMBER	⚡ POWER	🔑 KEY LOCKING	🔒 COMBO LOCKING	⚡ SINGLE USB PERIPHERAL	⚡🔌 DUAL USB PERIPHERAL
RAM-HOL-SAM52PU	•				
RAM-HOL-SAM52PDU	•			•	
RAM-HOL-SAM52PD2U	•				•
RAM-HOL-SAM57PKLU	•	•			
RAM-HOL-SAM57PCLU	•		•		
RAM-HOL-SAM57PDCLU	•		•	•	
RAM-HOL-SAM57PD2CLU	•		•		•
RAM-HOL-SAM57PDKLU	•	•		•	
RAM-HOL-SAM57PD2KLU	•	•			•

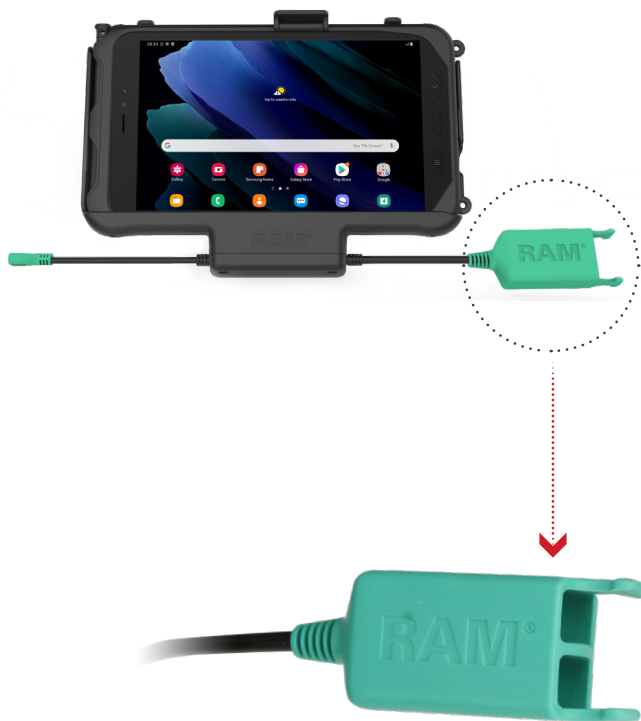

PERIPHERALS

Connect up to any two USB Type A peripherals directly to your Tab Active2, Tab Active3 and Tab Active Pro Docking Station

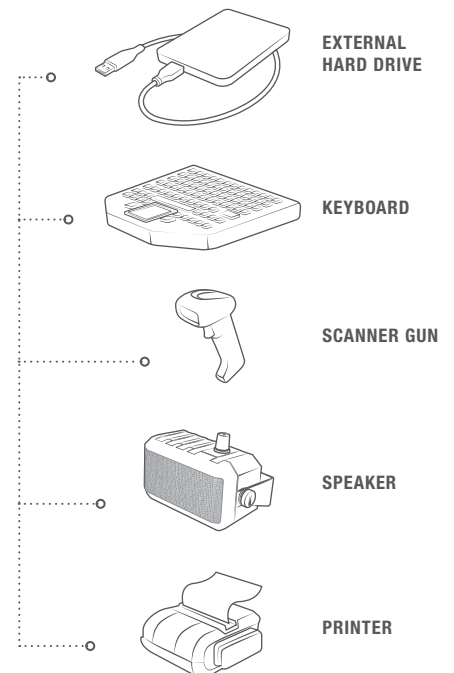

GDS® KEYBOARD™



RAM-KB4-USB

GDS® Keyboard™ with 10-Key Numeric Pad



RAM-KB2-USB

GDS® Keyboard™ with Track Pad

Back view of the
GDS® Keyboard™

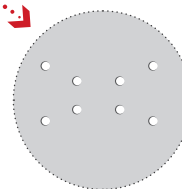

AMPS & VESA hole patterns
for any RAM® Mount

GDS® AUDIO



RAM-SPEAK-A02

GDS® Audio™ Amplified
Speaker with PTT
Breakout Feature

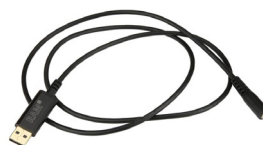

RAP-CAB-USBA-AUD35U

RAM® Audio Adapter Cable -
3.5mm Female Connector to
USB Type A Male

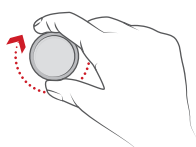

Max volume range: 93dB

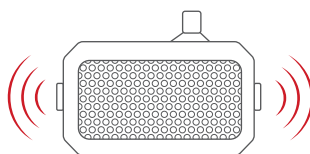

8Ω / 10W rated speaker

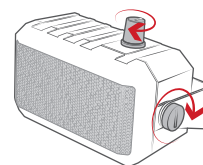

Independently adjustable volum knob

PRINTER SOLUTIONS

QLN SERIES, ZQ500 SERIES, ZQ600 SERIES



Spring-loaded universal
holders offer convenient
insertion and removal

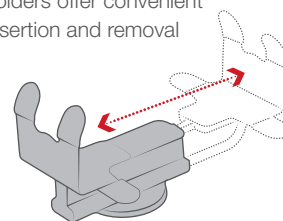

RAM-VPR-104

RAM® Quick-Draw™ Jr. Universal Small Printer Holder

RAM® POWER-GRIP™



RAP-396U

RAM® Power-Grip™
Holder for Zebra 3600
Series



RAP-450U

RAM® Power-Grip™ XL
Holder for Zebra MC9300

Features replaceable
elastomeric fins for a
secure fit

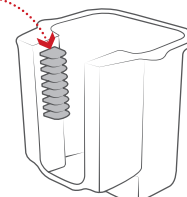



SEEN IN THIS PHOTO:

RAM-HOL-SAM59U

RAM® EZ-Roll'r™ Cradle

RAM-B-238

RAM® Diamond Ball Base

RAM-B-201U-C

RAM® Double Socket Arm

RAP-B-400U

RAM® Tough-Claw™ Small
Clamp Base with Ball



SEEN IN THIS PHOTO:

RAM-B-166-SAM9PU

RAM® EZ-Roll'r™ Powered
Suction Cup Mount for
Samsung XCover Pro

FEATURES

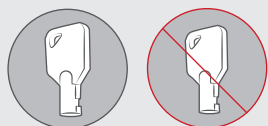

Locking & non-locking options available

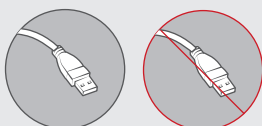

Powered & non-powered options available

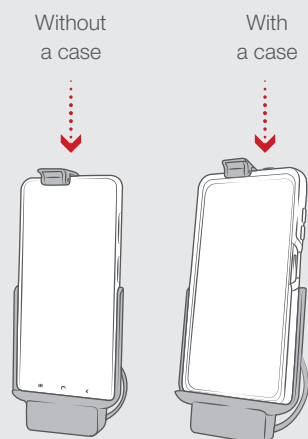

Solutions for XCover Pro with case, without a case, and with an OtterBox uniVERSE case

SAMSUNG XCOVER PRO & FIELDPRO

Both the Samsung XCover Pro & FieldPro take some of the best features of current Tab Active tablets by introducing the pogo-pad technology for charging purposes. RAM® supports these kinds of innovations with pogo-pin enabled powered docks. Of course, with a non-powered option available, the RAM® EZ-Roll'r™ system supports the Samsung XCover Pro without a case as well as an option for OtterBox uniVERSE-wrapped XCover Pros. Simply drop the device into the powered cradle and the aligned pogo-pins to pogo-pads instantly starts charging.

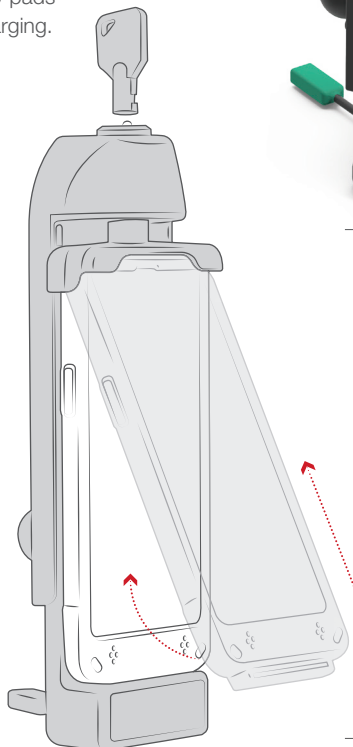

RAM-GDS-DOCKL-V3CU
Locking Vehicle Phone Dock



RAM-GDS-SKIN-SAM59
IntelliSkin®



RAM-HOL-SAM59U
Non-Powered RAM® EZ-Roll'r™

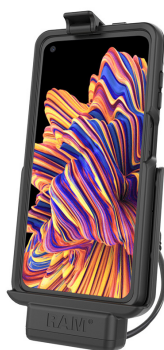

RAM-HOL-SAM9P-OT2U
Powered RAM® EZ-Roll'r™ with OtterBox uniVERSE



RAM-HOL-SAM9PU
Powered RAM® EZ-Roll'r™



RAM-HOL-SAM72PU
Powered RAM® EZ-Roll'r™ for Samsung Galaxy XCover FieldPro

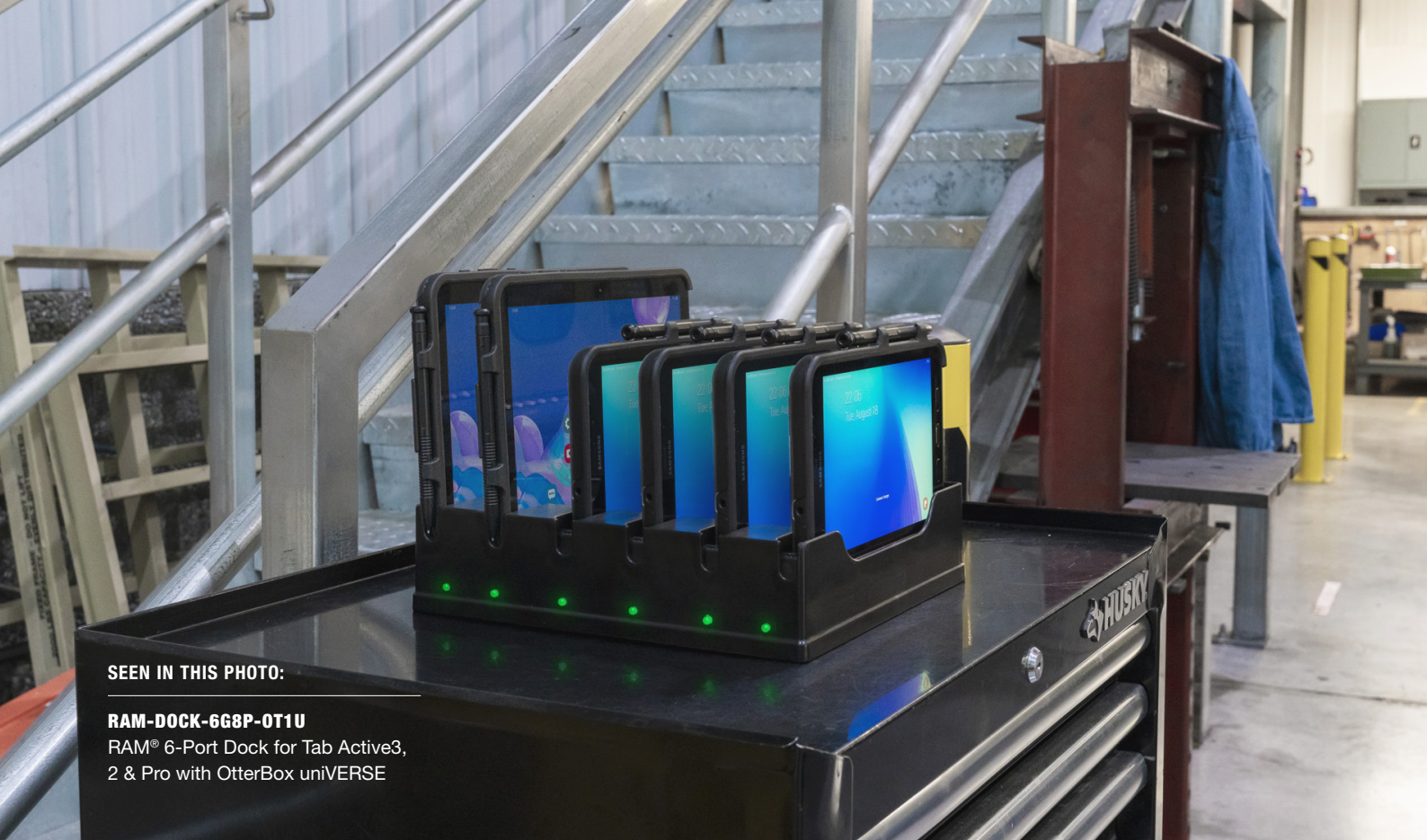

SEEN IN THIS PHOTO:

RAM-DOCK-6G8P-OT1U

RAM® 6-Port Dock for Tab Active3, 2 & Pro with OtterBox uniVERSE

DESKTOP DOCKS

The RAM® 6-Port desktop dock charging station was designed specifically to support up to six Samsung Galaxy Tab Active or XCover Pro/FieldPro devices for simultaneous charging. These desktop docks reduce the amount of charging cords needed to charge each device by consolidating power through one cord and providing each Samsung tablet with its own charging bay to reduce clutter.



RAM-DOCK-6G8PU

RAM® 6-Port Dock for Tab Active3, Tab Active2 & Tab Active Pro



RAM-DOCK-6G8P-OT1U

RAM® 6-Port Dock for Tab Active3, 2 & Pro with OtterBox uniVERSE

FEATURES

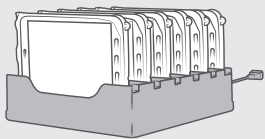

Charges up to six Tab Active Pros, Tab Active3s and Tab Active2s interchangeably

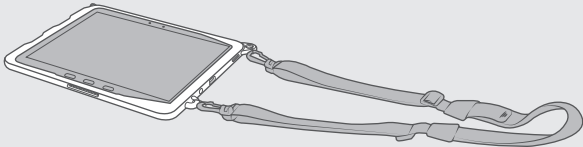

Supports Devices with OEM Case, RAM® Skin & OtterBox uniVERSE



RAM-DOCK-6G-SAM59PU
RAM® 6-Port Charging Dock for
Samsung XCover Pro



RAM-DOCK-6G-SAM59P-OT1U
RAM® 6-Port Charging Dock for Samsung
XCover Pro with OtterBox uniVERSE



RAM-DOCK-6G-SAM72PU
RAM® 6-Port Charging Dock for
Samsung XCover FieldPro



ADDITIONAL FEATURES

- 1 Integrated pogo-pin contacts match Samsung Tab Active pogo pads for connectivity
- 2 Removable form-fit spacers used for Tab Active3 and 2
- 3 6-Port dock allows space for RAM® Skin™ and accessories
- 4 LED lights indicate charge status

SEEN IN THIS PHOTO:

RAM-GDS-DOCK-D2CU

GDS® Desktop Dock with USB Type-C
for IntelliSkin® Products

RAM-GDS-SKIN-SAM29H

IntelliSkin® for Samsung Tab Active2 -
GDS® Hand-Stand™ Compatible



DESKTOP DOCKS CONTINUED

INTELLISKIN® DESKTOP DOCKS

Desktop charging stations are also available for IntelliSkin®-wrapped Samsung Galaxy smartphones and tablets. Designed specifically to support the GDS® Ecosystem™ these desktop docks utilize the pogo-pin technology found in all GDS® Docks™ so you can keep a seamless workflow for your organization. These docks successfully reduce the amount of charging cords needed to charge each device by consolidating power through one cord and providing each Samsung tablet with its own charging bay to reduce clutter.

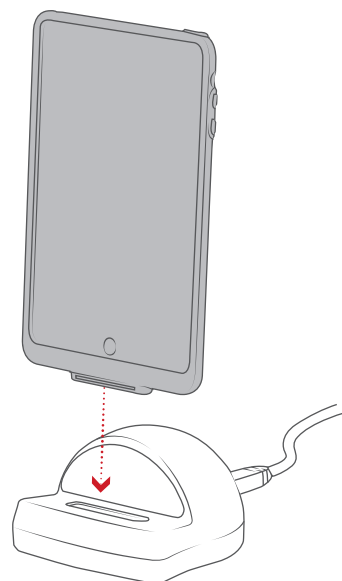

RAM-GDS-DOCK-6G9PU
GDS® 6-Port Desktop Charger for
Phones with IntelliSkin®



RAM-GDS-DOCK-D2CU
GDS® Desktop Dock with USB
Type-C for IntelliSkin® Products



RAM-GDS-DOCK-D2C-NDU
GDS® Desktop Dock with USB Type-C for
Next Gen IntelliSkin®

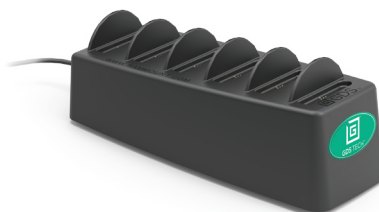

RAM-GDS-DOCK-6G1PU
6-Port Desktop Charger



RAM-GDS-DOCK-6G1P-NGU
GDS® 6-Port Desktop Charger for Next Gen
IntelliSkin®

FEATURES

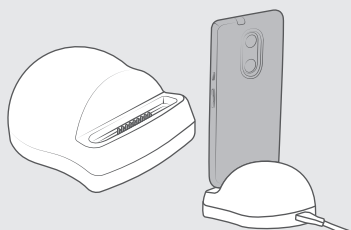

Features 18-pin contacts that easily connect to your IntelliSkin® wrapped device and support USB Type-C data transfer and charging profiles.

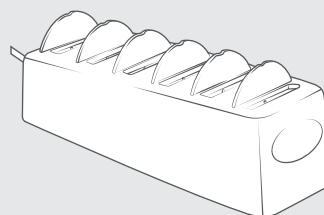

Charges up to six IntelliSkin®-enabled devices simultaneously and supports USB 2.0/3.0 phones and tablet

SEEN IN THIS PHOTO:

RAM-SKIN-SAM29

RAM® Skin™ for Samsung Tab Active2

RAM-GDS-HS1U

GDS® Hand-Stand™ Hand Strap and Kick Stand for Tablets



SEEN IN THIS PHOTO:

RAM-SKIN-SAM73

RAM® Skin™ for Samsung Tab Active3

RAM-GDS-HS1U

GDS® Shoulder Strap Accessory for IntelliSkin® Products



RAM® SKIN™

This RAM® Skin™ was designed specifically for the Samsung Tab Active Pro, Tab Active3 and Tab Active2. It features MIL-STD-810G military-grade drop protection and a built-in S Pen holder. Made for rugged use in a variety of applications, the RAM® Skin™ is ideally paired with the GDS® Hand-Stand™ tablet hand strap and kick stand as well as the GDS® shoulder strap accessory.

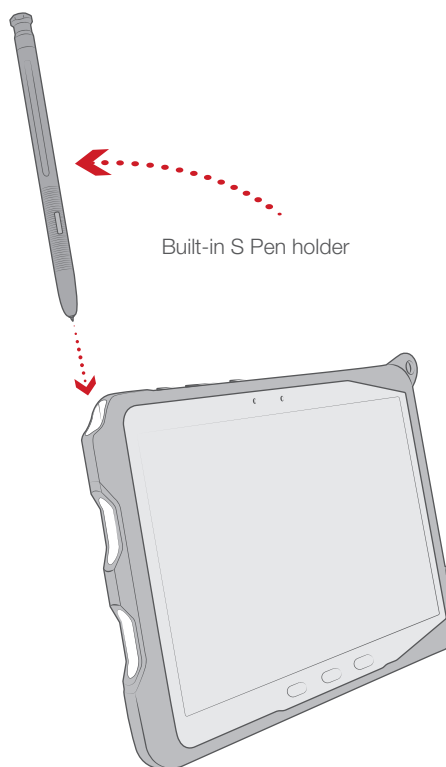

Built-in S Pen holder



RAM-SKIN-SAM29

RAM® Skin™ for Samsung Tab Active2



RAM-SKIN-SAM52

RAM® Skin™ for Samsung Tab Active Pro



RAM-SKIN-SAM73

RAM® Skin™ for Samsung Tab Active3



RAM-GDS-HS1U

GDS® Hand-Stand™ Hand Strap and Kick Stand for Tablets



RAM-GDS-SS1U

GDS® Shoulder Strap Accessory for IntelliSkin® and RAM® Skin™



RAM-GDS-HS1MU

GDS® Hand-Stand™ Magnetic Hand Strap and Kick Stand for Tablets

FEATURES



Compatible with GDS® Ergo™ accessories

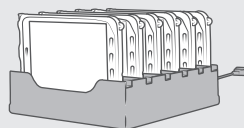
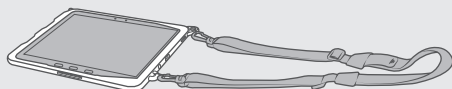

Compatible with a range of feature-rich RAM® holders

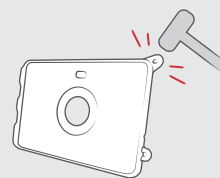

Made of durable polycarbonate and thermoplastic elastomers

Product positioning marker provides universal compatibility across IntelliSkin® Next Gen sleeves and GDS® top cups



SEEN IN THIS PHOTO:

RAM-GDS-SKIN-SAM67-NG

IntelliSkin® Next Gen for Samsung Tab A 8.4 SM-T307

RAM-GDS-DOCKL-V9-SAM67U

GDS® mUSB Vehicle Dock for Samsung Tab A 8.4 & Tab A 8.0 (2019)

RAM-GDS-HS1U

GDS® Hand-Stand™ Hand Strap and Kick Stand for Tablets

RAM-101U-B-XAT1

RAM® Universal Backing Plate Mount

INTELLISKIN® & INTELLISKIN® NEXT GEN

IntelliSkin® is a protective sleeve for phones and tablets featuring GDS® Tech™ with pogo pin technology and military-grade drop protection. With an integrated GDS® connector molded directly into each skin and ruggedized docking contacts on each skin's exterior, IntelliSkin® is designed to extend the life of devices by preventing damage to the charging port from repetitive docking. The IntelliSkin® Next Generation protective sleeve includes all the great features of the original IntelliSkin® while adding several enhancements. An insert molded redesign of the skin combines a hard plastic shell with soft, shock-absorbing rubber. Ruggedized contacts for repetitive docking remain on the exterior, but are now flat to collect less dirt and allow for easier cleaning. An integrated USB Type-C connector at the bottom of the skin allows for device charging even when you don't have a GDS® Dock™ available.



RAM-GDS-SKIN-SAM54-NG

IntelliSkin® Next Gen for Samsung Tab Active Pro

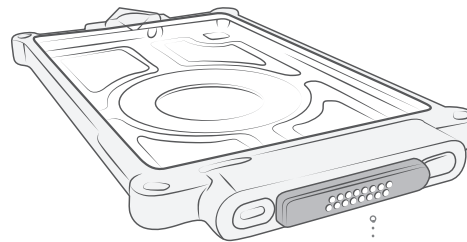

POGO PIN TECHNOLOGY

Protects your device ports from constant plugging and unplugging.

FEATURES

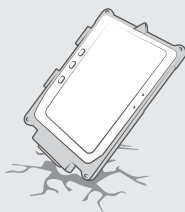

DROP PROTECTION

Having passed rigorous military-grade spec tests for withstanding shock and impact.

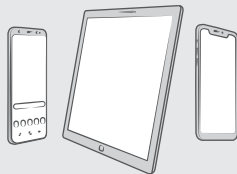

UNIVERSAL DOCKING

Pogo Pin technology allows for any IntelliSkin®-wrapped device to work within the GDS® Ecosystem™



WORKFLOW ENABLEMENT

Connect multiple peripherals to your mounting solution and gain instant access when device is docked



RAM-GDS-SKIN-SAM59

IntelliSkin® for Samsung Galaxy XCover Pro



RAM-GDS-SKIN-SAM67-NG

IntelliSkin® Next Gen for Samsung Tab A 8.4 SM-T307



RAM-GDS-SKIN-SAM61

IntelliSkin® for Samsung Galaxy A20



RAM-GDS-SKIN-SAM29H

IntelliSkin® for Samsung Tab Active2 SM-T390 & SM-T395



RAM-GDS-SKIN-SAM77

IntelliSkin® for Samsung Galaxy S20 FE 5G



RAM-GDS-SKIN-SAM74-NG

IntelliSkin® Next Gen for Samsung Tab Active3



SEEN IN THIS PHOTO:

RAM-GDS-SKIN-SAM54-NG

IntelliSkin® Next Gen for Samsung
Tab Active Pro

RAM-GDS-DOCKL-V9-OMT1U

GDS® Type-C Vehicle Dock for
IntelliSkin® Next Gen Tablets

RAM-VB-195-SW2

RAM® No-Drill™ Mount for
'17-21 Ford F-250 - F-550 + More

FEATURES

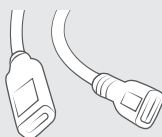

mUSB and USB Type-C Docks provide fast charging

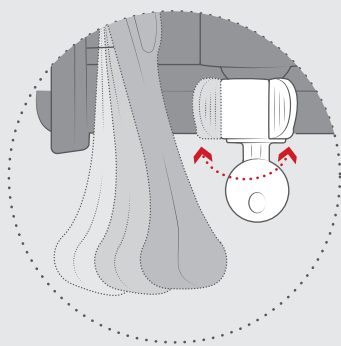

Key Locking

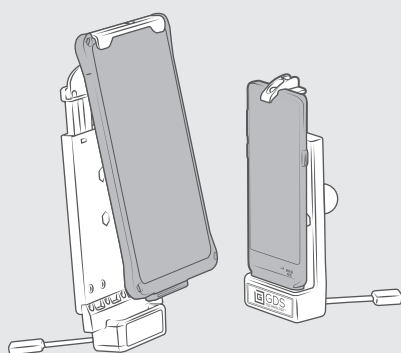

Compatible with any RAM® phone & tablet mounts

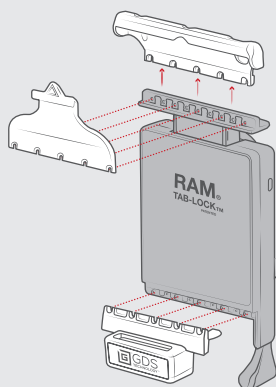

Interchangeable Top Cups

GDS® VEHICLE DOCKS™

GDS® Vehicle Docks™ with GDS® Technology™ offer a universal charging platform for any device wrapped in an IntelliSkin® sleeve. IntelliSkin® offers drop protection and uses ruggedized external contacts to allow for repetitive docking, with no need to deal with charging cables. The main advantage of GDS® Vehicle Docks™ is the interchangeable top and bottom cups. Simply switch out either cup depending on the device you plan on docking instead of purchasing new docks. New top cups for IntelliSkin® Next Gen-wrapped devices feature universal positioning marker for a clean docking experience



RAM-GDS-DOCKKL-V9-OMT1U
GDS® Type-C Vehicle Dock for IntelliSkin® Next Gen Tablets

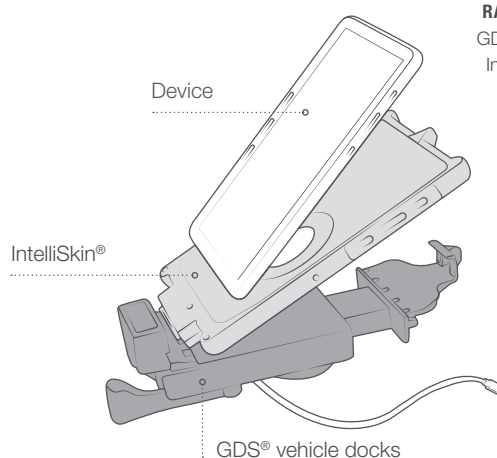

RAM-GDS-DOCK-V1CU
GDS® Vehicle Phone Dock with USB Type-C for IntelliSkin® Products



RAM-GDS-DOCKKL-V3CU
Locking Vehicle Phone Dock



RAM-GDS-DOCKKL-V2-SAM21U
GDS® Locking Vehicle Dock for Samsung Tab E 8.0



RAM-GDS-DOCKKL-V9-SAM67CU
GDS® Type-C Vehicle Dock for Samsung Tab A 8.4 & Tab A 8.0



SEEN IN THIS PHOTO:

RAM-GDS-SKIN-SAM54-NG

IntelliSkin® Next Gen for Samsung Tab Active Pro

RAM-GDS-DOCKLF-SAM54CU

Locking GDS® Cool-Dock™ with USB Type-C for Samsung Tab Active Pro

RAM-VB-195-SW2

RAM® No-Drill™ Mount for '17-21 Ford F-250 - F-550 + More



SEEN IN THIS PHOTO:

RAM-GDS-SKIN-SAM74-NG

IntelliSkin® Next Gen for Samsung Tab Active3

RAM-GDS-DOCK-SAM62CU

Locking GDS® Cool-Dock™ with USB Type-C for Samsung Tab Active3/2

GDS® VEHICLE DOCKS™ CONTINUED

GDS® TOUGH-DOCK™ & GDS® COOL-DOCK™

The GDS® Tough-Dock™ and GDS® Cool-Dock™ are the newest vehicle docks in the GDS® Tech™ line of vehicle docks designed to support select Samsung Galaxy tablets in a Next Gen IntelliSkin® protective sleeve for your fleet. Take advantage of a USB Type-C connector, supporting data sync and fast charging capabilities.



RAM-GDS-DOCKLF-SAM67U

Locking GDS® Cool-Dock™ for Samsung Tab A 8.4 SM-T307

FEATURES

1

LOCKING & NON-LOCKING
Secure your device for theft deterrence with a key locking option available for all GDS® Tough-Dock™ and GDS® Cool-Dock™ models.

2

GDS® HAND-STAND™ COMPATIBLE
The GDS® Tough-Dock™ and GDS® Cool-Dock™ have integrated space for GDS® Hand-Stand™ attachments on the back of your IntelliSkin® Next Gen-wrapped device.

3

BUILT-IN FAN
12-VDC Axial cooling fan with 2.2m long long hardwire cable and SAE quick disconnect plugs available as an upgrade, or standard with all GDS® Cool-Dock™ models.

4

STANDARD & HIGH SPEED POWER OPTIONS
All GDS® Tough-Dock™ and GDS® Cool-Dock™ models are available and support both mUSB and USB Type-C connections.

5

CONNECT YOUR KEYBOARD & OTHER PERIPHERALS
Customize your mobile workstation with peripheral add-ons that help improve your workflow. Our GDS® Ecosystem™ makes it easy to choose different peripherals designed to work perfectly with the GDS® Tough-Dock™ and GDS® Cool-Dock™.



SEEN IN THIS PHOTO:

RAM-TC-SAM29U

RAM® Tough-Case™ with USB Type A for Samsung Tab Active3 and Tab Active2

FEATURES



Ideal for ELD use



Oversized strain relief protects cable connection



Open enclosure on front and back allows heat to flow from device.

RAM® TOUGH-CASE™

The RAM® Tough-Case™ is a rugged two-piece enclosure with a built-in coiled power cable that tethers the device inside of any vehicle. This case allows you to create a hardwired connection to the tablet using a custom USB Type-C connector, with a stretch of up to 7 ft which offers maximum tablet mobility while staying connected. Your connection will remain secured and protected with the use of oversized strain relief built into the RAM® Tough-Case™ making this the ideal ELD mounting solution for current Samsung tablets.



Keeps tablet physically tethered to the vehicle

RAM-TC-SAM29U
RAM® Tough-Case™ for
Samsung Tab Active2 -
Type A Male USB



RAM-TC-SAM29U

RAM® Tough-Case™ with USB Type A for Samsung Tab Active3 and Tab Active2



RAM-TC-SAM29CU

RAM® Tough-Case™ with USB Type-C for Samsung Tab Active3 and Tab Active2



RAM-TC-SAM54U

RAM® Tough-Case™ for Samsung Tab Active Pro - Type A Male USB



RAM-TC-SAM50U

RAM® Tough-Case™ for Samsung Tab A 10.1, Tab A7 10.4 & Tab S6 LITE 10.4



RAM-TC-SAM67-387U

RAM® Tough-Case™ for Samsung Tab A 8.0 (2018) SM-T387



RAM-TC-SAM67-307U

RAM® Tough-Case™ for Samsung Tab A 8.4 SM-T307



RAM-TC-SAM67-290U

RAM® Tough-Case™ for Samsung Tab A 8.0 (2019) SM-T290

CHARGERS FOR USB TYPE-A



RAM-GDS-CHARGE-V7BU

GDS® Modular 8-40V Hardwire Charger with Female USB Type A Connector



RAM-GDS-CHARGE-USB2QCCIG

GDS® 2-Port USB Cigarette Charger with Qualcomm® Quick Charge™

POWER DELIVERY CHARGERS WITH USB TYPE-C



RAM-GDS-CHARGE-V3FCU

GDS® Hardwire USB Type-C Power Delivery Charger with Female Connector



RAM-GDS-CHARGE-V3FCAU

GDS® Hardwire Charger with USB Type-C Female Connector & USB Type A Port



RAM-GDS-CHARGE-V3FCA2U

GDS® Hardwire Charger with USB Type-C Female & Dual USB Type A Ports



RAM-GDS-CHARGE-CIGC

GDS® Type-C and Type A 2-Port Cigarette Charger



SEEN IN THIS PHOTO:

RAM-HOL-TC-SAM29FU

RAM® Tough-Case™ Holder for Samsung Tab
Active3, Tab A 8.4 & 8.0 + More with Fan



RAM® TOUGH-CASE™ CONTINUED

RAM® TOUGH-CASE™ HOLDER

To accommodate the RAM® Tough-Case™-wrapped device, an appropriate form-fit cradle snaps it into place with ports and S pen holder exposed for full access to your Samsung tablet. Equipped with a built-in fan, this holder combats high temperature environments as well as overheating. With the RAM® Tough-Case™ holder taking up minimal space, this solution is ideal for ELD mounting.

FOR TAB ACTIVE3, TAB ACTIVE2, TAB A 8.0, TAB A 8.4



RAM-HOL-TC-SAM29FU

RAM® Tough-Case™ Holder for Samsung Tab Active3, Tab A 8.4 & 8.0 + More with Fan

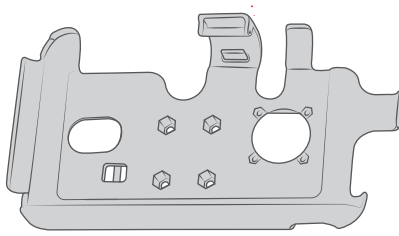

RAM-HOL-TC-SAM29U

RAM® Tough-Case™ Holder for Samsung Tab Active3, Tab A 8.4 & 8.0 + More Without fan



FOR TAB ACTIVE PRO, TAB A 10.1, TAB A7 10.4 & TAB S6 LITE



RAM-HOL-TC-SAM54FU

RAM® Tough-Case™ Holder for Samsung Tab Active Pro With Fan



RAM-HOL-TC-SAM54U

RAM® Tough-Case™ Holder for Samsung Tab Active Pro Without fan

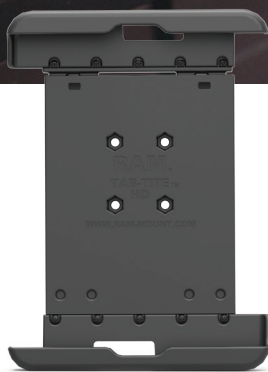

RAM-HOL-TAB29U

RAM® Tab-Tite™ Spring Loaded Holder for 8" Tablets with Cases

UNIVERSAL HOLDERS

RAM® TAB-TITE™ & RAM® TAB-LOCK™

Get the most out of your tablet with the RAM® Tab-Tite™ spring-loaded, quick release holder. With interchangeable end cups, you can fit the holder to your tablet for a near custom fit. The spring-loaded design makes it easy to insert and remove your tablet while keeping it secure.

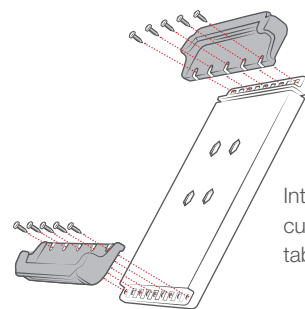

Interchangeable cups support any tablet



RAM-HOL-TAB24-CUPSU

RAM® Tab-Tite™ End Cups for 8" Tablets



RAM-HOL-TAB20U

RAM® Tab-Tite™ Holder for 9" Tablets with Heavy Duty Cases



RAM-HOL-TABL27U

RAM® Tab-Lock™ Tablet Holder for Samsung Galaxy Tab A 8.0 + More



RAM-HOL-TAB-RISER2U

1" Risers for RAM® Tab-Tite™ and RAM® Tab-Lock™ Holders



RAM-B-407-201-C-TAB3U

RAM® Tab-Tite™ with RAM® Tough-Wedge™ Mount for 10" Tablets



RAM-B-138-TAB4-225BU

RAM® Tab-Tite™ Drill-Down Mount with Backing Plate for Small Tablets



RAM-B-299-3-TAB30U

RAM® Tab-Tite™ Cup Holder Mount for Samsung Galaxy Tab S2 8.0 + More



RAM-138-TAB17U
RAM® Tab-Tite™ Large Tablet Holder with
Flat Surface Mount

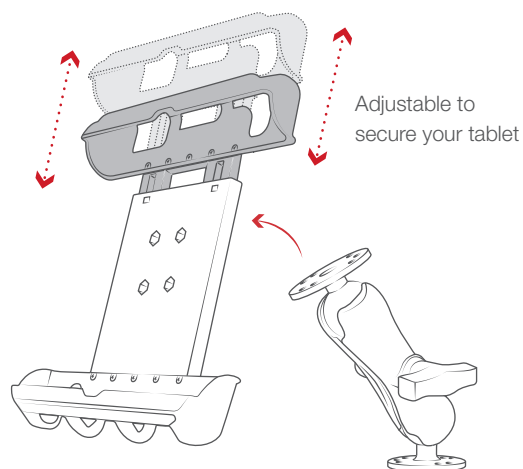

FEATURES

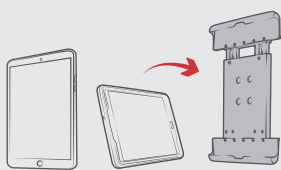

Supports tablets in portrait and
landscape mode



Made of high-strength composites
for durability and reliability in the
most demanding environments

Non-locking and locking
options available

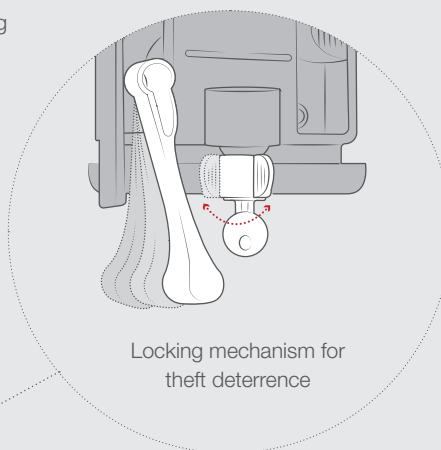
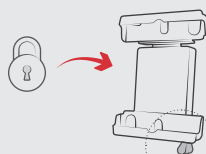
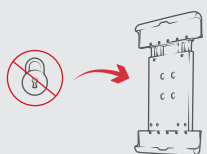



SEEN IN THIS PHOTO:

RAM-B-202-UN9U
RAM® X-Grip® Holder with
Ball for 9"-10" Tablets



RAM-HOL-UN9U

RAM® X-Grip® Universal Holder
for 9"-10" Tablets

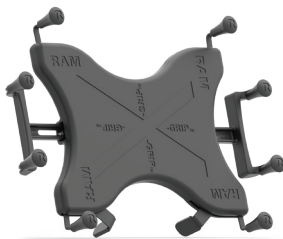

RAM-HOL-UN11U

For 11"-12" Tablets



RAM-HOL-UN8BCU

RAM® X-Grip® Universal Holder for 7"-8"
Tablets with Ball

UNIVERSAL HOLDERS CONTINUED RAM® X-Grip®

Using a tablet for in-vehicle navigation and mobile work is on the rise. The RAM® X-Grip® for Tablets holds all the benefits and design features of the standard X-Grip® with added arm support for a variety of different size tablets with, or without a case. Additional grip handles provide side support for portrait, or landscape orientation, and are completely removable. Protect your investment with the highly rugged X-Grip® and be sure these holders stand the test of time in the harshest environments.

Additional grip handles for
convenient insertion and removal

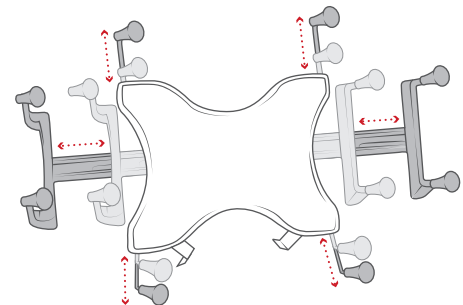

FEATURES

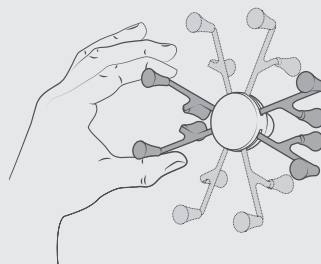

Highly adjustable to
support tablets in portrait
and landscape mode



Fits all tablets
7" - 12" with or
without a case

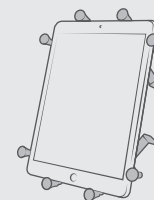

Steel spring-loaded
arms keep
tablets secure



SEEN IN THIS PHOTO:

RAP-B-299-4-UN8U

RAM® X-Grip® for 7"-8" Tablets with RAM® Stubby™ Cup Holder Base

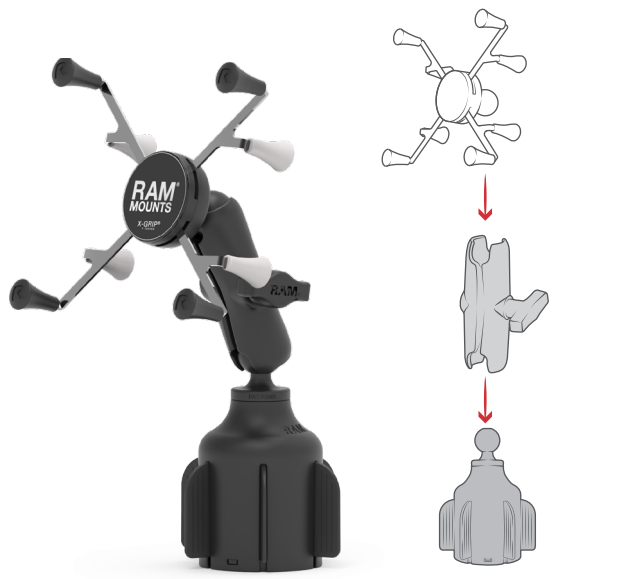

RAP-B-299-4-UN8U

RAM® X-Grip® for 7"-8" Tablets with RAM® Stubby™ Cup Holder Base



RAM-HOL-UN7B

RAM® X-Grip® Universal Small Phone Holder with Ball



RAM-HOL-UN10B

RAM® X-Grip® Universal Large Phone Holder with Ball



RAP-B-407-UN8U

RAM® X-Grip® Mount with RAM® Tough-Wedge™ for 7"-8" Tablets



RAM-B-101-C-UN9U

RAM® X-Grip® Drill-Down Double Ball Mount for 9"-10" Tablets



RAP-299-3-UN9U

RAM® X-Grip® with RAM-A-CAN™ II Cup Holder Mount for 9"-10" Tablets



SEEN IN THIS PHOTO:

RAM-VB-196-GDS-EC01

GDS® Ecosystem™ Vehicle Bundle with
Monitor, Keyboard & Phone Mount

SAMSUNG DEX IN-VEHICLE

RAM® Mounts has partnered with Samsung to support the Samsung DeX platform by enabling the system in-vehicle. Samsung DeX allows you to consolidate your workflow through a Samsung phone while RAM® Mounts allows you to transform your vehicle into a mobile workstation with the help of familiar peripherals that emulate a desktop experience.

The GDS® Ecosystem™ Bundle is the all-in-one solution for introducing Samsung DeX into your workflow. This bundle includes a GDS® View™ 13.3" touchscreen monitor, a GDS® Keyboard™, display bracket, universal vehicle mount, phone mount, and hardwire chargers to transform your vehicle into a mobile office. Simply insert your DeX-enabled Samsung phone and connect your device to the workstation so you can work on the go.

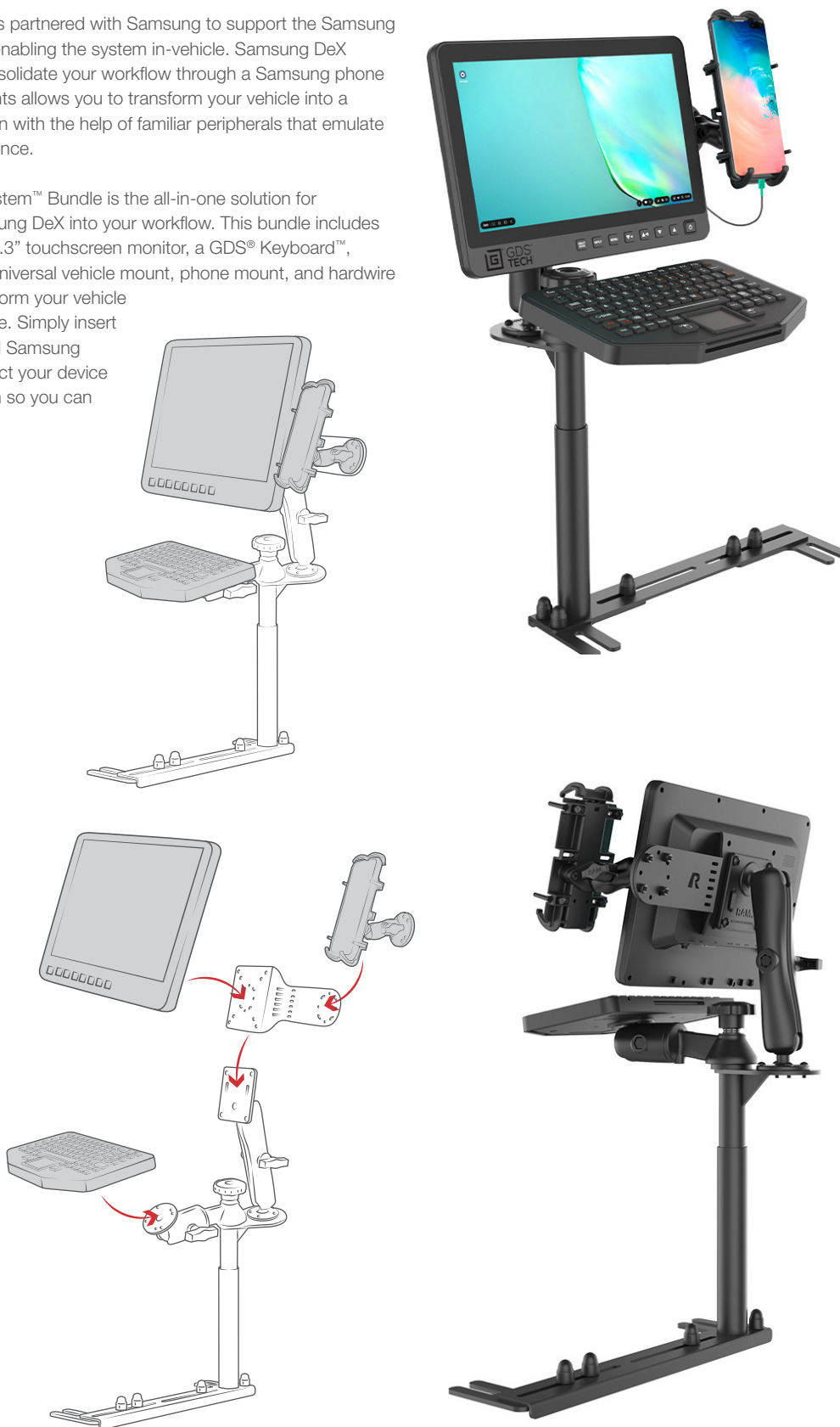

RAM-VB-196-GDS-EC01

GDS® Ecosystem™ Vehicle Bundle with Monitor, Keyboard & Phone Mount

SEEN IN THIS PHOTO:

RAM-HOL-SAM60PU

RAM® EZ-Roll'r™ Powered Dock for Samsung Tab Active3 and Tab Active2

RAM-101U-247-4

Square Post Clamp Mount





RAM-HOL-SAM59U
Non-Powered RAM® EZ-Roll'r™

RAM-B-166U
RAM® Twist-Lock™ Suction Cup Mount



RAM-HOL-SAM59U
Non-Powered RAM® EZ-Roll'r™

RAP-B-400-238U
RAM® Tough-Claw™ Mount

POPULAR RAM® MOUNTS

TABLET MOUNTS UNIVERSAL



RAM-101U-225-XAT1
Drill-Down Dashboard Mount



RAM-101U-247-4
Square Post Clamp Mount



RAP-401-202U
RAM® Tough-Claw™ Mount

TABLET MOUNTS RAM® NO-DRILL™ VEHICLE FLOOR MOUNTS



RAM-VB-203-SW2
2019-2020 Chevy Silverado



RAM-VB-178A-SW2
2012-2019 RAM 2500-5500



RAM-VB-195-SW2
2017-2020 Ford F-Series



RAM-VB-196-SW2
Universal Floor Mount

PHONE MOUNTS



RAM-B-138U
Drill-Down Double Ball Mount



RAM-B-166U
RAM® Twist-Lock™ Suction Cup Mount



RAM-B-149ZU
U-Bolt Rail Mount



RAP-B-400-238U
RAM® Tough-Claw™ Mount



RAM-B-299-4-238U
RAM® Stubby™ Cup Holder Mount



RAM-B-408-75-1-238U
RAM® Torque™ Rail Mount



RAP-B-378-238U
Flex Adhesive Double Ball Mount



RAM-B-121-238U
Yoke Clamp Double Ball Mount



Mount Anything, Anywhere

SAMSUNG

rammount.com
1.800.497.7479
sales@rammount.com



RAM® double socket arms with their distinctive Hourglass Shape are recognized globally as a symbol of the reliability, quality and durability of this line of products. The Hourglass Shape is a registered trademark of National Products Inc.



The distinctive RAM® "X-Grip®" product shape is a trademark of National Products Inc.

Printed in the USA. Please recycle.