

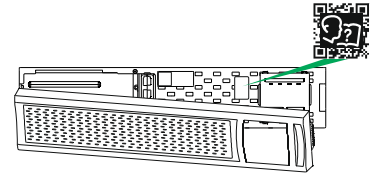

Quick Installation Guide

990-9892F – 07/2025

SMT750RM2UC, SMT1000RM2UC, SMT1500RM2UC,
SMT1500RM2UCUS, SMT2200RM2UC, SMT2200RM2UCUS,
SMT3000RM2UC, and SMT3000RM2UCUS

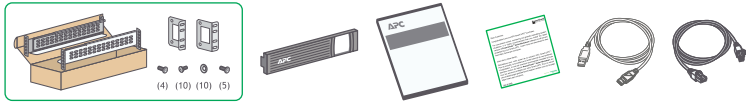

SMT750RM2UC

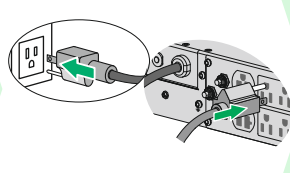
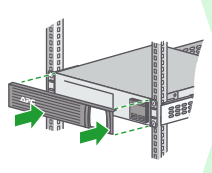
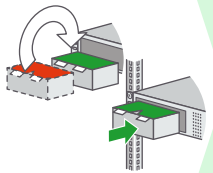
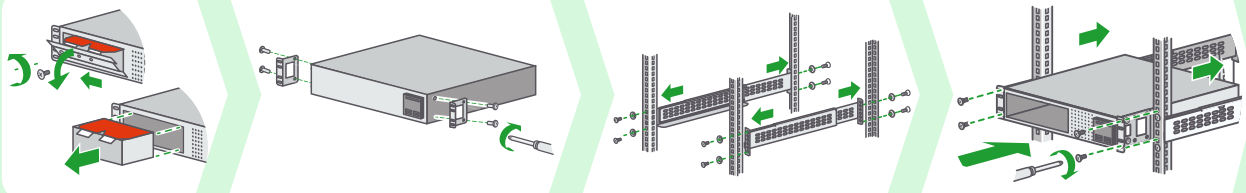

<https://smartconnect.apc.com>

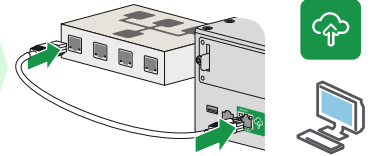

SMT1000RM2UC,
SMT1500RM2UC,
SMT1500RM2UCUS

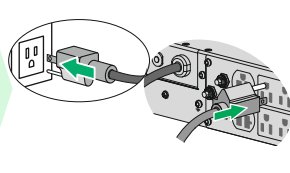
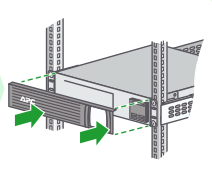
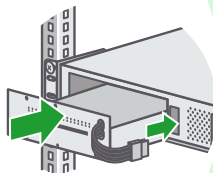
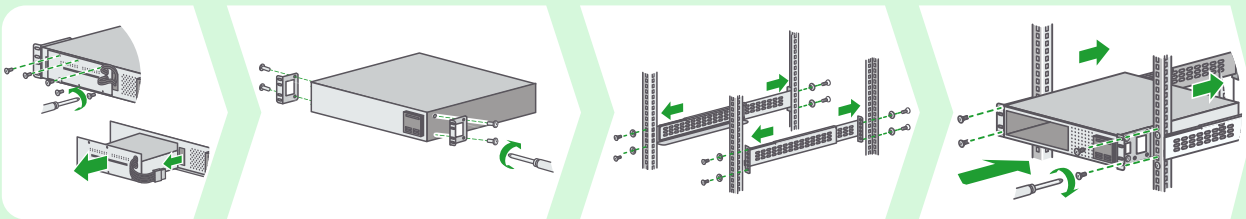

<https://smartconnect.apc.com>

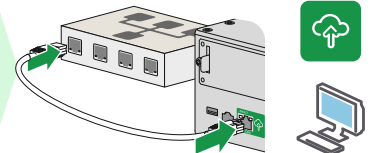

SMT2200RM2UC,
SMT2200RM2UCUS,
SMT3000RM2UC,
SMT3000RM2UCUS

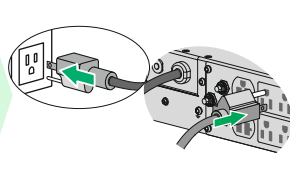
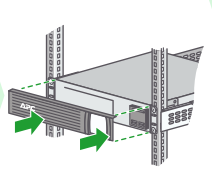
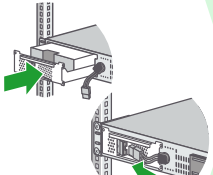
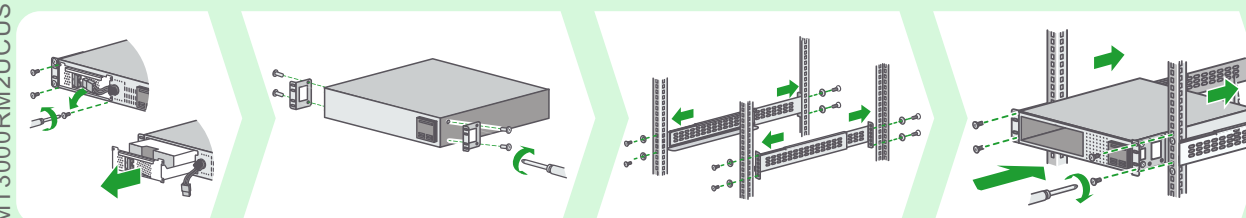

<https://smartconnect.apc.com>

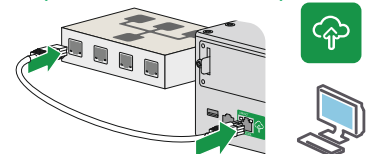



990-9892F – 07/2025

EN

Quick Installation Guide



Read the instructions carefully in Safety Guide supplied with the UPS and the operation manual “**Smart-UPS Uninterruptible Power Supply SMT750RM2UC, SMT750RM2UCNC, SMT1000RM2UC, SMT1500RM2UC, SMT1500RM2UCUS, SMT1500RM2UCNC, SMT1500RM2UCNCUS, SMT2200RM2UC, SMT2200RM2UCUS, SMT2200RM2UCNC, SMT3000RM2UC, SMT3000RM2UCUS, and SMT3000RM2UCNC 120 Vac, Rack-Mount**” (JPS29633) to become familiar with the UPS before attempting to install and operate it.

To download the user manual - scan the QR code on the UPS or use the link
<https://www.go2se.com/ref=SMT1000RM2UC/DownloadDocuments>.

- SmartConnect features include Free additional 1-year battery warranty / Remote Monitoring / Email Notifications / Firmware Updates. Availability of features varies by terms of use.
- By connecting this product to the internet using the SmartConnect Ethernet Port, you are agreeing to the APC SmartConnect Terms of use and Data Privacy Notice as found at
<https://smartconnect.apc.com/terms-and-privacy>.

© 2025 Schneider Electric. All rights reserved.

ES

Guía de Instalación Rápida



Lea atentamente las instrucciones que se encuentran en la Guía de Seguridad que viene con el UPS y el manual del usuario del «**Smart-UPS Sistema de Alimentación Ininterrumpida SMT750RM2UC, SMT750RM2UCNC, SMT1000RM2UC, SMT1500RM2UC, SMT1500RM2UCUS, SMT1500RM2UCNC, SMT1500RM2UCNCUS, SMT2200RM2UC, SMT2200RM2UCUS, SMT2200RM2UCNC, SMT3000RM2UC, SMT3000RM2UCUS, y SMT3000RM2UCNC 120 Vac, Montaje en Bastidor**» (JPS29633) para familiarizarse con el UPS antes de intentar instalarlo u operarlo.

Para descargar el manual del usuario - escanee el código QR que en el UPS o utilice el enlace
<https://www.go2se.com/ref=SMT1000RM2UC/DownloadDocuments>.

- Las características de SmartConnect incluyen 1 año de garantía adicional gratis / Monitoreo remoto / Avisos por e-mail / Actualizaciones de firmware. La disponibilidad de funciones varía según los términos de uso.
- Conectando este producto a Internet utilizando el puerto SmartConnect Ethernet, usted acepta los Términos de Uso y el Aviso de Privacidad de los Datos de APC SmartConnect, como se indican en
<https://smartconnect.apc.com/terms-and-privacy>.

© 2025 Schneider Electric. Reservados todos los derechos.

FC

Rapide Guide D'installation



Lisez attentivement les instructions du Guide de sécurité fourni avec l'UPS et le Manuel de l'utilisateur «**Smart-UPS Alimentation sans Coupure SMT750RM2UC, SMT750RM2UCNC, SMT1000RM2UC, SMT1500RM2UC, SMT1500RM2UCUS, SMT1500RM2UCNC, SMT1500RM2UCNCUS, SMT2200RM2UC, SMT2200RM2UCUS, SMT2200RM2UCNC, SMT3000RM2UC, SMT3000RM2UCUS, et SMT3000RM2UCNC 120 Vac, Montage en Rack**» (JPS29633) pour vous familiariser avec l'UPS avant d'essayer de l'installer et de le faire fonctionner.

Pour télécharger le manuel d'utilisation - scannez le code QR sur l'UPS ou utilisez le lien
<https://www.go2se.com/ref=SMT1500RM2UCNC/DownloadDocuments>.

- Les fonctionnalités de SmartConnect comprennent une garantie supplémentaire gratuite d'un an sur la batterie, la surveillance à distance, les notifications par courriel et les mises à jour du micrologiciel. La disponibilité des fonctionnalités peut varier selon les conditions d'utilisation.
- En connectant ce produit à Internet via le port Ethernet SmartConnect, vous acceptez les conditions d'utilisation et l'avis de confidentialité des données d'APC SmartConnect, telles qu'elles figurent sur
<https://smartconnect.apc.com/terms-and-privacy>.

© 2025 Schneider Electric. Tous droits réservés.