

# User Manual



## MiVue™ True 4K PRO Surround

Got a Question?

Visit [www.navman.com.au/faq](http://www.navman.com.au/faq) | [www.navman.co.nz/faq](http://www.navman.co.nz/faq) for more information

Revision: R03  
(02/2026)

## **Trademark**

All brand and product names are trademarks or registered trademarks of their respective companies.

## **Disclaimer**

Specifications and documents are subject to change without notice. Navman does not warrant this document is error-free. Navman assumes no liability for damage incurred directly or indirectly from errors, omissions, or discrepancies between the device and the documents. Visit [www.navman.com.au](http://www.navman.com.au) or [www.navman.co.nz](http://www.navman.co.nz) for the latest user manual.

## **Note**

Not all models are available in all regions.

Depending on the specific model purchased, the colour and look of your device and accessories may not exactly match the graphics shown in this document. It is recommended that you contact a skilled installer (e.g. the service personnel of the vehicle or an authorised auto technician) for assistance and installation.

## **Regulatory information**

For regulatory identification purposes, this Navman device is assigned a model number of N704. Marking labels located on the exterior of your device indicate the regulations that your model complies with. Please check the marking labels on your device and refer to the corresponding statements in this section. Some notices apply to specific models only. The user needs to switch off the device when exposed to areas with potentially explosive atmospheres such as petrol stations, chemical storage depots and blasting operations.

## **WEEE**



This product must not be disposed of as normal household waste, in accordance with the EU directive for waste electrical and electronic equipment (WEEE – 2012/19/EU). Instead, it should be disposed of by returning it to the point of sale, or to a municipal recycling collection point.

# Table of Contents

Product overview .....	4
MiVue™ dash cam .....	4
MiVue™ 2-in-1 rear cam .....	5
Using a memory card .....	6
Formatting a card .....	6
Using your dash cam in a vehicle .....	7
Precautions and notices .....	7
Mounting the dash cam .....	7
Turning the dash cam on .....	10
The Recording Screen .....	11
Changing display mode .....	12
Recording videos while driving .....	13
Continuous recording .....	13
Recording videos while parked .....	14
Camera Mode .....	15
Viewing videos and photos .....	16
Safety camera alerts .....	17
Adding a safety camera .....	17
Updating safety camera data .....	18
Premium Safety Alerts .....	18

Getting connected .....	19
Navman MiVue™ Pro .....	19
Connecting your dash cam to Navman MiVue™ Pro .....	19
Over-the-Air (OTA) updates .....	20
The Menu screen .....	21
Safety precautions.....	27
About the vehicle power adapter .....	27
About the Li-ion coin cell battery .....	28
About free & open-source software (FOSS) .....	29
Caring for your device .....	30
About GPS.....	31
Important notice .....	32
Software licence .....	32
Privacy notice .....	37
Monthly safety camera updates .....	39
Two-year limited warranty .....	39

# Product overview

---

## MiVue™ dash cam

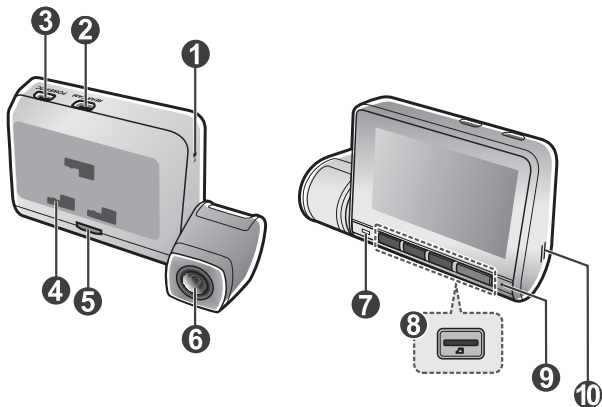

- 1 Reset button
- 2 MiVue™ rear cam connector
- 3 Power port
- 4 Mounting slot (x3)
- 5 Parking Mode indicator
- 6 Camera Lens
- 7 LED indicator
- 8 Memory card slot & function keys
- 9 Microphone
- 10 Speaker

## MiVue™ 2-in-1 rear cam

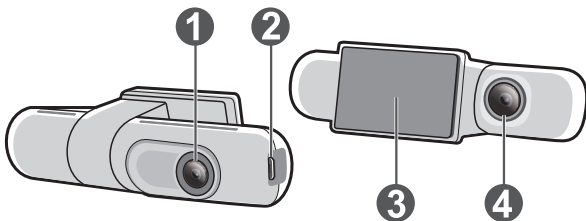

- ① Interior/side view recording camera
- ② Micro-USB connector
- ③ Mounting plate
- ④ Rear recording camera

**Note:** Screenshots and product images are for illustrative purposes only and may differ from the actual product.

## Using a memory card

---

In order to record video footage, Navman MiVue™ dash cameras need a microSD. It is very important to use a microSD card specifically designed to be used in dash cameras and for 4K Ultra HD recording. It will ensure the card will be more reliable and last longer; the wrong type of card has a greater chance of failing, even after a short period of time. Please visit [www.navman.com.au/memory-card](http://www.navman.com.au/memory-card) or [www.navman.co.nz/memory-card](http://www.navman.co.nz/memory-card) for more information on recommended SD cards.

To insert the SD card, hold it by the edges and gently insert it into the slot as shown in the illustration.

To remove the card, gently push the top edge of the card inwards to release it and pull it out of the slot.

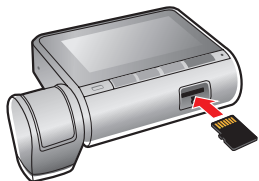

### Formatting a card

You may be required to format the memory card on first time use or when a new memory card is inserted to ensure compatibility with the dash cam system files. To format the memory card (all data will be erased), press **≡** > **SD Card** > **Format** and select **✓** to confirm.

#### Note:

- Please format the memory card before first time use or when using a new MicroSD card to avoid recording errors caused by missing system files or folders.
- DO NOT apply pressure to the centre of the memory card.
- Navman cannot guarantee product compatibility with memory cards from all manufacturers. Please always check the specifications/warranty to ensure the memory card can be used in dash cameras and loop recording devices.
- Please format the memory card to avoid recording errors caused by missing system files or folders.
- You may need to format your memory card periodically to ensure it remains in good working condition.
- You should use separate MicroSD cards for the dash cam and other electronic products (such as a digital camera).
- You are advised to disconnect the power to the device before removing the memory card.

# Using your dash cam in a vehicle

---

## Precautions and notices

- For your own safety, do not operate the controls of the product while driving. Using this product does not exempt the driver from taking full responsibility for his/her driving behaviour, which includes observing all traffic rules and safety regulations.
- Make sure the cameras are positioned in a way that does not obstruct the driver's view or airbag deployment.
- Make sure that no object is blocking the camera lens and no reflective material appears near the lens. Please keep the lenses clean.
- Video quality may be degraded if the vehicle's windscreen is tinted. If the car's windscreen is tinted with a reflective coating, its surface may be athermic and impact GPS reception. In this instance, please mount the device in a "clear area".
- The device will automatically calibrate its G-sensor during start-up. Always turn on the device after it is mounted in place to avoid G-sensor malfunction.

## Mounting the dash cam

### Note:

- The dash cam should be placed near the rear-view mirror to ensure the highest video quality, but never position the device where the driver's field of vision is blocked.
- Please note that the installation illustrations are for reference only. If you encounter problems during installation, it is recommended that you contact a service personnel or authorised auto technician for assistance and installation.

1. Before attaching the device to the windscreen, it is recommended that you clean the windscreen with rubbing alcohol to make sure the installation area is free of dust, oil and grease.

- If installing the device using an electrostatic sticker (optional), attach the electrostatic sticker to the windscreen (make sure there are no air bubbles trapped underneath).

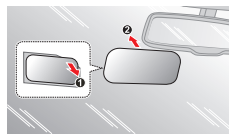

**Note:**

- If your vehicle's windscreen has a third visor frit (a patch of black dots around the rear view mirror), please do not attempt to affix the electrostatic film/dash cam in this area as it is likely to fall off.
- Attaching the device to an electrostatic sticker allows for the easy removal of the device mount from the windscreen.



- Peel the backing tape from the windscreen mount and press firmly to attach it to your windscreen (make sure the "UP" arrow is pointing upward). Fit the dash cam to the window mount by aligning the three tabs and slide the dash cam to the left until it clicks into position.

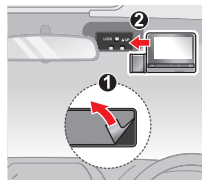

**Note:** For best results, allow at least 12 hours before attaching the device to the mount to assure a strong bond between the 3M adhesive tape and the electrostatic sticker/windscreen.

- Detach the mounting base from the MiVue™ rear cam, peel the backing tape from the mount and press it firmly to attach to the electrostatic sticker or rear window. To ensure correct orientation, the micro-USB port should be facing right when affixing the MiVue™ rear cam to the mount.

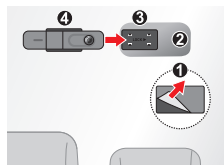

5. Connect then route the cables through the top ceiling and the A-pillar and roof lining so that it does not interfere with driving. Make sure that the cable installation does not interfere with the vehicle's airbags or other safety features.

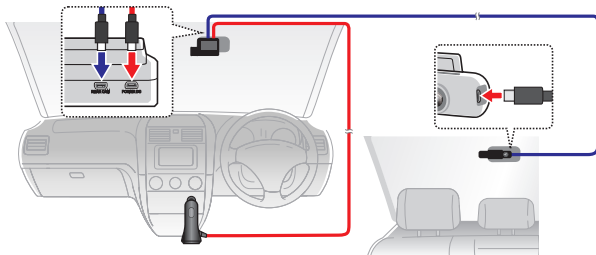

6. When adjusting the viewing angle of the dash cam and rear recording camera, make sure that the camera's view is parallel with level ground and the ground to sky ratio is close to a 50/50 split.

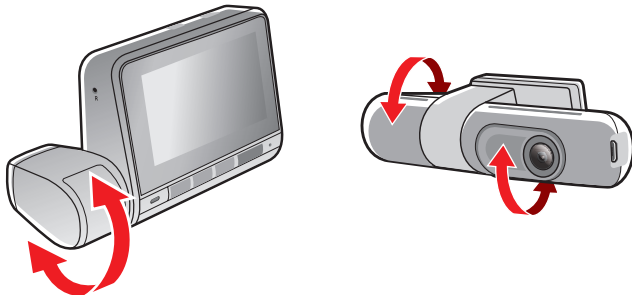

## Turning the dash cam on

---

The dash cam will turn on automatically once vehicle engine is started. When the device is powered on for the first time, follow the on-screen prompts to set the system language, time zone, and distance unit. If the screen turns off after a specified period of inactivity (video recording is still in progress), press any button to turn it back on.

If the dash cam becomes unresponsive during use, insert a pin or paperclip into the Reset button to restart the device.

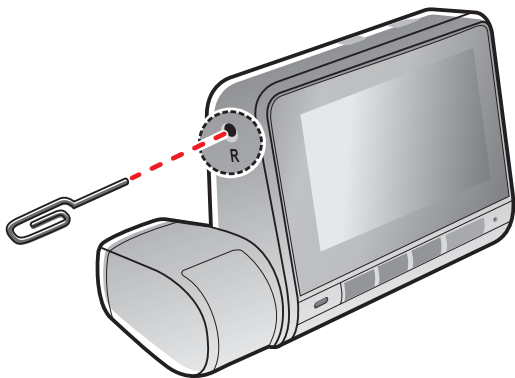

# The Recording Screen

---

The following image shows the main recording screen of the dash cam once it is booted up.

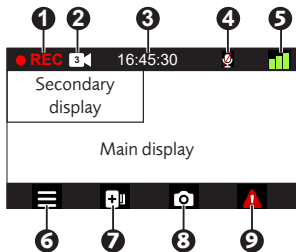

- |                            |   |
|----------------------------|---|
| ① Recording indicator      | ⑥ Opens system menu **                      |
| ② Multi-camera indicator * | ⑦ Adds a safety cam at current location *** |
| ③ Time display             | ⑧ Takes a photo ****                        |
| ④ Microphone status        | ⑨ Saves an emergency recording              |
| ⑤ GPS signal indicator     |   |

\* Only appears when the MiVue™ rear cam is connected

\*\* Press and hold to turn the device on & off

\*\*\* Press and hold to activate Parking Mode monitoring (if enabled)

\*\*\*\* Press and hold to cycle between display modes

## Changing display mode

With the MiVue™ rear cam connected, the  button can also be used to switch between display modes. Press and hold the button for three seconds to cycle through the following display modes:

- Picture-in-Picture with the dash cam image showing in the main display and rear recording camera image showing in the secondary display.
- Picture-in-Picture with the dash cam image showing in the main display and interior/side view camera image showing in the secondary display.
- Picture-in-Picture with the rear recording camera image showing in the main display and dash cam image showing in the secondary display.
- Picture-in-Picture with the interior/side view camera image showing in the main display and dash cam image showing in the secondary display.
- Single picture showing the dash cam image.
- Single picture showing the rear recording camera image.
- Single picture showing the interior/side view camera image.



# Recording videos while driving

---

## Continuous recording

Continuous recording will automatically commence shortly after the system is powered up. Recording can be paused by pressing . Press  to return to the recording screen and resume recording.



Videos taken during continuous recording are divided into multiple clips and saved under the "Normal" folder, but recording will not stop between video clips. Once the folder has reached its allocated capacity, the system will automatically record over the oldest video saved under this folder.

## Event-driven recording

During continuous recording, if a sudden event has been detected, such as running over a road bump, vehicle collision, high-speed driving, or making a sharp turn, the G-sensor will prompt the dash cam to record the event.



**Note:** The sensitivity level of the G-sensor can be adjusted by going to  > **Video Recording** > **G-sensor Sensitivity**.

Whenever event-driven recording is triggered, the video file containing the actual event, along with the files recorded right before and after the event are automatically copied to the "Event" folder. Once the folder has reached its allocated capacity, the oldest video saved under this folder is automatically overwritten.

Press  to manually activate event-driven recording while continuous recording is in progress. Press  to stop event-driven recording and resume continuous recording.

## Recording videos while parked

---

While the vehicle is parked, the dash cam can be used to monitor the vehicle's surroundings by activating Parking Mode. Videos are recorded whenever movements or vibrations are detected. Before activating Parking Mode, storage space on the memory card must be allocated to store videos recorded under this mode. Press  > **SD Card > Storage Allocation** and use  /  to select a suitable configuration. Please transfer important videos or photos to a PC or smartphone as modifying memory allocation will erase all data from the memory card.

To enable Parking Mode, press  > **Parking Mode > Detection** and select:

- **Smart Mode:** Recordings are triggered when vibrations or moving objects are detected.
- **Low Power Mode:** Vibrations trigger the dash cam to wake up and start recording. Less power is used as the dash cam is in hibernation.

The dash cam will automatically enter Parking Mode and turn off the LCD screen when the vehicle ignition is turned off. Press any button to turn the screen back on.

When operating under Smart Mode, videos are recorded only after movements or vibrations have been detected. The actual recording will start 5 seconds before and end 15 seconds after a trigger has been set off. Video recording will continue if the sensor is triggered again while recording an event. Parking Mode recordings are saved in the "Parking" folder. Once the folder has reached its allocated capacity, the system will automatically record over the oldest video saved under this folder.

To exit Parking Mode and resume continuous loop recording, press  (if necessary, press any button to activate the display first). Parking Mode will also exit automatically when vehicle ignition is turned on. You will be prompted to view any saved recordings.

**Note:** In order for the dash cam to have sufficient power to operate in this mode, the Navman Smart Box accessory (sold separately) must be installed (please consult a professional auto mechanic for installation and safety tips).

## Camera Mode

---











The dash cam can also be used as a camera to take photographs. Press  to capture a still image. Photos captured by the dash cam are stored in the "Photo" folder.

A dedicated Camera Mode can also be activated by pressing  > **Camera**.

## Viewing videos and photos

---

To view a video or photo captured by the dash cam:

1. Press  > **File Playback**.
2. Use  /  to select a folder then press  to enter the highlighted folder.
3. Use  /  to select the video or image then press  to view the file.
4. While viewing a file, press  /  to jump to the previous/next file, respectively.
5. While viewing a video, press  to perform the following actions:
  - **Play/Pause:** Plays or pauses the current video.
  - **Play (\*\*\*\*\*) Video:** Plays the corresponding video captured by the other cameras.
  - **Delete:** Deletes the current video file.
6. While viewing a photo, press  to delete or view the corresponding rear photo.

### Note:

- Transfer videos to a PC, smartphone, or media player for the best viewing experience.
- A deleted file cannot be recovered. Make sure important files are backed up.
- Videos recorded by the dash cam and MiVue™ rear cam are linked but stored in their respective folders. If one file is moved/deleted, linked files will also be processed accordingly.

## Safety camera alerts

---

**Caution:** The safety camera feature may not be available in all countries due to legal reasons.

The system can issue alerts if the vehicle is approaching a safety/speed camera to help drivers monitor their speed.

The driver will receive a visual alert on the screen as well as an audio warning (**Beep/Voice**) when there is a safety camera ahead.





If the **Safety Cam > Alert Sound** setting is set to **Beep**:

- The dash cam will beep once to alert the driver of the safety camera ahead.
- If the vehicle is travelling over the speed limit while approaching a safety camera, the driver will hear continuous beeping until the driver slows down to the proper speed.
- The dash cam will beep again once the vehicle has passed the safety camera.

### Adding a safety camera

**Note:** A custom safety camera can only be added after a GPS fix is established.

Up to 100 custom safety camera locations can be added to the built-in database. To add a custom safety camera at the vehicle's current location, press  on the recording screen. After a location has been added, the dash cam will issue alerts the next time you pass through this location.







To view detailed information on a custom safety camera, press  > **Safety Cam > Custom Safety Cam**, use  /  to select a location, then press  to view its GPS coordinates and timestamp; press  to delete the record.

## Updating safety camera data

Navman does not warrant that all types and locations of safety camera data are available as cameras may be removed, relocated or new cameras installed. Your MiVue™ dash cam may come with monthly safety camera updates via the Navman MiVue™ Pro app (for selected models only).

## Premium Safety Alerts

The system can issue alerts if the vehicle is approaching a school zone, accident blackspot, railway crossing or check speed zone to help drivers proceed with caution:

Traffic light camera	
Red light camera	
School zone	
Railroad crossing	
Accident blackspot	
Check speed zone	

# Getting connected

---

## Navman MiVue™ Pro

Videos recorded by the dash cam can be viewed, shared, and backed up using Navman MiVue™ Pro via WIFI. Search for "Navman MiVue Pro" in the Apple App Store or Google Play Store to download the app for free.

### Note:

- The Navman MiVue™ Pro app is compatible with iOS 11.0 (and above) and Android 8.0 (and above) devices. Navman does not guarantee the product's compatibility with smartphones from all manufacturers.
- Not all MiVue dash cam models support the Navman MiVue™ Pro app or all its features.

## Connecting your dash cam to Navman MiVue™ Pro

On the dash cam, press  > **Connect App** > **Connect App** to display the WIFI QR code, SSID and password of the dash cam. Follow the steps below to set up the WIFI connection between the dash cam and the smartphone via the App.

1. Make sure WIFI is enabled on the smartphone.
2. Launch Navman MiVue Pro and tap the "+" icon at the centre of the screen.
3. Select your product model.
4. Tap **Scan** to open the phone's camera and scan the WIFI QR code, or scroll down to tap the **Connect Manually** button.
5. If connecting manually, tap **Select WIFI** and select the dash cam (SSID: MiVue\_XXXXX) to proceed. Tap **Done** to complete WIFI setup.

**Note:** The instructions on how to operate a smartphone are for reference only. Actual settings and methods may vary depending on the phone type/model and app version.

## **Over-the-Air (OTA) updates**

Occasionally, Navman may offer software updates including new device firmware and monthly safety camera data. You can update the data via OTA updates in the Navman MiVue™ Pro app. When new data is available, you will be asked to update when opening the app. Follow the on-screen instructions to complete the update. For more information on Navman MiVue™ Pro's features, refer to the Navman MiVue™ Pro App Quick Start Guide.

# The Menu screen

---

Press  to access the Menu screen that includes the following device settings:

## File Playback

Plays recorded videos and photos.

## Connect App

- **Connect App:** Activates WIFI and displays WIFI settings for connecting a smartphone to the dash cam.
- **Change Password:** Changes the WIFI password.

## Sound Recording

Enables/disables audio recording during video capture.

## Camera

Activates Camera Mode for capturing still images.

## Driving Safety

The dash cam provides advanced driving safety functions to make your driving safer.

- **Calibration:** You are advised to calibrate the system regularly in order to be alerted properly. Follow the steps to calibrate the system.
  1. Drive the vehicle in the middle of the lane.
  2. Ask a passenger to perform system calibration by following the on-screen instructions.

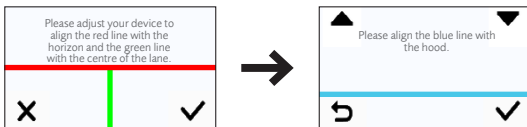

- **LDWS:** Select **Beep** or **Voice** to enable the LDWS (Lane Departure Warning System) function. The system will alert you when it detects that the GPS car speed is over 60 km/h and the car has strayed from its intended lane. The default setting is off.
- **FCWS:** Select **Beep** or **Voice** to enable the FCWS (Forward Collision Warning System) function. The system will alert you when the car moves slowly and gets too close to the car ahead. The default setting is off.
- **BCW:** Once enabled, the BCW (Back Collision Warning) function will alert you of a potential collision behind the vehicle. The default setting is off.
- **Headlight Reminder:** Once enabled, the system will remind you to turn the lights on when driving after dark.
- **Driver Fatigue Alert:** Once enabled, the system will remind you to take a break every **2/3/4** hours during a long drive.
- **Eco Drive Indicator:** Once enabled, a red/yellow/green indicator is used to represent your driving efficiency.
- **Front Departure:** Once enabled, the system will alert you when the car ahead has proceeded to move forward after idling for 10 seconds or longer.

## Safety Cam

- **Detection:** Enables/disables safety camera alerts.
- **Alert Sound:** Selects **Beep/Voice** or turns off audio alerts.
- **Alert Distance:** The system will alert you at a preset distance (**Short/Medium/Long**) when your vehicle is approaching a safety camera.
- **Alert Method**
  - **Smart Alert:** Sets the alert distance function according to the current GPS car speed.
  - **Standard Alert:** Sets the alert distance function according to the speed limit.
- **Threshold:** Sets the speed value for the dash cam to start offering alerts.
- **Cruise Speed Alert:** Sets the cruise speed limit. When you drive at a cruise speed over the set value, you will receive alerts from the dash cam.

- **Custom Safety Cam:** Lists all custom safety cameras sorted by creation timestamp.
- **Mobile SafetyCam Alert:** Enables/disables mobile safetycam alerts.

## Parking Mode

- **Detection:** When enabled, the dash cam will automatically record videos when vehicle ignition is shut off and certain events are triggered.
  - **Smart Mode:** Recording is triggered by the G-sensor, Standby Mode settings (conditions that determine Parking Mode activation), and motion detection
  - **Low Power Mode:** Recording is triggered by the G-sensor. Standby Mode settings and motion detection are turned off.
  - **Off:** Turns off Parking Mode.
- **Detection Method:** Sets the detection method to **Both Motion & G-Sensor** or **Only G-Sensor**.
- **Standby Mode:** Sets the sensitivity level (**Easy/Medium/Difficult**) for the G-sensor to activate Parking Mode. For example, when the option is set to Easy, the G-sensor will have a low sensitivity and Parking Mode can be triggered more easily (G-sensor values: Easy - 0.2G; Medium - 0.15G; Difficult - 0.1G).
- **G-Sensor Sensitivity:** Sets the sensitivity level (**Low/Medium/High**) of the G-sensor for triggering video recording during Parking Mode.
- **Motion Sensitivity:** Sets the sensitivity level (**Low/Medium/High**) of motion detection that triggers video recording during Parking Mode.
- **Motion Detection:** Enables/disables motion detection.
- **Motion Detection Area:** Sets the area of motion detection to **Whole Area** (the entire display as marked by the green rectangle) or **Main Area Only** (the main viewing area as marked by the yellow rectangle).
- **LED Indicator:** Turns the parking indicator **On** or **Off** (only applicable while operating under Smart Mode).

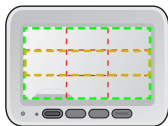

## Video Recording

- **Video Clip Length:** Sets the length of video clips captured during continuous loop recording.

SD card capacity	Length of video clip		
	1 min.	3 min.	5 min.
< 16GB	<i>Incompatible memory card</i>		
16GB	✓	✗	✗
32GB	✓	✗	✗
64GB	✓	✓	✓
128GB	✓	✓	✓
256GB	✗	✓	✓
> 256GB	<i>Incompatible memory card</i>		

- **Video Resolution:** Sets the resolution of videos captured by the dash cam.
- **Frequency:** Sets the frequency for the camera to avoid problems caused by artificial light sources that are not constant.
- **EV:** Sets the exposure level to adjust the brightness of the image.
- **G-Sensor Sensitivity:** Sets the sensitivity level of the G-sensor for triggering event-driven video recording.
- **Stamps:** Specifies the information (**Coordinates/G-Sensor**) displayed on the recorded video.
- **Speed Stamp:** Displays the driving speed on the recorded video.
- **Text Stamp:** Displays customisable text information.

## System

- **Satellites:** Displays the status of GPS signal reception.

- **Date/Time:** Sets the system date and time.

The system date and time must be correct in order for the videos to display accurate timestamps. The date and time can be configured by:

    - **Use GPS Time:** Select the appropriate **Time Zone** and **Daylight Saving Time** settings for your location.
    - **Manual:** Press **+**/**-** to adjust the highlighted value and press **→** to navigate to the next field.
  - **Welcome Sound:** Enables/disables notification sounds during device start-up.
  - **System Sound:** Enables/disables system notification sounds.
  - **Voice Command:** Enables/disables the dash cam's ability to listen for voice commands.
  - **Voice Guidance:** Displays the list of voice commands available to the user (Front View, Rear View, Screen Switch, Emergency Recording, and Sound Recording Switch).
  - **Volume:** Adjusts the volume level.
  - **LCD Standby**
    - **Always On:** Keeps the LCD on.
    - **HUD:** Activates Driving Speed Display Mode where the LCD only displays current time and vehicle speed.
    - **10 sec/1 min/3 min:** Sets the timer for the LCD to turn off automatically after recording starts.
  - **Preference Transfer**
    - **Back up to SD card:** Copies current system settings to the memory card.
    - **Restore from SD card:** Imports system settings from the memory card.
  - **POI Transfer**
    - **Back up to SD card:** Copies custom saved safety cam data to the memory card.
    - **Restore from SD card:** Imports custom saved safety cam data from the memory card.
-

- **Language:** Sets the language.
- **Distance Unit:** Sets the preferred system (**Metric/Imperial**) for measuring distances.
- **Restore to Defaults:** Restores the system to factory default settings.
- **Version:** Displays software information.

## **SD Card**

- **Storage Allocation:** The system provides several sets of memory configurations for storing videos and photos. Select the proper configuration based on your usage.
- **Format:** Formats the memory card (all data will be erased).

## Safety precautions

---

### About the vehicle power adapter

- Use only the vehicle power adapter supplied with your device. Using other vehicle power adapters may result in product malfunction and/or danger.
- This product is intended to be supplied by a LISTED Power Unit marked with "LPS", "Limited Power Source" and output rated + 5 V dc / 2.0 A.
- Do not use the vehicle power adapter in a high moisture environment. Never touch the vehicle power adapter when your hands or feet are wet.
- Allow adequate ventilation around the vehicle power adapter when connected to the device. Do not cover the vehicle power adapter with paper or other objects that will reduce cooling. Do not use the vehicle power adapter while it is inside a carrying case.
- Connect the vehicle power adapter to a proper power source. Voltage requirements are found on the product case and/or packaging.
- Do not use the vehicle power adapter if the cord becomes damaged.
- Do not attempt to service the unit. There are no serviceable parts inside. Replace the unit if it is damaged or exposed to excess moisture.

For more information on how to recycle old electronic devices, please contact your local council office. You can also visit [www.navman.com.au](http://www.navman.com.au) / [www.navman.co.nz](http://www.navman.co.nz) to view our latest trade-in offers.

## About the Li-ion coin cell battery

### **CAUTION - KEEP DEVICE AND BATTERY OUT OF REACH OF CHILDREN**

- This device contains a non-replaceable internal coin cell battery that is fixed internally. Do not attempt to disassemble, crush, puncture, or dispose the device in fire or water.
- Swallowing the battery may lead to serious injury or death in as little as two hours due to chemical burns and potential perforation of the oesophagus.
- If you suspect your child has swallowed or inserted a coin cell battery, immediately call the 24-hour Poisons Information Centre on 13 11 26 for expert advice.
- Examine the device and make sure it hasn't been forced open and components are correctly secured.
- THE LITHIUM-ION COIN CELL BATTERY CONTAINED IN THE PRODUCT MUST BE RECYCLED OR DISPOSED OF PROPERLY. IT IS HIGHLY RECOMMENDED YOU USE YOUR PRODUCT ONLY WITH THE SUPPLIED DC POWER LEAD (VEHICLE POWER ADAPTER/BATTERY CABLE) AND AC ADAPTER (HOME POWER ADAPTER) FOR POWERING THE DEVICE.

For more information on how to recycle your old electronic devices and lithium batteries, please contact your local council office.



## **About free & open-source software (FOSS)**

### **MiVue™ Pro (iOS)**

[https://service.mio.com/M0100/F0110\\_Download\\_Faq.aspx?bullid=AllBull&faqid=132924  
&Region=Rest%20of%20Europe&Language=English](https://service.mio.com/M0100/F0110_Download_Faq.aspx?bullid=AllBull&faqid=132924&Region=Rest%20of%20Europe&Language=English)

### **MiVue™ Pro (Android)**

[https://service.mio.com/M0100/F0110\\_Download\\_Faq.aspx?bullid=AllBull&faqid=132923  
&Region=Rest%20of%20Europe&Language=English](https://service.mio.com/M0100/F0110_Download_Faq.aspx?bullid=AllBull&faqid=132923&Region=Rest%20of%20Europe&Language=English)

## Caring for your device

---

Taking good care of your device will ensure trouble-free operation and reduce the risk of damage.

- Keep your device away from excessive moisture and extreme temperatures.
- Avoid exposing your device to direct sunlight or strong ultraviolet light for extended periods of time.
- Do not place anything on top of your device or drop objects on your device.
- Do not drop your device or subject it to severe shock. Installation height < 2m.
- Do not subject your device to sudden and drastic temperature changes. This can cause moisture condensation inside the unit which may damage your device. In the event of moisture condensation, allow the device to dry out completely before use.
- The screen scratches easily. Avoid touching it with sharp objects. Non-adhesive generic screen protectors designed specifically for portable devices with LCD panels may be used to help protect the screen from minor scratches.
- Never clean the device with it powered on. Use a soft, lint-free cloth to wipe the screen and the exterior of your device.
- Avoid using paper towels to clean the screen.
- Never attempt to disassemble, repair or modify your device. Disassembly, modification or any attempt at repair could cause damage to your device and even bodily injury or property damage and will void any warranty.
- Do not store or carry flammable liquids, gases or explosive materials in the same compartment as your device, its parts or accessories.
- To discourage theft, do not leave the device and its accessories in plain view in an unattended vehicle.
- Overheating may damage the device.
- Operating temperature: 60°C (Max.); Storage temperature: -20°C to 80°C.

## About GPS

---

- GPS is operated by the United States government, which is solely responsible for the performance of GPS. Any change to the GPS system can affect the accuracy of all GPS equipment.
- GPS satellite signals cannot pass through solid materials (except glass). GPS positioning is not available when you are inside a tunnel or building. Signal reception can be affected by conditions such as bad weather or dense overhead obstacles (e.g. trees, tunnels, viaducts and tall buildings).
- GPS positioning data is for reference only.

## Important notice

---

In addition to the user manual, this document contains the following terms that apply to your use of your Navman product:

### Software licence

#### 1. Generally.

Navman ("Licensor") is willing to grant the following licence (the "Licence") to use the software, if any, provided with this Software Licence and Privacy Notice (whether provided separately or associated with a device) (the "Licensed Product") to the original retail purchaser (and, subject to the limitations below, certain transferees) of the Licensed Product or the device upon or with which the Licensed Product was installed or associated as of the time of purchase (the "Customer") only if Customer accepts all of the terms of the Licence.

PLEASE READ THESE TERMS CAREFULLY. USING THE SOFTWARE WILL CONSTITUTE CUSTOMER'S ACCEPTANCE OF THE TERMS AND CONDITIONS OF THIS LICENCE. PLEASE NOTE THAT THIS LICENCE IS NOT ITSELF A LICENCE TO USE NAVIGATION DATA THAT MAY BE INCLUDED WITH A DEVICE. NAVIGATION DATA IS COVERED BY A SEPARATE LICENCE AGREEMENT. IF YOU DO NOT AGREE TO THE TERMS OF THIS LICENCE, DO NOT INSTALL OR USE THE LICENSED PRODUCT. RATHER, RETURN THE LICENSED PRODUCT (AND, IF YOU RECEIVED THE LICENSED PRODUCT INSTALLED ON A DEVICE, RETURN THE DEVICE) PROMPTLY, INCLUDING ALL PACKAGING AND WRITTEN MATERIALS, TO LICENSOR AND LICENSOR WILL REFUND TO CUSTOMER THE ORIGINAL RETAIL PRICE PAID FOR THE PRODUCT (LESS DELIVERY AND HANDLING CHARGES, WHERE PERMITTED).

#### 2. Licence Grant.

This section does not limit or affect the rights of any person under the Consumer Guarantees (as defined in section 7 below).

Licensor grants to Customer a non-exclusive licence (without right to transfer, assign, or sublicense except as stated in this Licence) to use: (a) the Licensed Product (that term being further restricted where the Licensed Product is, or contains, a work of authorship fixed in

tangible (including electronic) media to mean the single purchased copy thereof); and (b) the accompanying materials, including any manuals contained in the Licensed Product (the "Materials"), in accordance with the terms and conditions of this Licence.

### **3. Limitations on Use.**

Customer will not place, secure, or use, or permit any other person to place, secure, or use, the Licensed Product or any device associated with the Licensed Product, in a manner that limits any user or operator's view, that is likely to distract any user or operator, or that may cause accidents, personal injury, or property damage. Customer, and any user that Customer permits to use the Licensed Product or any associated device, is solely responsible for observing safe driving, operating, and other practices so as to avoid accidents or injury to persons or property. Certain functionality of the Licensed Product or the device may be dependent upon the use of hardware (sometimes called a "dongle" or "module") or software keys that enable or unlock the functionality. This Licence does not permit Customer to use any of such functionality unless Customer has also legitimately purchased or otherwise obtained the appropriate dongle, module, or software key. Each dongle, module, or software key is intended solely to enable the portion of functionality of the Licensed Product or device described in the documentation associated with the dongle, module, or software key and no other functionality.

### **4. Intellectual Property Rights.**

As between Licensor and Customer, the copyright and all other intellectual property rights in the Licensed Product and Materials (including any enhancements or modifications) are the property of Licensor. Customer must not rent, lease, reproduce, translate, adapt, vary, reverse-engineer, or modify the Licensed Product or Materials or communicate the same to any person other than in accordance with the terms of this Licence (or to the extent permitted by mandatory laws). Customer may not rent or lend the Licensed Product, or reproduce, prepare any derivative work, distribute, perform publicly, display publicly, perform by digital or other transmission, or broadcast the Licensed Product. Any rights not expressly granted in this Licence are reserved by Licensor.

## **5. Transfer of Licence.**

Customer may transfer this Licence to a subsequent transferee of the Licensed Product or the device, if any, upon which the Licensed Product is installed, provided that Customer transfers to the transferee all physical embodiments of the Licensed Product, the device upon which the Licensed Product is installed, if any, and all of the Materials, and retains no copy or part of the Licensed Product or the Materials.

Where the Licensed Product is transferred, technical support offered by the Licensor will only be available to the transferee, if the transferee provides proof of the original purchase of the Licensed Product.

## **6. Copying.**

Customer may not copy the Licensed Product or Materials except that one copy of any separate software component of the Licensed Product may be made to the extent that such copying is necessary for Customer's own backup purposes.

## **7. Liability.**

### 7.1 Interpretation - Consumer Guarantees.

In this Software Licence and Privacy Notice:

- (a) "Australian Consumer Law" has the meaning given to that term in section 4 of the Competition and Consumer Act 2010 (Commonwealth of Australia);
- (b) "Consumer" has the meaning given to that term in section 3 of the Australian Consumer Law, or section 2 of the New Zealand Consumer Guarantees Act 1993, as the context requires;
- (c) "Consumer Guarantees" has the meaning given in section 7.2 below; and
- (d) "PDH Goods or Services" means goods or services ordinarily acquired for personal, domestic or household use.

### 7.2 Consumer Guarantees

Under the Australian Consumer Law (and other similar legislation of Australian states and territories) and the New Zealand Consumer Guarantees Act 1993, certain statutory guarantees are conferred in relation to the supply of goods or services to a Consumer ("Consumer Guarantees").

### 7.3 Limitation of Liability – Consumer Guarantees.

Where you as a Consumer acquire goods and services under this Licence from Licensor:

- (a) subject to clause 7.4, in Australia or New Zealand, where the goods or services are PDH Goods or Services, the operation of the applicable Consumer Guarantees cannot be, and are not in this Licence, excluded, restricted or modified; or
- (b) in Australia (or if Consumer Guarantees are otherwise conferred in relation to goods and services by Australian law), where the goods or services are not PDH Goods or Services, Licensor limits its liability for a failure to comply with any Consumer Guarantee (other than where to do so would otherwise cause all or part of this clause to be void) to (at Licensor's option): (i) in the case of goods, repairing or replacing the goods or paying the cost of having the goods repaired or replaced; and (ii) in the case of services, re-supplying the services or paying the cost of having the services re-supplied, and Licensor does not exclude or limit the operation of the Consumer Guarantees under any other provision of this Licence or in any other manner and you agree it is fair and reasonable in all the circumstances for Licensor's liability to be so limited.

To the extent permitted by law and except for the Consumer Guarantees, Licensor excludes from this Licence all representations, guarantees, conditions, warranties, rights, remedies, liabilities and other terms that may be conferred or implied by statute, general law or custom, in fact or otherwise, except any guarantee, implied term or right conferred under any legislation (including the Australian Consumer Law and the New Zealand Consumer Guarantees Act 1993), the exclusion of which would contravene legislation or cause part or all of this clause to be void.

### 7.4 Business Supplies in New Zealand

In New Zealand, where both Licensor and Customer are 'in trade' and Customer is acquiring the goods and services for the purposes of a business, then both Licensor and Customer acknowledge and agree that the statutory guarantees and implied terms, covenants and conditions contained in the New Zealand Consumer Guarantees Act 1993 are excluded to the fullest extent permitted by law and do not apply, and Licensor does not exclude or limit the operation of the Consumer Guarantees under any other provision of this Licence or in any other manner and you agree it is fair and reasonable in all the circumstances for Licensor's liability to be so limited.

### 7.5 Limitation of Liability – General.

To the extent permitted by law and except for any liability under the Consumer Guarantees: (a) the Licensor will not, under any circumstances, be liable under the law of tort, contract, or otherwise for any loss of profits or loss of data or any indirect or consequential loss or damage, however caused, arising out of or in connection with this Licence; (b) the Licensor's aggregate liability for all claims arising out of or in connection with this Licence will be limited to the total amount actually and originally paid at retail by the customer for the Licensed Product; and (c) without limiting the foregoing or any other limitation of liability or disclaimer contained in this Software Licence and Privacy Notice, all limitations and disclaimers contained in the product warranty or any limited warranty for any product sold in connection with the Licensed Product also apply to this Licence.

### **8. Termination.**

Licensor may, in addition to any other remedies available to Licensor, terminate this Licence immediately if Customer breaches any of its obligations under this Licence.

### **9. Product warranty.**

The warranty for the Licensed Product is set out in the warranty documentation provided with the Licensed Product or the device on which the Licensed Product is installed (subject to any exclusions and limitations set out in this document), and applies in addition to this Licence and to any rights that you have under the Consumer Guarantees.

### **10. Governing Law and interpretation.**

Where the Licensed Product was acquired by the original retail purchaser in Australia, this Licence is governed by the laws of New South Wales, the parties submit to the non-exclusive jurisdiction of the courts of New South Wales. Where the Licensed Product was acquired by the original retail purchaser in New Zealand, this Licence is governed by the laws of New Zealand, the parties submit to the non-exclusive jurisdiction of the courts of New Zealand. The term "Navman" refers to MiTAC Australia Pty Ltd of Unit 5, 43-51 College Street, Gladesville, NSW 2111, Australia.

## **Privacy notice**

### **Location Information**

The Navman device and software a customer uses may, by its nature and function, create, contain, receive, store, or transmit location based information that, either alone or in combination with other information, could identify a person, establish a person's whereabouts, reveal the nature or type of places that a person visits or in which a person is interested, or identify a person's movements, habits, and other information about a person ("Location Information"). This Location Information is used to provide location related services to customers. For this purpose, Navman\* may disclose Location Information to its related companies, service providers, and agents which may be located overseas in countries including the USA, China, Taiwan, Australia, New Zealand and the Philippines. Except as explained below in relation to country location when using connected device features, it is Navman's policy not to collect or store Location Information, or to provide Location Information to unaffiliated third parties or persons who are not agents or service providers of Navman, without first receiving the consent of the customer (such as where the customer subscribes to, or directly or indirectly requests, location-based or similar services from Navman or a third party). Notwithstanding this clause, if, and to the extent that, a court order, subpoena, or rule of law requires that Navman disclose Location Information to a third party, Navman reserves the right to comply with such court order, subpoena, or rule of law.

### **Connected Device Information**

If a customer accesses the Navman connected device feature (or a similar feature) from a website or mobile device, Navman may collect personal information about the customer through the connected device, such as username, email address, social networking account username (if the customer chooses to connect to its social networking account), what country the customer is located in when using the device (but not other Location Information), and internet protocol address, ("Connected Device Information"). Connected Device Information may be automatically synced between the customer's compatible and connected devices. When a customer uses the connected device feature, Location Information and dash cam recordings pass temporarily through our cloud infrastructure and to your device for the purpose of providing that service to you. However, we do not collect or store this data (except country location as explained above), even temporarily.

Navman will use this information to fulfil the customer's requests for products and services, for communication, to offer products or services related to the customer's location (including by providing information about local businesses onto the customer's Navman device), interests and preferences and to assist Navman in its development of products and services. Connected Device Information may be provided to Navman's related companies, agents and third party service providers to enable Navman to deliver programs, products, information and services and to maintain Navman's websites, mailing lists and other services. The recipients that Connected Device Information is provided to may be located in different countries to that in which the customer is based, including in the USA, China, Taiwan, Australia, New Zealand and the Philippines. The third parties that data is provided to may include social media providers if the customer has linked the connected device feature to a social media account. Connected Device Information will not be transferred to third parties that are not acting on behalf of Navman without the customer's consent unless required by law or for the purposes disclosed in this clause. The customer may choose not to provide Connected Device Information to Navman, but this may cause certain features of the connected device to be unavailable.

### **Information Storage**

Any Location Information or Connected Device Information will be collected and held by CloudMade Inc., 1370 Willow Road, Menlo Park, CA 94025, USA (a third party company who provides cloud services to us), MiTAC Australia Pty Ltd, Unit 5, 43-51 College Street, Gladesville, NSW 2111, Australia. Navman will take reasonable steps to secure any Location Information or Connected Device Information about the customer.

### **Access, correction and complaints**

The customer may request to see a copy of the Location Information or Connected Device Information held by Navman about the customer, and can request corrections to be made to the Location Information or Connected Device Information. Navman's privacy policy contains information about how a customer may exercise their rights under the foregoing sentence, how a customer may complain about any breach of privacy laws or applicable codes, and how Navman will deal with such a complaint. Navman's privacy policy is available at <https://www.navman.com.au/privacy>.

\* In this Privacy Notice, the term "Navman" means MiTAC Australia Pty Ltd (an entity registered in Australia and New Zealand and trading as Mitac Professional Solutions, Magellan GPS Technology, MIO TECHNOLOGY and NAVMAN TECHNOLOGY).

## **Monthly safety camera updates**

Navman's "Monthly Safety Camera Updates" entitles you to receive up to 12 safety alert updates annually, when and as such updates are made available from the Navman server. It is only applicable for this specific Navman product its useful life expires or Navman no longer receives safety alert data from its third party supplier, whichever occurs first.

Updates are not transferable to other Navman or alternative products. The updates you receive will be updates to the same geographic map data originally included with your Navman product when originally purchased. Full terms and conditions are available at [www.navman.com.au](http://www.navman.com.au) / [www.navman.co.nz](http://www.navman.co.nz) or by contacting Customer Support.

You may need to use an appropriate connection to a WIFI enabled device with Navman MiVue™ Pro installed and Internet connection required. Android and iOS compatible. Only preloaded data sold with your device can be updated under this offer.

## **Two-year limited warranty**

The two-year limited warranty applies separately to your use of the product, and should be read independently of the other terms contained in the user manual.

### **1. Scope.**

Our goods come with guarantees that cannot be excluded under the Australian Consumer Law and the New Zealand Consumer Guarantees Act 1993. You are entitled to a replacement or refund for a major failure and for compensation for any other reasonably foreseeable loss or damage. You are also entitled to have the goods repaired or replaced if the goods fail to be of acceptable quality and the failure does not amount to a major failure.

Where a product is comprised of both hardware and software and a separate software licence is provided with the product, the terms of the software licence apply to the software and this limited warranty applies only to the hardware portion of the product. This section does affect any rights you may have under the Consumer Guarantees (as defined below).

This warranty is issued by MiTAC Australia Pty Ltd ("Navman"), in Australia and New Zealand.

## **2. Warranty.**

Apart from any rights that you may have because of the Consumer Guarantees (as defined below), Navman warrants to the original end-user retail purchaser from an authorized Navman dealer that this product will be free from defects in material and workmanship and (where a User Manual is provided) will substantially conform to the specifications and descriptions in the User Manual for the Warranty Period. The "Warranty Period" is two years from the date of original retail purchase in Australia and New Zealand, as supported by a complete, legible and dated copy of the original sales receipt.

## **3. Exclusions and Limitations.**

This section sets out exclusions and limitations which apply to the warranty. It does not affect the rights of any person under the Consumer Guarantees (as defined below). This warranty does not cover any non-rechargeable batteries, finishes, service performed or attempted by anyone other than an authorised Navman Service Centre, installations or defects caused by improper installation, any products, components or parts not manufactured by Navman, any claim in relation to infringement of any patent, trademark, copyright or other proprietary right, including trade secrets, any damage or failure of the product caused by shipping, misuse, tampering, abuse, negligence, wear and tear in excess of that expected from normal consumer use, unauthorised attachments or modification, failure to maintain as recommended, electrical discharges (including lightning), exposure to water (except as otherwise stated in the User Manual), moisture or liquids, proximity or exposure to heat, disasters such as fire, flood, wind, and lightning, or failure of availability or reliability of any external resource necessary or useful for the product's operation (for example, and to the extent applicable, the global positioning system constellation of satellites and their transmissions; traffic, weather, navigation, point-of-interest, or other data; and radio-frequency or other wired or wireless signals, whether transferring data or otherwise). Improper or incorrectly performed maintenance or repair, commercial use, or alteration or removal of any serial number or the opening, dismantling or repair of this product by anyone other than an authorised Navman Service Centre each will void this warranty. To the extent that the product is used or useful for navigation: (a) the product, including any associated electronic charts or maps, navigation data, or radio or other services, is a supplement to other navigational resources and not a replacement of them; (b)

the product does not replace any charts, maps, or other information required by law to be used for any activity (such as nautical or aeronautical charts); (c) errors and omissions are inevitable; (d) the user is responsible for cross-checking the product against other sources of navigation information; and (e) Navman recommends having back-up navigation tools available in the event that the product becomes inoperable.

#### **4. Remedies and How to Obtain Warranty Service.**

If the product is defective or fails to conform with the warranted specifications, and you send the product and all other required information and materials to Navman, or return it to the retail outlet from which it was purchased, on or before the last day of the Warranty Period (refer to steps 1 to 3 below), Navman will repair or replace the product at its own discretion). This is your remedy for defective or non-conforming products under Navman's warranty. You may have other rights or remedies under applicable laws (including under the Consumer Guarantees, as defined below).

To obtain your warranty service:

1. Contact Navman to obtain a Return Materials Authorisation number (RMA). You can reach Navman using the details below or through your authorised Navman dealer.
2. Pack the product, a copy of your dated purchase receipt, your address and telephone number, and any other information Navman requests as part of the return authorisation process (such as any return authorisation form you received) in sturdy packing material.
3. Ship the product and other required items to Navman at the address specified below, or return it to the retail outlet from which it was purchased, on or up to the end of the Warranty Period. You should retain proof of shipping to evidence the date of shipment. Please send the item by registered post for tracking purposes.

Please provide the following information when returning your product:

Name: ..... Address: .....

Phone: ..... Email: .....

## Contact Details:

### In Australia:

Attention: Navman Repairs  
RMA No. .... (Required)  
Locked bag 5010  
Gladesville NSW 1675  
Phone: 1300 628 626  
Email: pcnsupportaus@navman.com.au

### In New Zealand:

FREIGHTWAYS GLOBAL LOGISTICS  
(NZC INTERNATIONAL)  
Attention: Navman Repairs  
RMA No. .... (Required)  
616 Oruarangi Road  
Mangere  
Auckland 2022  
Phone: 0800 466 286  
Email: pcnsupportaus@navman.com.au

RMA number (compulsory - please contact support for your RMA number). If an RMA is not obtained before sending the unit in for repair, the unit will be quarantined and this will add to the repair turnaround time by at least one week.

You must pay for shipping and insurance to get the product to Navman at the applicable address. Except where otherwise provided by Consumer Guarantees (as defined below), you assume all risk of loss or damage to the product until it arrives at Navman's facility. Navman will pay for ground shipping of a new or repaired product back to you at an address in the same country as the repair facility and assume all risk of loss or damage to the product until it arrives at the address you specify. You must request and pay for expedited shipping. Repairing the product may result in data loss. Navman will not be responsible for the loss or alteration of any user data stored in the product. You should back up or otherwise preserve any such data before sending the product to Navman. Except where otherwise required by Consumer Guarantees (as defined below in this document), if Navman reasonably determines that the product has not failed to meet the standards of the warranty, you will be liable for the cost of return shipment, Navman may require payment of such costs before returning the product, and the risk of loss or damage will remain with you notwithstanding Navman's possession of the product. The Warranty Period will stop on the day you send the product to Navman. The remainder of the Warranty Period will resume when the repaired or replacement product arrives at the address you specify.

## **5. Applicable Law.**

Where the product was acquired by the original retail purchaser in Australia, this limited warranty is governed by the laws of New South Wales. Where the product was acquired by the original retail purchaser in New Zealand, this limited warranty is governed by the laws of New Zealand.

## **6. Consumer Guarantees**

### 6.1 Interpretation.

In this two-year limited warranty:

- (a) "Australian Consumer Law" has the meaning given to that term in section 4 of the Competition and Consumer Act 2010 (Commonwealth of Australia);
- (b) "Consumer" has the meaning given to that term in section 3 of the Australian Consumer Law, or section 2 of the New Zealand Consumer Guarantees Act 1993, as the context requires;
- (c) "Consumer Guarantees" has the meaning given below; and
- (d) "PDH Goods or Services" means goods or services of a kind ordinarily acquired for personal, domestic or household use or consumption.

### 6.2 Consumer Guarantees

Under the Australian Consumer Law (and other similar legislation of Australian states and territories) and the New Zealand Consumer Guarantees Act 1993, certain statutory guarantees are conferred in relation to the supply of goods or services to a Consumer (Consumer Guarantees).

In addition to the warranty, you may also have other rights under the Consumer Guarantees which cannot be excluded, restricted or modified by agreement. This warranty does not exclude, restrict or modify the application of any condition, warranty, guarantee, right or remedy conferred by or implied under any provision of any statute where to do so would: (a) contravene that statute or (b) cause any part of this clause to be void.

Where you as a Consumer acquire goods and services to which this warranty relates:

- (a) subject to clause 6.3, in Australia or New Zealand, where the goods or services are PDH Goods or Services, the operation of the applicable Consumer Guarantees cannot be, and are not in this warranty, excluded, restricted or modified; or

(b) in Australia (or if Consumer Guarantees are otherwise conferred in relation to those goods and services by Australian law), where the goods or services are not PDH Goods or Services, Navman limits its liability for a failure to comply with any Consumer Guarantee (other than where to do so would otherwise cause all or part of this clause to be void) to (at Navman's option): (i) in the case of goods, repairing or replacing the goods or paying the cost of having the goods repaired or replaced; and (ii) in the case of services, re-supplying the services or paying the cost of having the services re-supplied, and Navman does not exclude or limit the operation of the Consumer Guarantees under any other provision of this warranty or in any other manner and you agree it is fair and reasonable in all the circumstances for Navman's liability to be so limited.

### 6.3. Business Supplies in New Zealand

In New Zealand, where both Navman and you are 'in trade' and you are acquiring the goods and services for the purposes of a business, then both Navman and you acknowledge and agree that the statutory guarantees and implied terms, covenants and conditions contained in the New Zealand Consumer Guarantees Act 1993 are excluded to the fullest extent permitted by law and do not apply, and Navman does not exclude or limit the operation of the Consumer Guarantees under any other provision of this warranty or in any other manner and you agree it is fair and reasonable in all the circumstances for Navman's liability to be so limited.

### **7. Disclaimers and Other Provisions**

To the extent permitted by law and except for the Consumer Guarantees and the warranty described above, Navman excludes all representations, guarantees, conditions, warranties rights and remedies, liabilities and other terms that may be conferred or implied by statute, general law or custom, in fact or otherwise except any guarantee, implied term or right conferred under any legislation (including the Australian Consumer Law and the New Zealand Consumer Guarantees Act 1993), the exclusion of which would contravene legislation or cause part or all of this clause to be void and the customer acknowledges that Navman does not warrant that the operation of the product will be continuous or error-free.

Except for liability for a breach of a Consumer Guarantee (a) Navman will not, under any circumstances, be liable under the law of tort (including negligence), contract, or otherwise for any profit or data loss or any indirect or consequential loss or damage, however caused,

arising out of or in connection with the product; (b) Navman's aggregate liability for all claims arising out of or in connection with the product will be limited to the total amount actually and originally paid at retail by the customer for the product.

## **8. Privacy Notice**

We collect the personal information you provide when you obtain this warranty and if you make a warranty claim to provide the warranty and any warranty service. We collect this information either directly from you or from the agent which handles our warranty claims.

We may disclose your personal information to: (i) the agent which handles our warranty claims; (ii) our related companies, our employees and agents; (iii) anyone required or authorised by law; and (iv) anyone else you authorise. These recipients may be located overseas including in Australia, New Zealand, Taiwan, the USA, China and the Philippines.

Our policy on the collection, use and disclosure of your personal information is set out in our Privacy Policy available at <https://www.navman.com.au/privacy>. Our policy contains details about how to access or correct the personal information we hold and how to file a complaint about a privacy breach and how we will handle such a complaint.

## **9. Disclaimer**

In the event of improvements to the product, and software, or in limited circumstances where events occur outside Navman's control, specifications and documents may be subject to change without notice. While Navman has taken reasonable care to ensure the accuracy of this document, due to circumstances outside of Navman's control, Navman cannot warrant this document is at all times error-free.

## **10. Notes**

Not all models are available in all regions. Depending upon the specific model purchased, the colour and look of your device and accessories may not exactly match the graphics shown in this document. The screenshots and other presentations shown in this document are for reference only. They may differ from the actual screens and presentations generated by the actual product.