

Control **iD**

**Product  
Catalog**



# Index

ACCESS CONTROL	PG.
iDFace Max Access Controller	06
iDFace Access Controller	08
iDAccess Access Controller	10
iDAccess Nano Access Controller	12
iDAccess Nano Prox Access Controller	14
iDAccess Pro Access Controller	16
iDAccess Pro Prox Access Controller	18
iDFlex Pro Access Controller	20
iDFlex Pro Prox Access Controller	22
iDFlex Lite Access Controller	24
iDFlex IP65 Access Controller	26
iDFlex IP65 Prox Access Controller	28
iDFit 4X2 Access Controller	30
iDTouch Access Controller	32
IDUHF Access Controller	34
IDUHF Lite Access Controller	36
IDBox Controller Board	38
iDProx Compact and iDProx Slim Proximity Readers	40
TURNSTILES	
iDBlock Next turnstile with iDFace Max	42
iDBlock Next turnstile with iDFace	46
Catraca iDBlock Next	50
iDBlock Next BQC turnstile with iDFace Max	52
iDBlock Next BQC turnstile with iDFace	56
Catraca iDBlock Next BQC	60
iDBlock Facial Turnstile	62
iDBlock Facial Mini Turnstile	64
iDBlock turnstile	66
iDBlock QR Code Turnstile	68
iDBlock Articulated Arm Ratchet	70
iDBlock Facial Recliner for People with Disabilities	72

	PG.
iDBlock PCD Turnstile	74
iDBlock Turnstile Facial Recognition Counter	76
iDBlock Countertop Turnstile	78
TOURNIQUET	
FET-100 turnstile	80
ELECTRONIC SECURITY ACCESSORIES	
Accessories for Access Control	82
iDConnect Wireless Ethernet Router	84
iDPower Timed Charger	86
iDProx USB Proximity Reader	88
SOFTWARE - ACCESS CONTROL	
iDSECURE Cloud	90
TIME AND ATTENDANCE CONTROL	
REP iDClass Facial	94
REP iDClass	96
SOFTWARE - TIME AND ATTENDANCE CONTROL	
RHiD Time and Attendance Software	98
COMMERCIAL AUTOMATION	
Print iD Touch Thermal Printer	102
SAT Fiscal SAT iD	104
iDBio Biometric Reader	106

# CONTROL ACCESS





iDFace Max Access  
Controller with Facial Recognition

With a modern design and elegant finish, the iDFace Max is the ideal device for monitoring and controlling the entry and exit of people using facial recognition technology. Its advanced algorithm and high-quality cameras allow the identification of up to 100,000 faces (1:N) with live face detection and identification of users with and without masks. For communication, the device has an integrated SIP intercom\* and features TCP/IP, USB, Wi-Fi\*, and Bluetooth\* connections. In addition, its large 7" touchscreen LCD display enables easy and intuitive navigation for configuring access rules and viewing reports.

- 7" touchscreen display
- Identification of up to 100,000 faces with live face detection\* IP65 protection rating
- Customized access rules by groups and schedules
- Integrated SIP intercom\* TCP/IP, USB, Wi-Fi\* and Bluetooth\* communication

\*As per model

MODELS (NCM 85437099)

IDFMAX/FP/A Facial Recognition + Proximity 125 kHz ASK	LIC/IDFACE/50K Upgrade license for 50,000 Faces
IDFMAX/FP/M Facial Recognition + MIFARE proximity	LIC/IDFACE/100K Upgrade license for 100,000 Faces



iDFace Max  
Access Control with Facial Recognition

TECHNICAL SPECIFICATIONS

ACCESS CONTROL

Number of Users: Capacity for over 200,000 registered users. Number of Faces: Capacity for up to 100,000\* faces with live face detection. Access Rules: Release rules according to schedules and departments.

Door Control  
Through the external drive module and/or internal relay.

Sensors and Pushbutton:  
1 pushbutton input on the drive module; 1 input for open door sensor on the drive module.

Output Relay: 1  
internal relay and 1 in the drive module, up to 30VAC/5A.

Wiegand 1-port input  
on the drive module.

Wiegand 1-port  
output on the drive module.

COMMUNICATION

- Ethernet 1  
porta Ethernet 10/100Mbps nativa
- USB  
1 USB Host 2.0 port
- OSDP  
Supports OSDP protocol as a Peripheral Device via RS-485 interface
- Wi-Fi  
Integrated Wi-Fi communication (optional)
- GPRS  
GPRS connection module (optional)
- SIP Intercom  
Integrated SIP intercom compatible with G711 (Pro version)

METHODS OF IDENTIFICATION

- Facial Recognition  
Two 1080p HD cameras (visible light and infrared light)
- Proximity Cards (as per model)  
Tecnologias MIFARETM/ 125 kHz ASK or HID
- Password  
User identification via numeric password
- QR Code  
User identification via QR Code

USER INTERFACE

- Tela LCD Touchscreen  
7" (800x1280) color TFT LCD display with capacitive touchscreen.
- Integrated Web Software  
Complete browser-based access control management software
- Audio  
Built-in speaker and microphone



GENERAL CHARACTERISTICS

- Overall dimensions  
119.4 mm x 34.6 mm x 247 mm (W x D x H) - Terminal 52 mm x 52 mm x 22 mm (W x D x H) - Actuation Module External
- Equipment weight 950g -  
Terminal 35g -  
External Drive Module
- Power supply:  
External 12V 2A power supply or PoE (IEEE802.3af)
- IP65 protection rating

Time and Attendance Control  
Collector compatible with RHid software (REP-P) as per MTP Ordinance 671/2021

INTERCONNECTION DIAGRAM

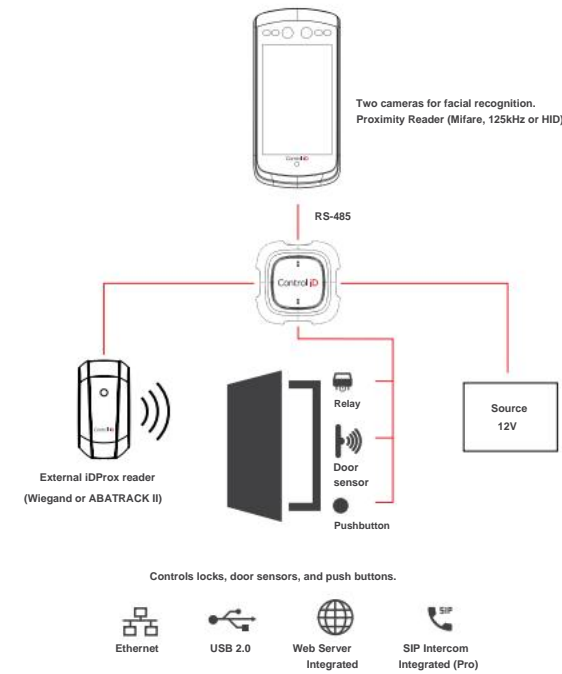

iDFace Facial Recognition  
Access Controller

With a modern and innovative design, iDFace is the ideal device for to monitor and control entry and exit. of people through facial recognition technology. Its algorithm High quality allows for the detection of live faces, authenticating masked users, and identifying up to 10,000 faces. (1:N)\*. For communication, the device has an integrated SIP intercom\* and features TCP/IP, USB, Wi-Fi\*, and Bluetooth\* connections. Additionally, the device has a 3.5” touchscreen display and embedded web software that facilitates the management of access rules and the viewing of reports.

- Customized access rules by group and time.
- 3.5” Display touchscreen
- Integrated SIP intercom\*
- IP65 Protection Rating
- TCP/IP, USB, Wi-Fi\* and Bluetooth\* communication;
- Identification of up to 10,000 faces with live face detection\*

\*As per model

MODELS (NCM 85437099)

<b>IDFACE/FP/A</b> Facial Recognition (3,000 faces) + Proximity 125 kHz ASK	<b>IDFACEPRO/FP/M</b> Facial Recognition (10,000 faces) + SIP + MIFARE™ Proximity
<b>IDFACE/FP/M</b> Facial Recognition (3,000 faces) + MIFARE™ Proximity	<b>IDFACE/FP/H</b> Facial Recognition (3,000 faces) + Proximity HID
<b>IDFACEPRO/FP/A</b> Facial Recognition (10,000 faces) + SIP + Proximity 125 kHz ASK	<b>IDFACEPRO/FP/H</b> Facial Recognition (10,000 faces) + SIP + HID Proximity



iDFace  
Access Controller  
Facial Recognition

TECHNICAL SPECIFICATIONS

ACCESS CONTROL

- Number of Users  
Capacity for over 200,000 registered users.
- Number of Faces  
Capacity for up to 3,000 (Lite)/10,000 (Pro) faces with live face detection.
- Access Rules  
Release rules according to schedules and departments.
- Door Control  
Control via external drive module
- Sensors and Pushbuttons  
1 push-button input  
1 input for open door sensor
- Output Relay  
1 internal relay in the drive module, up to 30VAC/5A
- Wiegand Entrance  
1 native port
- Wiegand Exit  
1 native port

COMMUNICATION

- Ethernet  
1 native 10/100Mbps Ethernet port
- USB  
1 porta USB Host 2.0
- RS-485  
One RS-485 port for communication between the external drive module and the terminal.
- Wi-Fi  
Integrated Wi-Fi communication (optional)
- GPRS  
GPRS connection module (optional)
- SIP Intercom  
Integrated SIP intercom (Pro version)

METHODS OF IDENTIFICATION

- Facial Recognition  
Two 1080p HD cameras (visible light and infrared light)
- Proximity Cards (as per model)  
Tecnologias MIFARE™/ 125 kHz ASK or HID
- Password  
User identification via numeric password
- QR Code  
User identification via QR Code

USER INTERFACE

- Tela LCD Touchscreen  
3.5” (320x480) color TFT LCD display with capacitive touchscreen.
- Integrated Web Software  
Complete browser-based access control management software
- Audio  
Built-in speaker and microphone



GENERAL CHARACTERISTICS

- Overall dimensions  
76,7 mm x 54,5 mm x 174 mm (L x P x A) - Terminal  
52 mm x 52 mm x 22 mm (W x D x H) - Drive Module  
External
- Equipment weight  
240g - Terminal  
35g - External Drive Module
- Food  
External 12V 2A power supply
- Degree of protection  
IP65
- Time and Attendance Control  
Collector compatible with RHID software (REP-P) as per MTP Ordinance 671/2021

INTERCONNECTION DIAGRAM

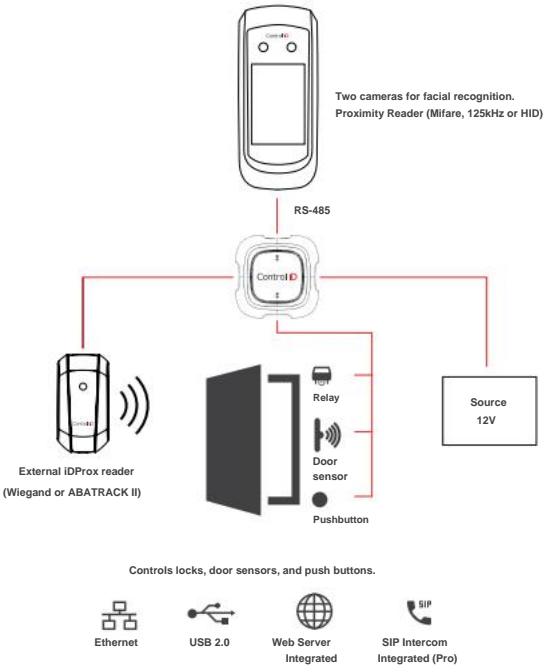



# Access Controller Multifuncional iDAccess

Through its compact and modern design, the iDAccess Access Controller is able to...  
To efficiently and quickly control the entry and exit of people.

Each of its features was designed with the latest technologies to make its operation easier and more intuitive.

In addition, it has integration with iDCloud, enabling management and contingency planning in the cloud.

- Display touchscreen
- Customized access rules by group and schedule;
- Biometric identification, proximity card, and password.
- Embedded web access software
- Eliminating the need for installation processes: Integrated alarm control panel

## MODELS (NCM 85437099)

- IDA/B  
Biometrics
- IDA/BP/ASK  
Proximity 125 kHz ASK + Biometrics
- IDA/BP/MIF  
MIFARE™ Proximity + Biometrics



# iDAccess Access Controller Multifunctional

## TECHNICAL SPECIFICATIONS

### ACCESS CONTROL

- Door Control  
2 doors with individual inputs for push button and door sensor.
- Number of Users  
Capacity for over 200,000 registered users.
- Number of Fingerprints:  
Capacity for up to 2,000 fingerprints in stand-alone mode and over 100,000 in online mode.
- Access Rules  
Release rules according to schedules and departments. Access
- Logs.  
Capacity for over 200,000 records.
- iDCloud  
Optional cloud-based monitoring, synchronization, and backup service.
- Wiegand Tickets  
1 native port (expandable up to 4); configurable as ABATRACK II
- Wiegand Exits  
1 native port (expandable up to 4); configurable as ABATRACK II
- Output Relays  
2 independent relays up to 30VAC/5A

### ALARM CENTER

- Alarm Inputs  
5 independent alarm zones, with configurable trigger times and polarity.
- Alarm Output  
Transistorized output with a maximum capacity of 12VDC@10mA
- Vandalism Detection  
Configurable alarm for equipment removal from the support.
- Burglary Detection  
Configurable alarm for door opening without relay activation.
- Detection of Coercion  
Possibility of registering a panic button per user.

### COMMUNICATION

- Ethernet  
1 native 10/100Mbps Ethernet port
- USB  
1 porta USB Host 2.0
- RS-485  
1 native RS-485 port with 120Ω termination
- GPRS  
GPRS connection module (optional)
- Wi-Fi  
Wi-Fi connection module (optional)

### METHODS OF IDENTIFICATION

- Biometric Reader  
500 DPI optical fingerprint reader
- Proximity Cards (as per model)  
MIFARE™ or 125kHz technologies (including ASK, FSK and PSK)
- Password  
User identification via numeric password



### GENERAL CHARACTERISTICS

- Overall dimensions  
55 mm x 170 mm x 70 mm (P x A x L)
- Equipment weight  
250g
- Packaged weight  
400g
- Food  
External 12V power supply (not included)
- Consumption  
2,4W (200mA) nominal

### USER INTERFACE

- 2.6" (320x240) color TFT
- LCD touchscreen display with resistive touchscreen.

Integrated Web Software:  
Complete access control management software via browser.

### INTERCONNECTION DIAGRAM

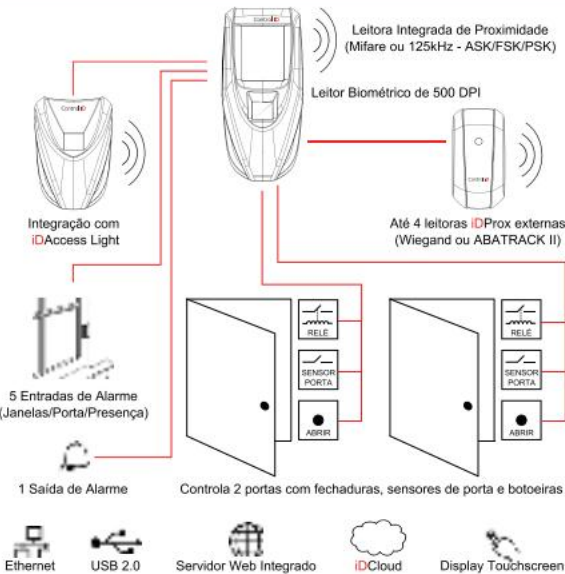

# Access Controller Multifunctional iDAccess Nano

With a modern and compact design, the iDAccess Nano is capable of quickly monitoring and controlling the entry and exit of people. Its small size allows for installation in a wide variety of environments, and its 1.2 GHz quad-core processor guarantees the identification of up to 100,000 fingerprints in a 1:N configuration in stand-alone mode.

Furthermore, its external drive module allows for expandable solutions with greater safety.

- Display touchscreen de 1,77"
- 1.2 GHz quad-core processor TCP/IP communication 1:N
- biometric identification of up to 100,000 fingerprints\*
- Customized access rules by group and time.
- Biometric identification, proximity card, and password.

\*As per model

## MODELS (NCM 85437099)

IDANANO/BP/A  
Biometrics + Proximity 125kHz ASK

IDANANO/BP/M  
MIFARE™ Biometrics + Proximity

Upgrade iDAccess Nano  
para iDAccess Nano Enterprise



# iDAccess Nano Access Controller Multifunctional

## TECHNICAL SPECIFICATIONS

### ACCESS CONTROL

- Number of Users  
Capacity for over 200,000 registered users.
- Number of fingerprints (as per model)  
Capacity for 6,000 / 10,000 / 50,000 / 100,000 digital devices.
- Access Rules  
Release rules according to schedules and departments.
- Door Control  
Control via external drive module
- Sensors and Pushbuttons  
1 push-button input  
1 input for open door sensor
- Output Relay  
1 internal relay in the drive module, up to 30VAC/5A
- Wiegand Entrance  
1 native port
- Wiegand Exit  
1 native port

### COMMUNICATION

- Ethernet  
1 native 10/100Mbps Ethernet port
- USB  
1 porta USB Host 2.0
- RS-485  
1 RS-485 port for communication between the module external drive and terminal
- GPRS  
GPRS connection module (optional)
- Wi-Fi  
Wi-Fi connection module (optional)

### METHODS OF IDENTIFICATION

- Biometric Reader  
500 DPI optical fingerprint reader
- Proximity Cards (as per model)  
Tecnologias MIFARE™ or 125 kHz ASK
- Password  
User identification via numeric password

### USER INTERFACE

- Tela LCD Touchscreen  
1.77" (128x160) color TFT LCD display with resistive touchscreen.
- Integrated Web Software  
Complete control management software access via browser



### GENERAL CHARACTERISTICS

- Overall dimensions  
57,3 mm x 45,4 mm x 129,4 mm (L x P x A) - Terminal  
52 mm x 52 mm x 22 mm (W x D x H) - Drive Module  
External
- Equipment weight  
110g - Terminal  
35g - External Drive Module
- Food  
External 12V power supply
- Total Consumption  
1,92W (160mA) nominal

### INTERCONNECTION DIAGRAM

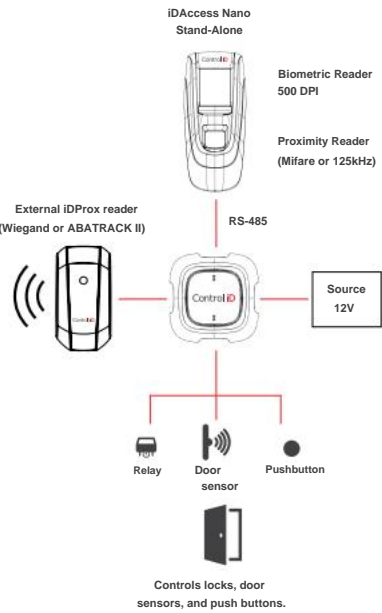



# Access Controller Multifunctional iDAccess Nano Prox

With a modern and compact design, the iDAccess Nano Prox is able to quickly monitor and control the entry and exit of people.

Its compact size allows for installation in a wide variety of environments, and its 1.2 GHz quad-core processor ensures high speed.

Furthermore, its external drive module allows for expandable solutions with greater safety.

• Display touchscreen de 1,77”  
1.2 GHz quad-core processor TCP/IP communication  
Customized access rules by group and time.  
Identification via proximity card and password

### MODELS (NCM 85437099)

- IDANANO/P/A  
Proximity 125 kHz ASK
- IDANANO/P/M  
MIFARE™ Proximity



# iDAccess Nano Prox Access Controller Multifunctional

## TECHNICAL SPECIFICATIONS

### ACCESS CONTROL

- Number of Users  
Capacity for over 200,000 registered users.
- Access Rules  
Release rules according to schedules and departments.
- Door Control  
Control via external drive module
- Network Operation  
Yes. Enterprise mode requires a separately sold license.
- Sensors and Pushbuttons  
1 push-button input  
1 input for open door sensor
- Output Relay  
1 internal relay in the drive module, up to 30VAC/5A
- Wiegand Entrance  
1 native port
- Wiegand Exit  
1 native port

### COMMUNICATION

- Ethernet  
1 native 10/100Mbps Ethernet port
- USB  
1 porta USB Host 2.0
- RS-485  
One RS-485 port for communication between the external drive module and the terminal.
- GPRS  
Optional GPRS connection module
- Wi-Fi  
Optional Wi-Fi connection module

### METHODS OF IDENTIFICATION

- Proximity Cards (as per model)  
Tecnologias MIFARE™ or 125 kHz ASK
- Password  
User identification via numeric password

### USER INTERFACE

- Tela LCD Touchscreen  
1.77” (128x160) color TFT LCD display with resistive touchscreen.
- Integrated Web Software  
Complete control management software access via browser



### GENERAL CHARACTERISTICS

- Overall dimensions  
57,3 mm x 45,4 mm x 129,4 mm (L x P x A) - Terminal  
52 mm x 52 mm x 22 mm (W x D x H) - Drive Module External
- Equipment weight  
110g - Terminal  
35g - External Drive Module
- Food  
External 12V power supply
- Total Consumption  
1,92W (160mA) nominal

### INTERCONNECTION DIAGRAM

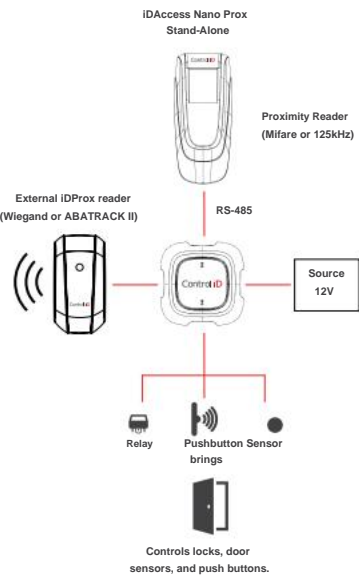



# Access Controller Multifunctional iDAccess Pro

With a modern and innovative design, the iDAccess Pro is the ideal equipment for monitoring and controlling the entry and exit of people in corporate environments that demand high performance.

Its 1.2 GHz quad-core processor ensures the identification of up to 100,000 1:N fingerprints in stand-alone mode.

In addition, the device features a 3.5" touchscreen display and embedded web software that facilitates the management of rules. access.

- Display touchscreen de 3,5"
- 1.2 GHz quad-core processor TCP/IP
- communication 1:N
- biometric identification of up to 100,000 fingerprints\*
- Customized access rules by group and time.

\*As per model

## MODELS (NCM 85437099)

- IDAPRO/BP/A  
Biometrics + Proximity 125 kHz ASK
- IDAPRO/BP/M  
MIFARE™ Biometrics + Proximity
- IDAPRO/BP/H  
Biometrics + HID Proximity



# iDAccess Pro Access Controller Multifunctional

## TECHNICAL SPECIFICATIONS

### ACCESS CONTROL

- Number of Users  
Capacity for over 200,000 registered users.
- Number of fingerprints (as per model)  
Capacity for 6,000 / 10,000 / 50,000 / 100,000 digital devices.
- Access Rules  
Release rules according to schedules and departments.
- Door Control  
Control via external drive module
- Sensors and Pushbuttons  
1 push-button input  
1 input for open door sensor
- Output Relay  
1 internal relay in the drive module, up to 30VAC/5A
- Wiegand Entrance  
1 native port
- Wiegand Exit  
1 native port

### COMMUNICATION

- Ethernet  
1 native 10/100Mbps Ethernet port
- USB  
1 porta USB Host 2.0
- RS-485  
One RS-485 port for communication between the external drive module and the terminal.
- GPRS  
GPRS connection module (optional)
- Wi-Fi  
Wi-Fi connection module (optional)

### METHODS OF IDENTIFICATION

- Biometric Reader  
500 DPI optical fingerprint reader
- Proximity Cards (as per model)  
Tecnologias HID / MIFARE™ or 125 kHz ASK
- Password  
User identification via numeric password

### USER INTERFACE

- Tela LCD Touchscreen  
3.5" (320x480) color TFT LCD display with resistive touchscreen.
- Integrated Web Software  
Complete browser-based access control management software



### GENERAL CHARACTERISTICS

- Overall dimensions  
81,2 mm x 51,8 mm x 184 mm (L x P x A) - Terminal  
52 mm x 52 mm x 22 mm (W x D x H) - Drive Module External
- Equipment weight  
195g - Terminal  
35g - External Drive Module
- Food  
External 12V power supply
- Total Consumption  
1,92W (160mA) nominal

### INTERCONNECTION DIAGRAM

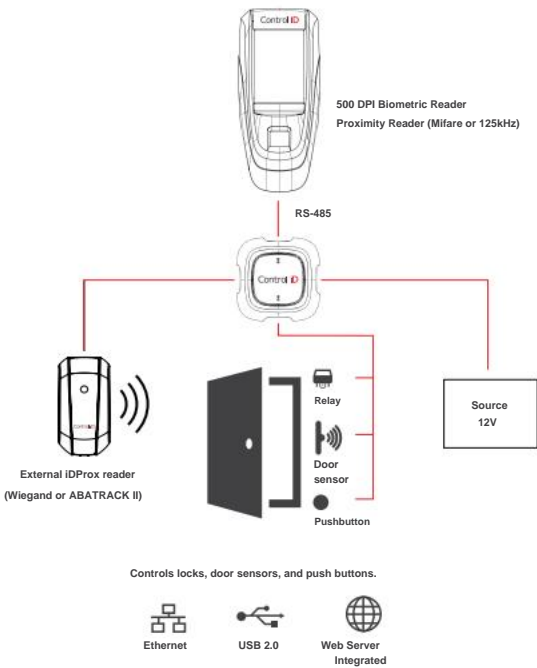

# Access Controller Multifunctional iDAccess Pro Prox

With a modern design and Innovative, the iDAccess Pro Prox is the ideal equipment for monitoring and controlling the entry and exit of people in corporate environments that demand high performance.

Your quad-core processor  
The 1.2 GHz frequency ensures high speed.

In addition, the device features a 3.5” touchscreen display and embedded web software that facilitates the management of access rules.

i Display touchscreen de 3,5”  
1.2 GHz quad-core processor TCP/IP communication  
Customized access rules by group and time.

- MODELS (NCM 85437099)
- IDAPRO/P/A

Proximity 125 kHz ASK
- IDAPRO/P/M

MIFARE™ Proximity



# iDAccess Pro Prox Access Controller Multifunctional

## TECHNICAL SPECIFICATIONS

### ACCESS CONTROL

- Number of Users  
Capacity for over 200,000 registered users.
- Access Rules  
Release rules according to schedules and departments.
- Door Control  
Control via external drive module
- Sensors and Pushbuttons  
1 push-button input  
1 input for open door sensor
- Output Relay  
1 internal relay in the drive module, up to 30VAC/5A

Wiegand Entrance  
1 native port

Wiegand Exit  
1 native port

### COMMUNICATION

- Ethernet  
1 native 10/100Mbps Ethernet port
- USB  
1 porta USB Host 2.0
- RS-485  
One RS-485 port for communication between the external drive module and the terminal.
- GPRS  
GPRS connection module (optional)
- Wi-Fi  
Wi-Fi connection module (optional)

### METHODS OF IDENTIFICATION

- Proximity Cards (as per model)  
HID / MIFARE™ or 125 kHz ASK technologies (various standards)
- Password  
User identification via numeric password

### USER INTERFACE

- Tela LCD Touchscreen  
3.5” (320x480) color TFT LCD display with resistive touchscreen.
- Integrated Web Software  
Complete browser-based access control management software



### GENERAL CHARACTERISTICS

- Overall dimensions  
81,2 mm x 51,8 mm x 184 mm (L x P x A) - Terminal  
52 mm x 52 mm x 22 mm (L x P x A) - Módulo de External Actuation
- Equipment weight  
195g - Terminal  
35g - External Drive Module
- Food  
External 12V power supply
- Total Consumption  
1,92W (160mA) nominal

### INTERCONNECTION DIAGRAM

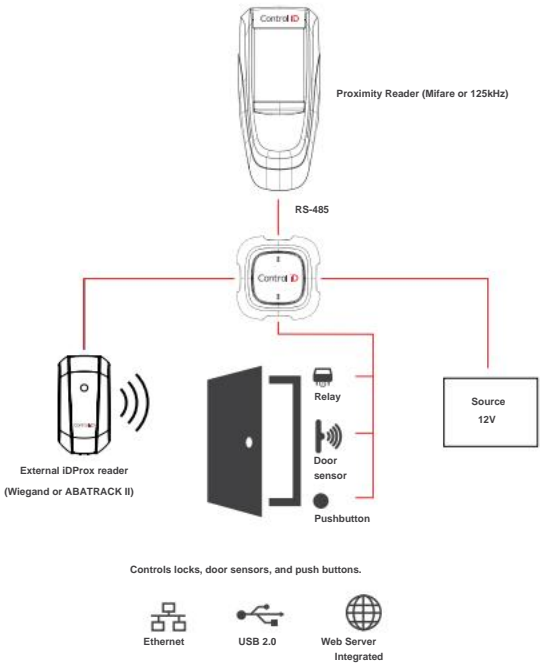

# Access Controller Multifuncional iDFlex Pro

With its innovative architecture and modern design, the iDFlex is a compact, robust access controller ready to meet the needs of businesses of all sizes. It is easy and intuitive to use.

The external drive module allows for expandable solutions and greater... security.

The product also features embedded web software, eliminating the need to install any additional software.

i Display touchscreen  
Customized access rules by group and time.  
Biometric identification, by proximity card and password  
External drive module with relay

Best value for money on the market

## MODELS (NCM 85437099)

IDFLEX/AC/B  
PRO - Biometria + TCP/IP

IDFLEX/AC/BP/A  
PRO - Proximity 125 kHz ASK + Biometrics + TCP/IP

IDFLEX/AC/BP/A  
PRO - MIFARE™ Proximity + Biometrics + TCP/IP



# iDFlex Pro Access Controller Multifunctional

## TECHNICAL SPECIFICATIONS

### ACCESS CONTROL

- Number of Users  
Capacity for over 200,000 registered users.
- Number of Fingerprints  
Capacity for up to 6,000 fingerprints.
- Access Rules  
Release rules according to schedules and departments.
- Access Logs  
Capacity for over 200,000 records.
- iDCloud  
Optional cloud-based monitoring, synchronization, and backup service.

- Door Control  
Control a door securely.
- Sensors and Pushbuttons  
1 push-button input  
1 input for open door sensor
- Output Relay  
1 internal relay in the drive module, up to 30VAC/5A
- Wiegand Entrance  
1 native port
- Wiegand Exit  
1 native port

### COMMUNICATION

- Ethernet  
1 native 10/100Mbps Ethernet port
- USB  
1 porta USB Host 2.0
- RS-485  
One RS-485 port for communication between the external drive module and the terminal.
- GPRS  
GPRS connection module (optional)
- Wi-Fi  
Wi-Fi connection module (optional)

### METHODS OF IDENTIFICATION

- Biometric Reader  
500 DPI optical fingerprint reader
- Proximity Cards (as per model)  
Tecnologias MIFARE™ or 125 kHz ASK
- Password  
User identification via numeric password

### USER INTERFACE

- Tela LCD Touchscreen  
2.4" (320x240) color TFT LCD display with resistive touchscreen.
- Integrated Web Software  
Complete browser-based access control management software



### GENERAL CHARACTERISTICS

- Overall dimensions  
100 mm x 95 mm x 36 mm (L x A x P) - Terminal  
52 mm x 52 mm x 22 mm (L x P x A) - Módulo de External Actuation
- Equipment weight  
212g - Terminal  
34g - External Drive Module  
263g - Packaged Weight
- Food  
External 12V power supply
- Total Consumption  
2,4W (200mA) nominal

### INTERCONNECTION DIAGRAM

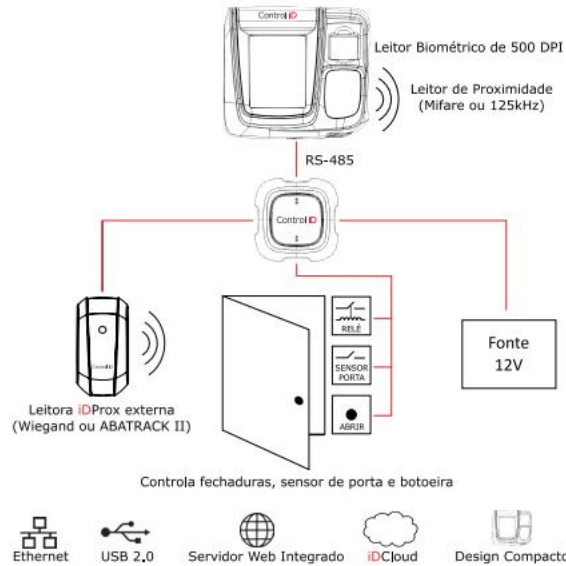



# Access Controller Multifunctional iDFlex Pro Prox

With its innovative architecture and modern design, the iDFlex Pro Prox is a compact, robust access controller ready to meet the needs of businesses of all sizes. It is easy and intuitive to use.

The external drive module allows for expandable solutions and greater... security.

The product also features embedded web software, eliminating the need to install any additional software.

i Display touchscreen  
Access rules customized by groups and schedules; Identification via proximity card and password.

External drive module with relay

Best value for money on the market

## MODELS (NCM 85437099)

IDFLEX/AC/P/A  
PRO - Proximidade 125 kHz ASK + TCP/IP

IDFLEX/AC/P/M  
PRO - MIFARE™ Proximity + TCP/IP



# iDFlex Pro Prox Access Controller Multifunctional

## TECHNICAL SPECIFICATIONS

### ACCESS CONTROL

- Number of Users  
Capacity for over 200,000 registered users.
- Access Rules  
Release rules according to schedules and departments.
- Access Logs  
Capacity for over 200,000 records.
- iDCloud  
Optional cloud-based monitoring, synchronization, and backup service.

- Door Control  
Control a door securely.
- Network Operation  
Yes. Enterprise mode requires a separately sold license.
- Sensors and Pushbuttons  
1 push-button input  
1 input for open door sensor
- Output Relay  
1 internal relay in the drive module, up to 30VAC/5A

- Wiegand Entrance  
1 native port
- Wiegand Exit  
1 native port

### COMMUNICATION

- Ethernet  
1 native 10/100Mbps Ethernet port
- USB  
1 porta USB Host 2.0
- RS-485  
One RS-485 port for communication between the external drive module and the terminal.
- GPRS  
GPRS connection module (optional)
- Wi-Fi  
Wi-Fi connection module (optional)

### METHODS OF IDENTIFICATION

- Proximity Cards (as per model)  
Tecnologias MIFARE™ or 125 kHz ASK
- Password  
User identification via numeric password

### USER INTERFACE

- Tela LCD Touchscreen  
2.4" (320x240) color TFT LCD display with resistive touchscreen.
- Integrated Web Software  
Complete browser-based access control management software



### GENERAL CHARACTERISTICS

- Overall dimensions  
100 mm x 95 mm x 36 mm (L x A x P) - Terminal  
52 mm x 52 mm x 22 mm (L x P x A) - Módulo de External Actuation
- Equipment weight  
212g - Terminal  
34g - External Drive Module  
263g - Packaged Weight
- Food  
External 12V power supply
- Total Consumption  
2,4W (200mA) nominal

### INTERCONNECTION DIAGRAM

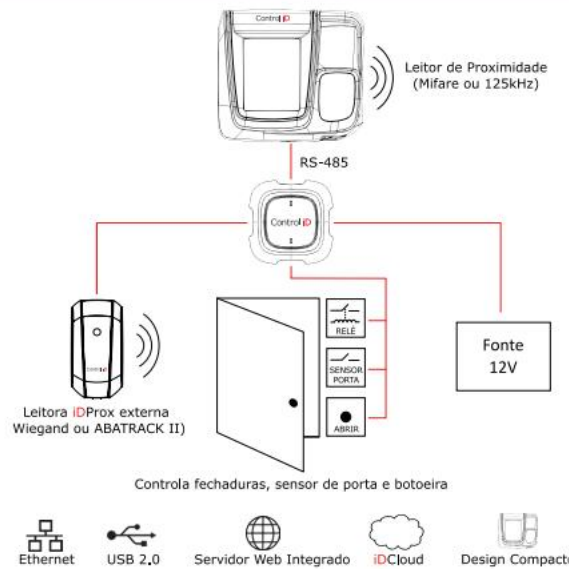

# Access Controller Multifunctional iDFlex Lite

With its innovative architecture and modern design, the iDFlex is a compact, robust access controller ready to meet the needs of businesses of all sizes. It is easy and intuitive to use.

The external drive module allows for expandable solutions and greater... security.

Display touchscreen  
Customized access rules by group and schedule; Biometric identification, proximity card, and password.  
External drive module with relay

Best value for money on the market



## MODELS (NCM 85437099)

IDFLEXLITE/AC/BP/A  
LITE - Proximity 125 kHz ASK + Biometrics

# iDFlex Lite Access Controller Multifunctional

## TECHNICAL SPECIFICATIONS

### ACCESS CONTROL

- Number of Users  
Capacity for over 200,000 registered users.
- Number of Fingerprints  
Capacity for up to 6,000 fingerprints.
- Access Rules  
Release rules according to schedules and departments.
- Access Logs  
Capacity for over 200,000 records.
- Door Control  
Control a door securely.
- Sensors and Pushbuttons  
1 push-button input  
1 input for open door sensor
- Output Relay  
1 internal relay in the drive module, up to 30VAC/5A
- Wiegand Entrance  
1 native port
- Wiegand Exit  
1 native port

### COMMUNICATION

- USB  
1 porta USB Host 2.0
- RS-485  
One RS-485 port for communication between the external drive module and the terminal.
- GPRS  
GPRS connection module (optional)
- Wi-Fi  
Wi-Fi connection module (optional)

### METHODS OF IDENTIFICATION

- Biometric Reader  
500 DPI optical fingerprint reader
- Proximity Cards (as per model)  
Tecnologias MIFARETM or 125 kHz ASK
- Password  
User identification via numeric password

### USER INTERFACE

- Tela LCD Touchscreen  
2.4" (320x240) color TFT LCD display with resistive touchscreen.



### GENERAL CHARACTERISTICS

- Overall dimensions  
100 mm x 95 mm x 36 mm (L x A x P) - Terminal  
52 mm x 52 mm x 22 mm (L x P x A) - Módulo de External Actuation
- Equipment weight  
212g - Terminal  
34g - External Drive Module  
263g - Packaged Weight
- Food  
External 12V power supply
- Total Consumption  
2,4W (200mA) nominal

### INTERCONNECTION DIAGRAM

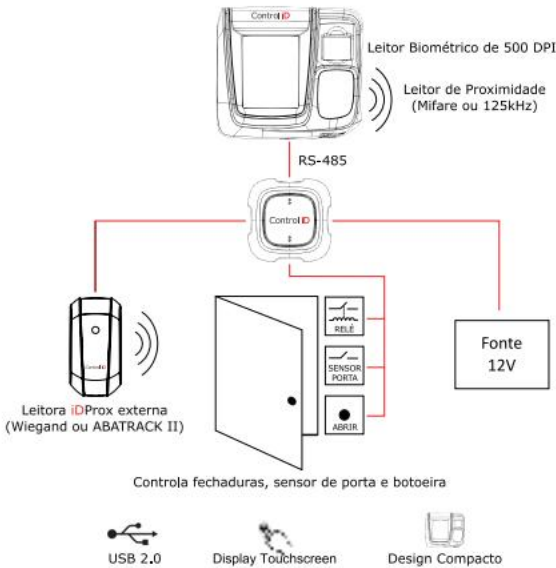



# Access Controller Multifunctional iDFlex IP65

With its innovative architecture and modern design, the iDFlex IP65 It is a compact, robust access controller ready to meet the needs of businesses of all sizes. It is easy and intuitive to use.

The external drive module allows for expandable solutions and greater... security.

The product also features embedded web software, eliminating the need to install any additional software.

• Display touchscreen  
Customized access rules by group and schedule; Biometric identification, proximity card, and password.  
External drive module with relay

Best value for money on the market

## MODELS (NCM 85437099)

IDFLEXIP65/AC/BP/A  
Proximity 125 kHz ASK + Biometrics + TCP/IP

IDFLEXIP65/AC/BP/M  
MIFARE™ Proximity + Biometrics + TCP/IP



# iDFlex IP65 Access Controller Multifunctional

## TECHNICAL SPECIFICATIONS

### ACCESS CONTROL

- Number of Users  
Capacity for over 200,000 registered users.
- Number of Fingerprints  
Capacity for up to 6,000 fingerprints.
- Access Rules  
Release rules according to schedules and departments.
- Access Logs  
Capacity for over 200,000 records.
- iDCloud  
Optional cloud monitoring, synchronization and backup service. Door control.

- Control a door securely.
- Sensors and Pushbuttons  
1 push-button input  
1 input for open door sensor
- Output Relay  
1 internal relay in the drive module, up to 30VAC/5A

- Wiegand Entrance  
1 native port

- Wiegand Exit  
1 native port

### IP65 protection

Equipped with special protection against water and dust.

### COMMUNICATION

- Ethernet  
1 native 10/100Mbps Ethernet port
- USB  
1 porta USB Host 2.0
- RS-485  
One RS-485 port for communication between the external drive module and the terminal.
- GPRS  
GPRS connection module (optional)
- Wi-Fi  
Wi-Fi connection module (optional)

### METHODS OF IDENTIFICATION

- Biometric Reader  
500 DPI optical fingerprint reader
- Proximity Cards (as per model)  
Tecnologias MIFARE™ or 125 kHz ASK
- Password  
User identification via numeric password

### USER INTERFACE

Tela LCD Touchscreen  
2.4" (320x240) color TFT LCD display with resistive touchscreen.

Integrated Web Software  
Complete browser-based access control management software



### GENERAL CHARACTERISTICS

Overall dimensions  
100 mm x 95 mm x 36 mm (L x A x P) - Terminal  
52 mm x 52 mm x 22 mm (L x P x A) - Módulo de External Actuation

Equipment weight  
212g - Terminal  
34g - External Drive Module  
263g - Packaged Weight

Food  
External 12V power supply

Total Consumption  
2,4W (200mA) nominal

### INTERCONNECTION DIAGRAM

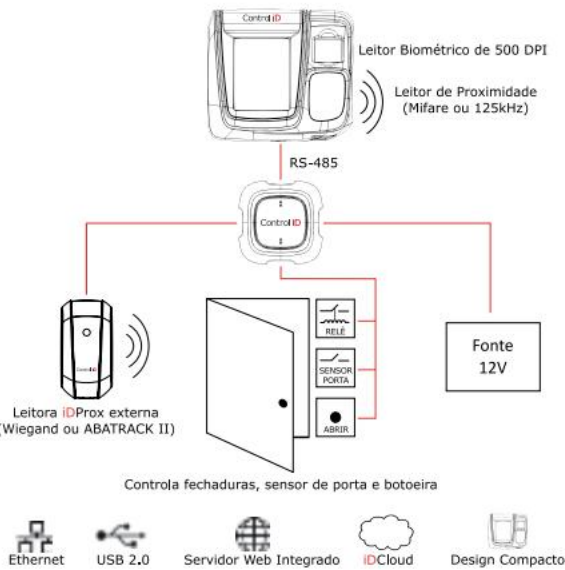



# Access Controller Multifunctional iDFlex IP65 Prox

With its innovative architecture and modern design, the iDFlex IP65 Prox is a compact, robust access controller ready to meet the needs of businesses of all sizes. It is easy and intuitive to use.

The external drive module allows for expandable solutions and greater... security.

The product also features embedded web software, eliminating the need to install any additional software.

i Display touchscreen  
Access rules customized by groups and schedules; Identification via proximity card and password.

External drive module with relay

Best value for money on the market

## MODELS (NCM 85437099)

IDFLEXIP65/AC/P/A  
Proximity 125 kHz ASK + TCP/IP



# iDFlex IP65 Prox Access Controller Multifunctional

## TECHNICAL SPECIFICATIONS

### ACCESS CONTROL

- Number of Users  
Capacity for over 200,000 registered users.
- Access Rules  
Release rules according to schedules and departments.
- Access Logs  
Capacity for over 200,000 records.
- iDCloud  
Optional cloud-based monitoring, synchronization, and backup service.

- Door Control  
Control a door securely.
- Network Operation  
Yes. Enterprise mode requires a separately sold license.
- Sensors and Pushbuttons  
1 push-button input  
1 input for open door sensor
- Output Relay  
1 internal relay in the drive module, up to 30VAC/5A

- Wiegand Entrance  
1 native port

- Wiegand Exit  
1 native port

### IP65 protection

Equipped with special protection against water and dust.

### COMMUNICATION

- Ethernet  
1 native 10/100Mbps Ethernet port
- USB  
1 porta USB Host 2.0
- RS-485  
One RS-485 port for communication between the external drive module and the terminal.
- GPRS  
GPRS connection module (optional)
- Wi-Fi  
Wi-Fi connection module (optional)

### METHODS OF IDENTIFICATION

- Proximity Cards (as per model)  
Tecnologias MIFARETM or 125 kHz ASK
- Password  
User identification via numeric password

### USER INTERFACE

- Tela LCD Touchscreen  
2.4" (320x240) color TFT LCD display with resistive touchscreen.
- Integrated Web Software  
Complete browser-based access control management software



### GENERAL CHARACTERISTICS

- Overall dimensions  
100 mm x 95 mm x 36 mm (L x A x P) - Terminal  
52 mm x 52 mm x 22 mm (L x P x A) - Módulo de External Actuation
- Equipment weight  
212g - Terminal  
34g - External Drive Module  
263g - Packaged Weight
- Food  
External 12V power supply
- Total Consumption  
2,4W (200mA) nominal

### INTERCONNECTION DIAGRAM

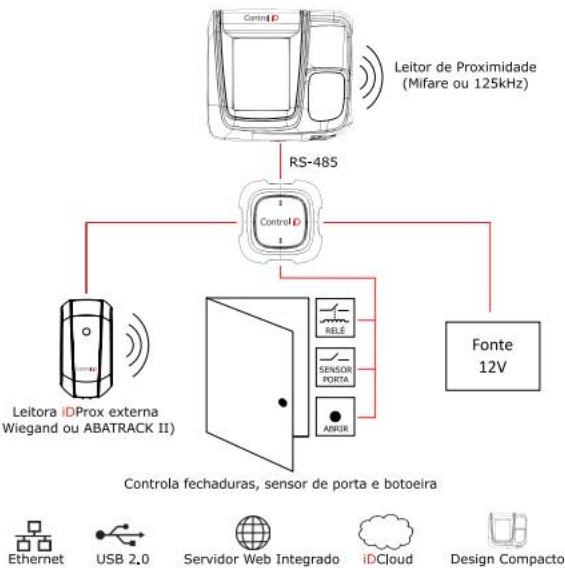

Access Controller  
Built-in (4x2)  
iDFit

With an extremely compact and modern design that fits inside a standard 4x2 box, the iDFit Access Controller is capable of efficiently and quickly controlling the entry and exit of...

people.

Despite its small size, the equipment features the latest screen, identification, and communication technologies to make its operation easier and more intuitive.

- Display touchscreen
- Customized access rules by group and time.
- Biometric identification, proximity card, and password.
- Embedded web access software eliminating installation processes
- Integrated Alarm Center

MODELS (NCM 85437099)

- IDF/BIO  
Biometrics
- IDF/BP/ASK  
Proximity 125 kHz ASK + Biometrics
- IDF/BP/MIF  
MIFARE™ Proximity + Biometrics



iDFit  
Access Controller  
Built-in (4x2)

TECHNICAL SPECIFICATIONS

ACCESS CONTROL

- Door Control  
2 doors with individual inputs for push button and door sensor.
- Number of Users  
Capacity for over 200,000 registered users.
- Number of Fingerprints  
Capacity for up to 2,000 digital signatures in stand-alone mode and over 100,000 in online mode.
- Access Rules  
Release rules according to schedules and departments.
- Access Logs  
Capacity for over 200,000 records.
- iDCloud  
Optional cloud-based monitoring, synchronization, and backup service.
- Wiegand inputs.  
1 native port (expandable to 4); configurable as ABATRACK II
- Wiegand Exits  
1 native port (expandable up to 4); configurable as ABATRACK II
- Output Relays  
2 independent relays up to 30VAC/5A

ALARM CENTER

- Alarm Inputs  
5 independent alarm zones, with configurable trigger times and polarity.
- Alarm Output  
Transistorized output with a maximum capacity of 12VDC@10mA
- Burglary Detection  
Configurable alarm for door opening without relay activation.
- Detection of Coercion  
Possibility of registering a panic button per user.

COMMUNICATION

- Ethernet  
1 native 10/100Mbps Ethernet port
- USB  
1 porta USB Host 2.0
- RS-485  
1 native RS-485 port with 120Ω termination
- GPRS  
GPRS connection module (optional)
- Wi-Fi  
Wi-Fi connection module (optional)

METHODS OF IDENTIFICATION

- Biometric Reader  
500 DPI optical fingerprint reader
- Proximity Cards (as per model)  
MIFARE™ or 125 kHz technologies (including ASK, FSK and PSK)
- Password  
User identification via numeric password



GENERAL CHARACTERISTICS

- Overall dimensions (W x H x L)  
60 mm x 144 mm x 84 mm (geral)  
43 mm x 102 mm x 59 mm (recessed part)
- Equipment weight  
250g
- Packaged weight  
400g
- Food  
External 12V power supply (not included)
- Consumption  
2,4W (200mA) nominal

USER INTERFACE

- 2.4" (320x240) color TFT  
LCD touchscreen display with capacitive touchscreen.
- Integrated Web Software:  
Complete access control management software via browser.

INTERCONNECTION DIAGRAM

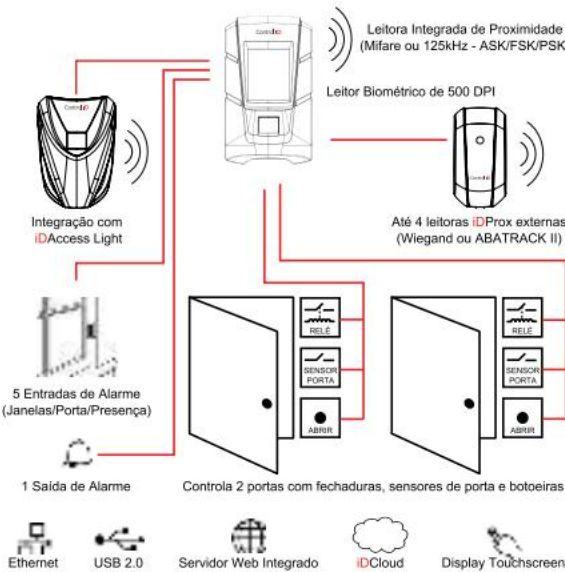



# Keyboard for Access Control

## iDTouch

Through a modern design

Stylish and elegant, the iDTouch is capable to control efficiently

and speed of entry and exit of people.

Its capacitive keyboard and user-friendly interface.

They allow you to adjust settings and access the device using a password or proximity card.

In addition, the device allows you to synchronize your database with another iDTouch.

Capacitive Keyboard  
Password and proximity card identification;  
Data synchronization between two devices.  
Capacity for 1,000 users and cards  
Door opening control

### MODELS (NCM 85437099)

**IDTOUCH/ASK**  
iDTouch - Proximity 125 kHz ASK and password

**IDTOUCH/MIF**  
iDTouch - MIFARE™ proximity and password

**IDTOUCHIP65/ASK**  
iDTouch IP65 - Proximity 125 kHz ASK and password

**IDTOUCHIP65/MIF**  
iDTouch IP65 - MIFARE™ proximity and password



# iDTouch

## Keyboard for Access Control

### TECHNICAL SPECIFICATIONS

#### ACCESS CONTROL

Door control for 1 door with push-button input.

Number of Users  
Capacity for up to 1000 users.

Number of Passwords  
Capacity for up to 1000 passwords.

Number of Cards  
Capacity for up to 1000 RFID cards.

Identification (as per model)  
Password, card, or both.

Output Relay  
1 independent 30VAC/5A relay

Doorbell  
1. Logical interface for controlling an external relay.

Violation Detection  
Continuous beep in case of violation.

#### COMMUNICATION

Wiegand Entrance  
1 native port for Wiegand communication.

Wiegand Exit  
1 native port for Wiegand communication.

Synchronization  
Allows transferring users from one iDTouch to another.

#### METHODS OF IDENTIFICATION

Proximity Cards (as per model)  
Tecnologias MIFARE™ or 125 kHz ASK

Password  
User identification via password  
numeric of 4 to 6 digits

#### USER INTERFACE

Capacitive Keys  
13 backlit capacitive keys

Identification LED  
Green and red LED

Buzzer  
Buzzer de 4kHz e 70dbA @ 100mm



#### GENERAL CHARACTERISTICS

Overall dimensions:  
15 cm x 8 cm x 3 cm (H x W x D)

Equipment weight  
155g

Packaged weight  
205g

Food  
External 12V power supply (not included)

Consumption  
1,8W (150mA) nominal

#### INTERCONNECTION DIAGRAM

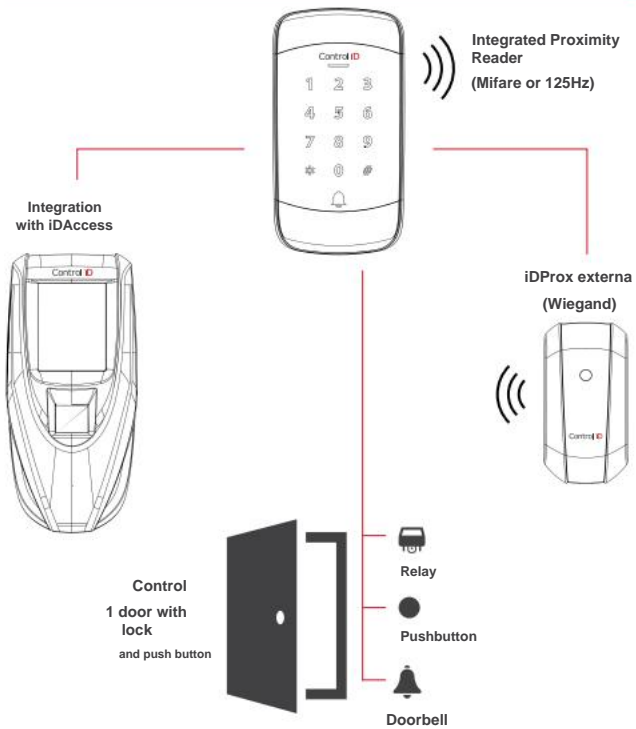



# Access Controller with UHF Reader iDUHF

Control iD brings to market equipment with IP65 protection. Ideal for monitoring and controlling vehicle access in corporate and residential condominiums. With an integrated UHF reader with a range of up to 15 meters, the iDUHF operates as a standalone device that provides both reading and authentication of vehicle tags, as well as control of the external engine drive board.

Its storage capacity is up to 200,000 users, and through the embedded web software, it is possible to configure the product, customize access rules, and generate specific reports in a simple and intuitive way.

- Reading and authenticating tags on the device itself.
- Customizable access rules and reports
- It stores up to 200,000 users.
- IP65 protection
- Controls the plate and motor drive.
- Embedded software and TCP/IP communication

## MODELS (NCM 85437099)

IDUHF



# iDUHF Access Controller with UHF Reader

## TECHNICAL SPECIFICATIONS

### ACCESS CONTROL

- Number of Users  
Capacity for over 200,000 registered users.
- Access Rules  
Release rules according to schedules and departments.
- Access Logs  
Capacity for over 200,000 records.

### COMMUNICATION

- Ethernet  
1 native 10/100Mbps Ethernet port
- RS-485  
1 native RS-485 port with 120 Ohm termination
- RS-232  
1 native RS-232 port
- Output Relay: 1  
relay up to 30VAC/5A
- Wiegand Exit  
1 native output
- Additional entries  
Trigger and Door Sensor Inputs

### METHODS OF IDENTIFICATION

- UHF Reader  
Reading distance up to 15m, depending on the tag used and the antenna installation conditions.

### USER INTERFACE

- Integrated Web Software  
Complete browser-based access control management software



### GENERAL CHARACTERISTICS

- Overall dimensions  
420 mm x 420 mm x 60 mm (L x A x P) - Antena  
52 mm x 52 mm x 22 mm (L x P x A) - Módulo de External Actuation
- Equipment weight  
2270g - Antena  
35g - External Drive Module
- Food  
External 12V power supply (not included)
- Total Consumption  
3,5W (300mA) nominal

### INTERCONNECTION DIAGRAM

#### iDUHF as an Access Controller

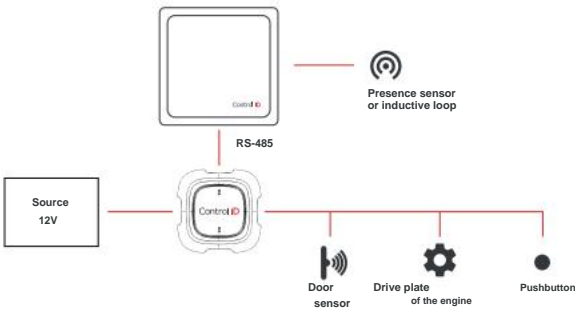

#### iDUHF as a UHF Reader (Wiegand)

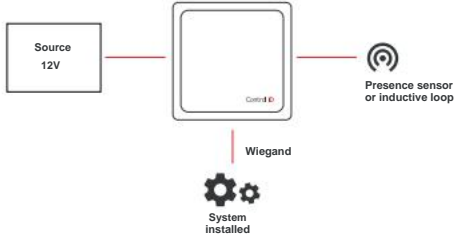

# Access Controller with UHF Reader iDUHF Lite

Control iD brings to market an IP65-protected device ideal for monitoring and controlling vehicle access in corporate and residential condominiums. With a compact size and integrated UHF reader with a range of up to 12 meters, the iDUHF Lite operates as a standalone device that provides both reading and authentication of vehicle tags, as well as control of the external motor activation board.

Its storage capacity is up to 200,000 users, and through the embedded web software, it is possible to configure the product, customize access rules, and generate specific reports in a simple and intuitive way.

- Reading and authenticating tags on the device itself.
- Customizable access rules and reports  
It stores up to 200,000 users.
- IP65 protection
- Controls motor drive board
- Embedded software and TCP/IP communication



# iDUHF Lite Access Controller with UHF Reader

## TECHNICAL SPECIFICATIONS

### ACCESS CONTROL

- Number of Users  
Capacity for over 200,000 registered users.
- Access Rules  
Release rules according to schedules and departments.
- Access Logs  
Capacity for over 200,000 records.

### COMMUNICATION

- Ethernet  
1 native 10/100Mbps Ethernet port
- RS-485  
1 native RS-485 port with 120 Ohm termination
- RS-232  
1 native RS-232 port
- Output Relay: 1  
relay up to 30VAC/5A
- Wiegand Exit  
1 native output
- Additional entries  
Trigger and Door Sensor Inputs

### METHODS OF IDENTIFICATION

- UHF Reader  
Reading distance up to 12m, depending on the tag used and the antenna installation conditions.

### USER INTERFACE

- Integrated Web Software  
Complete browser-based access control management software



### GENERAL CHARACTERISTICS

- Overall dimensions  
275 mm x 275 mm x 70 mm (L x A x P) - Antena  
52 mm x 52 mm x 22 mm (L x P x A) - Módulo de External Actuation
- Equipment weight  
1280g - Antenna  
35g - External Drive Module
- Food  
External 12V power supply (not included)
- Total Consumption  
3,5W (300mA) nominal
- Horizontal Capture Angle: 30 degrees to each side

### INTERCONNECTION DIAGRAM

iDUHF as an Access Controller

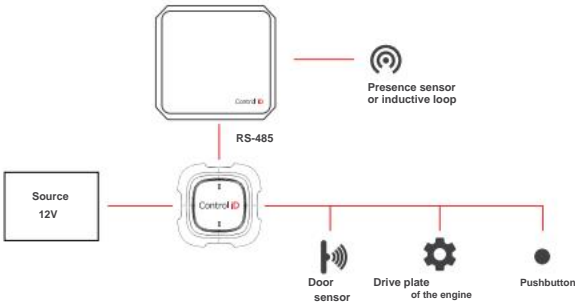

iDUHF as a UHF Reader (Wiegand)

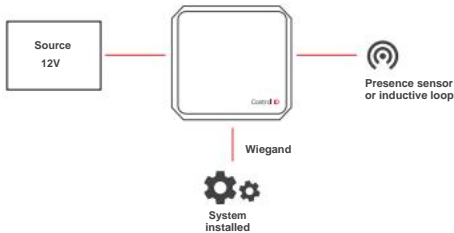

### MODELS (NCM 85437099)

IDUHF/LITE

# Access Controller Intelligent Multi-Door iDBox V2

The iDBox V2 controller features in a single product what exists most advanced in control access.

Through its touchscreen display and embedded web software, it is possible to manage access rules by groups and by schedule for multiple doors using proximity readers and biometric equipment. connected in a network.

It also features integration with iDSecure Cloud, enabling device management via the cloud, with contingency operation capabilities.

OSDP support with Secure Channel.

Readers can be configured individually.

for Wiegand, Abatrack or OSDP.  
Supports up to 8 signals for inputs.  
Supervised.  
Quad-core processor.

## MODELS (NCM 85437099)

IDBOXV2



# iDBox V2 Access Controller Intelligent Multi-Door

## TECHNICAL SPECIFICATIONS

### ACCESS CONTROL

- Door Control  
4 doors with individual inputs for push button and door sensor (can be configured as supervised inputs)
- Number of Users  
Capacity for over 1,000,000 registered users.
- Access Rules  
Release rules according to schedules and departments.
- Access Logs  
Capacity for over 1,000,000 records.
- iDCloud  
Optional cloud-based monitoring, synchronization, and backup service.

- Wiegand Tickets  
4 shared ports\*
- ABA TRACK II Tickets  
4 shared ports\*
- Interface RS-485  
4 native ports with OSDP support\*
- Output Relays  
4 relays (1 per port) up to 30V 5A with NO/NC/COM contacts

### COMMUNICATION

- Ethernet  
1 native 10/100Mbps Ethernet port
- USB  
1 porta USB Host 2.0
- RS-232  
1 native RS-232 port
- GPRS  
GPRS connection module (optional)
- Wi-Fi  
Wi-Fi connection module (optional)

### USER INTERFACE

- 4.3" (480x272) color TFT  
LCD touchscreen display with resistive touchscreen.
- Integrated Web Software  
Complete browser-based access control management software



### GENERAL CHARACTERISTICS

- Overall dimensions  
39 mm x 125 mm x 129 mm (D x H x W)
- Equipment weight  
250g
- Packaged weight  
400g
- Food  
External 12V power supply (not included)
- Consumption  
3,5W (300mA) nominal

### INTERCONNECTION DIAGRAM

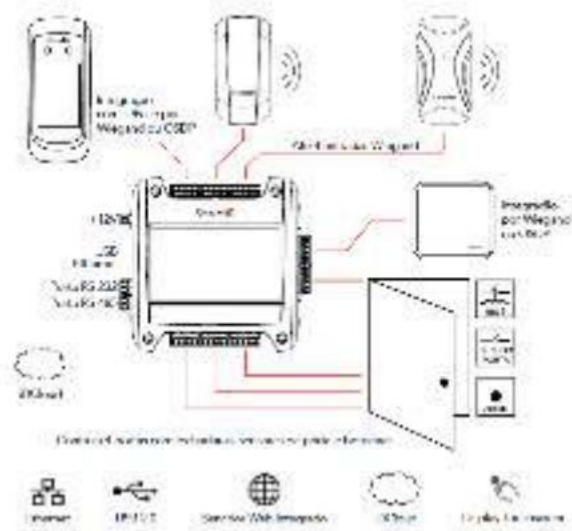



Proximity Card  
Reader  
iDProx

Featuring a modern design and high-performance embedded electronics, the iDProx family of proximity card readers is compatible with the leading technologies on the market.

The excellent reading range combined with the fast response time make this product ideal for a wide variety of environments.

Through its multiple communication protocols, it can be integrated with any existing access controllers.

Mifare and 125kHz card reading; Selectable Wiegand or ABATRACK outputs

Easy installation  
Audiovisual signaling after card reading.

Modern and innovative design

MODELS (NCM 85437099)

iDProx Compact  
IDP/C/ASK  
Proximity 125 kHz ASK

IDP/C/MIF  
MIFARE™ Proximity

iDProx Slim  
IDP/S/ASK  
Proximity 125 kHz ASK

IDP/S/MIF  
MIFARE™ Proximity



iDProx  
Proximity Card  
Reader

TECHNICAL SPECIFICATIONS

METHODS OF IDENTIFICATION

Proximity Cards  
MIFARE™ and 125 kHz technologies (including ASK, FSK and PSK)  
Reach  
ASK:15cm, FSK: 10cm, PSK: 10cm, MIFARE: 6cm

COMMUNICATION

Wiegand Exit  
1 native Wiegand port (can be configured for ABATRACK II)  
TTL Serial Output  
1. A shared TTL logic level serial port (RS-232)

LED  
Internal LED control input for the equipment.  
Beep  
Internal buzzer control input for the equipment.

USER INTERFACE

LED  
Red, green, and yellow LED  
Buzzer  
Buzzer de 4kHz e 70 dbA @ 100mm



GENERAL CHARACTERISTICS

Overall dimensions  
Slim Model  
20 mm x 95 mm x 51 mm (P x A x L)

Modelo Compact 22  
mm x 130 mm x 55 mm (P x A x L)

Equipment weight  
200g

Packaged weight  
400g

Food  
External 12V power supply (not included)

Consumption  
1,2W (100mA) nominal

Degree of Protection  
IP65

INTERCONNECTION DIAGRAM



# iDBlock Next Smart Turnstile with iDFace Max

Control iD brings to market a revolutionary turnstile with a unique design and up to two installed iDFaces Max, which control both the entry and exit of people through facial recognition technology. The equipment has an integrated support that allows operation with only one iDFace Max installed, offering combined entry or exit control.

The equipment also allows operation with an optional fingerprint reader. With an innovative mechanism, the iDBlock Next turnstile can be used in any type of indoor environment.

Furthermore, it can operate completely stand-alone via embedded web software, requiring no additional software installation.

\* Facial recognition\* \* Controls entry and exit with up to 2 iDFaces Max \* Revolutionary mechanism \* Color touchscreen display \* TCP/IP communication \* Stand-alone and online operation \* Modern and innovative design

\*As per model



# iDBlock Next com iDFace Max Smart Turnstile

## TECHNICAL SPECIFICATIONS

### ACCESS CONTROL

- People Control  
Defining the direction of rotation release and confirming passage.
- Anti-Double Entry  
Blocking multiple passages in the same direction.
- Collection Box  
Possibility of validating and collecting visitor badges.
- Number of Users: Capacity for over 200,000 registered users.
- Number of Faces: Capacity for up to 100,000\* faces with live face detection.
- Number of Fingerprints:  
Capacity for up to 10,000 fingerprints\*

### MECHANISM

- Durability  
exceeding 800,000 rotations and easy to maintain.
- Sound Noise  
Silent mechanism

### METHODS OF IDENTIFICATION

- Facial Recognition  
Two 1080p HD cameras in each iDFace (visible light and IR light)\*
- Proximity Cards\*  
Tecnologias MIFARE™/ 125 kHz ASK
- Fingerprint Reader\*  
500 DPI optical reader
- Password  
User identification via numeric password
- QR Code  
User identification via QR Code

### COMMUNICATION

- Ethernet 1  
porta Ethernet 10/100Mbps nativa
- GPRS  
GPRS connection module (optional)
- Wi-Fi  
Wi-Fi connection module (optional)
- USB  
1 porta USB Host 2.0
- SIP Intercom  
Integrated SIP intercom compatible with G711



### GENERAL CHARACTERISTICS

- Overall dimensions  
704 mm x 1367 mm x 658 mm (D x H x W)
- Food  
Internal 12V/2A power supply included.
- Consumption  
24W (2A) nominal

### USER INTERFACE

- Tela LCD Touchscreen (base)  
3.5" (320x480) color TFT LCD display with capacitive touchscreen\*
- LCD touchscreen display on each iDFace  
7" (800x1280) color TFT LCD display with capacitive touchscreen\*
- Integrated Web Software  
Complete browser-based access control management software
- Audio  
Built-in speaker and microphone

iDBlock Next  
turnstile models  
with iDFace Max  
(NCM 84798999)



iDBlock Next Stainless Steel with 2 Facial Recognition Recognition

- IDBLOCKNEXT/IN/2FMAX/A iDBlock  
Next Facial Inox + 2 Faciais + Prox. 125 kHz
- IDBLOCKNEXT/IN/2FMAX/A/U iDBlock  
Next Facial Inox + 2 Faciais + Prox. 125 kHz + Urna
- IDBLOCKNEXT/IN/2FMAX/M iDBlock  
Next Facial Inox + 2 Faciais + Prox. 13,56 MHz
- IDBLOCKNEXT/IN/2FMAX/M/U iDBlock  
Next Facial Inox + 2 Faciais + Prox. 13,56 MHz + Urna
- IDBLOCKNEXT/IN/B2FMAX/A iDBlock  
Next Facial Inox com Biometria + 2 Faciais + Prox. 125 kHz
- IDBLOCKNEXT/IN/B2FMAX/A/U iDBlock  
Next Facial Inox com Biometria + 2 Faciais + Prox. 125 kHz + Urna
- IDBLOCKNEXT/IN/B2FMAX/M iDBlock  
Next Facial Inox com Biometria + 2 Faciais + Prox. 13,56 MHz
- IDBLOCKNEXT/IN/B2FMAX/M/U iDBlock  
Next Facial Inox com Biometria + 2 Faciais + Prox. 13,56 MHz + Urna



iDBlock Next Stainless Steel with 1 Facial Recognition Reader

- IDBLOCKNEXT/IN/1FMAX/A iDBlock  
Next Facial Inox + 1 Facial + Prox. 125 kHz
- IDBLOCKNEXT/IN/1FMAX/A/U iDBlock  
Next Facial Inox + 1 Facial + Prox. 125 kHz + Urna
- IDBLOCKNEXT/IN/1FMAX/M iDBlock  
Next Facial Inox + 1 Facial + Prox. 13,56 MHz
- IDBLOCKNEXT/IN/1FMAX/M/U iDBlock  
Next Facial Inox + 1 Facial + Prox. 13,56 MHz + Urna
- IDBLOCKNEXT/IN/B1FMAX/A iDBlock  
Next Facial Inox com Biometria + 1 Facial + Prox. 125 kHz
- IDBLOCKNEXT/IN/B1FMAX/A/U iDBlock  
Next Facial Inox com Biometria + 1 Facial + Prox. 125 kHz + Urna
- IDBLOCKNEXT/IN/B1FMAX/M iDBlock  
Next Facial Inox com Biometria + 1 Facial + Prox. 13,56 MHz
- IDBLOCKNEXT/IN/B1FMAX/M/U iDBlock  
Next Facial Inox com Biometria + 1 Facial + Prox. 13,56 MHz + Urna



iDBlock Next Painted with 2 Facial Recognition Readers

- IDBLOCKNEXT/PT/2FMAX/A iDBlock  
Next Facial Pintada + 2 Faciais + Prox. 125 kHz
- IDBLOCKNEXT/PT/2FMAX/A/U iDBlock  
Next Facial Pintada + 2 Faciais + Prox. 125 kHz + Urna
- IDBLOCKNEXT/PT/2FMAX/M iDBlock  
Next Facial Pintada + 2 Faciais + Prox. 13,56 MHz
- IDBLOCKNEXT/PT/2FMAX/M/U iDBlock  
Next Facial Pintada + 1 Facial + Prox. 13,56 MHz + Urna
- IDBLOCKNEXT/PT/B2FMAX/A iDBlock  
Next Facial Recognition with Biometrics + 2 Facial Recognitions + Proximity 125 kHz
- IDBLOCKNEXT/PT/B2FMAX/A/U iDBlock  
Next Facial Recognition with Biometrics + 2 Facial Recognitions + Proximity 125 kHz + Voting Machine
- IDBLOCKNEXT/PT/B2FMAX/M iDBlock  
Next Facial Recognition with Biometrics + 2 Facial Recognitions + Proximity 13.56 MHz
- IDBLOCKNEXT/PT/B2FMAX/M/U iDBlock  
Next Facial Recognition with Biometrics + 2 Facial Recognitions + Proximity 13.56 MHz



iDBlock Next Painted with 1 Facial Recognition Reader

- IDBLOCKNEXT/PT/1FMAX/A iDBlock  
Next Facial Pintada + 1 Facial + Prox. 125 kHz
- IDBLOCKNEXT/PT/1FMAX/A/U iDBlock  
Next Facial Pintada + 1 Facial + Prox. 125 kHz + Urna
- IDBLOCKNEXT/PT/1FMAX/M iDBlock  
Next Facial Pintada + 1 Facial + Prox. 13,56 MHz
- IDBLOCKNEXT/PT/1FMAX/M/U iDBlock  
Next Facial Pintada + 1 Facial + Prox. 13,56 MHz + Urna
- IDBLOCKNEXT/PT/B1FMAX/A iDBlock  
Next Facial Pintada com Biometria + 1 Facial + Prox. 125 kHz
- IDBLOCKNEXT/PT/B1FMAX/A/U iDBlock  
Next Facial Pintada com Biometria + 1 Facial + Prox. 125 kHz + Urna
- IDBLOCKNEXT/PT/B1FMAX/M iDBlock  
Next Facial Pintada com Biometria + 1 Facial + Prox. 13,56 MHz
- IDBLOCKNEXT/PT/B1FMAX/M/U iDBlock  
Next Facial Pintada com Biometria + 1 Facial + Prox. 13,56 MHz + Urna



# Smart Turnstile iDBlock Next com iDFace

Control iD brings to market a revolutionary turnstile with a unique design and up to two installed iDFaces, which control both the entry and exit of people through facial recognition technology.

The device features an integrated support that allows operation with only one iDFace installed, offering combined control of entry or exit. The device also allows operation with an optional fingerprint reader.

With an innovative mechanism, the iDBlock Next turnstile can be used in any type of environment. Furthermore, it can operate completely stand-alone via embedded web software, requiring no additional software installation.

- Facial recognition\*
- Controls entry and exit with up to 2 iDFaces
- Revolutionary mechanism
- 7" Display colorido touchscreen
- TCP/IP communication
- Stand-alone and online operation
- Modern and innovative design

\*As per model



# iDBlock Next com iDFace Smart Turnstile

## TECHNICAL SPECIFICATIONS

### ACCESS CONTROL

- People Control  
Defining the direction of rotation release and confirming passage.
- Anti-Double Entry  
Blocking multiple passages in the same direction.
- Collection Box  
Possibility of validating and collecting visitor badges.
- Number of Users  
Capacity for over 200,000 registered users.
- Number of Faces  
Capacity for up to 3,000 (Lite)/10,000 (Pro) faces with live face detection.

### MECHANISM

- Durability  
Greater than 800,000 RPM and easy to maintain.
- Sound Noise  
Silent mechanism

### METHODS OF IDENTIFICATION

- Facial Recognition  
Two 1080p HD cameras in each iDFace (visible light and IR light)\*
- Proximity Cards (as per model)  
Tecnologias MIFARE™/ 125 kHz ASK
- Fingerprint Reader  
500 DPI optical reader
- Password  
User identification via numeric password
- QR Code  
User identification via QR Code

### COMMUNICATION

- Ethernet  
1 native 10/100Mbps Ethernet port
- GPRS  
GPRS connection module (optional)
- Wi-Fi  
Wi-Fi connection module (optional)
- USB  
1 porta USB Host 2.0
- SIP Intercom  
Integrated SIP intercom (Pro version)



### GENERAL CHARACTERISTICS

- Overall dimensions  
704 mm x 1367 mm x 658 mm (P x A x L)
- Food  
Internal 12V/2A power supply included.
- Consumption  
3,5W (300mA) nominal

### USER INTERFACE

- Tela LCD Touchscreen (base)  
3.5" (320x480) color TFT LCD display with capacitive touchscreen\*
- LCD touchscreen display on each iDFace  
3.5" (320x480) color TFT LCD display with capacitive touchscreen\*
- Integrated Web Software  
Complete browser-based access control management software
- Audio  
Built-in speaker and microphone

iDBlock Next  
turnstile models  
with iDFace  
(NCM 84798999)



iDBlock Next Stainless Steel with 2 Facial Recognition Recognition

- IDBLOCKNEXT/IN/2FP/A  
iDBlock Next Facial Inox com 2 Faciais + Prox. 125 kHz ASK
- IDBLOCKNEXT/IN/2FP/M  
iDBlock Next Facial Inox com 2 Faciais + Prox. MIFARE™
- IDBLOCKNEXT/IN/2FP/A/U iDBlock  
Next Facial Inox com 2 Faciais + Prox. 125 kHz ASK + Urna
- IDBLOCKNEXT/IN/2FP/M/U iDBlock  
Next Facial Inox com 2 Faciais + Prox. MIFARE™ + Urna
- IDBLOCKNEXT/IN/B2FP/A  
iDBlock Next Facial Inox com Biometria + 2 Faciais + Prox. 125 kHz ASK
- IDBLOCKNEXT/IN/B2FP/M iDBlock  
Next Facial Inox com Biometria + 2 Faciais + Prox. MIFARE™
- IDBLOCKNEXT/IN/B2FP/A/U iDBlock  
Next Facial Inox com Biometria + 2 Faciais + Prox. 125 kHz ASK + Urna
- IDBLOCKNEXT/IN/B2FP/M/U iDBlock  
Next Facial Inox com Biometria + 2 Faciais + Prox. MIFARE™ + Urna



iDBlock Next Stainless Steel with 1 Facial Recognition Reader

- IDBLOCKNEXT/IN/1FP/A  
iDBlock Next Facial Inox com 1 Facial + Prox. 125 kHz ASK
- IDBLOCKNEXT/IN/1FP/M  
iDBlock Next Facial Inox com 1 Facial + Prox. MIFARE™
- IDBLOCKNEXT/IN/1FP/A/U iDBlock  
Next Facial Inox com 1 Facial + Prox. 125 kHz ASK + Urna
- IDBLOCKNEXT/IN/1FP/M/U iDBlock  
Next Facial Inox com 1 Facial + Prox. MIFARE™ + Urna
- IDBLOCKNEXT/IN/B1FP/A  
iDBlock Next Facial Inox com Biometria + 1 Facial + Prox. 125 kHz ASK
- IDBLOCKNEXT/IN/B1FP/M iDBlock  
Next Facial Inox com Biometria + 1 Facial + Prox. MIFARE™
- IDBLOCKNEXT/IN/B1FP/A/U iDBlock  
Next Facial Inox com Biometria + 1 Facial + Prox. 125 kHz ASK + Urna
- IDBLOCKNEXT/IN/B1FP/M/U iDBlock  
Next Facial Inox com Biometria + 1 Facial + Prox. MIFARE™ + Urna



iDBlock Next Painted with 2 Facial Recognition Readers

- IDBLOCKNEXT/PT/2FP/A  
iDBlock Next Facial Pintada com 2 Faciais + Prox. 125 kHz ASK
- IDBLOCKNEXT/PT/2FP/M  
iDBlock Next Facial Pintada with 2 Faces + Proximity MIFARE™
- IDBLOCKNEXT/PT/2FP/A/U iDBlock  
Next Facial Pintada com 2 Faciais + Prox. 125 kHz ASK + Urna
- IDBLOCKNEXT/PT/2FP/M/U iDBlock  
Next Face Painted with 2 Faces + MIFARE™ Proximity + Urn
- IDBLOCKNEXT/PT/B2FP/A  
iDBlock Next Facial Recognition with Biometrics + 2 Facial Recognitions + Proximity 125 kHz ASK
- IDBLOCKNEXT/PT/B2FP/M  
iDBlock Next Facial Recognition with Biometrics + 2 Facial Recognitions + Proximity MIFARE™
- IDBLOCKNEXT/PT/B2FP/A/U iDBlock  
Next Facial Recognition with Biometrics + 2 Facial Recognitions + Proximity 125 kHz ASK + Ballot Box
- IDBLOCKNEXT/PT/B2FP/M/U iDBlock  
Next Facial Recognition with Biometrics + 2 Facial Recognitions + Proximity MIFARE™ + Ballot Box



iDBlock Next Painted with 1 Facial Recognition Reader

- IDBLOCKNEXT/PT/1FP/A  
iDBlock Next Facial Pintada com 1 Facial + Prox. 125 kHz ASK
- IDBLOCKNEXT/PT/1FP/M  
iDBlock Next Facial Pintada com 1 Facial + Prox. MIFARE™
- IDBLOCKNEXT/PT/1FP/A/U iDBlock  
Next Facial Pintada com 1 Facial + Prox. 125 kHz ASK + Urna
- IDBLOCKNEXT/PT/1FP/M/U iDBlock  
Next Facial Pintada com 1 Facial + Prox. MIFARE™ + Urna
- IDBLOCKNEXT/PT/B1FP/A  
iDBlock Next Facial Pintada com Biometria + 1 Facial + Prox. 125 kHz ASK
- IDBLOCKNEXT/PT/B1FP/M  
iDBlock Next Facial Pintada com Biometria + 1 Facial + Prox. MIFARE™
- IDBLOCKNEXT/PT/B1FP/A/U iDBlock  
Next Facial Pintada com Biometria + 1 Facial + Prox. 125 kHz ASK + Urna
- IDBLOCKNEXT/PT/B1FP/M/U iDBlock  
Next Facial Pintada com Biometria + 1 Facial + Prox. MIFARE™ + Urna

iDBlock Next  
Turnstile Models with Biometric and/  
or Proximity Access  
(NCM 84798999)



iDBlock Next Stainless Steel Biometrics and Proximity

- IDBLOCKNEXT/IN/BP/A  
iDBlock Next Inox com Biometria + Prox. 125 kHz
- IDBLOCKNEXT/IN/BP/A/U  
iDBlock Next Inox com Biometria + Prox. 125 kHz + Urna
- IDBLOCKNEXT/IN/BP/M  
iDBlock Next Inox com Biometria + Prox. 13,56 MHz
- IDBLOCKNEXT/IN/BP/M/U  
iDBlock Next Inox com Biometria + Prox. 13,56 MHz + Urna

iDBlock Next Stainless Steel Proximity

- IDBLOCKNEXT/IN/P/A  
iDBlock Next Inox + Prox. 125 kHz
- IDBLOCKNEXT/IN/P/A/U  
iDBlock Next Inox + Prox. 125 kHz + Urna
- IDBLOCKNEXT/IN/P/M  
iDBlock Next Inox + Prox. 13,56 MHz
- IDBLOCKNEXT/IN/P/M/U  
iDBlock Next Inox + Prox. 13,56 MHz + Urna



iDBlock Next Painted Biometrics and Proximity

- IDBLOCKNEXT/PT/BP/A  
iDBlock Next Pintada com Biometria + Prox. 125 kHz
- IDBLOCKNEXT/PT/BP/A/U  
iDBlock Next Pintada com Biometria + Prox. 125 kHz + Urna
- IDBLOCKNEXT/PT/BP/M  
iDBlock Next Pintada com Biometria + Prox. 13,56 MHz
- IDBLOCKNEXT/PT/BP/M/U  
iDBlock Next Pintada com Biometria + Prox. 13,56 MHz + Urna

iDBlock Next Painted Proximity

- IDBLOCKNEXT/PT/P/A  
iDBlock Next Pintada + Prox. 125 kHz
- IDBLOCKNEXT/PT/P/A/U  
iDBlock Next Pintada + Prox. 125 kHz + Urna
- IDBLOCKNEXT/PT/P/M  
iDBlock Next Pintada + Prox. 13,56 MHz
- IDBLOCKNEXT/PT/P/M/U  
iDBlock Next Pintada + Prox. 13,56 MHz + Urna



# Smart Turnstile iDBlock Next BQC com iDFace Max

Control iD brings a turnstile to the market.  
revolutionary with a unique design and up to two  
iDFaces Max devices are installed, which control  
both the entry and exit of people through facial  
recognition technology.

The equipment has a support.  
The integrated system allows operation with  
only one iDFace Max installed, offering combined  
control of entry or exit. The equipment also  
allows operation with an optional fingerprint  
reader.

Featuring an articulated arm mechanism for  
emergencies, the iDBlock Next turnstile can be  
used in any type of indoor environment.  
Furthermore, it can operate completely stand-  
alone via embedded web software, requiring no  
additional software installation.

- Facial recognition\*
- Controls entry and exit with up to 2 iDFaces Max
- Articulated arm mechanism (BQC)
- TCP/IP communication
- Stand-alone and online operation
- Modern and innovative design

\*As per model



# iDBlock Next BQC com iDFace Max Smart Turnstile

## TECHNICAL SPECIFICATIONS

### ACCESS CONTROL

- People Control  
Defining the direction of rotation release and confirming passage.
- Anti-Double Entry  
Blocking multiple passages in the same direction.
- Collection Box  
Possibility of validating and collecting visitor badges.
- Number of Users  
Capacity for over 200,000 registered users.
- Number of Faces  
Capacity for up to 100,000\* faces  
with live face detection
- Number of Fingerprints  
Capacity for up to 10,000 fingerprints\*

### MECHANISM

- Durability  
Greater than 800,000 RPM and easy to maintain.
- Articulated Arm  
Articulated arm mechanism for emergencies
- Sound Noise  
Silent mechanism

### METHODS OF IDENTIFICATION

- Facial Recognition  
Two 1080p HD cameras on each iDFace Max (visible light and IR light)\*
- Proximity Cards\*  
MIFARE, 125kHz ASK ou HID
- Fingerprint Reader\*  
500 DPI optical reader
- Password  
User identification via numeric password
- QR Code  
User identification via QR Code

### COMMUNICATION

- Ethernet  
1 native 10/100Mbps Ethernet port
- GPRS  
GPRS connection module (optional)
- Wi-Fi  
Wi-Fi connection module (optional)
- USB  
1 porta USB Host 2.0
- SIP Intercom  
Integrated SIP intercom compatible with G711



### GENERAL CHARACTERISTICS

- Overall dimensions  
704 mm x 1367 mm x 658 mm (P x A x L)
- Food  
Internal 12V/2A power supply included.
- Consumption  
24W (2A) nominal

### USER INTERFACE

- Tela LCD Touchscreen (base)  
3.5" (320x480) color TFT LCD display with  
capacitive touchscreen\*
- LCD touchscreen display on each iDFace Max  
7" (800x1280) color TFT LCD display with  
capacitive touchscreen\*
- Integrated Web Software  
Complete browser-based access control  
management software
- Audio  
Built-in speaker and microphone

iDBlock Next  
BQC turnstile models  
with iDFace Max  
(NCM 84798999)



iDBlock Next BQC Stainless Steel with  
2 Facial Recognition Recognition Systems

- IDBLOCKNEXT/BQC/IN/2FMAX/A iDBlock  
Next Facial BQC Inox + 2 Faciais + Prox. 125 kHz
- IDBLOCKNEXT/BQC/IN/2FMAX/A/U iDBlock  
Next Facial BQC Inox + 2 Faciais + Prox. 125 kHz + Urna
- IDBLOCKNEXT/BQC/IN/2FMAX/M iDBlock  
Next Facial BQC Inox + 2 Faciais + Prox. 13,56 MHz
- IDBLOCKNEXT/BQC/IN/2FMAX/M/U iDBlock  
Next Facial BQC Inox + 2 Faciais + Prox. 13,56 MHz + Urna
- IDBLOCKNEXT/BQC/IN/B2FMAX/A iDBlock  
Next Facial BQC Inox com Biometria + 2 Faciais + Prox. 125 kHz
- IDBLOCKNEXT/BQC/IN/B2FMAX/A/U iDBlock  
Next Facial BQC Inox com Biometria + 2 Faciais + Prox. 125 kHz + Urna
- IDBLOCKNEXT/BQC/IN/B2FMAX/M iDBlock  
Next Facial BQC Inox com Biometria + 2 Faciais + Prox. 13,56 MHz
- IDBLOCKNEXT/BQC/IN/B2FMAX/M/U iDBlock  
Next Facial BQC Inox com Biometria + 2 Faciais + Prox. 13,56 MHz + Urna



iDBlock Next Stainless Steel  
with 1 Facial Recognition Reader

- IDBLOCKNEXT/BQC/IN/1FMAX/A iDBlock  
Next Facial BQC Inox + 1 Facial + Prox. 125 kHz
- IDBLOCKNEXT/BQC/IN/1FMAX/A/U iDBlock  
Next Facial BQC Inox + 1 Facial + Prox. 125 kHz + Urna
- IDBLOCKNEXT/BQC/IN/1FMAX/M iDBlock  
Next Facial BQC Inox + 1 Facial + Prox. 13,56 MHz
- IDBLOCKNEXT/BQC/IN/1FMAX/M/U iDBlock  
Next Facial BQC Inox + 1 Facial + Prox. 13,56 MHz + Urna
- IDBLOCKNEXT/BQC/IN/B1FMAX/A iDBlock  
Next Facial BQC Inox com Biometria + 1 Facial + Prox. 125 kHz
- IDBLOCKNEXT/BQC/IN/B1FMAX/A/U iDBlock  
Next Facial BQC Inox com Biometria + 1 Facial + Prox. 125 kHz + Urna
- IDBLOCKNEXT/BQC/IN/B1FMAX/M iDBlock  
Next Facial BQC Inox com Biometria + 1 Facial + Prox. 13,56 MHz
- IDBLOCKNEXT/BQC/IN/B1FMAX/M/U iDBlock  
Next Facial BQC Inox com Biometria + 1 Facial + Prox. 13,56 MHz + Urna



iDBlock Next Painted with 2 Facial  
Recognition Readers

- IDBLOCKNEXT/BQC/PT/2FMAX/A iDBlock  
Next Facial BQC Pintada + 2 Faciais + Prox. 125 kHz
- IDBLOCKNEXT/BQC/PT/2FMAX/A/U iDBlock  
Next Facial BQC Pintada + 2 Faciais + Prox. 125 kHz + Urna
- IDBLOCKNEXT/BQC/PT/2FMAX/M iDBlock  
Next Facial BQC Pintada + 2 Faciais + Prox. 13,56 MHz
- IDBLOCKNEXT/BQC/PT/2FMAX/M/U iDBlock  
Next Facial BQC Pintada + 2 Faciais + Prox. 13,56 MHz + Urna
- iDBlock Next Facial Recognition (BQC)  
Painted with Biometrics + 2 Facial Recognitions + Proximity Recognition 125 kHz
- IDBLOCKNEXT/BQC/PT/B2FMAX/A/U iDBlock  
Next Facial BQC Painted with Biometrics + 2 Facial Recognition + Proximity 125 kHz + Ballot Box
- IDBLOCKNEXT/BQC/PT/B2FMAX/M iDBlock  
Next Facial Recognition with Biometrics + 2 Facial Recognitions + Proximity 13.56 MHz
- IDBLOCKNEXT/BQC/PT/B2FMAX/M/U iDBlock  
Next Facial Recognition BQC Painted Biometrics + 2 Facial Recognitions + Proximity 13.56 MHz + Voting Machine



iDBlock Next Painted with 1 Facial  
Recognition Reader

- IDBLOCKNEXT/BQC/PT/1FMAX/A iDBlock  
Next Facial BQC Pintada + 1 Facial + Prox. 125 kHz
- IDBLOCKNEXT/BQC/PT/1FMAX/A/U iDBlock  
Next Facial BQC Pintada + 1 Facial + Prox. 125 kHz + Urna
- IDBLOCKNEXT/BQC/PT/1FMAX/M iDBlock  
Next Facial BQC Pintada + 1 Facial + Prox. 13,56 MHz
- IDBLOCKNEXT/BQC/PT/1FMAX/M/U iDBlock  
Next Facial BQC Pintada + 1 Facial + Prox. 13,56 MHz + Urna
- IDBLOCKNEXT/BQC/PT/B1FMAX/A iDBlock  
Next Facial BQC Pintada com Biometria + 1 Facial + Prox. 125 kHz
- IDBLOCKNEXT/BQC/PT/B1FMAX/A/U iDBlock  
Next Facial BQC Pintada com Biometria + 1 Facial + Prox. 125 kHz + Urna
- IDBLOCKNEXT/BQC/PT/B1FMAX/M iDBlock  
Next Facial BQC Pintada com Biometria + 1 Facial + Prox. 13,56 MHz
- IDBLOCKNEXT/BQC/PT/B1FMAX/M/U iDBlock  
Next Facial BQC Pintada com Biometria + 1 Facial + Prox. 13,56 MHz + Urna

# Smart Turnstile iDBlock Next BQC com iDFace

Control iD brings to market a revolutionary turnstile with a unique design and up to two installed iDFaces, which control both the entry and exit of people through facial recognition technology.

The equipment has a support.  
The integrated system allows operation with only one iDFace installed, offering combined control of entry or exit. The equipment also allows operation with an optional fingerprint reader.

Featuring an articulated arm mechanism for emergencies, the iDBlock Next turnstile can be used in any type of indoor environment. Furthermore, it can operate completely stand-alone via embedded web software, requiring no additional software installation.

- Facial recognition\*
- Controls entry and exit with up to 2 iDFaces
- Articulated arm mechanism (BQC)
- TCP/IP communication
- Stand-alone and online operation
- Modern and innovative design

\*As per model



# iDBlock Next BQC com iDFace Smart Turnstile

## TECHNICAL SPECIFICATIONS

### ACCESS CONTROL

- People Control  
Defining the direction of rotation release and confirming passage.
- Anti-Double Entry  
Blocking multiple passages in the same direction.
- Collection Box  
Possibility of validating and collecting visitor badges.
- Number of Users  
Capacity for over 200,000 registered users.
- Number of Faces  
Capacity for up to 3,000 (Lite)/10,000 (Pro) faces with live face detection.

- Number of Fingerprints  
Capacity for up to 10,000 fingerprints\*

### MECHANISM

- Durability  
Greater than 800,000 RPM and easy to maintain.
- Articulated Arm  
Articulated arm mechanism for emergencies
- Sound Noise  
Silent mechanism

### METHODS OF IDENTIFICATION

- Facial Recognition  
Two 1080p HD cameras in each iDFace (visible light and IR light)\*
- Proximity Cards\*  
MIFARE™, 125kHz ASK ou HID
- Fingerprint Reader\*  
500 DPI optical reader
- Password  
User identification via numeric password
- QR Code  
User identification via QR Code

### COMMUNICATION

- Ethernet  
1 native 10/100Mbps Ethernet port
- GPRS  
GPRS connection module (optional)
- Wi-Fi  
Wi-Fi connection module (optional)
- USB  
1 porta USB Host 2.0
- SIP Intercom  
Integrated SIP intercom (Pro version)



### GENERAL CHARACTERISTICS

- Overall dimensions  
704 mm x 1367 mm x 658 mm (P x A x L)
- Food  
Internal 12V/2A power supply included.
- Consumption  
24W (2A)\* nominal

### USER INTERFACE

- Tela LCD Touchscreen (base)  
3.5" (320x480) color TFT LCD display with capacitive touchscreen\*
- LCD touchscreen display on each iDFace  
3.5" (320x480) color TFT LCD display with capacitive touchscreen\*
- Integrated Web Software  
Complete browser-based access control management software
- Audio  
Built-in speaker and microphone



iDBlock Next  
BQC turnstile models  
with iDFace  
(NCM 84798999)



iDBlock Next Stainless Steel  
with 2 Facial Recognition Recognition

- IDBLOCKNEXT/BQC/IN/2FP/A iDBlock  
Next Facial BQC Inox + 2 Faciais + Prox. 125 kHz
- IDBLOCKNEXT/BQC/IN/2FP/A/U iDBlock  
Next Facial BQC Inox + 2 Faciais + Prox. 125 kHz + Urna
- IDBLOCKNEXT/BQC/IN/2FP/M iDBlock  
Next Facial BQC Inox + 2 Faciais + Prox. 13,56 MHz
- IDBLOCKNEXT/BQC/IN/2FP/M/U iDBlock  
Next Facial BQC Inox + 2 Faciais + Prox. 13,56 MHz + Urna
- IDBLOCKNEXT/BQC/IN/B2FP/A iDBlock  
Next Facial BQC Inox com Biometria + 2 Faciais + Prox. 125 kHz
- IDBLOCKNEXT/BQC/IN/B2FP/A/U iDBlock  
Next Facial BQC Inox com Biometria + 2 Faciais + Prox. 125 kHz + Urna
- IDBLOCKNEXT/BQC/IN/B2FP/M iDBlock  
Next Facial BQC Inox com Biometria + 2 Faciais + Prox. 13,56 MHz
- IDBLOCKNEXT/BQC/IN/B2FP/M/U iDBlock  
Next Facial BQC Inox com Biometria + 2 Faciais + Prox. 13,56 MHz + Urna



iDBlock Next Stainless Steel  
with 1 Facial Recognition Reader

- IDBLOCKNEXT/BQC/IN/1FP/A iDBlock  
Next Facial BQC Inox + 1 Facial + Prox. 125 kHz
- IDBLOCKNEXT/BQC/IN/1FP/A/U iDBlock  
Next Facial BQC Inox + 1 Facial + Prox. 125 kHz + Urna
- IDBLOCKNEXT/BQC/IN/1FP/M iDBlock  
Next Facial BQC Inox + 1 Facial + Prox. 13,56 MHz
- IDBLOCKNEXT/BQC/IN/1FP/M/U iDBlock  
Next Facial BQC Inox + 1 Facial + Prox. 13,56 MHz + Urna
- IDBLOCKNEXT/BQC/IN/B1FP/A iDBlock  
Next Facial BQC Inox com Biometria + 1 Facial + Prox. 125 kHz
- IDBLOCKNEXT/BQC/IN/B1FP/A/U iDBlock  
Next Facial BQC Inox com Biometria + 1 Facial + Prox. 125 kHz + Urna
- IDBLOCKNEXT/BQC/IN/B1FP/M iDBlock  
Next Facial BQC Inox com Biometria + 1 Facial + Prox. 13,56 MHz
- IDBLOCKNEXT/BQC/IN/B1FP/M/U iDBlock  
Next Facial BQC Inox com Biometria + 1 Facial + Prox. 13,56 MHz + Urna



iDBlock Next Painted with 2 Facial  
Recognition Readers

- IDBLOCKNEXT/BQC/PT/2FP/A iDBlock  
Next Facial BQC Pintada + 2 Faciais + Prox. 125 kHz
- IDBLOCKNEXT/BQC/PT/2FP/A/U iDBlock  
Next Facial BQC Pintada + 2 Faciais + Prox. 125 kHz + Urna
- IDBLOCKNEXT/BQC/PT/2FP/M iDBlock  
Next Facial BQC Pintada + 2 Faciais + Prox. 13,56 MHz
- IDBLOCKNEXT/BQC/PT/2FP/M/U iDBlock  
Next Facial BQC Pintada + 2 Faciais + Prox. 13,56 MHz + Urna
- iDBlock Next Facial Recognition (BQC)  
Painted with Biometrics + 2 Facial Recognitions + Proximity 125 kHz
- IDBLOCKNEXT/BQC/PT/B2FP/A/U iDBlock  
Next Facial Recognition BQC Painted with Biometrics + 2 Facial Recognitions + Proximity 125 kHz + Ballot Box
- IDBLOCKNEXT/BQC/PT/B2FP/M iDBlock  
Next Facial Recognition with Biometrics + 2 Facial Recognitions + Proximity 13.56 MHz
- IDBLOCKNEXT/BQC/PT/B2FP/M/U iDBlock  
Next Facial Recognition BQC Painted Biometrics + 2 Facial Recognitions + Proximity 13.56 MHz + Voting Machine



iDBlock Next Painted with 1 Facial  
Recognition Reader

- IDBLOCKNEXT/BQC/PT/1FP/A iDBlock  
Next Facial BQC Pintada + 1 Facial + Prox. 125 kHz
- IDBLOCKNEXT/BQC/PT/1FP/A/U iDBlock  
Next Facial BQC Pintada + 1 Facial + Prox. 125 kHz + Urna
- IDBLOCKNEXT/BQC/PT/1FP/M iDBlock  
Next Facial BQC Pintada + 1 Facial + Prox. 13,56 MHz
- IDBLOCKNEXT/BQC/PT/1FP/M/U iDBlock  
Next Facial BQC Pintada + 1 Facial + Prox. 13,56 MHz + Urna
- IDBLOCKNEXT/BQC/PT/B1FP/A iDBlock  
Next Facial BQC Pintada com Biometria + 1 Facial + Prox. 125 kHz
- IDBLOCKNEXT/BQC/PT/B1FP/A/U iDBlock  
Next Facial BQC Pintada com Biometria + 1 Facial + Prox. 125 kHz + Urna
- IDBLOCKNEXT/BQC/PT/B1FP/M iDBlock  
Next Facial BQC Pintada com Biometria + 1 Facial + Prox. 13,56 MHz
- IDBLOCKNEXT/BQC/PT/B1FP/M/U iDBlock  
Next Facial BQC Pintada com Biometria + 1 Facial + Prox. 13,56 MHz + Urna

iDBlock Next  
BQC Turnstile Models  
Biometrics and/or Proximity  
(NCM 84798999)



iDBlock Next Stainless Steel Biometrics and Proximity

- IDBLOCKNEXT/BQC/IN/BP/A  
iDBlock Next BQC Inox com Biometria + Prox. 125 kHz
- IDBLOCKNEXT/BQC/IN/BP/A/QR  
iDBlock Next BQC Inox com Biometria + Prox. 125 kHz + QR Code
- IDBLOCKNEXT/BQC/IN/BP/A/U  
iDBlock Next BQC Inox com Biometria + Prox. 125 kHz + Urna
- IDBLOCKNEXT/BQC/IN/BP/A/U/QR  
iDBlock Next BQC Inox com Biometria + Prox. 125 kHz + Urna + QR Code
- IDBLOCKNEXT/BQC/IN/BP/M  
iDBlock Next BQC Inox com Biometria + Prox. 13,56 MHz
- IDBLOCKNEXT/BQC/IN/BP/M/QR  
iDBlock Next BQC Inox com Biometria + Prox. 13,56 MHz + QR Code
- IDBLOCKNEXT/BQC/IN/BP/M/U  
iDBlock Next BQC Inox com Biometria + Prox. 13,56 MHz + Urna
- IDBLOCKNEXT/BQC/IN/BP/M/U/QR  
iDBlock Next BQC Inox com Biometria + Prox. 13,56 MHz + Urna + QR Code

iDBlock Next Stainless Steel Proximity

- IDBLOCKNEXT/BQC/IN/P/A  
iDBlock Next BQC Inox + Prox. 125 kHz
- IDBLOCKNEXT/BQC/IN/P/A/QR  
iDBlock Next BQC Inox + Prox. 125 kHz + QR Code
- IDBLOCKNEXT/BQC/IN/P/A/U  
iDBlock Next BQC Inox + Prox. 125 kHz + Urna
- IDBLOCKNEXT/BQC/IN/P/A/U/QR  
iDBlock Next BQC Inox + Prox. 125 kHz + Urna + QR Code
- IDBLOCKNEXT/BQC/IN/P/M  
iDBlock Next BQC Inox + Prox. 13,56 MHz
- IDBLOCKNEXT/BQC/IN/P/M/QR  
iDBlock Next BQC Inox + Prox. 13,56 MHz + QR Code
- IDBLOCKNEXT/BQC/IN/P/M/U  
iDBlock Next BQC Inox + Prox. 13,56 MHz + Urna
- IDBLOCKNEXT/BQC/IN/P/M/U/QR  
iDBlock Next BQC Inox + Prox. 13,56 MHz + Urna + QR Code



iDBlock Next Painted Biometrics and Proximity

- IDBLOCKNEXT/BQC/PT/BP/A  
iDBlock Next BQC Pintada com Biometria + Prox. 125 kHz
- IDBLOCKNEXT/BQC/PT/BP/A/QR  
iDBlock Next BQC Pintada com Biometria + Prox. 125 kHz + QR Code
- IDBLOCKNEXT/BQC/PT/BP/A/U  
iDBlock Next BQC Pintada com Biometria + Prox. 125 kHz + Urna
- IDBLOCKNEXT/BQC/PT/BP/A/U/QR  
iDBlock Next BQC Pintada com Biometria + Prox. 125 kHz + Urna + QR Code
- IDBLOCKNEXT/BQC/PT/BP/M  
iDBlock Next BQC Pintada com Biometria + Prox. 13,56 MHz
- IDBLOCKNEXT/BQC/PT/BP/M/QR  
iDBlock Next BQC Pintada com Biometria + Prox. 13,56 MHz + QR Code
- IDBLOCKNEXT/BQC/PT/BP/M/U  
iDBlock Next BQC Pintada com Biometria + Prox. 13,56 MHz + Urna
- IDBLOCKNEXT/BQC/PT/BP/M/U/QR  
iDBlock Next BQC Pintada com Biometria + Prox. 13,56 MHz + Urna + QR Code

iDBlock Next Painted Proximity

- IDBLOCKNEXT/BQC/PT/P/A  
iDBlock Next BQC Pintada + Prox. 125 kHz
- IDBLOCKNEXT/BQC/PT/P/A/QR  
iDBlock Next BQC Pintada + Prox. 125 kHz + QR Code
- IDBLOCKNEXT/BQC/PT/P/A/U  
iDBlock Next BQC Pintada + Prox. 125 kHz + Urna
- IDBLOCKNEXT/BQC/PT/P/A/U/QR  
iDBlock Next BQC Pintada + Prox. 125 kHz + Urna + QR Code
- IDBLOCKNEXT/BQC/PT/P/M  
iDBlock Next BQC Pintada + Prox. 13,56 MHz
- IDBLOCKNEXT/BQC/PT/P/M/QR  
iDBlock Next BQC Pintada + Prox. 13,56 MHz + QR Code
- IDBLOCKNEXT/BQC/PT/P/M/U  
iDBlock Next BQC Pintada + Prox. 13,56 MHz + Urna
- IDBLOCKNEXT/BQC/PT/P/M/U/QR  
iDBlock Next BQC Pintada + Prox. 13,56 MHz + Urna + QR Code

# iDBlock Facial Smart Turnstile

Control iD has developed a revolutionary turnstile capable of accommodating up to two installed iDFaces, which control both the entry and exit of people through facial recognition technology.

The equipment features a custom-made support that also allows operation with only one iDFace installed, in which case it offers control of either the entrance or the exit.

With an innovative, ultra-quiet mechanism and bold design, the iDBlock Facial turnstile can be used in any type of environment. Furthermore, it can operate completely stand-alone via embedded web software, requiring no additional software installation.

Facial recognition. Controls entry and exit with up to 2 iDFaces. Revolutionary ultra-quiet mechanism. 4.3" color touchscreen display. TCP/IP communication. Stand-alone and online operation. Modern and innovative design.

## MODELS (NCM 84798999)

IDBLOCK/PT/2FP/A iDBlock Facial Black with 2 Faces + Proximity 125 kHz ASK	IDBLOCK/PT/1FP/A iDBlock Facial Preta com 1 Facial + Prox. 125 kHz ASK
IDBLOCK/IN/2FP/A iDBlock Facial Inox com 2 Faciais + Prox. 125 kHz ASK	IDBLOCK/PT/1FP/M iDBlock Facial Preta com 1 Facial + Prox. MIFARE™
IDBLOCK/PT/2FP/M iDBlock Black Face Mask with 2 Face Recognition + Proximity MIFARE™	IDBLOCK/IN/1FP/A iDBlock Facial Inox com 1 Facial + Prox. 125 kHz ASK
IDBLOCK/IN/2FP/M iDBlock Facial Inox com 2 Faciais + Prox. MIFARE™	IDBLOCK/IN/1FP/M iDBlock Facial Inox com 1 Facial + Prox. MIFARE™

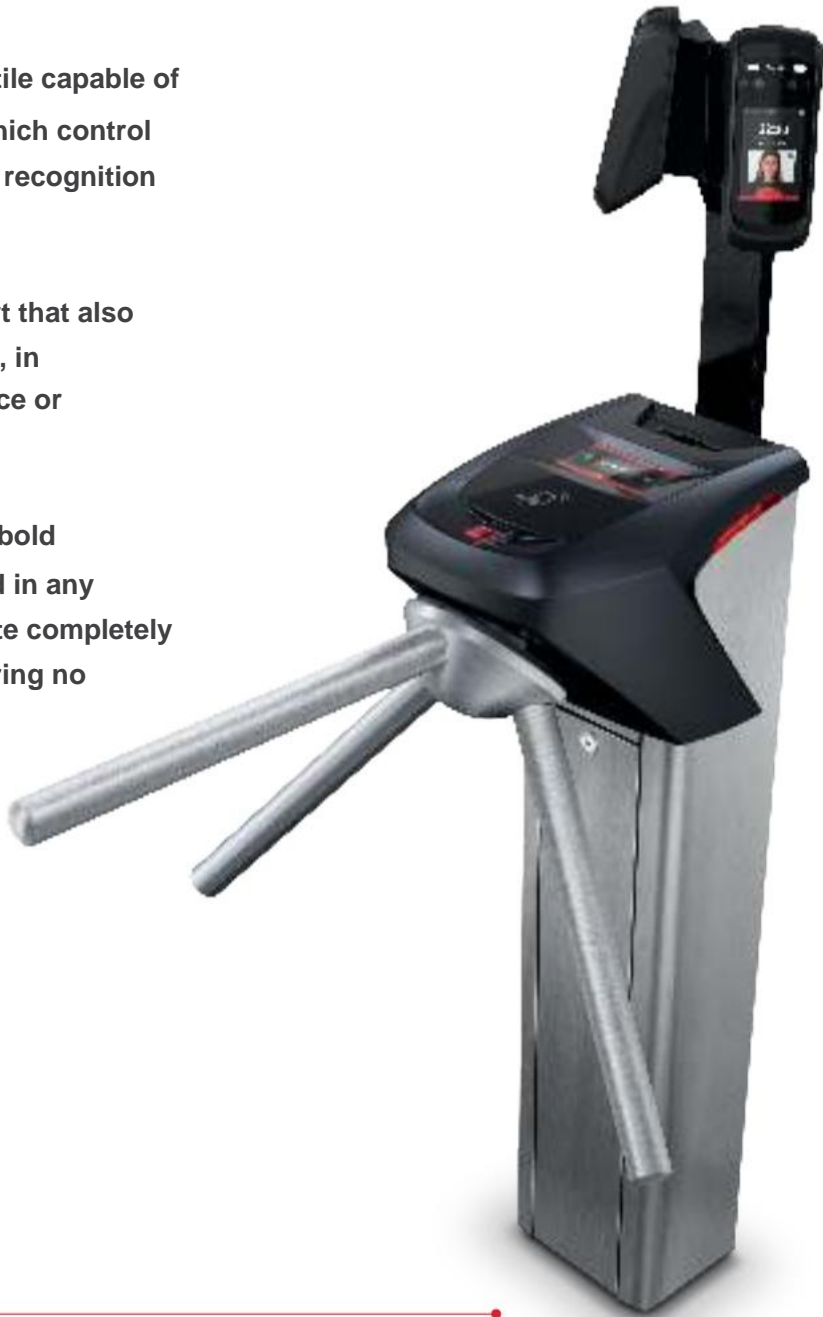

# iDBlock Facial Smart Turnstile

## TECHNICAL SPECIFICATIONS

### ACCESS CONTROL

- People Control  
Defining the direction of rotation release and confirming passage.
- Anti-Double Entry  
Blocking multiple passages in the same direction.
- Collection Box  
Possibility of validating and collecting visitor badges.
- Number of Users: Capacity for over 200,000 registered users.
- Number of Faces: Capacity for up to 3,000 (Lite)/10,000 (Pro) faces with live face detection.

### MECHANISM

- Durability  
exceeding 800,000 rotations and easy to maintain.
- Sound Noise  
Extremely quiet mechanism

### METHODS OF IDENTIFICATION

- Facial Recognition  
Two 1080p HD cameras in each iDFace (visible light and IR light)
- Proximity Cards (as per model)  
Tecnologias MIFARE™/ 125 kHz ASK
- Fingerprint Reader  
500 DPI optical reader
- Password  
User identification via numeric password
- QR Code  
User identification via QR Code

### COMMUNICATION

- Ethernet 1  
porta Ethernet 10/100Mbps nativa
- RS-485  
1 native RS-485 port with 120 Ohm termination
- RS-232  
1 native RS-232 port
- GPRS  
GPRS connection module (optional)
- Wi-Fi  
Wi-Fi connection module (optional)
- USB  
1 porta USB Host 2.0
- SIP Intercom  
Integrated SIP intercom (Pro version)



### GENERAL CHARACTERISTICS

- Overall dimensions  
795 mm x 1370 mm x 635 mm (D x H x W)
- Food  
Internal 12V/2A power supply included.
- Consumption  
3,5W (300mA) nominal

### USER INTERFACE

- Tela LCD Touchscreen (base)  
4.3" (480x272) color TFT LCD display with capacitive touchscreen\*
- LCD Touchscreen display in each iDFace: 3.5" (320x480) color TFT LCD display with capacitive touchscreen\*
- Integrated Web Software  
Complete browser-based access control management software
- Audio  
Built-in speaker and microphone



# iDBlock Facial Mini Smart Turnstile

Control iD has developed a revolutionary turnstile capable of accommodating up to two installed iDFaces, which control both the entry and exit of people through facial recognition technology.

The equipment features a custom-made support that also allows operation with only one iDFace installed, in which case it offers control of either the entrance or the exit.

With an innovative, ultra-quiet mechanism and compact design, the iDBlock Facial Mini turnstile is ideal for schools and environments with children's traffic. Furthermore, it can operate completely stand-alone via embedded web software, requiring no additional software installation.

Facial recognition. Controls entry and exit with 2 iDFaces. Revolutionary ultra-quiet mechanism. 4.3" color touchscreen display. TCP/IP communication. Stand-alone and online operation. Modern and innovative design.



# iDBlock Facial Mini Smart Turnstile

## TECHNICAL SPECIFICATIONS

### ACCESS CONTROL

- People Control  
Defining the direction of rotation release and confirming passage.
- Anti-Double Entry  
Blocking multiple passages in the same direction.
- Number of Users: Capacity for over 200,000 registered users.
- Number of Faces: Capacity for up to 3,000 (Lite)/10,000 (Pro) faces with live face detection.

### MECHANISM

- Durability  
exceeding 800,000 rotations and easy to maintain.
- Sound Noise  
Extremely quiet mechanism

### METHODS OF IDENTIFICATION

- Facial Recognition  
Two 1080p HD cameras in each iDFace (visible light and IR light)
- Proximity Cards (as per model)  
Tecnologias MIFARETM/ 125 kHz ASK
- Fingerprint Reader  
500 DPI optical reader
- Password  
User identification via numeric password
- QR Code  
User identification via QR Code

### COMMUNICATION

- Ethernet 1  
porta Ethernet 10/100Mbps nativa
- RS-485  
1 native RS-485 port with 120 Ohm termination
- RS-232  
1 native RS-232 port
- GPRS  
GPRS connection module (optional)
- Wi-Fi  
Wi-Fi connection module (optional)
- USB  
1 porta USB Host 2.0
- SIP Intercom  
Integrated SIP intercom (Pro version)



### GENERAL CHARACTERISTICS

- Overall dimensions  
743 mm x 927 mm x 568 mm (D x H x W)
- Food  
Internal 12V/2A power supply included.
- Consumption  
3,5W (300mA) nominal
- Cor  
Black or Stainless Steel

### USER INTERFACE

- Tela LCD Touchscreen (base)  
4.3" (480x272) color TFT LCD display with resistive touchscreen\*
- LCD Touchscreen display in each iDFace: 3.5" (320x480) color TFT LCD display with capacitive touchscreen\*
- Integrated Web Software  
Complete browser-based access control management software
- Audio  
Built-in speaker and microphone

# iDBlock Smart Turnstile

Always striving for innovation, Control iD, using the most modern technologies, has developed a revolutionary turnstile. With an innovative, ultra-quiet mechanism and bold design, the iDBlock turnstile can be used in any type of environment.

The product features a touchscreen display, enabling a user-friendly and intuitive interaction. Furthermore, it can operate completely stand-alone via embedded web software, requiring no additional software installation.

Revolutionary ultra-quiet mechanism; 4.3" color touchscreen display; TCP/IP communication; Stand-alone and online operation; Modern and innovative design.



## MODELS (NCM 84798999)

<b>IDBLOCK/PT/P/A</b> Proximity 125 kHz ASK	<b>IDBLOCK/IN/P/A</b> Proximity 125 kHz ASK
<b>IDBLOCK/PT/P/M</b> MIFARE™ Proximity	<b>IDBLOCK/IN/P/M</b> MIFARE™ Proximity
<b>IDBLOCK/PT/BP/A</b> Proximity 125 kHz ASK + Biometrics	<b>IDBLOCK/IN/BP/A</b> Proximity 125 kHz ASK + Biometrics
<b>IDBLOCK/PT/BP/M</b> MIFARE™ Proximity + Biometrics	<b>IDBLOCK/IN/BP/M</b> MIFARE™ Proximity + Biometrics

# iDBlock Smart Turnstile

## TECHNICAL SPECIFICATIONS

### ACCESS CONTROL

- People Control  
Defining the direction of rotation release and confirming passage.
- Anti-Double Entry  
Blocking multiple passages in the same direction.
- Collection Box  
Possibility of validating and collecting visitor badges.
- Number of Users: Capacity for over 200,000 registered users (card/password)

Number of Fingerprints  
(depending on model): Capacity for 2,000/10,000 fingerprints offline and over 100,000 online.

### MECHANISM

- Durability  
exceeding 800,000 rotations and easy to maintain.
- Sound Noise  
Extremely quiet mechanism

### METHODS OF IDENTIFICATION

- Biometric Reader  
500 DPI optical fingerprint reader
- Proximity Cards (as per model)  
MIFARE™ / 125 kHz (ASK, FSK and PSK) / HID (various standards)
- Password  
User identification via numeric password
- QR Code (as per template)  
User identification via QR Code

### COMMUNICATION

- Ethernet 1  
porta Ethernet 10/100Mbps nativa
- RS-485  
1 native RS-485 port with 120 Ohm termination
- RS-232  
1 native RS-232 port
- GPRS  
GPRS connection module (optional)
- Wi-Fi  
Wi-Fi connection module (optional)

### USER INTERFACE

- 4.3" (480x272) color TFT  
LCD touchscreen display with resistive touchscreen.
- Integrated Web Software  
Complete browser-based access control management software



### GENERAL CHARACTERISTICS

- Overall dimensions  
772 mm x 950 mm x 635 mm (D x H x W)
- Food  
Internal 12V/2A power supply included.
- Consumption  
3,5W (300mA) nominal

### INTERCONNECTION DIAGRAM

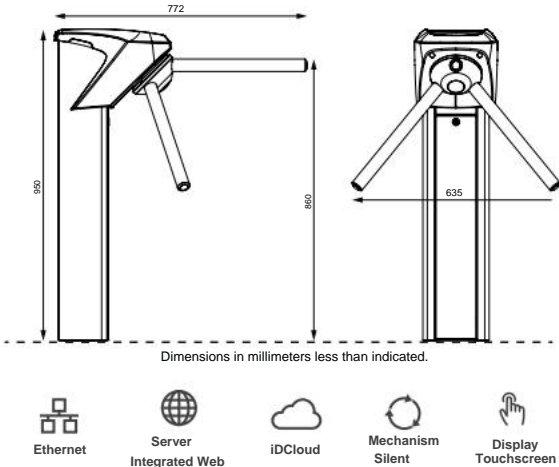

# Smart Turnstile iDBlock QRCode

Always striving for innovation, Control iD, using the most modern technologies, has developed a revolutionary turnstile.

With an innovative, ultra-quiet mechanism and bold design, the iDBlock QR Code turnstile can be used in any type of environment.

The product features a touchscreen display, enabling a user-friendly and intuitive interaction.

Furthermore, it can operate completely stand-alone via embedded web software, requiring no additional software installation.

Revolutionary ultra-quiet mechanism.  
4.3" color  
touchscreen display.  
TCP/IP communication  
Stand-alone and online operation  
Modern and innovative design



# iDBlock QRCode Smart Turnstile

## TECHNICAL SPECIFICATIONS

### ACCESS CONTROL

- People Control  
Defining the direction of rotation release and confirming passage.
- Anti-Double Entry  
Blocking multiple passages in the same direction.
- Collection Box  
Possibility of validating and collecting visitor badges.
- Number of Users  
Capacity for over 200,000 registered users. (card/password)
- Number of fingerprints (as per model)  
Capacity for 2,000/10,000 offline digital records and over 100,000 online.

### MECHANISM

- Durability  
Greater than 800,000 RPM and easy to maintain.
- Sound Noise  
Extremely quiet mechanism

### METHODS OF IDENTIFICATION

- Biometric Reader  
500 DPI optical fingerprint reader
- Proximity Cards (as per model)  
MIFARE™ / 125 kHz (ASK, FSK and PSK) / HID (various standards)
- Password  
User identification via numeric password
- QR Code  
User identification via QR Code

### COMMUNICATION

- Ethernet  
1 native 10/100Mbps Ethernet port
- RS-485  
1 native RS-485 port with 120 Ohm termination
- RS-232  
1 native RS-232 port
- GPRS  
GPRS connection module (optional)
- Wi-Fi  
Wi-Fi connection module (optional)

### USER INTERFACE

- 4.3" (480x272) color TFT  
LCD touchscreen display with resistive touchscreen.
- Integrated Web Software  
Complete browser-based access control management software



### GENERAL CHARACTERISTICS

- Overall dimensions  
772 mm x 950 mm x 635 mm (P x A x L)
- Food  
Internal 12V/2A power supply included.
- Consumption  
3,5W (300mA) nominal

### INTERCONNECTION DIAGRAM

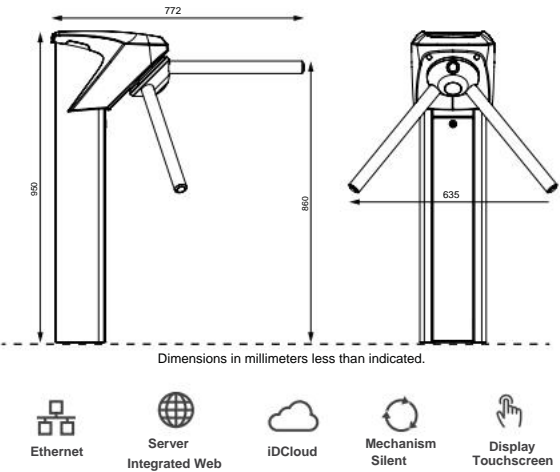



# Smart Turnstile iDBlock Articulated Arm

Always striving for innovation, Control iD, using the most modern technologies, has developed a revolutionary turnstile.

Featuring an articulated arm mechanism for emergencies and a bold design, the iDBlock turnstile can be used in any type of environment.

The product features a touchscreen. enabling a friendly interaction and intuitive for the user.

Furthermore, it can operate completely stand-alone via embedded software, requiring no... from installing additional software.

- Articulated arm mechanism for emergencies
- 7" Colorful Touchscreen Display
- TCP/IP communication
- Stand-alone and online operation
- Modern and innovative design

## MODELS (NCM 84798999)

**IDBLOCK/BQC/PT/BP/A**  
Proximity 125 kHz ASK + Biometrics

**IDBLOCK/BQC/PT/BP/M**  
MIFARE™ Proximity + Biometrics

**IDBLOCK/BQC/IN/BP/A**  
Proximity 125 kHz ASK + Biometrics

**IDBLOCK/BQC/IN/BP/M**  
MIFARE™ Proximity + Biometrics



# iDBlock Articulated Arm Smart Turnstile

## TECHNICAL SPECIFICATIONS

### ACCESS CONTROL

- People Control**  
Defining the direction of rotation release and confirming passage.
- Anti-Double Entry**  
Blocking multiple passages in the same direction.
- Collection Box**  
Possibility of validating and collecting visitor badges.
- Number of Users**  
Capacity for over 200,000 registered users. (card/password)
- Number of fingerprints (as per model)**  
Capacity for 2,000/10,000 offline digital records and over 100,000 online.

### MECHANISM

- Durability**  
Greater than 800,000 RPM and easy to maintain.
- Sound Noise**  
Extremely quiet mechanism

### METHODS OF IDENTIFICATION

- Biometric Reader**  
500 DPI optical fingerprint reader
- Proximity Cards (as per model)**  
MIFARE™ / 125 kHz (ASK, FSK, and PSK) / HID (various standards)
- Password**  
User identification via numeric password
- QR Code (as per template)**  
User identification via QR Code

### COMMUNICATION

- Ethernet**  
1 native 10/100Mbps Ethernet port
- RS-485**  
1 native RS-485 port with 120 Ohm termination
- RS-232**  
1 native RS-232 port
- GPRS**  
GPRS connection module (optional)
- Wi-Fi**  
Wi-Fi connection module (optional)

### USER INTERFACE

- Tela LCD Touchscreen**  
7" (800x480) color TFT LCD display with resistive touchscreen.
- Integrated Web Software**  
Complete browser-based access control management software



### GENERAL CHARACTERISTICS

- Overall dimensions**  
826 mm x 1069 mm x 250 mm (P x A x L)
- Food**  
Internal 12V/2A power supply included.
- Consumption**  
3,5W (300mA) nominal

### INTERCONNECTION DIAGRAM

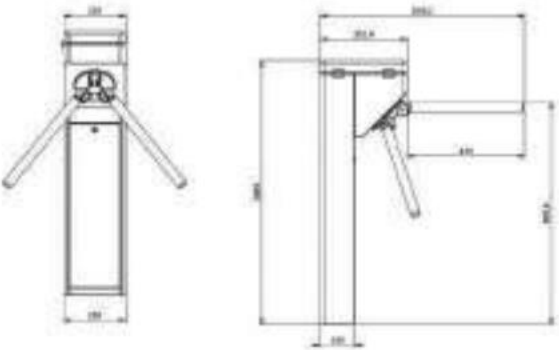

# Smart Turnstile

## iDBlock PcD Facial

Always striving for innovation, Control iD, Using the latest technologies, he developed a turnstile designed for people with special needs.

With a horizontal articulated arm mechanism and a bold design, the turnstile can be installed in various environments to make them more accessible to the public.

The iDBlock PcD Facial can be equipped with up to two installed iDFaces, which control both the entry and exit of people through facial recognition technology. In addition, the product features a touchscreen enabling a user-friendly and intuitive interaction and can operate completely stand-alone via embedded software, requiring no additional software installation.

- Facial recognition\*
- Controls entry and exit with up to 2 iDFaces\*
- Horizontal articulated arm mechanism
- 7" Colorful Touchscreen Display
- TCP/IP communication
- Stand-alone and online operation
- Modern and innovative design

\*As per model

### MODELS (NCM 84798999)

**IDBLOCK/PNEIN/2FP/A**  
iDBlock PcD Facial + 2 Faciais + Prox. 125 kHz ASK

**IDBLOCK/PNEIN/2FP/A/U**  
iDBlock PcD Facial + 2 Faciais + Prox. 125 kHz ASK + Urna

**IDBLOCK/PNEIN/2FP/B/A**  
iDBlock PcD Facial + 2 Facial Recognition + Biometrics + Proximity 125 kHz ASK

**IDBLOCK/PNEIN/2FP/B/A/U**  
iDBlock PcD Facial + 2 Facial Recognition + Biometrics + Proximity 125 kHz ASK + Ballot Box

**IDBLOCK/PNEIN/2FP/B/M**  
iDBlock PcD Facial + 2 Facial Recognitions + Biometrics + Proximity MIFARE™

**IDBLOCK/PNEIN/2FP/B/M/U**  
iDBlock PcD Facial + 2 Facial Recognitions + Biometrics + Proximity MIFARE™ + Ballot Box

**IDBLOCK/PNEIN/2FP/M**  
iDBlock PcD Facial + 2 Faciais + Prox. MIFARE™

**IDBLOCK/PNEIN/2FP/M/U**  
iDBlock PcD Facial + 2 Facial Recognition + Proximity MIFARE™ + Ballot Box



# iDBlock PcD Facial

## Smart Turnstile

### TECHNICAL SPECIFICATIONS

#### ACCESS CONTROL

**People Control**  
Defining the direction of rotation release and confirming passage.

**Anti-Double Entry**  
Blocking multiple passages in the same direction.

**Collection Box**  
Possibility of validating and collecting visitor badges.

**Number of Users**  
Capacity for over 200,000 registered users.  
(card/password)

**Number of fingerprints (as per model)**  
Capacity for 2,000/10,000 offline digital records and over 100,000 online.

**Number of Faces**  
Capacity for up to 3,000 (Lite)/10,000 (Pro) faces with live face detection.

#### MECHANISM

**Durability**  
Greater than 800,000 RPM and easy to maintain.

**Sound Noise**  
Extremely quiet mechanism

#### METHODS OF IDENTIFICATION

**Facial Recognition**  
Two 1080p HD cameras in each iDFace (visible light and IR light)\*

**Biometric Reader**  
500 DPI optical fingerprint reader

**Proximity Cards (as per model)**  
MIFARE™ / 125 kHz (ASK, FSK and PSK) / HID (various standards)

**Password**  
User identification via numeric password

**QR Code (as per template)**  
User identification via QR Code

#### COMMUNICATION

**Ethernet**  
1 native 10/100Mbps Ethernet port

**RS-485**  
1 native RS-485 port with 120 Ohm termination

**RS-232**  
1 native RS-232 port

**GPRS**  
GPRS connection module (optional)

**Wi-Fi**  
Wi-Fi connection module (optional)



#### GENERAL CHARACTERISTICS

**Overall dimensions**  
1112 mm x 1010 mm x 250 mm (P x A x L)

**Food**  
Internal 12V/2A power supply included.

**Consumption**  
3,5W (300mA) nominal

#### USER INTERFACE

**Tela LCD Touchscreen (base)**  
7" (800x480) color TFT LCD display with resistive touchscreen.

**LCD touchscreen display on each iDFace**  
3.5" (320x480) color TFT LCD display with capacitive touchscreen\*

**Integrated Web Software**  
Complete browser-based access control management software

**Audio**  
Built-in speaker and microphone

#### INTERCONNECTION DIAGRAM

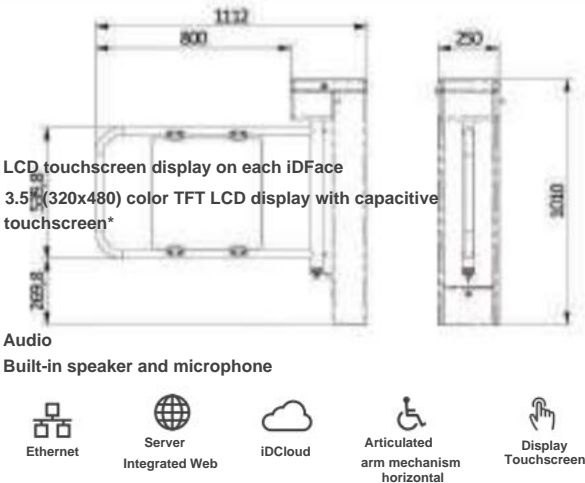

iDBlock Smart Turnstile  
for People with Disabilities

Always striving for innovation, Control iD, using the most modern technologies, has developed a turnstile designed for people with special needs.

With a horizontal articulated arm mechanism and a bold design, the iDBlock PNE turnstile can be installed in various environments to make them more accessible to the public.

The product features a touchscreen, enabling a user-friendly and intuitive interaction.

Furthermore, it can operate completely stand-alone via embedded software, requiring no additional software installation.

- Horizontal articulated arm mechanism 7” color touchscreen display TCP/IP communication Stand-alone and online operation Modern and innovative design

MODELS (NCM 84798999)

- IDBLOCK/PNEIN/BP/A  
Proximity 125 kHz ASK + Biometrics
- IDBLOCK/PNEIN/BP/M  
MIFARE™ Proximity + Biometrics



iDBlock PNE  
Smart Turnstile

TECHNICAL SPECIFICATIONS

ACCESS CONTROL

- People Control  
Defining the direction of rotation release and confirming passage.
- Anti-Double Entry  
Blocking multiple passages in the same direction.
- Collection Box  
Possibility of validating and collecting visitor badges.
- Number of Users: Capacity for  
over 200,000 registered users (card/password)

- Number of fingerprints (as per model)  
Capacity for 2,000/10,000 offline digital records and  
over 100,000 online.

MECHANISM

- Durability  
exceeding 800,000 rotations and easy to maintain.
- Sound Noise  
Extremely quiet mechanism

METHODS OF IDENTIFICATION

- Biometric Reader  
500 DPI optical fingerprint reader
- Proximity Cards (as per model)  
MIFARE™ / 125 kHz (ASK, FSK and PSK) / HID (various standards)
- Password  
User identification via numeric password
- QR Code (as per template)  
User identification via QR Code

COMMUNICATION

- Ethernet 1  
porta Ethernet 10/100Mbps nativa
- RS-485  
1 native RS-485 port with 120 Ohm termination
- RS-232  
1 native RS-232 port
- GPRS  
GPRS connection module (optional)
- Wi-Fi  
Wi-Fi connection module (optional)

USER INTERFACE

- Tela LCD Touchscreen  
7” (800x480) color TFT LCD display with resistive  
touchscreen.
- Integrated Web Software  
Complete browser-based access control  
management software



GENERAL CHARACTERISTICS

- Overall dimensions  
1112 mm x 1010 mm x 250 mm (D x H x W)
- Food  
Internal 12V/2A power supply included.
- Consumption  
3,5W (300mA) nominal

INTERCONNECTION DIAGRAM

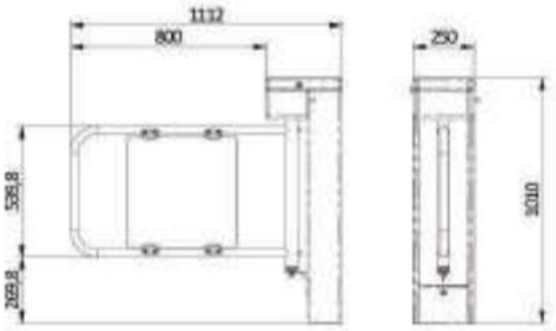



iDBlock Smart Turnstile  
with Facial Recognition Access Control

Control iD brings to market a revolutionary turnstile with a unique design and up to two installed iDFaces Max, which control both the entry and exit of people through facial recognition technology. The equipment has an integrated support that allows operation with only one iDFace Max installed, offering combined entry or exit control. With an innovative, ultra-quiet mechanism and bold design, the iDBlock Countertop turnstile with iDFace Max can be used in any type of environment. Furthermore, it can operate completely stand-alone via embedded web software, requiring no additional software installation.

Facial recognition. Controls entry and exit with up to 2 iDFaces Max. Revolutionary mechanism. TCP/IP communication. Stand-alone and online operation. Modern and innovative design.

MODELS (NCM 84798999)

IDBLOCK/BAL/IN/1FMAX/A iDBlock Stainless Steel Facial Countertop + 1 Facial + Proximity 125 kHz	IDBLOCK/BAL/IN/1FMAX/M iDBlock Stainless Steel Facial Recognition Counter + 1 Facial Recognition + Proximity 13.56 MHz
IDBLOCK/BAL/IN/1FMAX/A/U iDBlock Stainless Steel Facial Countertop + 1 Facial + Proximity 125 kHz + Ballot Box	IDBLOCK/BAL/IN/1FMAX/M/U iDBlock Stainless Steel Facial Recognition Counter + 1 Facial Recognition Sensor + Proximity 13.56 MHz + Ballot Box
IDBLOCK/BAL/IN/1FMAX/BP/A iDBlock Stainless Steel Facial Countertop + 1 Facial Recognition + Biometrics + Proximity 125 kHz	IDBLOCK/BAL/IN/2FMAX/A iDBlock Stainless Steel Facial Countertop + 2 Facial Devices + Proximity 125 kHz
IDBLOCK/BAL/IN/1FMAX/BP/A/U iDBlock Stainless Steel Facial Recognition Counter + 1 Facial Recognition + Biometrics + Proximity 125 kHz + Ballot Box	IDBLOCK/BAL/IN/2FMAX/BP/A iDBlock Stainless Steel Facial Recognition Counter + 2 Facial Recognition + Biometrics + Proximity 125 kHz
IDBLOCK/BAL/IN/1FMAX/BP/M iDBlock Stainless Steel Facial Recognition Countertop Display + 1 Facial Recognition + Biometrics + Proximity 13.56 MHz	IDBLOCK/BAL/IN/2FMAX/BP/M iDBlock Stainless Steel Facial Recognition Countertop Display + 2 Facial Recognitions + Biometrics + Proximity 13.56 MHz
IDBLOCK/BAL/IN/1FMAX/BP/M/U iDBlock Stainless Steel Facial Recognition Counter + 1 Facial Recognition + Biometrics + Proximity 13.56 MHz + Voting Machine	IDBLOCK/BAL/IN/2FMAX/M iDBlock Stainless Steel Facial Recognition Counter + 2 Facial Recognition + Proximity 13.56 MHz



iDBlock Face Counter  
Smart Turnstile

TECHNICAL SPECIFICATIONS

ACCESS CONTROL

- People Control  
Defining the direction of rotation release and confirming passage.
- Anti-Double Entry  
Blocking multiple passages in the same direction.
- Collection Box  
Possibility of validating and collecting visitor badges.
- Number of Users: Capacity for over 200,000 registered users.
- Number of Faces: Capacity for up to 100,000\* faces with live face detection (\*depending on model)

MECHANISM

- Durability  
Greater than 800,000 RPM and easy maintenance.
- Extremely quiet mechanism.

METHODS OF IDENTIFICATION

- Facial Recognition  
Two 1080p HD cameras on each iDFace Max (visible light and IR light)\*
- Proximity Cards\*  
MIFARE™, 125kHz ASK ou HID
- Biometric Reader\*  
500 DPI optical fingerprint reader
- Password  
User identification via numeric password
- QR Code  
User identification via QR Code

COMMUNICATION

- Ethernet 1  
porta Ethernet 10/100Mbps nativa
- RS-485  
1 native RS-485 port with 120 Ohm termination
- RS-232  
1 native RS-232 port
- GPRS  
GPRS connection module (optional)
- Wi-Fi  
Wi-Fi connection module (optional)
- SIP Intercom  
Integrated SIP intercom compatible with G711

USER INTERFACE

- LCD touchscreen display on each iDFace Max  
7" (800x480) color TFT LCD display with capacitive touch screen
- Integrated Web Software  
Complete browser-based access control management software
- Audio  
Built-in speaker and microphone



GENERAL CHARACTERISTICS

- Overall dimensions  
700 mm x 1432 mm x 1100 mm (D x H x W)
- Food  
Internal 12V/5A power supply included.
- Consumption  
24W (2A) nominal

INTERCONNECTION DIAGRAM

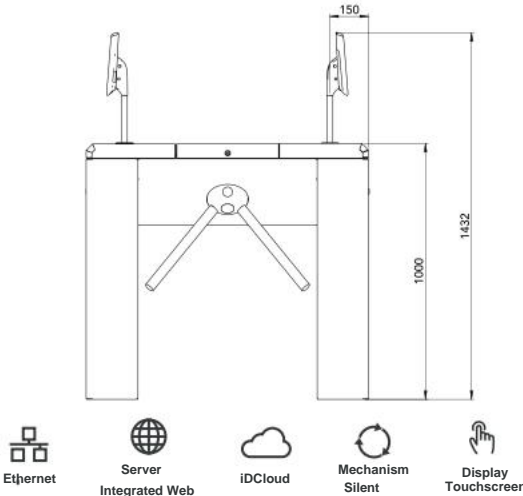

# iDBlock Smart Turnstile for Countertop

Always striving for innovation, Control iD, using the most modern technologies, has developed a revolutionary turnstile. With an innovative, ultra-quiet mechanism and bold design, the iDBlock turnstile can be used in any type of environment. The product features a touchscreen display that allows for a user-friendly and intuitive interaction.

Furthermore, it can operate in stand-alone mode, without the need to install additional software.

Revolutionary ultra-quiet mechanism; 7" color touchscreen display; TCP/IP communication; Stand-alone and online operation; Modern and innovative design.



## MODELS (NCM 84798999)

**IDBLOCK/BAL/IN/BP/A**  
Proximity 125 kHz ASK + Biometrics

**IDBLOCK/BAL/IN/BP/M**  
MIFARE™ Proximity + Biometrics

**IDBLOCK/BAL/IN/P/A**  
Proximity 125kHz ASK

**IDBLOCK/BAL/IN/P/M**  
MIFARE™ Proximity

# iDBlock Counter Smart Turnstile

## TECHNICAL SPECIFICATIONS

### ACCESS CONTROL

**People Control**  
Defining the direction of rotation release and confirming passage.

**Anti-Double Entry**  
Blocking multiple passages in the same direction.

**Collection Box**  
Possibility of validating and collecting visitor badges.

**Number of Users: Capacity for**  
over 200,000 registered users (card/password)

**Number of fingerprints (as per model)**  
Capacity for 2,000/10,000 offline digital records and over 100,000 online.

### MECHANISM

**Durability**  
exceeding 800,000 rotations and easy to maintain.

**Sound Noise**  
Extremely quiet mechanism

### METHODS OF IDENTIFICATION

**Biometric Reader**  
500 DPI optical fingerprint reader

**Proximity Cards (as per model)**  
MIFARE™ / 125 kHz (ASK, FSK and PSK) / HID (various standards)

**Password**  
User identification via numeric password

### COMMUNICATION

**Ethernet 1**  
porta Ethernet 10/100Mbps nativa

**RS-485**  
1 native RS-485 port with 120 Ohm termination

**RS-232**  
1 native RS-232 port

**GPRS**  
GPRS connection module (optional)

**Wi-Fi**  
Wi-Fi connection module (optional)

### USER INTERFACE

**Tela LCD Touchscreen**  
7" (800x480) color TFT LCD display with resistive touchscreen.

**Integrated Web Software**  
Complete browser-based access control management software



### GENERAL CHARACTERISTICS

**Overall dimensions**  
700 mm x 999 mm x 1100 mm (D x H x W)

**Food**  
Internal 12V/2A power supply included.

**Consumption**  
3,5W (300mA) nominal

### INTERCONNECTION DIAGRAM

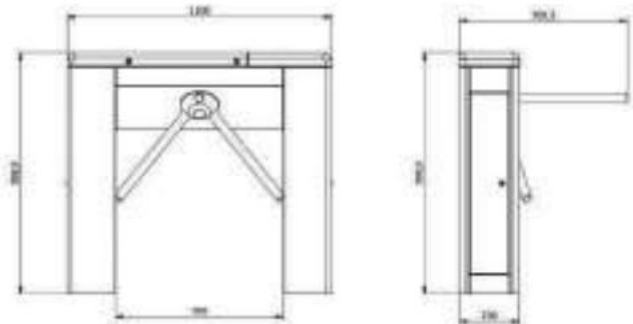

# Access Controller

## FET-100 turnstile

Control iD brings to market the FET-100 Turnstile, ideal for strictly controlled environments, guaranteeing a secure solution that features the most modern identification technologies and premium materials and finishes.

In addition to a modern and innovative design, the turnstile comes ready for integration with various access control software on the market, and can also operate completely stand-alone via embedded software, or online with the powerful iDSecure software.

Modern and innovative design. TCP/IP and USB communication. Wi-Fi and GPRS (optional). Stand-alone and online operation. Available in stainless steel or gray.



### MODELS (NCM 84798999)

- COMPLETE GRAY MODEL (INLET AND OUTLET)
- COMPLETE STAINLESS STEEL MODEL (INLET AND OUTLET)

# FET-100 turnstile

## Access Controller

### TECHNICAL SPECIFICATIONS

#### ACCESS CONTROL

- Number of Users  
According to the installed equipment
- Number of fingerprints (as per model)  
According to the installed equipment
- Number of Faces (as per model)  
According to the installed equipment

#### MECHANISM

- Durability  
Greater than 800,000 RPM and easy to maintain.
- Sound Noise  
Extremely quiet mechanism

#### METHODS OF IDENTIFICATION

- Facial Recognition (as per model)  
Two 1080p HD cameras (visible light and IR light)
- Biometric reader (as per model)  
500 DPI optical fingerprint reader
- Proximity Cards (as per model)  
MIFARE™ / 125 kHz (ASK, FSK, and PSK) / HID (various standards)
- Password  
User identification via numeric password

#### COMMUNICATION

- Ethernet 2  
portas Ethernet 10/100Mbps nativa
- USB  
2 native USB ports
- GPRS  
Optional GPRS connection module
- Wi-Fi  
Optional Wi-Fi connection module



#### GENERAL CHARACTERISTICS

- Overall dimensions  
1,45 M x 1,45 M x 2,20 M (C x L x A)
- Food  
110/220 VAC, 50/60 Hz
- Maximum Power Consumption  
40 W
- Finish  
Stainless steel (AISI304) or powder-coated paint finish.
- Gross Weight  
270 Kg

#### USER INTERFACE

- Tela LCD Touchscreen  
Color TFT LCD display with resistive touchscreen.
- Integrated Web Software  
Complete browser-based access control management software



# Access Control Accessories



Electromagnets  
EIM iDLite e EIM iDPro  
MODELS (NCM 83014000)  
EIM iDLite as a sensor  
EIM iDLite with sensor  
EIM iDPro com sensor



Contactless Pushbutton  
MODEL (NCM 85365090)  
BOT/PROX



Stainless steel push button  
MODEL (NCM 85365090)  
BOT/INOX



USB QR Code Reader  
MODELS (NCM 84719012)  
READER/2D/USB  
READER/2D/WIE



Fonte 12V 2A  
MODEL (NCM 85044021)  
FONTE/2V/2A/WM



Proximity Keyring  
MODELS (NCM 85235210)  
RFID/CHAPTER/125  
RFID/CHAP/MIF



iDFace Support Kit  
MODELS  
MAN/ADAP/BALFMAX  
iDFace Max Support Kit  
MAN/ADAP/BALF  
iDFace Support Kit



UHF day  
MODELS (NCM 85235210)  
RFID/TAG/UHF  
RFID/TAG/UHFPT



Proximity Card  
MODELS (NCM 85235210)  
RFID/CARD/125/CLA  
RFID/CARD/MIF/ISO  
RFID/CARD/125/ISO

Network Router  
Wireless to Ethernet  
iDConnect

With a compact and minimalist design, iDConnect is the ideal solution for adding wireless network connectivity to Control iD products that have Ethernet network connectivity, such as our Access Control and Time Clock lines.

With its 3 operating modes, the iDConnect can be configured to: act as a 4G LTE modem\*, providing internet connection via a Wi-Fi access point and/or its Ethernet port; it can be configured to connect to an existing wireless network to mirror access to that network on its Ethernet port; and finally, it can simply act as a wireless access point to an Ethernet network.

The iDConnect also features an integrated Firewall and VPN to incorporate security and connectivity to virtual private networks. In addition, the device has embedded web software that simplifies its configuration and management of its operating modes.

TCP/IP, Wi-Fi and LTE 4G\* communication  
3 Operating Modes for greater flexibility  
i Firewall com DMZ e Port Forwarding  
Connection support services such as DDNS and OpenVPN

\*As per model

MODELS (NCM 85176241)

IDCONNECT/4GWIFI  
SUP/IDCONNECT  
iDConnect Support



iDConnect  
Network Router  
Wireless to Ethernet

TECHNICAL SPECIFICATIONS

COMMUNICATION

Ethernet  
1 native 10/100Mbps Ethernet port  
Wi-Fi  
Integrated 802.11 b/g/n Wi-Fi connectivity  
4G Cellular Network  
Connectivity with LTE 4G CAT-M1\*

FIREWALL

DMZ  
Establishing a device on the iDConnect network to operate within an unrestricted access zone.  
Port Forwarding  
Support for port forwarding for devices on the iDConnect network.

SERVICES

DDNS  
DDNS support to facilitate locating the public IP address of the location where iDConnect is connected.  
OpenVPN  
Support for virtual private networks with OpenVPN.



GENERAL CHARACTERISTICS

Overall dimensions  
57 mm x 74mm x 54 mm (L x P x A – com antenna)  
57 mm x 61mm x 25 mm (L x P x A – sem antenna)  
Equipment weight  
39 g / 46 g (with antenna)\*  
Food  
External 5V 1A power supply (provided via USB)

USER INTERFACE

Integrated Web Software  
Complete software for managing and configuring via browser.  
LED RGB  
Colored LED indicating the operational status of the equipment.

OPERATING MODES

1- Ethernet and/or Wi-Fi (AP) for 4G \*



2- Ethernet to Wi-Fi (Client)



3- Ethernet e Wi-Fi (AP)



\*As per Model

# Charger Timed iDPower

With a modern and intuitive design, the iDPower is a 14VDC timed power supply capable of providing power and protection for a wide variety of access control systems.

Through its state-of-the-art analog and digital circuits, it is possible to efficiently and safely power numerous pieces of equipment installed in the same plant with just one unit of the product.

Furthermore, iDPower offers customized outputs and compatibility with 12V/7Ah batteries, enabling integration with alarm systems and ensuring the operation of plant devices even during power grid instabilities.

## Í Saída DC 14V/3A

- Timer relay\*
- Compatible with 12V/7Ah battery indicator LEDs
- Signaling relays for alarm systems\*

\*As per model

## MODELS (NCM 85044029)

IDPOWER



# iDPower Charger Timed

## TECHNICAL SPECIFICATIONS

### ELECTRICAL CHARACTERISTICS

Input voltage  
127/220 VAC - 50 e 60Hz

Output Voltage  
14 VDC

Output Current  
3 A

Rated Power  
42 W

### INTERFACES

LEDs  
LEDs indicating AC mains power, DC output, and battery level.

Battery  
Native wiring harness compatible with 12V 7Ah model batteries\*\*

Time Relay\*  
Configurable NO and NC relay (0-30s)

AC Relay\*  
AC mains indicator output relay

Relevant Status Bateria\*  
Low battery indicator output relay

\*As per model  
\*\*Battery sold separately\*\*

### PROTECTIONS

- AC mains input overcurrent (Fuse)
- Short circuit and overload on the DC output.
- Overvoltage during battery charging
- Reversing the polarity of the battery



### GENERAL CHARACTERISTICS

Overall dimensions  
213 x 261 x 95 mm (L x A x P)

Weight of the Equipment without Battery  
730g

Material  
Flame-retardant plastic housing (ABS V0)

Normal Operating Temperature  
0 - 40 °C

### INTERCONNECTION DIAGRAM

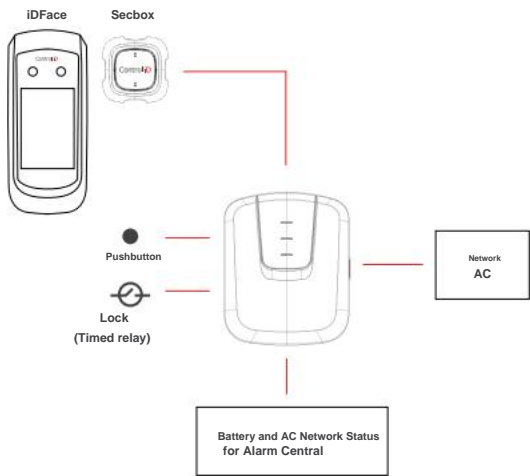



Proximity Reader  
Intelligent  
iDProx USB

With a modern and ergonomic design,  
The iDProx USB proximity reader is  
the ideal device for automating the  
process of reading RFID cards and tags.

Its USB 2.0 interface, combined with its  
dedicated hardware, allows data stored on  
a card to be transmitted quickly and efficiently  
to a computer, without the need for...

Installation of additional software.

Furthermore, the product has a unique feature.  
to allow changing the format  
output of information to facilitate  
integration with the most varied  
existing systems not on the market.

- Interface USB 2.0
- Plug and Play
- Compatible with Mifare and 125kHz technologies\*
- Compact and ergonomic design.
- Easy to use

\*As per model

MODELS (NCM 85437099)

IDPROX/USB/A  
ASK iDProx USB 125 kHz Reader

IDPROX/USB/M  
iDProx USB MIFARE™ Reader



iDProx USB  
Proximity Reader  
Intelligent

TECHNICAL SPECIFICATIONS

COMPATIBLE TECHNOLOGIES

Proximity Cards (as per model)  
MIFARE™ or 125 kHz ASK

Proximity tags (keychains) (as per model)  
MIFARE™ ou 125 kHz ASK

COMMUNICATION AND INTERFACES

Interface USB 2.0  
High-speed communication

Audible signal  
Internal buzzer for improved usability.

Integrated USB cable  
1.5m length for greater flexibility.

INTEGRATION

Drivers  
Windows (XP/2003/Vista/7/8/10), Linux e Android

Integration kit  
Available for free on Windows, Linux, and Android.

Integration examples  
Available for free in several languages.  
(C, C++, C#, Java, etc)



GENERAL CHARACTERISTICS

Overall dimensions  
67 x 67 x 69 mm (A x L x P)

Equipment weight  
120g

Food  
5V (supplied via USB)

Total Consumption  
< 500 mW

INTERCONNECTION DIAGRAM

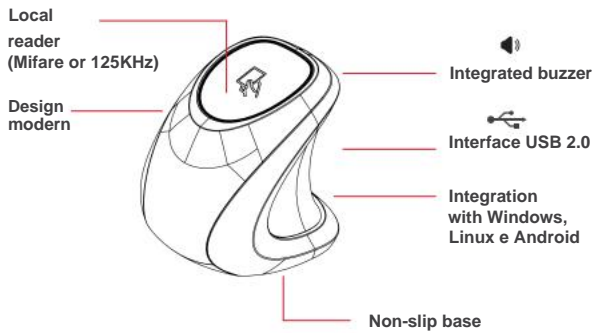

# Software for Access Control iD Secure Cloud

The iD Secure Cloud platform, developed by Control iD, allows you to control access for people and vehicles in companies of all sizes. With it, equipment configuration is simple and intuitive, and management is done quickly and securely.

The system can be accessed via a web browser on any device. The solution also features an exclusive app for iOS and Android that allows for visitor registration, remote opening, and viewing of access logs.

The platform allows you to configure customized access rules and generate detailed reports to make your operation easier and more intuitive.

- 100% cloud-based system
- Customizable access rules
- Mobile app (iOS and Android)
- Real-time monitoring
- Customizable reports
- Modern interface

### MODELS

- Plano IDSECURE CLOUD
- 1 device - 100 users - Free app
- Additional equipment
- 100 additional users

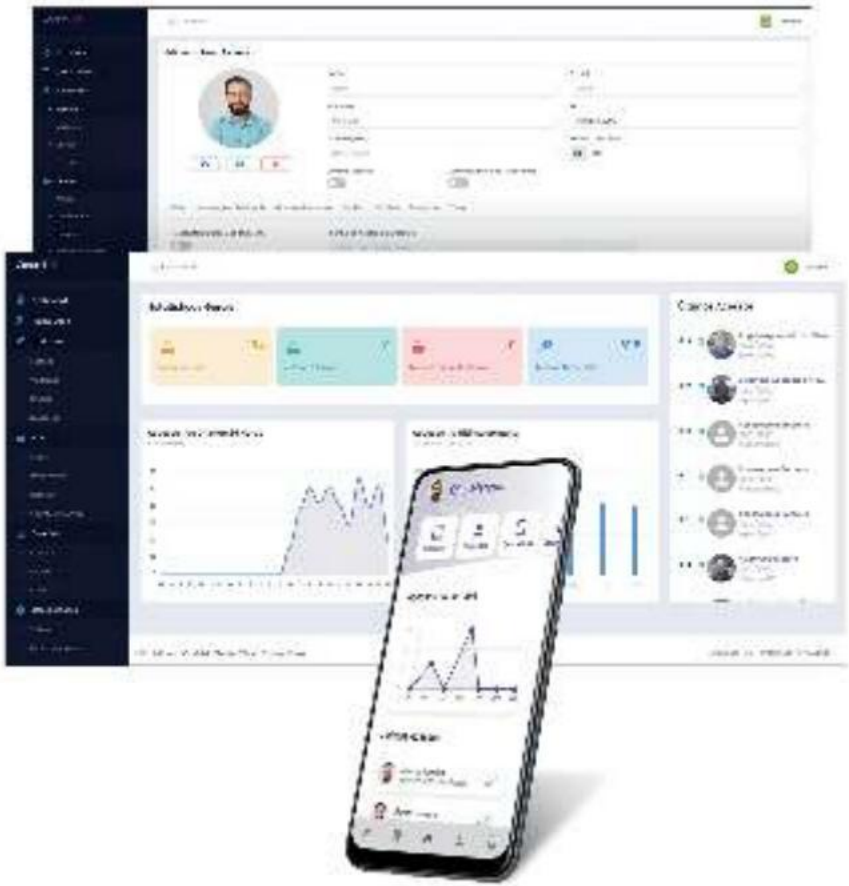

# iD Secure Cloud Access Control Software

## TECHNICAL SPECIFICATIONS

### EASY TO USE

The iD Secure Cloud solution was developed with a focus on usability, making the experience for managers and security professionals as intuitive as possible. The cloud-based software and mobile app allow for real-time access management from any device, anywhere.

### Access Rules and Reports

The configuration of complex rules based on companies, groups, schedules, and types (visitors and individuals) ensures the system's compatibility with the most advanced security requirements.

### Connectivity and Integration

All Control iD access controllers (e.g., iDFace, iDFit, iDBox, and iDBlock) are natively integrated with iD Secure Cloud and can be easily managed. Additionally, the system allows integration with card and/or biometric access control systems for PCs.

### A version for every need.

Control iD's solution also allows integration via API, offering versatility and security for the development of a wide variety of applications.

### COMPLETE SOLUTION FOR ACCESS CONTROL





**RESOURCES  
HUMANS**



# Electronic Time Clock REP iDClass Facial

Revolutionizing once again  
the market for Recorders  
Time and Attendance Electronics, by Control iD  
brings to market the REP iDClass Facial.  
In accordance with the Ordinance  
671/2021, the product uses the  
facial recognition technology  
for user identification.

Its touchscreen display enables  
a friendly and intuitive interaction  
and its innovative design, size  
Reduced size and robustness reaffirm the  
Control iD's leadership in the segment.

Facial recognition, proximity card and  
password identification;  
High-speed printing mechanism and  
robust guillotine cutter;  
Capacity for rolls up to 400m (10,000+  
tickets per roll); TCP/IP  
communication, embedded web  
server and two USB ports  
(Wi-Fi and GPRS optional)



### MODELS (NCM 85437099)

REP/671/FP/ASK  
REP iDClass Facial Prox ASK

REP/671/FP/MIF  
REP iDClass Facial Prox MIFARE™

## REP iDClass Facial

### TECHNICAL SPECIFICATIONS

#### TIME AND ATTENDANCE CONTROL

Ordinance 671/2021  
Product in compliance with MTE Ordinance 671.  
Number of Employees: Capacity  
for 15,000 registered users.  
Number of Faces: Capacity  
for 3,000 (standard) / 10,000 (Pro license) faces

#### METHODS OF IDENTIFICATION\*

Facial Recognition  
Two Full HD 1080p cameras (visible light and infrared light)  
Proximity Cards  
Compatible with MIFARE™ or 125 kHz ASK technology.  
Password  
User identification via numeric password

#### PRINTER AND ROLL

Roll Compartment: Capacity for  
rolls up to 400m (10,000+ tickets per roll)

Printing Mechanism  
High-quality Seiko (Japan) printing mechanism  
Automatic Ticket Cut  
High-speed guillotine printer

Print Speed  
Print speed of 100 mm/s

Detecting the Amount of Paper Remaining  
Allows for remote monitoring of paper levels.

#### COMMUNICATION

iDCloud  
Automatic synchronization with the cloud (sold separately)  
USB  
1 USB 2.0 Host port (Fiscal Port) for auditing  
Source Data Files (SDF)  
1 USB 2.0 Host port for importing and  
exporting users and receiving AFDs.  
Ethernet 1  
porta Ethernet 10/100Mbps nativa  
GPRS  
GPRS connection module via iDConnect (optional)  
Wi-Fi  
Wi-Fi connection module via iDConnect (optional)

#### GENERAL CHARACTERISTICS

Overall dimensions (W x H x D)  
32,96 cm x 21,86 cm x 12,62 cm  
Net weight  
750 g (l am a bobbin)  
Packaged weight  
1 kg  
Equipment color  
Textured black  
Warranty  
Food  
110-220V (Bi-Volt) / 60Hz  
No-Break (optional)  
Optional internal uninterruptible power supply (UPS) in case of power failure.



#### USER INTERFACE

Tela LCD Touchscreen  
2.4" 320x240 color TFT LCD display with resistive  
touchscreen.

#### FUNCTIONAL DIAGRAM

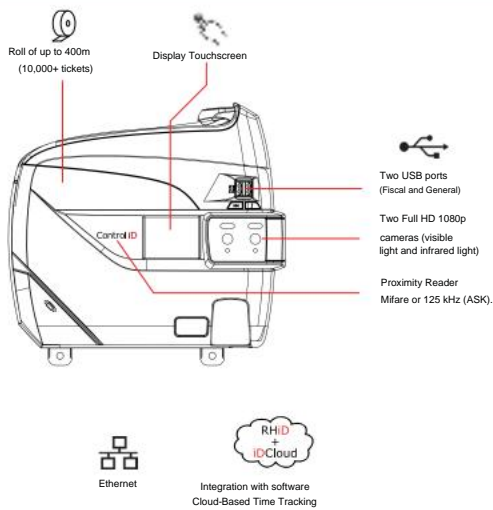

\*Identification methods vary depending on the model.

# Electronic Time Clock REP iDClass

Revolutionizing the Electronic Time  
and Attendance Recorder market once  
again, Control iD brings the REP iDClass to  
the market. Compliant with Ordinance 671  
and certified by Inmetro, the product  
utilizes the most modern technologies.

Its touchscreen display enables a user-  
friendly and intuitive interaction.  
With its user-friendly design and innovative  
aesthetics, compact size and  
robustness, Control iD  
reaffirms its leadership in the segment.

Certified by Inmetro and approved by  
the Ministry of Labor and Employment.  
Identification, biometrics, proximity  
card, barcodes, and password.  
High-speed printing mechanism and  
robust construction with  
guillotine cutter. Capacity for rolls up  
to 400m (10,000+ tickets  
per roll). TCP/IP communication,  
embedded web server and  
two USB ports (Wi-Fi and GPRS optional).



## MODELS (NCM 85437099)

**REP/671/PROX/ASK**  
iDClass – Proximity 125 KHz ASK

**REP/671/PROX/MIF**  
iDClass – MIFARE™ Proximity

**REP/671/BIO**  
iDClass – Biometrics

**REP/671/BP/ASK**  
iDClass – Biometrics + Proximity 125 KHz ASK

**REP/671/BP/MIF**  
iDClass – Biometrics + MIFARE™ Proximity

**REP/671/BB**  
iDClass – Biometrics + Barcode

**REP/671/MULT/ASK**  
iDClass – Biometrics + Barcode + Proximity 125 KHz ASK

**REP/671/MULT/MIF**  
iDClass – Biometrics + Barcode + MIFARE™ Proximity

# REP iDClass

## TECHNICAL SPECIFICATIONS

### TIME AND ATTENDANCE CONTROL

Certified by Inmetro  
Product certified by Inmetro – Certificate NCC 15.03813  
Approved by Ordinance 671.  
Product approved by the Ministry of Labor and Employment.  
Number of Employees: Capacity  
for 15,000 registered users.  
Number of Fingerprints:  
Capacity for 15,000 fingerprints (1:1) and 5,000 (1:N)

### METHODS OF IDENTIFICATION

Biometric Reader  
500 DPI optical fingerprint reader  
Proximity Cards  
Compatible with MIFARE™ or 125 kHz ASK technology.  
Barcode Cards  
Reading barcode cards  
(Code 39, 2 of 5 and 2 of 5 intertwined)  
Password  
User identification via numeric password

### PRINTER AND ROLL

Roll Compartment: Capacity for  
rolls up to 400m (10,000+ tickets per roll)

Printing Mechanism  
High-quality Seiko (Japan) printing mechanism  
Automatic Ticket Cutter, High-  
Speed Guillotine Printer  
Print Speed: 100 mm/s

Remaining Paper Quantity Detection Allows remote  
monitoring of paper levels.

### COMMUNICATION

iDCloud  
Automatic synchronization with the cloud (sold separately)  
USB  
1 USB 2.0 Host port (Fiscal Port) for auditing  
Source Data Files (SDF)  
1 USB 2.0 Host port for importing and exporting  
users and receiving AFD Ethernet; 1 native 10/100Mbps  
Ethernet  
port; GPRS.

GPRS connection module (optional)  
Wi-Fi  
Wi-Fi connection module (optional)

### GENERAL CHARACTERISTICS

Overall dimensions (W x H x D)  
246 mm x 246 mm x 104 mm (including bottom support) 246 mm  
x 230 mm x 104 mm (without support)  
Net weight  
750 g (I am a bobbin)  
Packaged weight  
1 kg  
1-year  
warranty  
Equipment color  
Textured black  
Food  
110-220V (Bi-Volt) / 60Hz  
No-Break (optional)  
Internal UPS (Uninterruptible Power Supply) with up to 4 hours of backup power.



### USER INTERFACE

Tela LCD Touchscreen  
2.4" 320x240 color TFT LCD display with resistive  
touchscreen.

### MODEL TABLE

		Biometria	Cartão RFID	Cartão de Barras	Senha
iDClass	Mult	✓	✓	✓	✓
	Bio Prox	✓	✓		✓
	Bio Barras	✓		✓	✓
	Bio	✓			✓
	Prox		✓		✓
	Barras			✓	✓

### FUNCTIONAL DIAGRAM

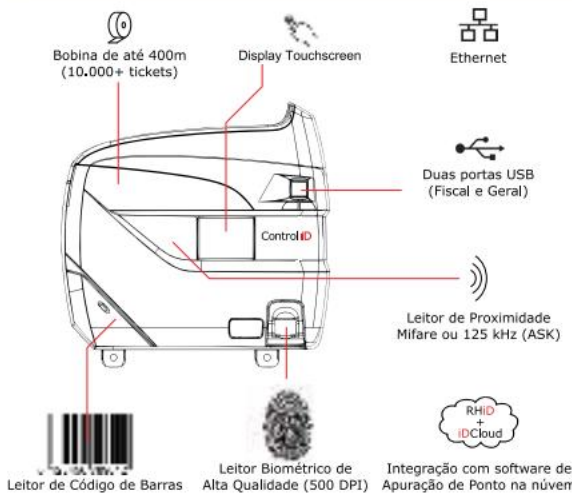



# Time and Attendance Software

## RHiD

The revolutionary RHiD platform, developed by Control iD, is a complete system that allows for time and attendance tracking in the cloud. Using the latest SaaS (Software as a Service) concepts, the system eliminates the need for installation and storage of information on local computers, as all data can be accessed through a browser or using the mobile application.

Real-time collaboration between managers, employees, and equipment offers greater convenience and freedom to monitor employee attendance.

Furthermore, software updates are automatic and made available to customers quickly, facilitating compliance with constantly evolving labor laws.

- Cloud-based platform (no installation required)
- Mobile app available for Android and iOS
- Real-time collaboration between managers, employees, and equipment.
- Complex schedule configuration: time bank, overtime, holidays, etc.
- Easy and fast time tracking for teams large and small.

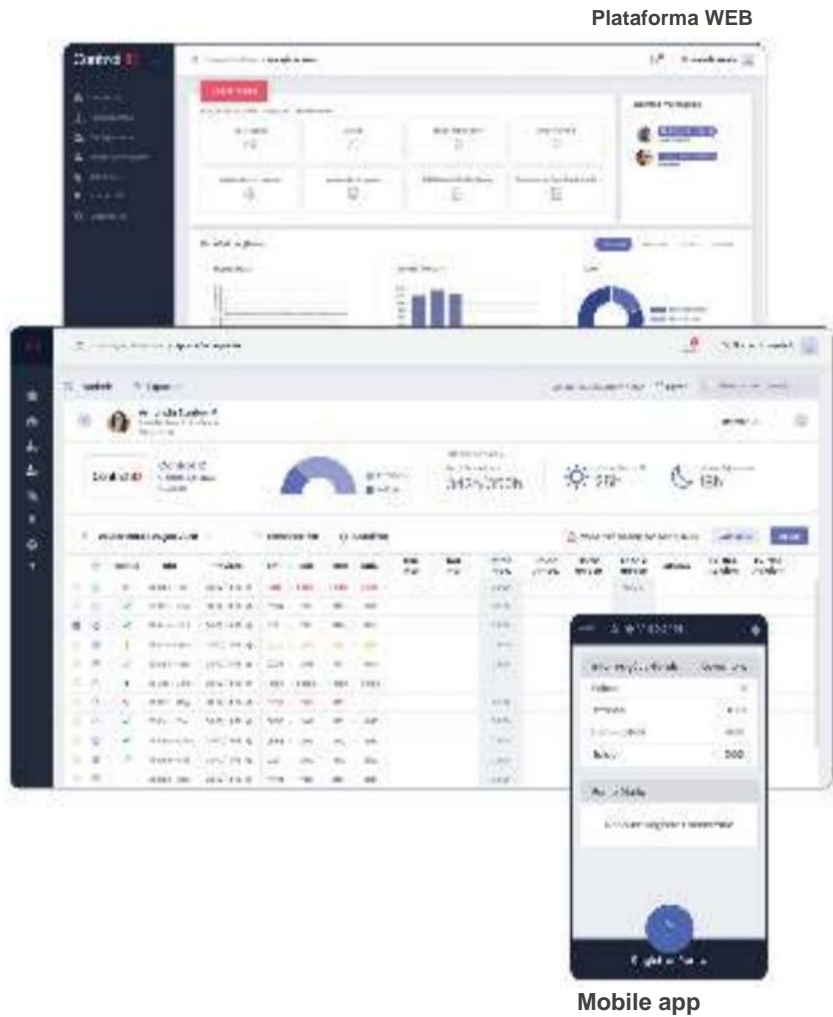

- MODELS**
- 1 to 10 employees
  - 11 to 50 employees
  - 51 to 200 employees
  - Additional leave for 100 employees
  - Additional CNPJ
  - Facial recognition on the server
  - Notification system

# RHiD

## Time and Attendance Software

### TECHNICAL SPECIFICATIONS

**EASY TO USE**

The RHiD solution was developed with a focus on usability, making the experience for both HR managers and employees as intuitive as possible. The system operates in the cloud, requiring no installation, and the 100% web-based interface allows access from any device.

**CONVERGENCE**

We created a solution that integrates time and attendance tracking through electronic time clocks (REPs), tracking done through our exclusive app that works on Android and iOS, and also allows employees to track their attendance directly from their PCs.

**Integration with REP**

The system is natively integrated with Control iD time and attendance systems using iDCloud software, which ensures bidirectional synchronization of information without the need for human intervention. It also integrates with equipment from other manufacturers via AFD files.

**POINT CALCULATION**

RHiD allows for highly flexible time and attendance control, catering to a wide range of companies, unions, schedules, and specific requirements of Brazilian legislation. It's also possible to work with an unlimited number of employees and companies, and to manage the approval workflow.

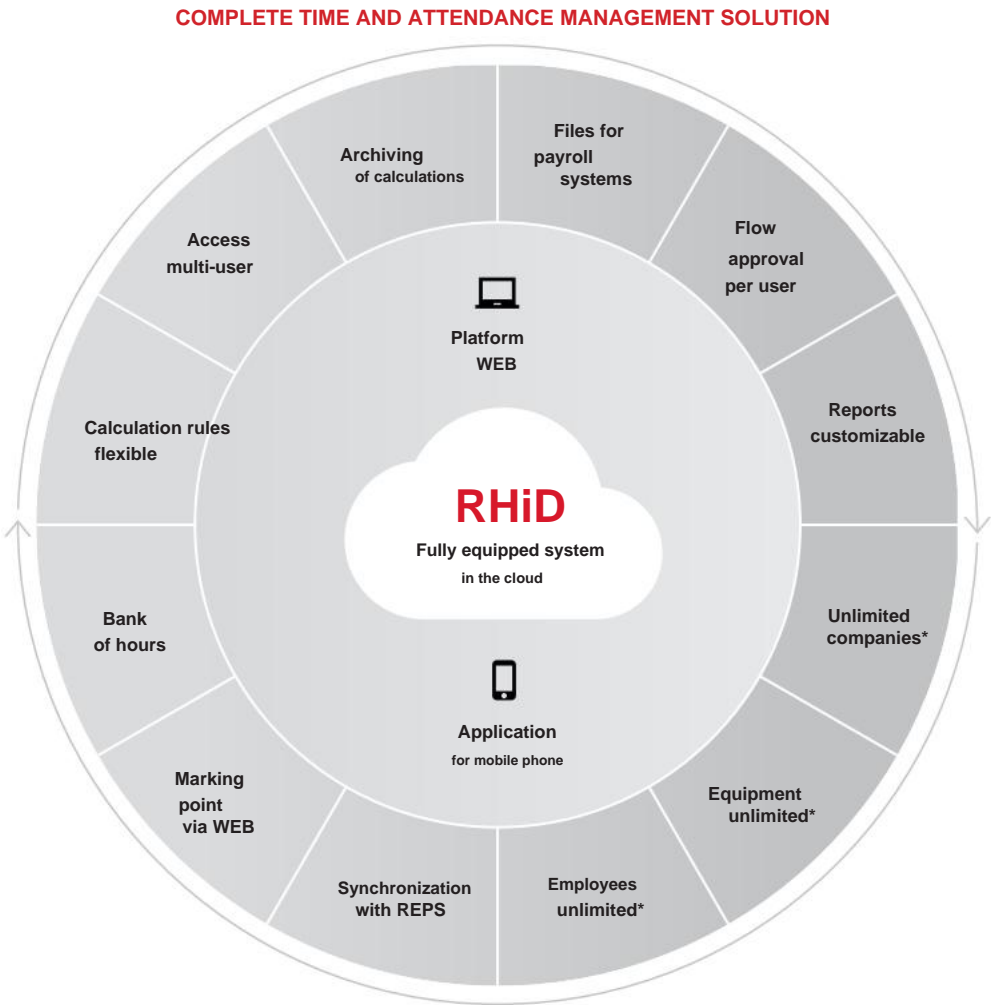

\*Some of the features presented are subject to the purchase of their respective licenses. Consult Control iD for more information.



# AUTOMATION COMMERCIAL



# Thermal Printer Print iD Touch

Equipped with a 2.4” touchscreen display and HDMI output, the Print iD Touch thermal printer is the ideal solution for all businesses.

Its graphical interface ensures ease of use, and its printing mechanism, developed by Control iD, guarantees high-quality and fast printing.

Furthermore, the embedded operating system allows for the integration of various software programs into the platform without the need for a connection to computers or other equipment external.

2.4” touchscreen display High-speed printing Embedded operating system HDMI output USB, Ethernet (TCP/IP), Wi-Fi\* and Bluetooth\* connectivity 1.2 GHz quad-core processor

\*Wi-Fi and Bluetooth modules sold separately.

MODELS (NCM 84433299)

IDPRINT TOUCH



# Print iD Touch Thermal Printer

## TECHNICAL SPECIFICATIONS

### CHARACTERISTICS

- High-speed printing  
Maximum speed of 300mm/s
- Printing Method  
Direct thermal printing
- High print quality  
High-density print head with 203 DPI (8 dots/mm)
- High resolution  
576 dots (72mm)
- Paper Type  
Thermosensitive coil
- Coil width 80mm or 58mm (adapter included)
- Data reception buffer  
32MB
- Printhead lifespan: 200km
- Easy to use  
The mechanism allows for easy installation of the coil.
- High-reliability guillotine  
High-precision, robust, and fast mechanism.
- Low paper sensor  
Configurable end-of-coil detection
- Integration with cash drawer  
RJ12 connector for 2 independent 24V solenoids.

### COMMUNICATION

- Ethernet 1  
Ethernet port (TCP/IP) 10/100Mbps USB
- Printing Port 1 USB Device  
2.0 type B port for printing USB Expansion Port 2
- USB Host 2.0 type A ports  
for Wi-Fi and Bluetooth modules and other devices

- 2.4” (320x240) color TFT  
LCD touchscreen display with resistive touchscreen.
- HDMI 1  
HDMI output for digital audio and video transmission.

### SOFTWARE

- Operating System  
Embedded operating system for integration
- Drivers  
Windows (32 e 64 bits - XP/Win7/Win8/Win10) e Linux
- Command set compatible  
with various market standards: UPC-A, UPC-E, EAN 8, EAN 13, Code 39, ITF Code 128, Code 93, Codabar, Interleaved 2 of 5, QR-Code and PDF417 barcodes.



### GENERAL CHARACTERISTICS

- Overall dimensions  
221 mm x 144 mm x 155 mm (D x H x W)
- Equipment weight 930g
- External feeding  
24V 2.5A dual voltage power supply (100-240V 50-60 Hz)
- Consumption during printing  
52W (2.2A) during printing  
1,7W(70mA) modo stand-by
- Drawer drive capacity: 2 solenoids of 24VDC 1A.
- Operating temperature 0° to 40° C
- Operating humidity: 5% to 90% RH

### INTERCONNECTION DIAGRAM

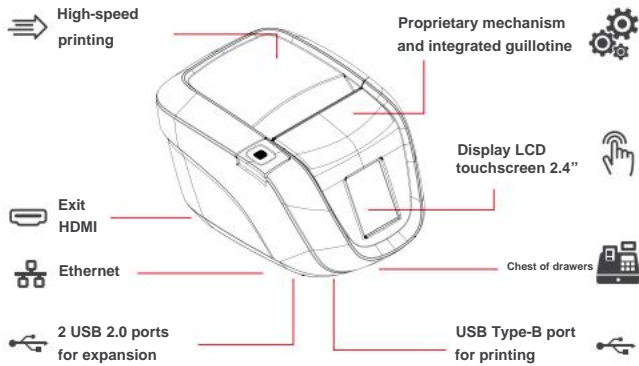



Coupon Authentication  
and Transmission System (CF-e)  
SAT iD

With its compact and modern design,  
the SAT-iD is capable of issuing  
secure, high-performance, and robust  
fiscal receipts.

Approved by the Treasury  
Department and in compliance with  
the most demanding market  
specifications, each of its  
features was designed with  
modern technologies to make  
its operation simple and  
transparent.

The software integration  
layer provided by Control iD  
is compatible with the main  
operating systems (Windows,  
Linux, and Android).

- Compact and modern design • USB 2.0 input Two Ethernet ports (TCP/IP) Approved by SEFAZ (Brazilian tax authority) Speed and reliability

MODELS (NCM 85437099)

IDSAT



SAT iD  
Coupon Authentication  
and Transmission System (CF-e)

TECHNICAL SPECIFICATIONS

FEATURES

- Activation
  - Activation of the equipment with the SEFAZ (State Finance Secretariat).
- Associate subscription
  - Linking the subscription to the commercial application
  - Send sale
  - Make a sale using the business app.
  - Cancel sale
  - To cancel a sale
- Change the activation code
  - Possibility of changing the activation code even after activation.
- Configure network
  - Dynamic or static network configuration
- Remote update
  - It is possible to update the equipment remotely.
- Operating information
  - Download the equipment's operating data, which includes:
    - Serial Number
      - Network type configured
      - Network address
      - Network status (Connected, Disconnected)
      - Internal battery level
      - Amount of memory available
      - Current date and time
      - Basic Software Version
        - Fiscal Receipt Layout Version - Last CF-e (Electronic Fiscal Receipt) issued
        - Date the certificate was issued
        - Certificate expiration date
        - Equipment operating status (Unlocked, Blocked by SEFAZ, (BlockedTaxpayer, Blocked)
  - Get operational history
    - Download operational history for auditing purposes.
  - Equipment lockout
    - It is possible to block the equipment for tax operations.

STORAGE CAPACITY

Equipped with high-quality 1GB flash memory.

SECURITY

- Digital certificate
  - The equipment works with an AC-SAT digital certificate.
- Cryptography
  - Equipped with a cryptographic module compliant with FIPS140-2.
- Violation
  - Detection against tampering with the equipment enclosure.

COMMUNICATION

- Ethernet:
  - 2 native 10/100Mbps Ethernet ports, bridged connection.
- USB
  - 1 porta USB Host 2.0



GENERAL CHARACTERISTICS

- Overall dimensions
  - 96.9 mm x 36.5 mm x 90 mm (D x H x W)
- Equipment weight: 100g
- Food
  - 5V 500mA (supplied via USB)
- Consumption
  - 1W (200mA) nominal
- Internal clock - RTC
  - Internal real-time clock
- Internal battery
  - Internal battery to store date and time information and security numbers for 5 (five) years.

USER INTERFACE

- LED indicators: 8 (eight) LEDs to indicate equipment operation.
- Food
- Network connection
  - Communication with Business Application Communicating with the SEFAZ server
  - Equipment Parameterized and Activated
- Coupons stored in memory were not transmitted.
- Contact support.
- Equipment locked.

INTERCONNECTION DIAGRAM

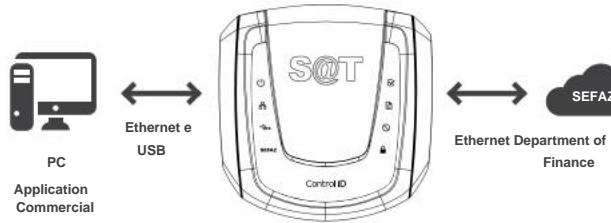



# iDBio Biometric Reader

Through its compact design and advanced optical technology, the iDBio Biometric Reader allows for high-quality fingerprint capture.

Through a specially designed prism, the product is able not only to obtain clear images in the most adverse conditions (dry fingers, wet fingers, sunlight, etc.), but also to allow for quick and secure biometric identification and validation.

Its USB interface and integration kit ensure ease of use and development.

USB 2.0 interface. High resolution (500 DPI). More than 1000 digits (1:N) per second. Modern and innovative design. Easy to use.



## MODELS (NCM 85437099)

IDBIO

# iDBio Biometric Reader

## TECHNICAL SPECIFICATIONS

### OPTICAL CHARACTERISTICS

Scanner area 21 x 19 mm

Image resolution 500 DPI

Image format: 256 grayscale levels

### COMMUNICATION AND INTERFACES

USB 2.0 interface  
High-speed communication

Audible signal  
Internal buzzer for improved usability.

Integrated USB cable  
1.5m length for greater flexibility.

### INTEGRATION

Drivers  
Windows (XP/2003/Vista/7/8/10), Linux e Android

Integration kit  
Available for free on Windows, Linux, and Android.

Integration examples  
Available for free in several languages.  
(C, C++, C#, Java, etc)

### IDENTIFICATION

Speed  
Validation of over 1000 users in less than 1 second.

Reliability  
High-performance algorithm with excellent FAR and FRR.

Standalone and integrated mode  
Image capture or identification directly in iDBio.



### GENERAL CHARACTERISTICS

Overall dimensions  
58 x 67 x 58 mm (W x H x D)

Equipment weight: 130g

Food  
5V (supplied via USB)

Total Consumption  
< 500 mW

### INTERCONNECTION DIAGRAM

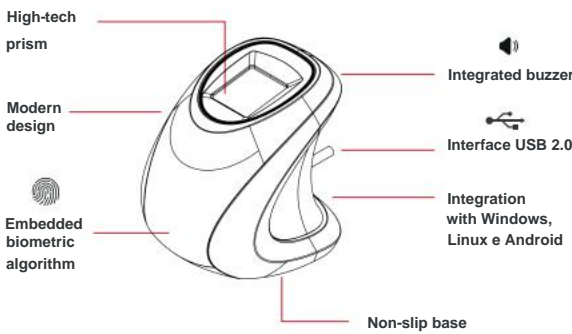

# ENTER CONTACT

**MORE INFORMATION ON THE WEBSITE:  
[WWW.CONTROLID.COM.BR](http://WWW.CONTROLID.COM.BR)**

**COMMERCIAL EMAIL:  
[COMMERCIAL@CONTROLID.COM.BR](mailto:COMMERCIAL@CONTROLID.COM.BR)**

**CONTROL ID**



**@CONTROL\_ID**

