



**We love that you are rocking JLab!
We take pride in our products and fully stand behind them.**

JLAB
EPIC
MOUSE 2



YOUR WARRANTY

All warranty claims are subject to JLab authorization and at our sole discretion. Retain your proof of purchase to ensure warranty coverage.



CONTACT US

Reach out to us at support@jlab.com or visit jlab.com/contact

REGISTER TODAY
jlab.com/register
 Product updates | How-to tips
 FAQs & more

SETUP

- 1 2.4 Connect**
 Plug in the USB-C dongle to computer and turn ON. Epic Mouse 2 will auto connect.

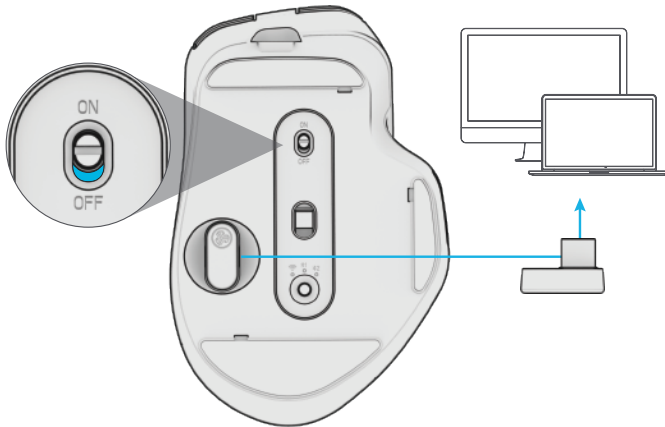

- 2 Bluetooth Connect**

Quick Press to switch between 2.4, 1, and 2. Then **Press Hold** to enter Pairing Mode. Select JLab Epic Mouse 2 in device settings.

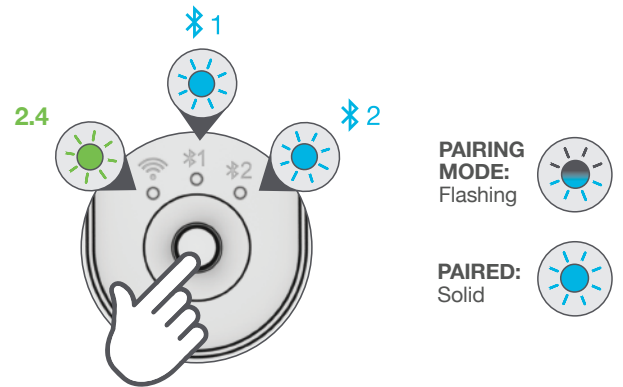

Have a JLab Epic or JBuds Keyboard?
 Scan the QR code to learn how to pair both your devices with just one dongle.

INTERFACE

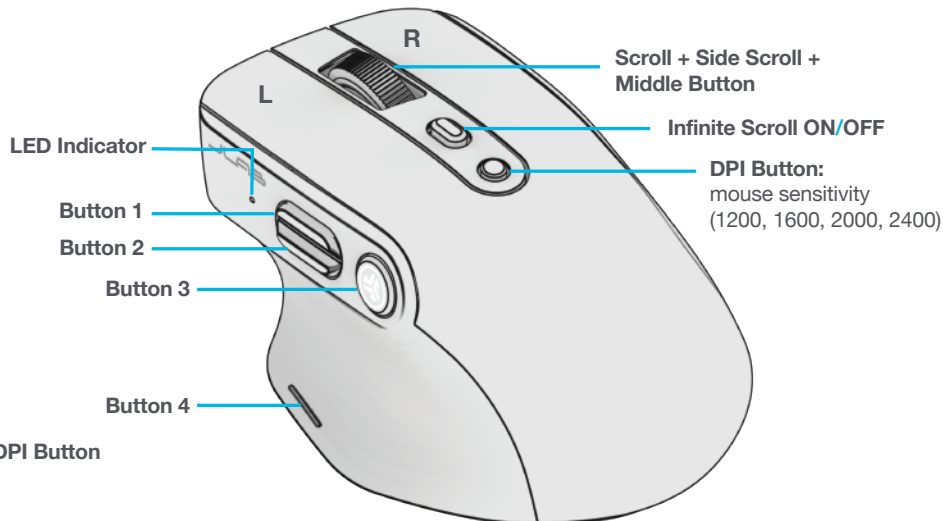

Change OS by
Press Hold 3s Button 3 + DPI Button
 Windows = Green LED
 Mac = White LED

CHARGING

Connect the Epic Mouse 2 to computer or USB 5V 1A (or less) to charge.

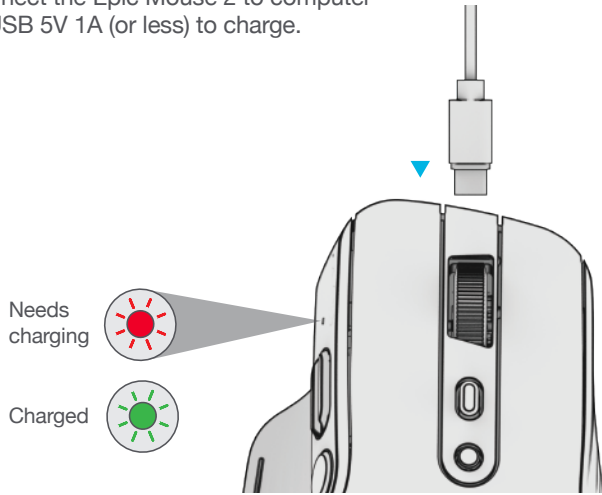

CUSTOMIZATION

Download the JLab Work App (for Mac and PC) to fully customize the Epic Mouse 2 at: [JLAB.COM/SOFTWARE](https://www.jlab.com/software)

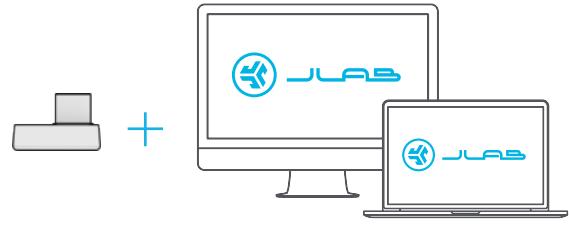

(USB-C dongle needs to be plugged in for customizing software)



[Shop products](#) | [Product alerts](#) | [Burn-in your headphones](#)

JLab Audio + Burn-in Tool

