

1

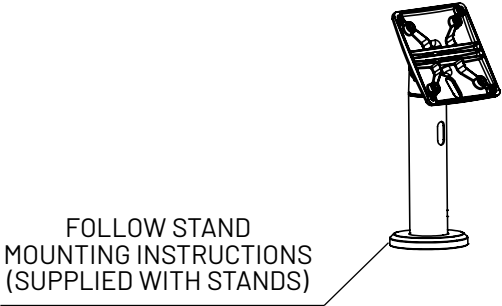

Or

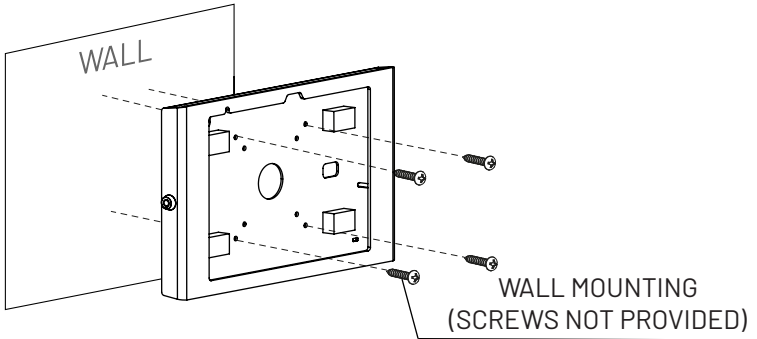

2

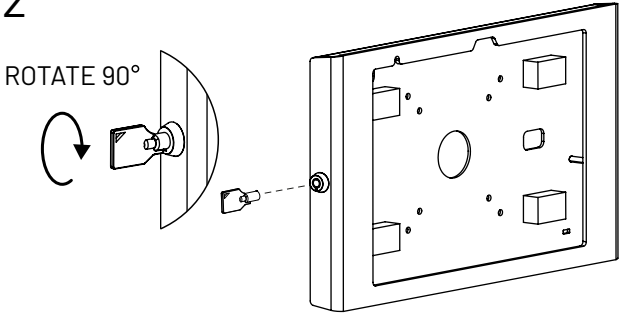

3

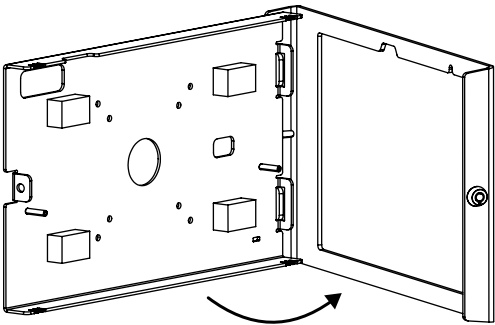

4

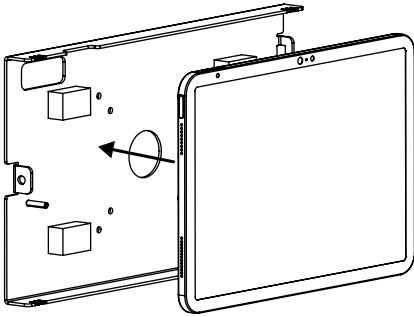

5

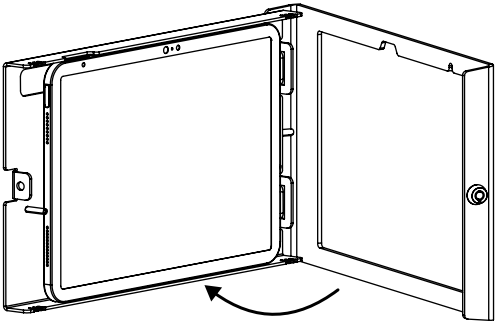

6

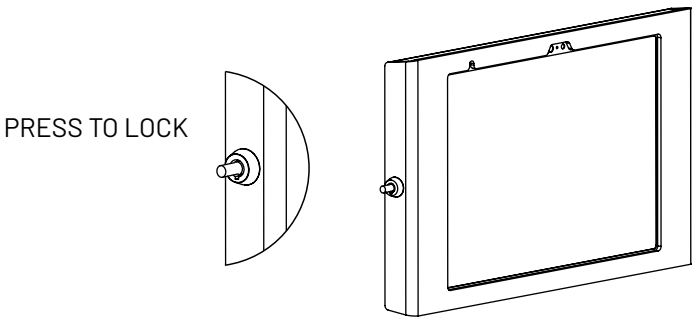

IN THE BOX

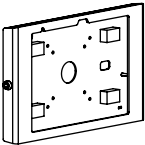

Apex Enclosure

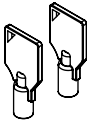

Keys

Through Stand Cable Assembly

1

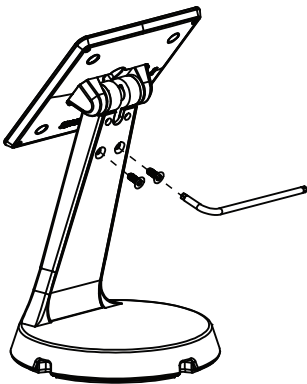

REMOVE FRONT COVER.
USE T-20 TORX
WRENCH (PROVIDED)
TO REMOVE M4 X 10mm
TORX FLAT HEAD SCREWS

2

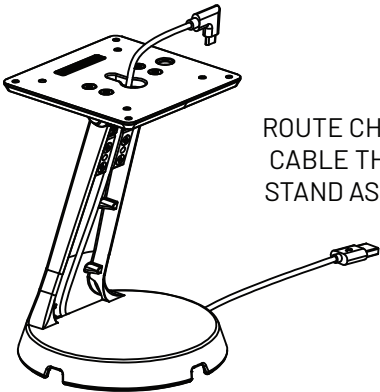

ROUTE CHARGING
CABLE THROUGH
STAND AS SHOWN

3

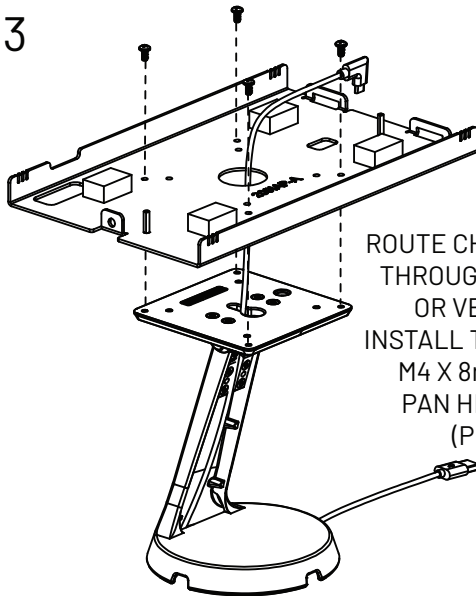

ROUTE CHARGING CABLE
THROUGH ENCLOSURE
OR VESA MOUNT.
INSTALL TO STAND USING
M4 X 8mm PHILLIPS
PAN HEAD SCREWS
(PROVIDED)

4

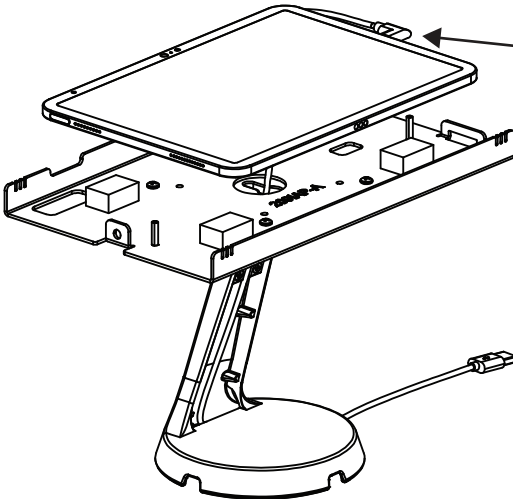

ATTACH CHARGING CABLE
TO TABLET, LEAVE A SMALL LOOP
OF CABLE BENEATH THE TABLET

5

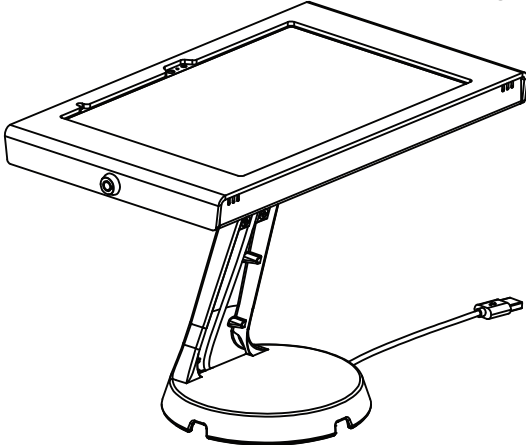

INSTALL THE REST OF THE ENCLOSURE
OR VESA MOUNT
PER THEIR INSTRUCTIONS

6

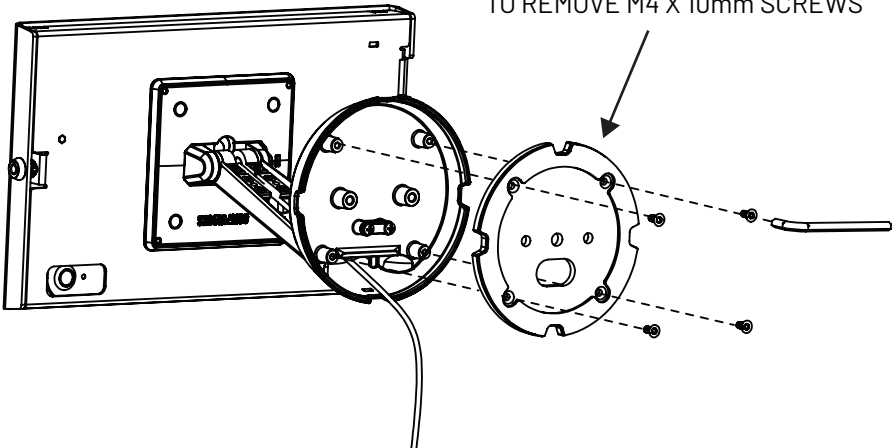

REMOVE BOTTOM PLATE.
USE T-20 TORX WRENCH (PROVIDED)
TO REMOVE M4 X 10mm SCREWS

7

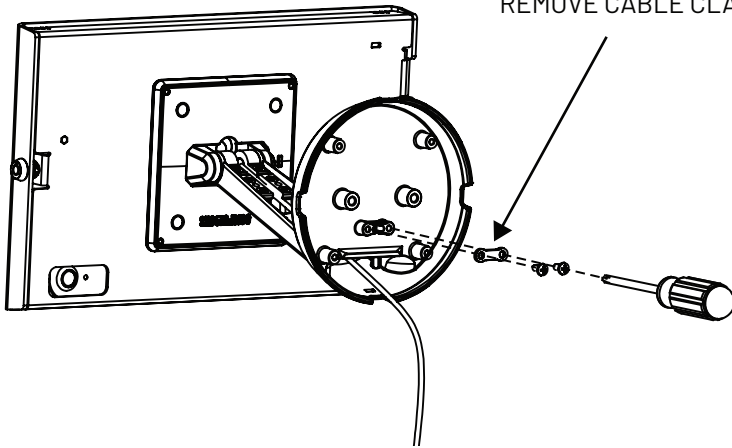

REMOVE CABLE CLAMP

8

ROUTE CHARGING CABLE
THROUGH CLAMP AREA

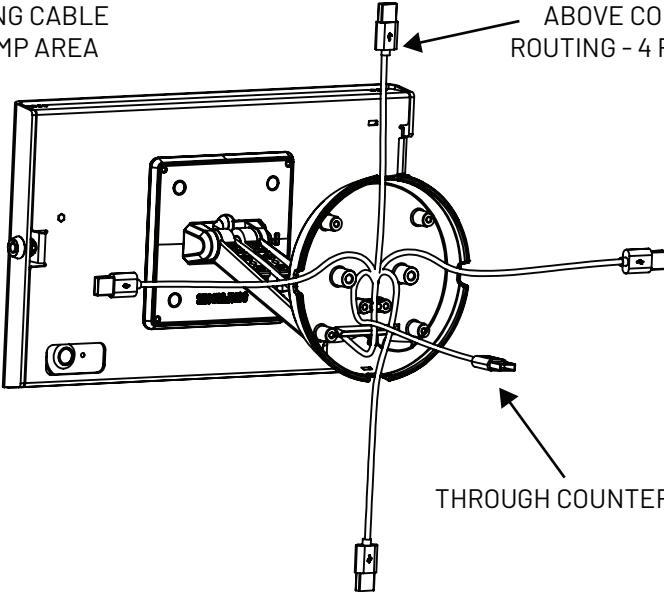

ABOVE COUNTER
ROUTING - 4 POSITIONS

THROUGH COUNTER ROUTING

9

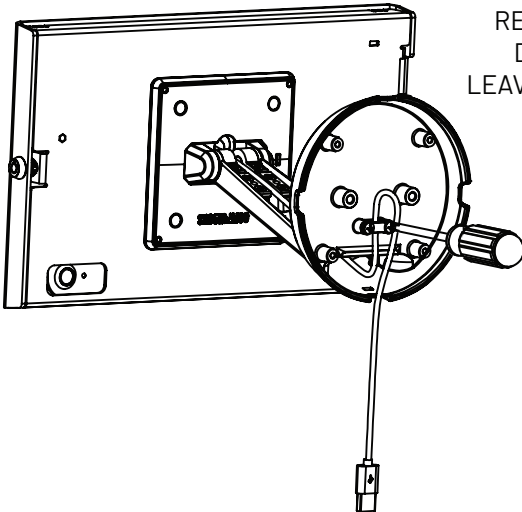

REINSTALL CABLE CLAMP
DO NOT OVER TIGHTEN
LEAVE SLACK IN POWER CORD
BELOW CLAMP

10

Securing Stand Using Cable Lock

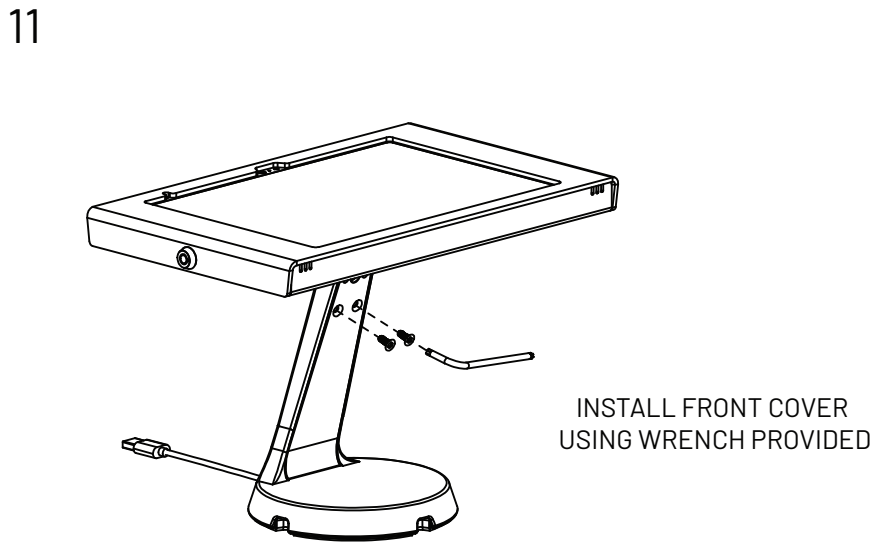
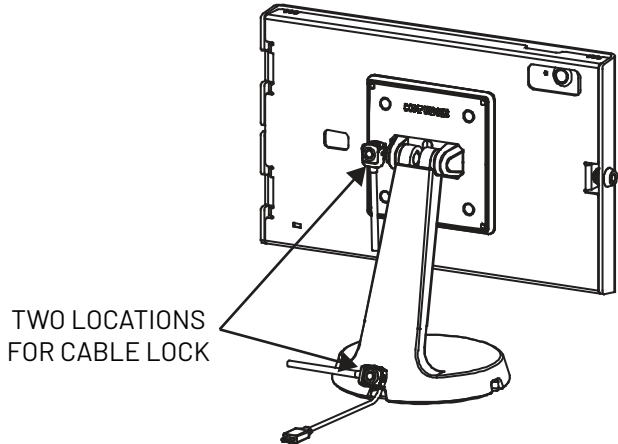
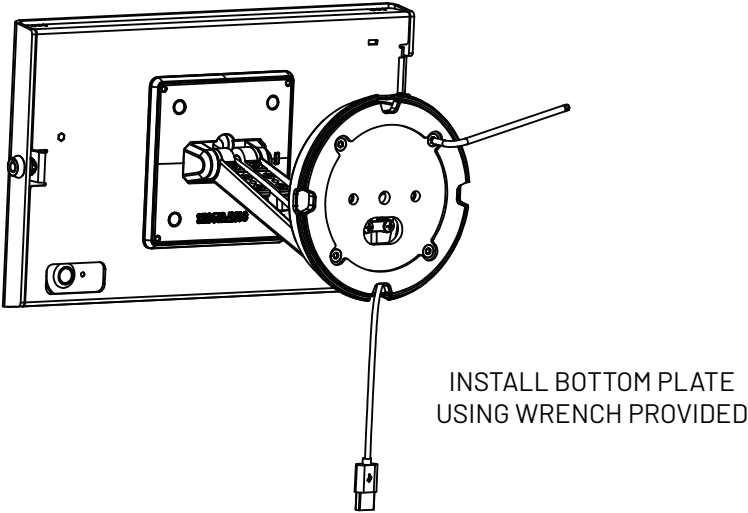

Tilt Tension Adjustment

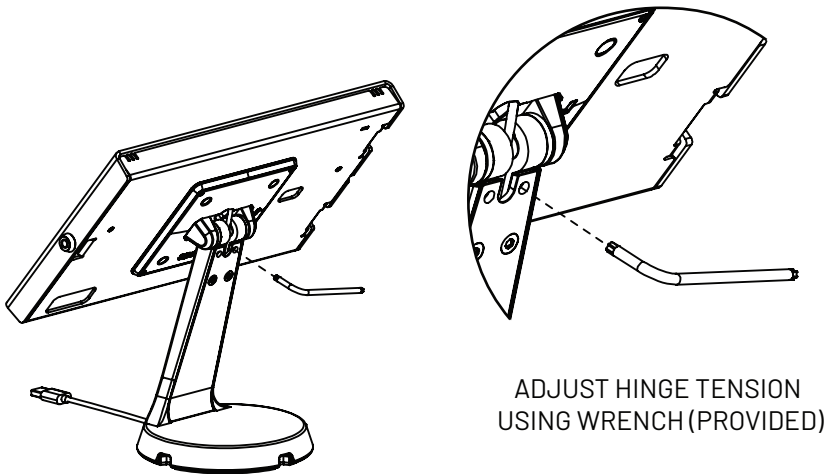

1

Secure Counter Mounting

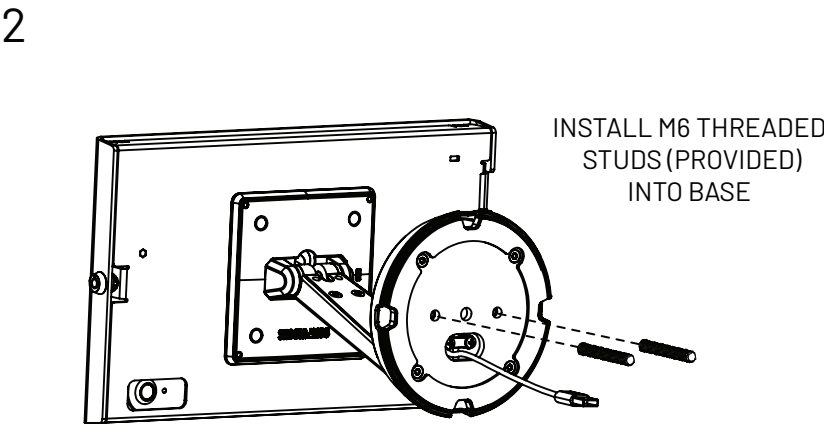
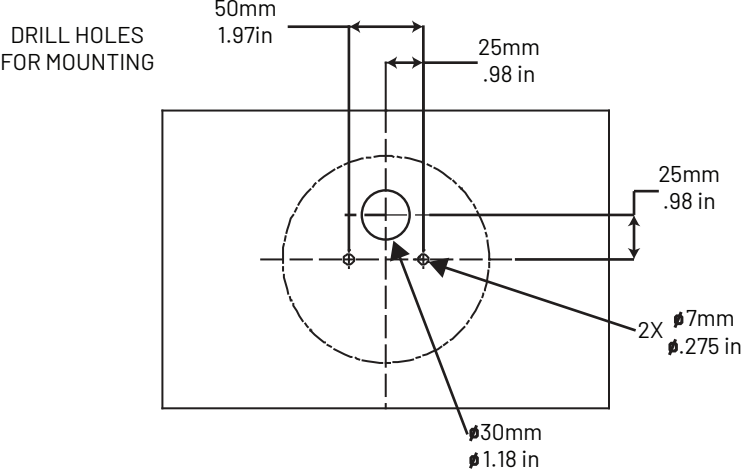

3

75mm VESA Mounting

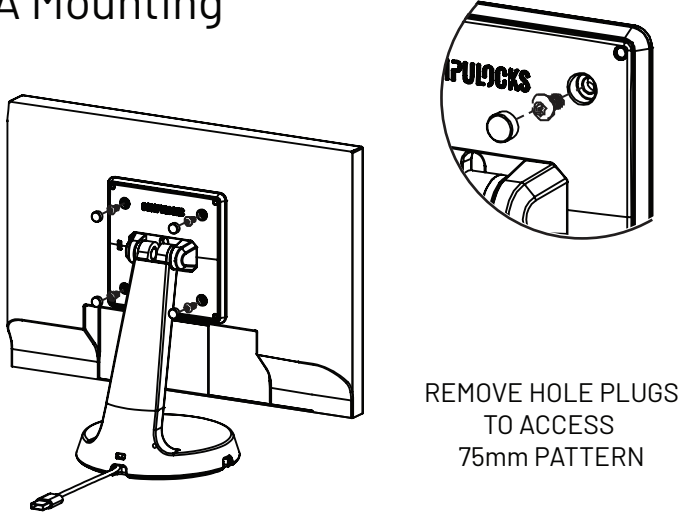
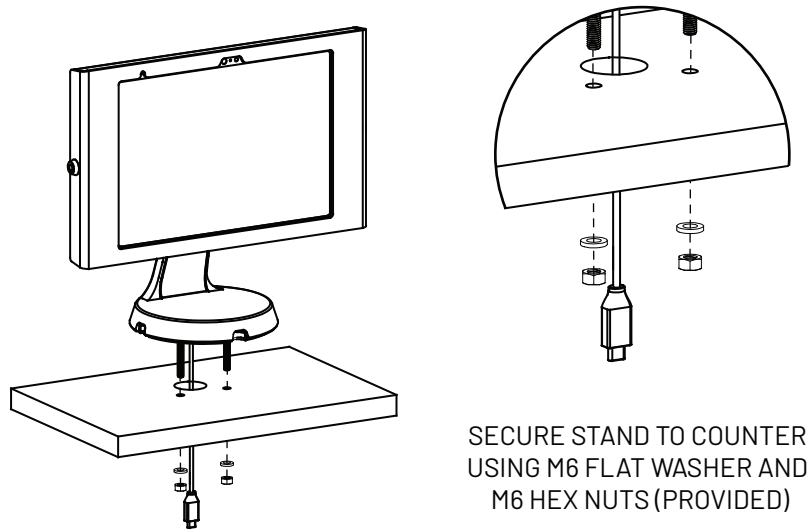

IN THE BOX



T20 TORX L-Wrench



M6 X 65mm Threaded Stud



M6 Flat Washer



M6-1mm Hex Nut



M4 X 8mm
Phillips Pan Head Screw

Hardware Kit

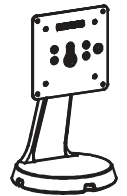

Stand