

1

LX series

Smart LED Projector

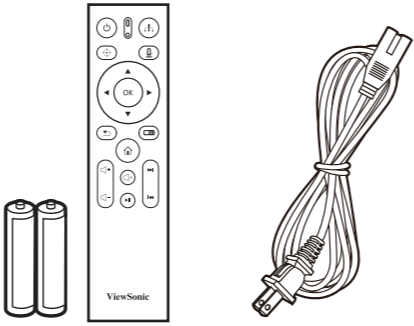
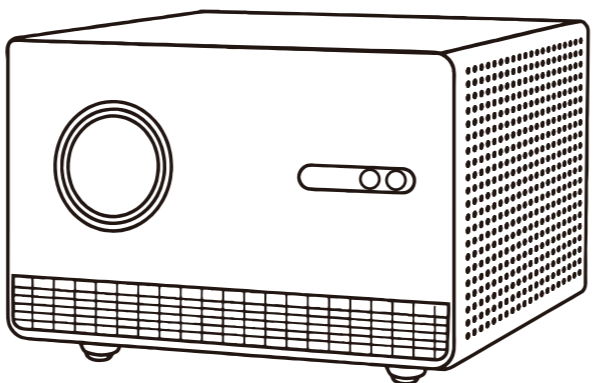

Quick Start Guide
 快速安装说明
 快速入門指南
 빠른 시작 가이드
 クイックスタートガイド
 Guide de démarrage rapide
 Schnellstarthandbuch
 Guía de inicio rápido
 Guida introduttiva
 Guia de Inicio Rápido
 Průručka so stručným návodom
 Vodnik za hitri začetek
 Przewodnik Szybki start
 короткий посібник користувача
 Hızlı Başlangıç Kılavuzu

Snabbstartsguide
 Vodič za brzo pokretanje
 краткоe руководство по началу работы
 Ghid de pornire rapidă
 Első lépések
 Οδηγός γρήγορης εκκίνησης
 Pika-aloitusopas
 Úvodní příručka
 Vodič za brzi početak
 Ръководство за бърз старт
 Aan de slag
 Panduan Mulai Cepat
 Hướng dẫn Khởi động Nhanh
 උඹවැරදීමේ මාර්ගදර්ශන
 دليل البدء السريع

2

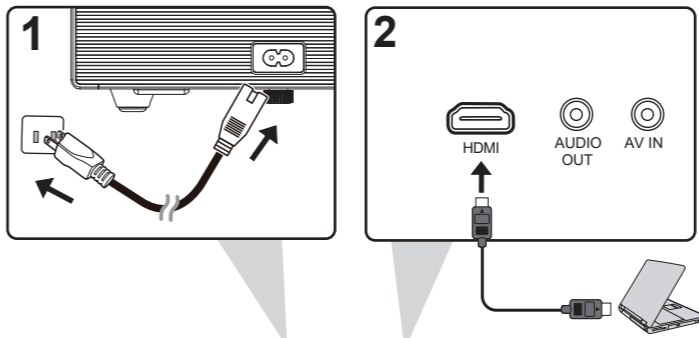

4

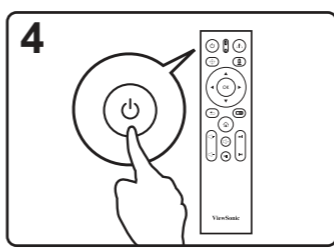

5

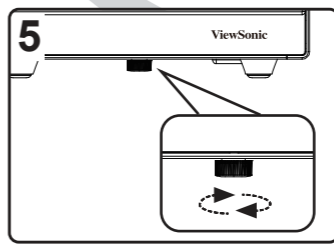

3

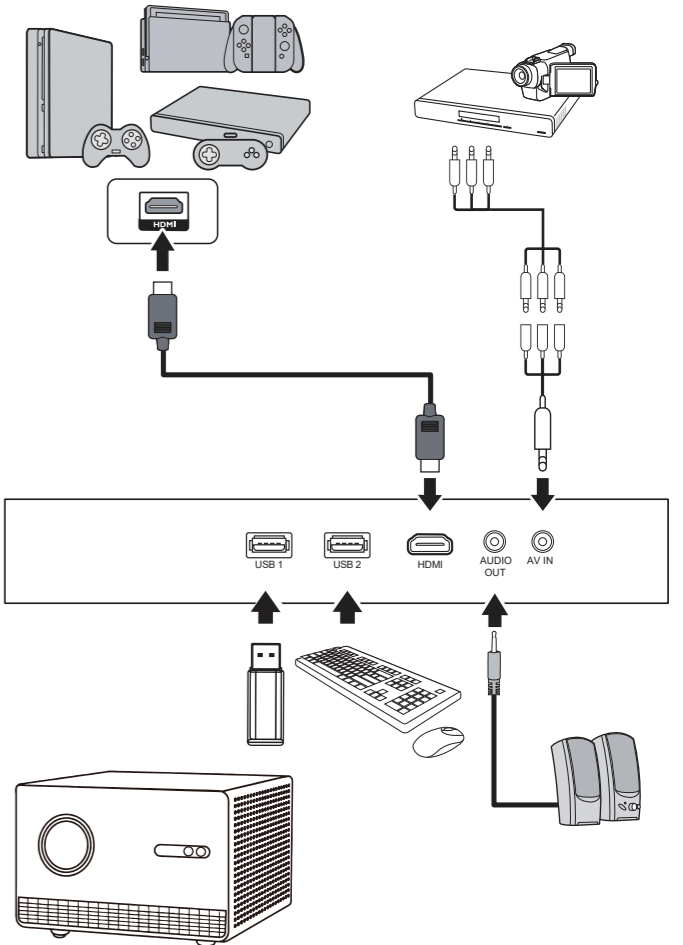

4

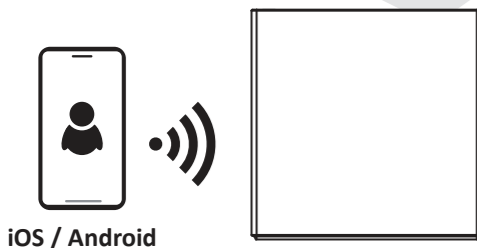

iOS / Android

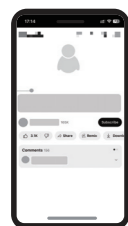

4-1

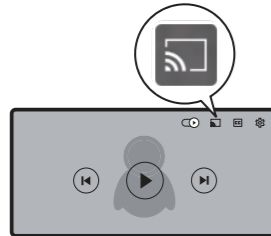

4-2



4-3

5

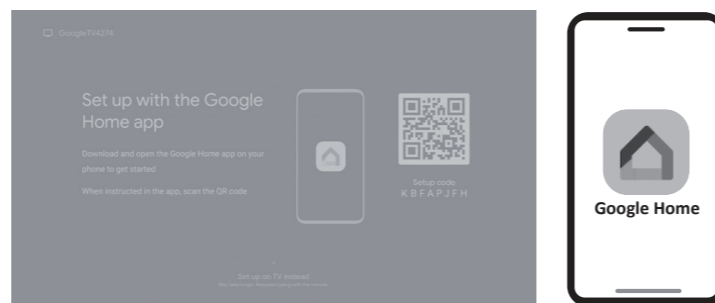

6

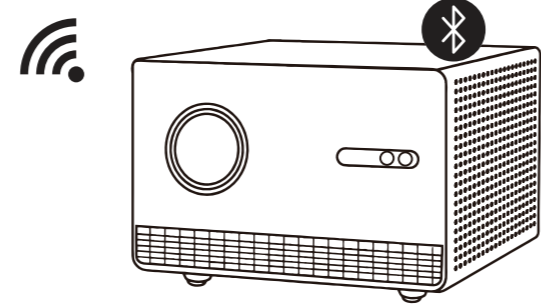
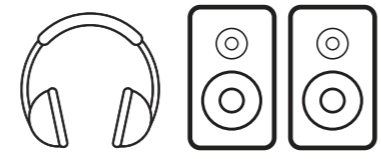

7

Tripod Hole: M4 x 7 (Max. L = 7 mm)
 Unit: mm

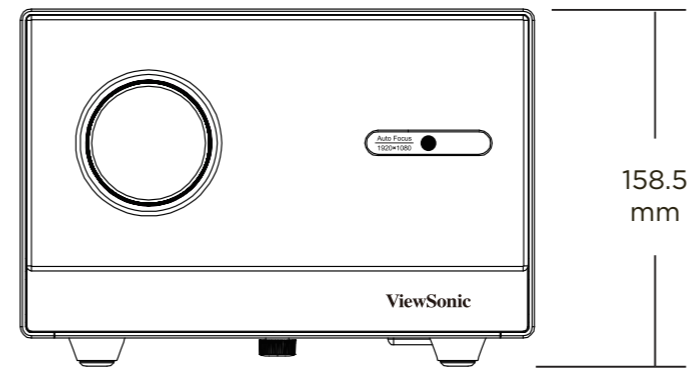
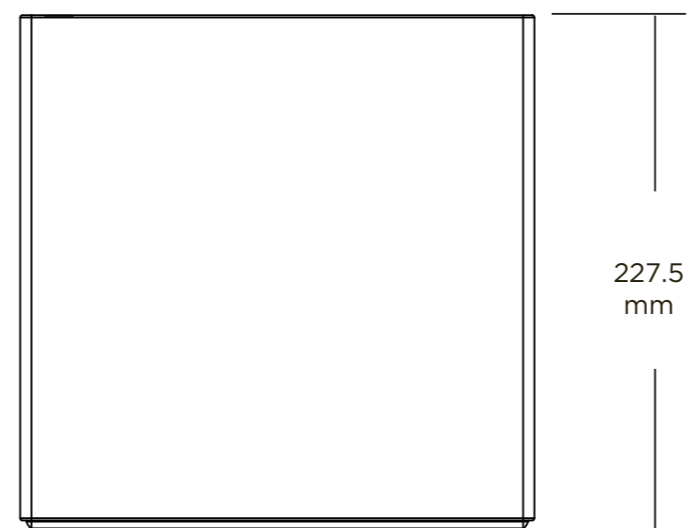

8

•16:9 image on a 16:9 screen

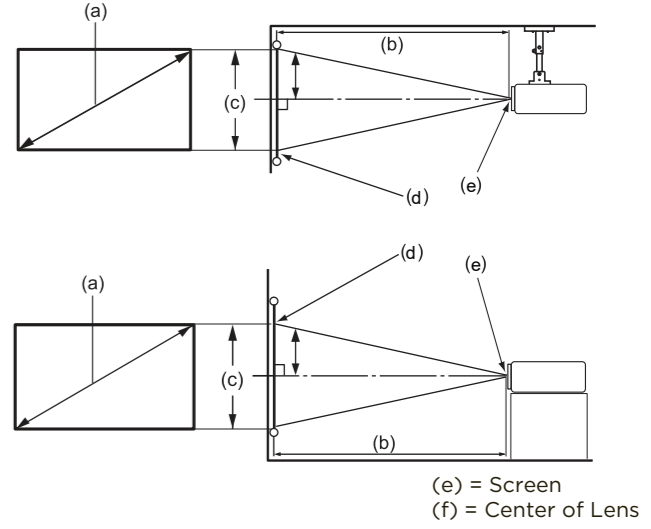

(e) = Screen
 (f) = Center of Lens

(a) Screen Size		16:9 Image on a 16:9 Screen				(c) Image height		(d) Vertical offset	
		(b) Projection distance							
		min.	max.						
inch	mm	inch	mm	inch	mm	inch	mm	inch	mm
50	127	51.5	130.9	54	136.2	24.5	62.3	43.58	111
60	152	62.6	158.9	63	160.5	29.4	74.7	52.29	133
70	178	72.6	184.4	74	186.7	34.3	87.2	61.01	155
80	203	82.8	210.4	86	217.6	39.2	99.6	69.73	177
90	229	93.5	237.5	96	244.8	44.1	112	78.44	199
100	254	103.0	261.5	107	270.9	49	125	87.16	221
110	279	113.6	288.6	116	295.3	53.9	137	95.87	244
120	305	125.0	317.6	128	324.3	58.8	149	104.6	266
130	330	135.1	343.1	138	350.2	63.7	162	113.3	288
140	356	146.1	371.2	149	378.9	68.6	174	122	310

It is recommended that if you intend to permanently install the projector, please physically test the projection size and distance using the actual projector in situ before you permanently install it.

