

Mesh Back Task Chair

Functionality Guide

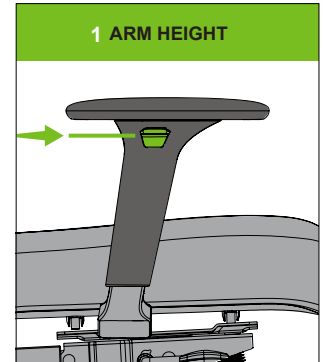

Adjust arms up and down to provide upper-body/arm support

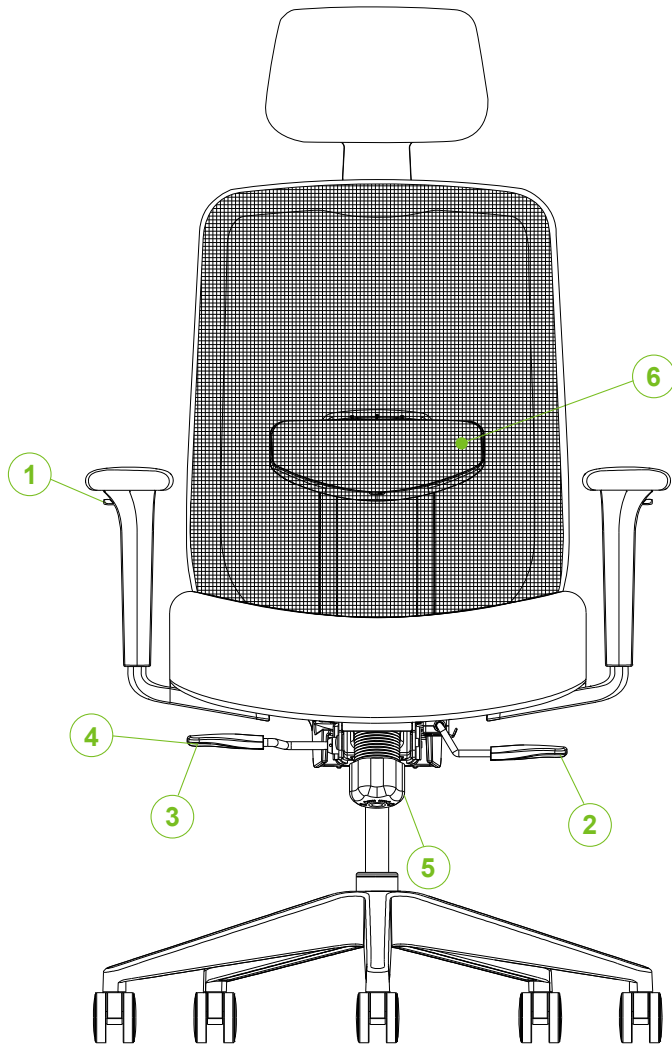
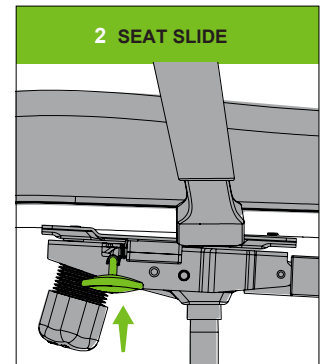

Move the seat forward and backward to adapt to various positions

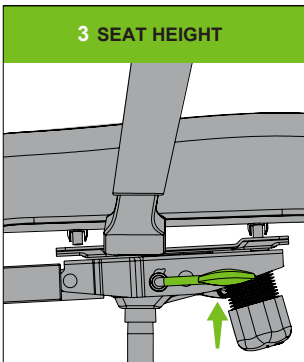

Move the seat up and down to adapt to various heights



Pull the back tilt lock out to unlock the back, or push in to lock

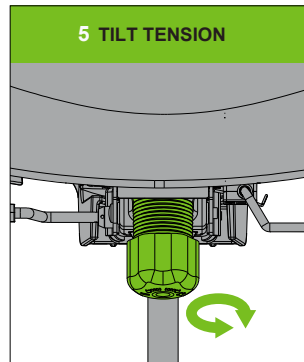

Turn knob to easily control the rate and ease of recline

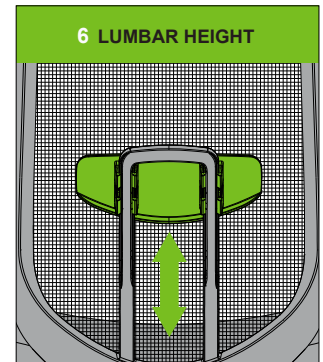

Adjust lumbar height up and down to find the optimal position

