



Quick Installation Guide

IDS 3204/4304/5054 Series Display

Revision A
P/N E329026

Learn more about Elo at [EloTouch.com](https://www.elotouch.com)

America

Tel +1 408 597 8000
EloSales.NA@elotouch.com

Europe (EMEA)

Tel +32 16 930 136
EMEA.sales@elotouch.com

Asia Pacific

Tel +86 (21) 3329 1385
EloAsia@elotouch.com

The information in this document is subject to change without notice. Elo Touch Solutions, Inc. and its Affiliates (collectively "Elo") makes no representations or warranties with respect to the contents herein, and specifically disclaims any implied warranties of merchantability or fitness for a particular purpose. Elo reserves the right to revise this publication and to make changes from time to time in the content hereof without obligation of Elo to notify any person of such revisions or changes.

No part of this publication may be reproduced, transmitted, transcribed, stored in a retrieval system, or translated into any language or computer language, in any form or by any means, including, but not limited to, electronic, magnetic, optical, chemical, manual, or otherwise without prior written permission of Elo Touch Solutions, Inc.

Elo and the Elo logo are either trademarks or registered trademarks of Elo Touch Solutions, Inc.



Go to www.elotouch.com/support to download user manual.
 请访问 www.elotouch.com.cn 获取用户手册

1. Mounting IDS Display (VESA Mount)

(Compatible Elo low-profile wall mount kit P/N E282876 available at www.elotouch.com)

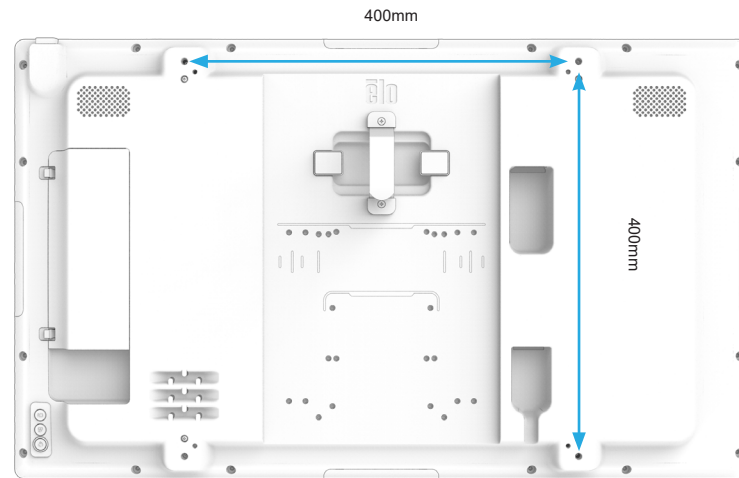

400mm VESA = M6 screws, x4

2. Connections

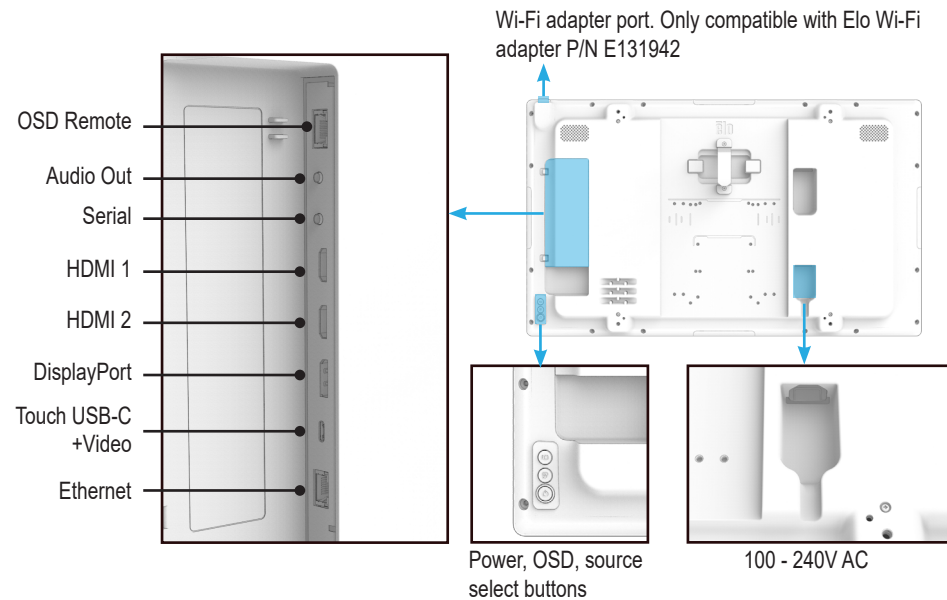

3. External Computer Mounting (computer sold separately)

100mm VESA pattern is available for the Elo Backpack™, Intel NUC, and other small computers with the same hole pattern.

Additionally, there are multiple patterns designed for select Brightsign players. Align the top of the Brightsign player with the horizontal marking and then center the player between the vertical markings to align the mounting holes on the player. Use M4x6 screws (included) to secure Brightsign players. See IDSx4 User Manual for detailed Brightsign Player compatibility list.

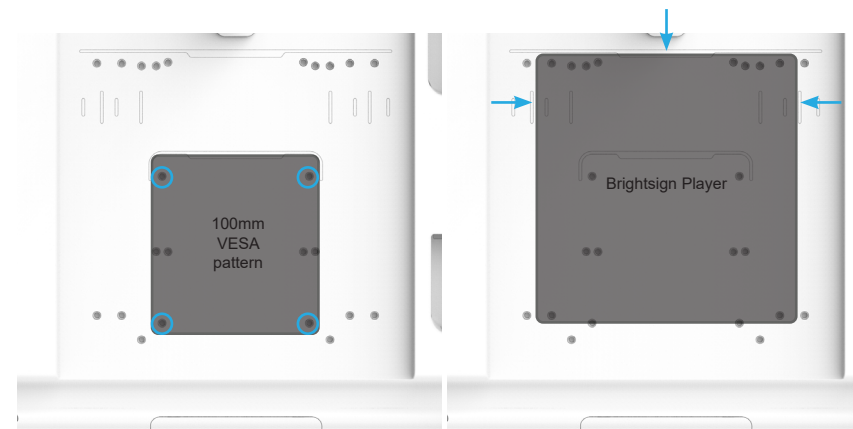

4. External computer power supply connection

Secure computer power supply with straps as shown below and connect power supply to IDS power output connection with the included cable. (Brightsign players require adapter which is not included). Connector DC cable from power supply to computer. Additional DC cable length can be wound up and secured under power supply before securing straps if desired.

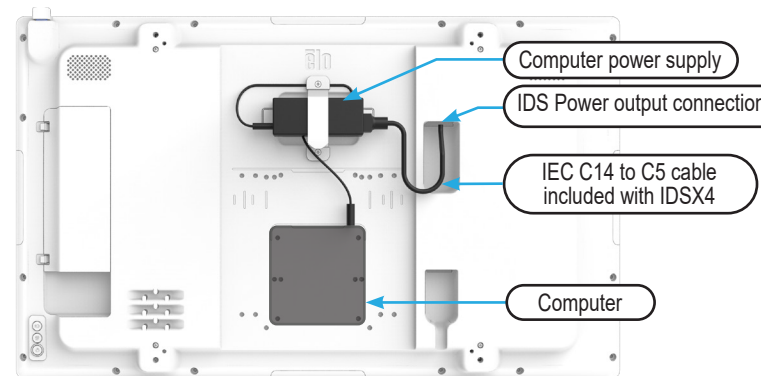

5. Elo Edge Connect Peripheral Mounting

Most popular accessories: 4K camera, Wall Mount, Magnetic Strip, 2D Barcode Reader. Scan QR code or visit:

<https://www.elotouch.com/accessories.html>

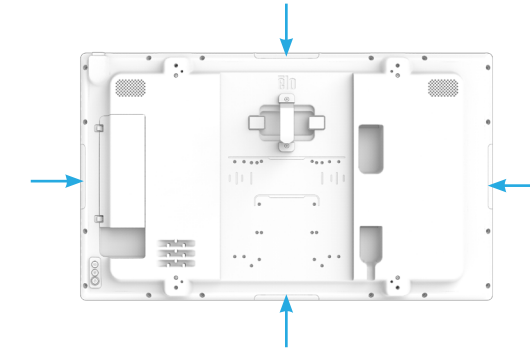

6. (Optional) EloView and IoT Setup (Elo document QIG590425)

Scan QR code or visit: <https://docs.elotouch.com/QIG590425.pdf>



7. (Optional) Connect IDS to ethernet router

(ethernet cable not included)

Warning! Do not connect router to remote OSD port.

