

For proper insertion of a 16-pin graphics card power cable into a power supply unit, or power cable into a compatible graphics card, please see the instructions below.

Make sure that the 16-pin cable is fully inserted into a PCI-E port on the graphics card, so that the plastic tab on the top of the cable connector clicks into place.

Do not bend this cable in order to achieve full insertion.

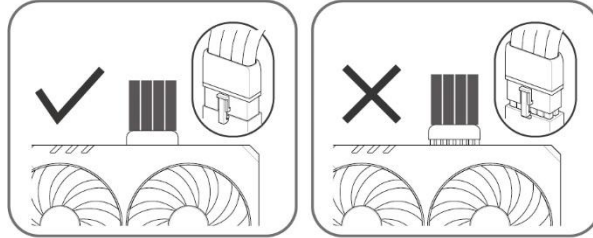

Make sure that the end of the 16-pin cable and all other cables labeled "PSU" is fully inserted into a matching port on the power supply, so that the plastic tab on the top of the cable connector clicks into place.

Do not bend this cable in order to achieve full insertion.

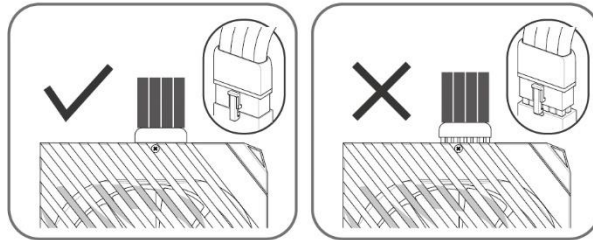

Make sure that the power supply cables labeled "PCI-E" are fully inserted into the four sockets on the adapter cable, so that the tabs on the top of the connectors click into place.

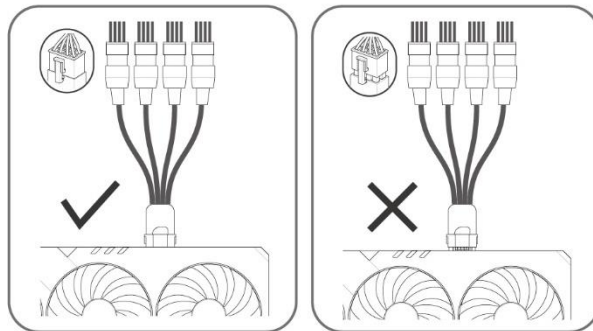

* Illustrations for reference only