

# QuickStart Guide

FortiWeb High-End Series

FWB-2000F, FWB-3000F, FWB-4000F

# Product Registration

Thank you for purchasing a Fortinet Appliance.

Manage and Access:

- Cloud Management
- FortiGuard Updates
- Firmware Upgrades
- Technical Support
- Warranty Coverage

Register your Fortinet Appliance:

Vous devez enregistrer le produit:

Debe registrar el producto:

登録のお願い:

请马上注册:

<http://support.fortinet.com>



March 10, 2022

Copyright© 2022 Fortinet, Inc. All rights reserved. Fortinet®, FortiGate®, FortiCare® and FortiGuard®, and certain other marks are registered trademarks of Fortinet, Inc., in the U.S. and other jurisdictions, and other Fortinet names herein may also be registered and/or common law trademarks of Fortinet. All other product or company names may be trademarks of their respective owners. Performance and other metrics contained herein were attained in internal lab tests under ideal conditions, and actual performance and other results may vary. Network variables, different network environments and other conditions may affect performance results. Nothing herein represents any binding commitment by Fortinet, and Fortinet disclaims all warranties, whether express or implied, except to the extent Fortinet enters a binding written contract, signed by Fortinet's General Counsel, with a purchaser that expressly warrants that the identified product will perform according to certain expressly-identified performance metrics and, in such event, only the specific performance metrics expressly identified in such binding written contract shall be binding on Fortinet. For absolute clarity, any such warranty will be limited to performance in the same ideal conditions as in Fortinet's internal lab tests. In no event does Fortinet make any commitment related to future deliverables, features or development, and circumstances may change such that any forward-looking statements herein are not accurate. Fortinet disclaims in full any covenants, representations, and guarantees pursuant hereto, whether express or implied. Fortinet reserves the right to change, modify, transfer, or otherwise revise this publication without notice, and the most current version of the publication shall be applicable.

For Product License Agreement / EULA and Warranty Terms, visit <https://www.fortinet.com/content/dam/fortinet/assets/legal/EULA.pdf>

# Table of Contents

Products	FortiWeb 2000F .....	6
	FortiWeb 3000F .....	12
	FortiWeb 4000F .....	18
Installation	Rack Installation .....	24
	Basic Connections.....	28
	SFP Installation.....	29
Setup	Appliance Setup .....	30
	GUI .....	31
	Command Line Interface (CLI) .....	32
Compliance	Cautions and Warnings.....	33
	Regulatory Compliance Information.....	33

# Box Includes - FortiWeb 2000F



FortiWeb 2000F



QuickStart Guide



2x Power Cable



1x Console Cable  
(USB to RJ45)

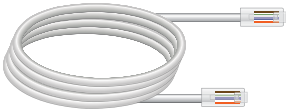

1x Ethernet Cable



2x HDD Tray Keys

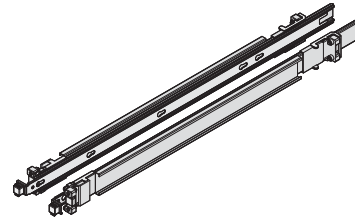

1x Rail Mount Kit  
(screws included)

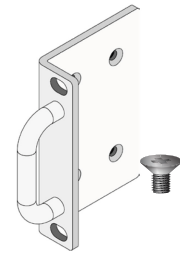

2x Handles, 4x Screws

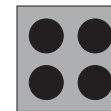

4x Rubber Feet

# Front - FortiWeb 2000F

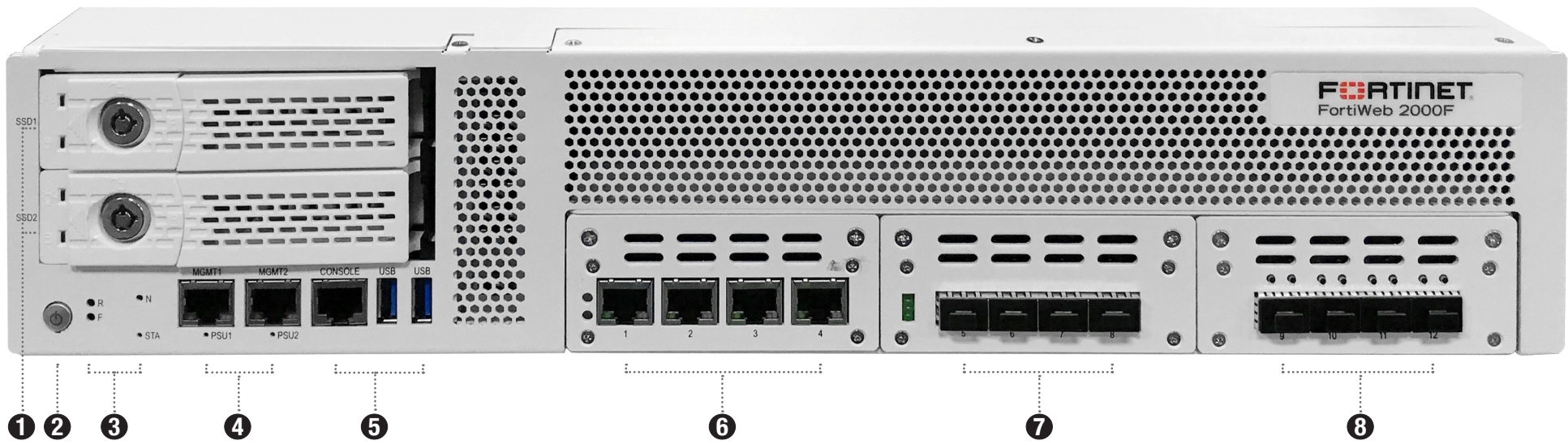

**1** Disk Storage 2x480GB SSD

**2** Power Button

- Blue: Device is on
- Off: Device is off

**3** System Management

- R:** System reboot button
- F:** Factory default reset button
- N:** NMI debug button

- STA:** System status indicator
- Green: System operating normally
  - Red: Critical system error
  - Flashing Red: Minor system error

**4** Management Ports MGMT1 192.168.1.99, MGMT2 192.168.2.99

- |  |   |
|--|---|
| <i>ACT</i>                             | <i>LINK</i>                             |
| ■ Green: Link established, no activity | ■ Amber: Link established at 1000Mbps   |
| ✦ Flashing Green: Data activity        | ■ Green: Link established at 100Mbps    |
| ■ Off: No link established             | ■ Off: No link established or at 10Mbps |

**Power Supply Status**

- Green: Power supplies operating normally
- Red: Power supply error

**5** Console Port (RJ-45) CLI management computer interface

**USB Ports (USB A)** 3.0 server ports

**6** Ports 1 to 4 (RJ-45) GE Ethernet ports

- |                 |  |
|-----------------|--|
| <i>LINK/ACT</i> | ■ Green: Link established, no activity               |
|                 | ✦ Flashing Green: Data activity                      |
|                 | ■ Off: No link established                           |
|                 | ■ Amber: Link established at 1000Mbps                |
| <i>SPEED</i>    | ■ Green: Link established at 100Mbps                 |
|                 | ■ Off: No link established or at 10Mbps              |
| <i>BYPASS</i>   | ■ Green: Bypass disabled, normal traffic flow to CPU |
|                 | ■ Red: Bypass active, traffic flows to the bypass    |
|                 | ■ Off: Open mode active, traffic drops               |

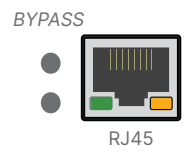
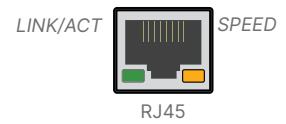

**7** Ports 5 to 8 (SFP) 1Gbps network connections

- Green: Link established at 1Gbps
- ✦ Flashing Green: Data activity
- Off: No link established



**8** Ports 9 to 12 (SFP+) 10Gbps network connections

- |                 |  |
|-----------------|--|
| <i>LINK/ACT</i> | ■ Green: Link established, no activity |
|                 | ✦ Flashing Green: Data activity        |
|                 | ■ Off: No link established             |
| <i>SPEED</i>    | ■ Blue: Link established at 10Gbps     |
|                 | ■ Off: No link established             |

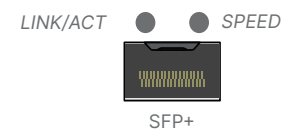

## Rear - FortiWeb 2000F



**1** Power Switch Appliance On/Off

**2** Redundant Hot-Swappable Power Supplies 100-240V AC, 10-5A, 50-60Hz

# Box Includes - FortiWeb 3000F

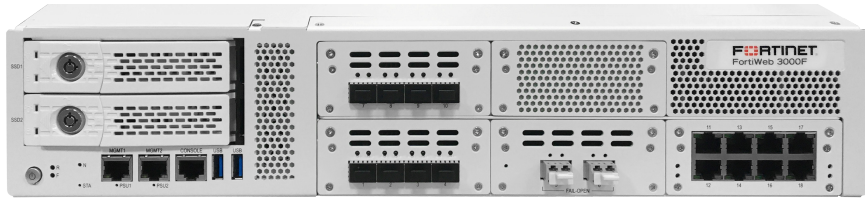

FortiWeb 3000F



QuickStart Guide



2x Power Cable



1x Console Cable  
(USB to RJ45)

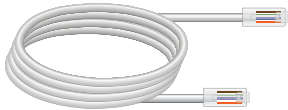

1x Ethernet Cable



2x HDD Tray Keys

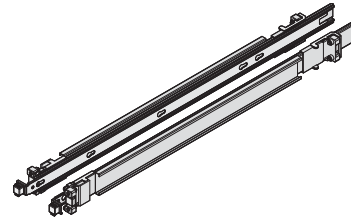

1x Rail Mount Kit  
(screws included)

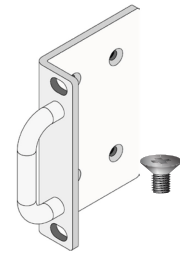

2x Handles, 4x Screws

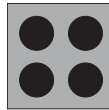

4x Rubber Feet

# Front - FortiWeb 3000F

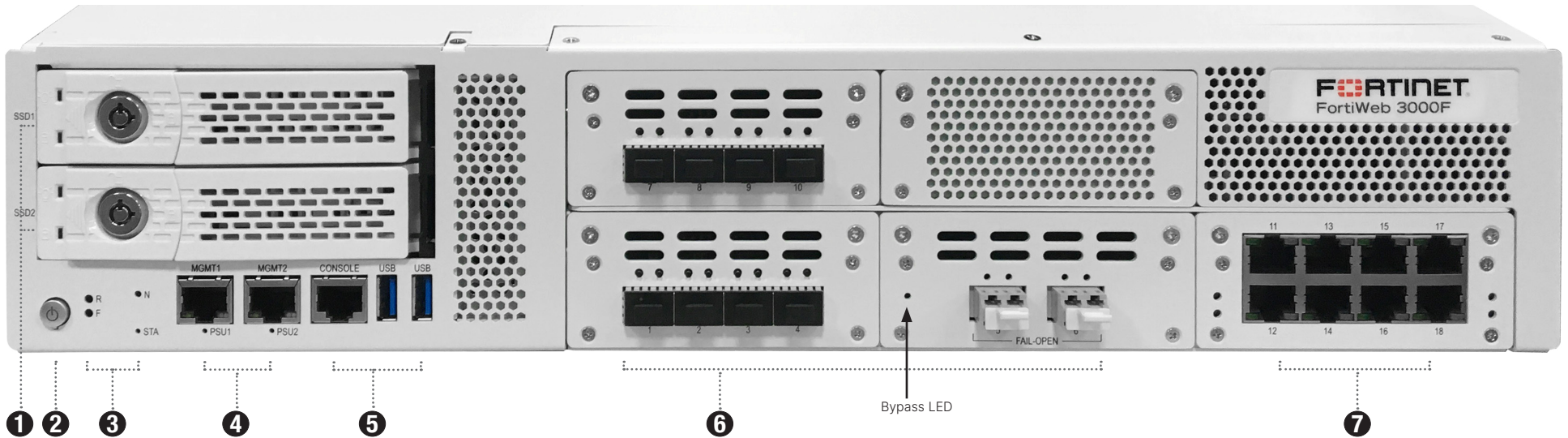

**1** Disk Storage 2× 960GB SSD

**2** Power Button

- Blue: Device is on
- Off: Device is off

**3** System Management

- R:** System reboot button
- F:** Factory default reset button
- N:** NMI debug button
- STA:** System status indicator
  - Green: System operating normally
  - Red: Critical system error
  - ⚡ Flashing Red: Minor system error

**4** Management Ports MGMT1 192.168.1.99, MGMT2 192.168.2.99

- |   |   |
|---|---|
| <b>ACT</b>  | <b>LINK</b>   |
| <span style="color: green;">■</span> Green: Link established, no activity | <span style="color: orange;">■</span> Amber: Link established at 1000Mbps |
| <span style="color: green;">⚡</span> Flashing Green: Data activity        | <span style="color: green;">■</span> Green: Link established at 100Mbps   |
| <span style="color: gray;">■</span> Off: No link established              | <span style="color: gray;">■</span> Off: No link established or at 10Mbps |

**Power Supply Status**

- Green: Power supplies operating normally
- Red: Power supply error

**5** Console Port (RJ-45) CLI management computer interface

**USB Ports (USB A)** 3.0 server ports

**6** Ports 1 to 10 (SFP+) 10Gbps network connections

- |                 |   |  |   |
|-----------------|---|--|---|
| <b>LINK/ACT</b> | <span style="color: green;">■</span> Green: Link established, no activity | <span style="color: gray;">●</span> LINK/ACT | <span style="color: gray;">●</span> SPEED |
|                 | <span style="color: green;">⚡</span> Flashing Green: Data activity        |  |   |
|                 | <span style="color: gray;">■</span> Off: No link established              |  |   |
| <b>SPEED</b>    | <span style="color: blue;">■</span> Blue: Link established at 10Gbps      |  | SFP+                                      |
|                 | <span style="color: gray;">■</span> Off: No link established or at 1Gbps  |  |   |

**Ports 5 & 6 (SFP+) 10Gbps Bypass connections**

- |               |   |  |
|---------------|---|--|
| <b>BYPASS</b> | <span style="color: green;">■</span> Green: Bypass disabled, normal traffic flow to CPU | <span style="color: gray;">●</span> BYPASS |
|               | <span style="color: red;">■</span> Red: Bypass active, traffic flows to the bypass      |  |
|               | <span style="color: gray;">■</span> Off: Open mode active, traffic drops                |  |
|               |   | SFP+                                       |

**7** Ports 11 to 18 (RJ-45) GE Ethernet ports

- |                 |   |  |   |
|-----------------|---|--|---|
| <b>LINK/ACT</b> | <span style="color: green;">■</span> Green: Link established, no activity | <span style="color: gray;">●</span> LINK/ACT | <span style="color: gray;">●</span> SPEED |
|                 | <span style="color: green;">⚡</span> Flashing Green: Data activity        |  |   |
|                 | <span style="color: gray;">■</span> Off: No link established              |  |   |
| <b>SPEED</b>    | <span style="color: orange;">■</span> Amber: Link established at 1000Mbps |  | RJ45                                      |
|                 | <span style="color: green;">■</span> Green: Link established at 100Mbps   |  |   |
|                 | <span style="color: gray;">■</span> Off: No link established or at 10Mbps |  |   |

**Ports 11 & 12, 13 & 14, 15 & 16, 17 & 18 (RJ-45) GE Ethernet Bypass ports**

- |               |   |
|---------------|---|
| <b>BYPASS</b> | <span style="color: green;">■</span> Green: Bypass disabled, normal traffic flow to CPU |
|               | <span style="color: red;">■</span> Red: Bypass active, traffic flows to the bypass      |
|               | <span style="color: gray;">■</span> Off: Open mode active, traffic drops                |



## Rear - FortiWeb 3000F



**1** Power Switch Appliance On/Off

**2** Redundant Hot-Swappable Power Supplies 100-240V AC, 10-5A, 50-60Hz

# Box Includes - FortiWeb 4000F



FortiWeb 4000F



QuickStart Guide



2x Power Cable



1x Console Cable  
(USB to RJ45)

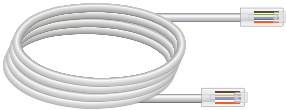

1x Ethernet Cable



2x HDD Tray Keys

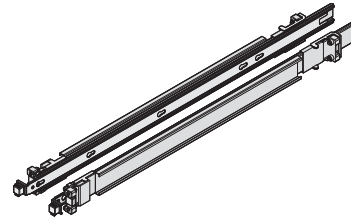

1x Rail Mount Kit  
(screws included)

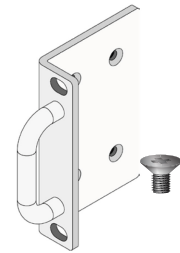

2x Handles, 4x Screws

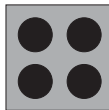

4x Rubber Feet

# Front - FortiWeb 4000F

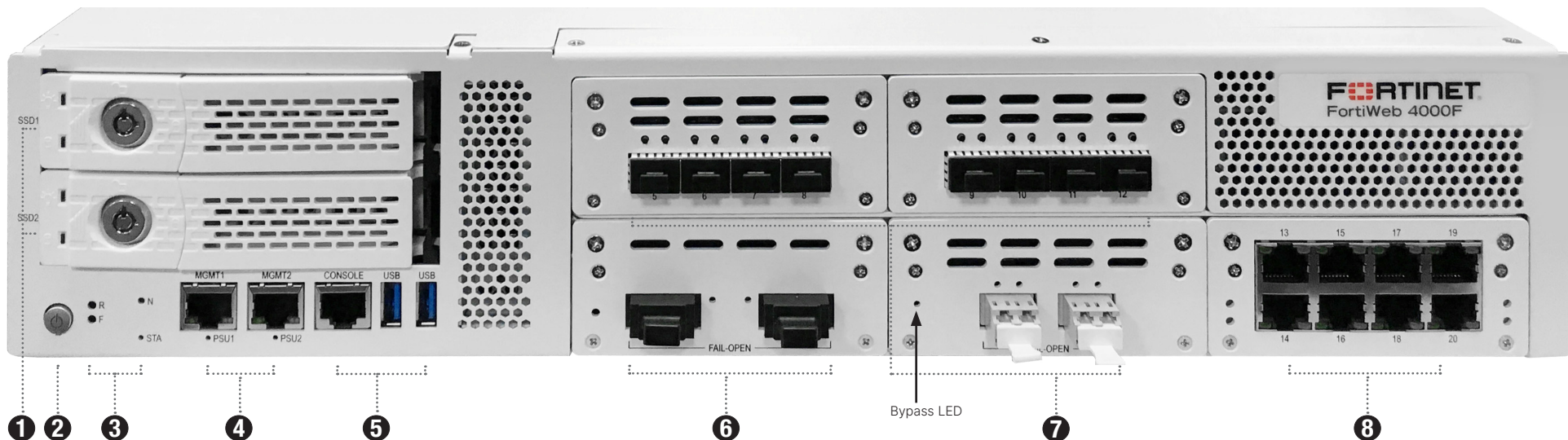

**1** Disk Storage 2x 960GB SSD

**2** Power Button  
 ● Blue: Device is on  
 ● Off: Device is off

**3** System Management  
 R: System reboot button  
 F: Factory default reset button  
 N: NMI debug button  
 STA: System status indicator  
 ● Green: System operating normally  
 ● Red: Critical system error  
 ● Flashing Red: Minor system error

**4** Management Ports MGMT1 192.168.1.99, MGMT2 192.168.2.99  
 ACT  
 ■ Green: Link established, no activity  
 ● Flashing Green: Data activity  
 ■ Off: No link established  
 LINK  
 ■ Amber: Link established at 1000Mbps  
 ■ Green: Link established at 100Mbps  
 ■ Off: No link established or at 10Mbps

**Power Supply Status**  
 ● Green: Power supplies operating normally  
 ● Red: Power supply error

**5** Console Port (RJ-45) CLI management computer interface  
 USB Ports (USB A) 3.0 server ports

**6** Ports 1 & 2 (QSFP+) 40Gbps network connections

LINK/ACT  
 ■ Green: Link established at 40Gbps  
 ● Flashing Green: Data activity  
 ■ Off: No link established  
 BYPASS  
 ■ Green: Bypass disabled, normal traffic flow to CPU  
 ■ Red: Bypass active, traffic flows to the bypass  
 ■ Off: Open mode active, traffic drops



QSFP+

**7** Ports 3 to 12 (SFP+) 10Gbps network connections

LINK/ACT  
 ■ Green: Link established, no activity  
 ● Flashing Green: Data activity  
 ■ Off: No link established  
 SPEED  
 ■ Blue: Link established at 10Gbps  
 ■ Off: No link established or at 1Gbps  
 BYPASS  
 ■ Green: Bypass disabled, normal traffic flow to CPU  
 ■ Red: Bypass active, traffic flows to the bypass  
 ■ Off: Open mode active, traffic drops

**8** Ports 13 to 20 (RJ-45) GE Ethernet ports

LINK/ACT  
 ■ Green: Link established, no activity  
 ● Flashing Green: Data activity  
 ■ Off: No link established  
 SPEED  
 ■ Amber: Link established at 1000Mbps  
 ■ Green: Link established at 100Mbps  
 ■ Off: No link established or at 10Mbps

**Ports 13 & 14, 15 & 16, 17 & 18, 19 & 20 (RJ-45) GE Ethernet Bypass ports**

BYPASS  
 ■ Green: Bypass disabled, normal traffic flow to CPU  
 ■ Red: Bypass active, traffic flows to the bypass  
 ■ Off: Open mode active, traffic drops

## Rear - FortiWeb 4000F



**1** Power Switch Appliance On/Off

**2** Redundant Hot-Swappable Power Supplies 100-240V AC, 10-5A, 50-60Hz

# Rack Installation

The supplied equipment is designed for standard 19inch racks.

## Rack Stability

Ensure the rack is stable before installing the slide rails and appliance.

- Check that the leveling jacks on the bottom of the rack are fully extended to the floor with the full weight of the rack resting on the jacks
- For single rack installation, stabilizers should be attached to the rack; for multiple rack installations, the racks should be coupled together

## Appliance Installation

- To avoid personal injury or equipment damage, use a lifting device
- Do not pick up the appliance by the front handles
- Each inner rail has a system lock out tab to prevent the appliance from sliding out, ensure that it is locked when installing the appliance
- Prevent Electrostatic discharge (ESD) damage by wearing antistatic devices
- Do not place heavy objects on the appliance

## What You Will Need

- Philips screwdriver, level & tape measure
- Rack-provided cage nuts and screws
- A lifting device or additional support
- ESD antistatic gear

## Support

For video support on installing these slide rails, please visit:

<https://video.fortinet.com>

For additional support, please visit:

<http://support.fortinet.com>

## Rail Assembly

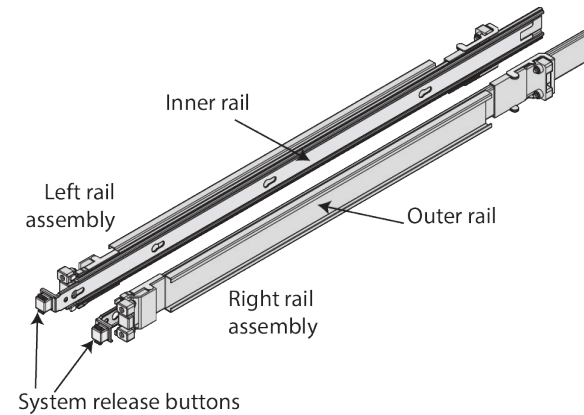

- The rail kit includes a left and a right rail assembly
- Each rail assembly includes an inner rail, a middle rail, and an outer rail
- The inner rail has locking keyholes used to secure the rail to the appliance
- The inner rail rear end has a lock out tab which slides into the middle rail
- The middle rail is in the outer rail and used to guide the inner rail into the outer rail
- The outer rail has front and rear mounting pins that push into to the rack holes
- The outer rail also has front and rear locking latches to secure the rail to the rack

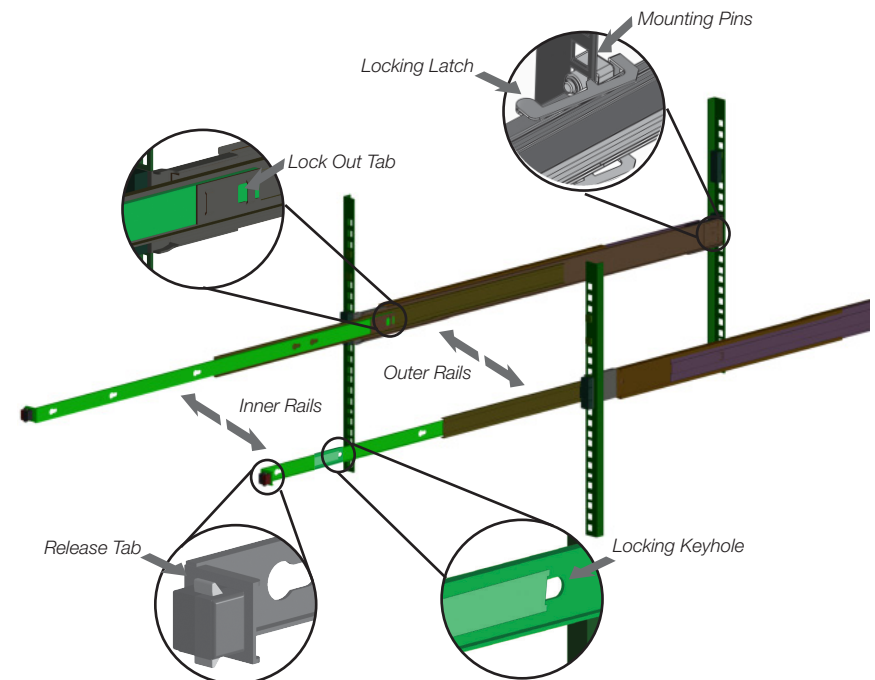

## Attach the Inner Rails to the Appliance

1. Detach the inner rail from the rail assembly by pressing the lock out tab
2. Place an inner rail against a side of the appliance
3. Align the inner rail keyholes with the appliance pins
4. Slide the rail towards the front of the appliance until the metal clip locks into place
5. For inner rails with 5 keyholes and a chassis with 3 pins and a thread hole, use the provided M4 shoulder screw to secure the rail to the appliance
6. Repeat steps 1 to 5 for the remaining inner rail

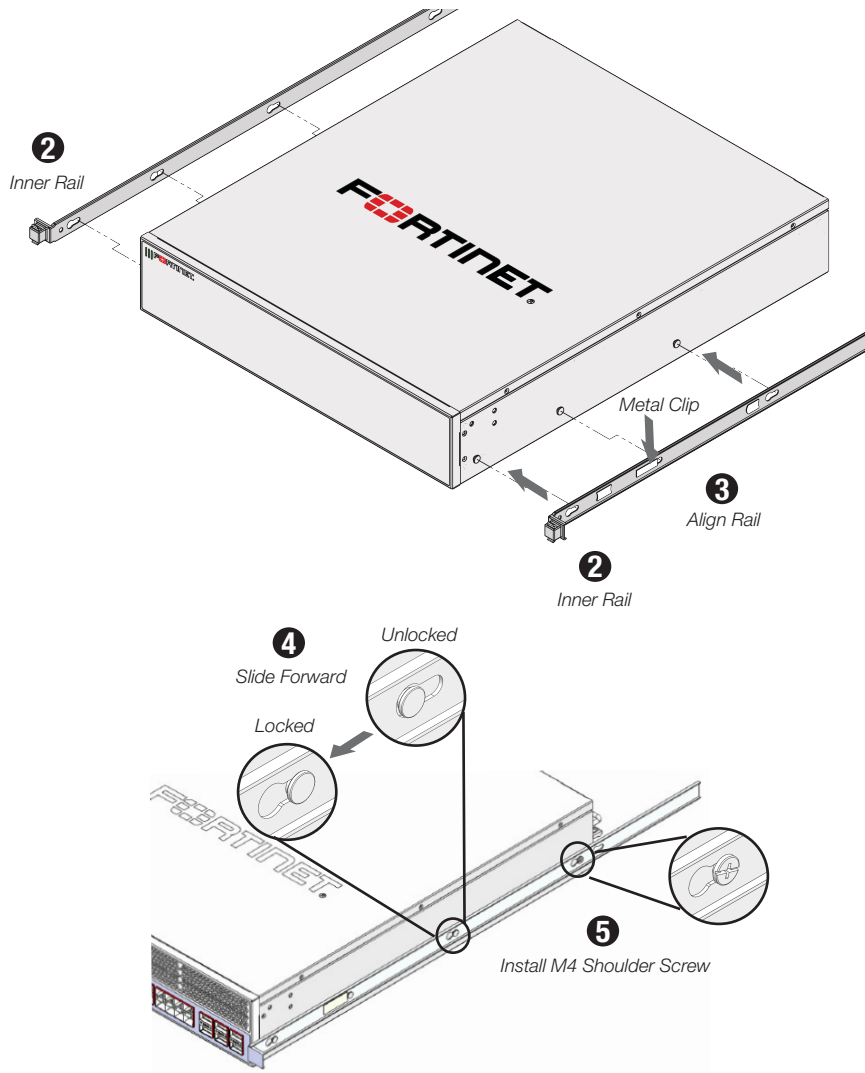

## Attach the Outer Rails to the Rack

### Front Outer Rail

1. Place an outer rail against a side of the rack
2. Align the front outer rail with the front of the rack
3. Push the front outer rail mounting pins into the rack post holes
4. Lock the locking latch to safely secure the front outer rail to the post

### Rear Outer Rail

5. Extend the rear outer rail just past the rack post
6. Level the rail and align the mounting pins
7. Push the rear mounting pins into the rack post holes
8. Lock the locking latch to safely secure the rear outer rail to the post
9. Repeat steps 1 to 8 for the remaining outer rail

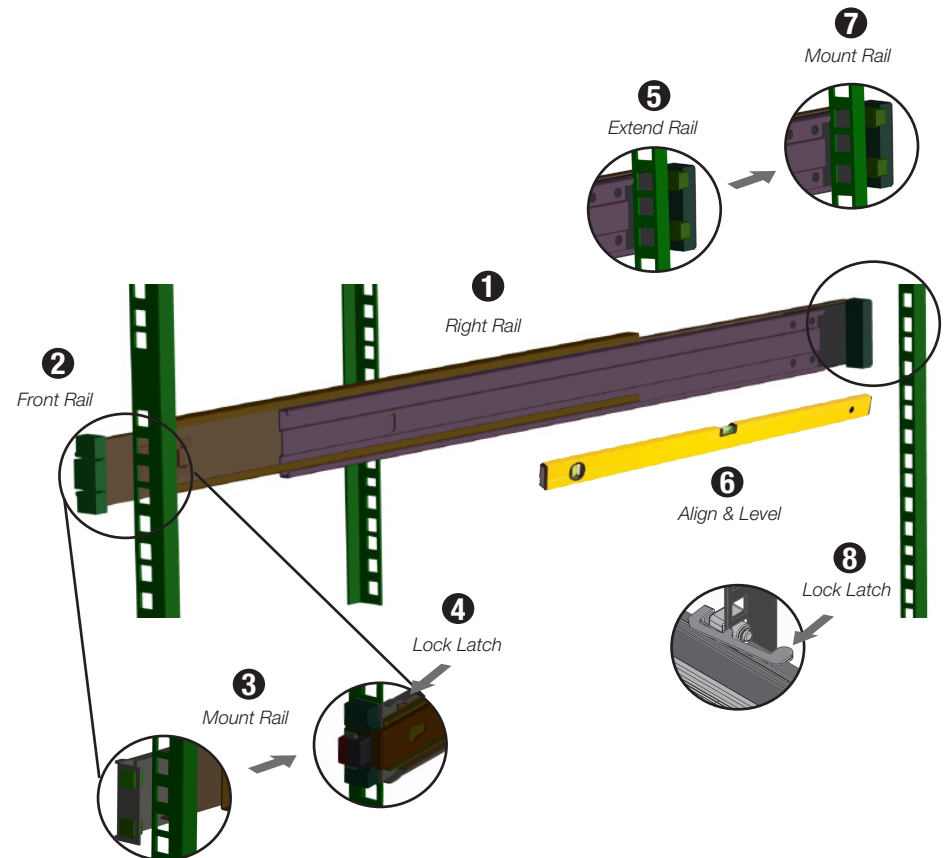

## Basic Connections

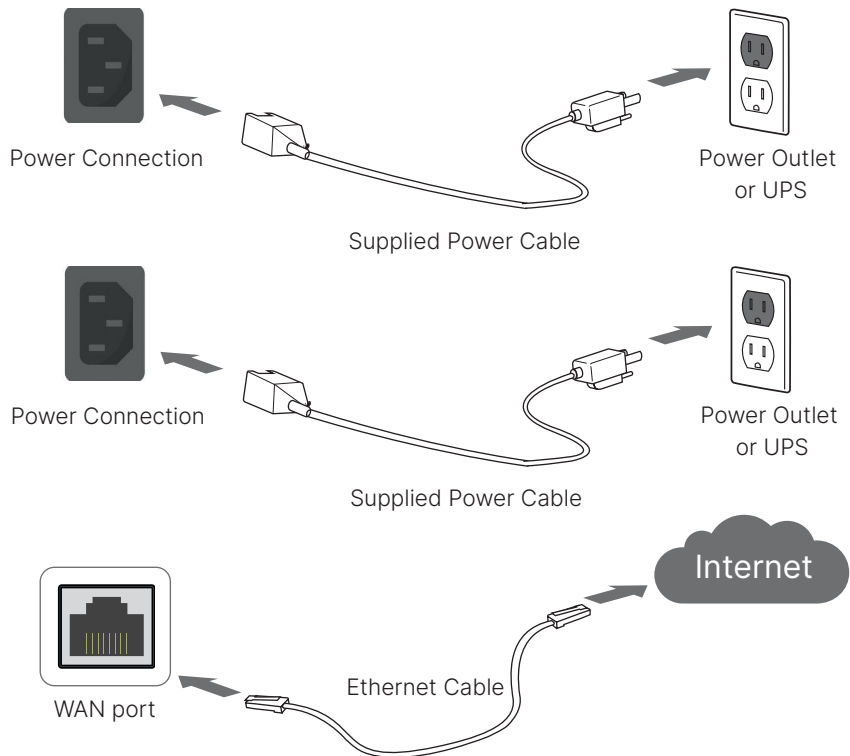

1. **Plug in** your device to power outlet using the **provided power cables**
2. Connect a **WAN port** to the internet using the supplied **Ethernet cable**

**Note:** Your device has dual AC inputs for failover redundancy. If both AC inputs are used, only one is active. If the active AC input fails, the second input will be active.

## SFP Installation

To install the SFP transceivers

1. **Slide the SFP** into the cage socket until it **clicks into place**
2. **Lift the latch** to **lock the SFP**

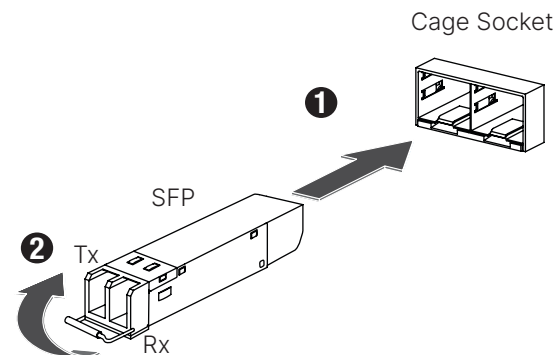

To remove the SFP transceivers

1. **Lower the latch** to unlock the SFP
2. **Carefully pull the SFP out** of the cage socket

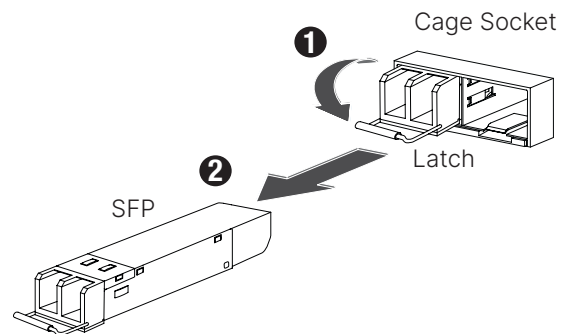

**Note:** For more information, visit [support.fortinet.com](https://support.fortinet.com)

# Appliance Setup

Set up your appliance locally or on the cloud by choosing one of the following options.



Local Setup

## GUI

Connect locally using a web-browser



Local Setup

## CLI

Connect locally using a direct console connection

# GUI

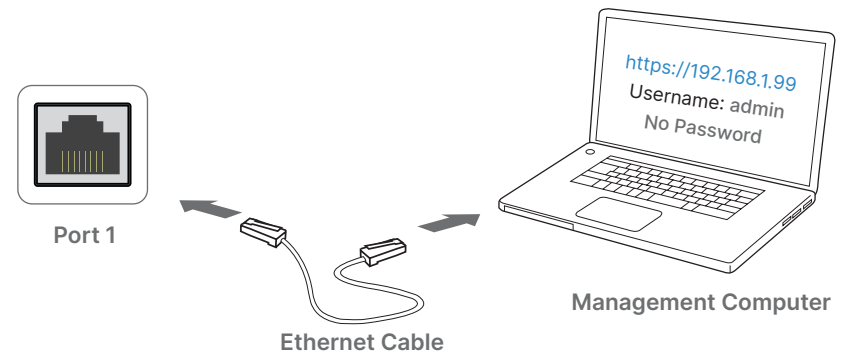

1. Connect **port 1** to the **Management Computer** with the supplied **Ethernet cable**
2. Enable **DHCP** or set the **Management Computer's IP** and subnet to:

**Static IP Address:** 192.168.1.1  
**Subnet Mask:** 255.255.255.0

3. Visit <https://192.168.1.99> in a web browser
4. Log in with username **admin** and leave the **password blank**
5. Create a **new password**, leave the Old Password blank
6. Log with username **admin** and your **new password**
7. Click **Begin** to complete your setup or **Later**

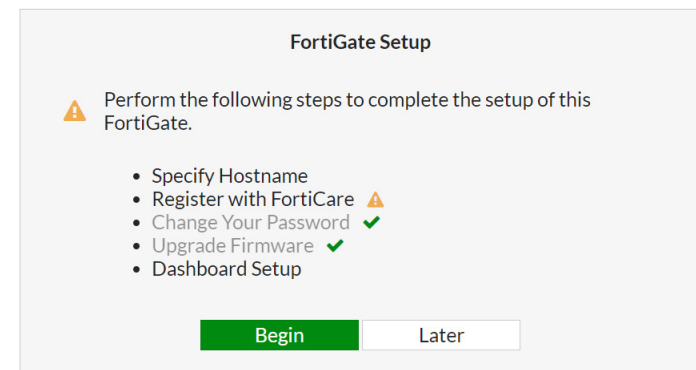



# CLI

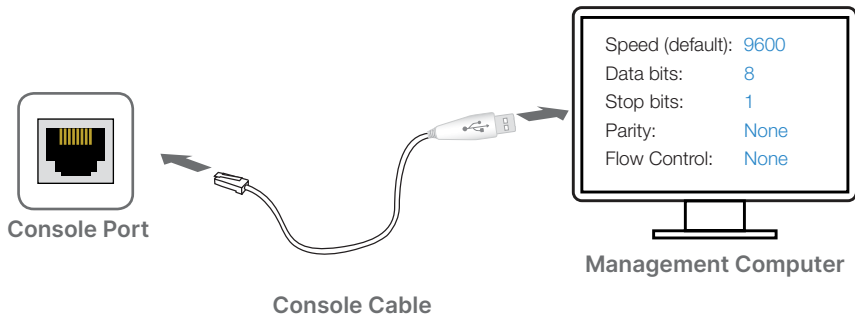

1. Connect the **Console Port** with a console cable to the Management Computer
2. Start a **terminal emulation program** on the Management Computer and select an available **COM Port** using the following default settings:

Baud rate: 9600  
 Data bits: 8  
 Parity: None  
 Stop bits: 1  
 Flow control: None

4. Press **Enter** on your keyboard to connect to the CLI
5. **Log in** using username **admin** and **no password**
6. Enter CLI commands to configure your appliance

**Note:** For detailed CLI instructions, visit [support.fortinet.com](http://support.fortinet.com)

## Cautions and Warnings

### Environmental specifications

Ambient operating temperature: 0°C to 40°C

Rack Mount Instructions - The following or similar rack-mount instructions are included with the installation instructions:

Instructions de montage en rack - Les instructions de montage en rack suivantes ou similaires sont incluses avec les instructions d'installation:

**Elevated Operating Ambient** - If installed in a closed or multi-unit rack assembly, the operating ambient temperature of the rack environment may be greater than room ambient. Therefore, consideration should be given to installing the equipment in an environment compatible with the maximum ambient temperature (T<sub>ma</sub>) specified by the manufacturer. **Température ambiante élevée** - S'il est installé dans un rack fermé ou à unités multiples, la température ambiante de fonctionnement de l'environnement du rack peut être supérieure à la température ambiante de la pièce. Par conséquent, il est important d'installer le matériel dans un environnement respectant la température ambiante maximale (T<sub>ma</sub>) stipulée par le fabricant.

**Reduced Air Flow** - Installation of the equipment in a rack should be such that the amount of air flow required for safe operation of the equipment is not compromised. **Ventilation réduite** - Installation de l'équipement dans un rack doit être telle que la quantité de flux d'air nécessaire au bon fonctionnement de l'équipement n'est pas compromise.

**Mechanical Loading** - Mounting of the equipment in the rack should be such that a hazardous condition is not achieved due to uneven mechanical loading. **Chargement Mécanique** - Montage de l'équipement dans le rack doit être telle qu'une situation dangereuse n'est pas liée à un chargement mécanique inégal.

**Circuit Overloading** - Consideration should be given to the connection of the equipment to the supply circuit and the effect that overloading of the circuits might have on overcurrent protection and supply wiring. Appropriate consideration of equipment nameplate ratings should be used when addressing this concern.

**Surtenision** - Il convient de prendre l'ensemble des précautions nécessaires lors du branchement de l'équipement au circuit d'alimentation et être particulièrement attentif aux effets de la suralimentation sur le dispositif assurant une protection contre les courts-circuits et le câblage. Ainsi, il est recommandé de tenir compte du numéro d'identification de l'équipement.

**Reliable Earthing** - Reliable earthing of rack-mounted equipment should be maintained. Particular attention should be given to supply connections other than direct connections to the branch circuit (e.g. use of power strips). **Fiabilité de la mise à la terre** - Fiabilité de la mise à la terre de l'équipement monté en rack doit être maintenue. Une attention particulière devrait être accordée aux connexions d'alimentation autres que les connexions directes au circuit de dérivation (par exemple de l'utilisation de bandes de puissance).

Refer to specific Product Model Data Sheet for Environmental Specifications (Operating Temperature, Storage Temperature, Humidity, and Altitude)

Référez à la Fiche Technique de ce produit pour les caractéristiques environnementales (Température de fonctionnement, température de stockage, humidité et l'altitude).

### Safety

**Moving parts** - Hazardous moving parts. Keep away from moving fan blades. **Pièces mobiles** - Pièces mobiles dangereuses. Se tenir éloigné des lames mobiles du ventilateur.

**Warning:** Equipment intended for installation in Restricted Access Location. **Avertissement:** Le matériel est conçu pour être installé dans un endroit où l'accès est restreint.

This equipment is not suitable for use in locations where children are likely to be present. Cet équipement n'est pas adapté à une utilisation dans des endroits où des enfants sont susceptibles d'être présents.

**Battery** - Risk of explosion if the battery is replaced by an incorrect type. Do not dispose of batteries in a fire. They may explode. Dispose of used batteries according to your local regulations. **IMPORTANT:** Switzerland: Annex 4.10 of SRB14.013 applies to batteries.

**Batterie** - Risque d'explosion si la batterie est remplacée par un type incorrect. Ne jetez pas les batteries au feu. Ils peuvent exploser. Jetez les piles usagées conformément aux réglementations locales. **IMPORTANT:** Suisse: l'annexe 4.10 de SRB14.013 s'appliquent aux batteries.

警告  
 本電池如果更換不正確會有爆炸的危險  
 請依製造商說明書處理用過之電池

**CAUTION:**  
 There is a danger of explosion if a battery is incorrect replaced. Replace only with the same or equivalent type.  
 Dispose batteries of according to the manufacturer's instructions.  
 Disposing a battery into fire, a hot oven, mechanically crushing, or cutting it can result in an explosion.  
 Leaving a battery in an extremely hot environment can result in leakage of flammable liquid, gas, or an explosion.  
 If a battery is subjected to extremely low air pressure, it may result in leakage of flammable liquid, gas, or an explosion.

**WARNUNG:**  
 Lithium-Batterie Achtung: Explosionsgefahr bei fehlerhafter Batteriewechsel. Ersetzen Sie nur den gleichen oder gleichwertigen Typ. Batterien gemäß den Anweisungen des Herstellers entsorgen.

Beseitigung einer BATTERIE in Feuer oder einen heißen Ofen oder mechanisches Zerklütern oder Schneiden einer BATTERIE, die zu einer EXPLOSION führen kann

Verlassen einer BATTERIE in einer extrem hohen Umgebungstemperatur, die zu einer EXPLOSION oder zum Austreten von brennbarer Flüssigkeit oder Gas führen kann

Eine BATTERIE, die einem extrem niedrigen Luftdruck ausgesetzt ist, der zu einer EXPLOSION oder zum Austreten von brennbarer Flüssigkeit oder Gas führen kann.

**CAUTION:** Shock Hazard. Disconnect all power sources.  
**ATTENTION:** Risque d'électrocution. Débranchez toutes les sources d'alimentation.

Convient pour une utilisation dans l'espace aérien conformément à l'article 300-22 (C) du Code National de l'Électricité, et des articles 2-128, 12-010 (3) et 12-100 du Code de l'électricité canadien, Partie 1, CSA C22.1.

**Caution:** Slide/rail mounted equipment is not to be used as a shelf or a work space.

**Attention:** Un équipement monté sur bâti ne doit pas être utilisé sur une étagère ou dans un espace de travail.

Laser Class 1 optical transceiver shall be used only  
 L'émetteur-récepteur optique de classe 1 laser doit être utilisé uniquement

The SFP ports should use UL Listed Optional Transceiver product, Rated 3.3Vdc, Laser Class 1.  
 Les ports SFP doivent utiliser un produit émetteur-récepteur en option répertorié UL, 3.3 Vdc, classe laser 1.

**Warning:** Class I Equipment. This equipment must be earthed. The power plug must be connected to a properly wired earth ground socket outlet. An improperly wired socket outlet could place hazardous voltage on accessible metal parts.

**Avertissement:** Équipement de classe I. Cet équipement doit être mis à la terre. La fiche d'alimentation doit être connectée à une prise de terre correctement câblée. Une prise de courant mal câblée pourrait placer une tension dangereuse sur les pièces métalliques accessibles.

**Warning:** All Ethernet cables are designed for intra-building connection to other equipment. Do not connect these ports directly to communication wiring or other wiring that exits the building where the appliance is located.

**Avertissement:** Tous les câbles Ethernet sont conçus pour une connexion intra-bâtiment à d'autres équipements. Ne connectez pas ces ports directement au câblage de communication ou à tout autre câblage qui sort du bâtiment où se trouve l'appareil.

## Regulatory Notices

### Federal Communication Commission (FCC) - USA

This device complies with Part 15 of FCC Rules. Operation is subject to the following two conditions:  
 (1) this device may not cause harmful interference, and  
 (2) this device must accept any interference received; including interference that may cause undesired operation.

This equipment has been tested and found to comply with the limits for a Class A digital device, pursuant to Part 15 of the FCC Rules. These limits are designed to provide reasonable protection against harmful interference when the equipment is operated in a commercial environment. This equipment generates, uses, and can radiate radio frequency energy, and if it is not installed and used in accordance with the instruction manual, it may cause harmful interference to radio communications. Operation of this equipment in a residential area is likely to cause harmful interference, in which case the user will be required to correct the interference at his own expense.

**WARNING:** Any changes or modifications to this product not expressly approved by the party responsible for compliance could void the user's authority to operate the equipment

### Industry Canada Equipment Standard for Digital Equipment (ICES) - Canada

CAN ICES-003 (A) / NMB-003 (A)

This digital apparatus does not exceed the Class A limits for radio noise emissions from digital apparatus set out in the Radio Interference Regulations of the Canadian Department of Communications.

Cet appareil numérique n'émet pas de bruits radioélectriques dépassant les limites applicables aux appareils numériques de la classe A prescrites dans le Règlement sur le brouillage radioélectrique édicté par le ministère des Communications du Canada.

### European Conformity (CE) - EU

This is a Class A product. In a domestic environment, this product may cause radio interference, in which case the user may be required to take adequate measures.



### Voluntary Control Council for Interference (VCCI) - Japan

この装置は、クラスA機器です。この装置を住宅環境で使用すると電波妨害を引き起こすことがあります。この場合には使用者が適切な対策を講ずるよう要求されることがあります。

VCCI-A

### Product Safety Electrical Appliance & Material (PSE) - Japan

日本では電気用品安全法(PSE)の規定により、同標している電源コードは本製品の専用電源コードとして利用し、他の製品に使用しないでください。

## Bureau of Standards Metrology and Inspection (BSMI) – Taiwan

The presence conditions of the restricted substance (BSMI RoHS table) are available at the link below:

限用物質含有情況表 (RoHS Table) 請到以下 網址下載：  
<https://www.fortinet.com/bsmi>

警告使用者：此為甲類資訊技術設備，於居住環境中使用時，可能會造成射頻擾動，在此種情況下，使用者會被要求採取某些適當的對策。

請仔細閱讀以下說明

1. 本設備勿置於潮濕處。
2. 連接至電源前，請先檢查電壓。
3. 當設備不用時，請將所有電源線拔除，避免電壓不穩而造成傷害。
4. 勿將任何液體灑入設備中，避免線路短路。
5. 基於安全理由，只有受到專業訓練的從業人員，才可以打開本設備。
6. 請勿自行調整或修理已通電的設備，以確保您的安全。
7. 如不小心受傷，請立刻找急救人員給予您適當的救援，千萬別因傷勢輕微而忽略自己的傷勢。
8. 請依照台灣法規處置電池。
9. 若正確更換電池可能導致爆炸危險，替換電池時，請使用設備生產商推薦使用的電池。
10. 請勿拆卸、刺穿或以其他方式損壞電池。
11. 雷射設備非用戶維修設備，請與生產商聯繫維修事宜。

英屬蓋曼群島商防特網股份有限公司台灣分公司  
地址：台北市內湖區行愛路176號2樓  
電話：(02) 27961666

## China

此为A级产品，在生活环境中，该产品可能会造成无线电干扰。这种情况下，可能需要用户对其采取切实可行的措施。

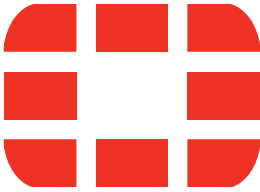

[Fortinet.com](https://www.fortinet.com)