



PRO Series
Personal Computer

PRO DP1 B0A7

Service Guide

Contents

How to Use this Service Manual.....	3
Necessary Tools	3
Safety Precautions	3
Other Notice.....	4
Upgrade and Warranty.....	4
Acquisition of Replaceable Parts	4
Removing the Cover	5
Installing the CPU.....	6
Installing the Thermal Module	8
Installing the Memory Module (DDR)	9
Installing the Solid-State Drive (SSD)	10
Installing the Wi-Fi Card	11
Installing the Graphics Card (VGA).....	12
Installing 2.5" & 3.5" Hard Disk Drive (HDD).....	14
Installing Optical Disc Drive (ODD) (Optional)	17

Revision

V1.1, 2023/05

How to Use this Service Manual

This Service Manual is targeted for MSI-authorized dealer or service center. It provides in-depth illustration of disassembling the system. Each topic may be related with each other; hence you are highly recommended to read this guide from cover to cover first. After that, you may go directly to any specific topic that most meets your immediate needs.



All information is subject to change without prior notice. The system photos are provided for demonstration of system disassembly only. The internal view of your system may vary depending on the model you purchased.

Necessary Tools

- A Phillips (crosshead) screwdriver and a flathead screwdriver, can be used to do most of the installation. Choose one with a magnetic head would be better.
- Pliers, can be used as an auxiliary tool to connect some connectors or cables.
- Box, can collect the screws and tiny objects.
- Forceps, can be used to pick up tiny screws or set up the jumpers.
- Rubber gloves, can prevent yourself from being incised and suffering the static charge.

Safety Precautions

The following precautions should be observed while handling the system:

- Place the system on a flat and stable surface.
- Do not place the system in environments subject to mist, smoke, vibration, excessive dust, salty or greasy air, or other corrosive gases and fumes.
- Do not drop or jolt the system.
- Do not bump or knock the LCD screen as it is fragile and could break.
- Do not use another power adapter other than the one enclosed with the system.
- Disconnect the AC/DC adapter before performing any installation procedures on the system.
- Do not perform any maintenance with wet hands.
- Prevent foreign substances, such as water, other liquids or chemicals, from entering the system while performing installation procedures on the system.
- Use a grounded wrist strap before handling system components such as CPU, Memory, HDD, mini PCI-E card, etc.
- Place system components on a grounded antistatic pad or on the bed that came with the components whenever the components are separated from the system.
- If there are any difficulties installing hardware devices, please contact MSI for further information.

Other Notice

The peripheral devices contained herein may vary depending on your actual system configuration.

Third-party trademarks and names are the properties of their respective owners.

The information contained herein relevant to software and hardware are for reference only and in accordance with actual system configuration. All information is subject to change without notice.

Upgrade and Warranty

Please note that certain components preinstalled in the product users purchased may be upgradable or replaceable by user's request. To learn more about upgrade limitation, please refer to the specification in the User's Manual. For any further information about the product users purchased, please contact the local dealer. It is strongly recommended that you contact the authorized dealer or service center for any upgrade or replace service.

Acquisition of Replaceable Parts

Please be noticed that the acquisition of replaceable parts (or compatible ones) of the product users purchased in certain countries or territories may be fulfilled by the manufacturer within 2 years at most since the product has been discontinued, depending on the official regulations declared at the time. Please contact the manufacturer via <https://www.msi.com/support/> for the detailed information about the acquisition of spare parts.

Removing the Cover



Before you remove or install any components, make sure the system is not turned on or connected to the AC power.

1. Place the system on a flat and steady surface. Unlock the 2 screws on the rear side, and keep the screws for later use.



2. Pull to open the cover carefully. Remove it, and set it aside for later use.

- Follow the above procedures in reverse order to install the cover.



Installing the CPU

1. Locate the CPU socket. Press the load lever down to unclip it.

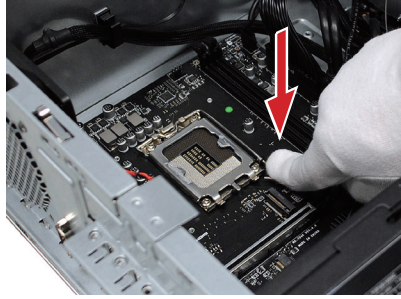

2. Open the load lever fully and carefully.

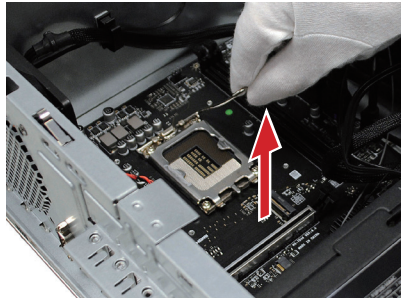

3. Next, open the load plate fully and carefully.

 **Important**

Do not touch the socket contacts or the bottom of the CPU.

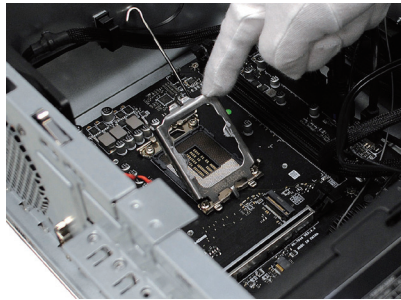

-
4. Align the notches with the socket alignment keys. Lower the CPU straight down, without tilting or sliding the CPU in the socket. Inspect the CPU to check if it is properly seated in the socket.

 **Important**

Hold the CPU carefully or it may cause serious damages.

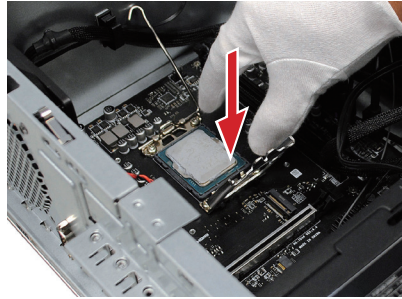

5. Close the load plate, and then close the load lever. Evenly spread a thin layer of thermal paste on the top of the CPU. This will help in heat dissipation and prevent CPU from overheating.

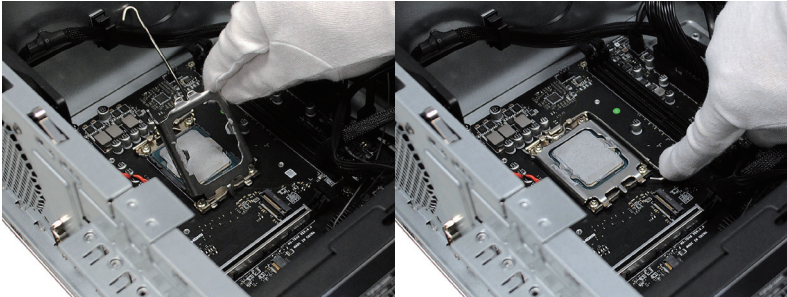

- *Follow the above procedures in reverse order to replace the CPU if needed.*
-

Installing the Thermal Module

1. Place the thermal module back and lock the 4 screws.

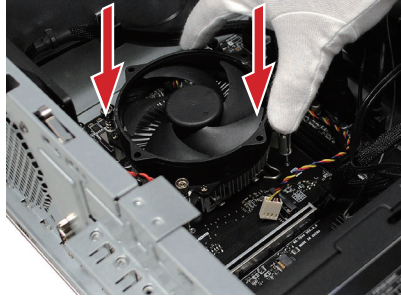

2. Connect the power cable.

- *Follow the above procedures in reverse order to replace the thermal module if needed.*

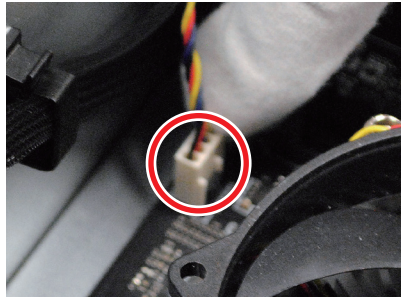

Installing the Memory Module (DDR)

1. Locate the DDR slot. Align the notch on the DDR with the key on the slot and insert the DDR into the slot.

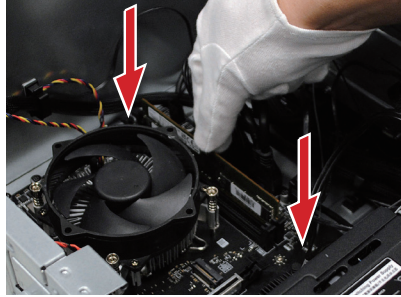

2. Push the DDR gently downwards until the slot clips click and lock the DDR in place.

- *Follow the above procedures in reverse order to replace the DDR if needed.*

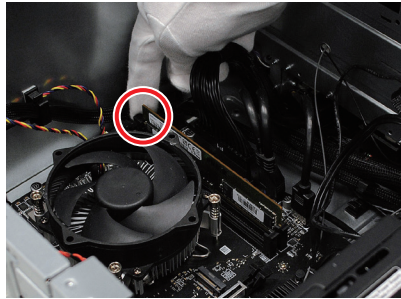

Installing the Solid-State Drive (SSD)

1. Locate the SSD slot. Unlock the screw if needed, and keep it for later use. Align the notch on the SSD with the key on the slot and insert the SSD into the slot.

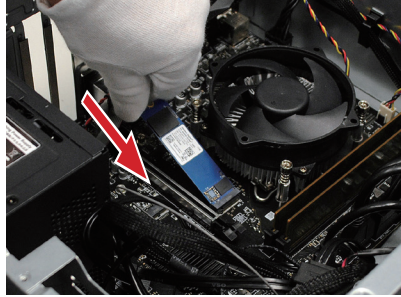

2. Push down the SSD and lock it with the screw.

- *Follow the above procedures in reverse order to replace the SSD if needed.*

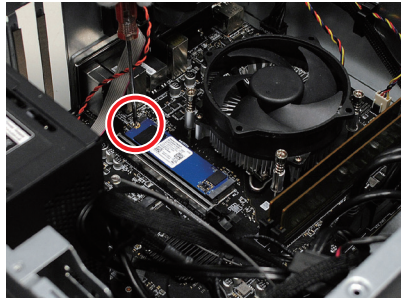

Installing the Wi-Fi Card

1. Locate the Wi-Fi card slot. Unlock the screw if needed, and keep it for later use. Align the notch on the Wi-Fi card with the key on the slot and insert the Wi-Fi card into the slot.

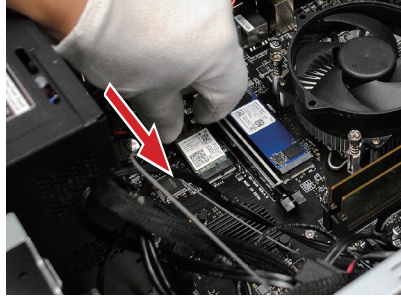

2. Push down the Wi-Fi card and lock it with screw. Connect the antennas carefully.

- *Follow the above procedures in reverse order to replace the Wi-Fi card if needed.*

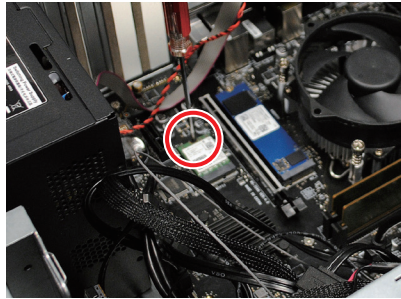

Installing the Graphics Card (VGA)

1. Open the PCI slot cover bracket.

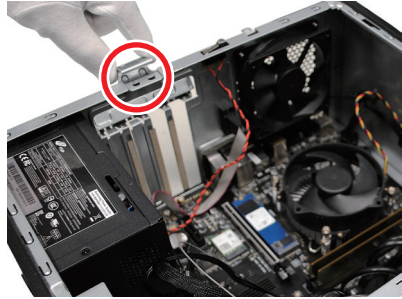

2. Locate the VGA card slot. Keep the gold fingers and the slot aligned, and push the VGA card till it can not go further.

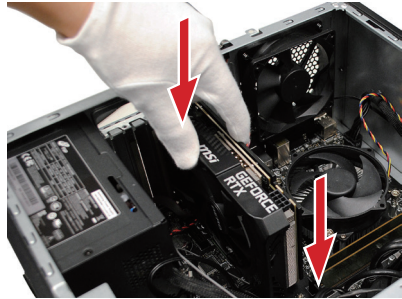

3. Connect the power cable.



-
4. Close the PCI slot cover bracket.

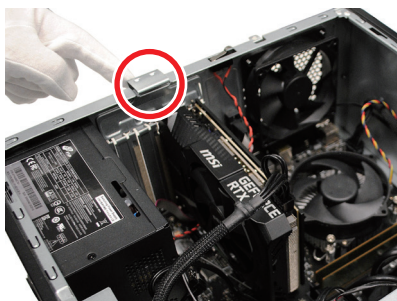

5. Lock 2 screws on the chassis to secure the VGA card.

- Follow the above procedures in reverse order to replace the VGA card if needed.

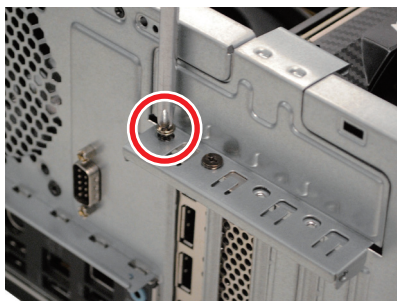

Installing 2.5" & 3.5" Hard Disk Drive (HDD)

1. Pull to open the front bezel carefully. Remove it, and set it aside for later use.

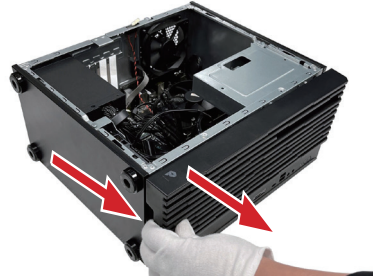

2. Unlock the screws on the rear side, and keep the screws for later use.

- Type 1

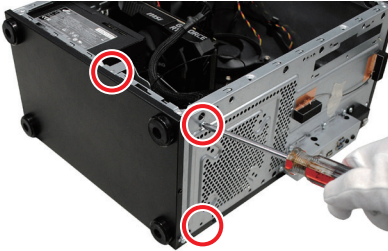

- Type 2

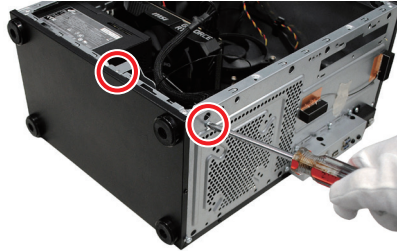

3. Locate the 1 screw between HDD tray and power supply. Unlock it on the chassis, and keep it for later use.

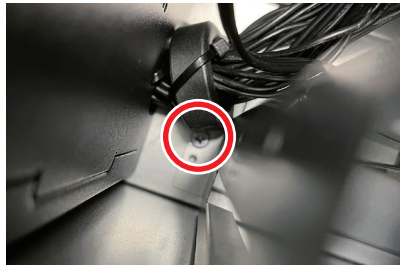

4. Take the HDD tray out carefully.

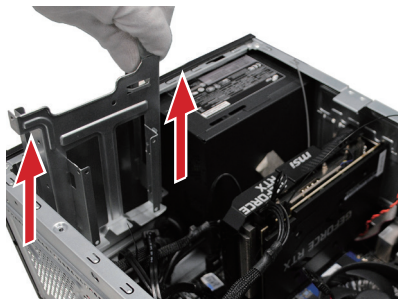

5. Place the 2.5" HDD on the HDD tray and lock the 4 screws.

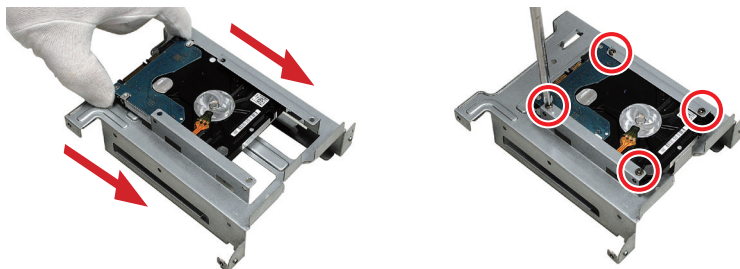

6. Place the 3.5" HDD on the HDD tray and lock the 4 screws.

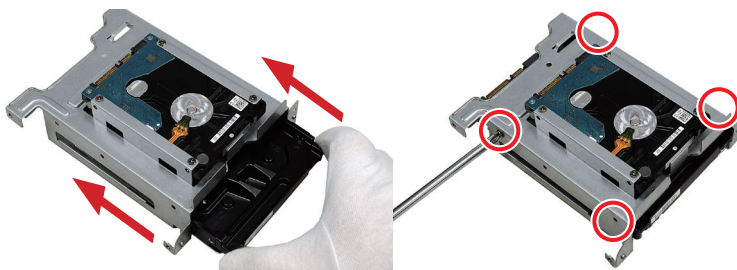

7. Place the HDD tray back carefully.

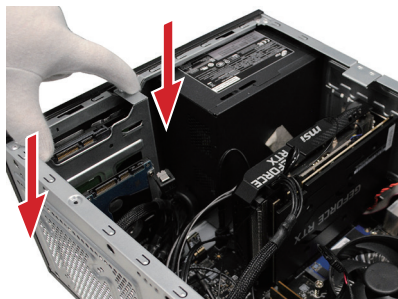

8. Lock all the screws back.



9. Connect the power cable and signal cable.

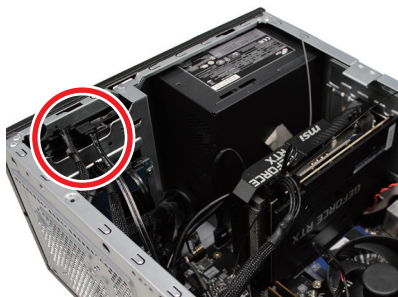

Installing Optical Disc Drive (ODD) (Optional)

1. Fit the bracket to the ODD and lock it with screw.



2. Place the ODD into the drive bay carefully.

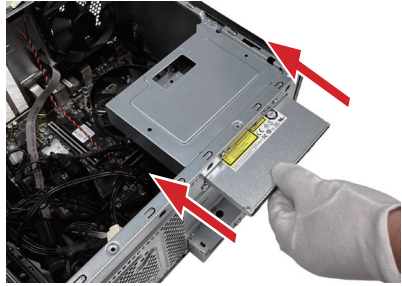

3. Lock the screw to secure the ODD.

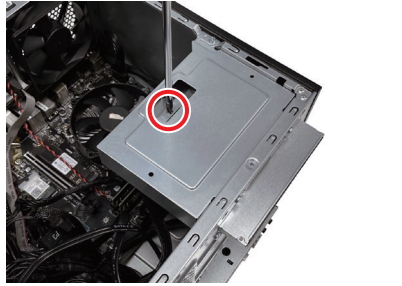

4. Connect the power and signal cable.



-
5. Install the front bezel carefully.

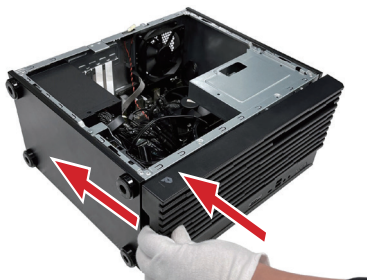

-
6. Insert an unfolded paper clip into the eject hole to open the ODD.

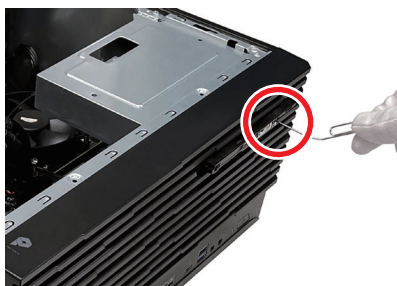

-
7. Align the hooks on the front bezel with the holes on the ODD and install it carefully.



-
8. Push to close the ODD.

