



ENH500-AX | EnStation 6

# Quick Installation Guide Outdoor Access Point / Client Bridge

ENH500-AX | EnStation 6

## ENH500-AX



Device\*2



PoE Adapter\*2



Quick Installation Guide



Power Cord\*2

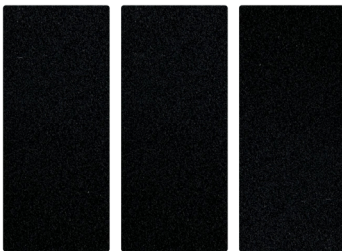

Waterproof\*2



Screw Set\*2

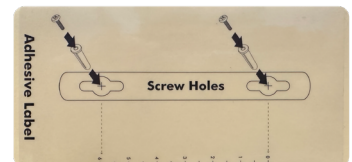

Adhesive Label



Pole Mounting Strap\*2

## EnStation 6



Device \*2



PoE Adapter\*2

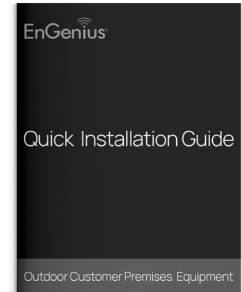

Quick Installation Guide



Sealing nut\*2



Bracket\*2



Power Cord\*2



Dynamic Stick\*2



Screw Set\*2



Pole Mounting Strap\*2

## Minimum Requirements

### Broadband Internet Service

(Cable or DSL Modem)

### Internet Browser

(Internet Explorer, Safari, Firefox, Chrome, Edge)

# 1 - Connecting the Device

## ENH500-AX

- Remove the rear bottom panel.
  - Connect one end of the Ethernet Cable to the LAN(PoE) port of the AP/Bridge and the other end to the PoE Port on the PoE Adapter.
  - Connect the Power Cord with the PoE Adapter and plug the other end into an electrical outlet.
  - Connect the second Ethernet Cable to the LAN port of the PoE Adapter and the other end to the Ethernet Port on the computer.
  - Place the panel removed from step A back into the device.
- Note:** The device should **ONLY** be powered via Ethernet Cable connected to the included PoE Adapter.

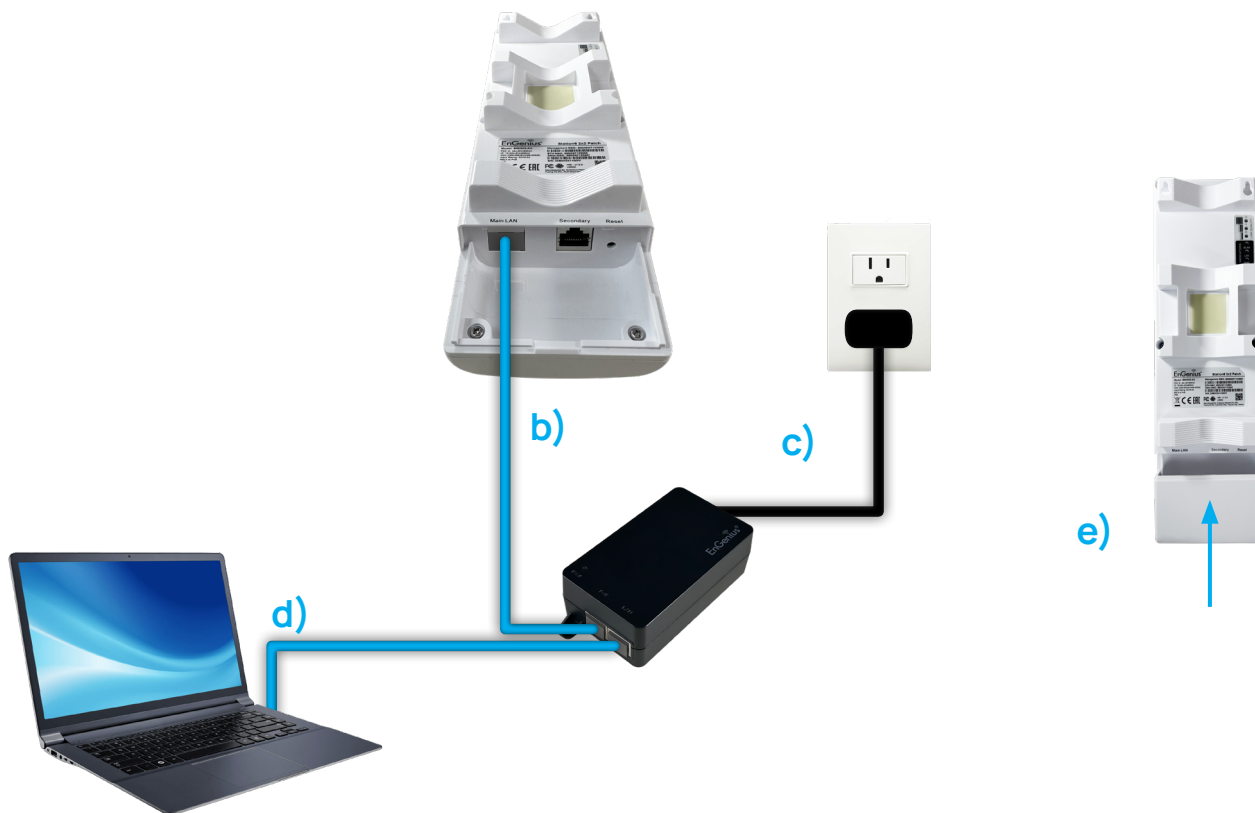

## EnStation 6

- Remove the rear bottom panel.
- Connect one end of the Ethernet Cable to the LAN(PoE) port of the CPE and the other end to the PoE Port on the PoE Adapter.
- Connect the Power Cord to the PoE Adapter and plug the other end into an electrical outlet.
- Connect the second Ethernet Cable to the LAN port of the PoE Adapter and the other end to the Ethernet Port onto the computer.
- Place the panel removed from step "a" back into the device.

• **Note:**

- The device should **ONLY** be powered via Ethernet Cable connected to the included PoE Adapter, EnStation 6 supports Proprietary 24V/54V PoE input.
- The 2nd Ethernet Port of the device can supply the 802.3af power source when used with the included PoE Adapter.



## 2 - IP Address Configuration

- a. Once your computer is on, ensure that your TCP/IP is set to “ON” or “Enabled”. Open **Network Connections** and then click **Local Area Connection**. Select **Internet Protocol Version 4 (TCP/IPv4)**.

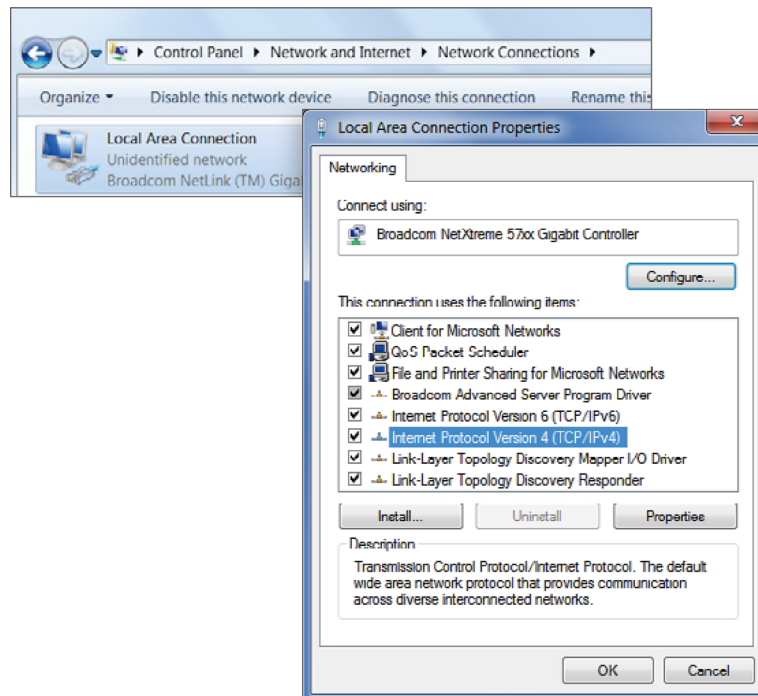

- b. If your computer is already on a network, ensure that you have set it to a Static IP Address on the interface. (Example: 192.168.1.10 and the Subnet Mask address as 255.255.255.0).

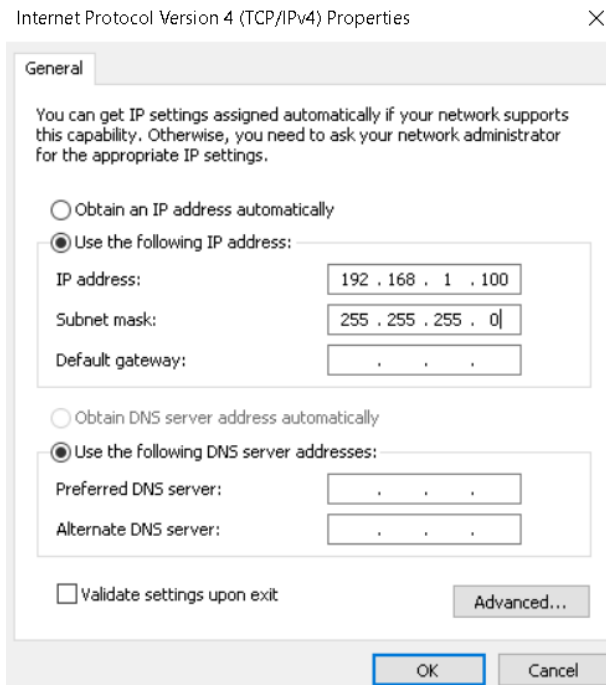

## 3 - Device Setup

- a. To configure the device, open a web browser. In the web browser's address bar enter **192.168.1.1** and hit enter.

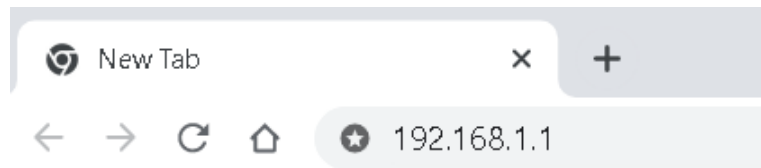

- b. A long screen will appear. By default, the device username is **"admin,"** and the password is **"admin"**. Enter the current username and password of the device and then click **Login**.

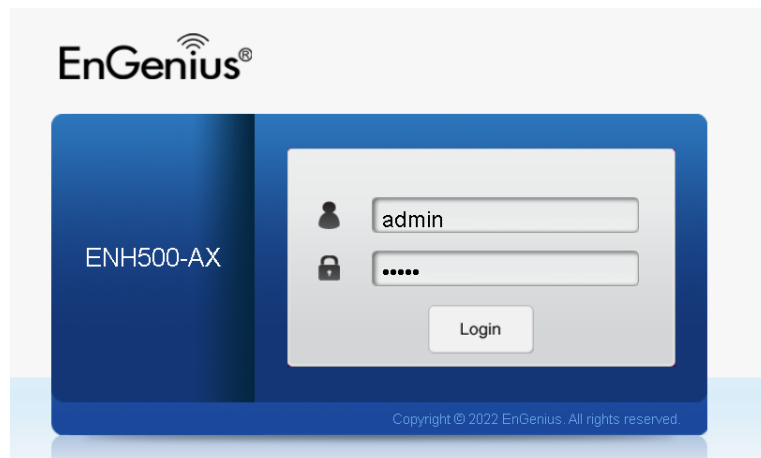

- **Note:** The model name on the login screen depends on the product you are using.
- c. You can also use the EnWiFi App and connect to the management SSID ,which is on the device label and GUI, to configure the device. The default Wi-Fi password is **12345678**.

# 4 - Switching Modes

## Configure on GUI

- a. The device can operate in the following modes:
  - Access Point, Client Bridge, WDS AP or WDS Station.

**EnGenius®** English

ENH500-AX AX3600 Dual Band Indoor Ceiling Mount Access Point Changes: 0 Reset Logout

**Overview**

- Device Status
- Connections
- Realtime

**Network**

- Basic
- Wireless

**Management**

- Advanced
- Time Zone
- WiFi Scheduler
- Tools

**System Manager**

- Account
- Firmware
- Log

**Device Information**

|                         |                          |
|-------------------------|--------------------------|
| Device Name             | ENH500-AX                |
| Serial Number           | 22B0XC411WH3             |
| MAC Address             |                          |
| - LAN                   | 88:DC:97:13:39:B0        |
| - Wireless LAN - 5GHz   | 88:DC:97:13:39:B2        |
| Country                 | USA                      |
| Current Local Time      | Wed Feb 15 20:00:14 2023 |
| Uptime                  | 0h 54m 56s               |
| Firmware Version        | v3.10.1_c                |
| Device Version          | 1.0                      |
| Management VLAN ID      | Untagged                 |
| Registration Check Code |                          |

**Memory Information**

|                 |                             |
|-----------------|-----------------------------|
| Total Available | 203368 kB / 381892 kB (53%) |
| Free            | 134384 kB / 381892 kB (35%) |
| Cached          | 52208 kB / 381892 kB (13%)  |
| Buffered        | 16776 kB / 381892 kB (4%)   |

- **Note:** The model name on the login screen depends on the product you are using.

a. Click on the Wireless link under the Network and set up the Operation Mode.

English

ENH500-AX AX3600 Dual Band Indoor Ceiling Mount Access Point Changes: 0 Reset Logout

**Overview**  
Device Status  
Connections  
Realtime  
**Network**  
Basic  
Wireless  
Management  
Advanced  
Time Zone  
WiFi Scheduler  
Tools  
System Manager  
Account  
Firmware  
Log

Wireless Settings

Device Name: ENH500-AX

Country / Region: USA

5GHz (ax/ac/n/a)

Operation Mode: Access Point  Green

WDS:  Enable  Disable

Channel HT Mode: Configuration

Channel: Configuration

Transmit Power: Auto

Bit Rate: Configuration

Client Limits:  Enable  Disable  
127

RSSI Threshold:  Enable  Disable  
-85 dBm  
(Range: -60dBm ~ -100dBm)

AP Detection: Scan

Distance (0-30km): 1 (0.6miles)

- It may take up to 90 seconds for the device to initially power up.

## Configure on EnWiFi App

b. Use EnWiFi App, open "Configure Wireless" to set up the Operation Mode.

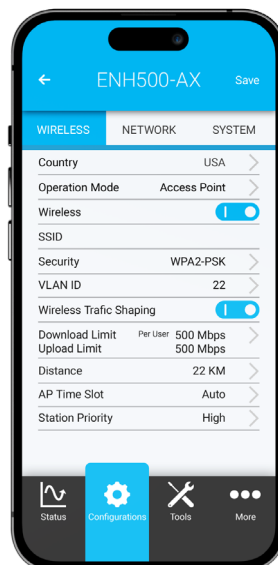



# 5 - Mounting the Device

## Wall Mounting

- a. Determine where the Access Point is to be placed and stick the Adhesive label on the surface.
- b. Use the appropriate drill bit to drill the 8.1 mm diameter and 26 mm depth holes on the markings of the label.
- c. Remove the label and Screw the anchors into the holes until they are flush with the wall.
- d. Screw the included screws into the anchors and place the Access Point against the wall with the mounting screw heads.

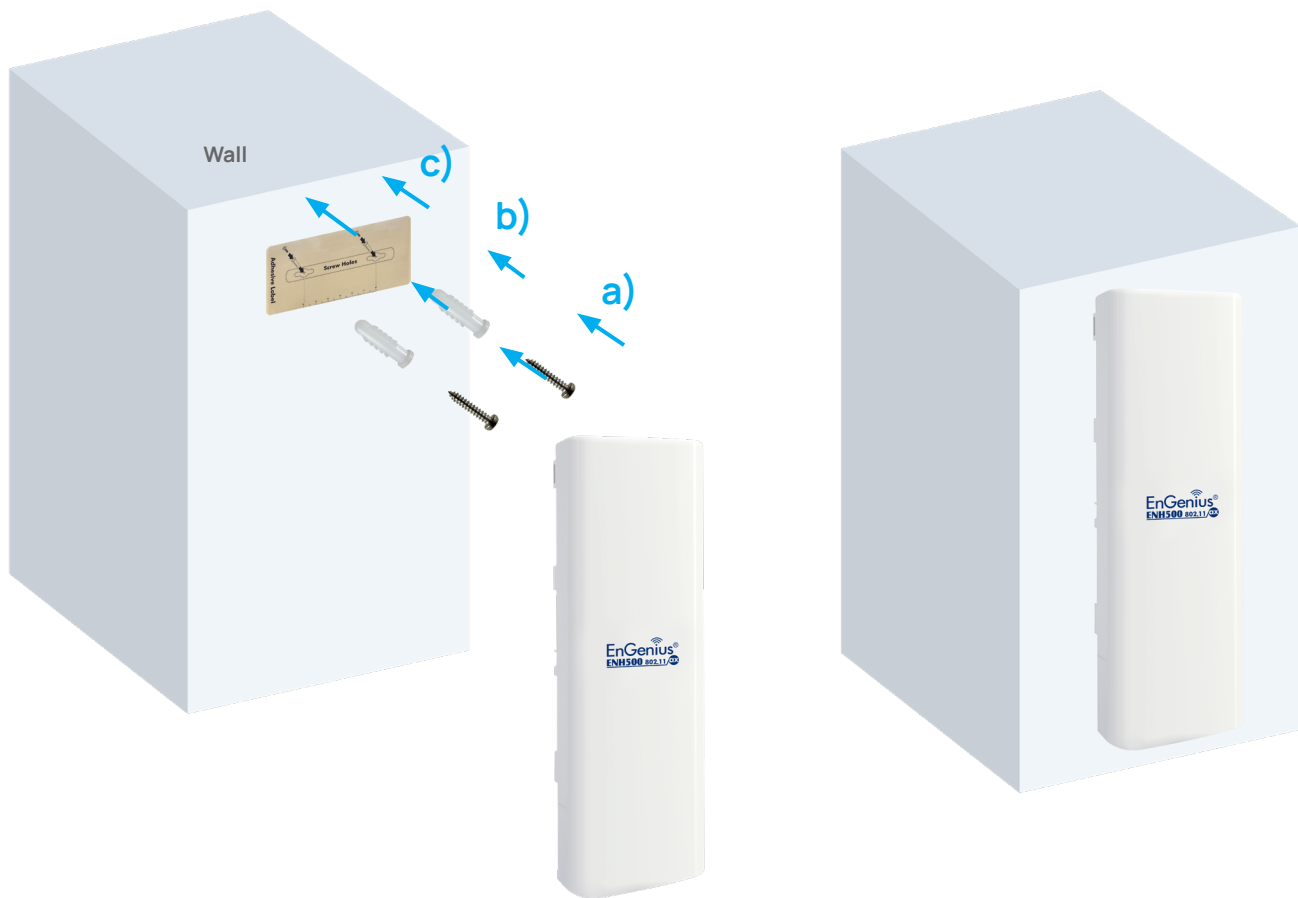

- a. Plug the dynamic stick into the bracket.
- b. Screw the sealing nut and assembled parts, tighten it with 80kgf.cm.
- c. Put the nock washer on the dynamic stick.
- d. Assemble the mounting parts to the device.

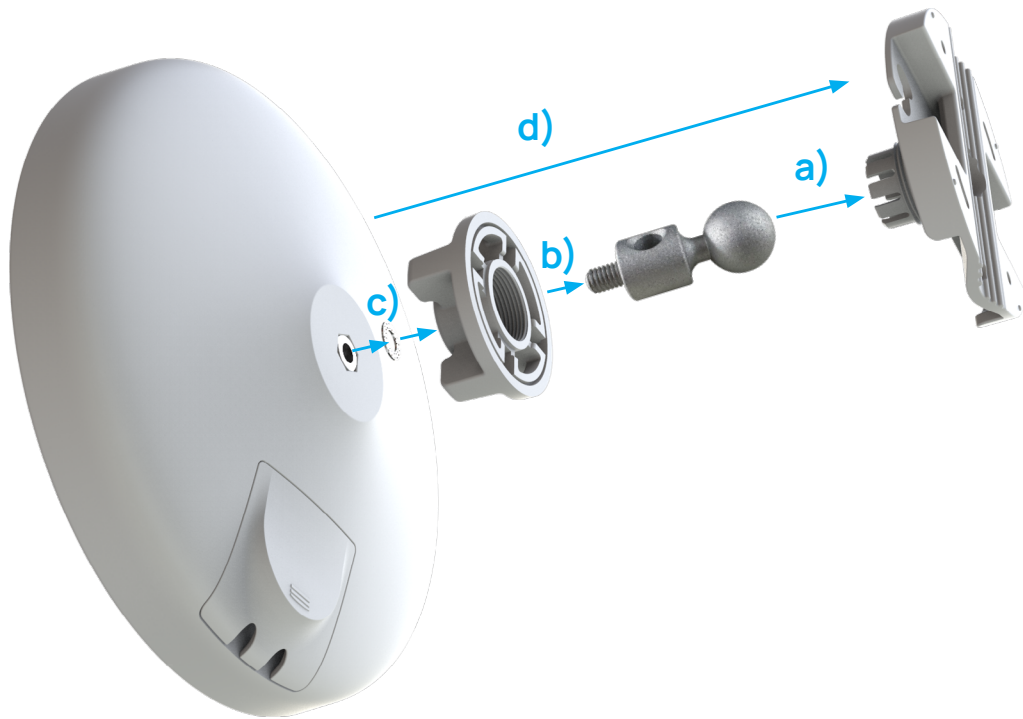

- e. Determine the mounting location. Mark and drill two pilot holes aligning to the screw holes of the bracket.
- f. Put wall anchors into the holes and insert the screw into the wall anchor.
- g. Screw and secure the bracket in place.

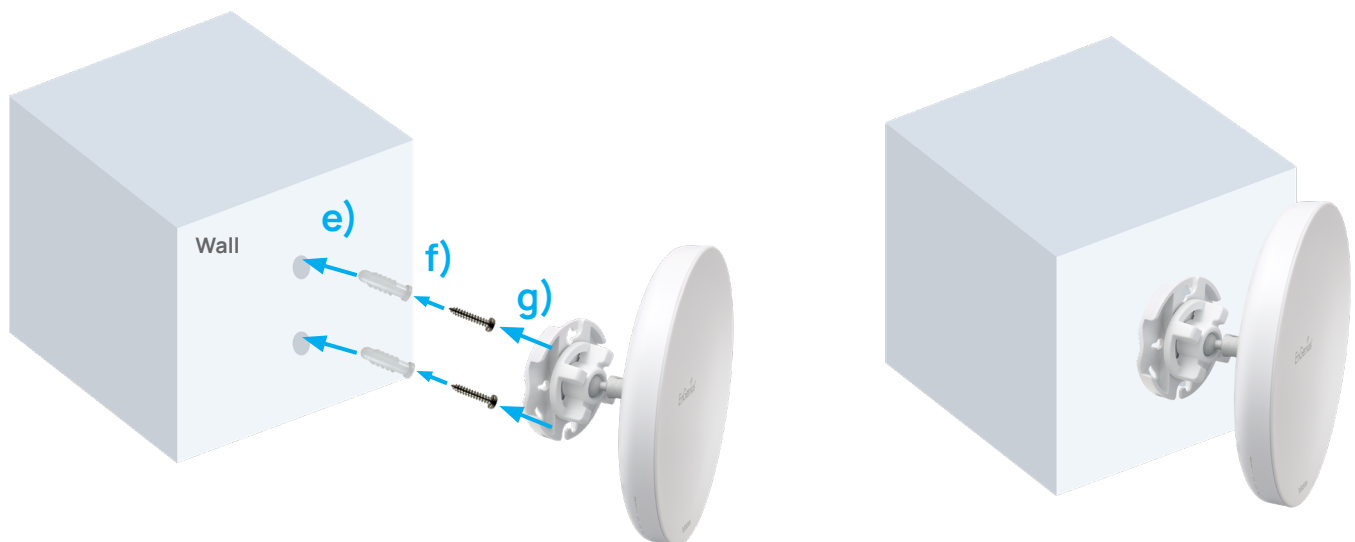

## Pole Mounting

- Thread the open end of the Pole Strap through the two tabs on the Pole Mount Bracket.
- Lock and tighten Pole Strap to secure Pole Mount Bracket to the pole.



- Plug the dynamic stick into the bracket.
- Screw the sealing nut and assembled parts, tighten it with 80kgf.cm.
- Put the nock washer on the dynamic stick.
- Assemble the mounting parts to the device.
- Thread the open end of the pole strap through the two tabs on the bracket.
- Lock and tighten the pole strap to secure the bracket to the pole.

